

AIR CONDITIONER (WAC*AW08ECB7/XAA)

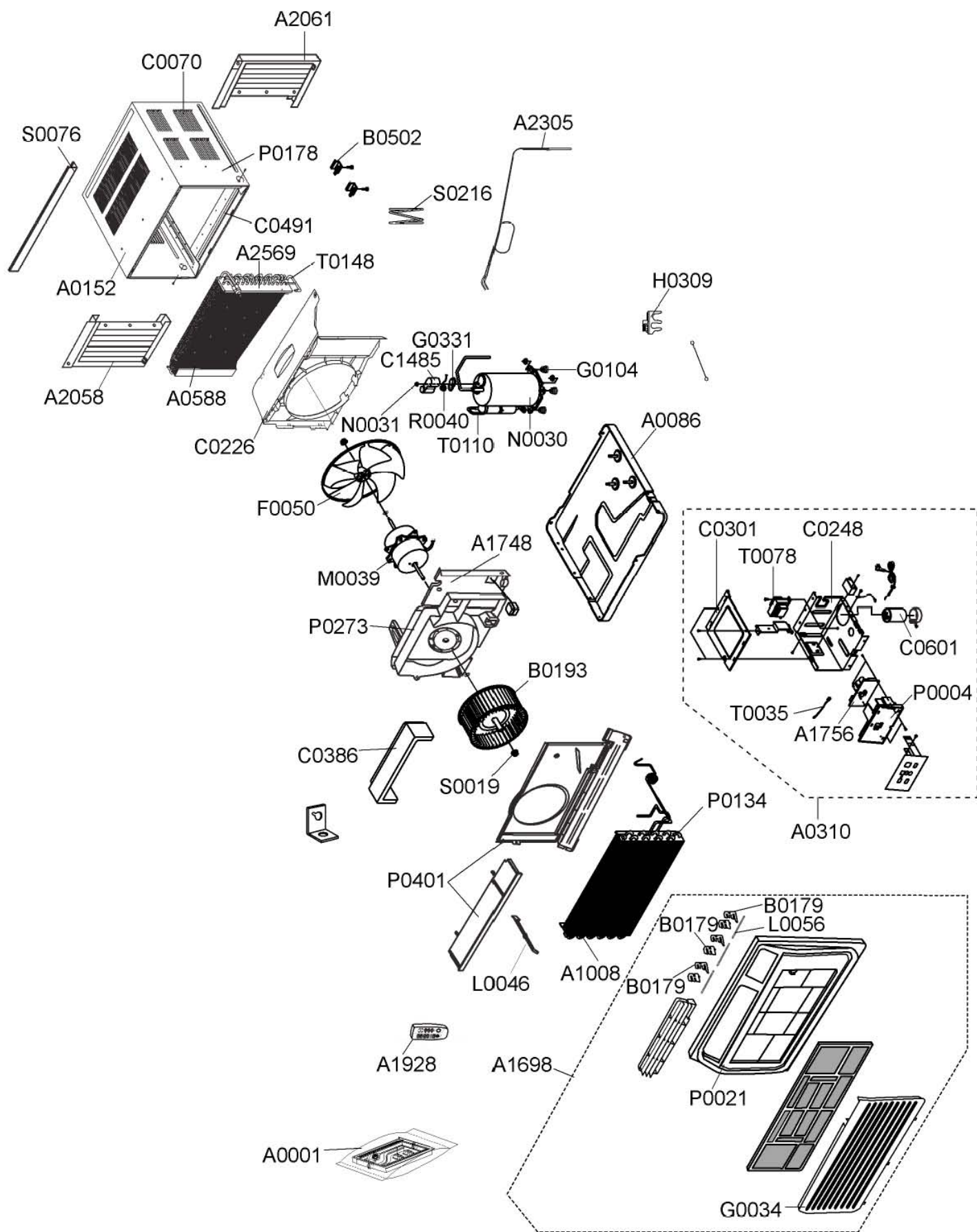

...3501-001169	RELAY-POWER;12VDC,0.9W,20000MA,SPST,20MS	R0042	SA
...3601-000263	FUSE-CARTRIDGE;250V,3.15A,TIME-LAG,GLASS	F0178	SA
...3601-001399	FUSE-RADIAL LEAD;250V,800mA,TIME DELAY,P	F0180	SNA
...3708-000523	CONNECTOR-FPC/FFC/PIC;8P,2.54MM,STRAIGHT	C1101	SA
...3711-000203	HEADER-BOARD TO CABLE;1WALL,2P/3P,1R,7.9		SA
...3711-000796	HEADER-BOARD TO CABLE;BOX,2P,1R,2.5MM,ST		SNA
...3711-000880	HEADER-BOARD TO CABLE;BOX,3P,1R,2.5MM,ST		SA
...3711-003407	HEADER-BOARD TO CABLE;1WALL,2P,1R,7.92MM		SNA
...3812-001283	WIRE-NO SHEATH CU;TCWA,300V,52mm(TAPING)	W0076	SA
...6042-001009	EYELET;ID1.8,OD2.2,L3,-,BRASS		SNA
...DB07-00074A	LED DISPLAY;CSE-42202G,H-PJT,2,14,20,22.	L0023	SNA
...DB09-00384A	IC MICOM£»S3C84E9X11-QZ89,-,44P,+5V,10MHS	L0023	NA
...DB39-00264L	CONNECT WIRE-MOTOR;H-P/J,#1015 18 AWG,-,	C0883	SNA
...DB41-00503A	PCB-MAIN;H-P/J,FR-1,ONE-LAYER,VERSION1,T		SNA
...DB61-00924A	HOLDER-FUSE;- ,FH-51B,-,-,-,SSEC	H0180	SNA
...DB62-03085A	HEAT SINK;- ,A6063,25,15,15,-,-,SSEC	H0034	SNA
...DB93-04822C	ASSY POWER CORD;LCDI,AMERICA,125V/10A,15	A1879	SA
...DB98-26867D	ASSY-LABEL UL;CO,-,18000BTU,AW18ECB7GEA,	L0111	SNA
...2501-001311	C-OIL;8/50uF,370V,MF,OD50*110mm,20.6mm	C0601	SA
...6002-000239	SCREW-TAPPING;TH,+,-,2S,M4,L8,ZPC(WHT),S	S0025	SA
...6002-000527	SCREW-TAPPING;TH,+,-,2S,M4,-,ZPC(WHT),ST	S0025	SA
...6002-000534	SCREW-TAPPING;PH,+,-,2S,M3,L8,ZPC(BLK),S	S0025	SNA
+ DB94-01317A	ASSY FAN PARTS;AW08ECB7XAA,8000BTU		SNA
...DB31-00215A	MOTOR FAN;YSK40-6S-1,H1-PJT,-,-,-,1030	M0039	SA
...DB60-00154B	FASTENER-MOTOR;- ,MSWR10,-,T2.0,OD21.5,ID	F0066	SA
...DB60-30004A	SCREW-MACHINE;FL,-,-,M6,-,ZPC(WHT),SWRCH	S0019	SA
...DB60-30020A	SCREW-MACHINE;FL,-,-,M6,-,ZPC(WHT),SWRCH	S0019	SA
...DB67-50077A	FAN-PROPELLER;- ,ABS,290,-,-,-	F0050	SA
...DB67-50078D	BLOWER;AZ09PHHEA,ABS+GF20%,-,-,-,-	B0193	SA
+ DB95-01167A	ASSY COMP PARTS;AW08ECB7XAA,8000BTU		SNA
...39B076HSAEA	ROTARY COMPRESSOR;115V,60HZ,1P;	R0110	SA
...6021-000124	NUT-HEXAGON;1C,M8,ZPC(YEL),SM10C	N0030	SA
...6021-001142	NUT-HEXAGON FLANGE;- ,M5,ZPC(YEL),SWCH10A	N0031	SA
...DB35-00024G	RELAY PROTECTOR O/L;- ,39B080HSAEA,MRA134	R0040	SA
...DB61-01897A	SPRING ETC-OLP;- ,STS304-WPB,-,24.9,-,-,3	S0216	SA
...DB61-02968A	BRACKET-COMP;Y-P/J,SGCC,T1.0,24,24,WHITE		SA
...DB63-00762B	COVER TERMINAL;AW069CB,GE NORLY,-,-,-,-,	C1485	SA
...DB63-00764A	GROMMET ISOLATOR;39A,EPDM,-,-,-,-,-,39	G0104	SA
...DB63-00765A	GASKET;R/COMP,EPDM,0.8,-,-,-,65-70,EPDM	G0331	SA
...DB63-01713A	COVER-OLP;H-P/J,PVC,T2.5,17,17,-,-,WHITE		SA
+ DB96-07194A	ASSY EVAP PARTS;AW08ECB7XAA,8000BTU		SNA
...DB96-07133A	ASSY EVAP;AW08ECB7XAA,3*11*390mm	A1008	SA
...DB01-00129A	FOIL;- ,WAC,FOIL,0.095,622,-,GREY,SILICA		SA
...DB62-00328B	TUBE JOINT;- ,C1120T-O,T0.8,-,L100,-,-	T0058	SNA
...DB62-02813A	TUBE-CU;- ,C1220T-O,0.28,7.0,-,-,Tw0.25 H	T0125	SA
...DB62-04423A	TUBE-EVAP IN;H1-TOP,C1220T-0,T0.7,OD4.76	T0017	SNA
...DB62-04424A	TUBE-EVAP OUT;H1-TOP,C1220T-0,T0.7,OD7.0	T0017	SNA
...DB70-00360D	PLATE-EVAP LF;H1-P/J,SGCC-M,-,T0.6,W49.5	P0400	SNA
...DB70-00361D	PLATE-EVAP RH;H1-P/J,SGCC-M,-,T0.6,W49.5	P0134	SA
...DB96-10256A	ASSY U-BEND C1220T-0,OD7,T0.41,RING 1.3	P0134	SA
...DB96-10257A	ASSY U-BEND C1220T-0,OD7,T0.41,RING 1.3	S0107	SA
+ DB96-07195A	ASSY COND PARTS;AW08ECB7XAA,8000BTU		SNA
...0202-001163	SOLDER-SILVER;BCUP-3S,KSD67,OD3.0,AG3.0%	S0107	SNA
...0204-000418	FREON;KORFROM-22,CHCLF2,99.9%,-	F0175	SNA
...DB96-07134A	ASSY COND;AW08ECB7XAA,2*14*505mm	A0588	SA
...DB01-00128A	FOIL;- ,WAC,FOIL,0.095,622,-,WHT,NORMAL		SA

DB62-00328A	TUBE JOINT-JUMP;C1220T-0,OD7,T0.7,L63.4,	T0058	SA
DB62-02813A	TUBE-CU;- ,C1220T-O,0.28,7.0,- ,Tw0.25 H	T0125	SA
DB62-04778A	TUBE COND-OUT;AW08NCB7XAA,C1220T-0,T0.7,	T0148	SA
DB62-31730A	TUBE-TRIPOD;BCUP-3,7.0,0.8,25,BCUP-2	T0109	SNA
DB65-10088B	CABLE-TIE;- ,NY-66,- ,-,L140MM	C0095	SNA
DB70-00362B	PLATE-COND;- ,SGCC-M,- ,T0.6,W16,- ,L336.5,	A2569	SA
DB70-00363E	PLATE-COND L,R;H1-P/J,SGCC-M,- ,T0.6,W57,	A2569	SA
DB96-06918A	ASSY TUBE COND IN;H1-P/J,10K-NOR	A2320	SNA
DB96-10256A	ASSY U-BEND C1220T-0,OD7,T0.41,RING 1.3	A2320	SA
DB62-30368A	TUBE-U BEND;C1220T-O,OD7.0,T0.41,L47,-	T0109	SNA
0102-000252	COPPER-TUBE;C1220T,O,OD7.0,- ,ROLL,-	T0125	SNA
DB93-50001A	ASSY-WIRE RING SOLD;- ,PI1.6	A1527	SNA
DB96-10257A	ASSY U-BEND C1220T-0,OD7,T0.41,RING 1.3	S0107	SA
DB62-30369A	TUBE-U BEND;C1220T-O,OD7.0,T0.41,L44.4,-	T0109	SNA
0102-000252	COPPER-TUBE;C1220T,O,OD7.0,- ,ROLL,-	T0125	SNA
DB93-50001A	ASSY-WIRE RING SOLD;- ,PI1.6	A1527	SNA
0202-001022	SOLDER-SILVER;- ,RL KS6704,D1.6,7P/93Cu,P	S0107	SNA
DB96-07196A	ASSY TUBE PARTS;AW08ECB7XAA,8000BTU		SNA
DB62-04769A	SEAL-COVER TUBE;H1-P/J,FOAM-PE,GRAY,T30,		SA
DB62-04826A	TUBE DISCHARGE;AW08ECB7XAA,C1220T-0,T0.7	T0008	SNA
DB62-04827A	TUBE SUCTION;AW08ECB7,C1220T-0,T0.7,OD9.	T0110	SNA
DB96-07131A	ASSY TUBE CAPILLARY;AW08ECB7XAA,H1-P/J,	A2305	SA
DB97-05642A	ASSY ACCESSORY PARTS;CO,- ,8000BTU,- ,-,		SNA
DB47-00035A	HOLDER;- ,-,1.5V,- ,AAA,NO HG,- ,-,	H0353	SNA
DB93-03018Y	ASSY REMOCON;Danby,ARC-758	A1928	SA
DB97-00252A	ASSY ACCESSORY-SEAL;SPS-P/J,GE,-	A0285	SA
DB72-00140M	SEAL-BASE;- ,-,T10,W25,L660,SPS-P/J	S0238	SNA
DB72-00200A	SEAL-ANGLE UP;- ,-,SPS-P/J,T5,W10,L660,-		SNA
DB97-03298A	ASSY-INSTALL PART;- ,co,- ,6K,- ,-,		SNA
DB64-00048H	SHUTTER-ANGLE UP;H1-P/J,HIPS,T3.0,- ,66	S0076	SA
DB97-02854B	ASSY ACCESSORY-BOX;- ,-,H1-P/J,DA	A0001	SA
DB61-30219F	BRACKET-INSTALL;GE,SPS-P/J,SGCC-A,T1.6,-	B0502	SA
DB69-01185B	BAG ACCESSORY;DANBY,- ,-,H1-P/J		SNA
DB72-00140J	SEAL-INSTALL WINDOW;- ,-,GRAY,T15,W35,L94		SA
DB72-10102X	SEAL-WINDOW SHUTTER;- ,-,STK,T3,35,940,		SA
DB92-00112C	ASSY SHUTTER-RH;H1-P/J,ASSY	A2061	SA
DB92-00113C	ASSY SHUTTER-LF;H1-P/J,ASSY	A2058	SA
DB97-30156C	ASSY ACCESSORY;- ,-,SPS/GEA,ASSY	A0001	SA
6002-000239	SCREW-TAPPING;TH,+ ,-,2S,M4,L8,ZPC(WHT),S	S0025	SA
6005-000124	SCREW-WOOD;RH,+ ,M5,L16,ZPC(WHT),MSWR10	S0018	SA
DB60-20015B	BOLT-HEX;HEX,M10,L20,ZPC3,MSWR10,-	B0249	SNA
DB61-30133B	BRACKET-INSTALL;- ,SBHG1-M,T1.0,- ,-,	B0502	SA
DB69-40027A	BAG PE;HDPE,0.05,100,150,- ,-,	B0016	SA