



# SPECIFICATIONS DC2

## FEATURES

- Dual 15-in woofers maximize LF output
- Horn-loaded 10-in cone mid frequency section with Radial Phase Plug™
- Horn-loaded 1.4-in exit/3-in voice coil HF compression driver
- Cutaway rear corner directs coverage down from a position close to the ceiling
- High-output system designed to deliver the extreme level requirements of high energy dance clubs

## DESCRIPTION

The DC2 is engineered for use in permanent installations. The system includes dual 15-in woofers in an optimally vented enclosure, a horn-loaded 10-in midrange and a 1.4-in exit/3-in voice coil high frequency compression driver on a 90° (h) x 40° (v) dispersion constant directivity horn.

A complex asymmetrical internal passive crossover/filter network provides MF/HF subsystem integration. An MX Series Close Coupled Processor™ should integrate the LF and MF/HF subsystems.

## APPLICATION

The DC2 bi-amplified three-way dance club system provides high output, high definition reinforcement for medium to large sized clubs. Overall design is robust to ensure reliability in the face of continuous peak output operation.

The DC2 is designed for overhead mounting in a horizontal configuration to cover medium to large sized dance floors. It is also very effective when used as a reinforcement system in live music clubs. Its cutaway upper-rear corner allows it to tuck up next to the ceiling while angling its coverage down 20°. The enclosure includes balance-optimized threaded mounting points.

Like all EAW products, it can be special ordered in virtually any color to match a specific décor. Six year warranty.

## PERFORMANCE

### Frequency Response

±3 dB	56 Hz to 18 kHz
-10 dB	45 Hz

### Axial Sensitivity (dB SPL, 1 watt @ 1 m)

Passive MF/HF	108
LF	100

### Nominal Input Impedance (ohms)

Passive MF/HF	6
LF	4

### Power Handling (watts, continuous)

Passive MF/HF	350
LF	1600



### Calculated Output Limit (dB SPL @ 1 m)

Passive MF/HF Peak	139
LF Peak	138
Passive MF/HF Long term	133
LF Long Term	132

### Nominal Beamwidth (degrees @ -6 dB SPL)

Horizontal	90
Vertical	40

## PHYSICAL

Product Group	Avalon
Configuration	3-way full-range
Powering	Bi-amplified (passive MF/HF crossover)
LF Subsystem	2x 15-in woofers, vented
MF Subsystem	1x 10-in cone, horn-loaded
HF Subsystem	1.4-in exit/3-in voice coil compression driver on CD horn
Enclosure Material	Exterior-grade Baltic birch plywood
Finish	Wear-resistant textured black paint
Connectors	2x Neutrik NL4 Speakon
Suspension Hardware	8x 3/8"-16 threaded mounting points (4 top, 2 per side)
Grille	Zinc coated perforated steel

### Dimensions

	inches	millimeters
Height (front)	22.5	572
Height (rear)	19.3	489
Width	57.1	1449
Depth	19.0	483

### Weights

	pounds	kilograms
Net Weight	190	86.5
Shipping Weight	207	94.2





# SPECIFICATIONS DC2

## DESCRIPTION

- ⊙ INDICATES MOUNTING POINT, 3/8-16 THREADED HOLE (PI ANGLE).
- ⊕ INDICATES CENTER OF BALANCE

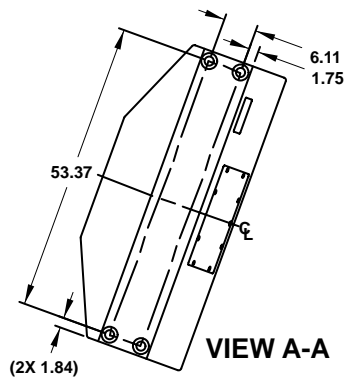
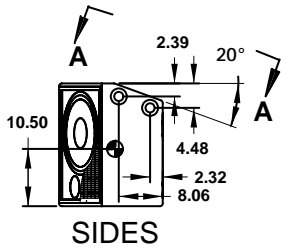
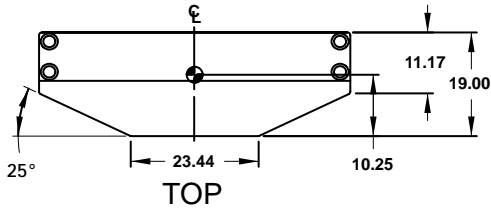
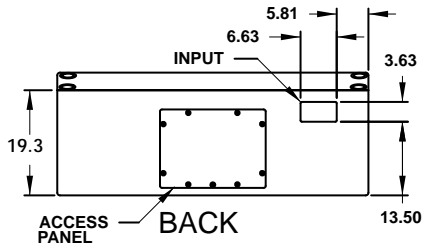
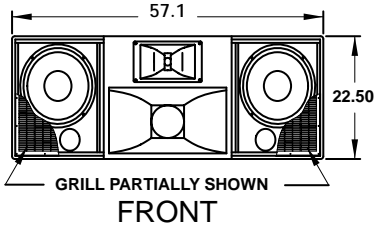

ANGLED TOP

## INPUT PANEL

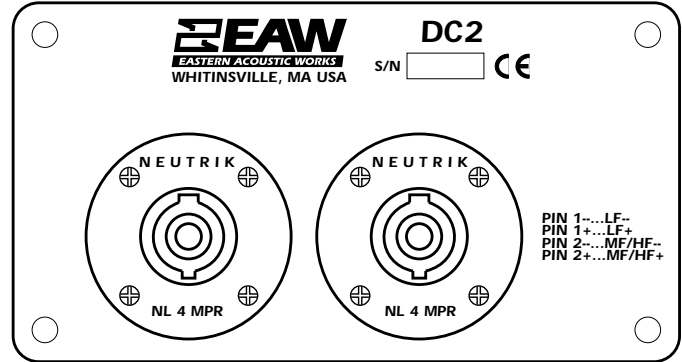

510888 (0)  
8/24/99

Manufacturing tolerances are +/- 0.13 and +/- 1°

