

# EXPLODED VIEW ELLIS DIVIDING HEAD

IMPORTANT — WHEN ORDERING PARTS  
PLEASE INDICATE ON YOUR ORDER THE  
SERIAL NUMBER OF YOUR DIVIDING HEAD

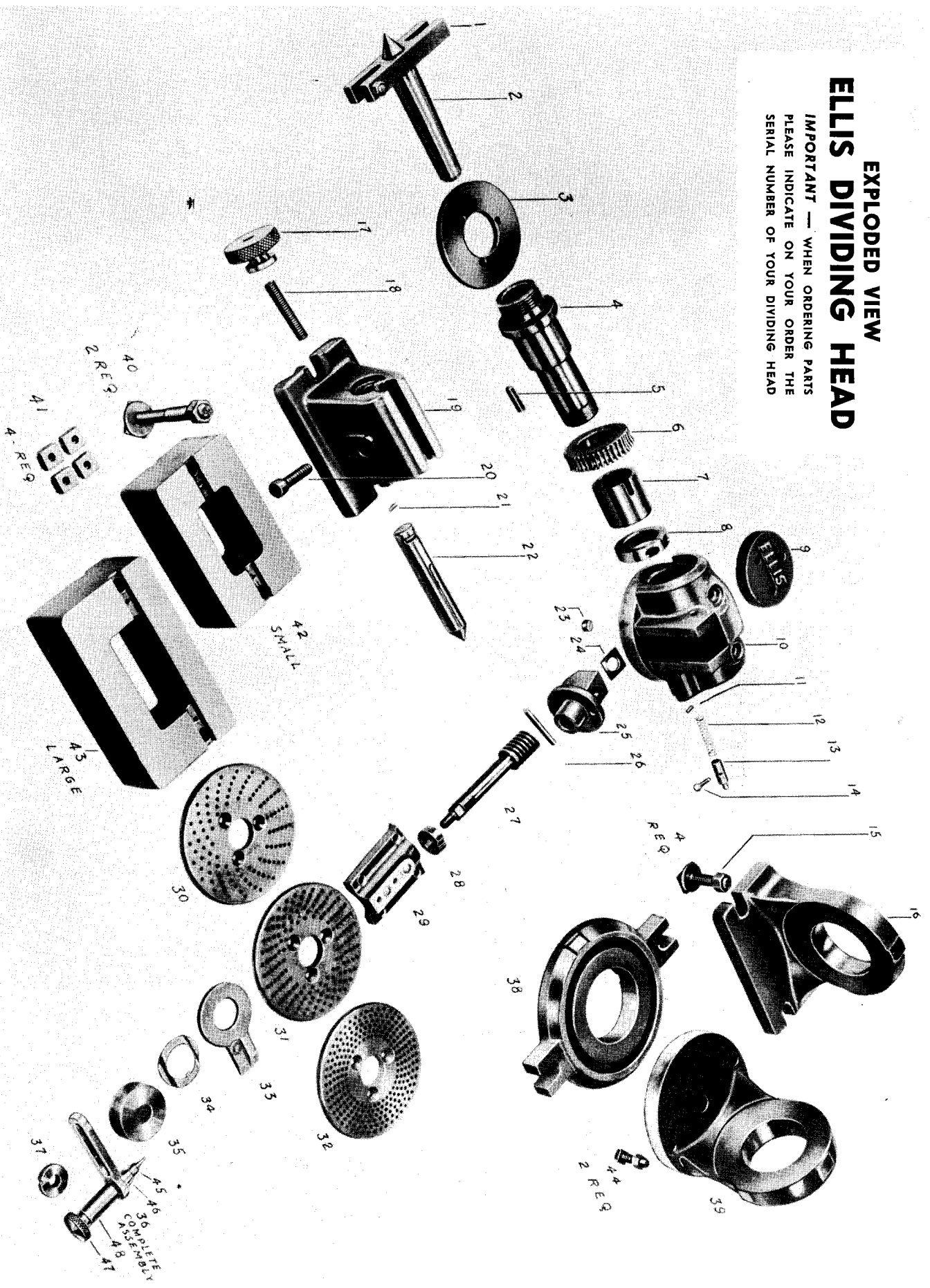

## ELLIS TOOL & MANUFACTURING COMPANY

*Manufacturers of Ellis Dividing Head*

712 HICKSON STREET • EL MONTE, CALIFORNIA • Cumberland 3-5445

**PARTS LIST**

- 1. Center Drive Arm
- 2. Dividing Head Center
- 3. Direct Index Plate (Blank)
- 4. Spindle
- 5. Spindle Key
- 6. Worm Wheel
- 7. Spindle Bushing
- 8. Spindle Nut
- 9. Body Locking Cap
- 10. Body
- 11. Direct Index Lock Pin
- 12. Direct Index Spring
- 13. Direct Index Pin
- 14. Direct Index Handle
- 15. Hold Down T-Bolts (short — 4 required)
- 16. Base (Standard)
- 17. Tailstock Adjusting Nut
- 18. Tailstock Adjusting Nut Stud
- 19. Tailstock
- 20. Spindle Lock Screw
- 21. Tailstock Center Guide Pin
- 22. Tailstock Center
- 23. Spindle Lock Shoe
- 24. Worm Thrust Washer
- 25. Worm Bearing
- 26. Worm Bearing Shaft
- 27. Worm
- 28. Worm Lock Nut
- 29. Body Cap
- 30. Index Plate No. 1
- 31. Index Plate No. 2
- 32. Index Plate No. 3
- 33. Sector Arm Assemblies Complete
- 34. Sector Arm Tension Spring
- 35. Tension Spring Cover
- 36. Crank Arm Assemblies Complete
- 37. Crank Arm Washer
- 38. Base (Swivel)
- 39. Swivel Base Body
- 40. Hold Down T-Bolts (long — 4 required)
- 41. T-Slot Keys (4 required)
- 42. Riser Block (small)
- 43. Riser Block (large)
- 44. Swivel Base Hold Down Bolts (2 required)
- 45. Indirect Index Pin
- 46. Indirect Index Pin Spring
- 47. Crank Arm Knob
- 48. Crank Arm
- 49.
- 50.