

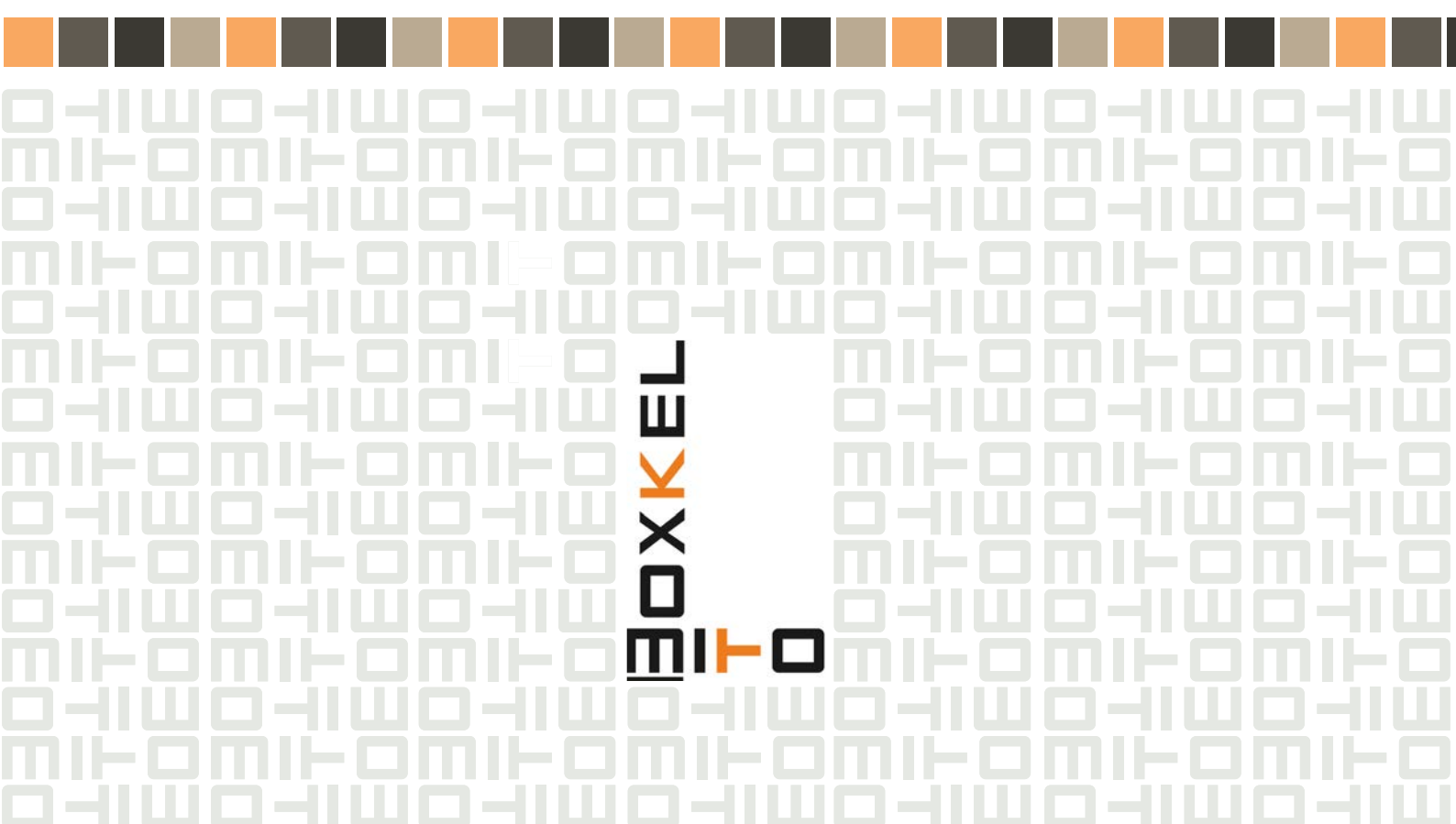

OPTIMO

FITTING INSTRUCTIONS



FITTING INSTRUCTIONS

POCKET DOOR FRAME "OPTIMO" FOR PLASTERBOARD WALLS 100MM THICKNESS

Available in kit format for self assembly

1. Insert horizontal front profiles (9) and fix them to the provided holes in the rear upright (3) and to the front profiles (1) and (2).
2. Repeat this procedure to the opposite side of the pocket door frame.
3. Insert the top cover (4) and fix it to the predrilled holes with the screws provided.
4. Insert the sliding top track (10) into the top cover (4) pushing it until it is fully inserted and stops.
5. Insert the lower installation alignment bar.
6. Fix the timber frame stop jamb (7) to the sliding top track with the nails provided.
7. Insert the middle installation alignment bar (12)
8. Place a plasterboard guide onto the floor aligned with the wall to be constructed and insert the pocket door frame.
9. Continue with the pocket door frame installation attaching the plasterboard sheets to the pocket door frame to form the finished wall.

NOTE – all numbers are in brackets () not speech marks ""

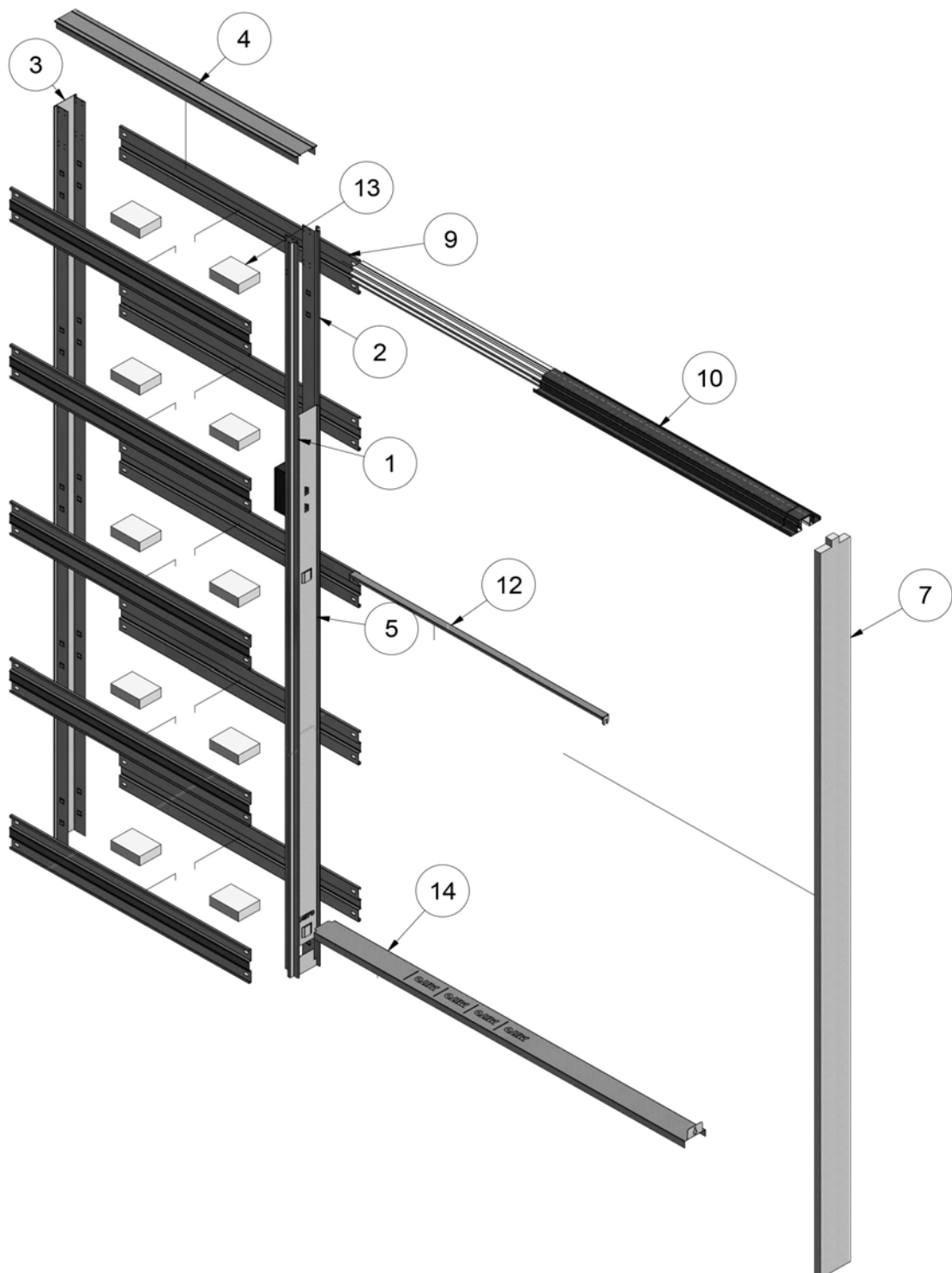

FITTING INSTRUCTIONS

Place the vertical front (A) and rear (B) pocket door frame profiles onto two trestles as shown. Insert between the uprights the horizontal cross members (3) to the fixing points indicated where they click and lock into place. Repeat this procedure on the opposite side once the pocket door frame has been turned over.

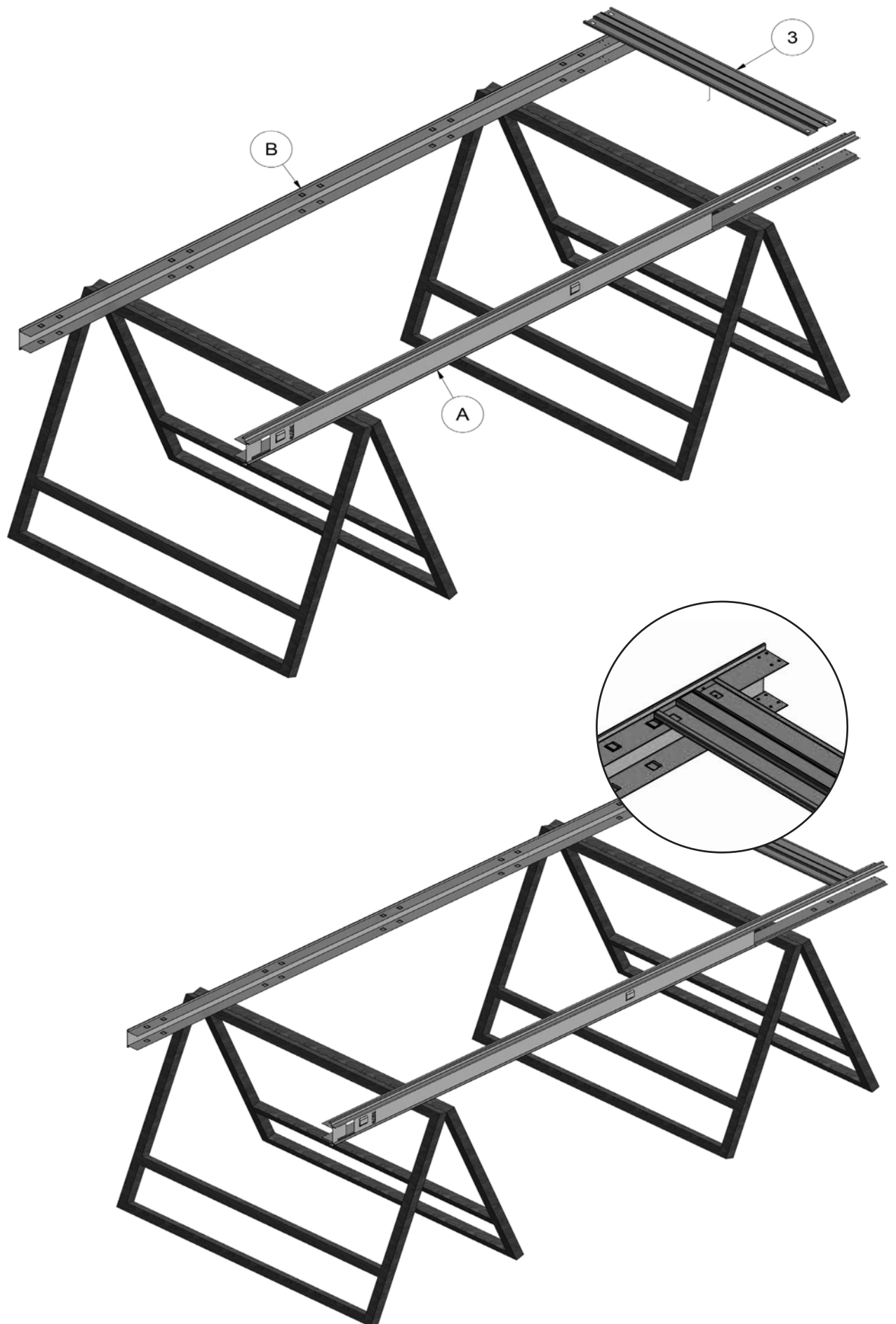

FITTING INSTRUCTIONS

1st Diagram – top cover needs to be labelled with “C” in a circle like third diagram has a “D”

Now the pocket door frame is ready to be completed with the sliding accessory set being fitted to the door and then final installation with the plasterboard panels to complete the finished wall.

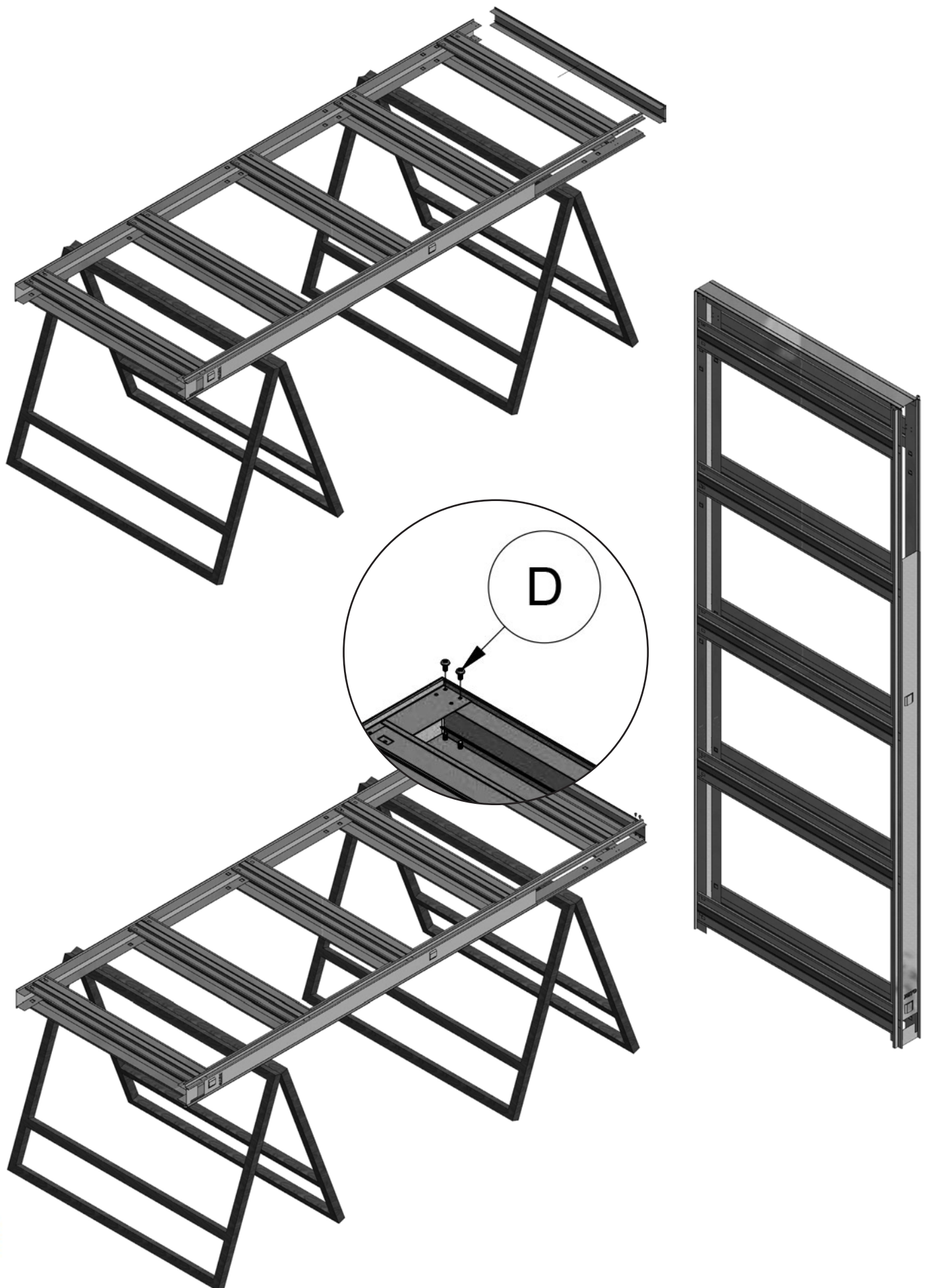

POCKET DOOR FRAME "OPTIMO" INSTALLATION.

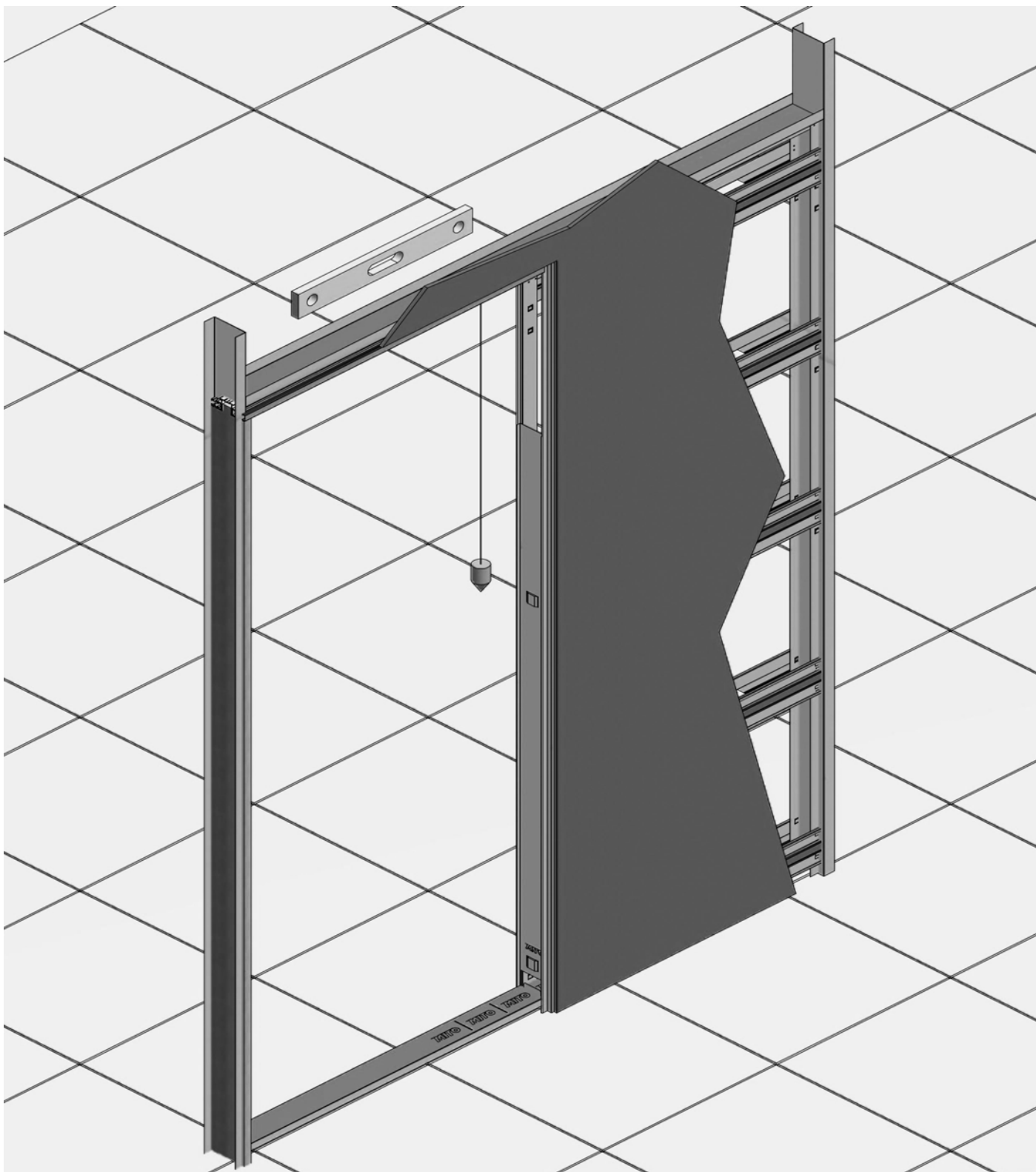

Position the pocket door frame into the plasterboard guide previously placed onto the floor and aligned with the wall to be constructed. Check the alignment of the top of the pocket door frame with the floor using a plumb line as shown; should there be a discrepancy, assume the floor is correct and adjust the alignment of the top of the pocket door frame accordingly. Place the wooden frame stop jamb next to the bottom installation alignment bar and fix the jamb to the bar. On the pocket side fix again fix the bottom installation alignment bar to the vertical upright which forms the mouth of the pocket. Fix the middle installation alignment bar to the wooden frame stop jamb and the vertical upright in the same way. Now fix the plasterboard sheets (not supplied) to the pocket door frame using self-tapping screws, ensuring the screws penetrate through the metal parts of the frame. For this purpose self-tapping screws to a maximum length of 20mm should be used assuming a plasterboard thickness of 12.5mm.



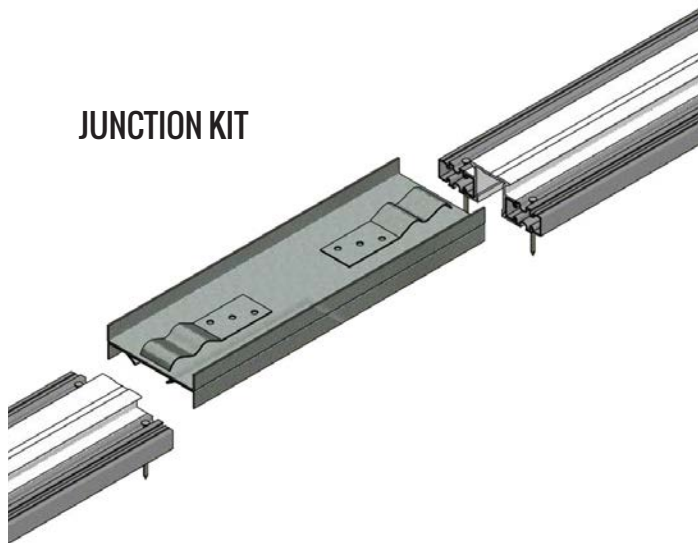

DOUBLE WING

After inserting and fixing the transom in the box-frame, insert the joining bracket into one rail for half of its length and fix it with supplied screws. Then insert the second transom and the second rail until they touch. Fix the second rail with supplied screws, insert distance transom into the provided space of the box-frame frontal part, then go on with the box-frame placement.

JUNCTION KIT

If you want to make a double wing box-frame from two single wing box-frames, it is necessary to cut the front part of the rail, taking as reference the predisposed hole in the plate. We advise to fix the rail and the support plate with further screws to get a more solid structure. Join the two rails inside the plate, the rails should touch in the middle of the junction kit, marked with the appropriate hole with triangle form.



OVERALL SIZE

L1 = Nominal W + 40 mm.

L2 = Nominal W x 2 + 70 mm.

H1 = Nominal H + 50 mm.

H2 = Nominal H + 85 mm.

INTERNAL BOX FRAME SPACE:

Finished wall mm. 100, internal box frame space mm. 58.

DOOR PANEL ASSEMBLY

Remove the box frame frontal cover, place the lower rail at the box frame base and fix it to the metallic box with supplied dowels or to the floor with fisher. Insert door profiles brush holders into the box-frame opening in the provided seat. Fix suspension brackets to the upper part of the door panel and make sure that provided holes for the carriage introduction are turn to the same side. Fix impact rubber to the back box-frame side and add shims if you prefer the door panel is not completely disappeared into the box-frame when the door is open. Insert carriages into the sliding rail in the provided hole placed in the side of the impact upright. Hook the door panel to the sliding carriages, regulate the height and check the alignment of plumb respect to the ground level. Insert upper transoms and then the impact jamb checking their perpendicularity respect the closed door panel. At the end fix frame covers on both wall sides.

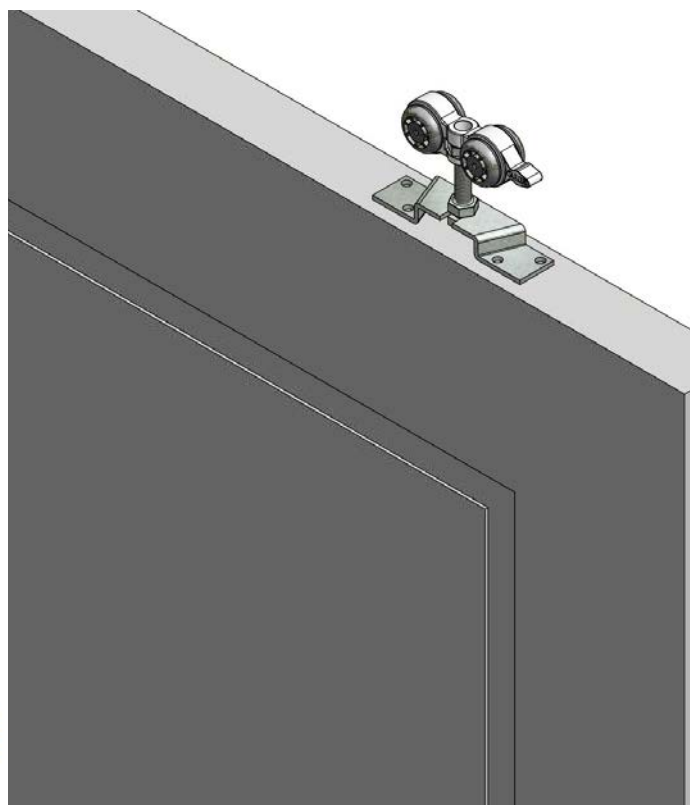
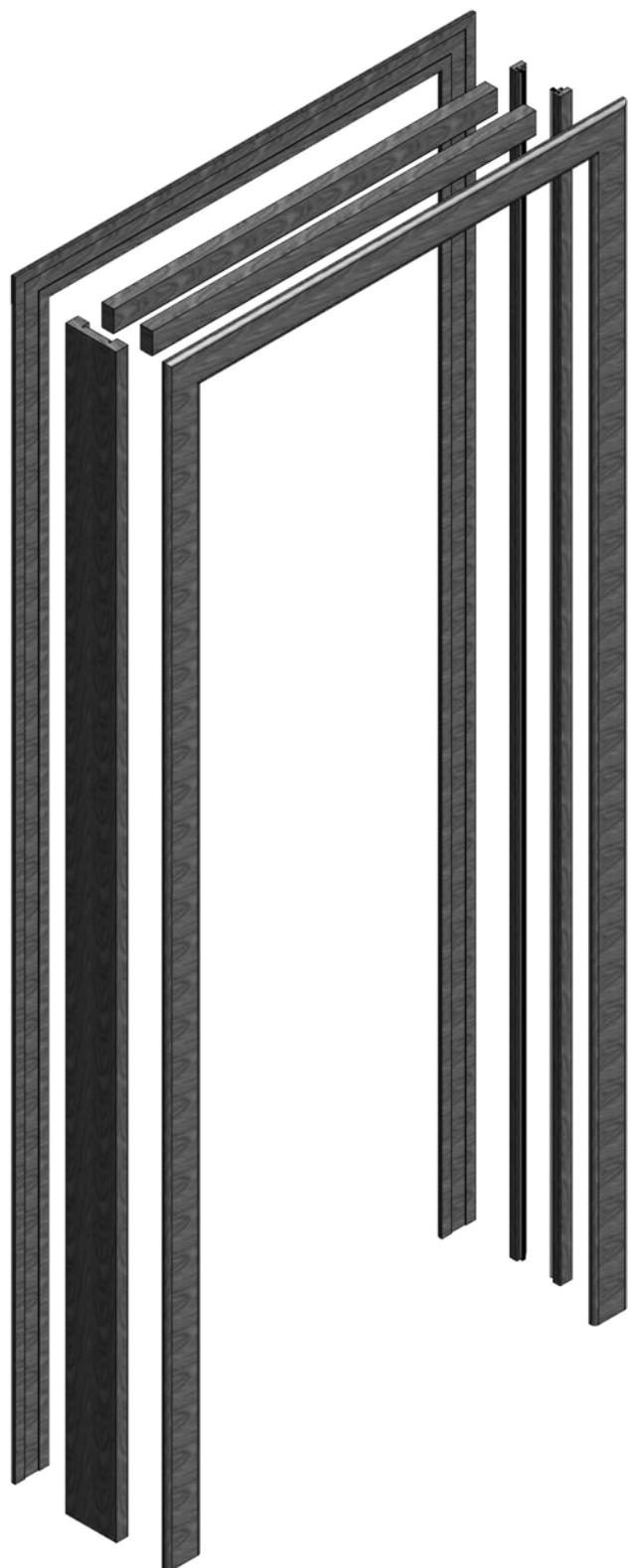
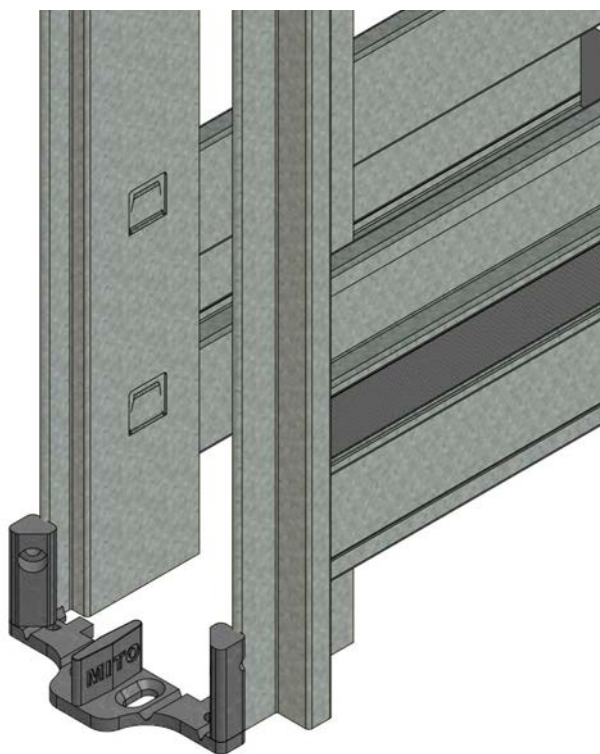

POCKET DOOR FRAMES FOR SINGLE DOORS

Plasterboard version

MAX PASSAGE SIZE	OVER DIMENSION	A	B	FINISHED WALL	PANEL DIMENSION	CODE
PW x PH	W x H			Sp	Standard DW DH	
600x2030	1288x2115	640	615	100	626x2040	99690133
700x2030	1488x2115	740	715	100	726x2040	99690135
800x2030	1688x2115	840	815	100	826x2040	99690137
900x2030	1888x2115	940	915	100	926x2040	99690139
1000x2030	2088x2115	1040	1015	100	1026x2040	99690141
585x1971	1273x2056	625	615	100	610x1981	99690143
661x1971	1449x2056	701	715	100	686x1981	99690145
737x1971	1625x2056	777	815	100	762x1981	99690147
813x1971	1701x2056	853	915	100	838x1981	99690149
900x1971	1888x2056	940	915	100	914x1981	99690151

* Dimensions are given in mm.

- Jamb finishing kit > Code 996090060 (included with pocket door set)
- Architrave finishing kit > Code 996090061 (optional)



> If flush pull handles are to be fitted to the door face, it is recommended that the door track stopper is positioned such that in the fully open position a small part of the door width remains outside the pocket frame. This is to prevent the risk of personal injury via trapped fingers.

> In the event that the door track stopper is positioned to allow the full width of the door to slide inside the pocket frame when in the fully open position, we can not accept liability for any personal injuries that occur.

> Doors, plasterboard panels, and outside architrave sections not supplied.

available accessory sets



Jointing set



Automatic door operator set



Soft closing set



Self closing set



Synchronised operation set



Switching points set

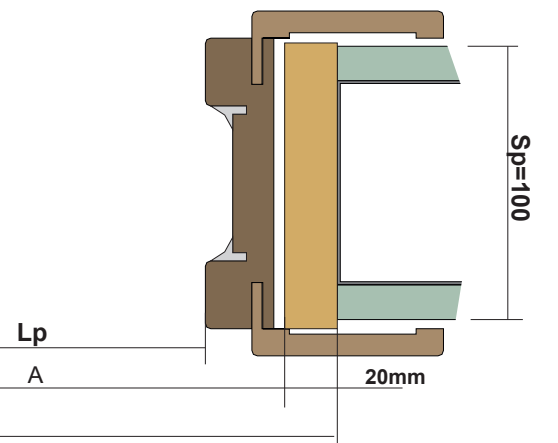
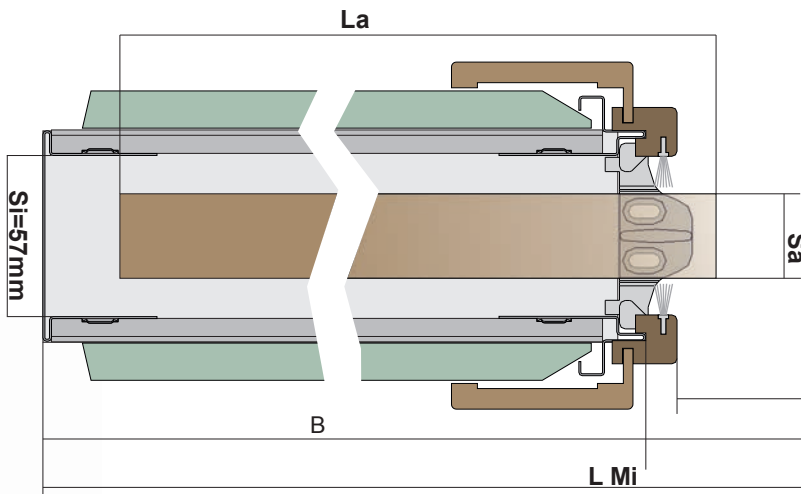
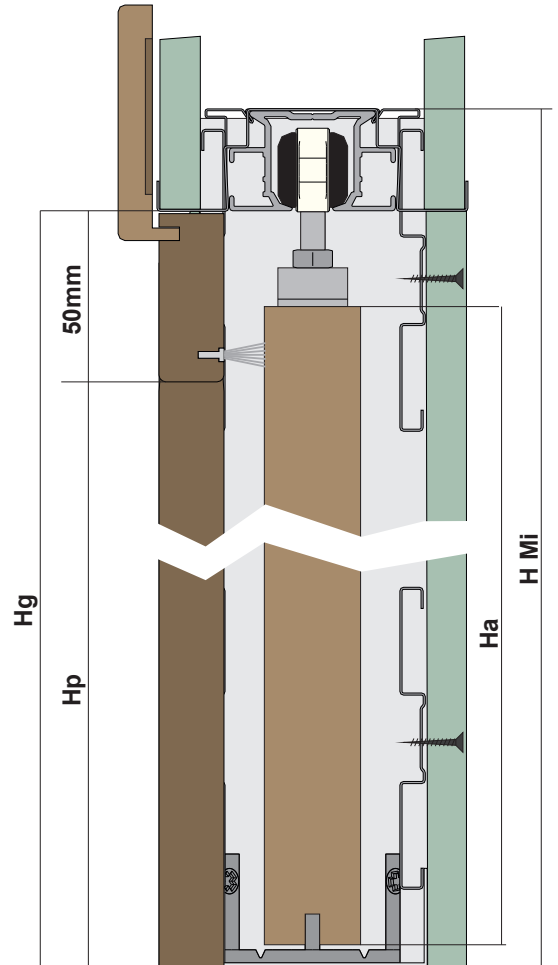
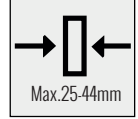

www.boxkel.com

BOXKEL
Poligono Industrial la Foradada
08580 San Quirze de Besora - Barcelona (SPAIN)

Tel. +34 93 852 96 15
Fax +34 93 855 13 42
boxkel@boxkel.com

