

AGES 4+

70058 Asst.

FurReal
friends™

New Born
Kitten

**INSTRUCTION
MANUAL**



© 2003 Hasbro. All Rights Reserved.

® denotes Reg. U.S. Pat. & TM Office.

U.S. Patents Pending

70058

P/N 6327230000

TIGER
ELECTRONICS

TIGERTOYS.COM 
For new products and offers

Questions? Call 1-800-327-8264





Thank you for purchasing the FURREAL FRIENDS Newborn Kitten toy. This cute and adorable kitten moves and sounds like a REAL newborn!

Requires 3 x 1.5V "AAA" or R03 size batteries (not included). Alkaline batteries recommended. Phillips/cross head screwdriver (not included) needed to insert batteries.

The FURREAL FRIENDS Newborn Kitten is an adorable baby kitten that was just born and needs your love and attention. She's very sleepy, so it's your job to gently wake her up. Give her lots of love and affection by petting the soft fur on her back. Listen to her make baby kitten sounds and then gently lift up her head to look at you!

Be sure to take good care of your FURREAL FRIENDS Newborn Kitten by following the instructions in this booklet!

To begin playing with your FURREAL FRIENDS Newborn Kitten, you must first install batteries.

TO INSTALL BATTERIES

Pull back the plush flap, and using a Phillips/cross head screwdriver, loosen screw in battery compartment cover (screw stays attached to cover) on the bottom. Insert 3 X 1.5V "AAA"/LR03 alkaline batteries. Replace cover and tighten screw.

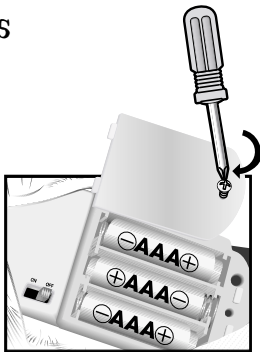

! CAUTION:

1. As with all small batteries, the batteries used with this toy should be kept away from small children who still put things in their mouths. If they are swallowed, promptly see a doctor and, in the U.S., have the doctor phone (202) 625-3333 collect, or, in Canada, have the doctor call your provincial Poison Control Centre.
2. Make sure the batteries are inserted correctly and always follow the toy and battery manufacturers' instructions;
3. Do not mix old batteries and new batteries or alkaline, standard (carbon zinc) or rechargeable (nickel-cadmium) batteries.

IMPORTANT: BATTERY INFORMATION

Please retain this information for future reference. Batteries should be replaced by an adult.

! CAUTION:

1. Always follow the instructions carefully. Use only batteries specified and be sure to insert them correctly by matching the + and - polarity markings.
2. Do not mix old batteries and new batteries or standard (carbon-zinc) with alkaline batteries.
3. Remove exhausted or dead batteries from the product.
4. Remove batteries if product is not to be played with for a long time.
5. Do not short circuit the supply terminals.
6. Should this product cause, or be affected by, local electrical interference, move it away from other electrical equipment. Reset (switching off and back on again or removing and re-inserting batteries) if necessary.
7. RECHARGEABLE BATTERIES: Do not mix these with any other types of battery. Always remove from the product before recharging. Recharge batteries under adult supervision. DO NOT RECHARGE OTHER TYPES OF BATTERIES.
8. As with all small items, these batteries should be kept away from children. If swallowed, seek medical attention immediately.

GETTING STARTED

Your FURREAL FRIENDS Newborn Kitten consists of the following parts:

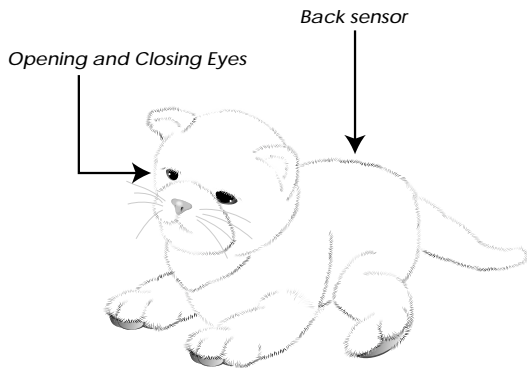

Your Kitten makes a variety of realistic meowing and purring sounds to let you know when she is happy, playful, sleepy, or needs some love and attention!

HOW TO PLAY WITH YOUR NEWBORN KITTEN

To turn your Newborn Kitten **ON**, pull back the plush flap over the battery door and switch the **ON/OFF** switch to **ON**. Then replace the flap.

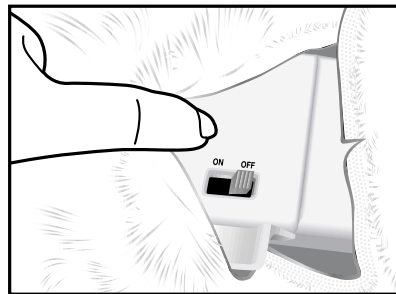

Once turned on, your sleepy Newborn Kitten will begin to wake up. She will start to move her head to an upright "awake" position and will then open her eyes. Now it's time to play with your Kitten!

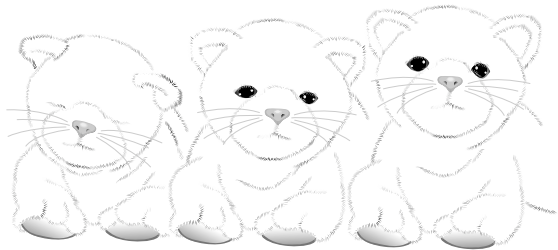

There are two ways to interact with your Newborn Kitten. If you pet her every so often, she will stay awake and will continue to move her head and open her eyes. Keep petting her every few seconds to keep her happy and playful!



Or, if you want to put your Kitten to sleep, pet her constantly without stopping. This nurturing type of petting will calm her down and make her lay her head down, close her eyes, and go back to sleep. If you stop petting her once she has gone back to sleep, she will wake up and look for more attention. If you stop petting her altogether, she will go back to sleep.



NOTE: Please remember to turn the **ON/OFF** switch to the **OFF** position if she will not be played with for a while, to conserve battery life.

Your Kitten is like a real Kitten in many ways. Show her lots of love and affection to keep her happy!

CLEANING INSTRUCTIONS

To clean your kitten's fur, gently brush her with a cloth or soft brush to loosen any dirt. Then use a slightly damp cloth to remove stains.

- DO NOT PUT IN THE WASHING MACHINE
- DO NOT SUBMERGE IN WATER
- DO NOT GET WET EXCEPT A DAMP CLOTH ON THE FUR
- TO PREVENT STAINING THE FUR, WIPE DIRT OFF IMMEDIATELY
- IF THE PUPPY GETS WET, REMOVE THE BATTERIES AND DRY THE FUR
- ONCE COMPLETELY DRY, REPLACE THE BATTERIES
- DO NOT USE DETERGENT OR STAIN REMOVERS ON THE FUR



High temperature will destroy the unit. Do not leave unit in direct sunlight.



Clean only with a piece of soft dry cloth.

- Prevent spills of food and beverage on the unit.
- Do not throw or kick the product, and do not push sharp objects through the speaker openings.

FCC STATEMENT

This equipment has been tested and found to comply with the limits for a Class B digital device, pursuant to Part 15 of the FCC Rules. These limits are designed to provide reasonable protection against harmful interference in a residential installation. This equipment generates, uses and can radiate radio frequency energy, and, if not installed and used in accordance with the instructions, may cause harmful interference to radio communications. However, there is no guarantee that interference will not occur in a particular installation. If this equipment does cause harmful interference to radio or television reception, which can be determined by turning the equipment off and on, the user is encouraged to try to correct the interference by one or more of the following measures:

- Reorient or relocate the receiving antenna.
- Increase the separation between the equipment and the receiver.
- Consult the dealer or an experienced radio/TV technician for help