

ILSCO

C101

Canada

Supplemental Catalog

**Mechanical and Compression
Grounding and Bonding Connectors**

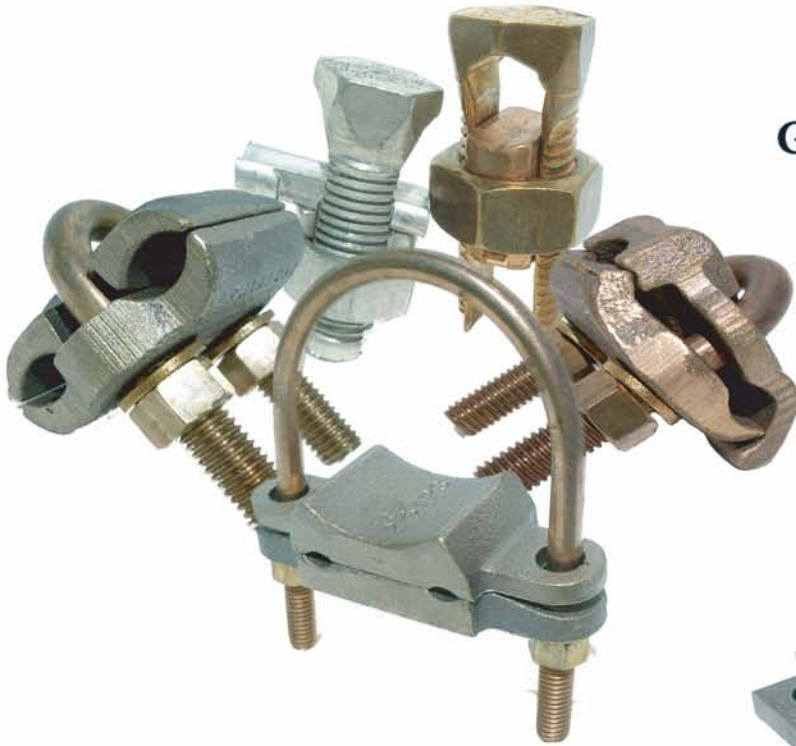

And much more...



Welcome to IlSCO Canada's Supplemental Catalog!

The products in this catalog are offered by IlSCO Canada Ltd. , solely for the Canadian market, and are additional to those found in the IlSCO "Solution Book" catalog.

Please be sure to obtain a copy of IlSCO's "Solution Book" catalog, for a complete detailing of the extensive line of products offered by IlSCO and IlSCO of Canada Ltd. to the entire North American market.



ILSCO Solution Book

Complete North American product catalog available by contacting your local IlSCO Canada Ltd. Sales Representative or by calling our office in Mississauga.

ILSCO of Canada Customer Service Hot Line:
TOLL FREE: 1 (800) 665-2607

Location	ILSCO Canada Ltd. Sales Agencies	Phone	Fax	email
Atlantic Provinces:	King-Rea Electrical Sales	(902) 674-2083	(902) 674-2991	alan.rea@ns.sympatico.ca
Quebec:	Theovine	(514) 637-0050	(514) 637-4630	abrunet@theovine.com
East/North Ontario:	MGS Sales	(613) 248-9308	(613) 248-9095	guathiermoe@sympatico.ca
Manitoba:	Hi-Tech Sales Ltd.	(204) 694-0000	(204) 694-0433	hi-tech_sales@mts.net
Saskatchewan:	Electra Sales	(306) 791-0266	(306) 791-0268	electrakirby@sasktel.net
South Alberta:	EP Sales	(403) 242-9883	(403) 242-9875	bob.elliston@epsalescalgary.com
British Columbia:	Milham Industries	(604) 526-4288	(604) 526-1850	freichard@milhamindustries.com

Position	ILSCO Canada Ltd. Representatives	Phone	Cell	Fax	email
VP Sales/Marketing	Bruce Petrie	(905) 274-2341	(416) 399-5497	(905) 274-2689	bpetrie@ilsco.com
National Sales Mgr.	Bruce Mackay	(403) 263-9330	(403) 830-1169	(403) 263-9360	bmackay@ilsco.com
Eastern Reg. Sales Mgr.	Al Legare	(905) 274-2341	(416) 565-5506	(905) 274-2689	alegare@ilsco.com
South Ont. Sales Rep.	Ron Stern	(905) 274-2341	(416) 399-4572	(905) 274-2689	rstern@ilsco.com
S. West Ont. Sales Rep.	Denis Leduc	(905) 274-2341	(519) 755-9689	(905) 274-2689	gmartin@ilsco.com
N. Alberta Sales Rep.	Art McCandless	(780) 986-5967	(780) 990-9466	(780) 986-5972	amccandless@ilsco.com

TYPE GGA

Features

- Manufactured from high strength copper alloy
- Clearly marked with wire size and die index
- Range taking
- Connector can be adjusted prior to installation
- Non-hazardous installation
- Prefilled with inhibiting compound
- Temperature Rating 90°C

Benefits

- Provides maximum conductivity and eliminates the possibility of corrosion. Suitable for direct burial.
- Provides easy identification and tooling recommendation
- Reduces inventory. Six sizes cover a wire range from 500MCM to #6, and 1/2" to 3/4" ground rods.
- Permits adjustments to be made for misaligned cross grids
- Can be installed in all types of weather with no need for protective equipment or clothing. Does not produce heat or dangerous particles.
- Prevents oxides from forming
- Ensures reliability

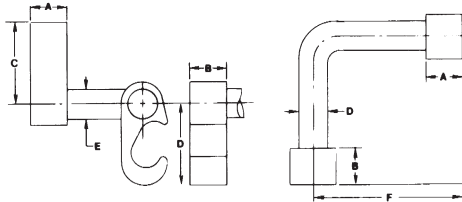

Catalog Number	Wire Range		Rod Size	Dimensions						A Die Index	B Die Index
	Main	Tap		A	B	C	D	E	F		
GGA-1	2Str.-6Sol.	2Str.-6Sol.	-	.75	.75	1.09	1.09	.313	2.50	0	0
GGA-2	250MCM-1Str	2Str.-6Sol.	1/2, 5/8	.75	.75	1.66	1.09	.313	2.50	997	0
GGA-3	250MCM-2Str	250MCM-2Str	1/2, 5/8	.75	.75	1.66	1.66	.500	2.50	997	997
GGA-4	500MCM-250MCM	2Str.-6Sol.	5/8, 3/4	.75	.75	2.09	1.09	.313	2.50	998	0
GGA-5	500MCM-250MCM	250MCM-2Str	5/8, 3/4	.75	.75	2.09	1.66	.500	2.50	998	997
GGA-6	500MCM-250MCM	500MCM-250MCM	5/8, 3/4	.75	.75	2.28	2.28	.750	2.50	999/1011	999/1011

NOTE: Hydraulic tools required on all sizes except GGA-1
 Dieless tools can not be used
 ILC-15H or similar required for GGA-4, GGA-5 and GGA-6

TYPE GGC

Features

- Manufactured from high strength copper alloy
- Clearly marked with wire size and die index
- Range taking
- Versatile
- Non-hazardous installation
- Prefilled with inhibiting compound
- Temperature Rating 90ü C

Benefits

- Provides maximum conductivity and eliminates the possibility of corrosion. Suitable for direct burial.
- Provides easy identification and tooling recommendation
- Reduces inventory. Eight sizes cover a wire range from 500MCM to #6, and 1/2" to 3/4" ground rods.
- Can be used as a tap connector or as a lap splice connector
- Can be installed in all types of weather with no need for protective equipment or clothing. Does not produce heat or dangerous particles.
- Prevents oxides from forming
- Ensures reliability

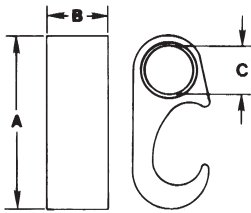

Catalog Number	Wire Range		Rod Size	Dimensions			Index
	Main	Tap		A	B	C	
GGC-1	2Str.-6Sol.	2Str.-6Sol.	-	1.4	.75	.33	0
GGC-2	250MCM-1/0Str	2Str.-4Sol.	1/2, 5/8	2.1	.75	.33	997
GGC-3	250MCM-1/0Str	2/0Str-1/0Str	1/2, 5/8	2.1	.75	.44	997
GGC-4	250MCM-1/0Str	250MCM-3/0Str	1/2, 5/8	2.1	.75	.61	997
GGC-5	500MCM-250MCM	2Str.-4Sol.	5/8, 3/4	2.6	.75	.33	998
GGC-6	500MCM-250MCM	2/0Str-1/0Str	5/8, 3/4	2.6	.75	.44	998
GGC-7	500MCM-250MCM	250MCM-3/0Str	5/8, 3/4	2.6	.75	.61	998
GGC-8	500MCM-250MCM	500MCM-350MCM	5/8, 3/4	2.9	.75	.84	999/1011

NOTE: Hydraulic tools required on all sizes except GGC-1

Dieless tools can not be used

ILC-15H or similar required for GGC-5, GGC-6, GGC-7 and GGC-8

TYPE RLT

Features

- Manufactured from high strength copper alloy
- Prefilled with oxide inhibitor
- Clearly marked with wire size and die index
- Range taking
- UL Listed and CSA Certified for 600v direct burial in earth or concrete
- May be used in ground grid applications

Benefits

- Provides maximum conductivity and eliminates the possibility of corrosion.
- Provides easy identification and tooling recommendation
- Reduces inventory
- Ensures reliability
- Flexibility in application

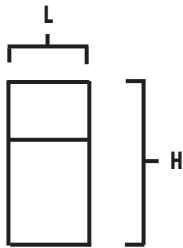

Catalog Number	Copper Wire Range	Ground Rod Size	Height	Length	Die Index
RLT-2	#2 - 2/0	1/2"	1.94	.88	998/1011
RLT-3	#2 - 2/0	5/8"	1.97	.88	998/1011
RLT-4	#2 - 2/0	3/4"	2.19	.88	998/1011
RLT-5	4/0 - 250MCM	1/2"	1.94	.88	998/1011
RLT-6	4/0 - 250MCM	5/8"	2.14	.88	998/1011
RLT-7	4/0 - 250MCM	3/4"	2.19	.88	998/1011
RLT-8	300MCM - 500MCM	5/8"	2.14	.88	998/1011
RLT-9	300MCM - 500MCM	3/4"	2.44	.88	998/1011

See stuffer sheet for complete information on tooling.

TYPE ULT AND CCT

Features

- Manufactured from high strength copper alloy
- Clearly marked with wire size and die index
- Range taking
- UL Listed and CSA Certified for 600 volts, 90°C

Benefits

- Provides maximum conductivity and eliminates the possibility of corrosion
- Provides easy identification and tooling recommendation
- Reduces inventory
- Ensures reliability

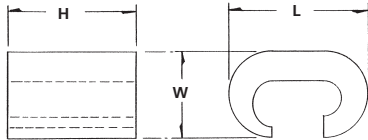

Catalog Number	Copper Wire Range		Die Index	Dimensions		
	Main	Tap		L	W	H
ULT-4	4Str.-6Sol.	6Str.-6Sol.	BG or 5/8	3/4	15/32	49/64
ULT-5	4Str.-6Sol.	4Str.-4Sol.	BG or 5/8	3/4	15/32	27/32
ULT-6	2Str.-2Sol.	6Str.-8Sol.	C	7/8	5/8	1
ULT-7	2Str.-2Sol.	2Str.-2Sol.	C	7/8	39/64	1-1/16
CCT-2020 *	2/0Str.-1/0Str	2/0Str.-1/0Str.	O	15/16	13/16	1-3/8
CCT-4020 *	4/0Str.-3/0Str	2/0Str.-1/0Str.	F or D3	1-1/16	1	1-5/8
ULT-12	4/0Str.-3/0str.	4/0Str.-3/0Str.	F or D3	1-1/8	1	1-5/8

* C/UL listed 486 A/B and 467 Suitable for direct burial.

TYPE ELT

Features

- Manufactured from copper alloy
- Clearly marked with wire size and die index
- Range taking
- UL Listed and CSA Certified for grounding and bonding, rated for 600 volts
- May be used in ground grid applications

Benefits

- Provides maximum conductivity and eliminates the possibility of corrosion. Suitable for direct burial
- Provides easy identification and tooling recommendation
- Reduces inventory
- Ensures reliability
- Flexibility in application



Catalog Number	Copper Wire Range		Width	Die Index
	Main	Tap		
ELT-1	2Str.-6Sol.	2Str.-6Sol.	.75	C (U Type)
ELT-4	2/0Str.-1Str.	2Str.-6Str.	.75	O (U Type)
ELT-2	2/0Str.-1Str.	2/0Str.-1Str.	.75	O (U Type)
ELT-5	250MCM-3/0Str	2/0Str.-6Sol.	.75	997 (U Type)
ELT-3	250MCM-3/0Str	250MCM-3/0Str	.900	997 (U Type)
ELT-6	500MCM-300MCM	250MCM-3/0Str	.875	1011 (U Type)

Tooling Information

Catalog Number	ILSCO			Burdny		
	ILC-12H-N ILC-12-N Die No. No. of Crimps	ILCB-12-N Die No. No. of Crimps	ILC-15H Die No. No. of Crimps	Y-35 Die Index No. of Crimps	Y-45 Die Index No. of Crimps	Y-46 Die Index No. of Crimps
ELT-1	ILD-C (1)	ILD-C (1)	- -	C (U Type) (1)	C (U Type) (1)	C (U Type) (1)
ELT-4	ILD-O (1)	ILD-O (1)	- -	O (U Type) (1)	O (U Type) (1)	O (U Type) (1)
ELT-2	ILD-O (1)	ILD-O (1)	- -	O (U Type) (1)	O (U Type) (1)	O (U Type) (1)
ELT-5	ILD-U997 (1)	ILD-U997 (1)	- -	997 (U Type) (1)	997 (U Type) (1)	997 (U Type) (1)
ELT-3	ILD-U997 (1)	ILD-U997 (1)	- -	997 (U Type) (1)	997 (U Type) (1)	997 (U Type) (1)
ELT-6	- -	- -	ILD-P1011 (2)	- -	1011 (U Type) (2)	1011 (U Type) (1)

See stuffer sheet for complete information on tooling.

TYPE GM, GMS AND GWL

For clamping cable or wire to flat surface

Made from high copper content alloy. Furnished with silicon bronze bolt, nut and lockwasher. Standard catalog items for 1/4" bar, for other applications, specify bar thickness.



TYPE GM

Catalog Number	Conductor Range	Wire Diameter Range	Approximate Dimensions						Bolt Dia.
			A		B		C		
			in	mm	in	mm	in	mm	
GM-1	8 Sol.-4 Str.	.128- .232	1 1/4	32	1	25	1 5/8	41	3/8
GM-2	4 Sol.-2/0 Str.	.204- .419	1 5/8	41	1 1/8	28	1 3/4	44	3/8
GM-3	2/0 Sol.-250 MCM	.365- .575	2 1/8	54	1 1/2	38	2	51	1/2
GM-4*	300-500 MCM	.634- .815	2 3/8	60	1 5/8	41	2 1/2	64	1/2
GM-5*	500-750 MCM	.815- .999	3	76	1 3/4	44	3	76	5/8
GM-6*	750-1000 MCM	.999-1.153	3 1/2	89	1 7/8	47	3 1/8	79	5/8

*UL listing is limited to a maximum wire size of 250 MCM by UL467.

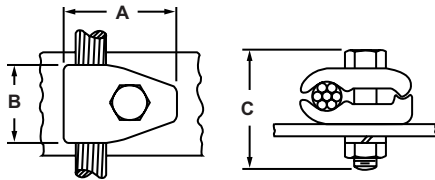

TYPE GMS

Catalog Number	Conductor Range	Wire Diameter Range	Approximate Dimensions						Bolt Dia.
			A		B		C		
			in	mm	in	mm	in	mm	
GMS-1	8 Sol.-4 Str.	.128- .232	1 1/4	32	1	25	1 5/8	41	3/8
GMS-2	4 Sol.-2/0 Str.	.204- .419	1 5/8	41	1 1/8	28	1 3/4	44	3/8
GMS-3	2/0 Sol.-250 MCM	.365- .575	2 1/8	54	1 1/2	38	2	51	1/2
GMS-4*	300-500 MCM	.634- .815	2 3/8	60	1 5/8	41	2 1/2	64	1/2
GMS-5*	500-750 MCM	.815- .999	3	76	1 3/4	44	3	76	5/8
GMS-6*	750-1000 MCM	.999-1.153	3 1/2	89	1 7/8	47	3 1/8	79	5/8

*UL listing is limited to a maximum wire size of 250 MCM by UL467.

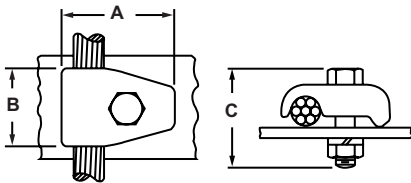

TYPE GWL

Catalog Number	Conductor Range	Wire Diameter Range	Approximate Dimensions						Bolt Dia.
			A		B		C		
			in	mm	in	mm	in	mm	
GWL-1	8 Str.-4 Str.	.146- .232	1 1/8	28	1 1/2	38	1 3/8	34	3/8
GWL-2	8 Str.-4 Str.	.146- .232	1 3/4	44	1 3/4	44	1 7/8	47	1/2
GWL-3	3 Str.-2/0 Str.	.260- .419	1 11/16	42	2	51	1 7/8	47	3/8
GWL-4	3 Str.-2/0 Str.	.260- .419	1 13/16	46	2 1/8	54	1 7/8	47	1/2
GWL-5	3/0 Str.-250 MCM	.470- .575	2 1/4	57	2 1/4	57	2 3/8	60	3/8
GWL-6	3/0 Str.-250 MCM	.470- .575	2 1/4	57	2 3/8	60	2 3/8	60	1/2
GWL-7	3/0 Str.-250 MCM	.470- .575	2 1/4	57	2 1/2	64	2 3/8	60	5/8

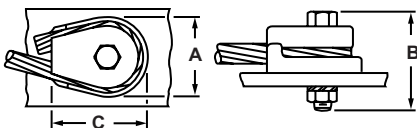

TYPE

GH, GHS, GJ AND GJS

For clamping cable or wire to flat bar

Made from high copper content alloy. Furnished with silicon bronze bolt, nut and lockwasher. Standard catalog items for 1/4" bar, for other applications, specify bar thickness.

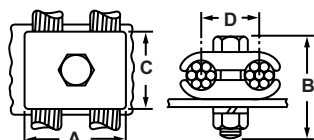

TYPE GH

Cat. No.	Conductor Range	Wire Diameter Range†	Approximate Dimensions								Bolt Dia.
			A		B		C		D		
		in	in	mm	in	mm	in	mm	in	mm	
GH-1	8 Sol.-4 Str.	.128- .232	1 1/4	32	1 1/2	38	1 3/8	34	3/4	19	3/8
GH-2	4 Sol.-2/0 Str.	.204- .419	1 1/2	38	2	51	1 5/8	41	1	25	3/8
GH-3	2/0 Sol.-250 MCM	.365- .575	2	51	2 1/4	57	1 3/4	44	1 1/4	32	1/2
GH-4	300-500 MCM	.634- .815	2 1/2	64	2 7/8	73	2	51	1 1/2	38	1/2
GH-5	500-750 MCM	.815- .999	3 1/4	82	3 3/8	85	2 3/8	60	1 3/4	44	5/8
GH-6	750-1000 MCM	.999-1.153	3 5/8	92	3 3/4	95	2 1/2	64	2	51	5/8
GH-7	1000-1250 MCM	1.153-1.290	4	102	4	102	2 3/4	70	2 1/4	57	5/8

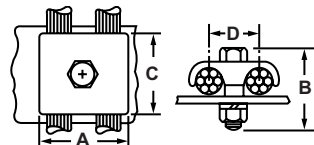

TYPE GHS

Cat. No.	Conductor Range	Wire Diameter Range	Approximate Dimensions								Bolt Dia.
			A		B		C		D		
		in	in	mm	in	mm	in	mm	in	mm	
GHS-1	8 Sol.-4 Str.	.128- .232	1 1/4	32	1 3/8	34	1 3/8	34	3/4	19	3/8
GHS-2	4 Sol.-2/0 Str.	.204- .419	1 1/2	38	1 1/2	38	1 5/8	41	1	25	3/8
GHS-3	2/0 Sol.-250 MCM	.365- .575	2	51	1 7/8	47	1 3/4	44	1 1/4	32	1/2
GHS-4	300-500 MCM	.634- .815	2 1/2	64	2 3/8	60	2	51	1 1/2	38	1/2
GHS-5	500-750 MCM	.815- .999	3 1/4	82	2 3/4	70	2 3/8	60	1 3/4	44	5/8
GHS-6	750-1000 MCM	.999-1.153	3 5/8	92	2 7/8	73	2 1/2	64	2	51	5/8
GHS-7	1000-1250 MCM	1.153-1.290	4	102	3	76	2 3/4	70	2 1/4	57	5/8

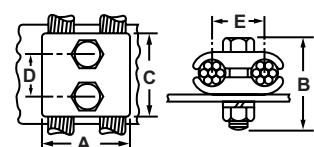

TYPE GJ

Cat. No.	Conductor Range	Wire Diameter Range	Approximate Dimensions									Bolt Dia.	
			A		B		C		D		E		
		in	in	mm	in	mm	in	mm	in	mm	in	mm	
GJ-1	8 Sol.-4 Str.	.128- .232	1 1/4	32	1 1/2	38	2	51	1 5/16	24	3/4	19	3/8
GJ-2	4 Sol.-2/0 Str.	.204- .419	1 1/2	38	2	51	2	51	1	25	1	25	3/8
GJ-3	2/0 Sol.-250 MCM	.365- .575	2	51	2 1/4	57	2 1/2	64	1 5/16	33	1 5/16	33	1/2
GJ-4	300-500 MCM	.634- .815	2 1/2	64	2 7/8	73	2 1/2	64	1 3/8	34	1 1/2	38	1/2
GJ-5	500-750 MCM	.815- .999	3 1/4	82	3 3/8	85	3	76	1 9/16	39	1 3/4	44	5/8
GJ-6	750-1000 MCM	.999-1.153	3 5/8	92	3 3/4	95	3	76	1 9/16	39	2	51	5/8
GJ-7	1000-1250 MCM	1.153-1.290	4	102	4	102	3 1/2	89	1 3/4	44	2 1/4	57	5/8

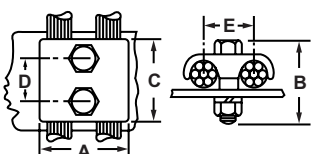

TYPE GJS

Cat. No.	Conductor Range	Wire Diameter Range	Approximate Dimensions									Bolt Dia.	
			A		B		C		D		E		
		in	in	mm	in	mm	in	mm	in	mm	in	mm	
GJS-1	8 Sol.-4 Str.	.128- .232	1 1/4	32	1 3/8	34	2	51	1 5/16	24	3/4	19	3/8
GJS-2	4 Sol.-2/0 Str.	.204- .419	1 1/2	38	1 1/2	38	2	51	1	25	1	25	3/8
GJS-3	2/0 Sol.-250 MCM	.365- .575	2	51	1 7/8	47	2 1/2	64	1 5/16	33	1 5/16	33	1/2
GJS-4	300-500 MCM	.634- .815	2 1/2	64	2 3/8	60	2 1/2	64	1 3/8	34	1 1/2	38	1/2
GJS-5	500-750 MCM	.815- .999	3 1/4	82	2 3/4	70	3	76	1 9/16	39	1 3/4	44	5/8
GJS-6	750-1000 MCM	.999-1.153	3 5/8	92	2 7/8	73	3	76	1 9/16	39	2	51	5/8
GJS-7	1000-1250 MCM	1.153-1.290	4	102	3	76	3 1/2	89	1 3/4	44	2 1/4	57	5/8

TYPE
GO

Made from high copper content alloy. Furnished with silicon bronze bolt, nuts and lockwashers.

For clamping braid, cable or strip copper to pipe

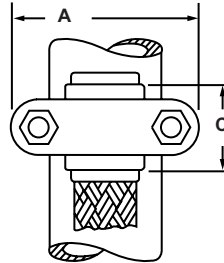
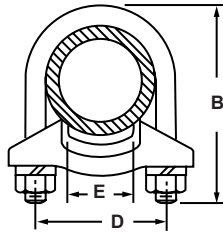

Catalog Number	IPS	Approximate Dimensions										Bolt Dia.†
		A		B		C		D		E		
		in	mm	in	mm	in	mm	in	mm	in	mm	
GO-0	3/4	2 1/2	64	2 1/2	64	1 1/8	28	1 1/2	38	1	25	3/8
GO-1	1	2 3/4	70	3 1/4	82	1 1/4	32	1 3/4	44	1	25	3/8
GO-2	1 1/4	3	76	3 1/2	89	1 3/8	34	2 1/16	53	1	25	3/8
GO-3	1 1/2	3 3/8	85	3 1/2	89	1 1/2	38	2 3/8	60	1	25	3/8
GO-4	1 1/2	3 3/8	85	3 1/2	89	1 1/2	38	2 3/8	60	1 1/2	38	3/8
GO-4A	1 1/2	3 3/8	85	3 1/2	89	1 1/2	38	2 3/8	60	2	51	1/2
GO-5	2	3 3/4	95	4 1/4	108	1 1/2	38	2 13/16	71	1	25	3/8
GO-6	2	3 3/4	95	4 1/4	108	1 1/2	38	2 13/16	71	1 1/2	38	3/8
GO-7	2	4	102	4 3/8	111	1 3/4	44	2 15/16	75	2	51	1/2
GO-7A	2 1/2	4 1/2	115	5	127	1 3/4	44	3 7/16	87	1 1/2	38	1/2
GO-8	2 1/2	4 1/2	115	5	127	1 7/8	47	3 7/16	87	2	51	1/2
GO-9	2 1/2	4 1/2	115	5	127	2	51	3 7/16	87	2 1/2	84	1/2
GO-10	3	5 1/4	133	6 1/4	158	2	51	4 1/16	104	2	51	1/2
GO-11	3	5 1/4	133	6 1/4	158	2	51	4 1/16	104	2 1/2	64	1/2
GO-12	3	5 1/4	133	6 1/4	158	2	51	4 1/16	104	3	76	1/2
GO-13	3 1/2	5 3/4	146	5 7/8	149	2 1/4	57	4 9/16	116	2	51	1/2
GO-14	3 1/2	5 3/4	146	5 7/8	149	2 1/4	57	4 9/16	116	2 1/2	64	1/2
GO-15	3 1/2	5 3/4	146	5 7/8	149	2 1/4	57	4 9/16	116	3	76	1/2
GO-16	4	6 1/4	158	6 1/2	165	2 1/4	57	5 1/16	129	2	51	1/2
GO-17	4	6 1/4	158	6 1/2	165	2 3/8	60	5 1/16	129	2 1/2	64	1/2
GO-18	4	6 1/4	158	6 1/2	165	2 1/2	64	5 1/16	129	3	76	1/2
GO-19	4	6 1/4	158	6 1/2	165	2 3/4	70	5 1/16	129	3 1/2	89	1/2

†3/8" U-Bolt threaded as shown above, add suffix "FT" for full thread. 1/2" U-Bolt standard is full thread.

TYPE GPL

Made from high copper content alloy. Furnished with silicon bronze bolt, nuts and lockwashers.

Universal parallel or 90° cable connection to rod or pipe

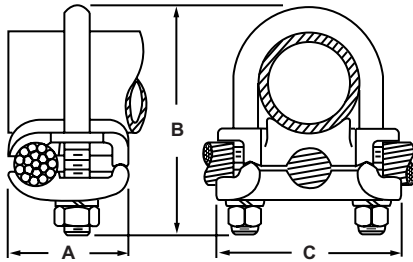

Catalog Number	Accommodates		Conductor Range	Wire Diameter Range	Approximate Dimensions						
	Rod	IPS			A		B		C		Bolt Dia.†
					in	mm	in	mm	in	mm	
GPL-1 *	1/2	1/4	8 Sol.-4 Str.	.128- .232	1 3/8	34	2 1/2	64	1 7/8	47	3/8
GPL-2 *	1/2	1/4	4 Sol.-2/0 Str.	.204- .419	1 5/8	41	2 1/2	64	1 7/8	47	3/8
GPL-3 *	1/2	1/4	2/0 Sol.-250 MCM	.365- .575	1 7/8	47	2 1/2	64	1 7/8	47	3/8
GPL-4	5/8 or 3/4	3/8	8 Sol.-4 Str.	.128- .232	1 3/8	34	2 3/4	70	2	51	3/8
GPL-5	5/8 or 3/4	3/8	4 Sol.-2/0 Str.	.204- .419	1 5/8	41	2 3/4	70	2	51	3/8
GPL-6	5/8 or 3/4	3/8	2/0 Sol.-250 MCM	.365- .575	1 7/8	47	2 3/4	70	2	51	3/8
GPL-7 •	5/8 or 1	3/8 or 3/4	300-500 MCM	.634- .815	2 1/4	57	3 1/2	89	2 3/8	60	1/2
GPL-8	7/8 or 1	1/2 or 3/4	8 Sol.-4 Str.	.128- .232	1 3/8	34	2 5/8	67	2 3/8	60	3/8
GPL-9	7/8 or 1	1/2 or 3/4	4 Sol.-2/0 Str.	.204- .419	1 5/8	41	2 5/8	67	2 3/8	60	3/8
GPL-10	7/8 or 1	1/2 or 3/4	2/0 Sol.-250 MCM	.365- .575	1 7/8	47	3	76	2 3/8	60	3/8
GPL-12 •	7/8 or 1	1/2 or 3/4	500-750 MCM	.815- .999	2 5/8	67	3 3/4	95	2 3/4	70	1/2
GPL-13 •	7/8 or 1	1/2 or 3/4	750-1000 MCM	.999-1.153	3	76	4	102	3 1/2	89	1/2
GPL-14	—	1	8 Sol.-4 Str.	.128- .232	1 3/8	34	2 3/4	70	2 5/8	67	3/8
GPL-15	—	1	4 Sol.-2/0 Str.	.204- .419	1 5/8	41	2 3/4	70	2 5/8	67	3/8
GPL-16	—	1	2/0 Sol.-250 MCM	.365- .575	1 7/8	47	3 1/4	82	2 5/8	67	3/8
GPL-17 •	—	1	300-500 MCM	.634- .815	2 3/8	60	4 1/2	115	3	76	1/2
GPL-18 •	—	1	500-750 MCM	.815- .999	2 5/8	67	4 1/2	115	3	76	1/2
GPL-19 •	—	1	750-1000 MCM	.999-1.153	3	76	4 3/4	121	3 1/2	89	1/2
GPL-20	—	1 1/4	8 Sol.-4 Str.	.128- .232	1 3/8	34	3 1/2	89	3	76	3/8
GPL-21	—	1 1/4	4 Sol.-2/0 Str.	.204- .419	1 5/8	41	3 1/2	89	3	76	3/8
GPL-22	—	1 1/4	2/0 Sol.-250 MCM	.365- .575	1 7/8	47	3 1/2	89	3	76	3/8
GPL-23 •	—	1 1/4	300-500 MCM	.634- .815	2 3/8	60	4 1/4	108	3 3/8	85	1/2
GPL-24 •	—	1 1/4	500-750 MCM	.815- .999	2 3/4	70	5	127	3 3/4	95	1/2
GPL-25 •	—	1 1/4	750-1000 MCM	.999-1.153	3	76	5 1/2	140	4 1/4	108	1/2
GPL-26	—	1 1/2	8 Sol.-4 Str.	.128- .232	1 3/8	34	4	102	3 1/4	82	3/8
GPL-27	—	1 1/2	4 Sol.-2/0 Str.	.204- .419	1 5/8	41	4	102	3 1/4	82	3/8
GPL-28	—	1 1/2	2/0 Sol.-250 MCM	.365- .575	1 7/8	47	4	102	3 1/4	82	3/8
GPL-29 •	—	1 1/2	300-500 MCM	.634- .815	2 3/8	60	4 5/8	118	3 5/8	92	1/2
GPL-30 •	—	1 1/2	500-750 MCM	.815- .999	2 3/4	70	5 1/4	133	4	102	1/2
GPL-31 •	—	1 1/2	750-1000 MCM	.999-1.153	3	76	5 3/4	146	4 1/2	115	1/2
GPL-32	—	2	8 Sol.-4 Str.	.128- .232	1 3/8	34	4 1/4	108	3 3/4	95	3/8
GPL-33	—	2	4 Sol.-2/0 Str.	.204- .419	1 5/8	41	4 1/4	108	3 3/4	95	3/8
GPL-34	—	2	2/0 Sol.-250 MCM	.365- .575	1 7/8	47	4 1/4	108	3 3/4	95	3/8
GPL-35 •	—	2	300-500 MCM	.634- .815	2 3/8	60	5 1/4	133	4	102	1/2
GPL-36 •	—	2	500-750 MCM	.815- .999	2 3/4	70	5 1/2	140	4 1/2	115	1/2
GPL-37 •	—	2	750-1000 MCM	.999-1.153	3	76	6	152	5	127	1/2

Chart continued next page

*UL listing is limited to a maximum wire size of 250 MCM.

*Not UL listed for 1/4" Pipe.

†3/8" U-Bolt threaded as shown above, add suffix "FT" for full thread. 1/2" U-Bolt standard is full thread.

TYPE GPL

Made from high copper content alloy. Furnished with silicon bronze bolt, nuts and lockwashers.

Universal parallel or 90° cable connection to rod or pipe

Continued from preceding page

Catalog Number	Accommodates		Conductor Range	Wire Diameter Range	Approximate Dimensions						
	Rod	IPS			A		B		C		Bolt Dia.†
					in	mm	in	mm	in	mm	
GPL-38	—	2 ¹ / ₂	8 Sol.-4 Str.	.128- .232	1 ³ / ₈	34	5	127	4 ¹ / ₄	108	3 ⁸ / ₈
GPL-39	—	2 ¹ / ₂	4 Sol.-2/0 Str.	.204- .419	1 ⁵ / ₈	41	5	127	4 ¹ / ₄	108	3 ⁸ / ₈
GPL-40	—	2 ¹ / ₂	2/0 Sol.-250 MCM	.365- .575	1 ⁷ / ₈	47	5	127	4 ¹ / ₄	108	3 ⁸ / ₈
GPL-41•	—	2 ¹ / ₂	300-500 MCM	.634- .815	2 ³ / ₈	60	5 ⁵ / ₈	143	4 ¹ / ₂	115	1 ² / ₂
GPL-42•	—	2 ¹ / ₂	500-750 MCM	.815- .999	2 ³ / ₄	70	6	152	5	127	1 ² / ₂
GPL-43•	—	2 ¹ / ₂	750-1000 MCM	.999-1.153	3	76	6 ¹ / ₂	165	5 ¹ / ₂	140	1 ² / ₂
GPL-44	—	3	8 Sol.-4 Str.	.128- .232	1 ³ / ₈	34	5 ¹ / ₂	140	4 ³ / ₄	121	3 ⁸ / ₈
GPL-45	—	3	4 Sol.-2/0 Str.	.204- .419	1 ⁵ / ₈	41	5 ¹ / ₂	140	4 ³ / ₄	121	3 ⁸ / ₈
GPL-46	—	3	2/0 Sol.-250 MCM	.365- .575	1 ⁷ / ₈	47	5 ¹ / ₂	140	4 ³ / ₄	121	3 ⁸ / ₈
GPL-47•	—	3	300-500 MCM	.634- .815	2 ³ / ₈	60	6 ¹ / ₄	158	5 ¹ / ₄	133	1 ² / ₂
GPL-48•	—	3	500-750 MCM	.815- .999	2 ³ / ₄	70	6 ³ / ₄	171	5 ¹ / ₂	140	1 ² / ₂
GPL-49•	—	3	750-1000 MCM	.999-1.153	3	76	7 ¹ / ₄	184	6	152	1 ² / ₂
GPL-50	—	3 ¹ / ₂	8 Sol.-4 Str.	.128- .232	1 ³ / ₈	34	6 ¹ / ₄	158	5 ¹ / ₄	133	3 ⁸ / ₈
GPL-51	—	3 ¹ / ₂	4 Sol.-2/0 Str.	.204- .419	1 ⁵ / ₈	41	6 ¹ / ₄	158	5 ¹ / ₄	133	3 ⁸ / ₈
GPL-52	—	3 ¹ / ₂	2/0 Sol.-250 MCM	.365- .575	1 ⁷ / ₈	47	6 ¹ / ₄	158	5 ¹ / ₄	133	3 ⁸ / ₈
GPL-53•	—	3 ¹ / ₂	300-500 MCM	.634- .815	2 ³ / ₈	60	6 ³ / ₄	171	5 ³ / ₄	146	1 ² / ₂
GPL-54•	—	3 ¹ / ₂	500-750 MCM	.815- .999	2 ³ / ₄	70	7 ¹ / ₂	191	6	152	1 ² / ₂
GPL-55•	—	3 ¹ / ₂	750-1000 MCM	.999-1.153	3	76	8	203	6 ¹ / ₂	165	1 ² / ₂
GPL-56	—	4	8 Sol.-4 Str.	.128- .232	1 ³ / ₈	34	6 ³ / ₈	161	5 ³ / ₄	146	3 ⁸ / ₈
GPL-57	—	4	4 Sol.-2/0 Str.	.204- .419	1 ⁵ / ₈	41	6 ³ / ₈	161	5 ³ / ₄	146	3 ⁸ / ₈
GPL-58	—	4	2/0 Sol.-250 MCM	.365- .575	1 ⁷ / ₈	47	6 ³ / ₈	161	5 ³ / ₄	146	3 ⁸ / ₈
GPL-59•	—	4	300-500 MCM	.634- .815	2 ³ / ₈	60	6 ³ / ₄	171	6 ¹ / ₄	158	1 ² / ₂
GPL-60•	—	4	500-750 MCM	.815- .999	2 ³ / ₄	70	8	203	6 ¹ / ₂	165	1 ² / ₂
GPL-61•	—	4	750-1000 MCM	.999-1.153	3	76	8 ¹ / ₂	216	7	178	1 ² / ₂
GPL-68	—	5	8 Sol.-4 Str.	.128- .232	1 ³ / ₈	34	6 ³ / ₈	161	6 ³ / ₄	171	3 ⁸ / ₈
GPL-69	—	5	4 Sol.-2/0 Str.	.204- .419	1 ⁷ / ₃₂	38	5 ⁵ / ₈	143	6 ¹³ / ₁₆	173	3 ⁸ / ₈
GPL-70	—	5	2/0 Sol.-250 MCM	.365- .575	1 ⁷ / ₈	47	6 ¹ / ₈	155	6 ¹³ / ₁₆	173	3 ⁸ / ₈
GPL-71•	—	5	300-500 MCM	.634- .815	2 ⁵ / ₁₆	59	6 ¹ / ₈	155	7 ¹ / ₈	181	1 ² / ₂
GPL-75	—	6	4 Sol.-2/0 Str.	.204- .419	1 ⁷ / ₃₂	38	5 ⁷ / ₈	149	7 ⁷ / ₈	200	3 ⁸ / ₈
GPL-76	—	6	2/0 Sol.-250 MCM	.365- .575	1 ⁷ / ₈	47	7 ¹ / ₈	181	7 ¹³ / ₁₆	199	3 ⁸ / ₈
GPL-77•	—	6	300-500 MCM	.634- .815	2 ⁵ / ₁₆	59	6 ³ / ₁₆	157	8 ³ / ₁₆	208	1 ² / ₂
GPL-87	—	8	4 Sol. 2/0 Str.	.204- .419	1 ⁷ / ₃₂	38	7 ¹ / ₈	181	9 ⁷ / ₈	251	3 ⁸ / ₈

•UL listing is limited to a maximum wire size of 250 MCM by UL467.

†³/₈" U-Bolt threaded as shown above, add suffix "FT" for full thread. ¹/₂" U-Bolt standard is full thread.

TYPE GR

Made from high copper content alloy. Furnished with silicon bronze bolt, nuts and lockwashers.

For clamping three equal size cables to pipe or rod

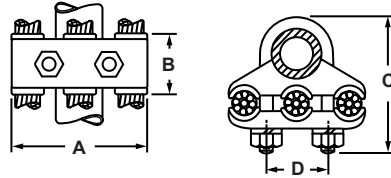

Catalog Number	Accommodates		Conductor Range	Wire Diameter Range	Approximate Dimensions								Bolt Dia.†
	Rod	IPS			A		B		C		D		
					in	mm	in	mm	in	mm	in	mm	
GR-1	1/2	1/4	8 Sol.-4 Str.	.128- .232	2 1/2	64	1 1/2	38	2 1/4	57	1	25	3/8
GR-2	1/2	1/4	4 Sol.-2/0 Str.	.204- .419	3	76	1 1/2	38	2 1/4	64	1	25	3/8
GR-3	1/2	1/4	2/0 Sol.-250 MCM	.365- .575	3 5/8	92	1 1/2	38	2 3/4	70	1	25	3/8
GR-4	5/8 or 3/4	3/8	8 Sol.-4 Str.	.128- .232	2 3/4	70	1 1/2	38	2 1/2	64	1 1/8	28	3/8
GR-5	5/8 or 3/4	3/8	4 Sol.-2/0 Str.	.204- .419	3	76	1 1/2	38	2 3/4	70	1 1/8	28	3/8
GR-6	5/8 or 3/4	3/8	2/0 Sol.-250 MCM	.365- .575	3 1/2	89	1 5/8	41	3	76	1 1/8	28	3/8
GR-7	5/8 or 3/4	3/8	300-500 MCM	.634- .815	4	102	1 5/8	41	3 1/4	82	1 1/8	28	1/2
GR-8	7/8 or 1	1/2 or 3/4	8 Sol.-4 Str.	.128- .232	2 7/8	73	1 1/2	38	3	76	1 1/2	38	3/8
GR-9	7/8 or 1	1/2 or 3/4	4 Sol.-2/0 Str.	.204- .419	3 1/2	89	1 1/2	38	3 1/4	82	1 1/2	38	3/8
GR-10	7/8 or 1	1/2 or 3/4	2/0 Sol.-250 MCM	.365- .575	3 7/8	98	1 5/8	41	3 3/8	85	1 1/2	38	1/2
GR-11	7/8 or 1	1/2 or 3/4	300-500 MCM	.634- .815	4 3/8	111	1 5/8	41	3 1/2	89	1 1/2	38	1/2
GR-12	7/8 or 1	1/2 or 3/4	500-750 MCM	.815- .999	5	127	1 3/4	44	4	102	1 5/8	41	1/2
GR-13	—	1	8 Sol.-4 Str.	.128- .232	3 1/4	82	1 1/2	38	3	76	1 3/4	44	3/8
GR-14	—	1	4 Sol.-2/0 Str.	.204- .419	3 5/8	92	1 1/2	38	3 1/4	82	1 3/4	44	3/8
GR-15	—	1	2/0 Sol.-250 MCM	.365- .575	4 1/8	105	1 5/8	41	3 1/2	89	1 3/4	44	3/8
GR-16	—	1	300-500 MCM	.634- .815	4 1/2	115	1 5/8	41	3 3/4	95	1 3/4	44	1/2
GR-17	—	1	500-750 MCM	.815- .999	5 1/8	130	1 3/4	44	4 1/4	108	1 7/8	47	1/2
GR-18	—	1	750-1000 MCM	.999-1.153	5 1/2	140	1 3/4	44	4 1/2	115	1 7/8	47	1/2
GR-19	—	1 1/4	8 Sol.-4 Str.	.128- .232	3 1/2	89	1 1/2	38	3 1/2	89	2 1/16	53	3/8
GR-20	—	1 1/4	4 Sol.-2/0 Str.	.204- .419	4	102	1 1/2	38	3 3/4	95	2 1/16	53	3/8
GR-21	—	1 1/4	2/0 Sol.-250 MCM	.365- .575	4 1/2	115	1 5/8	41	3 7/8	98	2 1/16	53	3/8
GR-22	—	1 1/4	300-500 MCM	.634- .815	5 1/8	130	1 3/4	44	4 3/8	111	2 3/16	56	1/2
GR-23	—	1 1/4	500-750 MCM	.815- .999	5 3/4	146	2	51	5 1/8	130	2 5/16	59	5/8
GR-24	—	1 1/4	750-1000 MCM	.999-1.153	6 1/4	158	2	51	5 3/8	136	2 5/16	59	5/8
GR-25	—	1 1/2	8 Sol.-4 Str.	.128- .232	3 3/4	95	1 1/2	38	3 3/4	95	2 3/8	60	3/8
GR-26	—	1 1/2	4 Sol.-2/0 Str.	.204- .419	4 1/4	108	1 1/2	38	4	102	2 3/8	60	3/8
GR-27	—	1 1/2	2/0 Sol.-250 MCM	.365- .575	4 3/4	121	1 3/4	44	4 1/4	108	2 3/8	60	3/8
GR-28	—	1 1/2	300-500 MCM	.634- .815	5 1/2	140	2	51	4 3/4	121	2 1/2	64	1/2
GR-29	—	1 1/2	500-750 MCM	.815- .999	6 1/4	158	2 1/4	57	5 1/4	133	2 5/8	67	5/8
GR-30	—	1 1/2	750-1000 MCM	.999-1.153	6 1/2	165	2 1/4	57	5 1/2	140	2 5/8	67	5/8
GR-31	—	2	8 Sol.-4 Str.	.128- .232	4 3/8	111	1 1/2	38	4 1/4	108	2 13/16	71	3/8
GR-32	—	2	4 Sol.-2/0 Str.	.204- .419	4 7/8	124	1 1/2	38	4 1/2	115	2 13/16	71	3/8
GR-33	—	2	2/0 Sol.-250 MCM	.365- .575	5 1/4	133	1 3/4	44	5	127	2 13/16	71	1/2
GR-34	—	2	300-500 MCM	.634- .815	5 3/4	140	2	51	5	127	2 15/16	75	1/2
GR-35	—	2	500-750 MCM	.815- .999	6 5/8	168	2 1/4	57	5 3/4	146	3 1/16	78	1/2
GR-36	—	2	750-1000 MCM	.999-1.153	7	178	2 1/4	57	6	152	3 1/16	78	5/8
GR-37	—	2 1/2	8 Sol.-4 Str.	.128- .232	4 7/8	124	1 1/2	38	4 5/8	118	3 5/16	84	3/8
GR-38	—	2 1/2	4 Sol.-2/0 Str.	.204- .419	5 3/8	136	1 1/2	38	5	127	3 5/16	84	3/8
GR-39	—	2 1/2	2/0 Sol.-250 MCM	.365- .575	5 7/8	149	1 3/4	44	5 1/4	133	3 5/16	84	1/2
GR-40	—	2 1/2	300-500 MCM	.634- .815	6 1/2	165	2	51	5 3/4	146	3 7/16	87	1/2
GR-41	—	2 1/2	500-750 MCM	.815- .999	7 1/4	184	2 1/4	57	6 1/4	158	3 9/16	90	5/8
GR-42	—	2 1/2	750-1000 MCM	.999-1.153	7 1/2	191	2 1/4	57	6 1/2	185	3 9/16	90	5/8
GR-43	—	3	8 Sol.-4 Str.	.128- .232	5 1/2	140	1 1/2	38	5 1/4	133	3 15/16	100	3/8
GR-44	—	3	4 Sol.-2/0 Str.	.204- .419	6	152	1 1/2	38	5 5/8	143	3 15/16	100	3/8
GR-45	—	3	2/0 Sol.-250 MCM	.365- .575	6 3/8	161	1 3/4	44	5 3/4	146	3 15/16	100	1/2
GR-46	—	3	300-500 MCM	.634- .815	6 7/8	174	2	51	6 1/4	158	4 1/16	104	1/2
GR-47	—	3	500-750 MCM	.815- .999	7 1/2	191	2 1/4	57	6 5/8	168	4 3/16	107	5/8
GR-48	—	3	750-1000 MCM	.999-1.153	8 1/8	206	2 1/4	57	6 7/8	174	4 3/16	107	5/8
GR-49	—	3 1/2	8 Sol.-4 Str.	.128- .232	6	152	1 1/2	38	5 5/8	143	4 7/16	113	3/8
GR-50	—	3 1/2	4 Sol.-2/0 Str.	.204- .419	6 3/8	161	1 1/2	38	5 7/8	149	4 7/16	113	1/2
GR-51	—	3 1/2	2/0 Sol.-250 MCM	.365- .575	6 3/4	171	1 3/4	44	6 3/8	161	4 7/16	113	1/2
GR-60	—	4	8 Sol.-4 Str.	.128- .232	6 3/8	161	1 1/2	38	6 3/8	161	4 15/16	120	3/8
GR-61	—	4	4 Sol.-2/0 Str.	.204- .419	6 11/16	169	1 1/2	38	6 3/8	161	4 15/16	126	1/2
GR-62	—	4	2/0 Sol.-250 MCM	.365- .575	7 1/4	184	1 3/4	44	6 3/4	171	4 15/16	126	1/2

† 3/8" U-Bolt threaded as shown above, add suffix "FT" for full thread. 1/2" U-Bolt standard is full thread.

TYPE

GSE AND HGSE

Eye bolt style - Transformer Ground Clamp

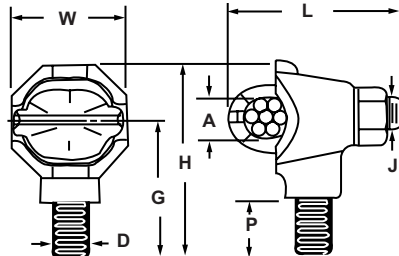

Bodies are cast from high conductivity, high strength copper alloy with cast high strength bronze eyebolts. Steel nuts and lockwashers are standard on all clamps. For silicon bronze hardware, suffix catalog number with "-SBH." Example: GSE-C1-SBH. The HGSE provides a hex or square shoulder for wrench tightening. Its flat surface also acts as a seal to the tank. The GSE may be tightened by using a wrench on the body.

Catalog Number	A Copper Conductor Range	Wire Diameter Range	Approximate Dimensions											
			D Stud Size	G		H		J (Eyebolt) in	L		P		W	
				in	in	mm	in		mm	in	mm	in	mm	in
GSE-C1	10 Sol.-1 Str.	.102-.332	1/2-13	13/16	21	1 1/4	32	3/8-16	1 1/2	38	7/16	11	7/8	22
GSE-020	8 Sol.-2/0 Str.	.128-.419	1/2-13	1	25	1 7/16	37	3/8-16	1 31/32	50	7/16	11	7/8	22
GSE-025	6 Sol.-250 MCM	.162-.575	1/2-13	1 11/16	43	1 15/16	49	1/2-13	2 9/16	65	5/16	8	1 1/4	32
HGSE-C1*	10 Sol.-1 Str.	.102-.332	1/2-13	1 3/16	30	1 3/4	44	3/8-16	1 31/32	50	7/16	11	1 1/8	28
HGSE-020*	8 Sol.-2/0 Str.	.128-.419	1/2-13	1 5/16	33	1 15/16	49	3/8-16	2	51	7/16	11	1 1/4	32
HGSE-250*	6 Sol.-250 MCM	.162-.575	1/2-13	1 3/16	30	2 1/8	54	1/2-13	2 5/8	67	15/32	12	1 7/8	48

*Designates two-way basket.

For tin plating, suffix catalog number with "-TN." Example: GSE-C1-TN.

TYPE

FF

Silicon Bronze Vise Grips - Copper to Copper wire

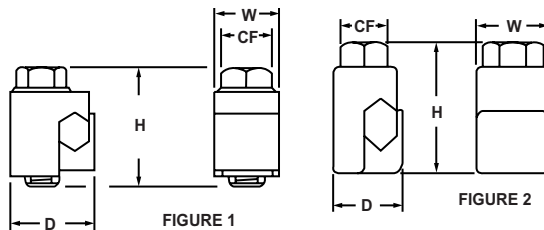
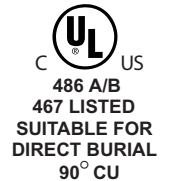

A stronger and more rigid connector of the vise type, with more grip on the conductors and full compression with any conductor combination. Easy to install. Non-swiveling—the slide cannot rotate out of the body. Castings made from bronze.

Catalog Number	Conductor Range		Wire Diameter Range	Fig. No.	Approximate Dimensions							
	Maximum 2 Conductors	Minimum 2 Conductors			Stud Diameter No. Threads	Hex CF	D		H		W	
							in	in	mm	in	mm	in
FF-6*	6 Sol.	8 Sol.	.128-.162	1	1/4-28	3/8	3/4	19.0	1	25.4	5/8	15.8
FF-4	4 Str.	6 Sol.	.162-.232	1	5/16-24	9/16	13/16	20.6	1 5/32	29.4	5/8	15.8
FF-2	2 Str.	4 Sol.	.204-.292	2	5/16-24	9/16	13/16	20.6	1 3/8	34.9	13/16	20.6
FF-2/0	2/0 Str.	2 Sol.	.258-.419	2	3/8-24	9/16	1 1/8	28.5	1 7/8	47.6	31/32	24.6
FF-4/0	4/0 Str.	1/0 Sol.	.325-.528	2	3/8-24	9/16	1 3/16	30.1	2 1/8	53.9	15/16	23.8

*Supplied with slotted hex head bolts only.

TYPE GT

Made from high copper content alloy. Furnished with silicon bronze bolt, nuts and lockwashers.

For clamping parallel cables or wires to pipe or rod

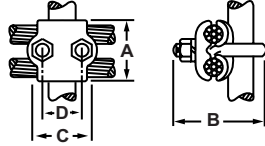

Catalog Number	Accommodates		Conductor Range	Wire Diameter Range in	Approximate Dimensions								Bolt Dia.†
	Rod	IPS			A		B		C		D		
					in	mm	in	mm	in	mm	in	mm	
GT-1	1/2	1/4	8 Sol.-4 Str.	.128- .232	1 5/8	41	2	51	1 5/8	41	1	25	3/8
GT-2	1/2	1/4	4 Sol.-2/0 Str.	.204- .419	2	51	2 1/8	54	1 3/4	44	1	25	3/8
GT-3	1/2	1/4	2/0 Sol.-250 MCM	.365- .575	2 1/2	64	2 1/4	57	1 7/8	47	1	25	3/8
GT-4	5/8 or 3/4	3/8	8 Sol.-4 Str.	.128- .232	1 5/8	41	2 1/8	54	1 5/8	41	1 1/8	28	3/8
GT-5	5/8 or 3/4	3/8	4 Sol.-2/0 Str.	.204- .419	2	51	2 1/2	64	1 3/4	44	1 1/8	28	3/8
GT-6	5/8 or 3/4	3/8	2/0 Sol.-250 MCM	.365- .575	2 1/2	64	2 3/8	67	1 7/8	47	1 1/8	28	3/8
GT-7	5/8 or 3/4	3/8	300-500 MCM	.634- .815	2 3/4	70	2 3/4	70	2	51	1 1/8	28	3/8
GT-8	7/8 or 1	1/2 or 3/4	8 Sol.-4 Str.	.128- .232	1 5/8	41	2 1/2	64	1 5/8	41	1 1/2	38	3/8
GT-9	7/8 or 1	1/2 or 3/4	4 Sol.-2/0 Str.	.204- .419	2	51	2 3/4	70	1 3/4	44	1 1/2	38	3/8
GT-10	7/8 or 1	1/2 or 3/4	2/0 Sol.-250 MCM	.365- .575	2 1/2	64	2 7/8	73	1 7/8	47	1 1/2	38	3/8
GT-11	7/8 or 1	1/2 or 3/4	300-500 MCM	.634- .815	2 3/4	70	3	76	2	51	1 1/2	38	3/8
GT-12	7/8 or 1	1/2 or 3/4	500-750 MCM	.815- .999	3 1/8	79	3 3/4	95	2 1/4	57	1 5/8	41	1/2
GT-13	-	1	8 Sol.-4 Str.	.128- .232	1 5/8	41	2 3/4	70	1 5/8	41	1 3/4	44	3/8
GT-14	-	1	4 Sol.-2/0 Str.	.204- .419	2	51	3	76	1 3/4	44	1 3/4	44	3/8
GT-15	-	1	2/0 Sol.-250 MCM	.365- .575	2 1/2	64	3 7/8	98	3 3/8	79	1 3/4	44	3/8
GT-16	-	1	300-500 MCM	.634- .815	2 3/4	70	3 3/4	95	2	51	1 3/4	44	3/8
GT-17	-	1	500-750 MCM	.815- .999	3 1/8	79	4 1/8	105	2 1/4	57	1 7/8	47	1/2
GT-18	-	1 1/4	8 Sol.-4 Str.	.128- .232	1 5/8	41	3	76	1 7/8	47	2 1/16	53	3/8
GT-19	-	1 1/4	4 Sol.-2/0 Str.	.204- .419	2	51	3 1/4	82	2	51	2 1/16	53	3/8
GT-20	-	1 1/4	2/0 Sol.-250 MCM	.365- .575	2 1/2	64	3 1/2	89	2 1/8	54	2 1/16	53	3/8
GT-21	-	1 1/4	300-500 MCM	.634- .815	2 3/4	70	4 1/8	105	2 1/4	57	2 3/16	56	1/2
GT-22	-	1 1/4	500-750 MCM	.815- .999	3 3/4	95	4 3/8	111	2 1/2	64	2 5/16	59	5/8
GT-23	-	1 1/4	750-1000 MCM	.999-1.153	4	102	4 5/8	118	2 3/4	70	2 5/16	59	5/8
GT-24	-	1 1/2	8 Sol.-4 Str.	.128- .232	1 5/8	41	3 1/4	82	2 1/4	57	2 3/8	60	3/8
GT-25	-	1 1/2	4 Sol.-2/0 Str.	.204- .419	2	51	3 1/2	89	2 3/8	60	2 3/8	60	3/8
GT-26	-	1 1/2	2/0 Sol.-250 MCM	.365- .575	2 1/2	64	3 7/8	98	2 1/2	64	2 3/8	60	3/8
GT-27	-	1 1/2	300-500 MCM	.634- .815	2 3/4	70	4 3/8	111	2 5/8	67	2 1/2	64	1/2
GT-28	-	1 1/2	500-750 MCM	.815- .999	3 3/4	95	4 3/4	121	2 3/4	70	2 5/8	67	5/8
GT-29	-	1 1/2	750-1000 MCM	.999-1.153	4	102	5	127	2 7/8	73	2 5/8	67	5/8
GT-30	-	2	8 Sol.-4 Str.	.128- .282	1 3/4	44	3 7/8	98	2 3/4	70	2 13/16	71	3/8
GT-31	-	2	4 Sol. 2/0 Str.	.204- .419	2	51	4 1/8	105	2 7/8	73	2 13/16	71	3/8
GT-32	-	2	2/0 Sol.-250 MCM	.365- .575	2 5/8	67	4 1/4	108	3	76	2 13/16	71	3/8
GT-33	-	2	300-500 MCM	.634- .815	2 7/8	73	4 5/8	118	3 1/8	79	2 15/16	75	1/2
GT-34	-	2	500-750 MCM	.815- .999	3 3/4	95	5 1/4	133	3 1/4	82	3 1/16	78	5/8
GT-35	-	2	750-1000 MCM	.999-1.153	4	102	5 1/2	140	3 1/4	82	3 1/16	78	5/8
GT-36	-	2 1/2	8 Sol.-4 Str.	.128- .232	1 3/4	44	4 3/8	111	3 3/8	85	3 5/8	92	3/8
GT-37	-	2 1/2	4 Sol.-2/0 Str.	.204- .419	2	51	4 1/2	115	3 3/8	85	3 5/16	84	3/8
GT-38	-	2 1/2	2/0 Sol.-250 MCM	.365- .575	2 5/8	67	4 3/4	121	3 1/2	89	3 3/16	84	3/8
GT-39	-	2 1/2	300-500 MCM	.634- .815	2 7/8	73	5 1/8	130	3 5/8	92	3 7/16	87	1/2
GT-40	-	2 1/2	500-750 MCM	.815- .999	3 3/4	95	5 5/8	143	3 3/4	95	3 3/16	90	5/8
GT-41	-	2 1/2	750-1000 MCM	.999-1.153	4	102	5 3/4	146	3 3/4	95	3 9/16	90	5/8
GT-42	-	3	8 Sol.-4 Str.	.128- .232	1 3/4	44	5	127	3 5/8	92	3 15/16	100	3/8
GT-43	-	3	4 Sol.-2/0 Str.	.204- .419	2	51	5 1/4	133	3 3/4	95	3 15/16	100	3/8
GT-44	-	3	2/0 Sol.-250 MCM	.365- .575	2 5/8	67	5 1/2	140	3 3/4	95	3 15/16	100	3/8
GT-45	-	3	300-500 MCM	.634- .815	2 7/8	73	5 7/8	149	3 7/8	98	4 1/16	104	1/2
GT-46	-	3	500-750 MCM	.815- .999	3 3/4	95	6 1/2	165	4 1/8	105	4 3/16	107	5/8
GT-47	-	3	750-1000 MCM	.999-1.153	4	102	6 3/4	171	4 1/8	105	4 3/16	107	5/8
GT-48	-	3 1/2	8 Sol.-4 Str.	.128- .232	1 3/4	44	5 1/2	140	3 7/8	98	4 7/16	113	3/8
GT-49	-	3 1/2	4 Sol.-2/0 Str.	.204- .419	2	51	5 7/8	149	3 7/8	98	4 7/16	113	3/8
GT-50	-	3 1/2	2/0 Sol.-250 MCM	.365- .575	2 5/8	67	6 1/8	155	4	102	4 7/16	113	3/8
GT-51	-	3 1/2	300-500 MCM	.634- .815	2 7/8	73	6 1/2	165	4 1/4	105	4 9/16	116	1/2
GT-52	-	3 1/2	500-750 MCM	.815- .999	3 3/4	95	7 1/8	181	4 5/8	118	4 11/16	119	5/8
GT-53	-	3 1/2	750-1000 MCM	.999-1.153	4	102	7 3/8	187	4 5/8	118	4 11/16	119	5/8
GT-54	-	3 1/2	1250-1500 MCM	1.290-1.412	4 1/4	108	7 5/8	194	4 3/4	121	4 11/16	119	5/8
GT-55	-	4	2/0 Sol.-250 MCM	.365- .575	2 5/8	67	6 1/2	165	4 3/4	121	4 15/16	126	3/8
GT-56	-	4	300-500 MCM	.634- .815	2 7/8	73	7	178	5	127	5 1/16	129	1/2

† 3/8" U-Bolt threaded as shown above, add suffix "FT" for full thread. 1/2" U-Bolt standard is full thread.

TYPE GU

Made from high copper content alloy. Furnished with silicon bronze bolt, nuts and lockwashers.

For clamping two cables or a looped cable or wire to pipe

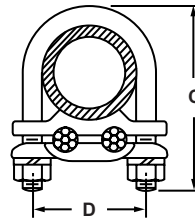
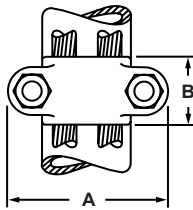
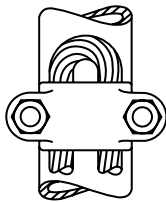

Catalog Number	IPS	Conductor Range	Wire Diameter Range	Approximate Dimensions								Bolt Dia.†
				A		B		C		D		
			in	in	mm	in	mm	in	mm	in	mm	
GU-0	3/4	8 Sol.-4 Str.	.128- .232	2 1/2	64	7/8	22	2 5/8	67	1 1/2	38	3/8
GU-00	3/4	4 Sol.-2/0 Str.	.204- .419	2 1/2	64	7/8	22	2 5/8	67	1 1/2	38	3/8
GU-1	1	8 Sol.-4 Str.	.128- .232	2 3/4	70	1 1/8	28	3	76	1 3/4	44	3/8
GU-2	1	4 Sol.-2/0 Str.	.204- .419	2 3/4	70	1 1/8	28	3 1/4	82	1 3/4	44	3/8
GU-3	1	2/0 Sol.-250 MCM	.365- .575	2 3/4	70	1 1/4	32	3 1/2	89	1 3/4	44	3/8
GU-4	1 1/4	8 Sol.-4 Str.	.128- .232	3	76	1 1/8	28	3 1/4	82	2 1/16	53	3/8
GU-5	1 1/4	4 Sol.-2/0 Str.	.204- .419	3	76	1 1/4	32	3 1/2	89	2 1/16	53	3/8
GU-6	1 1/4	2/0 Sol.-250 MCM	.365- .575	3	76	1 3/8	34	3 3/4	95	2 1/16	53	3/8
GU-7	1 1/2	8 Sol.-4 Str.	.128- .232	3 3/8	85	1 1/4	32	3 1/2	89	2 3/8	60	3/8
GU-8	1 1/2	4 Sol.-2/0 Str.	.204- .419	3 3/8	85	1 3/8	34	3 5/8	92	2 3/8	60	3/8
GU-9	1 1/2	2/0 Sol.-250 MCM	.365- .575	3 3/8	85	1 1/2	38	3 3/4	95	2 3/8	60	3/8
GU-10	2	8 Sol.-4 Str.	.128- .232	3 3/4	95	1 3/8	34	3 7/8	98	2 13/16	71	3/8
GU-11	2	4 Sol.-2/0 Str.	.204- .419	3 3/4	95	1 3/8	34	4 1/8	105	2 13/16	71	3/8
GU-12	2	2/0 Sol.-250 MCM	.365- .575	3 3/4	95	1 3/8	34	4 1/4	108	2 13/16	71	3/8
GU-13	2	300-500 MCM	.634- .815	4	102	1 1/2	38	4 5/8	118	2 15/16	75	1/2
GU-14	2 1/2	8 Sol.-4 Str.	.128- .232	4 1/4	108	1 3/8	34	5	127	3 5/16	84	3/8
GU-15	2 1/2	4 Sol.-2/0 Str.	.204- .419	4 1/4	108	1 3/8	34	5 1/8	130	3 5/16	84	3/8
GU-16	2 1/2	2/0 Sol.-250 MCM	.365- .575	4 1/4	108	1 3/8	34	5 1/4	133	3 5/16	84	3/8
GU-17	2 1/2	300-500 MCM	.634- .815	4 1/2	115	1 1/2	38	5 1/2	140	3 7/16	87	1/2
GU-18	2 1/2	500-750 MCM	.815- .999	4 1/2	115	1 1/2	38	5 3/4	146	3 7/16	87	1/2
GU-19	3	8 Sol.-4 Str.	.128- .232	5	127	1 3/8	34	5 1/4	133	3 15/16	100	3/8
GU-20	3	4 Sol.-2/0 Str.	.204- .419	5	127	1 3/8	34	5 1/2	140	3 15/16	100	3/8
GU-21	3	2/0 Sol.-250 MCM	.365- .575	5	127	1 3/8	34	5 3/4	146	3 15/16	100	3/8
GU-22	3	300-500 MCM	.634- .815	5 1/4	133	1 1/2	38	6	152	4 1/16	104	1/2
GU-23	3	500-750 MCM	.815- .999	5 1/2	140	1 3/4	44	6 3/8	161	4 3/16	107	5/8
GU-25	3 1/2	8 Sol.-4 Str.	.128- .232	5 1/2	140	1 1/2	38	6	152	4 7/16	113	3/8
GU-26	3 1/2	4 Sol.-2/0 Str.	.204- .419	5 1/2	140	1 1/2	38	6 1/8	155	4 7/16	113	3/8
GU-27	3 1/2	2/0 Sol.-250 MCM	.365- .575	5 1/2	140	1 1/2	38	6 1/4	158	4 7/16	113	3/8
GU-28	3 1/2	300-500 MCM	.634- .815	5 3/4	146	1 3/4	44	6 3/8	161	4 9/16	116	1/2
GU-29	3 1/2	500-750 MCM	.815- .999	6	152	1 7/8	47	6 5/8	168	4 11/16	119	5/8
GU-30	3 1/2	750-1000 MCM	.999-1.153	6	152	2 1/8	54	7	178	4 11/16	119	5/8
GU-31	4	8 Sol.-4 Str.	.128- .232	6	152	1 1/2	38	6 1/2	165	4 15/16	126	3/8
GU-32	4	4 Sol.-2/0 Str.	.204- .419	6	152	1 1/2	38	6 3/4	171	4 15/16	126	3/8
GU-33	4	2/0 Sol.-250 MCM	.365- .575	6	152	1 5/8	41	7	178	4 15/16	126	3/8
GU-34	4	300-500 MCM	.634- .815	6 1/4	158	1 5/8	41	7 1/4	184	5 1/16	129	1/2
GU-35	4	500-750 MCM	.815- .999	6 1/2	165	1 7/8	47	7 1/2	191	5 3/16	132	5/8
GU-36	4	750-1000 MCM	.999-1.153	6 1/2	165	2 1/8	54	7 3/4	197	5 3/16	132	5/8
GU-37	4	1250-1500 MCM	1.290-1.412	6 1/2	165	2 3/8	60	8 1/8	206	5 3/16	132	5/8

† 3/8" U-Bolt threaded as shown above, add suffix "FT" for full thread. 1/2" U-Bolt standard is full thread.

TYPE IK-C

Features

- Manufactured from high strength copper alloy
- Precision tooled threads
- UL Listed and CSA Certified, rated for 600 volts
- For copper conductor only

Benefits

- Allows maximum conductivity and high breakage resistance
- Allows maximum torque to be applied
- Ensures reliability

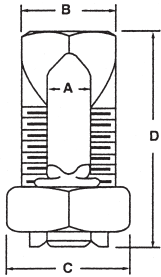

Catalog Number	Copper Wire			Dimensions			
	Range For Equal Main & Tap		Min. Tap With One Max. Main	A	B	C	D
	Min.	Max.					
IK-8C	16Str.	8Str.	16Str.	.15	.38	.50	.85
IK-6C +	10Sol.	6Sol.	16Sol.	.17	.50	.63	1.05
IK-4C +	8Sol.	4Sol.	16Sol.	.22	.56	.69	1.05
IK-3C +	6Sol.	2Sol.	12Sol.	.33	.69	.82	1.32
IK-2C +	6Sol.	2Str.	14Str.	.33	.69	.82	1.32
IK-1/0C +	4Sol.	1/0Str.	14Sol.	.38	.75	.88	1.64
IK-2/0C	2Sol.	2/0Str.	14Str.	.42	.82	1.00	1.82
IK-3/0C	2Sol.	3/0Str.	12Sol.	.47	.88	1.13	2.00
IK-250C	1/0Sol.	250MCM	10Sol.	.58	1.00	1.31	2.08
IK-350C	4/0Str.	350MCM	8Sol.	.75	1.50	1.63	2.63
IK-500C	250MCM	500MCM	8Sol.	.83	1.63	1.82	3.00
IK-750C	350MCM	750MCM	8Sol.	1.03	1.94	2.13	3.44
IK-1000C	500MCM	1000MCM	8Sol.	1.22	2.25	2.50	4.00

+ REA Listed

TYPE SK-C

Features

- Manufactured from high strength copper alloy
- Precision tooled threads
- Electro-tin plated
- Serrated spacer bar
- UL 486A Listed, rated for 600 volts

Benefits

- Allows maximum conductivity and high breakage resistance
- Allows maximum torque to be applied
- Provides low contact resistance
- Allows connection of copper to copper; copper to aluminum; steel to copper; and steel to aluminum
- Ensures reliability

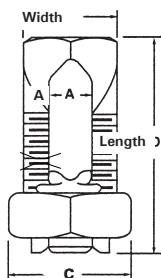

Catalog Number	Wire Range		Wire Range		Dimensions			
	Main Copper & Aluminum	ACSR-AAAC 5005	Tap Copper & Aluminum	ACSR-AAAC 5005	A	Width	C	Length
SK-6C *	8Str.-14Str.	8(6-1)	8Str.-14Str.	8(6-1)	.166	1/2	5/8	1-7/64
SK-4C *	6Str.-10Str.	6(6-1)	6Str.-10Str.	6(6-1)	.217	9/16	11/16	1-17/64
SK-3C + *	4Str.-8Sol./Str. AL 2Sol.-8Sol./Str. CU	6(6-1)-4(7-1)	4Str.-8Sol./Str. AL 2Sol.-8Sol./Str. CU	6(6-1)-4(7-1)	.326	11/16	13/16	1-35/64
SK-2C + *	2Str.-8Sol./Str.	3(6-1)-2(6-1)	2Str.-8Sol./Str.	6(6-1)-2(7-1)	.326	11/16	13/16	1-35/64

+ REA Listed.

*UL 486B Listed, Dual Rated

Catalog Number	Wire Range		Aluminum Range Not UL Listed		Dimensions			
	Main Copper	Tap Copper	Main	Tap	A	Width	C	Length
SK-1/0C +	1/0Str.-6Sol./Str.	1/0Str.-10Sol./Str.	3(6-1)-1(6-1)	6(6-1)-1(6-1)	.376	3/4	7/8	1-41/64
SK-2/0C +	2/0Str.-6Str.	2/0Str.-10Sol./Str.	1(6-1)-1/0(6-1)	6(6-1)-1/0(6-1)	.420	13/16	1	1-53/64
SK-3/0C	3/0Str.-4Str.	3/0Str./6Sol./Str.	1(6-1)-2/0(6-1)	8(6-1)-2/0(6-1)	.466	7/8	1-1/8	2
SK-250C	250MCM-4Str.	250MCM-4Str.	2/0(6-1)-4/0(6-1)	4(7-1)-4/0(6-1)	.577	1	1-15/16	2-21/64
SK-350C	350MCM-3/0Str.	350MCM-1Sol./Str.	3/0(6-1)-4/0(6-1)	4(6-1)-4/0(6-1)	.746	1-1/2	1-5/8	2-5/8
SK-500C	500MCM-3/0Str.	500MCM-1/0Str.	336.4(30-7)- 477(18-1)	2/0(6-1)-477(18/1)	.834	1-5/8	1-13/16	3

+ REA Listed.

TYPE SEL

Features

- Manufactured from high strength copper alloy
- Precision tooled threads
- UL 467 DB Listed for 600 volts direct burial

Benefits

- Provides maximum conductivity and a high degree of breakage resistance
- Allows maximum torque to be applied
- Ensures reliability for copper conductor

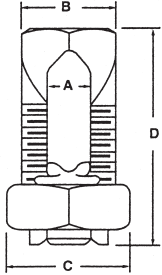

Catalog Number	Copper Wire		Maximum Wire		Wire Diameter Range In	Approx. Dimensions In Inches				Recommended Torque (in.-lb.)
	Range of Equal Main and Tap	Min. Tap With One Max. Main	Copperweld			A	B	C	D	
			Str.	Type A						
SEL-8S	8Str-16Str	16Str.	-	-	.057 - .145	.145	3/8	1/2	27/32	80
SEL-6S	6Sol.-10Sol.	16Sol.	-	-	.102 - .162	.165	7/16	5/8	1-7/64	165
SEL-4S	4Sol.-8Sol.	16Sol.	3 No. 12	8A	.128 - .204	.215	1/2	11/16	1-17/64	165
SEL-2S	2Str.-6Sol.	14Str.	3 No. 7	3A	.162 - .292	.328	5/8	13/16	1-35/64	275

TYPE

LD AND LDN

Double eyebolt type for copper cable to copper flat

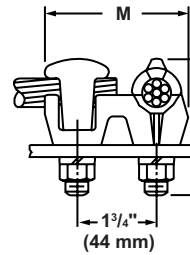
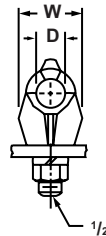

FIG. 1

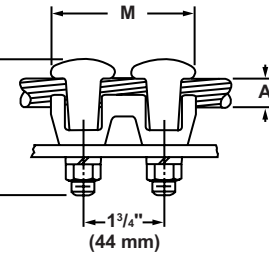

FIG. 2

FOR 1/4" THICK BAR

Catalog Number	A Conductor Range	Wire Diameter Range in	Fig. No.	Approximate Dimensions							
				D		L		M		W	
				in	mm	in	mm	in	mm	in	mm
LDN-2/0N	8 Sol.-2/0 Str.	.128- .419	2	7/16	11	2 ⁵ / ₁₆	59	2 ¹³ / ₁₆	71	2 ⁹ / ₃₂	23
LDN-2/0N2	8 Sol.-2/0 Str.	.128- .419	1	7/16	11	2 ³ / ₈	60	3 ¹ / ₈	79	1 ³ / ₈	35
LDN-025N	6 Str.-250 MCM	.184- .575	2	5/8	16	2 ⁹ / ₁₆	65	3	76	1 ¹ / ₁₆	27
LDN-025N2	6 Str.-250 MCM	.184- .575	1	5/8	16	2 ⁵ / ₈	67	3 ³ / ₈	86	1 ⁵ / ₈	41
LDN-035N	2 Sol.-350 MCM	.258- .682	2	1 ³ / ₁₆	21	3 ⁵ / ₁₆	84	3	76	1 ⁵ / ₁₆	33
LDN-050N	1/0 Sol.-500 MCM	.325- .815	2	1 ⁵ / ₁₆	24	3 ¹ / ₄	83	3	76	1 ⁷ / ₁₆	37
LDN-075	350-750 MCM	.682- .999	2	1 ¹ / ₁₆	27	3 ³ / ₁₆	81	3 ¹ / ₄	83	1 ¹⁹ / ₃₂	40
LDN-100N	2/0 Sol.-1000 MCM	.365-1.153	2	1 ¹ / ₄	32	3 ¹³ / ₁₆	97	3 ⁷ / ₁₆	87	1 ¹¹ / ₁₆	43
LD-200E	500-2000 MCM	.815-1.632	2	1 ²³ / ₃₂	44	5 ¹ / ₄	133	4	102	2 ³ / ₄	70

FOR 1/4" TO 3/4" THICK BAR

LDN-2/0N2E	8 Sol.-2/0 Str.	.128- .419	1	7/16	11	2 ⁷ / ₈	73	3 ¹ / ₈	79	1 ³ / ₈	35
LDN-025NE	6 Sol.-250 MCM	.162- .575	2	5/8	16	3 ¹ / ₁₆	78	3	76	1 ¹ / ₁₆	27
LDN-025N2E	6 Sol.-250 MCM	.162- .575	1	5/8	16	3 ¹ / ₁₆	78	3 ³ / ₈	86	1 ⁵ / ₈	41
LDN-035NE	2 Sol.-350 MCM	.258- .682	2	1 ³ / ₁₆	21	3 ⁵ / ₁₆	84	3	76	1 ⁵ / ₁₆	33
LDN-050NE	1/0 Sol.-500 MCM	.325- .815	2	1 ⁵ / ₁₆	24	3 ³ / ₄	95	3	76	1 ⁷ / ₁₆	37
LDN-075E	350-750 MCM	.682- .999	2	1 ¹ / ₁₆	27	3 ¹¹ / ₁₆	94	3 ¹ / ₄	83	1 ¹⁹ / ₃₂	40
LDN-100NE	2/0 Sol.-1000 MCM	.365-1.153	2	1 ¹ / ₄	32	4 ¹ / ₁₆	103	3 ⁷ / ₁₆	87	1 ¹¹ / ₁₆	43
LD-200E	500-2000 MCM	.815-1.632	2	1 ²³ / ₃₂	44	5 ¹ / ₄	133	4	102	2 ³ / ₄	70

"N" in prefix qualifies terminal for mounting on NEMA pads.

"N" in suffix qualifies eyebolt opening to NEMA.

"2" in suffix indicates two-way cable entrance.

TYPE

LS AND LSN

Single eyebolt type for copper cable to copper flat

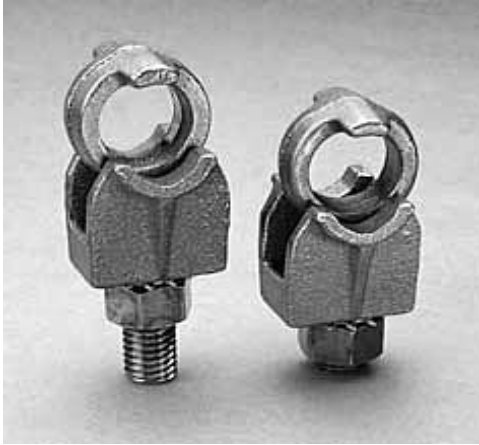

A practical and highly versatile connector that may be used for numerous applications. Used extensively by all manufacturers who bring out flat studs, bus, or spades on their equipment. Used also for grounding cables to steel substation structures.

Cups (bodies) are made from corrosion resistant, high conductivity copper alloy. Eyebolts are made from a special, aluminum bronze alloy, for maximum strength.

Silicon bronze nuts and lockwashers.

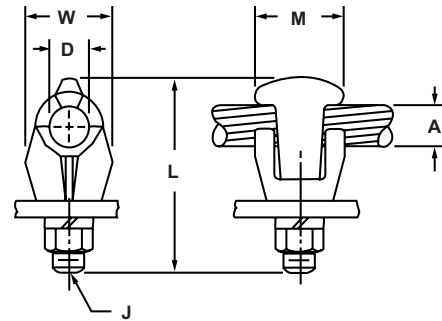

FOR 1/4" THICK BAR

Catalog Number	A Conductor Range	Wire Diameter Range in	Approximate Dimensions								
			D		L		M		W		J
			in	mm	in	mm	in	mm	in	mm	in
LS-C1E	10 Sol.-1 Str.	.102-.332	1 ¹ / ₃₂	9	2 ³ / ₈	60	1 ¹ / ₁₆	27	7/ ₈	22	3/ ₈
LSN-2/0N	8 Sol.-2/0 Str.	.128-.419	7/ ₁₆	11	2 ³ / ₈	60	1 ³ / ₈	35	1	25	1/ ₂
LS-2/0	8 Sol.-2/0 Str.	.128-.419	7/ ₁₆	11	2	51	1 ¹ / ₄	32	1	25	3/ ₈
LSN-025N	6 Sol.-250 MCM	.162-.575	5/ ₈	16	2 ⁹ / ₁₆	65	1 ¹ / ₄	32	1 ¹ / ₁₆	27	1/ ₂
LSN-035N	2 Sol.-350 MCM	.258-.682	1 ³ / ₁₆	21	3 ¹ / ₁₆	78	1 ¹ / ₄	32	1 ⁵ / ₁₆	33	1/ ₂
LSN-050N	1/0 Sol.-500 MCM	.325-.815	1 ⁵ / ₁₆	24	3 ¹ / ₄	83	1 ¹ / ₄	32	1 ⁷ / ₁₆	37	1/ ₂
LSN-075	350-750 MCM	.682-.999	1 ¹ / ₁₆	27	3 ³ / ₁₆	81	1 ¹ / ₂	38	1 ¹⁹ / ₃₂	40	1/ ₂
LSN-100N	2/0 Sol.-1000 MCM	.365-1.153	1 ¹ / ₄	32	4 ¹ / ₄	108	1 ²³ / ₃₂	44	1 ¹¹ / ₁₆	43	1/ ₂
LS-150E	1000-1500 MCM	1.153-1.412	1 ¹ / ₂	38	4 ³ / ₈	111	2 ¹ / ₄	57	2 ¹ / ₂	64	1/ ₂
LS-200E	500-2000 MCM	.325-1.632	1 ²³ / ₃₂	44	5 ¹ / ₄	133	2 ¹ / ₄	57	2 ³ / ₄	70	1/ ₂

FOR 1/4" TO 3/4" THICK BAR

LS-C1E	10 Sol.-1 Str.	.102-.332	1 ¹ / ₃₂	9	2 ³ / ₈	60	1 ¹ / ₁₆	27	7/ ₈	22	3/ ₈
LSN-2/0NE	8 Sol.-2/0 Str.	.128-.419	7/ ₁₆	11	2 ³ / ₄	70	1 ³ / ₈	35	1	25	1/ ₂
LS-2/0E	8 Sol.-2/0 Str.	.128-.419	7/ ₁₆	11	2 ¹ / ₂	64	1 ¹ / ₄	32	1	25	3/ ₈
LSN-025NE	6 Sol.-250 MCM	.162-.575	5/ ₈	16	3 ¹ / ₁₆	78	1 ¹ / ₄	32	1 ¹ / ₁₆	27	1/ ₂
LSN-035NE	2 Sol.-350 MCM	.258-.682	1 ³ / ₁₆	21	3 ⁵ / ₁₆	84	1 ¹ / ₄	32	1 ⁵ / ₁₆	33	1/ ₂
LSN-050NE	1/0 Sol.-500 MCM	.325-.815	1 ⁵ / ₁₆	24	3 ³ / ₄	95	1 ¹ / ₄	32	1 ⁷ / ₁₆	37	1/ ₂
LSN-075E	350-750 MCM	.682-.999	1 ¹ / ₁₆	27	3 ¹¹ / ₁₆	94	1 ¹ / ₂	38	1 ¹⁹ / ₃₂	40	1/ ₂
LSN-100NE	2/0 Sol.-1000 MCM	.365-1.153	1 ¹ / ₄	32	4 ¹ / ₂	114	1 ²³ / ₃₂	44	1 ¹¹ / ₁₆	43	1/ ₂
LS-150E	1000-1500 MCM	1.153-1.412	1 ¹ / ₂	38	4 ³ / ₈	111	2 ¹ / ₄	57	2 ¹ / ₂	64	1/ ₂
LS-200E	500-2000 MCM	.325-1.632	1 ²³ / ₃₂	44	5 ¹ / ₄	133	2 ¹ / ₄	57	2 ³ / ₄	70	1/ ₂

"N" in prefix qualifies terminal for mounting on NEMA pads.
 "N" in suffix qualifies eyebolt opening to NEMA.

TYPE

SSS, SCS, STS AND SDS

Body made from high copper content hard drawn rod. Used for connecting one or two conductors to various sizes external stud or tapped hole.



SSS SCS SSS-A1



STS SDS

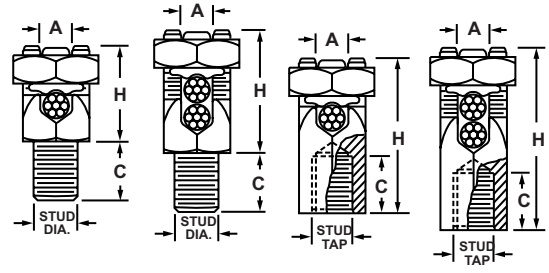

FIG. 1

FIG. 2

FIG. 3

FIG. 4

MALE TYPES SSS AND SCS

Catalog Number	Fig. 1 (One Cable)		Fig. 2 (Two Cables)		Stud Size	Approximate Dimensions										
	A Conductor Range	Wire Diameter Range in	Catalog Number	A Conductor Range		Wire Diameter Range in	Nut Hex.		C		H		Body Hex.			
							in	mm	in	mm	One Cable	Two Cable	in	mm		
SSS-0	12 Sol.-8 Str.	.081- .146	SCS-0	12 Sol.-8 Str.	.081- .146	1/4-20	1/2	13	1/2	13	5/8	16	3/4	19	3/8	9
SSS-0A1	12 Sol.-8 Str.	.081- .146	SCS-0A1	12 Sol.-8 Str.	.081- .146	1/4-20	1/2	13	1	25	5/8	16	3/4	19	3/8	9
SSS-1	8 Sol.-7 Str.	.128- .164	SCS-1	10 Sol.-7 Str.	.102- .164	1/4-20	11/16	17	1/2	13	7/8	22	1	25	1/2	13
SSS-1A1	8 Sol.-7 Str.	.128- .164	SCS-1A1	10 Sol.-7 Str.	.102- .164	1/4-20	11/16	17	1	25	7/8	22	1	25	1/2	13
SSS-2	10 Sol.-4 Str.	.102- .232	SCS-2	10 Sol.-4 Str.	.102- .232	5/16-18	3/4	19	9/16	14	15/16	24	15/32	29	9/16	14
SSS-2A1	10 Sol.-4 Str.	.102- .232	SCS-2A1	10 Sol.-4 Str.	.102- .232	5/16-18	3/4	19	1	25	15/16	24	15/32	29	9/16	14
SSS-3	6 Sol.-3 Str.	.162- .260	SCS-3	10 Sol.-3 Str.	.102- .260	3/8-16	13/16	21	5/8	16	1 1/16	27	1 3/32	28	5/8	16
SSS-3A1	6 Sol.-3 Str.	.162- .260	SCS-3A1	10 Sol.-3 Str.	.102- .260	3/8-16	13/16	21	1 1/8	29	1 1/16	27	1 3/32	28	5/8	16
SSS-4	4 Str.-2 Str.	.232- .292	SCS-4	10 Sol.-2 Str.	.102- .292	3/8-16	7/8	22	5/8	16	1 1/16	27	1 3/8	35	1 1/16	17
SSS-4A1	4 Str.-2 Str.	.232- .292	SCS-4A1	10 Sol.-2 Str.	.102- .292	3/8-16	7/8	22	1 1/8	29	1 1/16	27	1 9/32	33	1 1/16	17
SSS-5	6 Sol.-1/0 Str.	.162- .375	SCS-5	2 Sol.-1/0 Str.	.258- .375	1/2-13	1	25	3/4	19	1 5/16	33	1 11/16	43	3/4	19
SSS-5A1	6 Sol.-1/0 Str.	.162- .375	SCS-5A1	2 Sol.-1/0 Str.	.258- .375	1/2-13	1	25	1 1/4	32	1 5/16	33	1 11/16	43	3/4	19
SSS-6	1 Sol.-2/0 Str.	.289- .419	SCS-6	2 Sol.-2/0 Str.	.258- .419	1/2-13	1 1/8	29	3/4	19	1 7/16	37	1 7/8	48	7/8	22
SSS-6A1	1 Sol.-2/0 Str.	.289- .419	SCS-6A1	2 Sol.-2/0 Str.	.258- .419	1/2-13	1 1/8	29	1 1/4	32	1 7/16	37	1 7/8	48	7/8	22
SSS-8	3/0 Sol.-4/0 Str.	.410- .528	SCS-8	1 Sol.-4/0 Str.	.289- .528	5/8-11	1 3/8	35	1	25	1 11/16	43	2 1/4	57	1 1/8	29
SSS-8A1	3/0 Sol.-4/0 Str.	.410- .528	SCS-8A1	1 Sol.-4/0 Str.	.289- .528	5/8-11	1 3/8	35	1 1/2	38	1 11/16	43	2 1/4	57	1 1/8	29
SSS-9	4/0 Str.-350 MCM	.528- .682	SCS-9	1 Str.-350 MCM	.332- .682	5/8-11	1 1/2	38	1	25	2	51	2 11/16	68	1 1/4	32
SSS-9A1	4/0 Str.-350 MCM	.528- .682	SCS-9A1	1 Str.-350 MCM	.332- .682	5/8-11	1 1/2	38	1 1/2	38	2	51	2 11/16	68	1 1/4	32
SSS-10	250-500 MCM	.575- .815	SCS-10	3/0 Str.-500 MCM	.470- .815	3/4-10	1 13/16	46	1 3/8	35	2 5/16	59	3 3/16	81	1 1/2	38
SSS-10A1	250-500 MCM	.575- .815	SCS-10A1	3/0 Str.-500 MCM	.470- .815	3/4-10	1 13/16	46	1 3/4	44	2 5/16	59	3 3/16	81	1 1/2	38
* SSS-11	300-750 MCM	.634- .999	SCS-11	350-750 MCM	.682- .999	3/4-10	2 1/4	57	1 3/8	35	2 1/2	64	3 7/16	87	1 7/8	48
* SSS-11A1	300-750 MCM	.634- .999	SCS-11A1	350-750 MCM	.682- .999	3/4-10	2 1/4	57	1 7/8	48	2 1/2	64	3 7/16	87	1 7/8	48
* SSS-12	750-1000 MCM	.999-1.153	SCS-12	500-1000 MCM	.815-1.153	1-8	2 5/8	67	1 1/2	38	3	76	4	102	2 3/8	60
* SSS-12A1	750-1000 MCM	.999-1.153	SCS-12A1	500-1000 MCM	.815-1.153	1-8	2 5/8	67	2	51	3	76	4	102	2 3/8	60

FEMALE TYPES STS AND SDS

If nut and lockwasher are required, add suffix "-SMH" to catalog number.

Catalog Number	Fig. 3. (One Cable)		Fig. 4 (Two Cables)		Stud Size	Nut Hex.	C	H		Body Hex.						
	A Conductor Range	Wire Diameter Range in	Catalog Number	A Conductor Range				Wire Diameter Range in	in	mm	One Cable	Two Cable	in	mm		
STS-0	12 Sol.-8 Str.	.081- .146	SDS-0	12 Sol.-8 Str.	.081- .146	1/4-20	1/2	13	1/4	6	29/32	23	1 1/8	29	3/8	9
STS-1	10 Sol.-7 Str.	.102- .164	SDS-1	10 Sol.-7 Str.	.102- .164	1/4-20	11/16	17	1/4	6	1 1/8	29	1 7/16	37	1/2	13
STS-2	8 Sol.-4 Str.	.128- .232	SDS-2	10 Sol.-4 Str.	.102- .232	5/16-18	3/4	19	5/16	8	1 7/16	37	1 9/16	40	9/16	14
STS-3	6 Str.-3 Str.	.184- .260	SDS-3	10 Sol.-3 Str.	.102- .260	3/8-16	13/16	21	3/8	9	1 1/2	38	1 5/8	41	5/8	16
STS-4	6 Str.-2 Str.	.184- .292	SDS-4	10 Sol.-2 Str.	.102- .292	3/8-16	7/8	22	3/8	9	1 5/8	41	1 15/16	49	1 1/16	17
STS-5	2 Sol.-1/0 Str.	.258- .375	SDS-5	2 Sol.-1/0 Str.	.258- .375	1/2-13	1	25	7/16	11	1 7/8	48	2 1/8	54	3/4	19
STS-6	1 Sol.-2/0 Str.	.289- .419	SDS-6	2 Sol.-2/0 Str.	.258- .419	1/2-13	1 1/8	29	1/2	13	2 1/16	52	2 5/16	59	7/8	22
STS-8	1/0 Str.-4/0 Str.	.375- .528	SDS-8	1 Sol.-4/0 Str.	.289- .528	5/8-11	1 3/8	35	5/8	16	2 3/8	60	2 1/2	64	1 1/8	29
STS-9	4/0 Str.-350 MCM	.528- .682	SDS-9	1 Str.-350 MCM	.332- .682	5/8-11	1 1/2	38	5/8	16	2 5/8	67	2 11/16	68	1 1/4	32
STS-10	300-500 MCM	.634- .815	SDS-10	3/0 Str.-500 MCM	.470- .815	3/4-10	1 13/16	46	3/4	19	3 1/8	79	3 5/16	84	1 1/2	38
* STS-11	600-750 MCM	.893- .999	SDS-11	350-750 MCM	.682- .999	3/4-10	2 1/4	57	7/8	29	3 1/2	89	3 1/2	89	2	51
* STS-12	750-1000 MCM	.964-1.153	SDS-12	500-1000 MCM	.815-1.153	1-8	2 5/8	67	1 1/8	22	4 1/8	105	4	102	2 3/8	60

*UL listing is limited to 500 MCM.

TYPE TA-I

Features

- Manufactured from high strength 6061-T6 aluminum alloy
- Electro-tin plated
- CSA Certified and UL Listed
- I-Beam construction
- Rated for 600 volts, 90° C

Benefits

- Suitable for use with either copper or aluminum conductors
- Provides low contact resistance
- Ensures reliability for copper or aluminum conductors
- Reduces material content while maintaining the same performance standards as full sized connectors
- Ensures reliability



Catalog Number	Wire Range	Mounting Hole Diameter	Dimensions						Hex Size
			A	B	C	D	E	F	
TA-6I	6-14	.206	.75	.437	.44	.062	.062	.325	SLOT
TA-2I	2-14	.265	.94	.500	.60	.094	.25	.44	SLOT
TA-1/0I	1/0-14	.265	1.125	.531	.66	.156	.25	.60	SLOT
TA-2/0I	2/0-6	.265	1.225	.600	.70	.156	.25	.60	3/16
TA-250I	250 MCM-6	.406	1.875	.875	1.0	.250	.47	.875	5/16
TA-300I	300 MCM-6	.406	1.125	.875	1.13	.293	.500	1.00	5/16
TA-350I	350 MCM-6	.406	2.125	1.00	1.13	.293	.500	1.00	5/16
TA-500I	500 MCM-4	.406	2.375	1.20	1.38	.312	.625	1.125	3/8
TA-600I	600 MCM-2	.562	2.613	1.35	1.50	.423	.69	1.20	1/2
TA-800I	800 MCM-300 MCM	.660	3.04	1.58	1.75	.468	.82	1.40	1/2
TA-1000I	1000 MCM-350 MCM	.660	3.25	1.69	1.88	.500	.88	1.50	9/16

DE-OX Inhibitor is recommended for all aluminum terminations.

TYPE AU-I

Features

- Manufactured from high strength 6061-T6 aluminum alloy
- Electro-tin plated
- CSA Certified and UL Listed
- I-Beam construction
- Rated for 600 volts, 90° C

Benefits

- Suitable for use with either copper or aluminum conductors
- Provides low contact resistance
- Ensures reliability for copper or aluminum conductors
- Reduces material content while maintaining the same performance standards as full sized connectors
- Ensures reliability

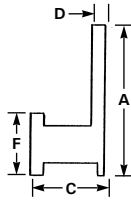
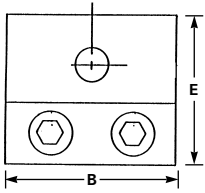

Catalog Number	Wire Range	Mounting Hole Diameter	Dimensions						Hex Size
			A	B	C	D	E	F	
AU-1/0I	1/0-14	.265	1.125	1.125	.66	.156	.25	.60	SLOT
AU-2/0I	2/0-6	.265	1.225	1.25	.70	.156	.25	.60	3/16
AU-250I	250 MCM-6	.406	1.875	1.648	1.0	.250	.47	.875	5/16
AU-350I	350 MCM-6	.406	2.125	1.920	1.13	.293	.500	1.00	5/16
AU-600I	600 MCM-2	.562	2.613	2.575	1.50	.423	.69	1.20	1/2
AU-800I	800 MCM-300 MCM	.660	3.04	3.035	1.75	.468	.82	1.40	1/2
AU-1000I	1000 MCM-350 MCM	.660	3.25	3.257	1.88	.500	.88	1.50	9/16

DE-OX Inhibitor is recommended for all aluminum terminations.

TYPE N174

Features

- Manufactured from high strength copper tubing
- Range taking
- UL Recognized and CSA certified for 600 volts

Benefits

- Provides maximum conductivity
- A wide range of conductor sizes can be used in the same connector
- Ensures reliability for copper conductor

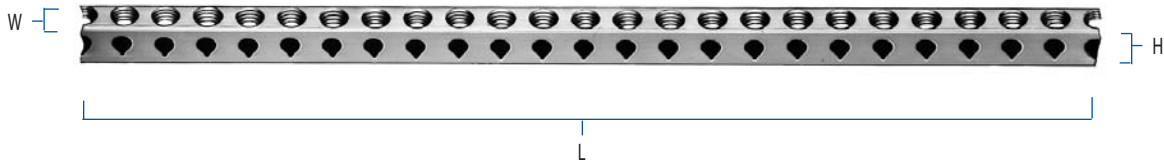

Catalog Number	Number Of Taps	Wire Range	Dimensions				Mounting Holes	Distance Between Holes
			L	W	H	Height With Maximum Wire		
N-174 Unassem. *	174	6-14	69.0	.343	.468	.75	None	.397"
N-174 Assembled **	174	6-14	69.0	.343	.468	.75	None	.397"

* Please order screws separately Part Number E153 (Screws)

** Assembled complete with E153 screws

Note: E153 screws use flathead screwdriver

Long Length Aluminum Neutral Bar

TYPE N8020

Features

- Manufactured from high strength aluminum alloy
- Range taking
- UL Recognized and CSA certified for 600 volts
- Electro-tin plated

Benefits

- Suitable for either copper or aluminum conductors
- A wide range of conductor sizes can be used in the same connector
- Ensures reliability
- Provides low contact resistance

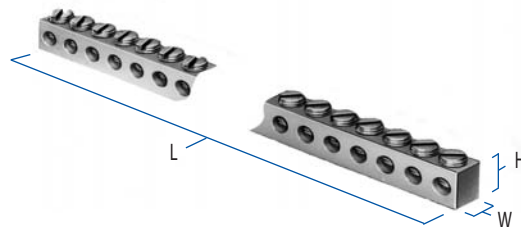

Catalog Number	Number Of Taps	Wire Range	Dimensions						Mounting Hole Positions	
			L	W	H	Height With Maximum Wire	Bolt Size	Mounting Holes	From End Of Bar To First Mounting Hole	Distance Between Holes
N8020 Unassembled *	231	4-14	72.0	.312	.437	.75	N/A	None	N/A	.312"
N8020A108T	10	4-14	3.168	.312	.437	.75	#10	.203 (#2,#9 holes)	.492	.312"
N8020A104T	4	4-14	1.296	.312	.437	.75	#10	.203 (#3 hole)	.492	.312"

* Please order screws separately Part Nuner E199 (Screws)

Note: E199 screws use flathead screwdriver or Robertson #2 (Red) Screwdriver

TYPE ACC

Features

- Manufactured from high strength aluminum alloy
- Chamfered barrel
- Pre-filled with DE-OX
- Color coded end cap inserted in end
- Designed to meet utility requirements

Benefits

- Provides maximum conductivity and excellent crimping characteristics
- Provides easy conductor insertion
- Prevents oxides from forming
- Prevents foreign materials from entering the connector prior to usage
- Utilizes standard CSA dies



Catalog Number	Wire Range Copper or Aluminum	Bolt Size	Tang Length	Overall Length	Width	Tooling Die Number
ACC-2	2Str. or Comp.	1/2	1.375	3.428	.950	CSA Die 22
ACC-1/0	1/0Str or Comp.	1/2	1.375	3.678	.950	CSA Die 22
ACC-2/0	2/0Str or Comp.	1/2	1.375	3.688	.950	CSA Die 22
ACC-3/0	3/0Str or Comp.	1/2	1.375	3.975	1.260	CSA Die 24
ACC-4/0	4/0Str or Comp.	1/2	1.375	3.940	1.190	CSA Die 24
ACC-250	250MCM or Comp.	1/2	1.500	4.210	1.300	CSA Die 26

TYPE
ASC

Features

- Manufactured from high strength aluminum alloy
- Chamfered barrel
- Pre-filled with DE-OX
- Color coded end cap inserted in each end
- Designed to meet utility requirements

Benefits

- Provides maximum conductivity and excellent crimping characteristics
- Provides easy conductor insertion
- Prevents oxides from forming
- Prevents foreign materials from entering the connector prior to usage
- Utilizes standard CSA dies



Catalog Number	Wire Range Copper or Aluminum	Minimum Strip Length	Overall Length	Tooling Die Number
ASC-2	2Str. or Comp.	1.500	3.250	CSA Die 22
ASC-1/0	1/0Str. or Comp.	1.875	4.000	CSA Die 22
ASC-2/0	2/0Str. or Comp.	1.875	4.000	CSA Die 22
ASC-3/0	3/0Str. or Comp.	1.900	4.050	CSA Die 24
ASC-4/0	4/0Str. or Comp.	2.375	5.000	CSA Die 24
ASC-250	250MCM or Comp.	2.375	5.000	CSA Die 26

TYPE PIK

Features

- Pre-insulated nylon jacket
- Dual-rated
- Color coded end caps
- Anchoring rings inside jacket
- Rated for 600 volts

Benefits

- Provides protection against moisture, extended shelf life and crimpability at sub-zero temperatures
- For aluminum to copper or aluminum to aluminum
- Provides for ease of wire size identification (conforms to industry standards) and also prevents dirt and other contaminants from entering the connector prior to use
- Holds connector insert in place during installation
- Ensures reliability

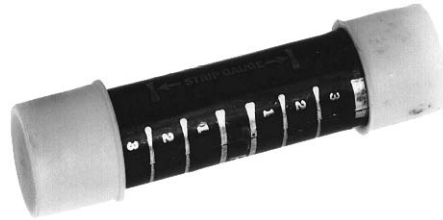
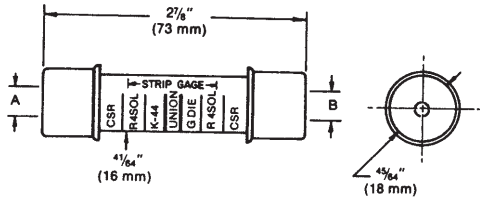

Catalog Number	A Range			Wire Diameter Range in Inches	Cap Color	B Range			Wire Diameter Range in Inches	Cap Color	Die Index
	ACSR	Alum. or Copper Str.	Copper Sol.			ACSR	Alum. or Copper Str.	Copper Sol.			
PIK-88	-	10	8	.116-.128	Brown	-	10	8	.116-.128	Brown	5/8 or BG
PIK-68	-	8	8	.145-.162	Green	-	10	8	.116-.128	Brown	5/8 or BG
PIK-66	-	8	8	.145-.162	Green	-	8	6	.145-.162	Green	5/8 or BG
PIK-48	6-6/1	5-6	4	.184-.206	Blue	-	10	8	.116-.128	Brown	5/8 or BG
PIK-46	6-6/1	5-6	4	.184-.206	Blue	-	8	6	.116-.128	Green	5/8 or BG
PIK-44	6-6/1	5-6	4	.184-.206	Blue	6-6/1	5-6	4	.116-.128	Blue	5/8 or BG
PIK-28	4-6/1, 7/1	3-4	2	.232-.260	Orange	-	10	8	.116-.128	Brown	5/8 or BG
PIK-26	4-6/1, 7/1	3-4	2	.232-.260	Orange	-	8	6	.145-.162	Green	5/8 or BG
PIK-24	4-6/1, 7/1	3-4	2	.232-.260	Orange	6-6/1	5-6	4	.184-.206	Blue	5/8 or BG
PIK-22	4-6/1, 7/1	3-4	2	.232-.260	Orange	4-6/1, 7/1	3-4	2	.232-.260	Orange	5/8 or BG
PIK-18	2-6/1, 7/1	1-2	-	.292-.332	Red	-	10	8	.116-.128	Brown	5/8 or BG
PIK-16	2-6/1, 7/1	1-2	-	.292-.332	Red	-	8	6	.145-.162	Green	5/8 or BG
PIK-14	2-6/1, 7/1	1-2	-	.292-.332	Red	6-6/1	5-6	4	.184-.206	Blue	5/8 or BG
PIK-12	2-6/1, 7/1	1-2	-	.292-.332	Red	4-6/1, 7/1	3-4	2	.232-.260	Orange	5/8 or BG
PIK-11	2-6/1, 7/1	1-2	-	.292-.332	Red	2-6/1, 7/1	1-2	-	.292-.332	Red	5/8 or BG
PIK-08	-	1/0	-	.373	Yellow	-	10	8	.116-.128	Brown	5/8 or BG
PIK-06	-	1/0	-	.373	Yellow	-	8	6	.145-.162	Green	5/8 or BG
PIK-04	-	1/0	-	.373	Yellow	6-6/1	5-6	4	.184-.206	Blue	5/8 or BG
PIK-02	-	1/0	-	.373	Yellow	4-6/1, 7/1	3-4	2	.232-.260	Orange	5/8 or BG
PIK-01	-	1/0	-	.373	Yellow	2-6/1, 7/1	1-2	-	.292-.332	Red	5/8 or BG
PIK-00	-	1/0	-	.373	Yellow	-	1/0	-	.373	Yellow	5/8 or BG

ILSCO Pre-Insulated Aluminum Compression Sleeves

TYPE PIK 840

Features

- Pre-insulated nylon jacket
- Dual-rated
- Color coded end caps
- Anchoring rings inside jacket
- Rated for 600 volts

Benefits

- Provides protection against moisture, extended shelf life and crimpability at sub-zero temperatures
- For aluminum to copper or aluminum to aluminum
- Provides for ease of wire size identification (conforms to industry standards) and also prevents dirt and other contaminants from entering the connector prior to use
- Holds connector insert in place during installation
- Ensures reliability

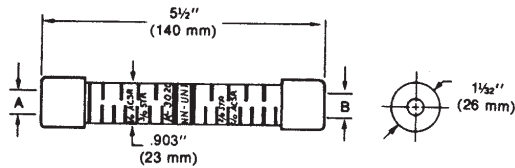

Catalog Number	A Range		Wire Diameter Range in Inches	Color Code A Range	B Range			Range in Inches	Color Code B Range	Die Index	
	ACSR	Alum. Str.			Alum. ACSR	Str.	Sol.			Hand	Hydraulic
PIK-01R	1/0	1/0	.373-.398	Yellow	2	1-2	1/0	.292-.332	Red	.840	B-249 or EEI 11A
PIK-00R	1/0	1/0	.373-.398	Yellow	1/0	1/0	-	.373-.398	Yellow	.840	B-249 or EEI 11A
PIK-204	2/0	2/0	.419-.447	Gray	6	5-6	4	.183-.206	Blue	.840	B-249 or EEI 11A
PIK-202	2/0	2/0	.419-.447	Gray	4	3-4	2	.231-.258	Orange	.840	B-249 or EEI 11A
PIK-201	2/0	2/0	.419-.447	Gray	2	1-2	1/0	.292-.332	Red	.840	B-249 or EEI 11A
PIK-200	2/0	2/0	.419-.447	Gray	1/0	1/0	-	.373-.398	Yellow	.840	B-249 or EEI 11A
PIK-2020	2/0	2/0	.419-.447	Gray	2/0	2/0	-	.419-.447	Gray	.840	B-249 or EEI 11A
PIK-302	3/0	3/0	.470-.502	Black	4	3-4	2	.231-.258	Orange	.840	B-249 or EEI 11A
PIK-301	3/0	3/0	.470-.502	Black	2	1-2	1/0	.292-.332	Red	.840	B-249 or EEI 11A
PIK-300	3/0	3/0	.470-.502	Black	1/0	1/0	-	.373-.398	Yellow	.840	B-249 or EEI 11A
PIK-3020	3/0	3/0	.470-.502	Black	2/0	2/0	-	.419-.447	Gray	.840	B-249 or EEI 11A
PIK-3030	3/0	3/0	.470-.502	Black	3/0	3/0	-	.470-.502	Black	.840	B-249 or EEI 11A
PIK-402	4/0	4/0	.528-.563	Pink	4	3-4	2	.231-.258	Orange	.840	B-249 or EEI 11A
PIK-401	4/0	4/0	.528-.563	Pink	2	1-2	1/0	.292-.332	Red	.840	B-249 or EEI 11A
PIK-400	4/0	4/0	.528-.563	Pink	1/0	1/0	-	.373-.398	Yellow	.840	B-249 or EEI 11A
PIK-4020	4/0	4/0	.528-.563	Pink	2/0	2/0	-	.419-.447	Gray	.840	B-249 or EEI 11A
PIK-4030	4/0	4/0	.528-.563	Pink	3/0	3/0	-	.470-.502	Black	.840	B-249 or EEI 11A
PIK-4040	4/0	4/0	.528-.563	Pink	4/0	4/0	-	.528-.563	Pink	.840	B-249 or EEI 11A

TYPE CST AND CDT

Made of high conductivity copper—metal barrier separates conductor thereby eliminating strand cutting.
 Generous chamfer protects cable.
 For compressing, use one crimp with hydraulic tools.
 Three crimps with mechanical tools.



SINGLE TAB

Catalog Number	Side A	Wire Diameter Range	Side B	Wire Diameter Range	Die Sets for	
		in		in	Mechanical	Hydraulic
CST 301	6 Sol., 6 Str., 4 Sol.	.162-.204	8 Sol., 8 Str., 6 Sol. 6 Str., 4 Sol.	.128-.204	W-BG	U-BG or U-243
CST 302	4 Sol., 4 Str., 2 Sol.	.204-.258	6 Sol., 6 Str., 4 Sol. 4 Str., 2 Sol.	.162-.258	W-KK	U-243

DOUBLE TAB

CDT-399-8	6 Sol., 6 Str., 4 Sol.	.162-.204	8 Sol., 6 Str., 4 Sol.	.128-.204	W-BG	U-BG or U-243
CDT-398-8	4 Sol., 4 Str., 2 Sol.	.204-.258	4 Sol., 4 Str., 2 Sol.	.204-.258	W-KK	U-243
CDT-304-8 CDT-303-8	2 Str., 1 Str., 1/0 Str.	.292-.375	6 Sol., 4 Sol., 4 Str., 2 Sol. 2 Str., 1 Str., 1/0 Str.	.162-.258 .292-.375	O	O
CDT-308-8 CDT-307-8	2/0 Str., 4/0 Str.	.419-.528	2 Str., 1 Str., 1/0 Str. 2/0 Str., 4/0 Str.	.292-.375 .419-.528	D	D ₃

TYPE
KO-R

For any combination of aluminum, copper† or ACSR

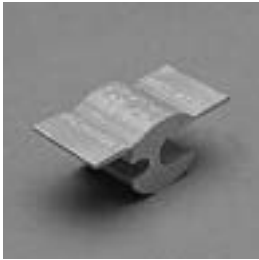

High Conductivity—Aluminum extrusions assure cool running high efficiency contacts.

Easy Crimping—Optimum temper for low handle load. Deep indent crimp lines for easy crimp location.

Pre-Loaded with oxide inhibitor in individual break-open boxes. CU to AL—Solid barrier provides conductor separation and prevents strand cutting. Also minimizes galvanic corrosion.

Weather-Protected—Full length tab provides complete enclosure for inhibitor, providing excellent weather protection.

STREET LIGHTING KO-R21 & 22

Double Tab Design—For making connections to street lights. Packed two per box.

MULTI-TAP CONNECTION KO-R24

Single Tab Design—For making one to four taps with one Press-On, and for making service connections.

Catalog Number	Size	Conductor Range	Wire Diameter Range in	Die Size
KO-R21	A B	4 Str.-4 ACSR 12 Sol.-10 Str.	.232-.257 .080-.117	5/8"-Nose
KO-R22	A B	6 Sol.-4 Sol. 12 Sol.-10 Str.	.162-.204 .080-.117	5/8"-Nose
KO-R24*	A B C	4 ACSR-2/0 Str 10 Str., 10 Sol., 6 Sol. 14 Sol., 10 Sol.	.257-.418 .101-.162 .064-.101	0

†Not Recommended for copper to copper applications.

*Single Tab "Press-On"

TYPE USEB-90

Comes complete with everything you require to splice USEB-90 cable, including connectors, heat shrinking tubing and installation instructions.

All kit components CSA Certified and UL listed.

Direct burial direct burial splice kits



Catalog Number

Kit Contains

2-USEB-90	2 of #2 Al/Cu Compression Sleeves, 1 of #4 Cu Compression Sleeve, 3 of Heat Shrink Tubing (Including overall jacket heat shrink tube)
1/0-USEB-90	2 of 1/0 Al/Cu Compression Sleeves, 1 of #3 Cu Compression Sleeve, 3 of Heat Shrink Tubing (Including overall jacket heat shrink tube)
2/0 USEB-90	2 of 2/0 Al/Cu Compression Sleeves, 1 of #2 Cu Compression Sleeve, 3 of Heat Shrink Tubing (Including overall jacket heat shrink tube)
4/0 USEB-90	2 of 4/0 Al/Cu Compression Sleeves, 1 of 1/0 Cu Compression Sleeve, 3 of Heat Shrink Tubing (Including overall jacket heat shrink tube)

See stuffer sheet for complete information on tooling.

TYPE **USEI-90**

Comes complete with everything you require to splice USEI-90 cable, including connectors, heat shrinking tubing and installation instructions.

Direct burial direct burial splice kits

All kit components CSA Certified and UL listed.



Triplexed Conductors - Reduced Neutral

Catalog Number	Kit Contains
USEI-2-1R	2 of #2 Al/Cu Compression Sleeves, 1 of #4 Al/Cu Compression Sleeves, 3 of Heat Shrink Tubing
USEI-1/0-1R	2 of 1/0 Al/Cu Compression Sleeves, 1 of #2 Al/Cu Compression Sleeves, 3 of Heat Shrink Tubing
USEI-4/0-1R	2 of 4/0 Al/Cu Compression Sleeves, 1 of 2/0 Al/Cu Compression Sleeves, 3 of Heat Shrink Tubing

Triplexed Conductors - Full Neutral

Catalog Number	Kit Contains
USEI-2-1F	3 of #2 Al/Cu Compression Sleeves, 3 of Heat Shrink Tubing
USEI-1/0-1F	2 of 1/0 Al/Cu Compression Sleeves, 3 of Heat Shrink Tubing
USEI-4/0-1F	2 of 4/0 Al/Cu Compression Sleeves, 3 of Heat Shrink Tubing

Quadruplexed Conductors - Reduced Neutral

Catalog Number	Kit Contains
USEI-2-3R	3 of #2 Al/Cu Compression Sleeves, 1 of #4 Al/Cu Compression Sleeves, 4 of Heat Shrink Tubing
USEI-1/0-3R	3 of 1/0 Al/Cu Compression Sleeves, 1 of #2 Al/Cu Compression Sleeves, 4 of Heat Shrink Tubing
USEI-4/0-3R	3 of 4/0 Al/Cu Compression Sleeves, 1 of 2/0 Al/Cu Compression Sleeves, 4 of Heat Shrink Tubing

See stuffer sheet for complete information on tooling.

TYPE ILSCONS

Features

- Color coded
- Funnel Entry
- Manufactured from high strength copper alloy
- Electro-tin plated
- Vinyl insulation
- Packaged in convenient small quantities
- UL Listed and CSA Certified for 600 volts, 90°C

Benefits

- Provides easy wire range identification
#22-16 AWG Red
#16-14 AWG Blue
#12-10 AWG Yellow
- Provides maximum conductivity
- Provides low contact resistance
- Provides tough pliable insulative qualities to protect connectors and wire from corrosion as well as providing some strain relief
- Attractive resealable packaging designed for merchandise racks
- Ensures reliability for copper conductor

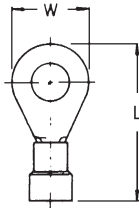

Catalog Number	Wire Range	Stud Size	Dimensions		Maximum Wire Insulated Diameter	Connector Type
			L	W		
44201-B100	16-22	6	.764	.26	.145	Vinyl Insulated Ring Terminals (Expanded)
44201-B1000	16-22	6	.764	.26	.145	Vinyl Insulated Ring Terminals (Expanded)
44203-B100	18-22	10	.819	.315	.145	Vinyl Insulated Ring Terminals (Expanded)
44203-B1000	18-22	10	.819	.315	.145	Vinyl Insulated Ring Terminals (Expanded)
44211-B100	14-16	6	.764	.26	.175	Vinyl Insulated Ring Terminals (Expanded)
44211-B1000	14-16	6	.764	.26	.175	Vinyl Insulated Ring Terminals (Expanded)
44213-B100	14-16	10	.858	.335	.175	Vinyl Insulated Ring Terminals (Expanded)
44213-B1000	14-16	10	.858	.335	.175	Vinyl Insulated Ring Terminals (Expanded)
44214-B100	14-16	1/4	1.055	.472	.175	Vinyl Insulated Ring Terminals (Expanded)
44214-B1000	14-16	1/4	1.055	.472	.175	Vinyl Insulated Ring Terminals (Expanded)
44222-B50	10-12	10	1.047	.374	.255	Vinyl Insulated Ring Terminals (Expanded)
44222-B500	10-12	10	1.047	.374	.255	Vinyl Insulated Ring Terminals (Expanded)
44223-B50	10-12	1/4	1.167	.472	.255	Vinyl Insulated Ring Terminals (Expanded)
44223-B500	10-12	1/4	1.167	.472	.255	Vinyl Insulated Ring Terminals (Expanded)
44224-B50	10-12	3/8	1.339	.591	.255	Vinyl Insulated Ring Terminals (Expanded)
44224-B500	10-12	3/8	1.339	.591	.255	Vinyl Insulated Ring Terminals (Expanded)

Can be supplied in bulk. Consult factory for part number.

Other sizes available on request. Contact factory for pricing.

TYPE ILSCONS

Features

- Color coded
- Funnel Entry
- Manufactured from high strength copper alloy
- Electro-tin plated
- Vinyl insulation
- Packaged in convenient small quantities
- UL Listed and CSA Certified for 600 volts, 90° C

Benefits

- Provides easy wire range identification
#22-16 AWG Red
#16-14 AWG Blue
#12-10 AWG Yellow
- Provides maximum conductivity
- Provides low contact resistance
- Provides tough pliable insulative qualities to protect connectors and wire from corrosion as well as providing some strain relief
- Attractive resealable packaging designed for merchandise racks
- Ensures reliability for copper conductor

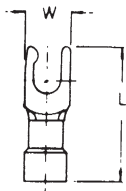

Catalog Number	Wire Range	Stud Size	Dimensions		Maximum Wire Insulated Diameter	Connector Type
			L	W		
44501-B100	16-22	6	.835	.252	.145	Vinyl Insulated Spade Terminals (Expanded)
44501-B1000	16-22	6	.835	.252	.145	Vinyl Insulated Spade Terminals (Expanded)
44503-B100	16-22	10	.835	.335	.145	Vinyl Insulated Spade Terminals (Expanded)
44503-B1000	16-22	10	.835	.335	.145	Vinyl Insulated Spade Terminals (Expanded)
44511-B100	14-16	6	.827	.236	.175	Vinyl Insulated Spade Terminals (Expanded)
44511-B1000	14-16	6	.827	.236	.175	Vinyl Insulated Spade Terminals (Expanded)
44513-B100	14-16	10	.827	.319	.175	Vinyl Insulated Spade Terminals (Expanded)
44513-B1000	14-16	10	.827	.319	.175	Vinyl Insulated Spade Terminals (Expanded)
44522-B50	10-12	10	1.004	.354	.255	Vinyl Insulated Spade Terminals (Expanded)
44522-B500	10-12	10	1.004	.354	.255	Vinyl Insulated Spade Terminals (Expanded)

Can be supplied in bulk. Consult factory for part number.

Other sizes available on request. Contact factory for pricing.

TYPE ILSCONS

Features

- Color coded
- Funnel Entry
- Manufactured from high strength copper alloy
- Electro-tin plated
- Silver solder brazed seam
- Vinyl insulation
- Packaged in convenient small quantities
- UL Listed and CSA Certified for 600 volts, 90°C

Benefits

- Provides easy wire range identification
- #22-16 AWG Red
- #16-14 AWG Blue
- #12-10 AWG Yellow
- Provides maximum conductivity
- Provides low contact resistance
- May be crimped anywhere and will not split open, even under extreme operating stresses
- Provides tough pliable insulative qualities to protect connectors and wire from corrosion as well as providing some strain relief
- Attractive resealable packaging designed for merchandise racks
- Ensures reliability for copper conductor

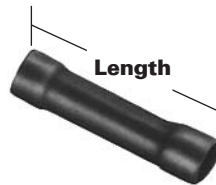

Catalog Number	Wire Range	Length	Maximum Wire Insulated Diameter	Connector Type
44900-B100	16-22	.953	.145	Expanded Vinyl Insulated Butt Splices
44900-B1000	16-22	.953	.145	Expanded Vinyl Insulated Butt Splices
44910-B100	14-16	.953	.175	Expanded Vinyl Insulated Butt Splices
44910-B1000	14-16	.953	.175	Expanded Vinyl Insulated Butt Splices
44920-B50	10-12	1.024	.255	Expanded Vinyl Insulated Butt Splices
44920-B500	10-12	1.024	.255	Expanded Vinyl Insulated Butt Splices

Can be supplied in bulk. Consult factory for part number.

Other sizes available on request. Contact factory for pricing.

TYPE ILSCONS

Features

- Color coded
- Funnel Entry
- Manufactured from high strength copper alloy
- Electro-tin plated
- Silver solder brazed seam
- Vinyl insulation
- Packaged in convenient small quantities
- Insulated connectors are rated for 600 volts, 90°C

Benefits

- Provides easy wire range identification
#22-16 AWG Red
#16-14 AWG Blue
#12-10 AWG Yellow
- Provides maximum conductivity
- Provides low contact resistance
- May be crimped anywhere and will not split open, even under extreme operating stresses
- Provides tough pliable insulative qualities to protect connectors and wire from corrosion as well as providing some strain relief
- Attractive resealable packaging designed for merchandise racks
- Ensures reliability for copper conductor



Catalog Number	Wire Range	Nema Tab	Length	Maximum Wire Insulated Diameter	Connector Type	Description
45100-B100	16-22	.032 x .250	.807	.145	Female	Vinyl Insulated Disconnects
45100-B1000	16-22	.032 x .250	.807	.145	Female	Vinyl Insulated Disconnects
45101-B1000	16-22	.032 x .250	.827	.145	Male	Vinyl Insulated Disconnects
45101-B10000	16-22	.032 x .250	.827	.145	Male	Vinyl Insulated Disconnects
45110-B100	14-16	.032 x .250	.807	.175	Female	Vinyl Insulated Disconnects
45110-B1000	14-16	.032 x .250	.807	.175	Female	Vinyl Insulated Disconnects
45111-B100	14-16	.032 x .250	.827	.175	Male	Vinyl Insulated Disconnects
45111-B1000	14-16	.032 x .250	.827	.175	Male	Vinyl Insulated Disconnects
45120-B50	10-12	.032 x .250	.925	.255	Female	Vinyl Insulated Disconnects
45120-B500	10-12	.032 x .250	.925	.255	Female	Vinyl Insulated Disconnects
45121-B50	10-12	.032 x .250	.945	.255	Male	Vinyl Insulated Disconnects
45121-B500	10-12	.032 x .250	.945	.255	Male	Vinyl Insulated Disconnects

Can be supplied in bulk. Consult factory for part number .

Other sizes available on request. Contact factory for pricing.



CABLE TIES



TYPE

93000 SERIES

IlSCO ties are an excellent quality cable tie and meet U.S. military specifications MIL-S-23190 and MS-3367.

Standard Cable Ties

CAT. NO.	PKG. QTY.	COLOUR	TENSILE STRENGTH	LENGTH	WIDTH	BUNDLE DIAMETER
93110-B100	100	NATURAL	18 LBS.	4.0"	0.10"	.75"
93110-B1000	1000	NATURAL	18 LBS.	4.0"	0.10"	.75"
93210-B100	100	UV BLACK	18 LBS.	4.0"	0.10"	.75"
93210-B1000	1000	UV BLACK	18 LBS.	4.0"	0.10"	.75"
93120-B100	100	NATURAL	40 LBS.	5.7"	0.14"	1.25"
93120-B1000	1000	NATURAL	40 LBS.	5.7"	0.14"	1.25"
93220-B100	100	UV BLACK	40 LBS.	5.7"	0.14"	1.25"
93220-B1000	1000	UV BLACK	40 LBS.	5.7"	0.14"	1.25"
93130-B100	100	NATURAL	50 LBS.	8"	0.19"	2.0"
93130-B1000	1000	NATURAL	50 LBS.	8"	0.19"	2.0"
93230-B100	100	UV BLACK	50 LBS.	8"	0.19"	2.0"
93230-B1000	1000	UV BLACK	50 LBS.	8"	0.19"	2.0"
93150-B100	100	NATURAL	50 LBS.	11.8"	0.19"	3.0"
93150-B1000	1000	NATURAL	50 LBS.	11.8"	0.19"	3.0"
93250-B100	100	UV BLACK	50 LBS.	11.8"	0.19"	3.0"
93250-B1000	1000	UV BLACK	50 LBS.	11.8"	0.19"	3.0"
93160-B100	100	NATURAL	50 LBS.	14.6"	0.19"	4.0"
93160-B1000	1000	NATURAL	50 LBS.	14.6"	0.19"	4.0"
93260-B100	100	UV BLACK	50 LBS.	14.6"	0.19"	4.0"
93260-B1000	1000	UV BLACK	50 LBS.	14.6"	0.19"	4.0"
93170-B100	100	NATURAL	120 LBS.	14.5"	0.30"	4.0"
93170-B500	500	NATURAL	120 LBS.	14.5"	0.30"	4.0"
93270-B100	100	UV BLACK	120 LBS.	14.5"	0.30"	4.0"
93270-B500	500	UV BLACK	120 LBS.	14.5"	0.30"	4.0"
93185-B100	100	NATURAL	120 LBS.	28"	0.30"	8.0"
93185-B500	500	NATURAL	120 LBS.	28"	0.30"	8.0"
93285-B100	100	UV BLACK	120 LBS.	28"	0.30"	8.0"
93285-B500	500	UV BLACK	120 LBS.	28"	0.30"	8.0"

Heavy Duty Cable Ties

CAT. NO.	PKG. QTY.	COLOUR	TENSILE STRENGTH	LENGTH	WIDTH	BUNDLE DIAMETER
93180-B100	100	NATURAL	175 LBS.	25.0"	0.35"	7.0"
93280-B100	100	UV BLACK	175 LBS.	25.0"	0.35"	7.0"
93195-B50	50	NATURAL	175 LBS.	36.5"	0.35"	10.7"
93295-B50	50	UV BLACK	175 LBS.	36.5"	0.35"	10.7"
93199-B50	50	NATURAL	175 LBS.	48.0"	0.35"	15.0"
93299-B50	50	UV BLACK	175 LBS.	48.0"	0.35"	15.0"

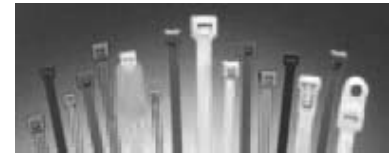

TYPE

93000 SERIES

IlSCO ties are an excellent quality cable tie and meet U.S. military specifications MIL-S-23190 and MS-3367.

Super Heavy Duty Cable Ties

CAT. NO.	PKG. QTY	COLOUR	TENSILE STRENGTH	LENGTH	WIDTH	BUNDLE DIAMETER
93190-B100	100	NATURAL	250 LBS.	22.0"	0.50"	6.0"
93290-B100	100	UV BLACK	250 LBS.	22.0"	0.50"	6.0"
93196-B100	100	NATURAL	250 LBS.	34.0"	0.50"	10.1"
93296-B100	100	UV BLACK	250 LBS.	34.0"	0.50"	10.1"

Colored Cable Ties

CAT. NO.	PKG. QTY	COLOUR	TENSILE STRENGTH	LENGTH	WIDTH	BUNDLE DIAMETER
93110-R-B100	100	RED	18 LBS.	4.0"	0.10"	.75"
93230-R-B100	100	RED	50 LBS.	8"	0.19"	2.0"
93110-GR-B100	100	GREEN	18 LBS.	4.0"	0.10"	.75"
93230-GR-B100	100	GREEN	50 LBS.	8"	0.19"	2.0"
93110-Y-B100	100	YELLOW	18 LBS.	4.0"	0.10"	.75"
93230-Y-B100	100	YELLOW	50 LBS.	8"	0.19"	2.0"
93110-BL-B100	100	BLUE	18 LBS.	4.0"	0.10"	.75"
93230-BL-B100	100	BLUE	50 LBS.	8"	0.19"	2.0"
93110-OR-B100	100	ORANGE	18 LBS.	4.0"	0.10"	.75"
93230-OR-B100	100	ORANGE	50 LBS.	8"	0.19"	2.0"

Mounting Head Cable Ties

CAT. NO.	PKG. QTY	COLOUR	TENSILE STRENGTH	LENGTH	WIDTH	BUNDLE DIAMETER
93310-B100	100	NATURAL	18 LBS.	4.5"	.10"	.62"
93410-B100	100	UV BLACK	18 LBS.	4.5"	.10"	.62"
93320-B100	100	NATURAL	40 LBS.	5.9"	.14"	1.25"
93420-B100	100	UV BLACK	40 LBS.	5.9"	.14"	1.25"
93341-B100	100	NATURAL	50 LBS.	8"	.19"	2"
93441-B100	100	UV BLACK	50 LBS.	8"	.19"	2"
93350-B100	100	NATURAL	50 LBS.	12.6"	.19"	3"
93450-B100	100	UV BLACK	50 LBS.	12.6"	.19"	3"
93380-B100	100	NATURAL	50 LBS.	15"	.19"	4"
93480-B100	100	UV BLACK	50 LBS.	15"	.19"	4"
93390-B100	100	NATURAL	120 LBS.	15"	.30"	4"
93490-B100	100	UV BLACK	120 LBS.	15"	.30"	4"

Push Mount Cable Ties

CAT. NO.	PKG. QTY	COLOUR	TENSILE STRENGTH	LENGTH	WIDTH	BUNDLE DIAMETER
93345-B100	100	NATURAL	50 LBS.	7.9"	.19"	2"
93445-B100	100	UV BLACK	50 LBS.	7.9"	.19"	2"

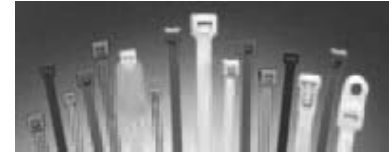

TYPE

93000 SERIES

IlSCO ties are an excellent quality cable tie and meet U.S. military specifications MIL-S-23190 and MS-3367.

Releasable Cable Ties

CAT. NO.	PKG. QTY.	COLOUR	TENSILE STRENGTH	LENGTH	WIDTH	BUNDLE DIAMETER
93620-B100	100	NATURAL	50 LBS.	5.9"	.30"	1.2"
93720-B100	100	UV BLACK	50 LBS.	5.9"	.30"	1.2"
93640-B100	100	NATURAL	50 LBS.	7.8"	.30"	2"
93740-B100	100	UV BLACK	50 LBS.	7.8"	.30"	2"
93650-B100	100	NATURAL	50 LBS.	10.5"	.30"	3"
93750-B100	100	UV BLACK	50 LBS.	10.5"	.30"	3"

In-line Cable Ties

CAT. NO.	PKG. QTY.	COLOUR	TENSILE STRENGTH	LENGTH	WIDTH	BUNDLE DIAMETER
93794-B100	100	UV BLACK	50 LBS.	7.2"	0.35"	1.7"
93795-B100	100	UV BLACK	50 LBS.	10.5"	0.35"	2.7"
93796-B100	100	UV BLACK	50 LBS.	14.1"	0.35"	3.7"

Stainless Steel Cable Ties

CAT. NO.	PKG. QTY.	COLOUR	TENSILE STRENGTH	LENGTH	WIDTH	BUNDLE DIAMETER
93804-B100	100	SS Steel	100	8"	.18"	2"
93808-B100	100	302/304	100	14"	.18"	4"
93812-B100	100	302/304	100	20"	.18"	6"
93805-B100	100	SS Steel	100	8"	.30"	2"
93809-B100	100	302/304	100	14"	.30"	4"
93813-B100	100	302/304	100	20"	.30"	8"

Mounting Bases

CAT. NO.	COLOUR	LENGTH	WIDTH	HEIGHT	HOLE SIZE	SLOT SIZE	PKG. QTY
93511-B100	NATURAL	.75"	.75"	.205"	# 6	.05"	100
93513-B100	UV BLACK	.75"	.75"	.205"	# 6	.05"	100
93510-B100	NATURAL	1.0"	1.0"	.215"	# 8	.07"	100
93512-B100	UV BLACK	1.0"	1.0"	.215"	# 8	.07"	100
93514-B100	NATURAL	12.0"	2.0"	300"	# 6 & # 8	.30"	100
93515-B100	UV BLACK	12.0"	2.0"	300"	# 6 & # 8	.30"	100

TYPE

27100 - 27600 SERIES

High-Ratio Heavy Wall Heat Shrink Tubing With Sealant



Extremely versatile 6:1 shrink ratio can accommodate a wide variety of connector shapes and configurations. Rigid heavy wall and thermoplastic adhesive lining provides a gas-tight, water-tight seal for the toughest applications.

48" Length	12" Length	6" Length	I.D. IN INCHES		COLOUR	WIRE RANGE	MAX. WALL THICKNESS
			EXP.	REC.			
27100-48	27100-12	27100-6	.750	.125	BLACK	14-1 GA.	.123
27101-48	27101-12	27101-6	1.30	.220	BLACK	8-4/0	.135
27102-48	27102-12	27102-6	1.75	.290	BLACK	2-750MCM	.140
27103-48	27103-12	27103-6	2.00	.330	BLACK	1/0-1000MCM	.170
27104-48	27104-12	27104-6	2.75	.460	BLACK	3/0-1200MCM	.190
27105-48	27105-12	27105-6	3.50	.673	BLACK	500-1300MCM	.170

Please contact factory for additional cut lengths of any size.

High-Ratio Dual Wall Heat Shrink Tubing with Sealant: Black



UL File-E85381
MIL-DTL-23053/4, Class 3

Extremely versatile 4:1 shrink ratio can accommodate a wide variety of connector shapes and configurations. Semi-rigid flame retardant tubing that shrinks to 25% of its original size.

48" Length	12" Length	6" Length	I.D. IN INCHES		WIRE RANGE	MAX. WALL THICKNESS
			EXP.	REC.		
27601-48	27601-12	27601-6	.225	.050	28-12 GA.	.047
27602-48	27602-12	27602-6	.293	.065	20-8 GA.	.060
27603-48	27603-12	27603-6	.427	.095	14-4 GA.	.075
27604-48	27604-12	27604-6	.700	.175	12-1/0	.095

Please contact factory for additional cut lengths of any size.

High-Ratio Dual Wall Heat Shrink Tubing with Sealant: Clear



UL File-E85381
MIL-DTL-23053/4, Class 3

Extremely versatile 4:1 shrink ratio can accommodate a wide variety of connector shapes and configurations. Clear semi-rigid tubing that allows for visual inspection of underlying material.

48" Length	12" Length	6" Length	I.D. IN INCHES		WIRE RANGE	MAX. WALL THICKNESS
			EXP.	REC.		
27601C-48	27601C-12	27601C-6	.225	.050	28-12 GA.	.047
27602C-48	27602C-12	27602C-6	.293	.065	20-8 GA.	.060
27603C-48	27603C-12	27603C-6	.427	.095	14-4 GA.	.075
27604C-48	27604C-12	27604C-6	.700	.175	12-1/0	.095

Please contact factory for additional cut lengths of any size.

TYPE

27200 - 27800 SERIES

Heavy Wall Heat Shrink Tubing - Railless Repair Sleeves With Sealant



A wraparound 3:1 shrink ration insulation that easily installs in repair or splice applications. No need to shut down equipment or disconnect electrical connection to environmentally protect applicaiton.

36" Length	12" Length	I.D. IN INCHES		COLOUR	WIRE RANGE	MAX. WALL THICKNESS
		EXP.	REC.			
27201-36	27201-12	1.20	.240	BLACK	8-3/0	.080
27202-36	27202-12	1.80	.600	BLACK	2/0-400MCM	.080
27203-36	27203-12	2.70	.950	BLACK	400-1000MCM	.080
27204-36	27204-12	3.60	1.30	BLACK	1000-2000MCM	.080
27205-36	27205-12	4.95	1.65	BLACK	Multiple Conductor	.080
27206-36	27206-12	6.75	2.50	BLACK	Multiple Conductor	.080

Semi-Rigid Dual Wall Heat Shrink Tubing With Meltable Inner Wall: Colour Coded



Provides effective method of colour coding electrical harness to industry standard.
Semi-Rigid 2.5:1 ratio.



UL File-E157227
MIL-DTL-23053/4, Class 1

COLOUR-CODED BY SIZE

48" Length	12" Length	6" Length	I.D. IN INCHES		COLOUR	WIRE RANGE	MAX. WALL THICKNESS
			EXP.	REC.			
27804BR-48	27804BR-12	27804BR-6	1/8 (.125)	.030	BROWN	26-18 GA.	.036
27805GY-48	27805GY-12	27805GY-6	3/16 (.187)	.060	GRAY	22-16 GA.	.043
27806W-48	27806W-12	27806W-6	1/4 (.250)	.080	WHITE	16-12 GA.	.047
27808R-48	27808R-12	27808R-6	3/8 (.375)	.130	RED	12-8 GA.	.050
27809BL-48	27809BL-12	27809BL-6	1/2 (.500)	.195	BLUE	8-4 GA.	.055
27810Y-48	27810Y-12	27810Y-6	3/4 (.750)	.313	YELLOW	4-1/0	.065
27811-48	27811-12	27811-6	1 (1.00)	.400	BLACK	2-4/0	.075

Additional cut lengths are available in all sizes. Consult factory for details.

TYPE

27095 - 29095 - 28005 KITS

27095 - Heavy Wall Heat Shrink Tubing Kit



An assortment of our most popular MIL-SPEC heavy wall sizes and colours. Handy plastic case keeps your tubing organized and stores easily.



CSA File-AP100973-1 C22.2 No. 198.2
UL File-E157227 UL 486 B&D
MIL-DTL-23053/4, Class 1

QUANTITY	ITEM	COLOUR	I.D. IN INCHES	
			EXP.	REC.
10	21106	BLACK	.400	.150
10	21806	RED	.400	.150
4	21206	BLACK	.750	.220
4	21306	RED	.750	.220
4	21406	BLACK	1.10	.375
4	21506	RED	1.10	.375

29095 - Dual Wall Heat Shrink Tubing Kit



An assortment of our most popular dual wall sizes and colours. Handy plastic case keeps your tubing organized and stores easily.

MIL-DTL-23053/4, Class 3

QUANTITY	ITEM	COLOUR	I.D. IN INCHES	
			EXP.	REC.
25	29006-6	BLACK	.250	.080
25	29006R-6	RED	.250	.080
15	29008-6	BLACK	.375	.125
15	29008R-6	RED	.375	.125
10	29009-6	BLACK	.500	.160
10	29009R-6	RED	.500	.160
5	29010-6	BLACK	.750	.320
5	29010R-6	RED	.750	.320

28005 - Thin Wall Heat Shrink Tubing Kit



An assortment of our most popular thin wall sizes and colours. Handy plastic case keeps your tubing organized and stores easily.



UL-224-VW-1

QUANTITY	ITEM	COLOUR	I.D. IN INCHES		MAX. WALL THICKNESS
			EXP.	REC.	
30	26005-6	BLACK	3/16 (.187)	.093	.020
28	26006W -6	WHITE	1/4 (.250)	.125	.025
20	26008R-6	RED	3/8 (.375)	.125	.025
14	26009-6	BLACK	1/2 (.500)	.250	.025
6	26010W -6	WHITE	3/4 (.750)	.375	.035

TYPE

94000 SERIES

94600 Power Torch



The most successful tool available in the transportation and industrial markets. This durable tool provides a dependable and powerful heat source for almost any application where a controlled flame is required. No shop should be without it. Features include:

- **Brass and Steel Construction** no tool is tougher
- **Dual Gas and Air Flame Controls** adjust temperature and flame precision to fit your application
- **2500°F Torch output** one tool for every job
- **Safety Lock** unique safety lock prevents accidents
- **Removable Base** for safe hands-free operation in both the vertical and horizontal position

Specifications:

Length 3.9 in. (100mm)
Width 1.4 in. (36mm)
Height (w/o stand) 5.4 in. (138mm)
Weight (gas filled) 9.88 oz. (280g)
Tank Capacity 2.03 fl. oz. (60ml)
Operating Time (one tank) up to 220 min.
Color Black

94905 Power Torch



The latest and most powerful butane torch yet, the heavy duty 94905 is equipped for the most demanding jobs. The best there is in high output butane tools, the ribbed aluminum body with ergonomic grip provide a light, but extremely durable tool. Leave your cumbersome propane setup at the shop. This compact tool does it all. Features include:

- **Waterproof Piezo Electronic Ignition** dependable ignition in any condition
- **Wind Resistant** constant flame in the most extreme environments
- **High BTU Torch Output** propane power in a portable easily refillable tool
- **Broad Base** for safe hands-free operation

94902 Power Torch



Lightweight version of the more powerful 94905 this tool provides compact durability and affordable versatility. Constructed of hi-tech polymers, brass, and ceramic parts that ensure precise performance and long operating life. Features include:

- **Waterproof Piezo Electronic Ignition** dependable ignition in any condition
- **Wind Resistant** High BTU Flame adjustable for medium duty tasks
- **2500°F Torch Output** lightweight but powerful
- **Ergonomic Hand Grip** for hours of comfortable operation
- **Broad Base** for safe hands-free operation

Specifications:

Length 3.9 in. (100mm)
Grip Dia. 1.34 in. (34mm)
Base Dia. 2.36 in. (60mm)
Height (w/o stand) 5.47 in. (139mm)
Weight (w/o fuel) 5.12 oz. (145g)
Tank Capacity 0.68 fl. oz. (20ml)
Operating Time (one tank) approx. 60 min. mid-setting
Color Blue

TYPE

94940 - 94700

94940 Ultra Shrink Jet



The high output flameless heat gun designed for industrial applications where versatility and power are a must. The flameless tool is safe to use in environments where vapors may be present or flames are prohibited. Included deflector attachment evenly distributes heat making heat shrink tubing installation faster. Leave the extension cords behind with this portable ergonomic heat tool.

Features include:

- **Automatic Piezo Ignition System**
- **Deflector & Stand Attachments** circulates heat evenly and provides safe hands-free option
- **1400° F Hot Output** the best tool for heavy duty flameless applications

Specifications:

Length (with soldering tip) 7.5 in. (190mm)
Weight (w/o fuel) 4.77 oz. (135g)
Tank Capacity 1.29 fl. oz. (38ml)
Operating Time (one tank) 200 min. at mid-setting
Color Blue



94700 Shrink Jet



IlSCO's most successful compact heat tool provides up to a 1300°F flameless heat source that is safe to use in environments where vapors may be present or flames are prohibited. The perfect tool for heat shrink terminal kits or heat shrink tubing assortments it's one of our best performers.

Features include:

- **Automatic Piezo Ignition System** water & wind resistant for a dependable light anywhere
- **1300°F Flameless Heat** safe and durable
- **Refillable Fuel Cell** use it over and over

Specifications:

Length 1 in. (25mm)
Width 3.2 in. (80mm)
Height 4.5 in. (115mm)
Weight (with fuel) 3.35 oz. (95g)
Operating Time (one tank) approx. 20 min.
Color Black



Cat No: 94701 - Replacement Fuel Cartridge

TYPE

94800 - 94900

94800 Micro Jet



The perfect tool for heat shrink terminal kits or heat shrink tubing assortments the 94800 provides an affordable compact heat tool.

Features include:

- **Automatic Piezo Ignition System** water & wind resistant for a dependable light anywhere
- **2500°F Torch Output** safe and durable
- **Compact & Powerful** thousands of everyday applications
- **Refillable Fuel Cell** use it over and over

Specifications:

Length 1 in. (25mm)
Width 2.6 in. (65mm)
Height 4.3 in. (110mm)
Weight (with fuel) 2.12 oz. (60g)
Operating Time (one gas fill) approx. 20 min.
Color Black

Cat No: 94701 – Replacement Fuel Cartridge

94900 Turbo Lite II



This small but versatile heat tool provides a 2400°F pinpoint blue flame that can easily handle applications such as heat shrink terminals and heat shrink tubing. Perfect for kits and promotional giveaways this tool is always a customer favorite.

Features Include:

- **Piezo Waterproof /Windproof Ignition System** wet & windy environments are no problem
- **Convenient Twist Flame Adjustment** set the flame the way you want it
- **Refillable Translucent Fuel Tank** takes the guess work out of when to refill
- **Compact & Powerful** thousands of everyday applications

Specifications:

Length 1.4 in. (35mm)
Width 0.8 in. (20mm)
Height 2.8 in. (71mm)
Weight (with fuel) 1.62 oz. (46g)
Operating Time (one gas fill) approx. 25 min.
Color Charcoal

TYPE

99000 SERIES

Wrap 'N Seal silicone tape self fuses and cures in 24 hours to form a permanent moisture seal. It has no adhesive lining leaving the application clean with no sticky residue. A centre ridge acts as a guide when wrapping for a uniform and straight application. It is ideal for high temperature applications.



CAT NO.	COLOUR	WIDTH	LENGTH	THICKNESS	PKG. QTY.
99200	WHITE	1"	20'	20mil	1
99201	RED	1"	20'	20mil	1
99202	BLACK	1"	20'	20mil	1
99205	GREEN	1"	20'	20mil	1
99206	BLUE	1"	20'	20mil	1
99207	YELLOW	1"	20'	20mil	1
99211	GRAY	1"	20'	20mil	1
99212	ORANGE	1"	20'	20mil	1
99208	CLEAR	1"	20'	20mil	1
99209	GLOW-IN-DARK	1"	20'	20mil	1

Specifications:

Operating Temperature	-65° F to +500° F
Dielectric Strength	400 volts per mil (vpm)
Tensile Strength	700 psi
Elongation	300%
MIL-SPEC	Meets MIL-I-46852C Type II Standard

Burndy	IlSCO
ES25A25A	PIK-00
ES25A2R	PIK-01
ES25A4R	PIK-02
ES25A6R	PIK-04
ES2R2R	PIK-11
ES2R4R	PIK-12
ES2R6R	PIK-14
ES2R8R	PIK-16
ES4R4R	PIK-22
ES4R6R	PIK-24
ES4R8R	PIK-26
ES6R6R	PIK-44
ES6R8R	PIK-46
ES8R8R	PIK-66
GAR1126	GPL-2
GAR1129	GPL-3
GAR114C	GPL-1
GAR1426	GPL-9
GAR1429	GPL-10
GAR144C	GPL-8
GAR1526	GPL-15
GAR1529	GPL-16
GAR1534	GPL-17
GAR154C	GPL-14
GAR1626	GPL-21
GAR1629	GPL-22
GAR1634	GPL-23
GAR164C	GPL-20
GAR1726	GPL-27
GAR1729	GPL-28
GAR1734	GPL-29
GAR174C	GPL-26
GAR1826	GPL-33
GAR1829	GPL-34
GAR1834	GPL-35
GAR184C	GPL-32
GAR1926	GPL-39
GAR1929	GPL-40
GAR1934	GPL-41
GAR194C	GPL-38
GAR2026	GPL-45
GAR2029	GPL-46
GAR2034	GPL-47
GAR204C	GPL-44
GAR2126	GPL-51
GAR2129	GPL-52
GAR2134	GPL-53
GAR214C	GPL-50
GAR2226	GPL-57
GAR2229	GPL-58
GAR2234	GPL-59
GAR224C	GPL-56
GAR2426	GPL-69
GAR2429	GPL-70
GAR2434	GPL-71
GAR244C	GPL-68
GAR6426	GPL-5
GAR6429	GPL-6

Burndy	IlSCO
GAR6434	GPL-7
GAR644C	GPL-4
GB26	GM-2
GB29	GM-3
GB34	GM-4
GB4C	GM-1
GBM26	GMS-2
GBM29	GMS-3
GBM34	GMS-4
GBM4C	GMS-1
GC2626	GH-2
GC2929	GH-3
GC3434	GH-4
GC4C4C	GH-1
GCM26	GHS-2
GCM29	GHS-3
GCM34	GHS-4
GCM4C	GHS-1
GD1526	GU-2
GD1529	GU-3
GD154C	GU-1
GD1626	GU-5
GD1629	GU-6
GD164C	GU-4
GD1726	GU-8
GD1729	GU-9
GD174C	GU-7
GD1826	GU-11
GD1829	GU-12
GD1834	GU-13
GD184C	GU-10
GD1926	GU-15
GD1929	GU-16
GD1934	GU-17
GD194C	GU-14
GD2026	GU-20
GD2029	GU-21
GD2034	GU-22
GD2039	GU-23
GD204C	GU-19
GD2126	GU-26
GD2129	GU-27
GD2134	GU-28
GD214C	GU-25
GD2226	GU-32
GD2229	GU-33
GD2234	GU-34
GD224C	GU-31
GG15-1	GO-1
GG16-1	GO-2
GG17-1	GO-3
GG17-5	GO-4
GG18-1	GO-5
GG18-15	GO-6
GG18-2	GO-7
GG19-2	GO-8
GG19-25	GO-9
GG20-2	GO-10

Burndy	IlSCO
GG20-25	GO-11
GG20-3	GO-12
GG21-2	GO-13
GG21-25	GO-14
GG21-3	GO-15
GG22-2	GO-16
GG22-25	GO-17
GG22-3	GO-18
GG22-35	GO-19
GK1126	GR-2
GK114C	GR-1
GK1426	GR-9
GK144C	GR-6
GK1526	GR-14
GK1529	GR-15
GK1534	GR-16
GK154C	GR-13
GK1626	GR-20
GK1634	GR-22
GK164C	GR-19
GK1726	GR-26
GK1734	GR-28
GK174C	GR-25
GK1826	GR-32
GK1834	GR-34
GK184C	GR-31
GK1926	GR-38
GK1934	GR-40
GK194C	GR-37
GK2026	GR-44
GK2034	GR-46
GK204C	GR-43
GK2126	GR-50
GK214C	GR-49
GK2226	GR-61
GK2229	GR-62
GK224C	GR-60
GK6426	GR-5
GK6429	GR-6
GK644C	GR-4
GL2626	GJ-2
GL2929	GJ-3
GL3434	GJ-4
GL4C4C	GJ-1
GP1126	GT-2
GP1129	GT-3
GP114C	GT-1
GP1426	GT-9
GP1429	GT-10
GP144C	GT-8
GP1526	GT-14
GP1529	GT-15
GP154C	GT-13
GP1626	GT-19
GP1629	GT-20
GP1634	GT-21
GP164C	GT-18
GP1726	GT-25

Burndy	IlSCO
GP1729	GT-26
GP1734	GT-27
GP174C	GT-24
GP1826	GT-31
GP1829	GT-32
GP1834	GT-33
GP184C	GT-30
GP1926	GT-37
GP1929	GT-38
GP1934	GT-39
GP194C	GT-36
GP2026	GT-43
GP2029	GT-44
GP2034	GT-45
GP204C	GT-42
GP2126	GT-49
GP2129	GT-50
GP2134	GT-51
GP214C	GT-48
GP2229	GT-55
GP2234	GT-56
GP6426	GT-5
GP6429	GT-6
GP644C	GT-4
GZ26-12	GWL-4
GZ26-38	GWL-3
GZ29-12	GWL-6
GZ29-38	GWL-5
GZ29-58	GWL-7
GZ4C12	GWL-2
GZ4C38	GWL-1
K2C22B1	SCS-3A1
K2C23B1	SCS-4A1
K2C26B1	SCS-6A1
K2C28B1	SCS-8A1
K2F15	SDS-0
K2F17	SDS-1
K2F20	SDS-2
K2F22	SDS-3
K2F23	SDS-4
K2F25	SDS-5
K2F26	SDS-6
K2F28	SDS-8
K2F31	SDS-9
K2F34	SDS-10
K2F39	SDS-11
K2F44	SDS-12
KC15	SSS-0
KC15B1	SSS-0A1
KC17	SSS-1
KC17B1	SSS-1A1
KC20	SSS-2
KC20B1	SSS-2A1
KC22	SSS-3
KC22B1	SSS-3A1
KC23	SSS-4
KC23B1	SSS-4A1
KC25	SSS-5

Burndy	IlSCO
KC25B1	SSS-5A1
KC26	SSS-6
KC26B1	SSS-6A1
KC28	SSS-8
KC28B1	SSS-8A1
KC31	SSS-9
KC31B1	SSS-9A1
KC34	SSS-10
KC34B1	SSS-10A1
KC39	SSS-11
KC39B1	SSS-11A1
KC44	SSS-12
KC44B1	SSS-12A1
KF15	STS-0
KF17	STS-1
KF20	STS-2
KF22	STS-3
KF23	STS-4
KF25	STS-5
KF26	STS-6
KF28	STS-8
KF31	STS-9
KF34	STS-10
KF39	STS-11
KF44	STS-12
KS15	IK-8-C
KS17	IK-6-C
KS20	IK-4-C
KS22	IK-3-C
KS23	IK-2-C
KS25	IK-1/0-C
KS26	IK-2/0-C
KS27	IK-3/0-C
KS28	IK-250-C
KS29	IK-250-C
KS31	IK-350-C
KS34	IK-500-C
KS39	IK-750-C
KS40	IK-1000-C
KSU17	SK-6-C
KSU20	SK-4-C
KSU22	SK-3-C
KSU23	SK-2-C
KSU25	SK-1/0-C
KSU26	SK-2/0-C
KSU27	SK-3/0-C
KSU29	SK-250-C
KSU31	SK-350-C
KSU34	SK-500-C
QGFL1CB1	LSC-1E
QGFL1CBT6	LSC-1
QGFL26B1	LSN-2/0
QGFL26B1T6	LSN-2/0NE
QGFL26B2	LSN-2/0N
QGFL29B1	LSN-O25N
QGFL29B1T6	LSN-O25NE
QGFL31B1	LSN-O35N
QGFL31B1T6	LSN-O35NE

Burndy	Ilsco
QGFL34B1	LSN-O50N
QGFL34B1T6	LSN-O50NE
QGFL39B1	LSN-O75
QGFL39B1T6	LSN-O75E
QGFL44B1	LSN-100N
QGFL44B1T6	LSN-100N
QGFL46B1	LSN-150E
QGFL46B1T6	LSN-150E
QGFL48B1	LSN-200E
QGFL48B1T6	LSN-200E
QQGFL26B2	LDN-2/0N
QQGFL29B1	LDN-25N
QQGFL29B1T6	LDN-025NE
QQGFL31B1	LDN-35N
QQGFL31B1T6	LDN-035NE
YC26C26	CCT-2020
YC28C26	CCT-4020
YC28C28	ULT-12
YC2C2	ULT-7
YC2C4	ULT-6
YC4C4	ULT-5
YC4C6	ULT-4
YGHC26C2	ELT-4
YGHC26C26	ELT-2
YGHC29C26	ELT-5
YGHC29C29	ELT-3
YGHC2C2	ELT-1
YGHC34C29	ELT-6
YGHP29C2	GGC-2
YGHP29C26	GGC-3
YGHP29C29	GGC-4
YGHP2C2	GGC-1
YGHP34C2	GGC-5
YGHP34C26	GGC-6
YGHP34C29	GGC-7
YGHP34C34	GGC-8
YGHR26C34	RLT-4
YGHR26C58	RLT-3
YGHR29C34	RLT-7
YGHR29C58	RLT-6
YGL29C2	GGA-2
YGL29C29	GGA-3
YGL2C2	GGA-1
YGL34C2	GGA-4
YGL34C29	GGA-5
YGL34C34	GGA-6
YPC26R8U	KO-R24
YPC2A8U	KO-R21

T&B/Blackburn	Ilsco
54720	ULT-4
54730	ULT-5
54735	ULT-6
54755	CCT-2020
54755	ELT-2
54755	ELT-4
54765	CCT-4020
54765	ELT-3
54765	ULT-12
54770	ELT-5
54780	ELT-6
54855	GGC-2
54860	GGC-3
54875	GGC-1
54885	GGC-5
54890	GGC-6
54895	GGC-7
54900	GGC-8
1000M	IK-1000-C
10H	IK-1/0-C
10HPS	SK-1/0-C
1H	IK-2-C
1HPS	SK-2-C
20H	IK-2/0-C
20HPS	SK-2/0-C
2H	IK-3-C
2HPS	SK-3-C
30H	IK-3/0-C
350HPS	SK-250-C
350HPS	SK-350-C
350M	IK-350-C
40H	IK-250-C
40H	IK-250-C
40HPS	SK-3/0-C
4H	IK-4-C
4HPS	SK-4-C
500HPS	SK-500-C
500M	IK-500-C
54855L	GGA-1
54865CK	GGC-4
54865L	GGA-2
54875L	GGA-3
54885L	GGA-4
54895L	GGA-5
54900L	GGA-6
6H	IK-6-C
6HPS	SK-6-C
750M	IK-750-C
8H	IK-8-C
BC22	ULT-7
GH2-TB	GH-2
GH3-TB	GH-3
GHS2-TB	GHS-2
GHS3-TB	GHS-3
GM1-TB	GM-1
GM2-TB	GM-2
GM3-TB	GM-3
GMS1-TB	GMS-1

T&B/Blackburn	Ilsco
GMS2-TB	GMS-2
GMS3-TB	GMS-3
GR34-202	RLT-4
GR34-40250	RLT-7
GR58-202	RLT-3
GR58-40250	RLT-6
GR5-TB	GR-5
GR6-TB	GR-6
GT5-TB	GT-5
GT6-TB	GT-6
GU11-TB	GU-11
GU15-TB	GU-15
GU20-TB	GU-20
GU21-TB	GU-21
GU2-TB	GU-2
GU33-TB	GU-33
GU4-TB	GU-4
GU8-TB	GU-8
GUV11821	GPL-15
GUV1184	GPL-14
GUV13821	GPL-21
GUV13825	GPL-22
GUV1384	GPL-20
GUV15821	GPL-27
GUV15825	GPL-28
GUV1584	GPL-26
GUV2021	GPL-33
GUV2025	GPL-34
GUV204	GPL-32
GUV21221	GPL-39
GUV21225	GPL-40
GUV3021	GPL-45
GUV3025	GPL-46
GUV31221	GPL-51
GUV4021	GPL-57
GUV4025	GPL-58
GUV5281	GPL-5
GUV5825	GPL-6
GUV584	GPL-4
GUV7821	GPL-9
GUV7825	GPL-10
GUV784	GPL-8
GWL1-TB	GWL-1
GWL2-TB	GWL-2
GWL3-TB	GWL-3
ICS-61	PIK-66
ICS-63	PIK-46
ICS-64	PIK-44
ICS-66	PIK-26
ICS-67	PIK-24
ICS-68	PIK-22
ICS-70	PIK-16
ICS-71	PIK-14
ICS-72	PIK-12
ICS-73	PIK-11
ICS-75	PIK-04
ICS-76	PIK-02
ICS-77	PIK-01

T&B/Blackburn	Ilsco
ICS-78	PIK-00
IKL35	PIK-01R
IKL36	PIK-00R
IKL44	PIK-202
IKL45	PIK-201
IKL46	PIK-200
IKL47	PIK-2020
IKL54	PIK-302
IKL55	PIK-301
IKL56	PIK-300
IKL57	PIK-3020
IKL58	PIK-3030
IKL64	PIK-402
IKL65	PIK-401
IKL66	PIK-400
IKL67	PIK-4020
IKL68	PIK-4030
IKL69	PIK-4040
SP0SL	SSS-0
SP0SL	SSS-0A1
SP10SL	SSS-10
SP10SL	SSS-10A1
SP1SL	SSS-1
SP2SL	SSS-2A1
SP3DL	SCS-3A1
SP3SL	SSS-3
SP3SL	SSS-3A1
SP4DL	SCS-4A1
SP4SL	SSS-4
SP4SL	SSS-4A1
SP5SL	SSS-5
SP5SL	SSS-5A1
SP6DL	SCS-6A1
SP6SL	SSS-6
SP6SL	SSS-6A1
SP8DL	SCS-8A1
SP8SL	SSS-8
SP8SL	SSS-8A1
SP9SL	SSS-9
SP9SL	SSS-9A1
WR139	KO-R24
WR9	KO-R21

Ask for your



ILSCO Solution Book

Complete North American product catalog available
by contacting your local IlSCO Canada Sales Representative
or by calling our office in Mississauga, Ontario.

ILSCO Canada Ltd. Customer Service Hot Line:
TOLL FREE: 1 (800) 665-2607
ILSCO website: www.ilSCO.com

ILSCO