

Hole Plugs and Vent Plugs

Nylon

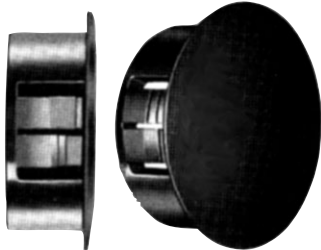

DP

HOLE PLUG

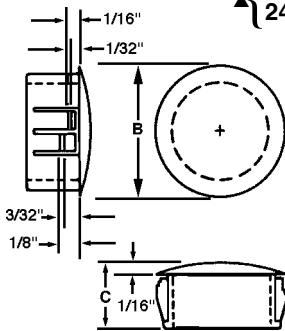

245-055 (Grey)
245-066 (Beige)



VP
Vent Plug

For 7/8", 1" and 2-1/2" holes.

Mounting Hole Dia. up to 4" available on DP and VP styles. Price on Request.

These will close your unneeded chassis holes quickly, easily and at low cost. Nylon material makes them suitable for use at elevated temperatures. 24 sizes for use in 3/16" to 3" diameter holes are available.

They lock firmly in chassis up to 1/4" thick. The convex matte finish head tapers to a thin edge and assures good appearance. Three sizes are also available with holes in their head for ventilation.



Recognized under the Component Program of Underwriters' Laboratories File #E-15331



Certified by Canadian Standards Association File #LR-8919

Maximum Thickness	Mounting Hole Diameter	SPAENAUR No.		Unit Pkg. Qty.	Description	PART DIMENSIONS		
		BLACK	WHITE			B Head Diameter	C Overall Height	
.062"	.187"	245-019	245-042	100	DP	1/4"	15/64"	
	.250"	245-020	245-041	100	DP	5/16"	5/16"	
	.312"	245-021	245-043	100	DP	3/8"		
.125"	.375"	245-053	245-022	100	DP	15/32"	13/32"	
	.437"	245-049	245-023	100	DP	17/32"		
	.500"	245-044	245-024	100	DP	37/64"		
	.562"	245-047	245-025	100	DP	21/32"		
	.625"	245-056	245-026	100	DP	23/32"		
	.687"	245-027		100	DP	25/32"		
	.750"	245-045	245-028	100	DP	59/64"	29/64"	
	.812"	245-029		100	DP	57/64"		
	.250"	.875"	245-030	245-048	100	DP	1-1/64"	3/4"
			245-031		100	VP	1-13/64"	
		1.000"		245-046	245-032	100	DP	1-7/32"
				245-033	245-060	100	VP	
1.093" to 1.125"			245-034		100	DP	1-5/16"	29/64"
1.187"			245-035		50	DP	1-3/8"	
1.250"			245-058	245-036	50	DP	1-1/2"	
1.375"		245-037		50	DP	1-43/64"		
1.500"		245-038	245-062	50	DP	1-29/32"		
1.750"		245-039	245-050	50	DP	2-9/64"		
2.000"		245-054	245-040	25	DP	2.343"	3/4"	
.250"	2.093" to 2.125"	245-059		10	DP	2.775"		
	2.500"	245-051	245-052	10	DP	2-23/32"		
	2.500"		245-061	10	VP	3-11/64"		
	3.000"	245-057		10	DP			

■ Indicates a component of Assortment No. 805-627, shown below.

HOLE PLUG & BUSHING ASSORTMENTS

A must for product design departments, experimental labs and for all prototype work. Pertinent information on each size is shown on inside lid label.



Priced Singly

ASSORTMENT
ASSORTMENT

805-627

Nylon HOLE & VENT PLUGS

22 Sizes

475 Total Pieces

Shipping weight 4.60 kg (10-1/4 lbs.)

Large Size Grey Enamelled Drawer fits the Slide Racks shown on Page A3.

805-626

Black Nylon SNAP BUSHINGS

32 Sizes

693 Total Pieces

Shipping weight 5.44 kg (12 lbs.)

Most popular items from page J63.

Priced Singly