

American Faucet & Coatings Corporation presents

Butler Mill and Brassworks Limited

1/2" Exposed Pressure Balance Valve Installation Instructions

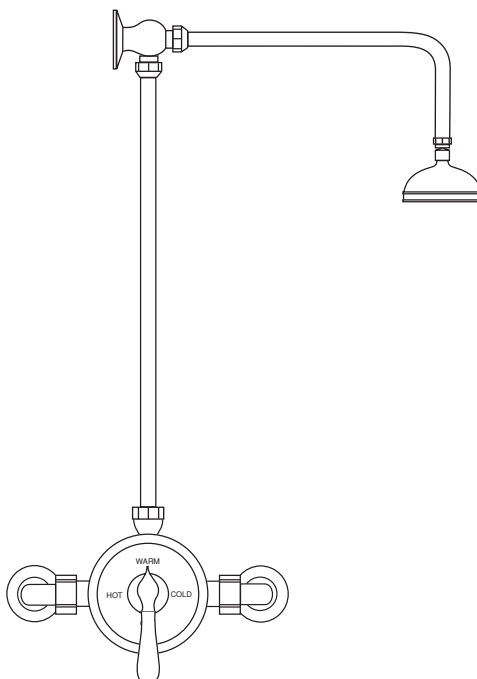

LEAVE FOR HOME OWNER
Model # 00.00.880

Care Instructions:

The Butler Mill and Brassworks Ltd. Product you have just purchased is designed to provide you with long lasting beauty and dependability. To ensure your product's longevity, please follow the following care instructions.

When installing, we recommend you lay all parts on a soft cloth or towel to avoid scratching or damaging the product. To care for your fitting, wipe with a clean, soft, damp cloth and blot dry as often as possible. Never use abrasive cleansers, sponges, or acidic cleaning products as these may damage the finish and may VOID THE WARRANTY.

Please read ALL instructions, cautions, and care recommendations before beginning installation.

CAUTIONS

- *Take special care to protect all components during the construction and installation.*
- *Before removal of old faucet, always turn off water.*
- *Open the faucets to reduce water pressure and to insure that complete water shut off has been accomplished.*
- *Before faucet installation, carefully flush all water lines.*
- *After faucet installation, remove aerator and flush all water lines again.
FAILURE TO DO SO MAY DAMAGE INTERNAL PARTS!*
- *Plumber's putty is not recommended. Use of caustic substances or acidic curing products for installation purposes may harm the finish or cause the product to not function properly.
Please read the cautions printed on any product purchased for use during installation.*

EXPOSED PRESSURE BALANCED VALVE (CYCLING TYPE)

Factory supplied with 24" Length

field cut at Point **A** if shorter arm is desired.

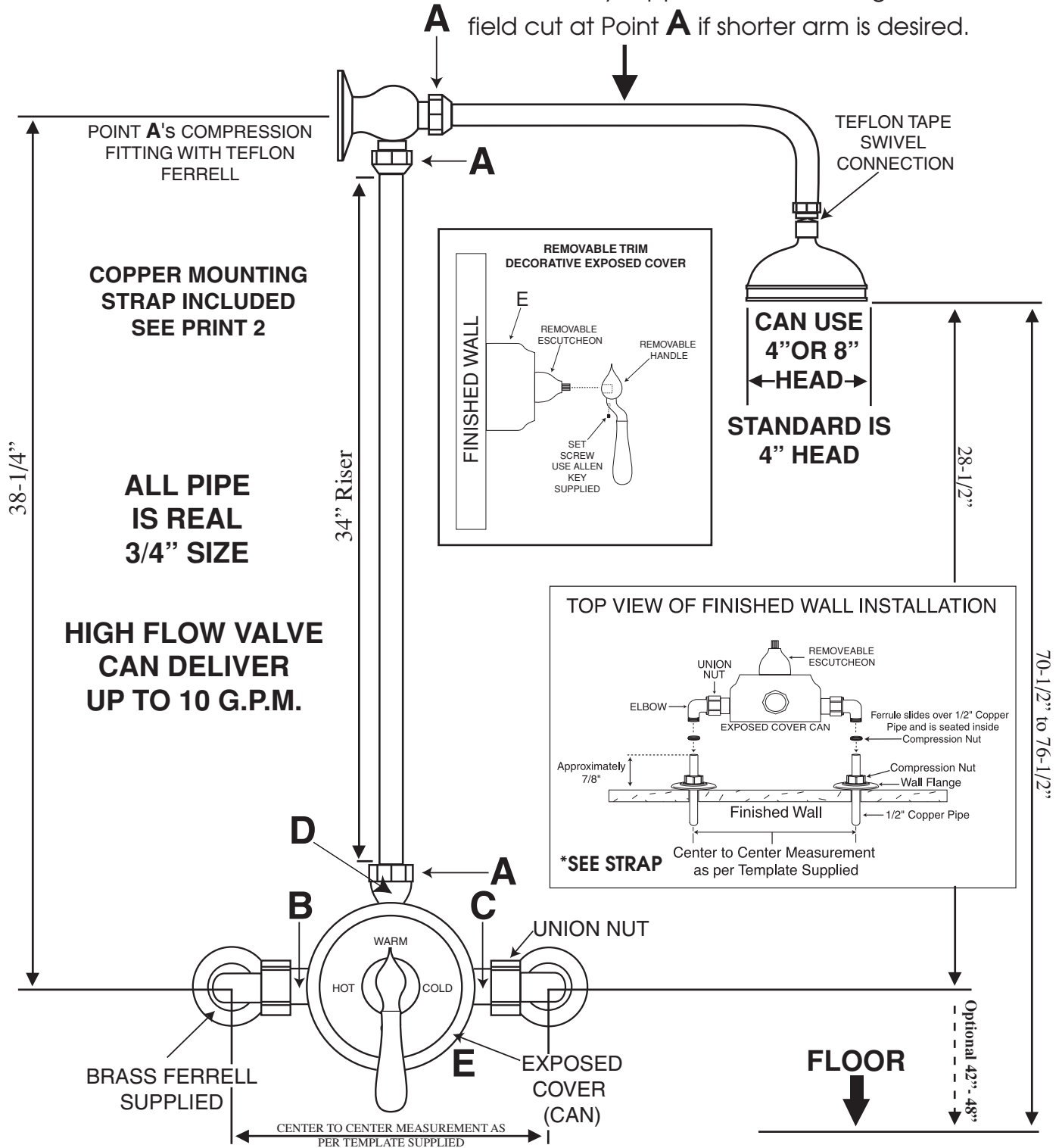

Installation begins by selecting the centerline of 2" x 4" backing studs at the factory suggested location of 42" to 48" as shown in (**Print 2**). The mounting plate is secured through the use of four metal screws. Note: The wall surface must be level on all sides of the centerline, otherwise the thermostatic system will not look level and straight when installed.

★ **MEASURE ALL SYSTEMS BEFORE INSTALLING**
RECOMMENDED ONLY
TYPICAL WALL FRAMING CONCEPT

PRINT 2

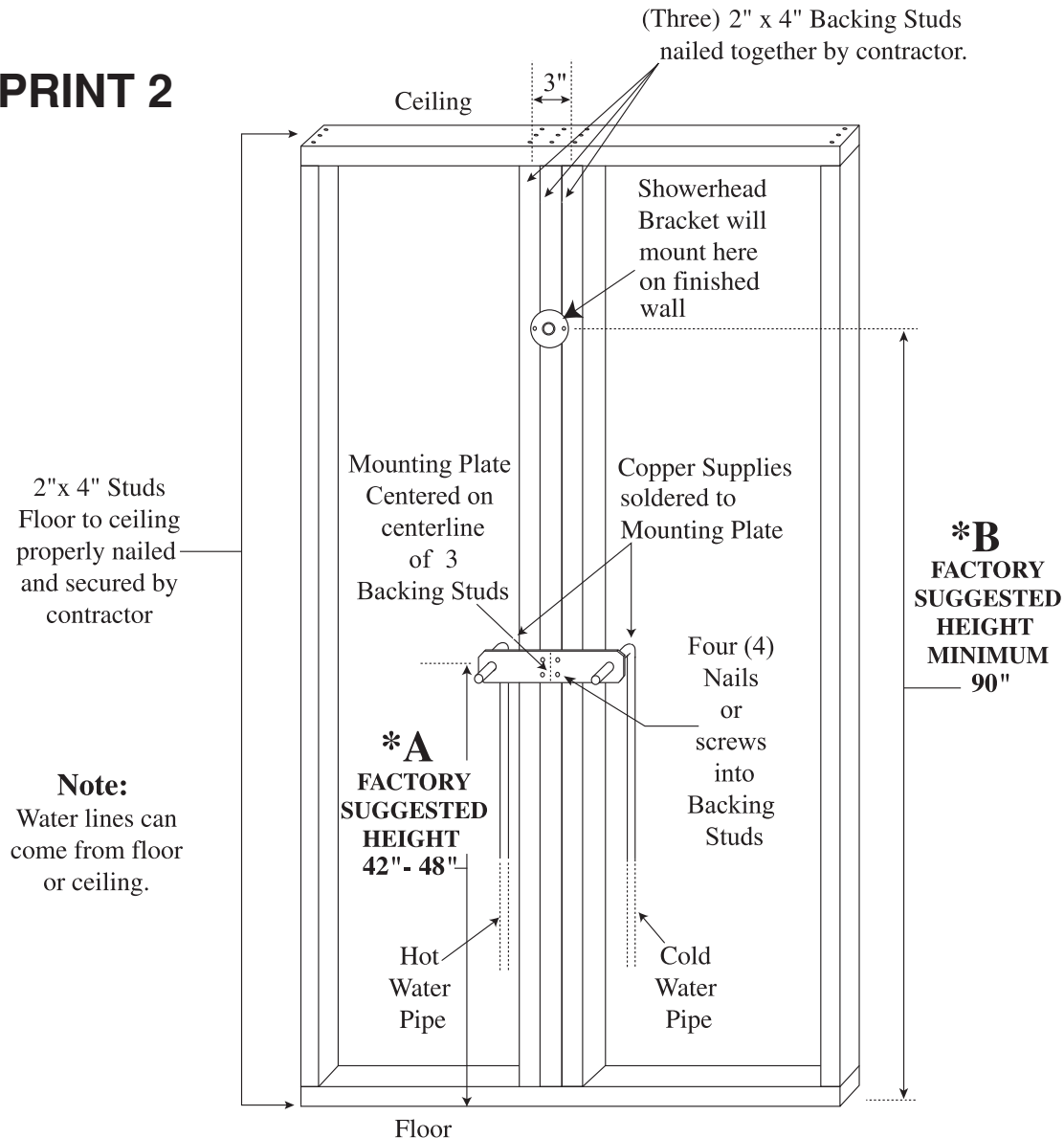

Note:
Water lines can come from floor or ceiling.

*** Note: These are factory suggestions only - The 90" Height at *B will allow a 6'5" tall person to walk underneath without bending.**

*** WE RECOMMEND ONLY LICENSED CONTRACTORS FOR ALL WORK**

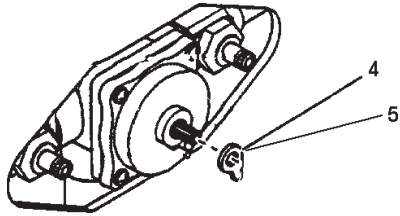

Fig 5

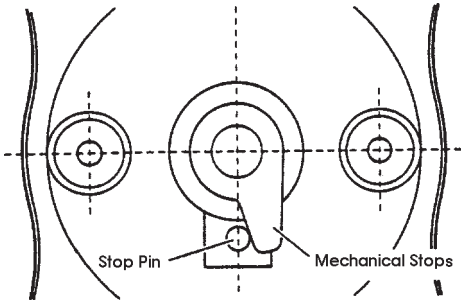

Fig 6

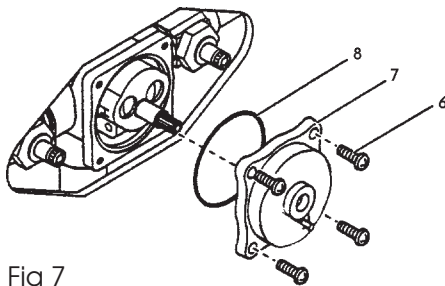

Fig 7

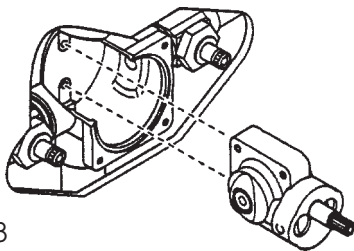

Fig 8

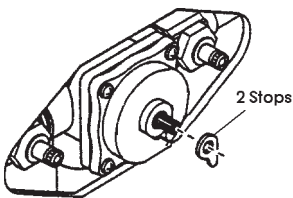

Fig 9

Should you need to access the rough pressure balanced valve below the decorative cover — Please Note:

1. The entire unit must be removed from the bath wall.
2. Turn off the water to this system before you take it apart.
3. Loosen all points (A) the compression nut, along with the union nuts (4) points on the body.
4. Remove the holding screws at top of wall bracket.
5. Pull unit off the wall (Two people will do this easier than one!)
6. Set unit on floor and proceed to disassemble all decorative parts connected to the center housing.
7. After the trim is removed you must unthread the brass connection at points B, C and D so you can access the rough valve.
8. Remove the mechanical stops, which are below the cap nut in the center of the valve.
9. Pay close attention to location setting of the mechanical stops (4 and 5). The thick mechanical stop (4) regulates cold temperature, while the thin top mechanical stop (5) regulates the hot temperature.
10. Loosen the four corner screws (6) and remove the valve cover (7) with the O-ring (8). The cartridge assembly is now exposed. (Fig 7)
11. Pull the cartridge out. Do not damage the O-ring seals.
12. Replace cartridge with new cartridge if necessary.
13. Put the O-ring on the valve cover. Make sure the surface of the valve cover, on which the O-ring will sit, and the O-ring are both clean.
14. Position the valve cover with stop pin facing down. Seat the cover to the body. Do not pinch the O-ring. The assembly should fit together with a minimum of pressing force. Reverse Figure 8.
15. Tighten up the cover screws, first lightly and diagonally, and then more firmly.
16. Close the valve by turning the cartridge stem clockwise. Position the mechanical stops as shown in figure 6 over the cartridge stem and push it into place. Thread on the cap nut and the stem extension with All Thread; then you are ready for the trim.
17. Put trim back on and reinstall on the wall as originally done.

Trouble Shooting - Pressure Balancing Valve

Malfunction	Cause	Remedy
Shower control opening through hot.	Hot and Cold water supplies have been connected in reverse.	Rotate cartridge as described in Back-to-back Installation .
Tub Filler or shower head drips after shutting off the valve.	Water remains in the piping column to the shower head (this is normal).	Allow approx. 3-5 min. to drain column, or turn lever on diverter to the tub fill position*.
	Incorrect setting of the mechanical stop(s) against the stop pin causing a partially opened cartridge.	Reset the mechanical stop as described in figure 6 previously.
	O-ring seal on the inlet of the cartridge is faulty.	Check the O-ring for cuts or damage and replace if necessary.
Shower insufficiently hot.	Adjustable handle position stop incorrectly set.	Reset handle position.
		Check hot water source temperature setting.
No flow of hot or cold water.	Either the hot or the cold side is not fully pressurized.	Be sure service stops are both wide open and system is fully pressurized.
	Debris caught inside the inlet of the cartridge.	Remove cartridge and flush out or remove any debris lodged inside the valve or inlet screens.
	Valve could be too deep in the wall.	Install stem extension kit.
Valve body too deep in wall.	The measured rough-in or finished wall surface is incorrect.	Install stem extension kit.

*** NOTE: At no time try to stop dripping by applying extreme force when closing the valve!**

Maintenance

This cartridge is designed for minimum maintenance in normal domestic use. If a malfunction occurs then this will probably necessitate a complete cartridge replacement. The cartridge contains no internally serviceable parts! Contact your installer or dealer.

To Clean trim, simply wipe gently with a damp cloth. Many household cleaners contain mild abrasives or chemicals and should never be used for cleaning decorative faucets.

Specifications and Dimensions

Min. operating pressure:	20 psi (140 kPa)	Our valves meet the requirements of the following organizations: CSA B-125 ANSI A112.18.1M ASSE 1016
Max. operating pressure:	145 psi (1000 kPa)	
Max. test pressure:	500 psi (3450 kPa)	
Hot and cold water inlets:	1/2 IPS or CxC	
Shower outlet:	1/2 IPS or CxC	
Tub outlet:	1/2 IPS or CxC	
Flow capacity:	10 USGPM @ 50 psi 19 l/min @ 345 kPa	

Product/Finish Warranty: American Faucet & Coatings Corporation warrants that products are free from defects in materials and workmanship for five (5) years from date of invoice. In addition, our Finish Warranty provides limited LIFETIME coverage for Chrome & PVD finishes, five (5) years for Omega powder coated finishes & Polished Gold. Living finishes are warranted for workmanship only. If any material proves to be defective after inspection by our company, it will be repaired or replaced at our discretion at no charge. However, no claims for labor, shipping costs, or consequential damages will be accepted.

What we will do: We will restore any product whose finish proves to be defective back to its original finish at no charge during the appropriate warranty period stated above. Proof of purchase must be provided. After the warranty period, American Faucet and Coatings Corporation will refinish any of its faucets at the prevailing appropriate charge.

What you must do: The faucets must be properly installed according to our instructions and specifications & are for residential use only. The faucets cannot be altered in any way. You must maintain and clean the faucets in accordance with the instructions provided with the product. You must use the faucet(s) for residential use only.

How to obtain service: Send your name, address, and telephone number along with a statement describing the nature of the problem and your paid sales slip or other proof of purchase to:

American Faucet & Coatings Corporation
3280 Corporate View
Vista, CA 92081

We will then contact you and take appropriate action. Do not send us any part(s) of your faucet(s) or its various connecting hoses unless we have contacted you and have sent you an approved RGA form. All transportation charges for returned goods must be paid by the customer.

What is not covered: This warranty does not cover the crystal/glass, or porcelain products of any faucet or the drain assembly or aerator on other than the Chrome or PVD finishes. This warranty also does not cover damage caused by accident, alterations, misuse, abuse, normal wear and tear, lime deposits, direct exposure to salty air or corrosive materials, or the color change that takes place with the passage of time, or use in any manner contrary to American Faucet and Coatings Corporation's printed instructions. In the case of in-the-wall installations American Faucet and Coatings Corp. will assume no liability if there is no access. **In no event will we be liable for labor of any kind, incidental or consequential damages.** This warranty is extended in lieu of all other expressed or implied warranties, whether oral or written. **Many installation compounds are harmful to brass and metal finishes. The use of any lead-based or acidic curing adhesive, silicone, mastic, or plumber's putty on or near our finished products will void the finish warranty. Use only sealants which are neutral curing and are not reactive with metal and brass finishes.** American Faucet & Coatings Corporation reserves the right to change, modify or alter its products as deemed necessary. This warranty supersedes any other American Faucet & Coatings Corporation warranties, whether oral or written.

Unless otherwise contrary to state law governing the purchase, American Faucet and Coatings Corporation's liability will not exceed the wholesale price for the American Faucet and Coatings Corporation product considered defective. This warranty gives you specific legal rights, and you may also have other rights which vary from state to state. Some states do not allow exclusion of incidental or consequential damages, so the above limitation may not apply to you.

LIFETIME WARRANTY ON 1/4 TURN CERAMIC DISC CARTRIDGE

Should the ceramic disc cartridge in your faucet ever fail, American Faucet & Coatings Corporation will replace the failed part free of charge to the original purchaser of the product. Your cost will be a \$7.95 handling and mailing charge. Labor not included. When ordering replacements, denote for widespread or centerset lavatory, Roman Tub, or other. Include age of faucet. (This does not include thermostatic, pressure balance, or diverter cartridges.)

CONSUMER WARNING CALIFORNIA PROPOSITION 65 WARNING

Among other chemicals known to cause harm, this faucet contains lead, a chemical known to the State of California to cause birth defects or other reproductive harm.

All faucets and products made of leaded brass alloys, even those that comply with U.S. Environmental Protection Agency regulations, contribute small amounts of lead to water that is allowed to stand in contact with the brass. This faucet complies with all E.P.A. regulations regarding the amount of lead used in plumbing brass and solder. The amount of lead contributed by any faucet is highest when the faucet is new. The following steps will reduce potential for exposure to lead from faucets and other parts of the plumbing system:

- Always run the water for a few seconds prior to use for drinking or cooking.
- Use only cold water for drinking or cooking.
- If you wish to flush the entire plumbing system of water that has been standing in the pipes or other fittings, run the cold water until the temperature of the water drops, indicating water coming from the outside main.
- If you are concerned about lead in your water, have your water tested.

American Faucet & Coatings Corporation