

NAUTILUS PRO-SERIES TREADMILL

Model:
T714

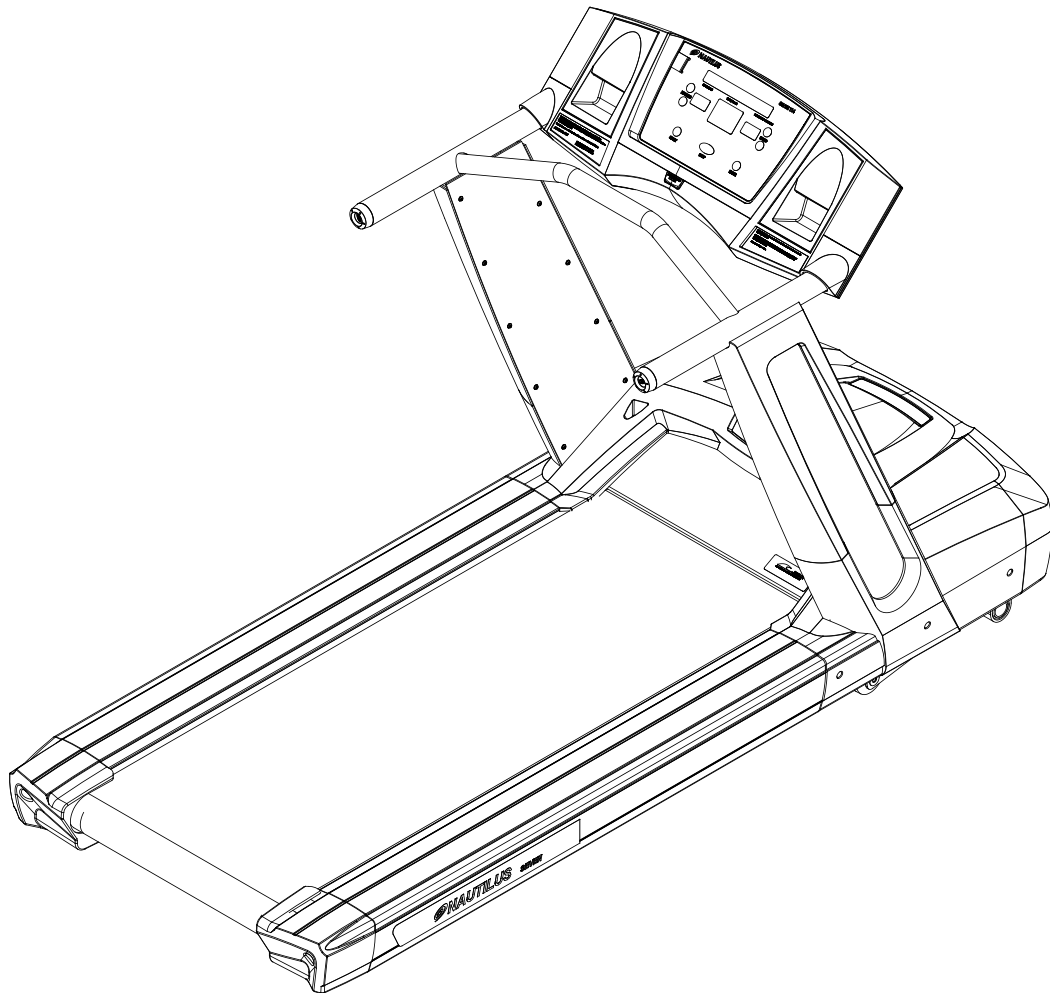

Assembly Instructions

i IMPORTANT!

Please read assembly instructions completely before beginning.

- Due to the treadmill's size and weight, the unit requires two people to move and assemble. Several steps of the assembly process will also require two people to perform.
- Carefully unpack the machine and check to ensure all parts have been included in the box.
- After treadmill is assembled, read through your Owner's Manual for complete safety information, installation requirements and operating instructions.

Required Assembly Tools

- #2 Phillips Screwdriver
- 9/16" Socket and Driver
- 5/32 Allen Wrench
- 9/16 Wrench

Hardware Contents

Item Number	Item Description	Quantity
1	#10-32 x .50" Phillips Head Screw	15
2	¼-20 x .50" Allen Head Screw	4
5	3/8-16 x 2.75" Bolt	2
6	3/8" Spring Washer	3
7	3/8" Washer	4
17	Nut, 3/8 -16 NC Finish	2
18	Screw, 3/8 - 16 x 5	2

Assembly Procedure

Note: For ease of assembly, install Console Assembly before folding Treadmill Uprights into position.

Step 1 - Install Console

- Plug the four connectors on the Console Assembly (#10) into the four connectors on the Treadmill Uprights (#11).
- Insert the Console Assembly (#10) into the Treadmill Uprights (#11) using extreme care not to damage or pinch any of the wiring harness. Gently pull the excess slack from the wire harness at the bottom of the Treadmill Uprights.
- Use four Allen Screws (#2) to secure the Console Assembly.

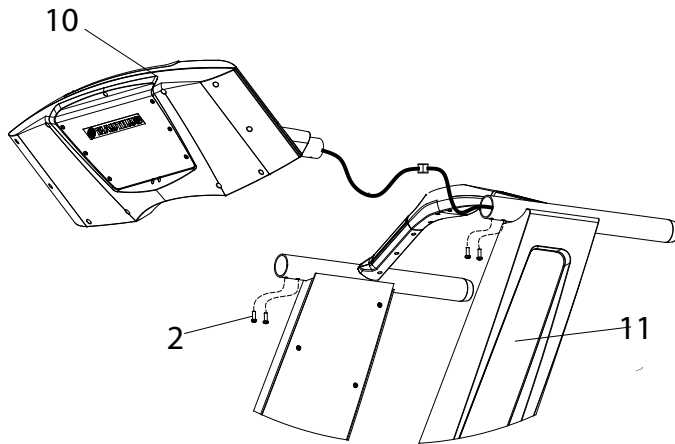

Step 2 - Secure Treadmill Uprights

- Fold the Treadmill Uprights (#11) into place using extreme care to avoid pinching the wiring harness at the base of the uprights. Use two Bolts (#5), three Spring Washers (#6), four Washers (#7), two Bolts (#18), two Nuts (#17), and the two Pivot Bolts (#15) to secure the uprights.

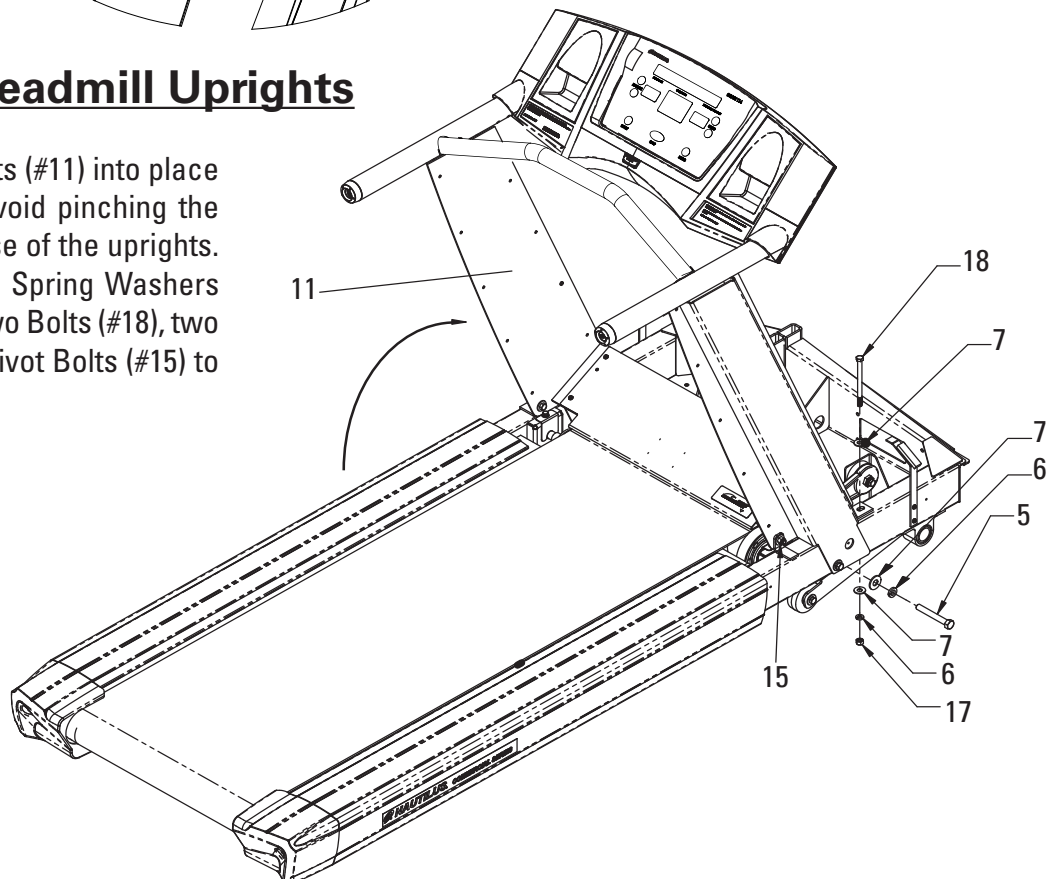

Step 3 - Attach Side Frame Covers

- Use 10 Phillips Head Screws (#1) to attach the left and right Side Frame Covers (#12).

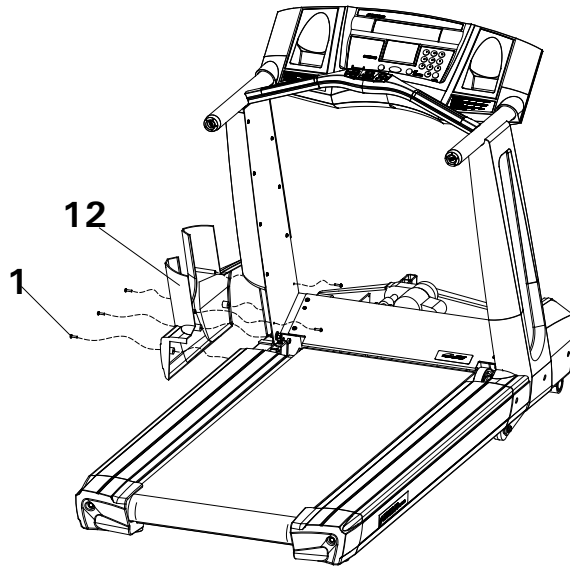

Step 4 - Attach Top Motor Cover

- Use two Phillips Head Screws (#1) to secure the Top Motor Cover onto the Kick Plate.

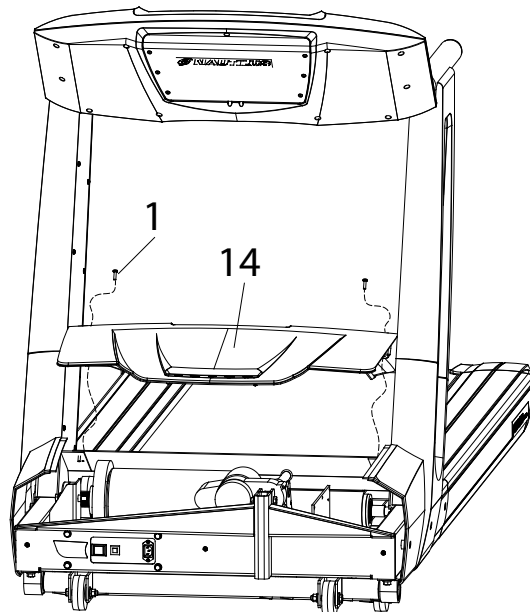

Step 5 - Attach Front Motor Cover

- Plug the Power Cord into the Power Cord Receptacle at the front of the treadmill.
- Use three Phillips Head Screws (#1) to secure the Front Motor Cover (#16).

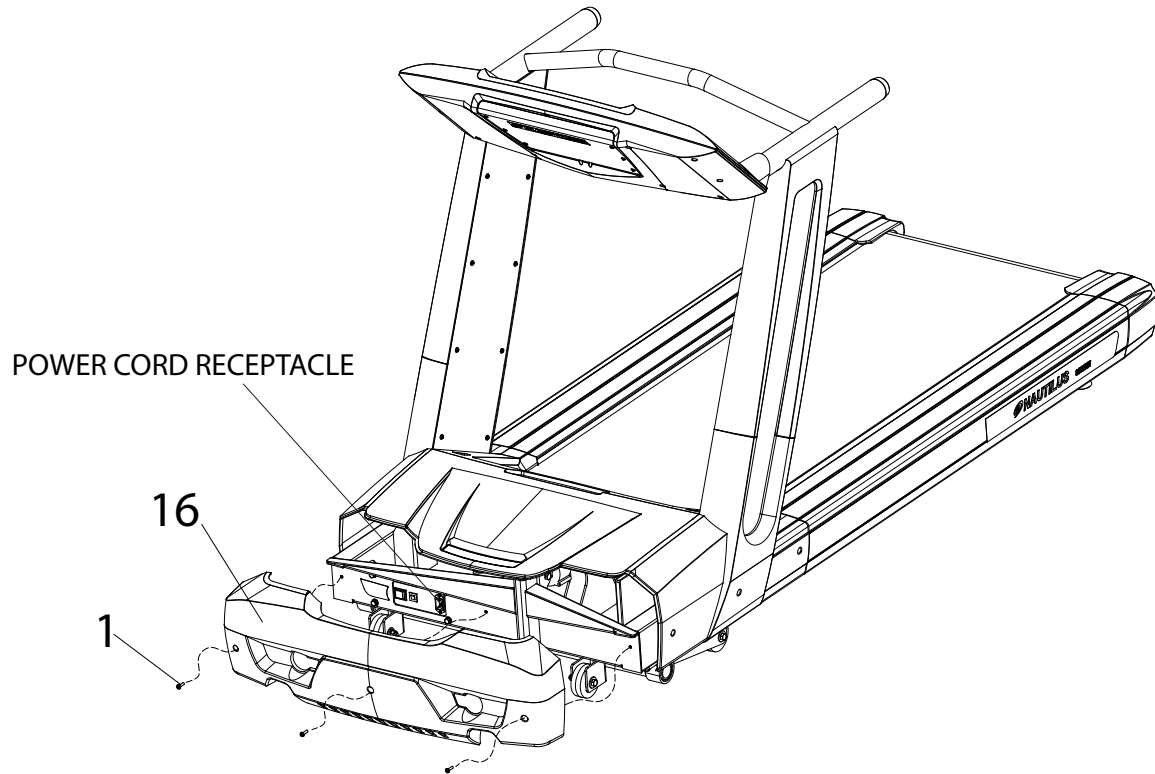

Assembly of your Nautilus Pro Series Series Treadmill is complete!

Please refer to your **Pro Series Owners Manual**
for information on proper use of your treadmill.

For more information visit our website Nautilus.com or call: 800-864-1270 (USA),
1-800-636-8316 (French Canadian), or +41-26-460-77-77 (International).