

# Contents

The Quick Guide is not intended as a substitute for your *Owner's Manual*. We strongly encourage you to review the *Owner's Manual* and supplementary manuals so you will have a better understanding of your vehicle's capabilities and limitations.

## **Air Conditioning System\***

Adjusting the temperature setting.....	75
Adjusting the fan speed setting.....	75
Change the airflow mode.....	75
Control screen.....	75
Side display operation screen (Vehicles with a navigation system [12.3-inch display]).....	76
Option control screen.....	77
Using the automatic mode.....	77
S-FLOW mode.....	77
Adjusting the temperature for driver and passenger seats separately ("DUAL" mode).....	77

## **Audio System (with Lexus Display Audio)\***

Lexus Display Audio operation buttons.....	69
Using the steering wheel switches to change audio sources.....	69
Audio menu screen.....	70
Operating the audio system using the steering wheel switches.....	72

## **Audio System (with Navigation System)\***

Audio control screen.....	61
Remote control (steering wheel audio switches).....	61
Basic operation.....	62
Radio.....	62
DVD player/CD player.....	63
Operating an iPod.....	64

## **Automatic High Beam.....**

## **Automatic Transmission (vehicles with paddle shift switches).....**

## **Automatic Transmission (vehicles without paddle shift switches).....**

## **Brake Hold.....**

## **BSM (Blind Spot Monitor).....**

## **Cruise Control.....**

## **Door Locks.....**

## **Driving Mode Select Switch.....**

## **Dynamic Radar Cruise Control with Full-speed Range.....**

\*: This feature may be operated by Voice command (See P.79)

Eco Driving Indicator .....	33
Engine (Ignition) Switch .....	15
Floor Mat Installation .....	11
Fog Lights .....	36
Fuel Tank Cap .....	94
Garage Door Opener .....	83
<b>Hands-Free System For Cellular Phone (with Lexus Display Audio)*</b>	
How to register a Bluetooth® device .....	66
Registering favorites .....	66
Dialing .....	66
Dialing from the phonebook .....	67
When the phonebook is empty .....	67
Dialing from favorites .....	67
To answer the phone .....	68
Operating a phone using the steering wheel switches .....	68
<b>Hands-free System For Cellular Phone (with Navigation System)*</b>	
Bluetooth® phone pairing .....	58
Contact transfer .....	59
Calling by name .....	60
Receiving a call .....	60
Steering switches .....	60
Head-up Display .....	31
Headlights .....	34
Information Services .....	89
Intelligent Clearance Sonar (ICS) .....	49
Intuitive Parking Assist .....	49
Keys .....	12
Lexus Climate Concierge .....	74
Lexus Display Audio Controller (with Lexus Display Audio) .....	65
Lexus Enform .....	87
LEXUS Enform Safety Connect .....	85
Lexus Safety System+ .....	41
LKA (Lane-Keeping Assist) .....	47

\*: This feature may be operated by Voice command (See P.79)

<b>Moon Roof</b> .....	92
<b>Multi-information Display</b> .....	27
<b>Navigation System*</b>	
Register home.....	56
Destination search.....	57
Voice Command System.....	79
<b>Panoramic Moon Roof</b> .....	92
<b>Panoramic View Monitor</b> .....	50
<b>Parking Brake</b> .....	25
<b>Portable Audio Device Ports</b> .....	72
<b>Power Back Door</b> .....	95
<b>Power Windows</b> .....	91
<b>Rear Seat Entertainment System Features</b> .....	73
<b>Rear Window Wiper and Washer</b> .....	40
<b>Remote Touch (with Navigation System)</b> .....	53
<b>Seat Heaters/Seat Ventilators</b> .....	78
<b>Smart Access System with Push-button Start</b> .....	13
<b>Theft Deterrent System</b> .....	14
<b>Tire Pressure Warning System</b> .....	48
<b>Turn Signal Lever</b> .....	24
<b>Voice Command System*</b>	
Basic operation.....	79
Command list.....	80
<b>Windshield Wipers and Washer</b> .....	37

\*: This feature may be operated by Voice command (See P.79)

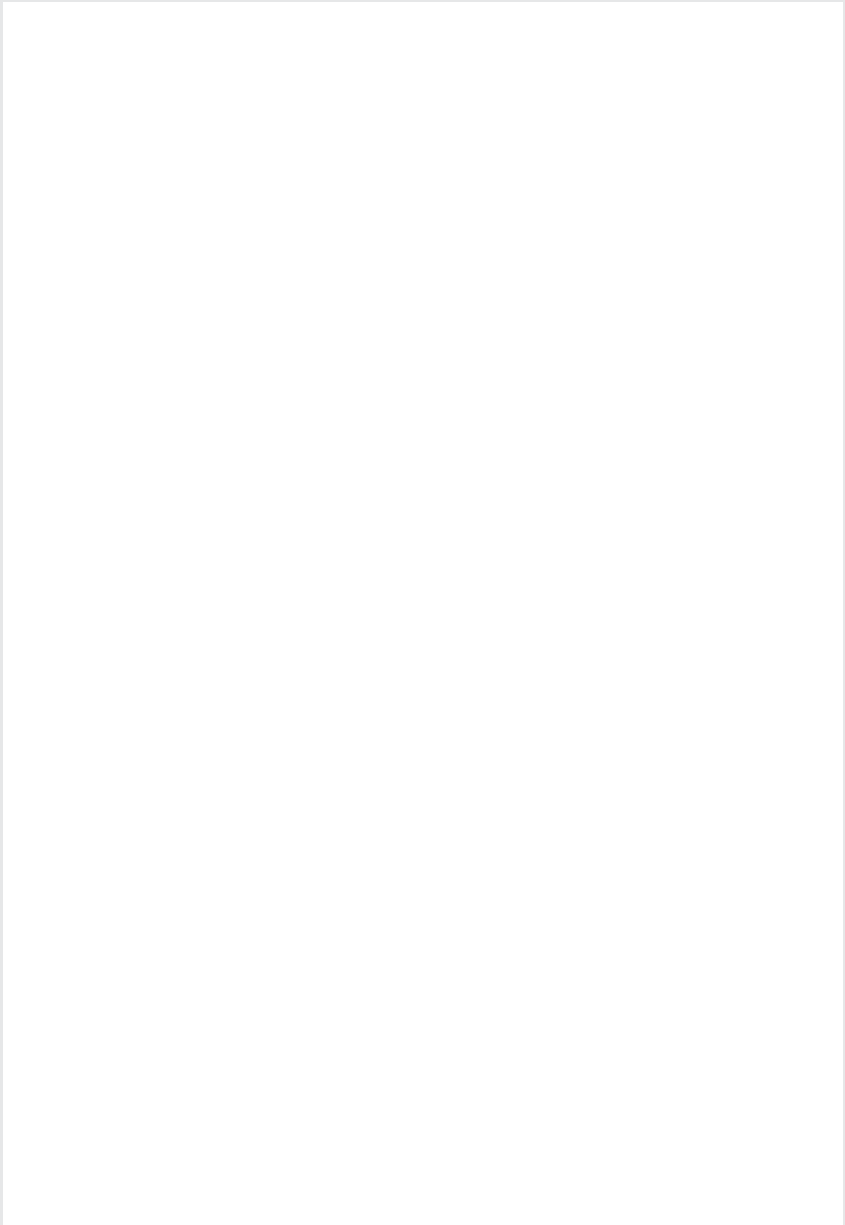

# Overview

# Instrument Panel

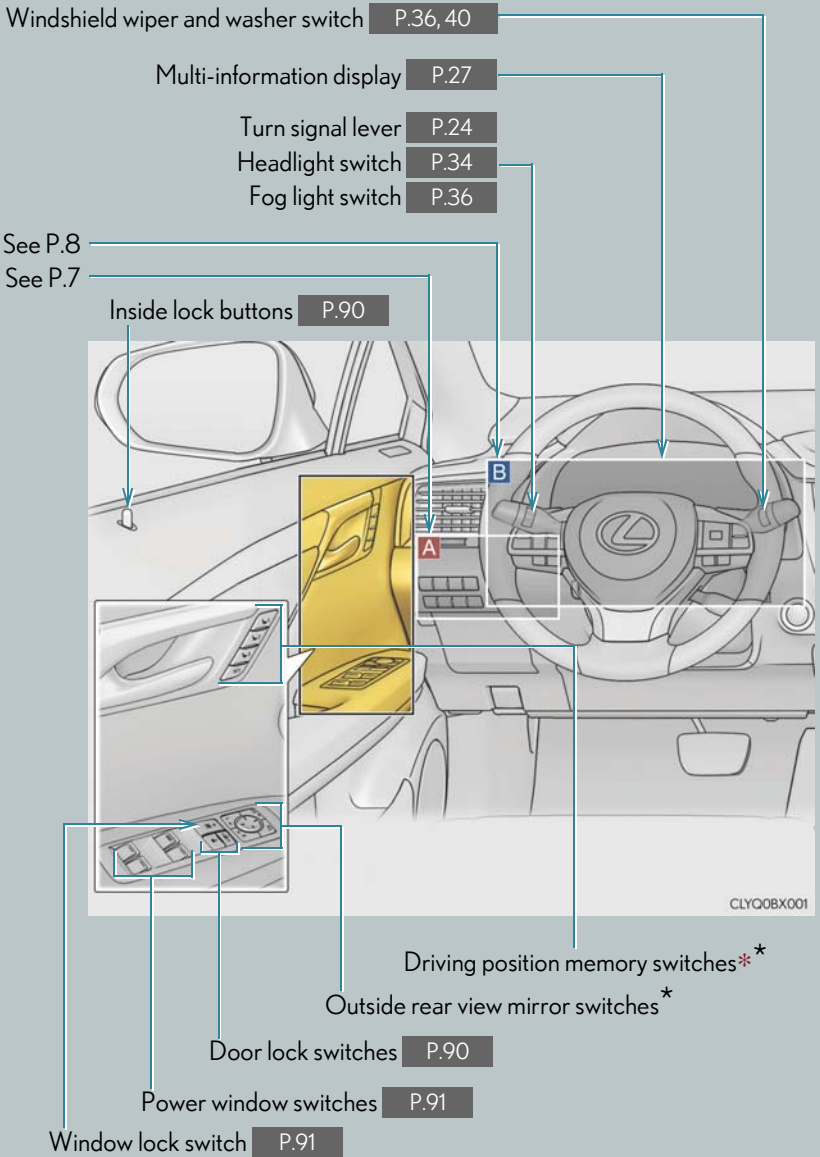

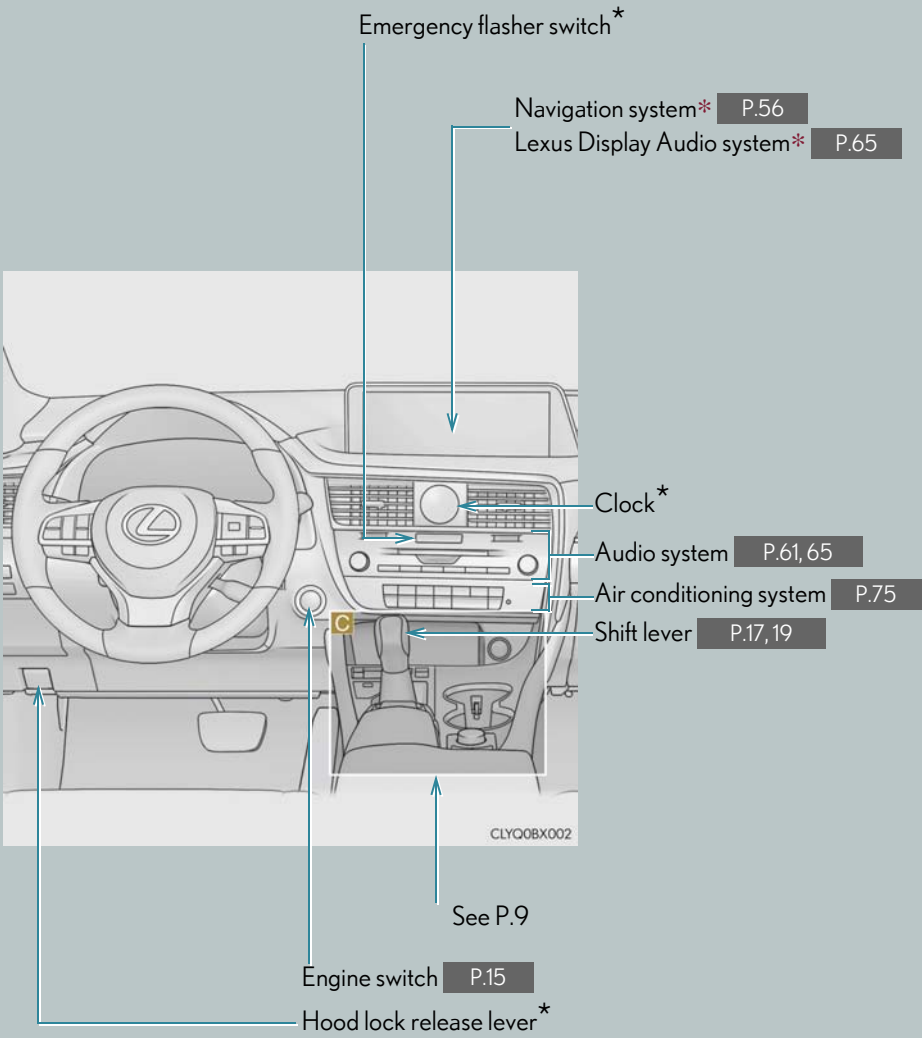

\*: If equipped  
 \*: Refer to "OWNER'S MANUAL".

A

Automatic High Beam switch\* P.35

Power back door switch P.95

HUD (Head-up display) switch\* P.31

Instrument panel light control switches\*

"ODO/TRIP" switch  
P.29

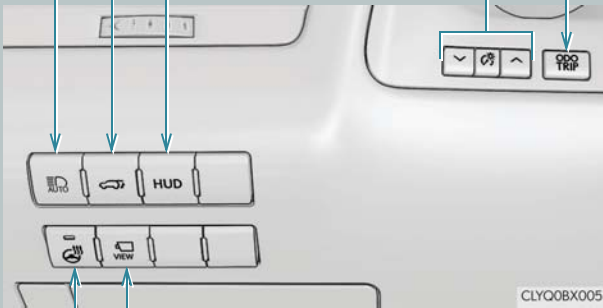

Camera switch\* P.50

Heated steering wheel switch\*

**B**

Audio remote control switches P.61

Meter control switches P.29

Paddle shift switches\* P.20,21

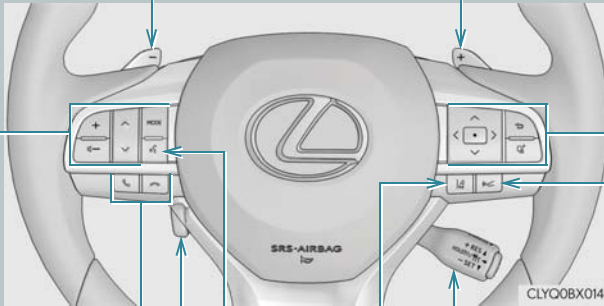

Telephone switches  
P.60, 68

Tilt and telescopic steering  
control switch\*

Talk switch P.60,68

LKA (Lane-Keeping Assist) switch\* P.47

Cruise control switch  
P.42, 45

Vehicle-to-vehicle distance  
button\* P.43

\*: If equipped

\*: Refer to "OWNER'S MANUAL".



# Overview

# Instrument Panel

C

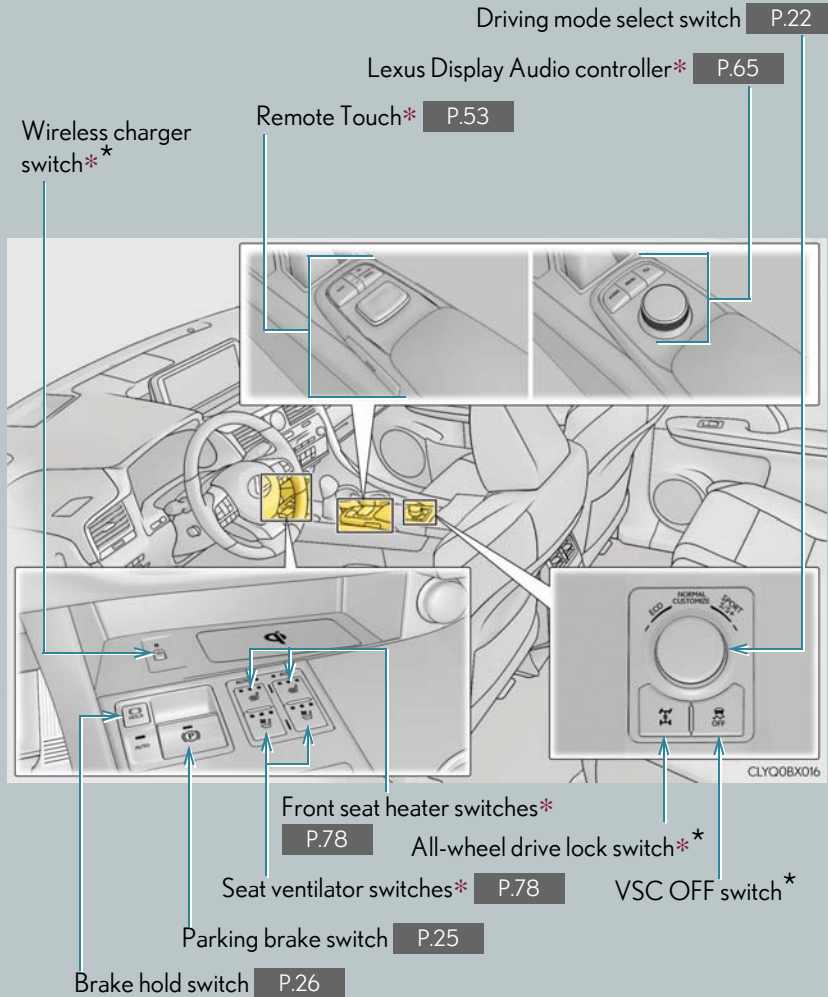

\*: If equipped

\*: Refer to "OWNER'S MANUAL".

Interior light\*  
Personal lights\*

Moon roof switches\* P.92

Panoramic moon roof switches\* P.92

Vanity lights\*

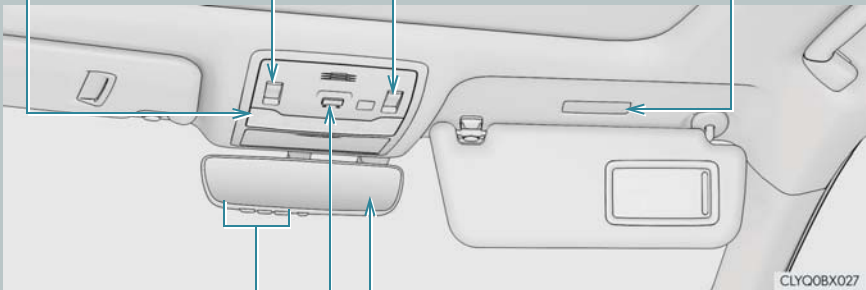

Inside rear view mirror\*

"SOS" button\* P.85

Garage door opener switches P.83

\*: If equipped

\*: Refer to "OWNER'S MANUAL".

## Floor Mat Installation

Use only floor mats designed specifically for vehicles of the same model and model year as your vehicle. Fix them securely in place onto the carpet.

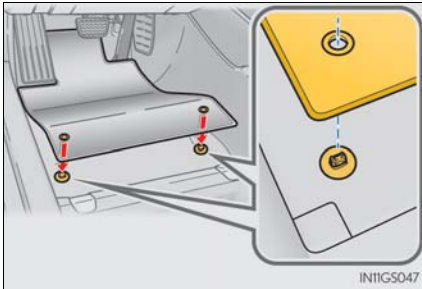

- 1** Insert the retaining hooks (clips) into the floor mat eyelets.

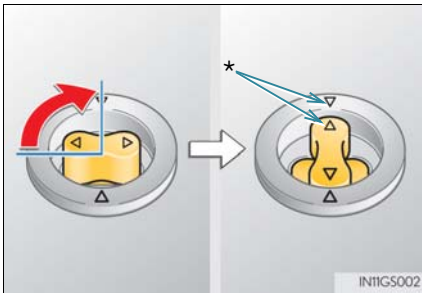

- 2** Turn the upper knob of each retaining hook (clip) to secure the floor mats in place.

\*: Always align the  $\triangle$  marks.

The shape of the retaining hooks (clips) may differ from that shown in the illustration.

# Keys

## ■ Electronic key



Smart access system with push-button start (→P.13, 15)

Wireless remote control (→P.13)

## ■ Mechanical key

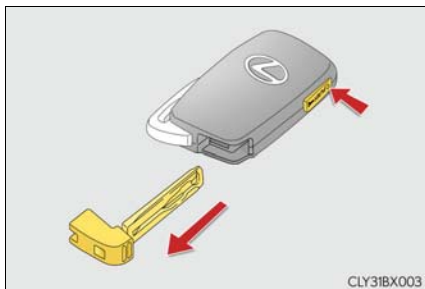

To take out the mechanical key, push the release button and take the key out.

The mechanical key can only be inserted in one direction, as the key only has grooves on one side. If the key cannot be inserted in a lock cylinder, turn it over and re-attempt to insert it.

After using the mechanical key, store it in the electronic key. Carry the mechanical key together with the electronic key.

If the electronic key battery is depleted or the entry function does not operate properly, you will need the mechanical key.

## ■ Wireless remote control

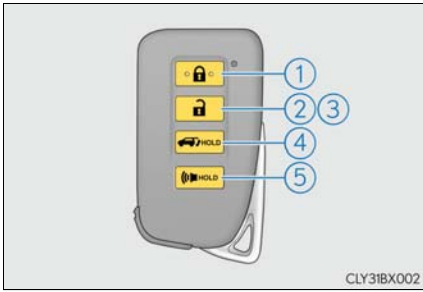

- ① Locks all the doors
- ② Unlocks all the doors
- ③ Opens the windows<sup>\*2</sup> and the moon roof<sup>\*1,2</sup> or panoramic moon roof<sup>\*1,2</sup>
- ④ Opens and closes the power back door
- ⑤ Sounds the alarm

\*1: If equipped

\*2: This setting must be customized at your Lexus dealer.

## ■ Smart Access System with Push-button Start

The following operations can be performed simply by carrying the electronic key on your person, for example in your pocket. The driver should always carry the electronic key. For details on starting the engine, see page 15.

## ■ Entering and exiting the vehicle

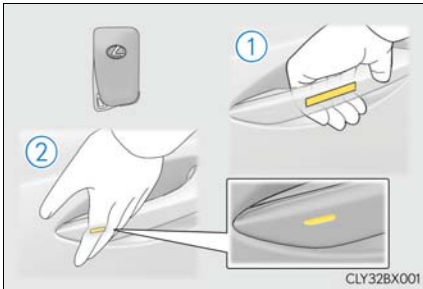

- ① Grip the driver's door handle to unlock the door. Grip any passenger door handle to unlock all the doors. Make sure to touch the sensor on the back of the handle. The doors cannot be unlocked for 3 seconds after the doors are locked.
- ② Touch the lock sensor (indentation on the surface of the door handle) to lock all the doors. Check that the door is securely locked.

## ■ Locking and unlocking the power back door

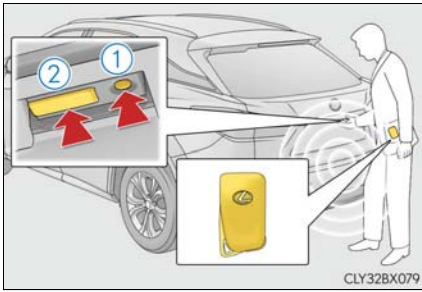

- ① Locks all the doors  
Check that the door is securely locked.
- ② Unlocks all the doors  
The doors cannot be unlocked for 3 seconds after the doors are locked.

For details on what to do when the electronic key does not operate properly, see page 100.

## ■ Theft Deterrent System

### ■ Engine immobilizer system

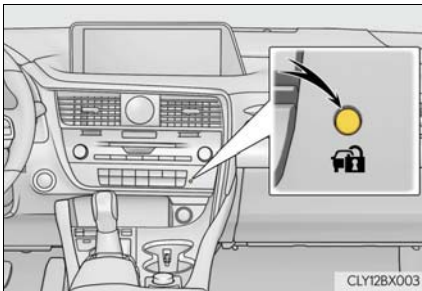

The indicator light flashes after the engine switch has been turned off to indicate that the system is operating.

The indicator light stops flashing after the engine switch has been turned to ACCESSORY or IGNITION ON mode to indicate that the system has been canceled.

### ■ Alarm

The alarm uses light and sound to give an alert when an intrusion is detected.

#### To set the alarm:

Close the doors and hood, and lock all the doors. The system will be set automatically after 30 seconds.

The indicator light changes from being on to flashing when the system is set.

#### To deactivate or stop the alarm:

- Unlock the doors.
- Turn the engine switch to ACCESSORY or IGNITION ON mode, or start the engine.  
(The alarm will be deactivated or stopped after a few seconds.)

## Engine (Ignition) Switch

Performing the following operations when carrying the electronic key on your person starts the engine or changes engine switch modes.

### Starting the engine

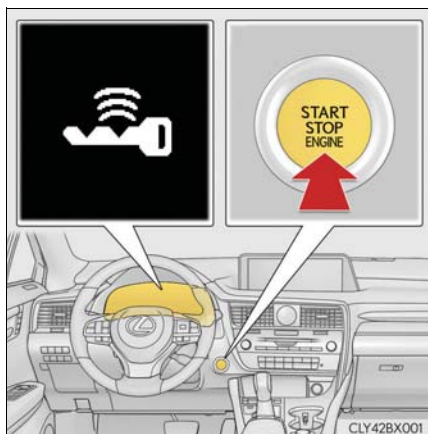

- 1 Check that the parking brake is set.
- 2 Check that the shift lever is in P.
- 3 Firmly depress the brake pedal.  
 and a message will be displayed on the multi-information display. If it is not displayed, the engine cannot be started.

- 4 Press the engine switch shortly and firmly.

When operating the engine switch, one short, firm press is enough.

It is not necessary to press and hold the switch.

The engine will crank until it starts or for up to 30 seconds, whichever is less.

Continue depressing the brake pedal until the engine is completely started.

The engine can be started from any engine switch mode.

### Stopping the engine

- 1 Stop the vehicle completely.
- 2 Set the parking brake, and shift the shift lever to P.
- 3 Press the engine switch.
- 4 Release the brake pedal and check that the display on the meters is off.

## ■ Changing engine switch modes

Modes can be changed by pressing the engine switch with brake pedal released. (The mode changes each time the switch is pressed.)

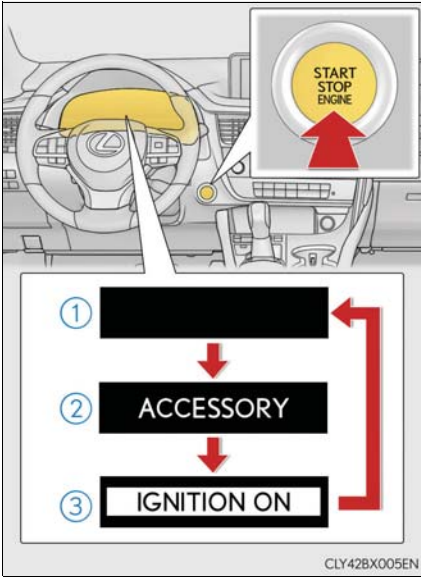

- ① Off\*  
The emergency flashers can be used.
- ② ACCESSORY mode  
Some electrical components such as the audio system can be used.  
"ACCESSORY" will be displayed on the meters.
- ③ IGNITION ON mode  
All electrical components can be used.  
"IGNITION ON" will be displayed on the meters.

\*: If the shift lever is in a position other than P when turning off the engine, the engine switch will be turned to ACCESSORY mode, not to off.

## ■ If your vehicle has to be stopped in an emergency

Only in an emergency, such as if it becomes impossible to stop the vehicle in the normal way, stop the vehicle using the following procedure:

- 1 Steadily step on the brake pedal with both feet and firmly depress it.  
Do not pump the brake pedal repeatedly as this will increase the effort required to slow the vehicle.
- 2 Shift the shift lever to N.  
► If the shift lever is shifted to N
- 3 After slowing down, stop the vehicle in a safe place by the road.
- 4 Stop the engine.



► If the shift lever cannot be shifted to N

- 3** Keep depressing the brake pedal with both feet to reduce vehicle speed as much as possible.



To stop the engine, press and hold the engine switch for 2 consecutive seconds or more, or press it briefly 3 times or more in succession.

- 5** Stop the vehicle in a safe place by the road.

## Automatic Transmission (vehicles without paddle shift switches)

### Shifting the shift lever

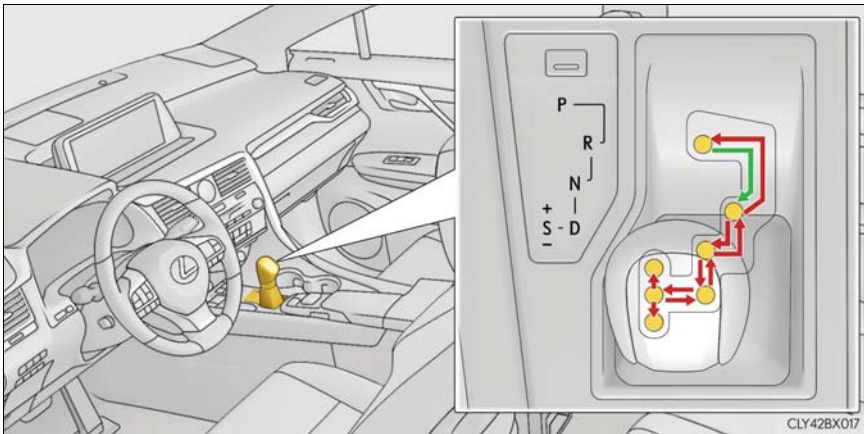

- ← While the engine switch is in IGNITION ON mode, move the shift lever with the brake pedal depressed. When shifting the shift lever between P and D, make sure that the vehicle is completely stopped.

## ■ Shift position purpose

Shift position	Objective or function
P	Parking the vehicle/starting the engine
R	Reversing
N	Condition in which the power is not transmission
D	Normal driving <sup>*1</sup>
S	S mode driving <sup>*2</sup>

\*1: Shifting to the D position allows the system to select a gear suitable for the driving conditions. Setting the shift lever to the D position is recommended for normal driving.

\*2: Selecting shift ranges using S mode restricts the upper limit of the possible gear ranges, controls engine braking forces, and prevents unnecessary upshifting.

## ■ Selecting shift ranges in S mode

To enter S mode, shift the shift lever to the S position. The shift range can then be selected by operating the shift lever. Changing the shift range allows restriction of the upper limit of the gears to be used, preventing unnecessary upshifting and enabling the level of engine braking force to be selected.

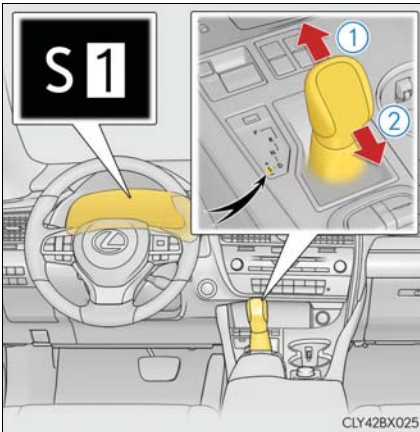

① Upshifting

② Downshifting

The initial shift range in S mode is set automatically between 3 and 7 according to vehicle speed and driving conditions.

## ■ Shift ranges and their functions

Meter display	Function
S2 - S8	A gear in the range between 1 and the selected gear is automatically chosen depending on vehicle speed and driving conditions
S1	Setting the gear at 1

A lower shift range will provide greater engine braking forces than a higher shift range.

## Automatic Transmission (vehicles with paddle shift switches)

### Shifting the shift lever

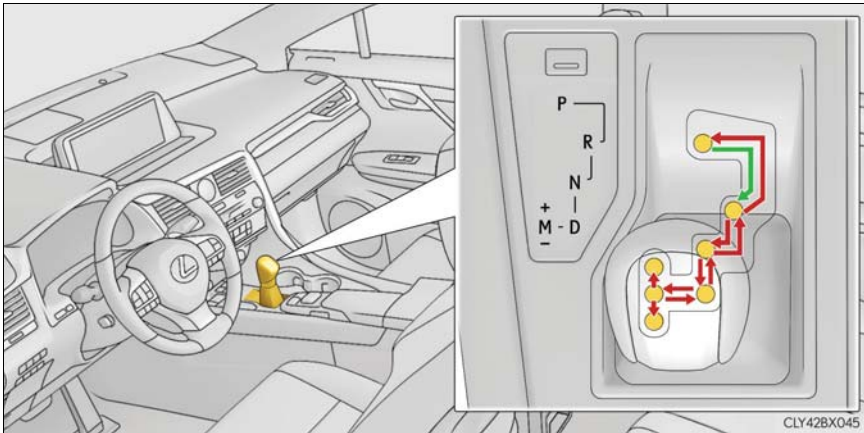

- While the engine switch is in IGNITION ON mode, move the shift lever with the brake pedal depressed. When shifting the shift lever between P and D, make sure that the vehicle is completely stopped.

### Shift position purpose

Shift position	Objective or function
P	Parking the vehicle/starting the engine
R	Reversing
N	Condition in which the power is not transmission
D	Normal driving <sup>*1</sup>
M	M mode driving <sup>*2</sup>

<sup>\*1</sup>: Shifting to the D position allows the system to select a gear suitable for the driving conditions.

Setting the shift lever to the D position is recommended for normal driving.

<sup>\*2</sup>: Selecting gears using M mode fixes the gear step, controls engine braking force, and prevents unnecessary upshifting.

## ■ Selecting shift ranges in the D position

When the “-” paddle shift switch is operated, the shift range will be downshifted to a range that enables engine braking force that is suitable to driving conditions. When the “+” paddle shift switch is operated, the shift range will be one gear higher than the gear in use during normal D position driving.

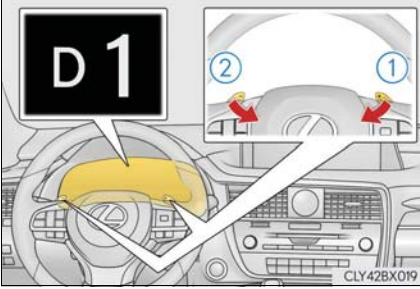

① Upshifting

② Downshifting

The selected shift range, from D1 to D8, will be displayed on the meters.

## ■ Shift ranges and their functions

Meter display	Function
D2 - D8	A gear in the range between 1 and the selected gear is automatically chosen depending on vehicle speed and driving conditions
D1	Setting the gear at 1

A lower shift range will provide greater engine braking forces than a higher shift range.

## ■ Selecting gears in the M position

To enter M mode, shift the shift lever to M. Gears can then be selected by operating the shift lever or paddle shift switches, allowing you to drive in the gear of your choosing.

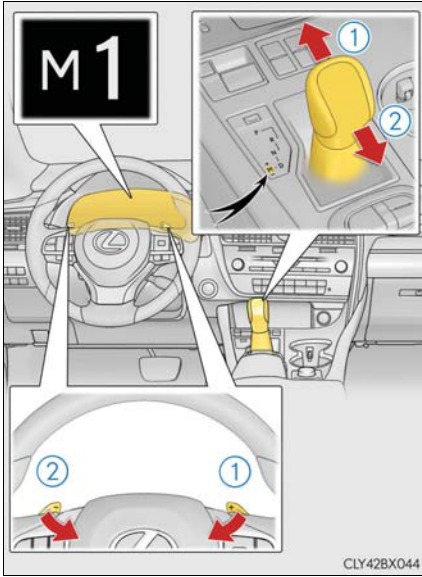

① Upshifting

② Downshifting

The gear changes once every time the shift lever or paddle shift switch is operated.

The selected gear, from M1 to M8, will be fixed and displayed on the meter.

When in the M position, the gear will not change unless the shift lever or paddle shift switches are operated. However, even when in the M position, the gears will be automatically changed in the following situation:

- When vehicle speed drops (downshift only).
- When the automatic transmission fluid or engine coolant temperature is low.
- When the automatic transmission fluid temperature is high (upshift only).
- When the needle of the tachometer is in the red zone (the range which exceeds the allowable revs of the engine).

In the following situations, the gear will not shift even if the shift lever or paddle shift switches are operated.

- The vehicle speed is low (upshift only).

## Driving Mode Select Switch

The driving modes can be selected to suit driving conditions.

### ► Vehicles without Adaptive Variable Suspension System

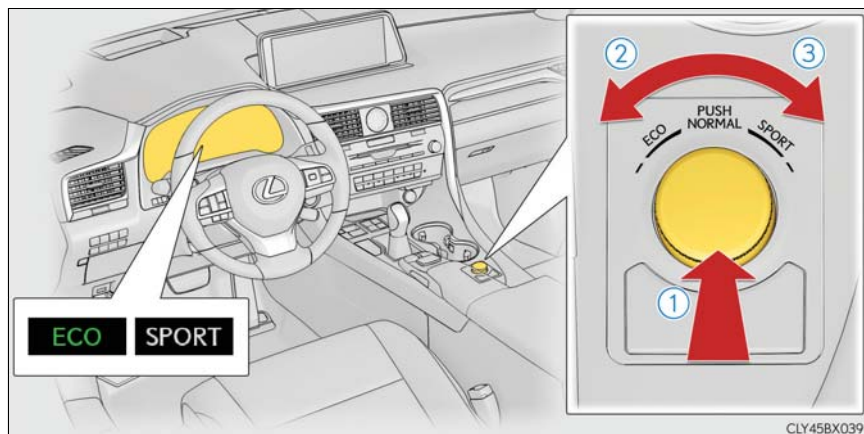

- ① Normal mode  
Provides an optimal balance of fuel economy, quietness, and dynamic performance. Suitable for city driving.  
Press the switch to change the driving mode to normal mode when Eco drive mode or sport mode is selected.
- ② Eco drive mode  
Helps the driver accelerate in an eco-friendly manner and improve fuel economy through moderate throttle characteristics and by controlling the operation of the air conditioning system (heating/cooling).  
When not in Eco drive mode, if the driving mode select switch is turned to the left, the Eco drive mode indicator will come on.
- ③ Sport mode  
Controls the transmission and engine to provide quick, powerful acceleration. This mode also changes the steering feel, making it suitable for when agile driving response is desired, such as when driving on roads with many curves.  
When not in sport mode, if the driving mode select switch is turned to the right, the "SPORT" indicator will come on.

► Vehicles with Adaptive Variable Suspension System

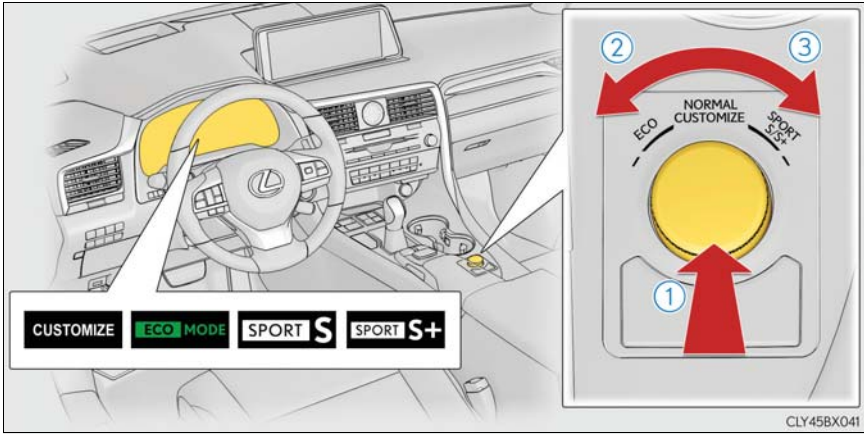

① Normal mode/Customized mode

Normal mode and customized mode are selected by pressing the driving mode select switch. Each time the switch is pressed, the driving mode changes between normal mode and customized mode. When customized mode is selected, the “CUSTOMIZE” indicator will be illuminated.

When Eco drive mode or sport mode is selected, pressing the switch changes the driving mode to normal mode.

- Normal mode

Provides an optimal balance of fuel economy, quietness, and dynamic performance. Suitable for city driving.

- Customized mode

Allows you to drive with the following functions set to your preferred settings.

Customized mode settings can only be changed on the drive mode customization display of the audio system screen.

Function	Setting
Powertrain	Normal
	Power
	Eco
Chassis	Normal
	Sport
Air conditioning system	Normal
	Eco

## ② Eco drive mode

Helps the driver accelerate in an eco-friendly manner and improve fuel economy through moderate throttle characteristics and by controlling the operation of the air conditioning system (heating/cooling).

When not in Eco drive mode, if the driving mode select switch is turned to the left, the Eco drive mode indicator will come on.

## ③ Sport mode

### • SPORT S mode

Controls the transmission and engine to provide quick, powerful acceleration. This mode is suitable for when agile driving response is desired, such as when driving on roads with many curves.

When not in SPORT S mode, if the driving mode select switch is turned to the right, the "SPORT S" indicator will come on.

### • SPORT S+ mode

Helps to ensure steering performance and driving stability by simultaneously controlling the steering and suspension in addition to the transmission and engine. Suitable for sportier driving.

When in SPORT S mode, if the driving mode select switch is turned to the right, the "SPORT S+" indicator will come on.

## Turn Signal Lever

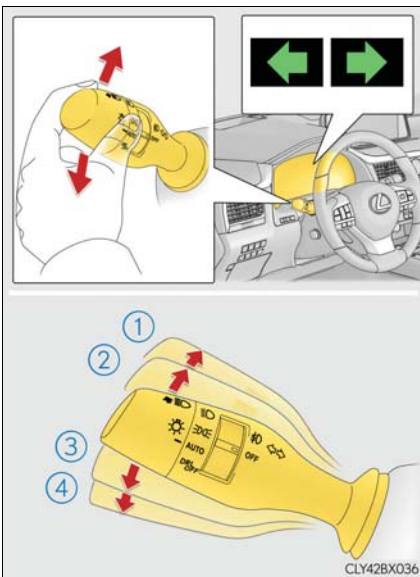

### ① Right turn

② Lane change to the right (move the lever partway and release it)  
The right hand signals will flash 3 times.

③ Lane change to the left (move the lever partway and release it)  
The left hand signals will flash 3 times.

### ④ Left turn



# Parking Brake

## Automatic mode

The parking brake is set or released automatically according to shift lever operation. Even when in automatic mode, the parking brake can be set and released manually.

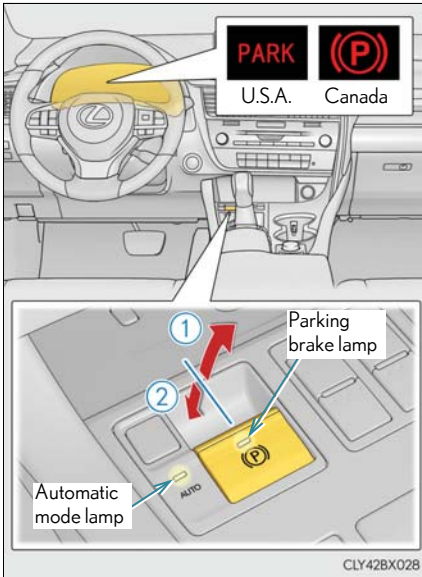

- ① Turns automatic mode on (while the vehicle is stopped, pull and hold the parking brake switch until the automatic mode lamp turns on)

- When the shift lever is moved out of P, the parking brake will be released, and the parking brake indicator light and parking brake lamp turn off.
- When the shift lever is moved into P, the parking brake will be set, and the parking brake indicator light and parking brake lamp turn on.

Operate the shift lever with the brake pedal depressed.

- ② Turns automatic mode off (while the vehicle is stopped, press and hold the parking brake switch until the automatic mode lamp turns off)

## Manual mode

The parking brake can be set and released manually.

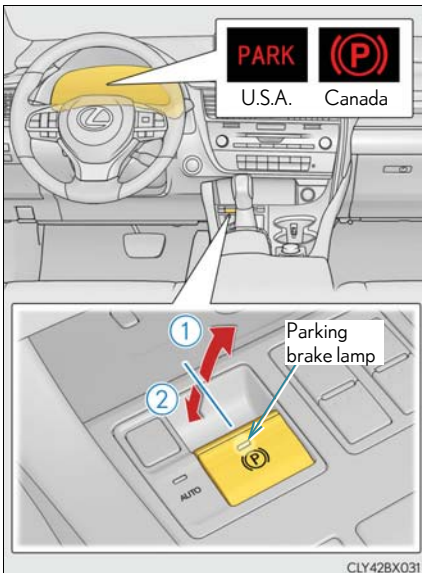

- ① Sets the parking brake  
The parking brake indicator light and parking brake lamp will turn on. Pull and hold the parking brake switch if an emergency occurs and it is necessary to operate the parking brake while driving.

- ② Releases the parking brake  
Operate the parking brake switch while depressing the brake pedal. Make sure that the parking brake indicator light and parking brake lamp turn off.

If the parking brake indicator light and parking brake lamp flashes, operate the switch again.

## Brake Hold

### ► Vehicles without paddle shift switches

The brake hold system keeps the brake applied when the shift lever is in D, S or N with the system on and the brake pedal has been depressed to stop the vehicle.

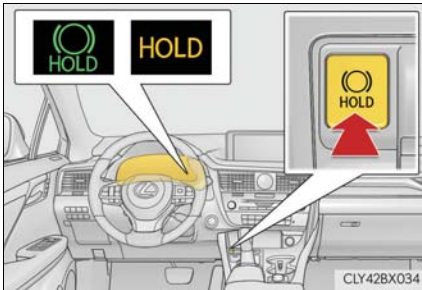

Turns the brake hold system on

The brake hold standby indicator (green) comes on. While the system is holding the brake, the brake hold operated indicator (yellow) comes on.

The system releases the brake when the accelerator pedal is depressed with the shift lever in D or S to allow smooth start off.

### ► Vehicles with paddle shift switches

The brake hold system keeps the brake applied when the shift lever is in D, M or N with the system on and the brake pedal has been depressed to stop the vehicle.

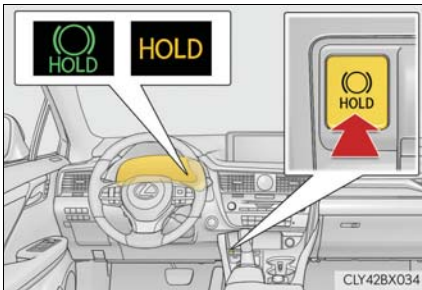

Turns the brake hold system on

The brake hold standby indicator (green) comes on. While the system is holding the brake, the brake hold operated indicator (yellow) comes on.

The system releases the brake when the accelerator pedal is depressed with the shift lever in D or M to allow smooth start off.

## Multi-information Display

The multi-information display presents the driver with a variety of driving-related data, such as the current outside temperature. The multi-information display can also be used to change the display settings and other settings.

### ► Except F SPORT models

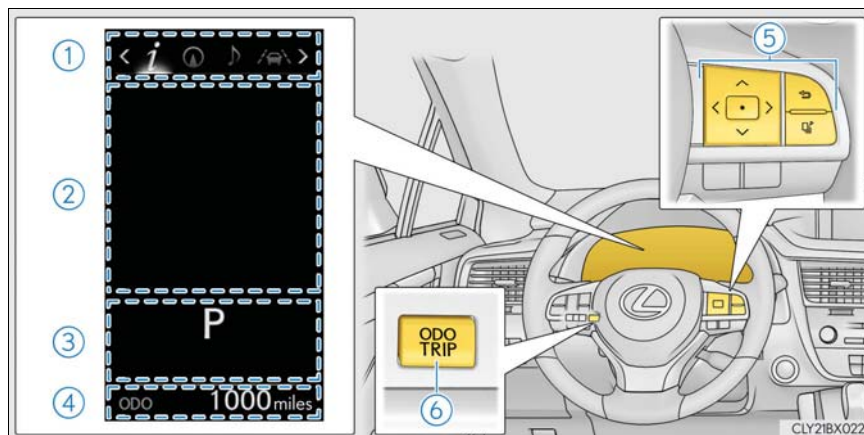

- ① Menu icon display area (→P. 30)  
Displays the following items:  
When a menu icon is not selected, the outside temperature and clock are displayed.
  - Menu icons
  - Outside temperature
  - Clock
- ② Content display area  
A variety of information can be displayed by selecting a menu icon. Additionally, warning or suggestion/advice pop-up displays will be displayed in some situations.
  - Menu icon content
  - Suggestion function
  - Warning message
- ③ Indicator/shift position display area  
Displays the following items:
  - Indicators
  - Shift position display
- ④ Odometer/trip meter display area  
Displays the following items:
  - Odometer/trip meter
  -  Distance until next engine oil change
- ⑤ Meter control switches (→P. 29)
- ⑥ “ODO/TRIP” switch (→P. 29)

► F SPORT models

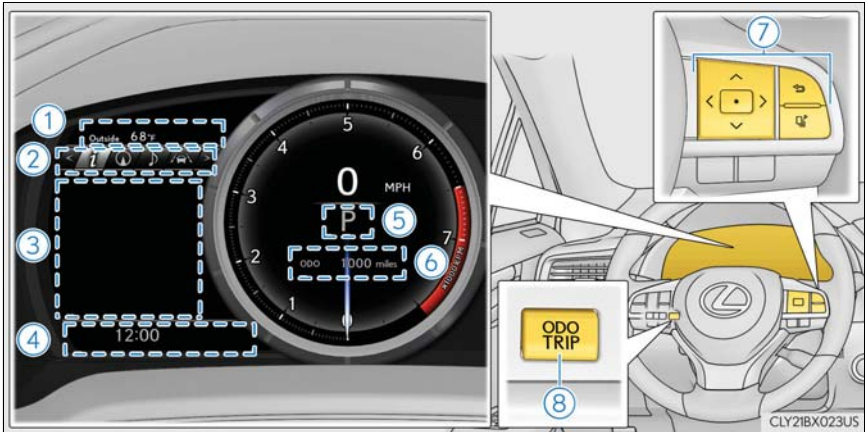





- ① Outside temperature
- ② Menu icons (→P. 30)
- ③ Content display area  
A variety of information can be displayed by selecting a menu icon. Additionally, warning or suggestion/advice pop-up displays will be displayed in some situations.
  - Menu icon content
  - Suggestion function
  - Warning message
- ④ Indicators/clock
  - Indicators
  - Clock
- ⑤ Shift position display
- ⑥ Odometer/trip meter display area  
Displays the following items:
  - Odometer/trip meter
  -  Distance until next engine oil change
- ⑦ Meter control switches (→P. 29)
- ⑧ “ODO/TRIP” switch (→P. 29)

## ■ Using the multi-information display

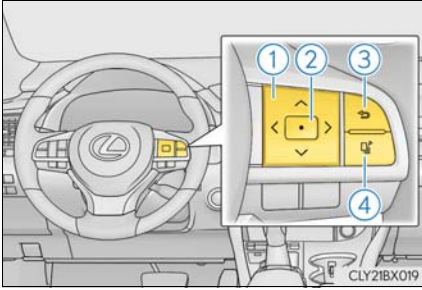
### ■ Using the content display area

The content display area is operated using the meter control switches.



- ①   : Select menu icons
-   : Change displayed content, scroll up/down the screen and move the cursor
- ② Press: Enter/Set  
Press and hold: Reset
- ③ Return to the previous screen  
Pressing and holding the switch will display the first screen of the selected menu icon.
- ④ Press: Display the top screen  
Press and hold: Register current screen as the top screen

### ■ Using the odometer/trip meter display area

Items in this area are operated using the “ODO/TRIP” switch.

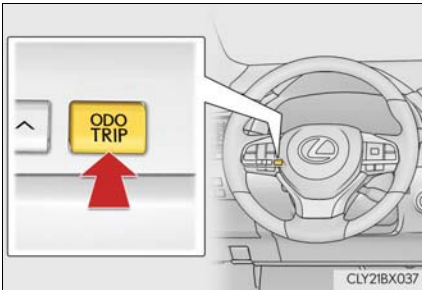

- Press: Change displayed item  
Each time the switch is pressed, the displayed item will be changed.
- Press and hold: Reset  
Display the desired trip meter and press and hold the switch to reset the trip meter.

## ■ Menu icons

---

Select a menu icon to display its content.



Drive information

Select to display various drive data.



Navigation system-linked display (if equipped)

Select to display the following navigation system-linked information.

- Route guidance
- Compass display (heading-up display)



Audio system-linked display

Select to enable selection of an audio source or track on the meter using the meter control switches.



Driving assist system information (if equipped)

Select to display the operational status of the following systems:

- Dynamic radar cruise control with full-speed range
- LKA (Lane-Keeping Assist)



Warning message display

Select to display warning messages and measures to be taken if a malfunction is detected.



Settings display



Select to change the meter display settings and other settings.

If a problem is detected in any of the vehicle's systems, a warning message is shown on the multi-information display.

## Head-up Display (if equipped)

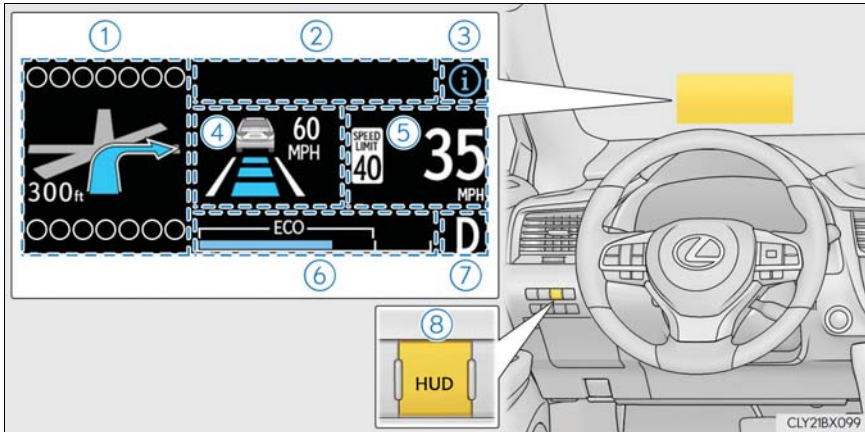
The head-up display is linked to the meters and navigation system (if equipped) and projects a variety of information in front of the driver, such as the current vehicle speed and route guidance to a set destination.



- ① Navigation system-linked display area (if equipped)  
Displays the following items, which are linked to the navigation system:
  - Street name
  - Route guidance to destination
  - Compass
- ② Message display area  
Displays the following items:
  - Pre-collision warning (Pre-collision system) (if equipped)
  - Alert from the Intelligent Clearance Sonar system (if equipped)
  - Notification message (Dynamic radar cruise control with full-speed range) (if equipped)
  - Audio system operation status
  - Outside temperature
- ③  /  icon (→P. 32)
- ④ Driving assist system status display area (if equipped)  
Displays the operational status of the following systems:
  - Dynamic radar cruise control with full-speed range
  - LKA (Lane-Keeping Assist)
  - Intuitive parking assist
  - Intelligent Clearance Sonar (ICS)Displayed content is the same as that displayed on the multi-information display. For details, refer to the explanations of each system.

- ⑤ Vehicle speed display area  
Displays the following items:
  - Vehicle speed
  - Speed limit (vehicles with a navigation system)
- ⑥ Eco Driving Indicator/Tachometer (→P. 33)
- ⑦ Shift position display
- ⑧ HUD (Head-up display) switch

## ■ Using the head-up display

---

### ■ Enabling/Disabling the head-up display

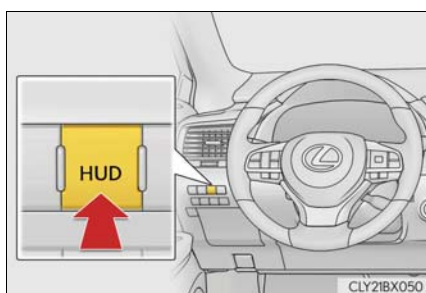

Press the HUD (Head-up display) switch.

### ■ Changing settings of the head-up display



Select  on the multi-information display to change the following settings:

- Display brightness/position  
Select to adjust the brightness and position of the head-up display.
- Display content  
Select to enable/disable the following items:
  - Route guidance to destination (if equipped)
  - Driving assist system status (if equipped)
  - Compass (if equipped)
  - Audio system operation status
- Eco Driving Indicator/Tachometer  
Select to display Eco Driving Indicator/tachometer/no content.

### ■ icons

---

Displays the following multi-information display linked icons:

- : Master warning icon  
Displayed when a warning message is displayed on the multi-information display.
- : Information icon  
Displayed when a suggestion/advice pop-up display is displayed on the multi-information display.



## Eco Driving Indicator/Tachometer

### Eco Driving Indicator

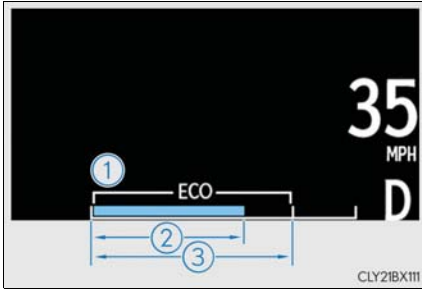

- ① Eco Driving Indicator Zone Display
- ② Eco driving ratio based on acceleration
- ③ Zone of Eco driving  
Displayed content is the same as that displayed on the multi-information display (Eco Driving Indicator). For details, refer to P. 33.

### Tachometer

Displays the engine speed in revolutions per minute.

The head-up display may seem dark or hard to see when viewed through sunglasses, especially polarized sunglasses.  
Adjust the brightness of the head-up display or remove your sunglasses.

## Eco Driving Indicator

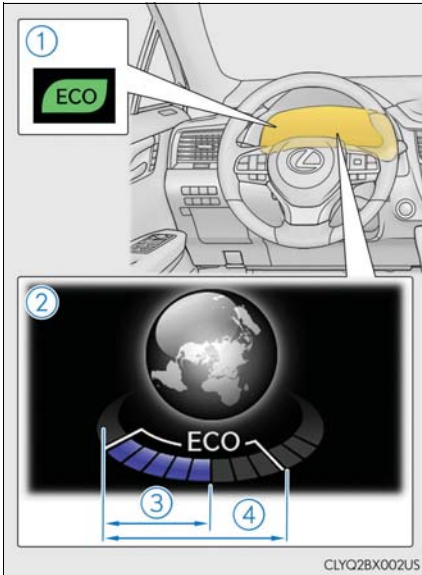

- ① Eco Driving Indicator Light  
During Eco-friendly acceleration (Eco driving), the Eco Driving Indicator Light will turn on. When the acceleration exceeds the Zone of Eco driving, or when the vehicle is stopped, the light turns off.
- ② Eco Driving Indicator Zone Display  
Suggests the Zone of Eco driving with current Eco driving ratio based on acceleration.
- ③ Eco driving ratio based on acceleration  
If the acceleration exceeds the Zone of Eco driving, the right side of the Eco Driving Indicator Zone Display will illuminate.
- ④ Zone of Eco driving

Eco Driving Indicator will not operate under the following conditions:

- The shift lever is in any position other than D.
- A paddle shift switch (if equipped) is operated.
- Sport mode is selected.
- The vehicle speed is approximately 80 mph (130 km/h) or higher.

# Headlights

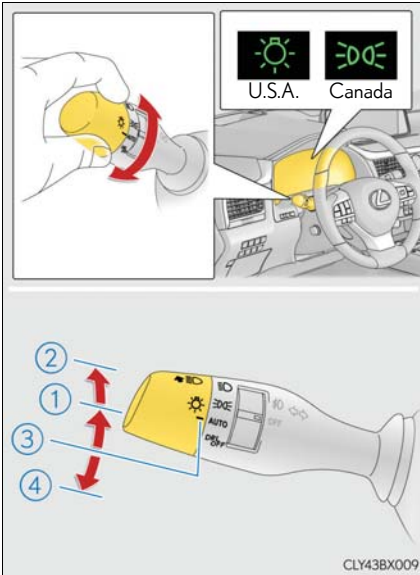

- ① The side marker, parking, tail, license plate and instrument panel lights turn on.
- ② The headlights and all the lights listed above turn on.
- ③ **AUTO** When the engine switch is in **IGNITION ON** mode, the headlights and all the lights listed above turn on and off automatically.
- ④ **DRL OFF** Off (U.S.A.)  
 The daytime running lights turn on. (Canada)

## Turning on the high beam headlights

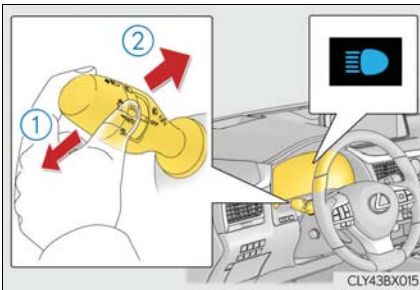

- ① With the headlights on, push the lever away from you to turn on the high beams. Pull the lever toward you to the center position to turn the high beams off.
- ② Pull the lever toward you and release it to flash the high beams once. You can flash the high beams with the headlights on or off.

## AFS (Adaptive Front-lighting System) (if equipped)

AFS (Adaptive Front-lighting System) secures excellent visibility at intersections and on curves by automatically adjusting the direction of the light axis of the headlights according to vehicle speed and the degree of the tire's angle as controlled by steering input.

AFS operates at speeds of 6 mph (10 km/h) or higher.

## Automatic High Beam (if equipped)

The Automatic High Beam uses a camera sensor located behind the upper portion of the windshield to assess the brightness of the lights of vehicles ahead, streetlights, etc., and automatically turns the high beams on or off as necessary.

### ■ Activating the Automatic High Beam

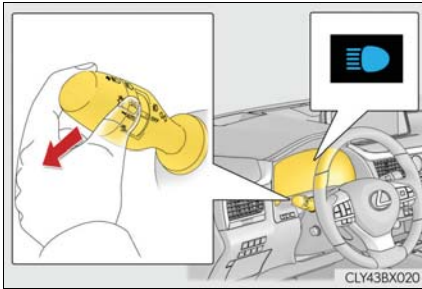

- 1** Push the lever away from you with the headlight switch in the  or **AUTO** position.

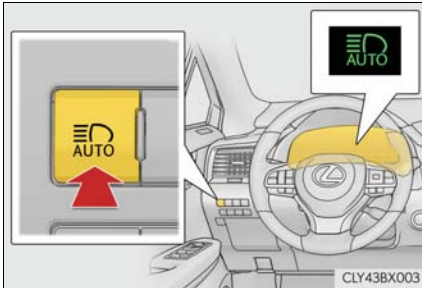

- 2** Press the Automatic High Beam switch. The Automatic High Beam indicator will come on when the system is operating.

### ■ Turning the high beams on/off manually

- Switching to the low beams

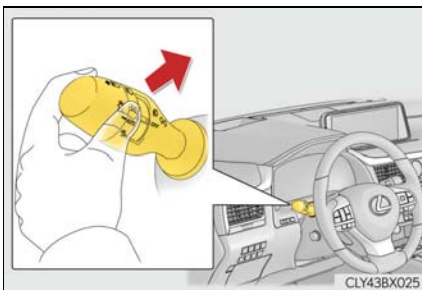

Pull the lever to its original position.

The Automatic High Beam indicator will turn off.

Push the lever away from you to activate the Automatic High Beam system again.

● Switching to the high beams

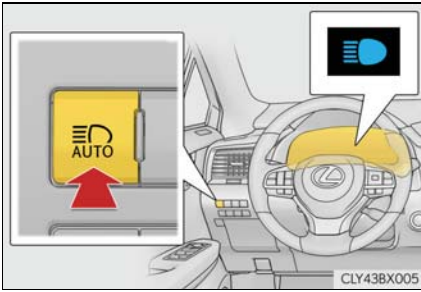



Press the Automatic High Beam switch.

The Automatic High Beam indicator will turn off and the high beam indicator will turn on.

Press the switch to activate the Automatic High Beam system again.

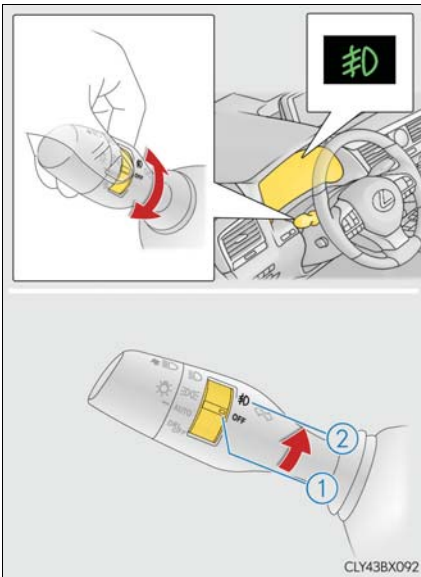
## Fog Lights



- ① OFF (U.S.A.) or ○ (Canada)  
Turns the fog lights off
- ②  Turns the front fog lights on

# Windshield Wipers and Washer

## ► Intermittent windshield wipers with interval adjuster

Wiper intervals can be adjusted when intermittent operation is selected. The interval of intermittent operation varies according to vehicle speed.

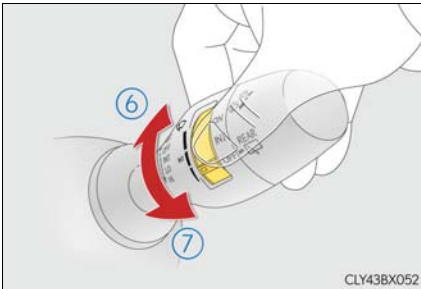
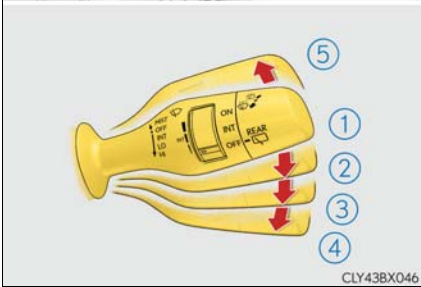
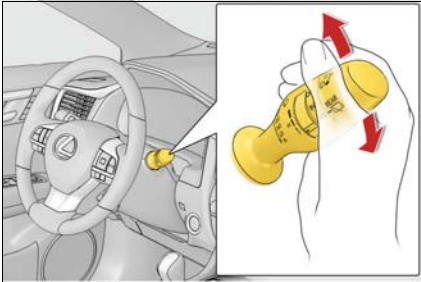

① **OFF** (U.S.A.) or ○ (Canada)  
Off

② **INT** (U.S.A.) or ◀ (Canada)  
Intermittent operation  
The intermittent windshield wiper operates more frequently as vehicle speed becomes higher.

③ **LO** (U.S.A.) or ▼ (Canada)  
Low speed operation

④ **HI** (U.S.A.) or ▼ (Canada)  
High speed operation

⑤ **MIST** (U.S.A.) or ▲ (Canada)  
Temporary operation

⑥ Increases the intermittent windshield wiper frequency

⑦ Decreases the intermittent windshield wiper frequency

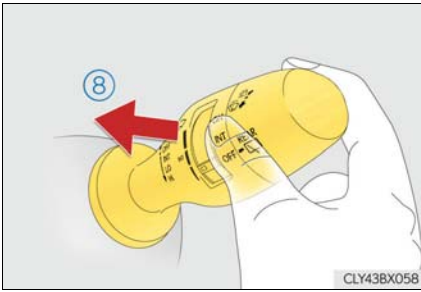

- ⑧ **Washer/wiper dual operation**  
The wipers will automatically operate a couple of times after the washer squirts.  
Vehicles with headlight cleaners:  
When the engine switch is in IGNITION ON mode and the headlights are on, if the lever is pulled, the headlight cleaners will operate once. After this, the headlight cleaners will operate every 5th time the lever is pulled.

► **Rain-sensing windshield wipers**

When "AUTO" is selected, the wipers will operate automatically when the sensor detects falling rain. The system automatically adjusts wiper timing in accordance with rain volume and vehicle speed.

The sensor sensitivity can be adjusted when "AUTO" is selected.

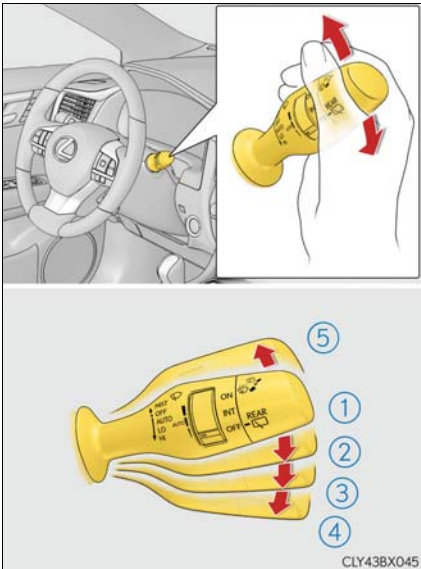

- ① **OFF** (U.S.A.) or ○ (Canada)  
Off
- ② **AUTO** Rain-sensing operation
- ③ **LO** (U.S.A.) or ▼ (Canada)  
Low speed operation
- ④ **HI** (U.S.A.) or ▼ (Canada)  
High speed operation
- ⑤ **MIST** (U.S.A.) or ▲ (Canada)  
Temporary operation

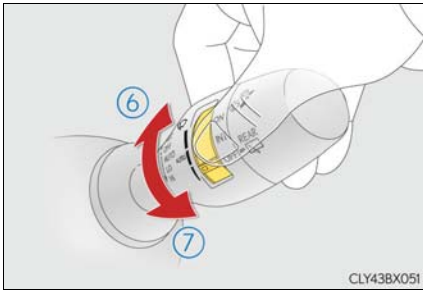

- ⑥ Increases the sensitivity
- ⑦ Decreases the sensitivity

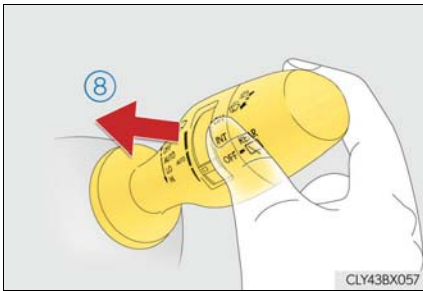

- ⑧ Washer/wiper dual operation  
The wipers will automatically operate a couple of times after the washer squirts.  
Vehicles with headlight cleaners:  
When the engine switch is in IGNITION ON mode and the headlights are on, if the lever is pulled, the headlight cleaners will operate once. After this, the headlight cleaners will operate every 5th time the lever is pulled.

## Rear Window Wiper and Washer

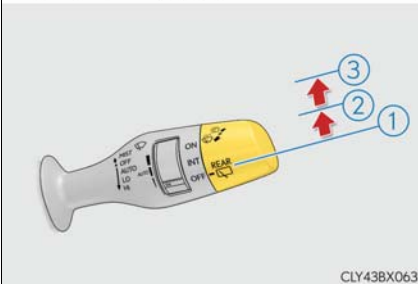
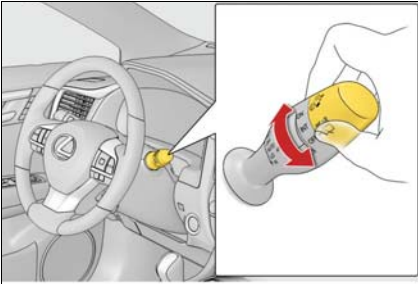

CLY43BX063

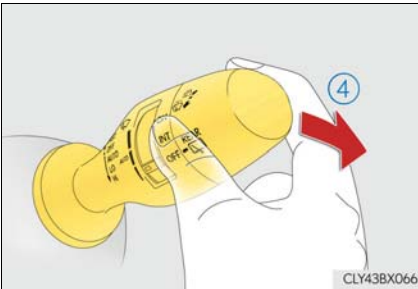

CLY43BX066

- ① **OFF** (U.S.A.) or ○ (Canada)  
Off
- ② **INT** (U.S.A.) or - - - (Canada)  
Intermittent operation
- ③ **ON** (U.S.A.) or — (Canada)  
Normal operation

- ④ **Washer/wiper dual operation**  
The wiper will automatically operate a couple of times after the washer squirts.



## **Lexus Safety System+ (if equipped)**

The Lexus Safety System+ consists of the following drive assist systems and contributes to a safe and comfortable driving experience:

### **■ PCS (Pre-Collision System)**

---

The pre-collision system uses a radar sensor and camera sensor to detect vehicles and pedestrians\* in front of your vehicle. When the system determines that the possibility of a frontal collision with a vehicle or pedestrian is high, a warning operates to urge the driver to take evasive action and the potential brake pressure is increased to help the driver avoid the collision. If the system determines that the possibility of a frontal collision with a vehicle or pedestrian is extremely high, the brakes are automatically applied to help avoid the collision or help reduce the impact of the collision.

### **■ LKA (Lane-Keeping Assist)**

---

→P. 47

### **■ Automatic High Beam**

---

→P. 35

### **■ Dynamic radar cruise control with full-speed range**

---

→P. 42

\*: Depending on the region in which the vehicle was sold, the pedestrian detection function may not be available. For details, refer to the "OWNER'S MANUAL".

## Dynamic Radar Cruise Control with Full-speed Range (if equipped)

In vehicle-to-vehicle distance control mode, the vehicle automatically accelerates, decelerates and stops to match the speed changes of the preceding vehicle even if the accelerator pedal is not depressed. In constant speed control mode, the vehicle runs at a fixed speed.

Use the dynamic radar cruise control with full-speed range on freeways and highways.

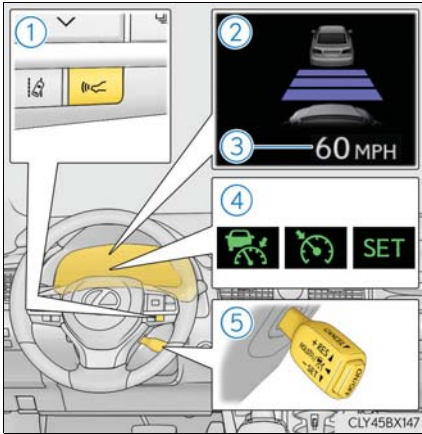

- 1 Vehicle-to-vehicle distance button
- 2 Display
- 3 Set speed
- 4 Indicators
- 5 Cruise control switch

### Setting the vehicle speed (vehicle-to-vehicle distance control mode)

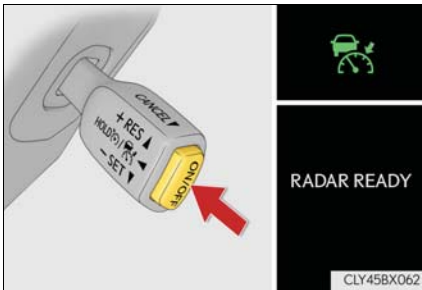

- 1 Press the "ON/OFF" button to activate the cruise control.

Radar cruise control indicator will come on and a message will be displayed on the multi-information display.

Press the button again to deactivate the cruise control.



- 2 Accelerate or decelerate, with accelerator pedal operation, to the desired vehicle speed (above approximately 30 mph [50 km/h]) and push the lever down to set the speed.

Cruise control "SET" indicator will come on.

The vehicle speed at the moment the lever is released becomes the set speed.

## ■ Adjusting the set speed

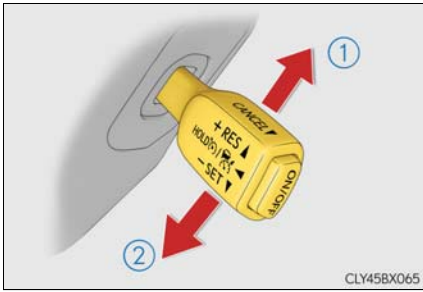

- ① Increases the speed  
(Except when the vehicle has been stopped by system control in vehicle-to-vehicle distance control mode)
- ② Decreases the speed  
Fine adjustment: Momentarily move the lever in the desired direction.  
Large adjustment: Hold the lever up or down to change the speed, and release when the desired speed is reached.

## ■ Changing the vehicle-to-vehicle distance (vehicle-to-vehicle distance control mode)

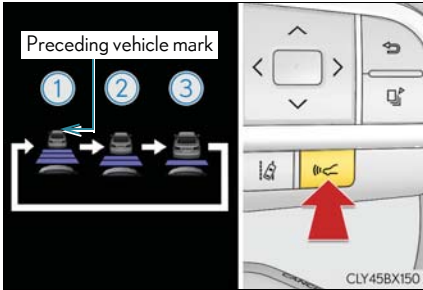

Pressing the button changes the vehicle-to-vehicle distance as follows:

- ① Long
  - ② Medium
  - ③ Short
- The vehicle-to-vehicle distance is set automatically to long mode when the engine switch is turned to IGNITION ON mode.
- If a vehicle is running ahead of you, the preceding vehicle mark will also be displayed.

The vehicle-to-vehicle distance control mode maintains the preset cruising speed as long as no vehicle is detected ahead.

## ■ Resuming follow-up cruising when the vehicle has been stopped by system control (vehicle-to-vehicle distance control mode)

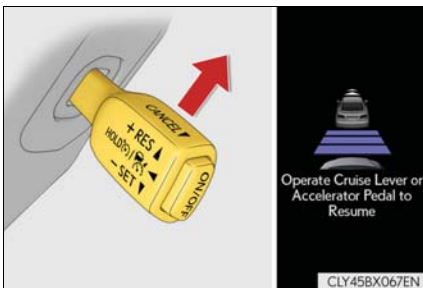

After the vehicle ahead of you starts off, push the lever up.

Your vehicle will also resume follow-up cruising if the accelerator pedal is depressed after the vehicle ahead of you starts off.

## ■ Canceling and resuming the speed control

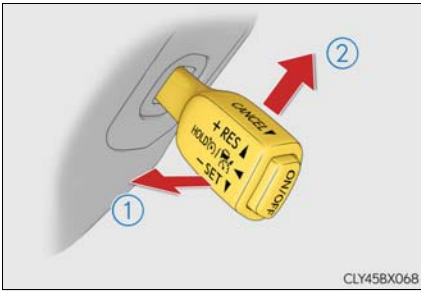

- 1 Pulling the lever toward you cancels the speed control.  
The speed control is also canceled when the brake pedal is depressed. (When the vehicle has been stopped by system control, depressing the brake pedal does not cancel the setting.)
- 2 Pushing the lever up resumes the cruise control and returns vehicle speed to the set speed.  
However, when a vehicle ahead is not detected, cruise control does not resume when the vehicle speed is approximately 25 mph (40 km/h) or less.

## ■ Selecting constant speed control mode

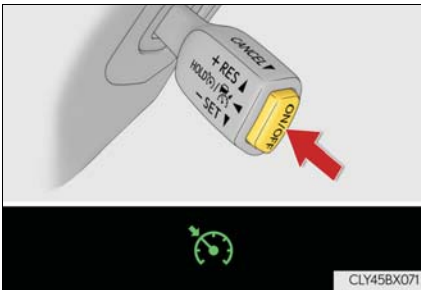

- 1 With the cruise control off, press and hold the "ON/OFF" button for 1.5 seconds or more.  
Immediately after the "ON/OFF" button is pressed, the radar cruise control indicator will come on. Afterwards, it switches to the cruise control indicator.  
Switching to constant speed control mode is only possible when operating the lever with the cruise control off.

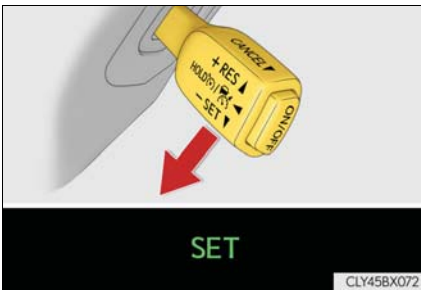

- 2 Accelerate or decelerate, with accelerator pedal operation, to the desired vehicle speed (above approximately 30 mph [50 km/h]) and push the lever down to set the speed.  
Cruise control "SET" indicator will come on.  
The vehicle speed at the moment the lever is released becomes the set speed.

## Cruise Control (if equipped)

Use the cruise control to maintain a set speed without operating the accelerator pedal.

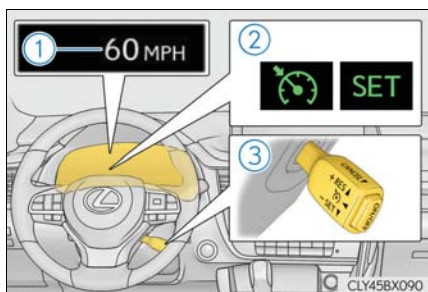

- 1 Set speed
- 2 Indicators
- 3 Cruise control switch

### Setting the vehicle speed

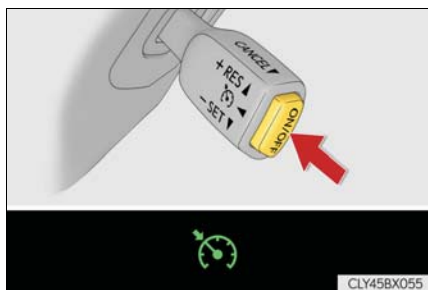

- 1 Press the "ON/OFF" button to activate the cruise control.

Cruise control indicator will be displayed on the multi-information display.

Press the button again to deactivate the cruise control.

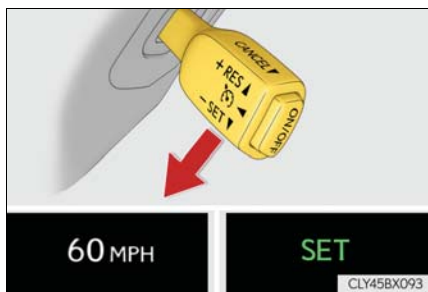

- 2 Accelerate or decelerate, with accelerator pedal operation, to the desired vehicle speed (above approximately 25 mph [40 km/h]) and push the lever down to set the speed.

Cruise control "SET" indicator and set speed will be displayed on the multi-information display.

The vehicle speed at the moment the lever is released becomes the set speed.

## ■ Adjusting the set speed

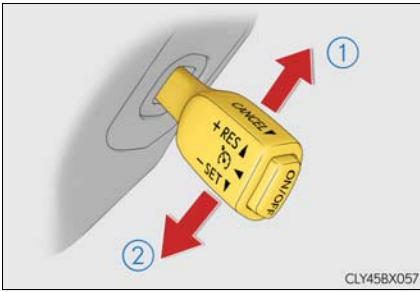

① Increases the speed

② Decreases the speed

Fine adjustment: Momentarily move the lever in the desired direction.

Large adjustment: Hold the lever in the desired direction.

## ■ Canceling and resuming the constant speed control

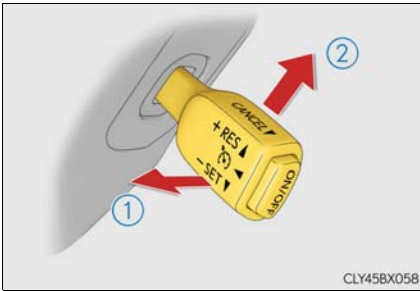

① Pulling the lever toward you cancels the constant speed control.

The speed setting is also canceled when the brake pedal is depressed.

② Pushing the lever up resumes the constant speed control.

However, resuming is available when the vehicle speed is more than approximately 25 mph (40 km/h).

## LKA (Lane-Keeping Assist) (if equipped)

When driving on highways and freeways with white or yellow lines, this function alerts the driver when the vehicle might depart from its lane and provides assistance by operating the steering wheel to keep the vehicle in its lane. Furthermore, the system also provides steering assistance when dynamic radar cruise control with full-speed range is operating to keep the vehicle in its lane.

### Turning LKA system on

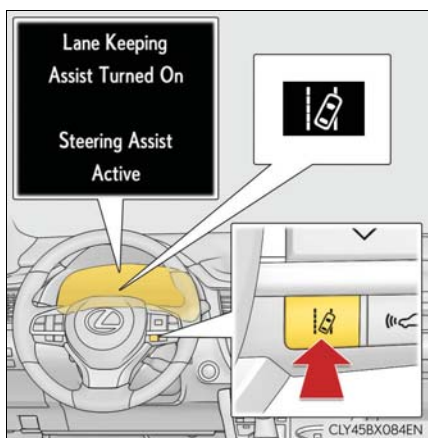

Press the LKA switch to turn the LKA system on.

The LKA indicator illuminates and a message is displayed on the multi-information display.

Press the LKA switch again to turn the LKA system off.

When the LKA system is turned on or off, operation of the LKA system continues in the same condition the next time the engine is started.

## Tire Pressure Warning System

Your vehicle is equipped with a tire pressure warning system that uses tire pressure warning valves and transmitters to detect low tire inflation pressure before serious problems arise.

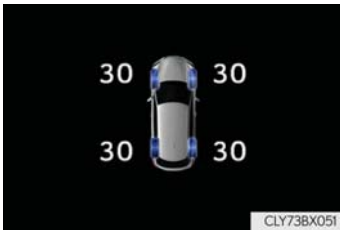

### The tire inflation pressure display function





The tire pressure detected by the tire pressure warning system can be displayed on the multi-information display.

### Initializing the tire pressure warning system

1 Select  on the multi-information display.

2 Press  or  of the meter control switch, select the "Vehicle Settings" screen and then press the .



Press  or  of the meter control switch, select the "TPMS" screen and then press and hold the  until the tire pressure warning light blinks slowly 3 times.

"- -" will be displayed for inflation pressure of each tire on the multi-information display while the tire pressure warning system determines the position of each tire.

When position of each tire is determined, the inflation pressure of each tire will be displayed on the multi-information display.

4 Drive the vehicle at approximately 25 mph (40 km/h) or more for approximately 10 to 30 minutes until the inflation pressure of each tire is displayed on the multi-information display.

If tire inflation pressure becomes low before the inflation pressure is displayed, the tire pressure warning light will come on.

Depending on the vehicle and driving conditions, initialization may take up to approximately 1 hour to complete.



## Intuitive Parking Assist (if equipped)

The distance from your vehicle to nearby obstacles when parallel parking or maneuvering into a garage is measured by the sensors and communicated via the displays and a buzzer. Always check the surrounding area when using this system.

### Turning the intuitive parking assist on/off







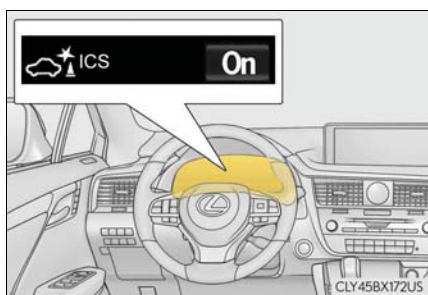

- 1 Press “<” or “>” of the meter control switches, select .
- 2 Press “^” or “v” of the meter control switches, select “Parking Assist”.  
When on, the indicator light comes on to inform the driver that the system is operational.

## Intelligent Clearance Sonar (ICS) (if equipped)

If a collision with an object may occur due to the vehicle suddenly moving forward due to an accidental accelerator pedal operation, the vehicle moving the unintended direction due to the wrong shift position being selected, or while parking or traveling at low speeds, the sensors detect objects, such a wall, in the traveling direction of the vehicle, and the system operates to lessen an impact with an object and reduce the resulting damage.

### Turning the Intelligent Clearance Sonar system on/off



- 1 Select  on the multi-information display.
- 2 Press  or  of the meter control switch and select “ICS”.
- 3 Press  of the meter control switch.
- 4 Select the “Yes” and push .

## Panoramic View Monitor (if equipped)

Panoramic view monitor assists the driver in viewing the surroundings, when operating at low speeds, by combining the front, side and rear cameras and displaying a vehicle overhead image on the screen.

### Camera switch

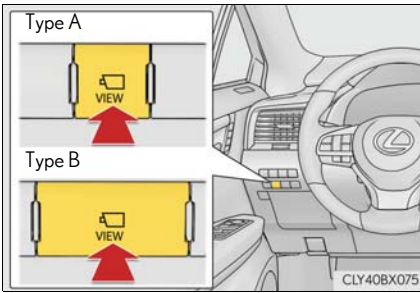

The camera switch is located as shown in the illustration.



## BSM (Blind Spot Monitor) (if equipped)

The Blind Spot Monitor is a system that has 2 functions;

- The BSM (Blind Spot Monitor) function  
Assists the driver in making a decision when changing lanes
- The RCTA (Rear Cross Traffic Alert) function  
Assists the driver when backing up

These functions use same sensors.

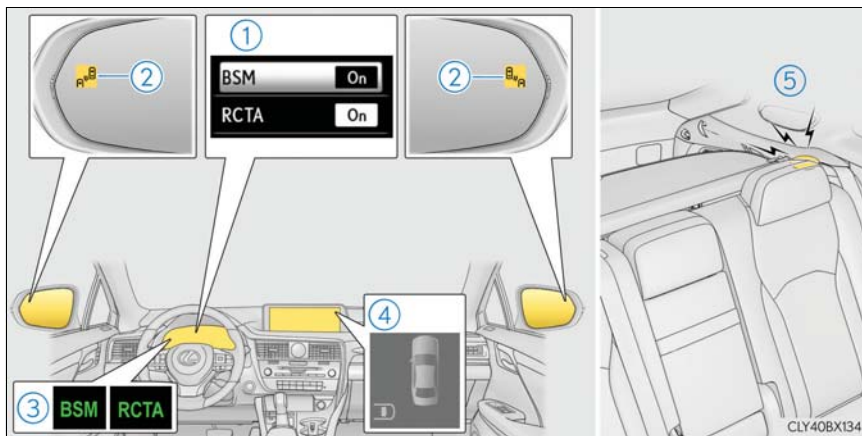

- ① Multi-information display  
Turning the BSM function/RCTA function on/off.  
The RCTA function is available when the BSM function is on.
- ② Outside rear view mirror indicators  
BSM function:  
When a vehicle is detected in a blind spot of the outside rear view mirrors or approaching rapidly from behind into a blind spot, the outside rear view mirror indicator on the detected side will illuminate. If the turn signal lever is operated toward the detected side, the outside rear view mirror indicator flashes.  
RCTA function:  
When a vehicle approaching from the right or left at the rear of the vehicle is detected, both outside rear view mirror indicators will flash.
- ③ "BSM" indicator/"RCTA" indicator  
When the BSM function/RCTA function is turned on, the indicator illuminates.
- ④ Monitor screen display (RCTA function only) (if equipped)  
If a vehicle approaching from the right or left at the rear of the vehicle is detected, the RCTA icon for the detected side will be displayed on the monitor screen.  
This illustration shows an example of a vehicle approaching from the left at the rear of the vehicle.
- ⑤ RCTA buzzer (RCTA function only)  
If a vehicle approaching from the right or left at the rear of the vehicle is detected, a buzzer will sound. The buzzer also sounds for approximately 1 second immediately after the BSM function is operated to turn the system on.

## Remote Touch (with Navigation System)

The Remote Touch can be used to operate the Remote Touch screens.

### Basic operation

#### ▶ Vehicles with 8-inch display

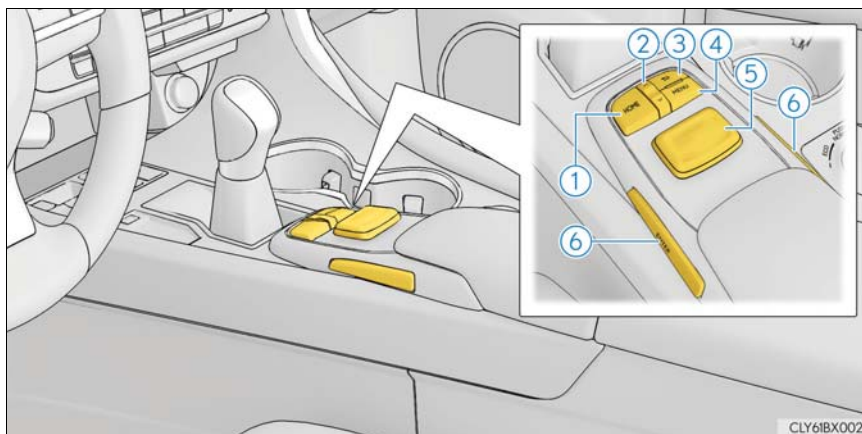

#### ▶ Vehicles with 12.3-inch display

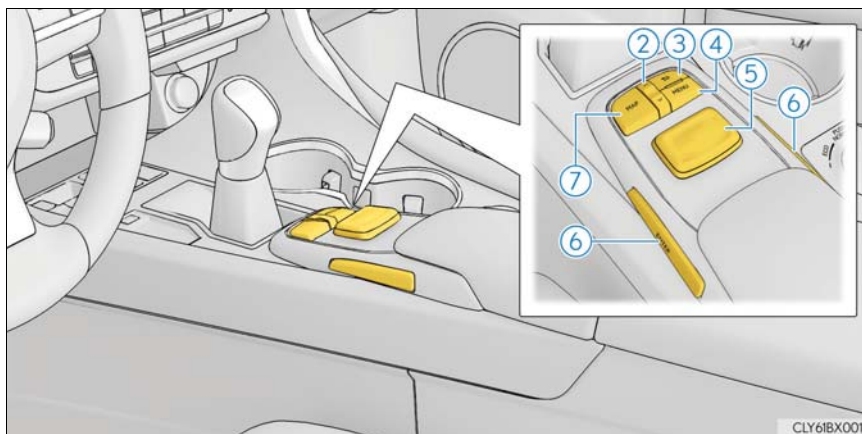

- ① “HOME” button  
Press this button to display the home screen.
- ② “^•v” button  
Press this button to change map scale and scroll through lists.
- ③ Back button  
Press to display the previous screen.
- ④ “MENU” button  
Press to display the “Menu” screen. (→P.54)

- ⑤ Remote Touch knob  
Move in the desired direction to select a function, letter and screen button.  
Press the knob to enter the selected function, letter or screen button.
- ⑥ “ENTER” button  
Press to enter the selected function, letter or screen button.
- ⑦ “MAP” button  
Press this button to display the vehicle’s current position.

## ■ Menu

### ▶ With 8-inch display



Press the “MENU” button on the Remote Touch to display the “Menu” screen.

- ① “Destination” (→P.57)
- ② “Radio” (→P.62)
- ③ “Media” (→P.61)
- ④ “Phone” (→P.58)
- ⑤ “LEXUS App Suite”
- ⑥ “Info”
- ⑦ “Climate” (→P.75)
- ⑧ “Setup”
- ⑨ “Display” (→P.55)

### ▶ With 12.3-inch display



## ■ Side Display



The following functions can be displayed and operated on the side display.

- ① Navigation
- ② Audio
- ③ Phone
- ④ Vehicle information
- ⑤ Air conditioning system (→P.75)

## ■ Display



Press the “MENU” button on the Remote Touch and select “Display” on the “Menu” screen.

- ① Turns the screen off
- ② Displays the screen in “Day Mode” with the headlight switch on
- ③ Adjust the screen display
- ④ Adjust the camera display

## ■ Screen scroll operation

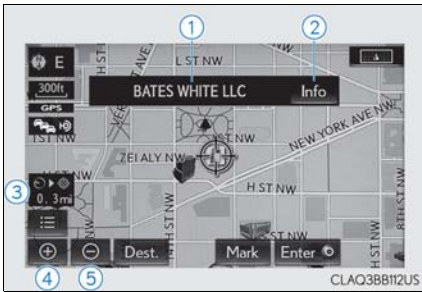

To scroll over the map, place the cursor mark in the desired position and then press and hold the Remote Touch knob.

- ① Indicates the street name, city name, etc. for the selected point
- ② Displays various information for the selected point
- ③ Indicates the distance from the current position to the cursor mark
- ④ Zooms in on the map
- ⑤ Zooms out on the map

## ■ Setting a route

While route guidance is operating, you can change the route using the following method.



### ▶ With 8-inch display

- ① Press the “MENU” button on the Remote Touch, then select “Nav.”.

### ▶ With 12.3-inch display

- ① Press the “MAP” button on the Remote Touch.
- ② Select .
- ③ Select “Edit Route”.



- 4** The following settings can be accessed.
- ① Adding destinations
  - ② Deleting destinations
  - ③ Reordering destinations
  - ④ Route preferences
  - ⑤ Route type
  - ⑥ Detour setting
  - ⑦ Starting from adjacent road

Some functions are unavailable while the vehicle is in motion. Refer to the "NAVIGATION SYSTEM OWNER'S MANUAL".

## Navigation System (if equipped)

### Register home

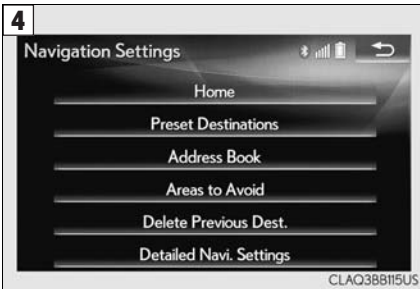

- 1** Press the "MENU" button on the Remote Touch.  
Please refer to page 53 for the Remote Touch operation.
- 2** Select "Setup".
- 3** Select "Navigation".
- 4** Select "Home".

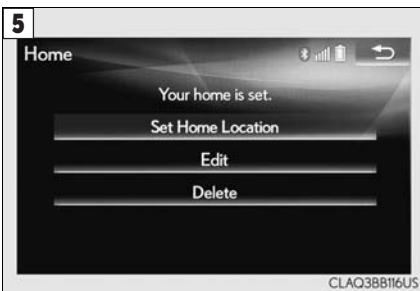

- 5** Select "Set Home Location".
- 6** Select "Address".
- 7** Select "City".
- 8** Enter a city name and select "OK".
- 9** Select the desired city name.
- 10** Enter a street name and select "OK".
- 11** Select the desired street name.
- 12** Enter a house number and select "OK".
- 13** Select "Enter".
- 14** Select "OK".



## Destination search

### Search by address



#### ► With 8-inch display

1 Press the “MENU” button on the Remote Touch, then select “Nav.”

#### ► With 12.3-inch display

1 Press the “MAP” button on the Remote Touch.

Please refer to page 53 for the Remote Touch operation.

2 Select “Dest.”

3 Select “Address”.

#### ► Search by city



4 Select “City”.

5 Enter a city name and select “OK”.

6 Select the desired city name.

7 Enter a street name and select “OK”.

8 Select the desired street name.

9 Enter a house number and select “OK”.

10 Select “Go”.

11 Select “OK”.

#### ► Search by street address



4 Select “Street Address”.

5 Enter a house number and select “OK”.

6 Enter a street name and select “OK”.

7 Select the desired street name.

8 Enter a city name and select “OK”.

9 Select the desired city name.

10 Select “Go”.

11 Select “OK”.

## Search by point of interest



### ▶ With 8-inch display

- 1 Press the "MENU" button on the Remote Touch, then select "Nav."

### ▶ With 12.3-inch display

- 1 Press the "MAP" button on the Remote Touch.  
Please refer to page 53 for the Remote Touch operation.
- 2 Select "Dest."
- 3 Select "Point of Interest".

## Hands-free System For Cellular Phone (with Navigation System)

### Bluetooth® phone pairing

To use the hands-free system, it is necessary to register a Bluetooth® phone with the system. Please refer to the cellular phone manufacturer's user guide for pairing procedures, or go to <http://www.lexus.com/MobileLink> for more phone information.



- 1 Turn the Bluetooth® connection setting of your cellular phone on.
- 2 Press the "MENU" button on the Remote Touch.  
Please refer to page 53 for the Remote Touch operation.
- 3 Select "Phone".



- 4 Select "Yes" to register a phone.



**5** When this screen is displayed, search for the device name displayed on this screen on the screen of your Bluetooth® device.

**6** Register the Bluetooth® device using your Bluetooth® device.



**7** Check that a confirmation screen is displayed indicating pairing was successful.

**8** Check that “Connected” is displayed and registration is complete.

## Contact transfer



**1** Press the “MENU” button on the Remote Touch. Please refer to page 53 for the Remote Touch operation.

**2** Select “Setup”.

**3** Select “Phone”.

**4** Select “Contact/Call History”.

**5** Select the desired contact to add to the favorites list.

**6** Check that a confirmation screen is displayed when the operation is complete.

Contact transfer may not be possible depending on phone model.

## ■ Calling by name

You can call by giving a name registered in the contact list. For details, refer to the “NAVIGATION SYSTEM OWNER’S MANUAL”.

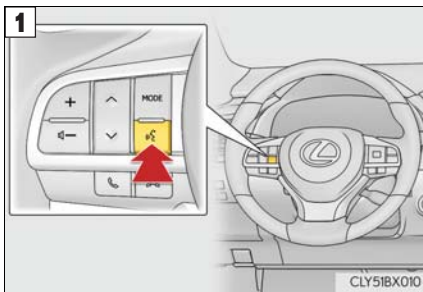

- 1 Press the talk switch.
- 2 Say “Call <contacts> <phone types>”.  
In the same manner as it is displayed on the screen, “Call <contacts> <phone types>”, after saying “Call a contact” say the name, or the name and type of phone, of a contact.  
For example: “Call a contact”, “John Smith” or “Call a contact”, “Mary Davis”, “Mobile”

Talk switch: Pressing this switch turns the voice command system on. Say a command after the beep.

## ■ Receiving a call

When a call is received, call screen is displayed with a sound.

Call screen can also be displayed on the side display.

Press  on the steering wheel to talk on the phone.

To refuse to receive the call, press  on the steering wheel.

## ■ Steering switches

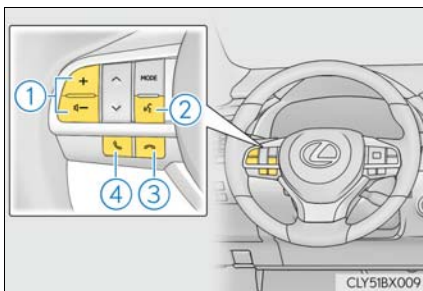

- ① Increases/decreases volume
- ② Start the voice command system
- ③ End call/Refuse call
- ④ Sending/Receiving/Phone top screen display

## Audio System (with Navigation System)

### Audio control screen

Follow the procedure below to display the audio control screen.



- 1 Press the "MENU" button on the Remote Touch.  
Please refer to page 53 for the Remote Touch operation.  
The "Menu" screen will be displayed.
- 2 Using the Remote Touch, select "Radio" or "Media".

### Remote control (steering wheel audio switches)

Some audio features can be controlled using the switches on the steering wheel.

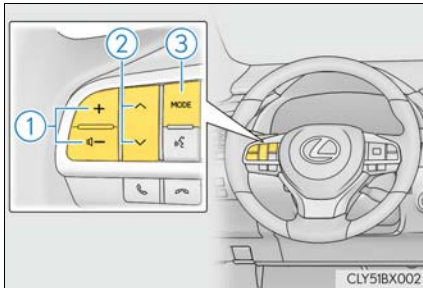

- 1 Adjust volume
- 2 Radio mode: Select a radio station/channel  
Audio CD mode: Select a track  
MP3/WMA/AAC disc mode: Select a file  
DVD mode: Select a chapter  
iPod mode: Select a track/file
- 3 Select audio source  
Play/Pause  
Turn mute on/off

## Basic operation



- 1 Display the audio source selection screen
- 2 Display the sound setting screen
- 3 Adjust volume  
Turn the audio system on/off
- 4 Select a radio/media mode
- 5 Play/Pause  
Turn mute on/off

## Radio



- 1 Display the cache radio operation buttons
- 2 Display the radio preset buttons
- 3 Scan for receivable stations/channels
- 4 Select to store artist and song title information
- 5 Display a list of receivable stations
- 6 Select a preset station/channel  
Seek for a station/channel
- 7 Step up/down frequencies/channels  
Move up/down the list

## Entering station/channel presets

- 1 Select the desired station/channel by using the tune, the seek or the scan function.
- 2 Select "Presets".
- 3 Select one of the screen buttons and hold it until a beep is heard, indicating that the station/channel has been set.

## DVD player/CD player

### Playing an audio CD



- 1 Select a track  
Rewind
- 2 Play/Pause
- 3 Select a track  
Fast forward
- 4 Set repeat playback
- 5 Set random playback
- 6 Display a track list
- 7 Eject a disc
- 8 Select a track  
Fast forward/rewind
- 9 Select a track  
Move up/down the list

### Playing a CD with MP3/WMA/AAC files



- 1 Select a folder
- 2 Select a file  
Rewind
- 3 Play/Pause
- 4 Select a file  
Fast forward
- 5 Set repeat playback
- 6 Set random playback
- 7 Display a folder list
- 8 Eject a disc
- 9 Select a file  
Fast forward/rewind
- 10 Select a file  
Move up/down the list

## ■ Playing a DVD

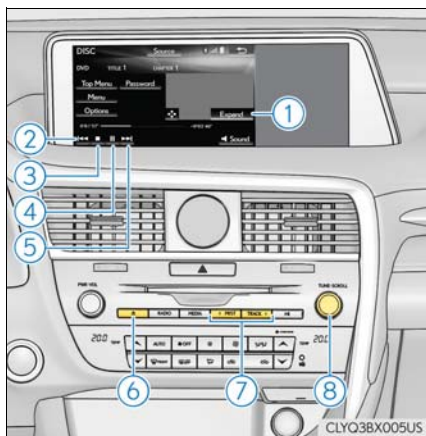

- ① Display full screen video
- ② Select a chapter  
Rewind
- ③ Stop the video screen
- ④ Play/Pause
- ⑤ Select a chapter  
Fast forward/Slow forward
- ⑥ Eject a disc
- ⑦ Select a chapter  
Fast forward/rewind
- ⑧ Select a chapter

## ■ Operating an iPod



- ① Select a track  
Rewind
- ② Play/Pause
- ③ Select a track  
Fast forward
- ④ Set repeat playback
- ⑤ Set random playback
- ⑥ Display the play mode selection screen
- ⑦ Select a track  
Fast forward/rewind
- ⑧ Select a track  
Move up/down the list



## Lexus Display Audio Controller (with Lexus Display Audio)

By using the Lexus Display Audio controller, you can control the audio system, hands-free system, etc.

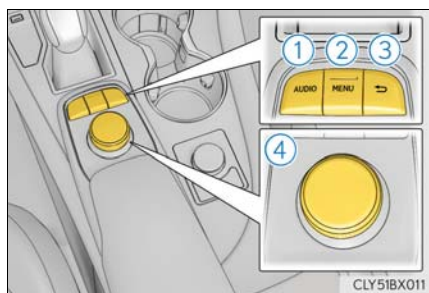

- ① Display the “Source” screen or audio top screen
- ② Display the “Menu” screen (→P.65)
- ③ Back button  
Display the previous screen
- ④ Turn or move the controller to select a function and number.  
Move the controller to display the left or right side of the screen.  
Push the controller to enter the selected function and number.

### ■ “Menu” screen

To display the “Menu” screen, press the “MENU” button on the Lexus Display Audio controller.



Button	Function
“Radio”	Display the radio top screen
“Media”	Display the media top screen
“Climate”	Display the air conditioning control screen (→P.75)
“Phone”	Display the phone top screen
“Connected Navi”*	If a turn-by-turn navigation application has been downloaded to a connected phone, the application will be displayed and can be used.
“Info”	Display the “Information” screen
“Setup”	Display the “Setup” screen
“Display”	Display the display settings screen

\*: Available in the 48 states, D.C. and Alaska

## ■ Screen for display settings

Go to "Display": "MENU" button → "Display"



- 1 Turn off screen.
- 2 Adjust screen quality.
- 3 Adjust screen quality of the rear view monitor camera.
- 4 Change to day mode.

## Hands-Free System For Cellular Phone (with Lexus Display Audio)

### ■ How to register a Bluetooth® device

- 1 Turn the Bluetooth® connection setting of your device set to on.
- 2 Go to "Bluetooth\* Setup": "MENU" button → "Setup" → "Bluetooth\*"
- 3 Move the controller to the left and then select "Add Device".



- 4 When this screen is displayed, search for the device name displayed on this screen on your Bluetooth® device.
  - 5 Register the Bluetooth® device using your Bluetooth® device.
- \*: Bluetooth is a registered trademark of Bluetooth SIG, Inc.

### ■ Registering favorites

You can register the desired contact from the phonebook. Up to 15 contacts per phone can be registered.

- 1 Go to "Add Favorite": "MENU" button → "Setup" → "Phone" → "Contact/Call History" → "Add Favorite"
- 2 Choose the contact to register.

### ■ Dialing

- 1 Go to "Dial Pad": "MENU" button → "Phone" → "Dial Pad"
- 2 Input a phone number.
- 3 Press the off-hook switch on the steering wheel or select .

## ■ Dialing from the phonebook

---

- 1 Go to "Contacts": "MENU" button → "Phone" → "Contacts"
- 2 Choose the desired contact to call from the list.
- 3 Choose the number and then press the off-hook switch on the steering wheel or press the controller.

## ■ When the phonebook is empty

---

You can transfer the phone numbers in a Bluetooth® phone to the system. Operation methods differ between PBAP (Phone Book Access Profile) compatible and PBAP incompatible Bluetooth® phones. If the cellular phone does not support either PBAP or OPP (Object Push Profile) service, you cannot transfer contacts.

- 1 Press the off-hook switch on the steering wheel.  
If the phonebook is empty, a message will be displayed.
  - ▶ **For a PBAP compatible Bluetooth® phone and "Automatic Transfer" is off**
- 2 To enable automatic transfer of new contacts from a cellular phone every time it is connected, select "Always".  
Select "Once" if you want to transfer new contacts from a cellular phone.
  - ▶ **For a PBAP incompatible and OPP compatible Bluetooth® phone**
- 2 Select "Transfer" and operate your cellular phone to transfer new contacts from a cellular phone.  
Select "Add" if you want to add a new contact manually.

## ■ Dialing from favorites

---

You can make a call using numbers registered in the favorites.

- 1 Go to "Favorites": "MENU" button → "Phone" → "Favorites"
- 2 Choose the desired contact to call from the list.
- 3 Choose the number and then press the off-hook switch on the steering wheel or press the controller.

## ■ To answer the phone



Press the off-hook switch on the steering wheel or select .

## ■ Operating a phone using the steering wheel switches

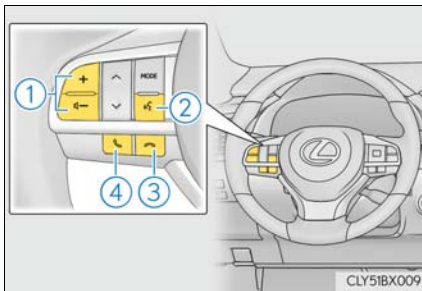

- ① Volume switch  
During an incoming call: Adjusts the ring tone volume  
During speaking on the phone: Adjusts in call volume  
The voice guidance volume cannot be adjusted using this button.
- ② Talk switch  
Press: Turns the voice command system on  
Press and hold: Turns the voice command system off
- ③ On-hook switch
  - End call
  - Refuse call
- ④ Off-hook switch
  - Start call
  - Receiving
  - Phone top screen display

## Audio System (with Lexus Display Audio)

### Lexus Display Audio operation buttons

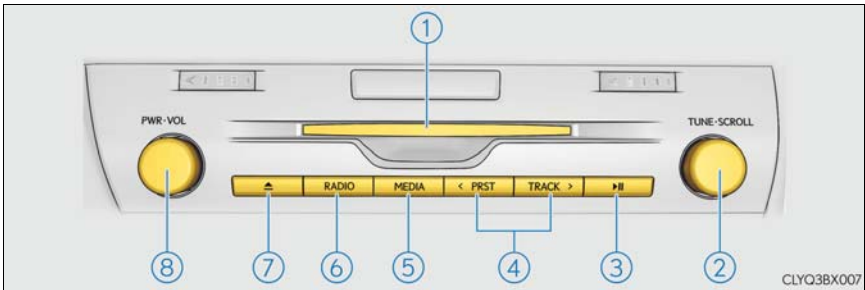

- ① Disc slot
- ② Seek up or down for a radio station, or to access a desired track or file.
- ③ Except radio and A/V mode: Pause or resume playing a track.  
Radio and A/V mode: Turn mute on/off.
- ④ Select a radio station band, track or file.
- ⑤ Display the media top screen.
- ⑥ Display the radio top screen.
- ⑦ Eject a disc.
- ⑧ Press to turn the audio system on/off, and turn to adjust the volume.

### Using the steering wheel switches to change audio sources

Press the "MODE" switch when the audio system is turned on. The audio source changes each time the "MODE" switch is pressed.

## ■ Audio menu screen

To display the audio menu screen, move the controller to the left while on an audio top screen.

### ► Radio mode



Button	Function	Target radio mode
"SCAN"	Scans for receivable stations	AM, FM
"SEEK"	Seeks a station of the nearest frequency (stops when a station is found)	AM, FM
"Tag"	Captures the song title and artist name information for potential purchase (when the "HD") indicator on the selected station is appears)	FM
"Multicast"	Changes the channel of HD Radio (HD2, HD3, HD4 where applicable)	FM
"Traffic"	Seeks a station of the traffic announcement	FM
"HD Radio"	Selects to set the station list shows of HD radio on/off	AM, FM
"Radio Settings"	Changes radio settings	All mode
"Sound Settings"	Changes sound settings	All mode

► Media mode

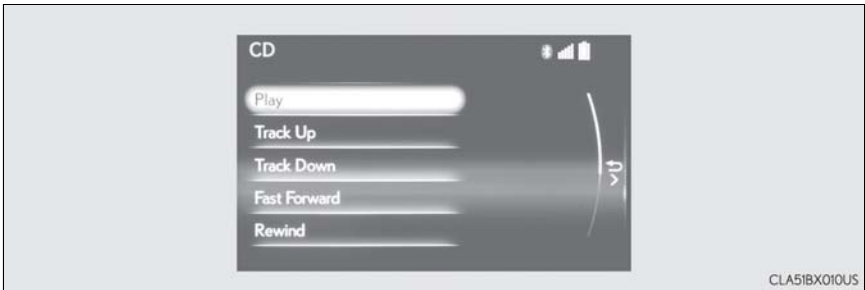

Button	Function	Target audio source
"Play"	Plays or pauses a track/file	All media (except A/V)
"Pause"		
"Track Up"	Selects a track/file	All media (except A/V)
"Track Down"		
"File Up"		
"File Down"		
"Folder Up"		
"Folder Down"	Selects a folder/album	MP3/WMA/AAC disc, USB
"Fast Forward"	Selects and hold: Fast-forward or rewind a track/file	All media (except A/V)
"Rewind"		
"Repeat"	Selects a repeat mode	All media (except A/V)
"Random"	Selects a random/shuffle play mode	All media (except A/V)
"Shuffle"		
"Full Screen"	Selects a full screen mode	iPod, A/V
"Connect"	Connects a Bluetooth® device	Bluetooth®
"Cover Art Settings"	Changes the cover art settings	CD, MP3/WMA/AAC disc, Bluetooth®
"iPod Settings"	Changes iPod settings	iPod
"USB Settings"	Changes USB settings	USB
"External Video Settings"	Changes A/V settings	A/V
"Sound Settings"	Changes sound settings	All media

## ■ Operating the audio system using the steering wheel switches

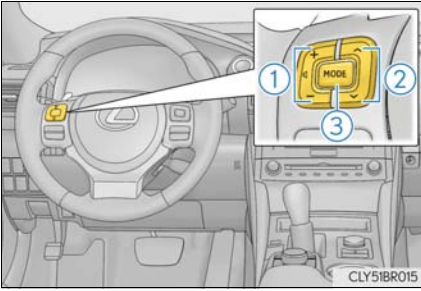

- ① Volume switch
  - Increases/decreases volume
  - Press and hold: Continuously increases/decreases volume
- ② Radio mode:
  - Press: Select a radio station
  - Press and hold: Seek up/down CD, MP3/WMA/AAC disc, Bluetooth<sup>®</sup>, iPod or USB mode:
  - Press: Select a track/file/video
  - Press and hold: Continuously tracks/files/videos up/down. (MP3/WMA/AAC disc, iPod or USB)
- ③ "MODE" switch
  - Turns the power on, selects audio source
  - Press and hold this switch to mute or pause the current operation. To cancel the mute or pause, press and hold.

## Portable Audio Device Ports

This port can be used to connect a portable audio device and listen to it through the vehicle's speakers.

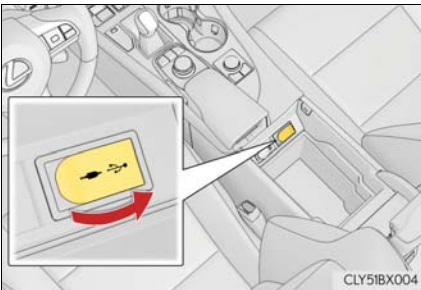

Press the console box knob, open the cover and connect the portable audio device.



## Rear Seat Entertainment System Features (if equipped)

The rear seat entertainment system is designed for the rear passengers to enjoy audio/visual system. When audio/visual equipment is connected to the A/V input port, rear passengers can enjoy different audio sources on each display.

The system can be used when the engine switch is in ACCESSORY or IGNITION ON mode.

### Overview

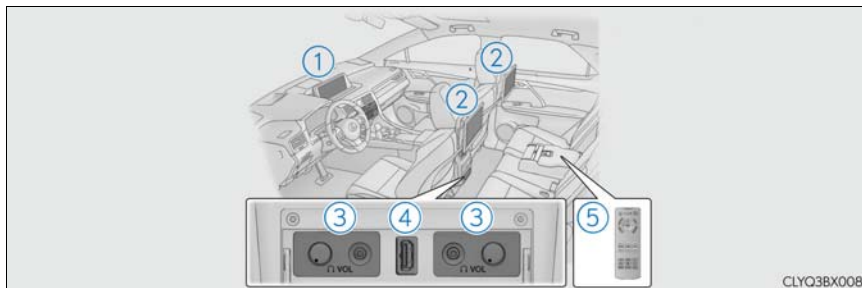

- 1 Front audio/visual system
- 2 Displays
- 3 Headphone volume control dials and headphone jacks
- 4 A/V input port (HDMI port)
- 5 Remote controller

### Operating rear seat entertainment system from the front seats



- 1 Press the "RADIO" or "MEDIA" button on the instrument panel.
- 2 Select "Source".
- 3 Select "Rear".
- 4 Select the desired button.

- 1 Select to turn the rear seat entertainment system on/off.
- 2 Select to lock the system so passengers in the rear seats cannot operate the rear seat entertainment system.
- 3 Select to output sound from rear seat entertainment system over the speakers in the vehicle. Select "Right" or "Left" to select for which screen sound will be output.

## ■ Selecting the source

The front and rear audio/visual source can be controlled from the rear seat entertainment system.

- 1 Press the "SOURCE" button on the remote controller.
- 2 Select the desired source.

## Lexus Climate Concierge (if equipped)

The climate control seats are automatically controlled according to the set temperature of the air conditioning system, outside temperature, cabin temperature, etc. Lexus Climate Concierge allows a comfortable condition to be maintained without adjusting each system.

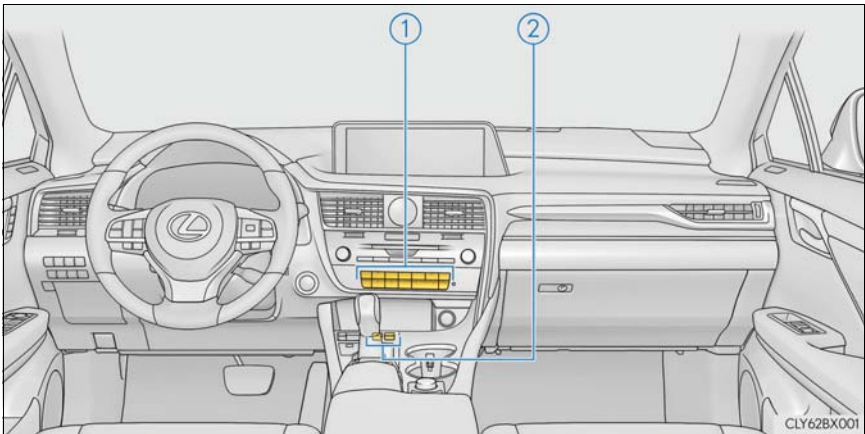

- 1 Automatic air conditioning system  
Set the air conditioning system to automatic mode.  
The temperature for the driver's seat and front passenger's seat can be adjusted individually.
- 2 Seat heaters and ventilators  
Select "AUTO" mode on each seat.  
Seat heater or ventilation is automatically selected according to the set temperature of the air conditioning system, outside temperature, etc.

## Air Conditioning System

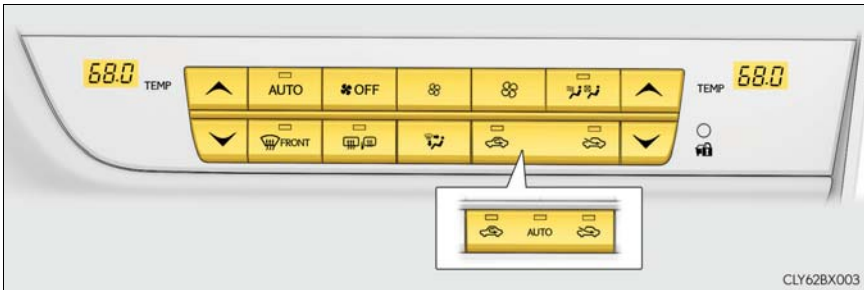

### ■ Adjusting the temperature setting

Press to increase the temperature and to decrease the temperature.

### ■ Adjusting the fan speed setting

Press to increase the fan speed and to decrease the fan speed.  
Press the "OFF" button to turn the fan off.

### ■ Change the airflow mode

To change the air outlets, press .

### ■ Control screen

#### ▶ Vehicles with a Lexus Display Audio system



- ① Adjust the left-hand side temperature setting
- ② Adjust the fan speed setting
- ③ Select to set auto mode on/off
- ④ Select to set eco mode on/off
- ⑤ Select to set cooling and dehumidification function on/off
- ⑥ Adjust the temperature for driver and passenger seats separately ("DUAL" mode)
- ⑦ Display the option control screen
- ⑧ Select the air flow mode
- ⑨ Adjust the right-hand side temperature setting

► Vehicles with a navigation system



- ① Adjust the left-hand side temperature setting
- ② Adjust the fan speed setting
- ③ Select the air flow mode
- ④ Adjust the right-hand side temperature setting
- ⑤ Display the option control screen
- ⑥ Select to set automatic mode on/off
- ⑦ Select to set cooling and dehumidification function on/off
- ⑧ Adjust the temperature for driver and passenger seats separately ("DUAL" mode)
- ⑨ Select to set eco mode on/off

■ Side display operation screen (Vehicles with a navigation system [12.3-inch display])



- ① Select the air flow mode
- ② Adjust the left-hand side temperature setting
- ③ Adjust the fan speed setting
- ④ Adjust the right-hand side temperature setting
- ⑤ Select to set auto mode on/off
- ⑥ Select to set cooling and dehumidification function on/off
- ⑦ Adjust the temperature for driver and passenger seats separately ("DUAL" mode)

## ■ Option control screen

Select  on the air conditioning control screen to display the option control screen. The functions can be switched on and off.

- ▶ Vehicles with a Lexus Display Audio system
- ▶ Vehicles with a navigation system



- ① Prevent ice from building up on the windshield and wiper blades (if equipped)

## ■ Using the automatic mode

Press the "AUTO" button to turn on the airflow and adjust the temperature setting.

## ■ S-FLOW mode

In S-FLOW mode, priority for the airflow is given to the front seats, reducing the airflow and air conditioning effect on the rear seats.

If a passenger is not detected in the front passenger seat, priority for the airflow will be given to the driver's seat only.

In this case, the temperature indicator for the front passenger side will turn off.

S-FLOW mode will be activated automatically according to the set temperature, outside temperature, etc.

The  indicator comes on when S-FLOW mode is on.

## ■ Adjusting the temperature for driver and passenger seats separately ("DUAL" mode)

To turn on the "DUAL" mode, perform any of the following procedures:

- Select "DUAL" on the air conditioning control screen.
- Select "DUAL" on the side display operation screen. (Vehicles with a navigation system [12.3-inch display])
- Adjust the temperature setting of the passenger side with the passenger side temperature adjustment button.

The indicator comes on when the "DUAL" mode is on.

# Seat Heaters (if equipped)/ Seat Ventilators (if equipped)

## Front seat heaters

When any switch is pressed, the system is set to automatic mode and the "AUTO" indicator (green) lights up.

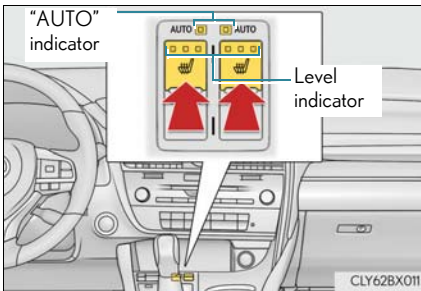

Each time the switch is pressed, the operation condition changes as follows.

Hi (3 segments lit) → Mid (2 segments lit)  
→ Lo (1 segment lit) → Off

The level indicator (amber) lights up during operation.

## Rear seat heaters

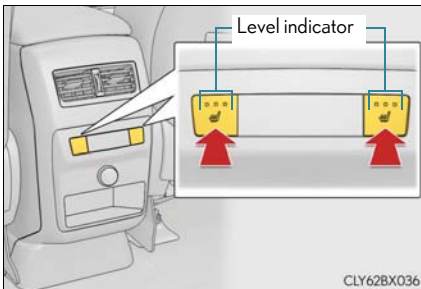

Each time the switch is pressed, the operation condition changes as follows.

Hi (3 segments lit) → Mid (2 segments lit)  
→ Lo (1 segment lit) → Off

The level indicator (amber) lights up during operation.

## Seat ventilators

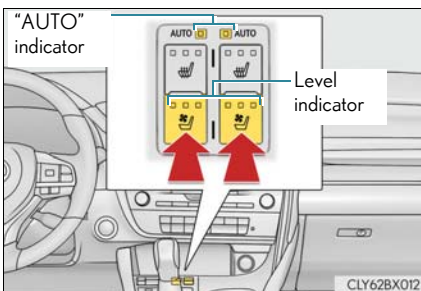

When any switch is pressed, the system is set to automatic mode and the "AUTO" indicator (green) lights up.

Each time the switch is pressed, the operation condition changes as follows.

Hi (3 segments lit) → Mid (2 segments lit)  
→ Lo (1 segment lit) → Off

The level indicator (green) lights up during operation.

# Voice Command System

## Basic operation

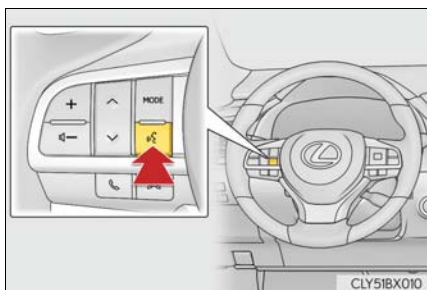

- 1** Press the talk switch on the steering wheel.
- 2** **▶ If you know the command:**  
Press the talk switch again.  
**▶ If you do not know the command:**  
Follow the voice guidance to learn the command and then press the talk switch again.
- 3** Say a command after the beep.

Continue on to pages 80-83 for a detailed list of Voice Commands for the following categories:

Basic.....	page 80
Apps.....	page 80
Navi .....	page 80
Phone.....	page 81
Radio .....	page 81
Audio.....	page 82
Info .....	page 82
Climate .....	page 83

### ■ Important voice commands information and tips

- Voice commands can be used while driving.
- You must wait until after the beep to say a command.
- If you know what command to use, you can press the talk switch at any time to interrupt the voice guidance.
- If a desired outcome is not shown, or if no selections are available, press  on the steering wheel to return to the previous screen.

**NOTE:** When entering voice commands you must wait until after the beep to speak.

## ■ Command list

### ▶ Basic

Command	Action
"Help"	Prompts voice guidance to offer examples of commands or operation methods
"Go Back"	Returns to the previous screen
"Go to <tab>"	Displays the command list of the selected tab
"More Hints"	Displays more commonly used commands
"Cancel"	Cancels the voice command system

### ▶ Apps (vehicles with navigation system)

Command	Action
"Launch <apps>"	Activates the LEXUS App Suite application

### ▶ Navi (vehicles with navigation system)

Command	Action
"Find <POI category>"	Displays a list of <POI category <sup>*</sup> > near the current position
"Enter an Address"	Enables setting a destination by saying the address
"Go Home"	Displays the route to home
"Pause Guidance"	Stops the route guidance
"Resume Guidance"	Resumes the route guidance
"Show <POI> icons"	Displays the specified POI icons
"Delete Destination"	Deletes the destination
"Previous Destination"	Displays previous destinations

\*: For example; "Gas stations", "Restaurants", etc.



## ► Phone

Command	Action
"Redial"	Places a call to the phone number of the latest outgoing call
"Call Back"	Places a call to the phone number of latest incoming call
"Show Recent Calls"	Displays the call history screen
"Dial <phone number>"	Places a call to the said phone number
"Call <contacts> <phonetypes>"	Place a call to the said phone type of the contact from the phone book
"Mobile Assistant"	Activates Apple's Siri® Eyes Free mode

## ► Radio

Command	Action
"Tune to <frequency> AM"	Changes the radio to the specified AM frequency
"Tune to <frequency> FM"	Changes the radio to the specified FM frequency
"Play <genre> station"	Changes the radio to an FM station of the specified genre
"Tune to FM <frequency> HD <number>"	Changes the radio to the specified HD radio station
"Tune to preset <number>"	Changes the radio to the specified preset radio station
"Tune to <name>"	Changes the radio to the satellite radio channel with the specified name
"Tune to channel <number>"	Changes the radio to the specified satellite radio channel number
"Play <genre> satellite station "	Changes the radio to a satellite radio channel of the specified genre
"AM Radio"	Selects AM radio mode
"FM Radio"	Selects FM radio mode
"Sirius XM"	Selects satellite radio mode

► **Audio**

Command	Action
"Play Playlist <name>"	Plays tracks from the selected playlist
"Play Artist <name>"	Plays tracks from the selected artist
"Play Song <name>"	Plays the selected track
"Play Album <name>"	Plays tracks from the selected album
"Turn Music On"	Turns the audio system on
"Turn Music Off"	Turns the audio system off
"Disc"	Selects the selected disc mode
"USB"	Selects USB audio mode
"iPod"	Selects iPod audio mode
"Bluetooth* Audio"	Selects Bluetooth® audio mode
"A.V."	Selects VTR mode
"Auxiliary"	Selects AUX audio mode

\*: Bluetooth is a registered trademark of Bluetooth SIG, Inc.

► **Info (vehicles with navigation system)**

Command	Action
"Destination Assist"	Connects the system to the Lexus response center
"Show Forecast"	Displays weather information
"Show Traffic"	Displays traffic information
"Lexus Insider"	Displays the Lexus insider list

## ► Climate

Command	Action
"Turn Climate Control On"	Turns air conditioning system on
"Turn Climate Control Off"	Turns air conditioning system off
"Warmer"	Increases the temperature of the air conditioning system
"Cooler"	Decreases the temperature of the air conditioning system
"<#> degrees"	Changes the set temperature of the air conditioning system to <#> degrees *

\*: Only within the possible temperature range of the air conditioning system

Commands relating to operation of the audio/visual and air conditioning systems can only be performed when the audio and air conditioning systems are turned on. Refer to the "OWNER'S MANUAL" and "NAVIGATION SYSTEM OWNER'S MANUAL".

## Garage Door Opener

The garage door opener can be programmed to operate garage doors, gates, entry doors, door locks, home lighting systems, security systems, and other devices.

### ■ Programming the HomeLink®

The HomeLink® wireless control system in your vehicle has 3 buttons which can be programmed to operate 3 different devices. Refer to the programming methods on the following pages to determine the method which is appropriate for the device.

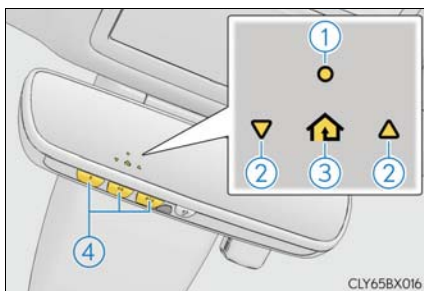

- ① HomeLink® indicator light
- ② Garage door operation indicators
- ③ HomeLink® icon  
Illuminates while HomeLink® is operating.
- ④ Buttons

## ■ Programming HomeLink®

- 1** Press and release the HomeLink® button you want to program and check that the HomeLink® indicator light flashes (orange).

Perform **3** within 60 seconds of **1**, or the indicator light will stop flashing and programming will not be able to be completed.

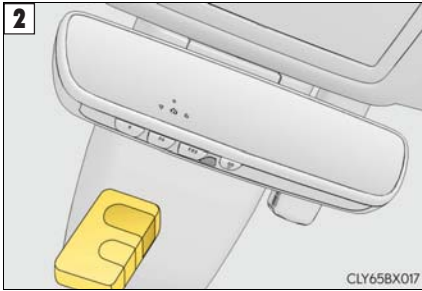

Point the remote control transmitter for the device at the rear view mirror, 1 to 3 in. (25 to 75 mm) from the HomeLink® buttons. Keep the HomeLink® indicator light in view while programming.

### ► For U.S.A. owners

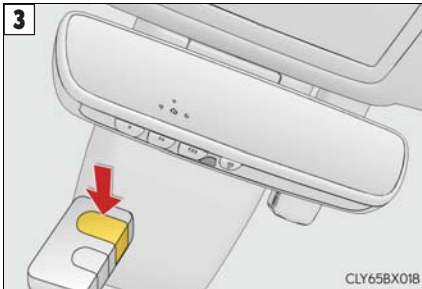

Press and hold the handheld transmitter button until the HomeLink® indicator light changes from slowly flashing orange to rapidly flashing green (rolling code) or continuously lit green (fixed code), then release the button.

### ► Programming an entry gate (for U.S.A. owners)/Programming a device in the Canadian market

- 3** Press and release the remote control transmitter button at 2 second intervals, repeatedly, until the HomeLink® indicator light changes from slowly flashing (orange) to rapidly flashing (green) (rolling code) or continuously lit (green) (fixed code).
- 4** Test the HomeLink® operation by pressing the newly programmed button and observing the indicator light:
  - Device with fixed code: If the indicator light is solid/continuous, programming has been completed and your garage door or other device should operate when the HomeLink® button is pressed and released.
  - Device with rolling code: If the indicator light flashes rapidly, your garage door opener motor (or other device) is equipped with a rolling code. Complete the programming process by firmly pressing and holding the programmed HomeLink® button for 2 seconds and then release the button.
  - If the garage door or other device does not operate, proceed to "If your garage door is of the rolling code type:".

- 5** Repeat the steps above to program another device for any of the remaining HomeLink<sup>®</sup> buttons.

If your garage door is of the rolling code type:

- 6** Press the training button on the motor-head unit in your garage.
- 7** Press and hold the vehicle's programmed HomeLink<sup>®</sup> button for 2 seconds and release it. Repeat this step once again.

If the door does not open, press and release the same button once again.

## ■ Programming other devices

---

For U.S.A. owners:

To program an entry gate, see the Owner's Manual.

To program other devices, contact your Lexus dealer.

For Canadian owners:

To program all other devices, follow the same procedure as for garage door programming.

## ■ Operating HomeLink<sup>®</sup>

---

Press the appropriate HomeLink<sup>®</sup> button. The HomeLink<sup>®</sup> indicator light should turn on.

## LEXUS Enform Safety Connect (if equipped)

Safety Connect is a subscription-based telematics service that uses Global Positioning System (GPS) data and embedded cellular technology to provide safety and security features to subscribers. Safety Connect is supported by Lexus' designated response center, which operates 24 hours per day, 7 days per week.

Safety Connect service is available by subscription on select, telematics hardware-equipped vehicles.

## ■ System components

---

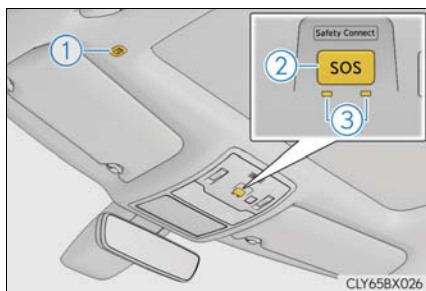

- ① Microphone
- ② "SOS" button
- ③ LED light indicators

## ■ Services

---

Subscribers have the following Safety Connect services available:

### ● Automatic Collision Notification\*

In case of either airbag deployment or severe rear-end collision, the system is designed to automatically call the response center. The responding agent receives the vehicle's location and attempts to speak with the vehicle occupants to assess the level of emergency. If the occupants are unable to communicate, the agent automatically treats the call as an emergency, contacts the nearest emergency services provider to describe the situation, and requests that assistance be sent to the location.

\*: U.S. Patent No. 7,508,298 B2

### ● Stolen Vehicle Location

If your vehicle is stolen, Safety Connect can work with local authorities to assist them in locating and recovering the vehicle. After filing a police report, call the Safety Connect response center at 1-800-25-LEXUS (1-800-255-3987) and follow the prompts for Safety Connect to initiate this service.

In addition to assisting law enforcement with recovery of a stolen vehicle, Safety-Connect-equipped vehicle location data may, under certain circumstances, be shared with third parties to locate your vehicle. Further information is available at [Lexus.com](http://Lexus.com).

### ● Emergency Assistance Button ("SOS")

In the event of an emergency on the road, push the "SOS" button to reach the Safety Connect response center. The answering agent will determine your vehicle's location, assess the emergency, and dispatch the necessary assistance required.

If you accidentally press the "SOS" button, tell the response-center agent that you are not experiencing an emergency.

### ● Enhanced Roadside Assistance

Enhanced Roadside Assistance adds GPS data to the already included warranty-based Lexus roadside service.

Subscribers can press the "SOS" button to reach a Safety Connect response-center agent, who can help with a wide range of needs, such as: towing, flat tire, fuel delivery, etc. For a description of the Enhanced Roadside Assistance services and their limitations, please see the Safety Connect Terms and Conditions, which are available at [Lexus.com](http://Lexus.com).

## ■ Subscription

---

After you have signed the Telematics Subscription Service Agreement and are enrolled, you can begin receiving services.

A variety of subscription terms is available for purchase. Contact your Lexus dealer, call 1-800-25-LEXUS (1-800-255-3987) or push the "SOS" button in your vehicle for further subscription details.

## **Lexus Enform (for U.S.A., if equipped)**

Lexus Enform is a service that includes Safety Connect, Service Connect, Remote, Destinations, Insider and App Suite.

For details, refer to the “OWNER’S MANUAL” and “NAVIGATION SYSTEM OWNER’S MANUAL”.

### **Function achieved by using a cellular phone (with navigation system)**

---

#### **Services**

Of the functions included with Lexus Enform, only LEXUS App Suite can be achieved by using a cellular phone.

LEXUS App Suite is a service that enables the usable contents of a cellular phone to be displayed on and operated from the navigation screen. Before LEXUS App Suite can be used, a few settings need to be performed.

#### **● LEXUS App Suite**

When LEXUS App Suite is activated, an application may need to update. By updating, an application can be kept the latest version. To updating the application, it is necessary to download the updated data and install it.

#### **Subscription**

LEXUS App Suite will be available on a trial period included upon purchase of a new vehicle. User registration is required to start using the service.

When a trial period has elapsed after purchasing a new vehicle, a fee will be charged to renew the contract. Services requiring a separate contract can also be used. For details, refer to <http://www.lexus.com/enform/> or call 1-800-255-3987.

### **Function achieved by using DCM and the navigation system (with navigation system)**

---

#### **Services**

Of the functions included with Lexus Enform, LEXUS Enform Destinations (Destination Assist, eDestination), and Lexus Insider can be achieved by making DCM cooperate with the navigation system.

These are subscription-based telematics services that use Global Positioning System (GPS) data, embedded cellular technology to provide safety and security as well as convenience features to subscribers. The services are supported by Lexus’ designated response center, which operates 24 hours a day, 7 days a week.

The services are available by subscription on select, telematics hardware-equipped vehicles.

#### **● Destination Assist**

Destination Assist provides you with live assistance for finding destinations via the Lexus response center. You can request either a specific business, address, or ask for help locating your desired destination by category, such as restaurants, gas stations, shopping centers or other points of interest (POI).

After you tell the agent your choice of destination, its coordinates are sent wirelessly to your vehicle’s navigation system.

## ● eDestination

With the eDestination feature, you can go online, and via the Lexus.com owner's Web site, select and organize destinations of your choice and then wirelessly send them to your vehicle's navigation system.

Up to 200 locations can be stored online and accessed or updated at any time.

Locations can be organized into up to 20 personalized folders.

You must first go online at [www.lexus.com/drivers/](http://www.lexus.com/drivers/) to view the Owners site where you will need to register and log in. After this, personalized folders that contain the locations to be sent to your vehicle can be created. (See Lexus Enform Guide for more information.)

## ● Lexus Insider

Lexus Insider is an optional service that can send audio messages, or articles, to participating owners' vehicles via the navigation system. Potential Lexus Insider subjects might include, for example, Lexus vehicle technology tips, updates on regional Lexus events, or audio excerpts from Lexus Magazine articles.

## ■ Subscription

After you have signed the Telematics Subscription Service Agreement and are enrolled, you can begin receiving services. A variety of subscription terms are available.

Contact your Lexus dealer, call 1-800-25-LEXUS (1-800-255-3987), or select the "Destination Assist" in your vehicle for further subscription details.

## ■ Function achieved by using DCM

---

### ■ Services

Of the functions included with Lexus Enform Safety Connect, Safety Connect can be achieved by using DCM.

- Lexus Enform Safety Connect (→P.85)

## ■ LEXUS Enform Remote

---

### ■ Services

Lexus Enform Remote is a cellular phone application that lets you view and remotely control certain aspects of your vehicle.

For details about the functions and services of this application, refer to <http://www.lexus.com/enform/>. For further details, contact your Lexus dealer.

Function of the Lexus Enform Remote is achieved by using an embedded cellular device in the vehicle (DCM: Data Communication Module).

### ■ Subscription

→P.88



## ■ LEXUS Enform Service Connect

---

### ■ Services

Lexus Enform Service Connect uses embedded telematics hardware to collect and transmit vehicle data that allows Lexus to provide:

- Vehicle Health Report (VHR)  
Safety Recalls, Service Campaigns, Current Vehicle Alerts, Required Maintenance, Vehicle Condition Status
- Maintenance Notifications
- Vehicle Alert Notifications

For details about this service and how to register, refer to

<http://www.lexus.com/enform/>.

The Lexus Enform Service Connect function is achieved by using a vehicle Data Communication Module (DCM).

### ■ Subscription

→P.88

## Information Services (if equipped)

Data service information, which is comprised of traffic information and weather information, can be received via HD Radio broadcast and by the LEXUS App Suite application on a Bluetooth® phone. The receiving method can be set to both or only via HD Radio broadcast.

For details about the LEXUS App Suite application, refer to the “NAVIGATION SYSTEM OWNER’S MANUAL”.

### ■ Services

---

#### ● Traffic Information

Traffic data can be received via HD Radio broadcast or LEXUS App Suite to display traffic information on the map screen.

#### ● Doppler Weather Information

Doppler weather radar information can be received via HD Radio broadcast or by the LEXUS App Suite application on a Bluetooth® phone.

For details about the LEXUS App Suite application, refer to the “NAVIGATION SYSTEM OWNER’S MANUAL”.

## Door Locks

The vehicle can be locked and unlocked using the entry function, wireless remote control or door lock switches.

For details the entry function or wireless remote control (→ P.12, 13)

### ■ Door lock switches (to lock/unlock)

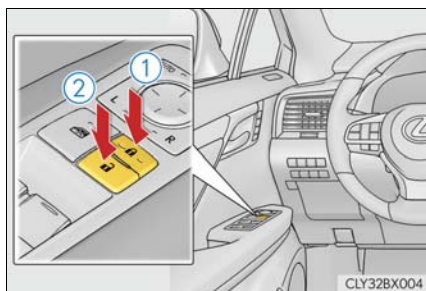

- ① Locks all the doors
- ② Unlocks all the doors

### ■ Inside lock buttons (to lock)

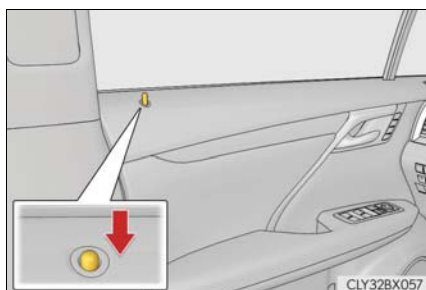

Push down the inside lock button to lock the door.

### ■ Inside door handles (to unlock)

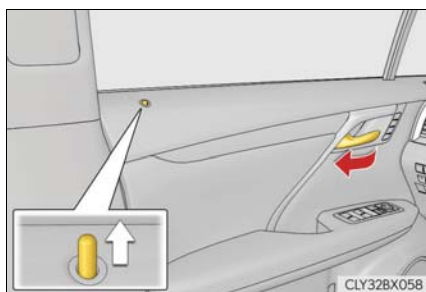

#### ► For the front doors

Pull the handle to unlock and open the door.

When the door is unlocked, the inside lock button will pop up.

#### ► For the rear doors

Pull the handle to unlock the door. Pull the handle a second time to open the door.

When the door is unlocked, the inside lock button will pop up.

## ■ Rear door child-protector lock

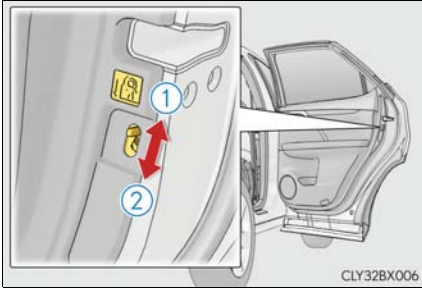

The door cannot be opened from inside the vehicle when the lock is set.

① Unlock

② Lock

These locks can be set to prevent children from opening the rear doors. Push down on each rear door switch to lock both rear doors.

## ■ Power Windows

### ■ Power window switches

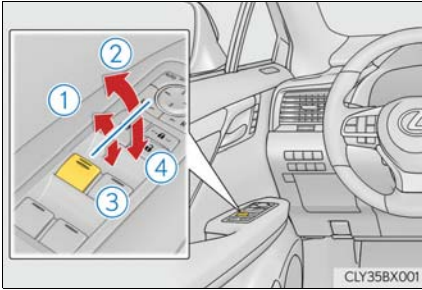

① Closing

② One-touch closing\*

③ Opening

④ One-touch opening\*

\*: To stop the window partway, operate the switch in the opposite direction.

### ■ Window lock switch

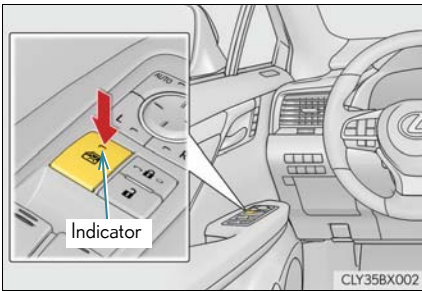

Press the switch down to lock the passenger windows. The indicator light will come on when the passenger windows are locked.

Use this switch to prevent children from accidentally opening or closing a passenger window.

The passenger windows can still be opened and closed using the driver's switch even if the lock switch is on.

## Moon Roof (if equipped)

### Opening and closing

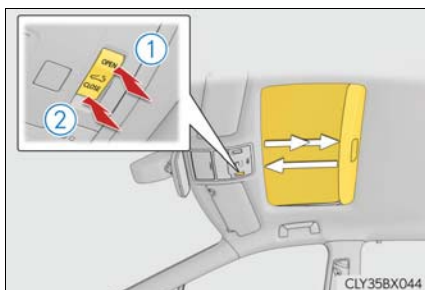

- ① Opens the moon roof\*  
The moon roof stops slightly before the fully open position to reduce wind noise.  
Press the switch again to fully open the moon roof.

- ② Closes the moon roof\*

\*: Lightly press either side of the moon roof switch to stop the moon roof partway.

### Tilting up and down

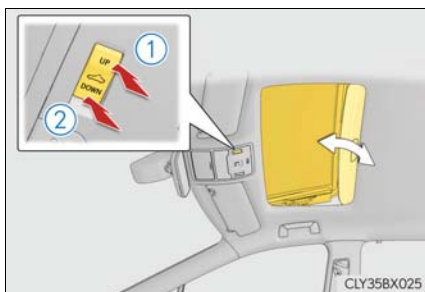

- ① Tilts the moon roof up\*

- ② Tilts the moon roof down\*

\*: Lightly press either side of the moon roof switch to stop the moon roof partway.

## Panoramic Moon Roof (if equipped)

### Opening and closing the electronic sunshade

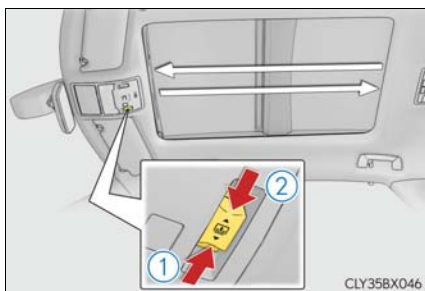

- ① Opens the electronic sunshade  
Slide and hold the  switch backward. The electronic sunshade will fully open automatically.\*

- ② Closes the electronic sunshade  
Slide and hold the  switch forward. The electronic sunshade will fully close automatically.\*

\*: Quickly slide and release the  switch in either direction to stop the electronic sunshade partway.

## ■ Tilting the panoramic moon roof up and down

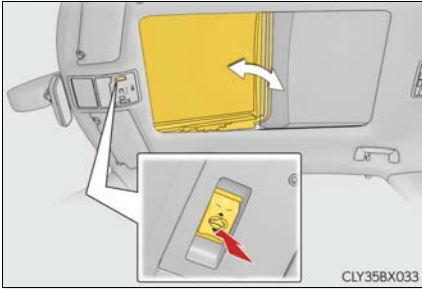

Tilts the panoramic moon roof up (press)\*

When the panoramic moon roof is tilted up, the electronic sunshade will open to the half-open position of the roof.

\*: Lightly press the  switch again to stop the panoramic moon roof partway.

Tilts the panoramic moon roof down (press and hold)

The panoramic moon roof can be tilted down only when it is in the tilt-up position.

## ■ Opening and closing the panoramic moon roof



Opens the panoramic moon roof\*

Slide and hold the  switch backward. The panoramic moon roof and electronic sunshade will open automatically.

The panoramic moon roof can be opened from the tilt-up position.

\*: Quickly slide and release the  switch in either direction to stop the panoramic moon roof partway.

Closes the panoramic moon roof

Slide and hold the  switch forward. The panoramic moon roof will fully close automatically.



## Fuel Tank Cap

### Before refueling the vehicle

- Close all the doors and windows, and turn the engine switch off.
- Confirm the type of fuel.

### Opening the fuel tank cap



- 1** With the doors unlocked, press the center of the rear edge of the fuel filler door.

Push inward and take your hand away to slightly open the fuel filler door. Then open the door fully by hand.

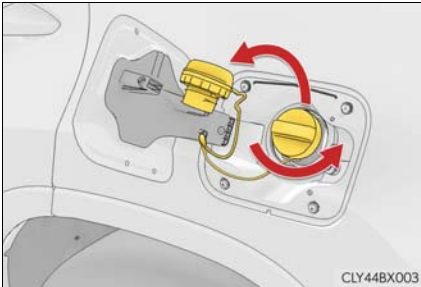

- 2** Turn the fuel tank cap slowly and remove it, then put it into the holder on the fuel filler door.

## Power Back Door

### Back door opener switch

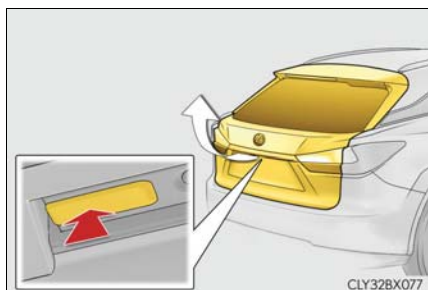

When the power back door is unlocked:  
Press the back door opener switch.

When the power back door is locked:  
While carrying an electronic key, press and hold the back door opener switch.

### Power back door switches

#### ► Instrument panel

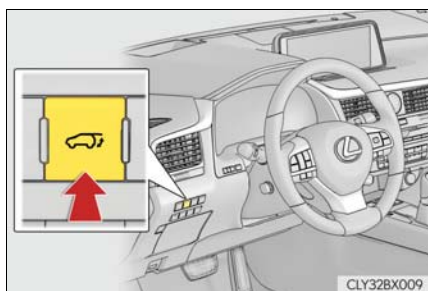

To open or close the power back door,  
press and hold the switch for approximately  
1 second.

#### ► Power back door

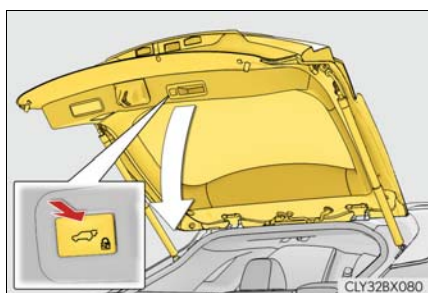

To close the power back door, press the  
 switch.

### Wireless remote control

→P.13

## ■ Touchless sensor (vehicles with a touchless power back door)

The touchless power back door enables automatic opening of the power back door by holding a hand over the upper part of the rear emblem or touching the upper part of the rear emblem. When operating the touchless power back door, make sure that the touchless sensor operation is enabled and that you are carrying an electronic key.

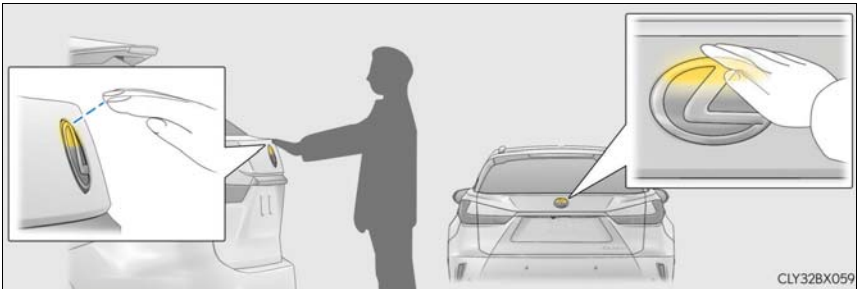

- 1** While carrying an electronic key, move your hand slowly toward the upper part of the rear emblem and hold it there until a buzzer sounds. (The upper part of the rear emblem can also be touched.)  
When all of the doors are locked: When your hand is detected, all of the doors will be unlocked.
- 2** Immediately after the buzzer sounds, move your hand away.  
If you do not move your hand away, a buzzer will sound twice and the power back door will not operate.
- 3** Check that the power back door begins to open.  
To stop the power back door partway, touch the rear emblem.  
To operate the power back door again, use a power back door switch. (Holding your hand over the upper part of the rear emblem will not operate the touchless sensor again.)

## ■ Back door closer

In the event that the power back door is left slightly open, the back door closer will automatically close it to the fully closed position.



## What to do if...

### List of Warning/Indicator Lights

**Stop the vehicle immediately. Continuing to drive the vehicle may be dangerous.**

**BRAKE**

(U.S.A.)

Brake system  
warning light



(Canada)



Charging system warning  
light (if equipped)

**Have the vehicle inspected immediately.**



Brake system warning light



Electric power steering  
system warning light



(U.S.A.)

Malfunction  
indicator lamp



Slip indicator



(Canada)



PCS warning light  
(if equipped)



SRS warning light



(flashes with a  
buzzer  
sounding)

**ABS**

(U.S.A.)

ABS warning light



ICS OFF indicator  
(if equipped)



(Canada)



Tire pressure warning light

**HOLD**

(Flashes)

Brake hold operated  
indicator



(Blinking and  
then continu-  
ously on)













Electric power steering  
system warning light



















**For further information, refer to the Owner's Manual.**

## What to do if...

### Follow the correction procedures.

	(U.S.A.) Parking brake indicator		Low fuel level warning light
	(Canada)		Driver's and front passenger's seat belt reminder light
	LKA indicator (if equipped)		Rear passengers' seat belt reminder light (if equipped)
	PCS warning light (if equipped)		Tire pressure warning light*
	ICS OFF indicator (if equipped)		Master warning light

### See the Owner's Manual

	Turn signal indicator		LKA indicator (if equipped)
	Headlight indicator (U.S.A.)		LKA indicator (if equipped)
	Tail light indicator (Canada)		LKA indicator (if equipped)
	Headlight high beam indicator		Intuitive parking assist indicator (if equipped)
	Automatic High Beam indicator (if equipped)		ICS OFF indicator (if equipped)
	Fog light indicator		"BSM" indicator (if equipped)
	Cruise control indicator		"RCTA" indicator (if equipped)
	Radar cruise control indicator (if equipped)		BSM outside rear view mirror indicators (if equipped)
	Cruise control "SET" indicator		Slip indicator

## What to do if...



VSC OFF indicator



PCS warning light  
(if equipped)



(U.S.A.)

Parking brake  
indicator



(Canada)



Brake hold standby indicator



Brake hold operated  
indicator

● Drive mode indicators

▶ Except F SPORT models



Eco drive mode indicator

▶ F SPORT models



Eco drive mode indicator



"SPORT S+" indicator



Eco Driving Indicator Light



Security indicator



All-wheel drive lock indicator  
(AWD models only)



Low outside temperature  
indicator



"AIR BAG  
ON/OFF" indicator  
(U.S.A.)



"AIR BAG  
ON/OFF" indicator  
(Canada)



"SPORT" indicator



"SPORT S" indicator



"CUSTOMIZE" indicator

For further information, refer to the Owner's Manual.

\*: It also comes on due to natural causes such as natural air leaks and tire inflation pressure changes caused by temperature. Adjust the tire inflation pressure to the specified level. The light will turn off after a few minutes. In case the light does not turn off even if the tire inflation pressure is adjusted, have the system checked by your Lexus dealer.

## What to do if...

### If the electronic key does not operate properly

#### Unlocking and locking the doors

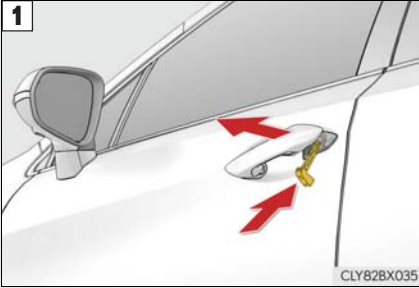

Insert the mechanical key while pulling on the driver's door handle.

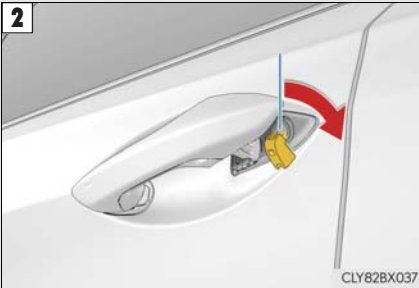

Unlocking the door.

Turning the key rearward unlocks the driver's door. Turning the key again unlocks the other doors.

**3** Remove the key, return the handle, and then pull the handle again.

#### Locking the door

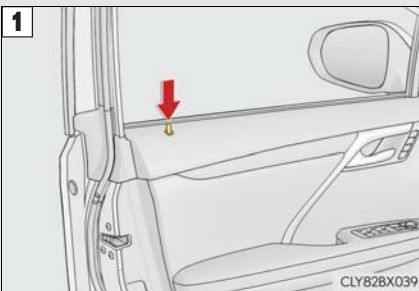

With the door open, push down the inside lock button.

**2** Close the door.

## What to do if...

### Starting the engine



- 1** Ensure that the shift lever is in P and depress the brake pedal.
- 2** Touch the Lexus emblem side of the electronic key to the engine switch.  
When the electronic key is detected, a buzzer sounds and the engine switch will turn to IGNITION ON mode.  
When the smart access system with push-button start is deactivated in customization setting, the engine switch will turn to ACCESSORY mode.
- 3** Firmly depress the brake pedal and check that  is shown on the multi-information display.
- 4** Press the engine switch.

In the event that the engine still cannot be started, contact your Lexus dealer.

If the electronic key battery is depleted, a warning message will be shown on the multi-information display. Replace the battery with a new one. For instructions on replacing the battery, refer to the "OWNER'S MANUAL". If you need further assistance, contact your Lexus dealer.

### If the engine doesn't start

Make sure that the correct operating procedures have been followed.

#### Brake pedal

Make sure that the brake pedal is firmly depressed when attempting to start the engine. (→P.15)

If the engine still does not start, see the "OWNER'S MANUAL" for more information or contact your Lexus dealer.



### Your Lexus dealer

Your Lexus dealer will provide quality maintenance and any other assistance you may require.

If there is not a Lexus dealer near you, please call the following number:

#### ■ U.S. OWNERS

- In the U.S. mainland or Canada:  
Lexus Roadside Assistance  
**1-800-25-LEXUS** or **1-800-255-3987** (Toll-Free)
- In Hawaii:  
Servco Automotive Roadside Assistance/Customer Services  
**1-800-25-LEXUS** or **1-800-255-3987** (Toll-Free)

#### ■ CANADIAN OWNERS

- In Canada or the U.S. mainland:  
Lexus Roadside Assistance/Customer Service  
**1-800-26-LEXUS** or **1-800-265-3987** (Toll-Free)

Please access our **websites** for further information.

- The U.S. mainland: [www.lexus.com](http://www.lexus.com)
- Hawaii: [www.servcolexus.com](http://www.servcolexus.com)
- Canada: [www.lexus.ca](http://www.lexus.ca)

©2016 TOYOTA MOTOR CORPORATION

All rights reserved. This material may not be reproduced or copied, in whole or in part, without the written permission of Toyota Motor Corporation.