

UrbanScape LED Pendant and Post-Top Luminaires

Modern styling meets advanced lighting technology



PHILIPS
LUMEC



Designed for simplicity. Focused on performance.

All you need to meet the most demanding path and street lighting requirements.

The Philips Lumec UrbanScape family of LED pendant and post-top luminaires is ideal for enhancing the architectural identity of environments with a modern-day appeal. Perfectly scaled in both proportion and performance for the demands of various pedestrian and roadway applications, UrbanScape provides a consistent style for entire lighting project.

Substantially more energy-efficient than HID luminaires thanks to industry leading LED technology, UrbanScape is the right choice for cities and utilities seeking cost effective, relamping-free outdoor lighting. Its IP66 rating, multiple lumen outputs and energy-saving control options are well suited to meet wide range of project requirements, including those of intersection lighting. In addition, exceptional thermal management extends LED component life while helping to maximize operations and maintenance savings.



Modern Styling

Bold Statment

UrbanScape LED luminaires allow you to create durable, visually appealing outdoor lighting projects while providing energy savings and a sense of security. They are well suited for municipal projects that range from simple recreational settings to more extensive boulevard lighting right through to architectural installations. Their minimalistic silhouette draws on avant-garde design, adding warmth and character to the surrounding environment and integrates especially well with forward-looking constructions and revitalized neighborhoods

State-of-the-art Optics

The optical system is composed of high-performance polymer refractor lenses which not only deliver pole spacing up to seven times the mounting height, but also optimize target lumens for superior lighting uniformity and intensity on the ground or street. The flat lens design eliminates uplight, which addresses the light pollution concerns of municipalities.

Environmentally Engineered

UrbanScape offers several sustainable features, starting with industry-leading LED drivers for minimal power loss and exceptional longevity. Luminaires are eco-designed for end-of-life disassembly and recycling, while LEDs contain no mercury nor hazardous materials. The end result is a reduced ecological footprint and the ability to project a greener image to stakeholders.

Advanced Technology

High-Performance LEDs

Both UrbanScape luminaire versions are optimized for LED lighting and powered by the LEDgine platform. LEDgine is compatible with the most advanced digital technology and lighting control options. Also, there are many lumen packages to choose from (up to 20,000 lm) with different combinations between the number of LEDs and the power of the driver. This provides the flexibility to meet virtually any outdoor lighting requirement by selecting the mix of energy savings, lifespan, light output and life-cycle cost best suited to your project.

Thermal Efficiency

The luminaire's innovative design includes electronic components located in the fitter. As a result, the driver and optional lighting controls are situated away from heat generated by the LEDs, ensuring improved thermal dissipation and, consequently, maximum system life of all components.

Flexibility of Connected Lighting

Every UrbanScape luminaire is controls-ready and able to accommodate the most advanced technology. Philips offers a range of outdoor lighting control solutions that feature superior flexibility, including real-time monitoring capabilities that help optimize the management of lighting assets. Designed to meet your specific needs, these systems are scalable from a few luminaires in a park to an entire network of luminaires throughout the city.



Recommended Applications

UrbanScape is valued for more than aesthetics. It is a family of cutting-edge LED luminaires engineered to cover a lot of ground by meeting the most demanding lighting requirements of multiple park, path and street lighting projects.

For architects and urban planners, this translates into better light rendering, improved ambience lighting and convenient style matching across post-top and pendant applications.

For municipalities and utilities, this results in considerable savings on electricity and relamping costs, providing an exceptional return on investment for heritage-site revitalization projects and other low-energy, sustainable urban developments.



Parks and
Recreation



City
Streets



City
Centers



Pedestrian
Areas
and
Bicycle
Paths



Campuses



Public
Areas



Green
Projects

UrbanScape **LED pendant**



Showing the way to cost-effective pedestrian and roadway lighting with a minimalistic look

The UrbanScape LED Pendant luminaire combines style and performance to create flexible, durable and attractive energy-saving solutions that blend in well with modern-styled urban architecture. Thanks to the open design it is capable of more powerful lumen packages suited to the higher visibility requirements of roads and intersections – up to 96 LEDs can deliver over 20,000 lumens, equivalent to 400W HID. The pendant model comes with a choice of flat or sag lens and an optional white opaque globe.



Flat Lens

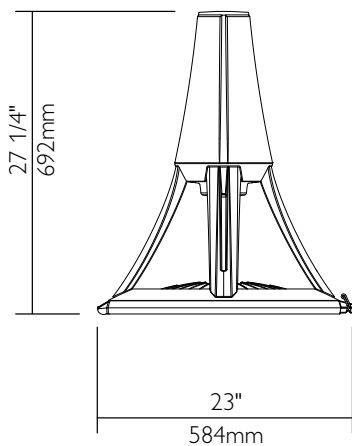

Sag Lens

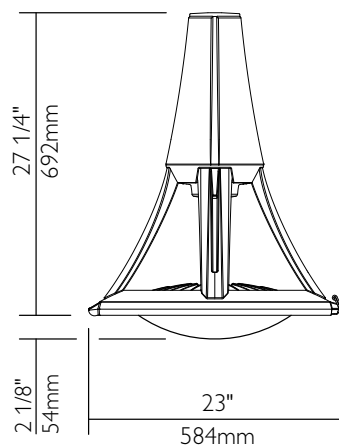

Key features

- Up to 96 high performance white LEDs
- Can deliver over 20,000 lumens equivalent to 400W HID
- Complete IP66 rated luminaire
- Dedicated LED optics (types 2,3,4 and 5)
- Operating lifespan of 100,000 hours. (with L₇₀ lumen maintenance at 25° C)
- Ships standard with dimmable (0-10V) driver

UrbanScape

LED post-top



The height of style and performance for park and pathway lighting

The UrbanScape LED post-top luminaire features flexible, robust energy-saving solutions for modern-styled urban architectural lighting. The post-top model comes with a flat lens to highlight the thinness of the LEDs. The luminaire provides attractive lighting at night, adding appeal to the surroundings and promoting safe use of the environment.

MPTC

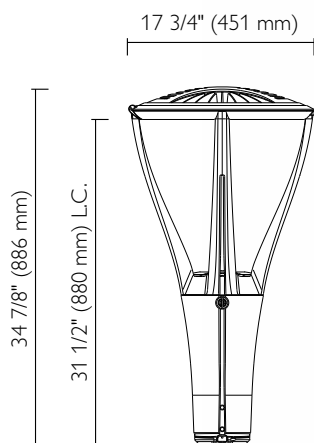

Key features

- Up to 80 high performance white LEDs
- Many lumen packages to choose from
- Complete IP66 rated luminaire
- Dedicated LED optics (types 2,3,4 and 5)
- Operating lifespan of 100,000 hours. (with L_{70} lumen maintenance at 25° C)
- Ships standard with dimmable (0-10V) driver
- Motion Response option available

Features & Benefits

Thermal Mastery

Features

LED heat sink made of die cast aluminum)

Placement of the electronic components in the fitter

Optimal thermal design

Benefits

→ Optimizes the LEDs' efficiency and life

→ Reduces degradation of light output over the lifespan

→ Operating lifespan of 100,000 hours L_{70} at 25°C.

→ Suitable for operation in an ambient temperature up to 40°C / 104°F

→ UL certified (Runs cool in almost every climate).

Unparalleled performance in thermal management

Because of the high efficiency thermal design, both LEDs and driver achieve 100,000 hours L_{70} at 25°C.

Longevity

Our longevity story is more than just using LEDs. During the design phase, industrial designers and engineers made sure that critical components (such as the LED board and the driver) are isolated from each other, located in the fixture to better manage the heat and maximize overall system life.

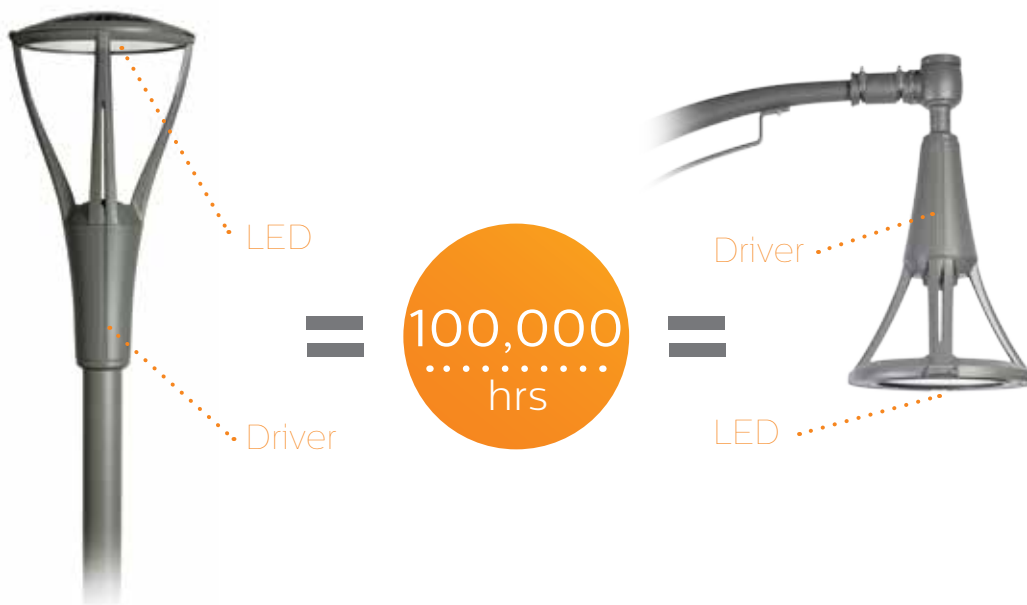

Sustainability

Features	Benefits
0% uplight (full cut-off / U=0 (bug rating)) (with flat lens)	→ Reduces light pollution, dark sky friendly.
Complete LED luminaire rated IP66	→ Protects the light source and electrical components from degradation caused by environmental pollutants such as rain, ice, snow, dust, sand, etc. Improved lifetime.
Energy efficient luminaire	→ Uses less energy compared to HID luminaires. The Philips Xitanium driver offers market leading power management and longevity due to superior heat management.
Made of sustainable materials (93% of the product can be recycled)	→ Projects a green image that pleases citizens and investors.
Eco-designed	→ Can be taken apart upon end-of-life for recycling.

Photometry

Features	Benefits
Flat lens of the luminaire	→ 0% uplight (full cut-off / U=0 (bug rating)).
Optical system composed of high performance refractor lenses	→ Spacing up to 7 x mounting height (depending on the luminaire version chosen and your application). Optimizes target lumens for superior lighting uniformity and intensity.
Dedicated LED optics / types 2,3,4 and 5	→ Provides high quality, uniform light distribution. Better control on light trespass.

Philips Lumileds LUXEON LEDs

UrbanScape's light engine uses the latest Philips LED technology to answer the needs of the most demanding projects and industry standards. LUXEON LEDs deliver a high color rendering index (CRI) and exceptional lumen output at an optimal color temperature required by municipalities and various type of applications.



Advanced Outdoor Lighting Solutions

Control ready solutions

Features

Ships standard with 0-10V driver

Optional 5-pin receptacle for dimming

Benefits

→ Dimming compatible.

→ Control ready for future proofing.

→ Compatible with dimming control as per ANSI C136.41.

Luminaire solutions

Features

Dynadimmer control ready

Motion Response option available with post-top version

Constant light output

Benefits

Schedules and dimming optimized for safety and economy.

→ Pre-programmed scenarios make the Dynadimmer a simple solution.

→ Ensure maximum light level when needed without compromising savings.

→ Efficient sensing with wide angle coverage and adjustable aiming

→ Management of light output to maintain lighting uniformity and intensity.

Site solutions

Different options are available according to your needs. Please contact us for more information.

City solutions

Features

CityTouch ready with Starsense (Dim and On/Off)

Amplight control ready

Benefits

Gives you the power to make the lighting in your city dynamic, intelligent and totally flexible.

→ Makes planning, analyzing and managing your lighting infrastructure very simple.

→ Dimming capability through industry standard twist lock receptacle.

→ Intelligent monitoring and control, automated management system that makes it easy to monitor and manage the entire system, in real time.

Starsense and CityTouch,

flawless communication

Set your lighting management on the right path for the future.
Make your city a smart city with connected lighting solutions.

Starsense Lighting Control System Dimmable is a revolutionary telemanagement system that connects your urban luminaires to Philips CityTouch Lighting Management Software, a web-based remote lighting asset management software solution that makes planning, analyzing, and managing your lighting infrastructure very simple with its intuitive user interface, map-based visualizations, and simple charts and diagrams. When combined with Starsense Dimmable, with just a few simple mouse clicks, you can monitor, adjust and control the lighting in your city. You are automatically informed when a failure occurs, enabling you to immediately initiate the work process. You can boost light levels to improve sense of security and visibility, or the lighting them to save energy and prevent light pollution. The scalability of CityTouch allows administrators to directly address individual light points, streets, or an entire district, empowering cities to deliver precisely the right amount of light at any place or time.

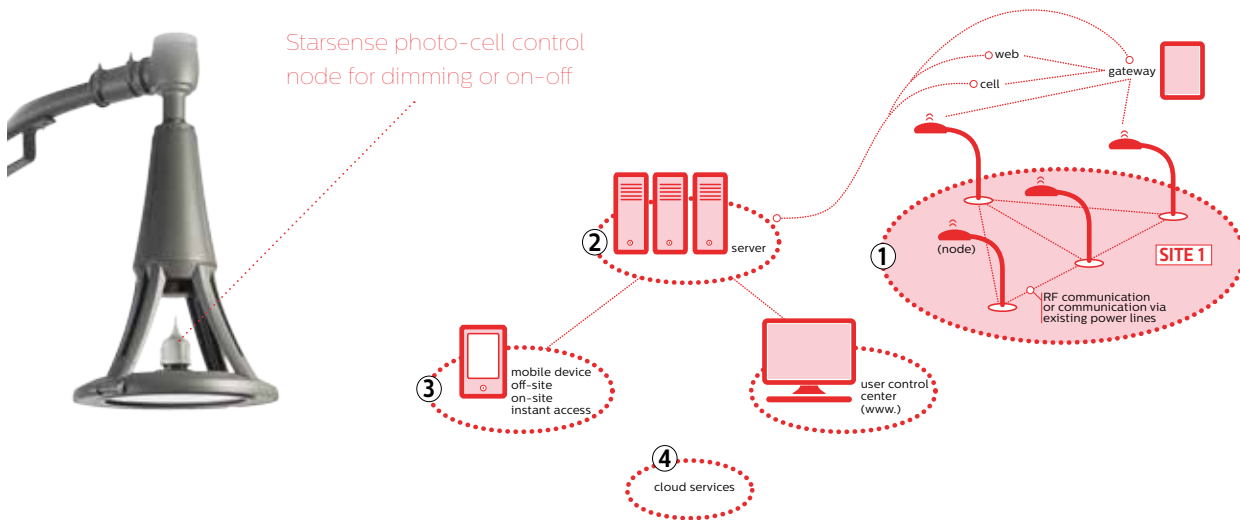

LED Lifespan

Features

Benefits

Philips LEDgine platform	→ Reduced maintenance costs, lower electrical bills, superior photometric performance, reduces light trespass and uplight.
Up to 80 high performance white LEDs (96 in the pendant version only)	→ Creates ambience and makes architecture look more authentic. Ensures maximum reliability and safety for drivers and citizens
The LEDgine comes with different driver possibilities and different LED boards	→ Optimized scenarios offering superior longevity and energy savings or maximum lumen output.
Available in standard neutral 4000 Kelvin, 70 CRI (Consult factory for other temperatures / Warm 3000 Kelvin and Cool 5700 Kelvin)	→ Produces improved color rendering vs. HID for greater perception. Creates different lighting ambiances.

* Calculated with an ambient temperature of 25°C / 77°F.

Pendant Ordering guide

example: MSC-145W64LED4K-T-LE3F-120-CDMGM25-SMA-RCD-BKTX

Luminaire	LED Module	Optical System	Voltage	Driver Options	Adaptor	Luminaire Options	Accessories	Mounting	Pole	Finish
MSC								-	-	
MSC ¹ : UrbanScape Pendant LED Luminaire	35W32LED4K-T ² 55W32LED4K-T ² 72W32LED4K-T 97W32LED4K-T ² 55W48LED4K-T 80W48LED4K-T 108W48LED4K-T 140W48LED4K-T 70W64LED4K-T 110W64LED4K-T 145W64LED4K-T ² 195W64LED4K-T ² 90W80LED4K-T 135W80LED4K-T 180W80LED4K-T 110W96LED4K-T 160W96LED4K-T 215W96LED4K-T ³	LE2F: Type II (ASYM) flat lens LE3F: Type III (ASYM) flat lens LE3WF ⁴ : Type III (ASYM) wide flat lens LE4F: Type IV (ASYM) flat lens LE5F: Type V (SYMM) flat lens LE2S: Type II (ASYM) sag lens LE3S: Type III (ASYM) sag lens LE3WS ⁴ : Type III (ASYM) wide sag lens LE4S: Type IV (ASYM) sag lens LE5S: Type V (SYMM) sag lens	120: 120V 208: 208V 240: 240V 277: 277V 347: 347V ⁵ 480: 480V ⁵	CDMG: Dynadimmer for standard dimming (Consult MetroScape spec sheet on the Philips web site for complete Dynadimmer scenarios) CLO: Pre-set driver to manage lumen depreciation AST: Pre-set driver for progressive start-up OTL: Pre-set driver to signal end of life of the lamp DALI: Pre-set driver compatible with the DALI control system MA1: 1/4" NPT threaded hole adaptor accepting a threaded tube. MA2: 1/2" NPT threaded hole adaptor accepting a threaded tube. SMA: Decorative retro side-mounted cast-aluminum, accepts tubes from 1 5/8" to 2 3/8" SMB: Decorative contemporary side-mounted cast-aluminum, accepts tubes from 1 5/8" to 2 3/8"		BX ⁶ : Bird repellent DH: Opaque decorative hood HS: House Side Shield PH8: Photoelectric cell PH8XL: Photoelectric cell, extended life PH9: Shorting Cap RCD ⁷ : 5-Pin receptacle for dimming photoelectric cell SPC ^{8,9} : Starsense Photo-cell Control Node On-Off SPCD ^{8,9} : Starsense Photo-cell Control Node Dimming		Consult the Philips web site for details and the complete line of Mountings		BE2TX BE6TX BE8TX BG2TX BKTX BRTX GN4TX GN6TX GN8TX GNTX GR GY3TX NP RD2TX RD4TX TG TS WHTX <i>(Consult UrbanScape spec sheet on the Philips web site for complete Finish code descriptions)</i>
									Consult the Philips web site for details and the complete line of Poles	

Post-Top Ordering guide

example: MPTC-42W32LED4K-T-LE3-120-CDMGM25-PH8-BKTX

Luminaire	LED Module	Optical System	Voltage	Driver Options	Luminaire Options	Mounting	Pole	Accessories	Finish	
MPTC										
MPTC ¹ : UrbanScape Post-Top LED Luminaire	16W16LED4K-T ² 24W16LED4K-T ² 30W16LED4K-T ² 48W16LED4K-T ² 35W32LED4K-T ² 55W32LED4K-T ² 72W32LED4K-T 97W32LED4K-T ² 55W48LED4K-T 80W48LED4K-T 108W48LED4K-T 140W48LED4K-T ² 70W64LED4K-T 110W64LED4K-T 90W80LED4K-T 135W80LED4K-T	LE2: Type II (ASYM) flat lens LE3: Type III (ASYM) flat lens LE3W ⁴ : Type III (ASYM) wide flat lens LE4: Type IV (ASYM) flat lens LE5: Type V (SYMM) flat lens	120: 120V 208: 208V 240: 240V 277: 277V 347: 347V ⁵ 480: 480V ⁵	CDMG: Dynadimmer for standard dimming (Consult UrbanScape spec sheet on the Philips web site for complete Dynadimmer scenarios) CLO: Pre-set driver to manage lumen depreciation AST: Pre-set driver for progressive start-up OTL: Pre-set driver to signal end of life of the lamp DALI: Pre-set driver compatible with the DALI control system	HS: House Side Shield OVR: Dynadimmer override function PH8: Photoelectric cell PH8XL: Photoelectric cell, extended life PH9: Shorting Cap RCD ⁷ : 5-Pin receptacle for dimming photoelectric cell TN3 ¹⁰ : Fitter to fit over a 3" (76 mm) O.D. by 4" (102 mm) long tenon TN3.5 ¹⁰ : Fitter to fit over a 3 1/2" (89 mm) O.D. by 4" (102 mm) long tenon		Consult the Philips web site for details and the complete line of Poles	SPC ^{8,9} : Starsense Photo-cell Control Node On-Off SPCD ^{8,9} : Starsense Photo-cell Control Node Dimming	BE2TX BE6TX BE8TX BG2TX BKTX BRTX GN4TX GN6TX GN8TX GNTX GR GY3TX NP RD2TX RD4TX TG TS WHTX <i>(Consult UrbanScape spec sheet on the Philips web site for complete Finish code descriptions)</i>	
									Consult the Philips web site for details and the complete line of Mountings	

1. Luminaire is always shipped with a dimmable 0-10V driver (except for 35W32LED4K).
2. 347V and 480V not available.
3. Not available with DH option.

4. Not available with HS option.
5. Not available with driver options.
6. Can not be used with DH, PH8, PH8XL, PH9 or RCD.
7. Use of photoelectric cell or shorting cap is required to ensure proper illumination.

8. Luminaire option RCD is required with this accessory.
9. CDMG, CDMGP and DALI are not available with SPC and SPCD.
10. Not available with Motion Response.

Luminaire Options:

Pendant and Post-Top



HS: House Side Shield



RCD: 5-Pin receptacle for dimming photoelectric cell



PH8: Photoelectric cell

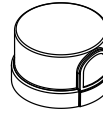

PH8XL: Photoelectric cell, extended life

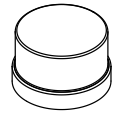

PH9: Shorting Cap

Pendant Only

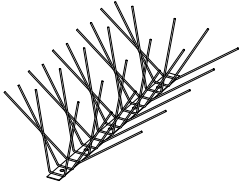

BX: Bird repellent

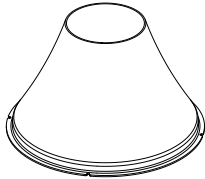

DH: Opaque decorative hood

Post-Top Only

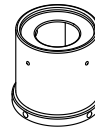

TN3: Fitter to fit over a 3" (76 mm) O.D. by 4" (102 mm) long tenon

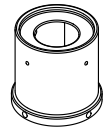

TN3.5: Fitter to fit over a 3 1/2" (89 mm) O.D. by 4" (102 mm) long tenon

Driver Options:

Pendant and Post-Top

CDMG: Dynadimmer for standard dimming

CLO: Pre-set driver to manage lumen depreciation

AST: Pre-set driver for progressive start-up

OTL: Pre-set driver to signal end of life of the lamp

DALI: Pre-set driver compatible with the DALI control system

Luminaire Accessories:

Pendant and Post-Top

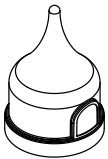

SPC: Starsense Photo-cell control node, on-off

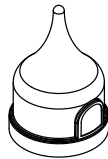

SPCD: Starsense Photo-cell control node, dimming

Post-Top Only

Motion Response: Tenon mount motion response provides 270° coverage on an adjustable knuckle. The coverage equals to up to 6 times the sensor height. It is an option offered jointly with the Dynadimmer **OVR** option, that can bring the light up to 100% when the motion response is triggered. It is available in a single or double mounting option. The tenon mount is fully rotatable 360°.

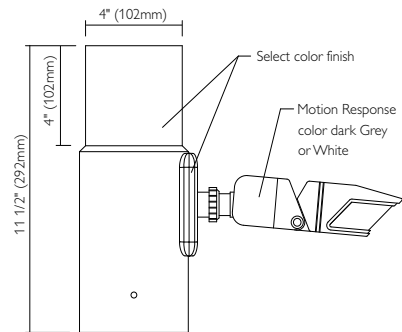

Adaptors:

Pendant Only

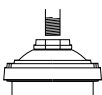

MA1: 1/4" NPT threaded hole adaptor accepting a threaded tube.

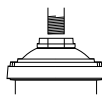

MA2: 1/2" NPT threaded hole adaptor accepting a threaded tube.

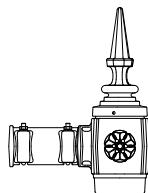

SMA: Decorative retro side-mounted cast-aluminum, accepts tubes from 1 5/8" to 2 3/8"

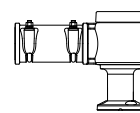

SMB: Decorative contemporary side-mounted cast-aluminum, accepts tubes from 1 5/8" to 2 3/8"



© 2014 Koninklijke Philips N.V. All rights reserved.
Specifications are subject to change without notice.
www.philips.com/luminaires

PLu-1314BR UrbanScape Brochure 06/14

Philips Lighting
North America Corporation
200 Franklin Square Drive
Somerset, NJ 08873
Phone: 855-486-2216

Imported by: Philips Lighting,
a division of Philips Electronics Ltd.
281 Hillmount Rd
Markham, ON L6C 2S3
Phone: 800-668-9008