

# INSTRUCTIONS

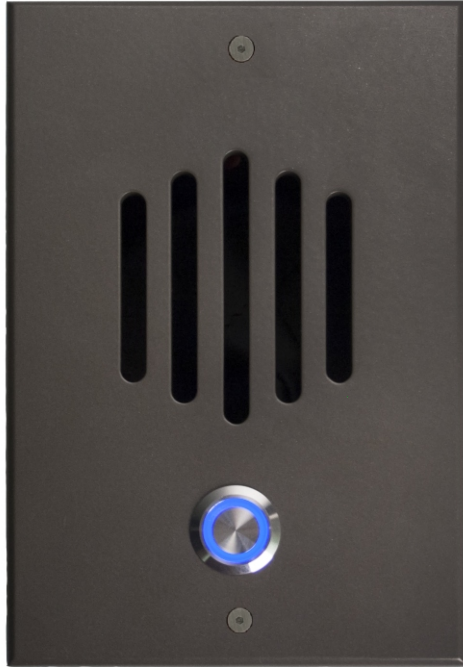

**SI-XXXX**

**SI-XXXXC**

**SI-XXXXP**

**Elite Series Brass Intercoms**

# Intoduction

Channel Vision's SI-Series are 1/4" solid brass door plates that interface with a telephone entry controller to provide communication with the front door. They are available in a variety of configurations including options for a hidden camera and compatibility with Panasonic's popular KSU phone systems. Each plate comes with the DP-9001 or DP-9002 surface mount box (depending on the finish color). It is compatible with the DP-Rbox-III flush mount box, which is sold separately.

Features:

- 1/4" thick solid brass plate
- Discrete speaker and microphone
- Fits the DP-Rbox-III flush mount box, and the DP-9001, DP-9002 surface mount boxes.
- Available in 8 different finishes

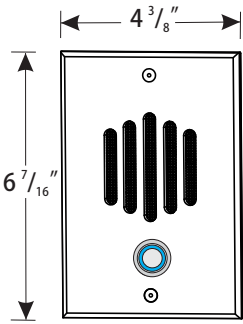

**DP-Series Faceplate  
(included)**

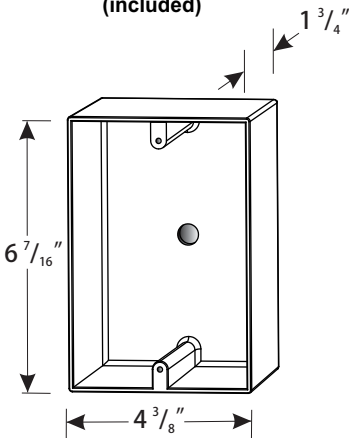

**DP-9001 or DP-9002  
Surface Mount Box  
(included)**

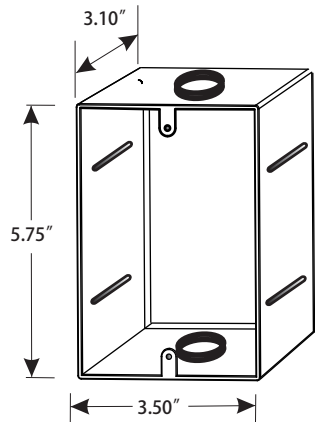

**DP-Rbox-III  
Flush Mount Box  
(optional)**

# Understanding the model number:

Part numbering: SI door plates	
<b>SI-0212C</b>	(SI-0212C shown for example only)
	Blank P-0920, P-0921, & TE-111 compatible
	C P-0930 compatible
	P Panasonic KSU compatible
	212 White
	222 Polished Brass
	232 Antique Brass
	242 Chrome
	252 Oil Rubbed Bronze
	262 Antique Copper
282 Black	
302 Satin Nickel	
0 No camera	
6 Color camera	

## Understanding the compatibility options

There are three different types of systems that SI door plates can be used with. The compatibility for these different types of systems is indicated by the suffix of the model number which follows the 4-digit numerical code.

If there is not a letter suffix on the model number, such as SI-0212, that door plate is compatible with Channel Vision's telephone entry products including models P-0920, P-0921, and TE-111.

If the suffix is the letter "P", such as SI-0212P, then the door plate is compatible with Panasonic's phone systems which are designed to use the Panasonic door phone model: KXT-xxxxx.

If the suffix is the letter "C", such as SI-0212C, then the door plate is compatible with Channel Vision's Whole-House CAT5 Intercom Hub, model P-0930.

Please double check to be sure that you have purchased the correct model number for your application.

# Attaching the Companion Board (300-001 and 300-003)

This door intercom product consists of two sub assemblies which must be attached to each other before the final assembly can be installed. In this guide the electronic sub assembly will be referred to as the "Companion Board" and the mechanical assembly will be referred to as the "Door Plate." Review the following diagrams and assemble as shown.

## Companion Board Connection Details

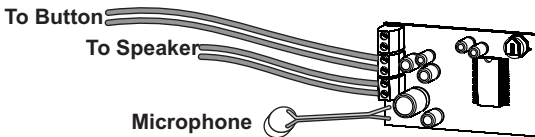

Remove the plastic cap that covers the microphone compartment on the door plate. Place the microphone in the compartment and replace the plastic cap over the microphone. Note that the plastic cap will form a friction fit over the top of the microphone wires holding them snug against the outer compartment wall until they exit at the base as shown. Remove the mounting screws which are already attached to the bracket and use them to attach the companion board. The companion board should mount on the front side of the bracket so that the screws pass through the companion board before threading into the bracket.

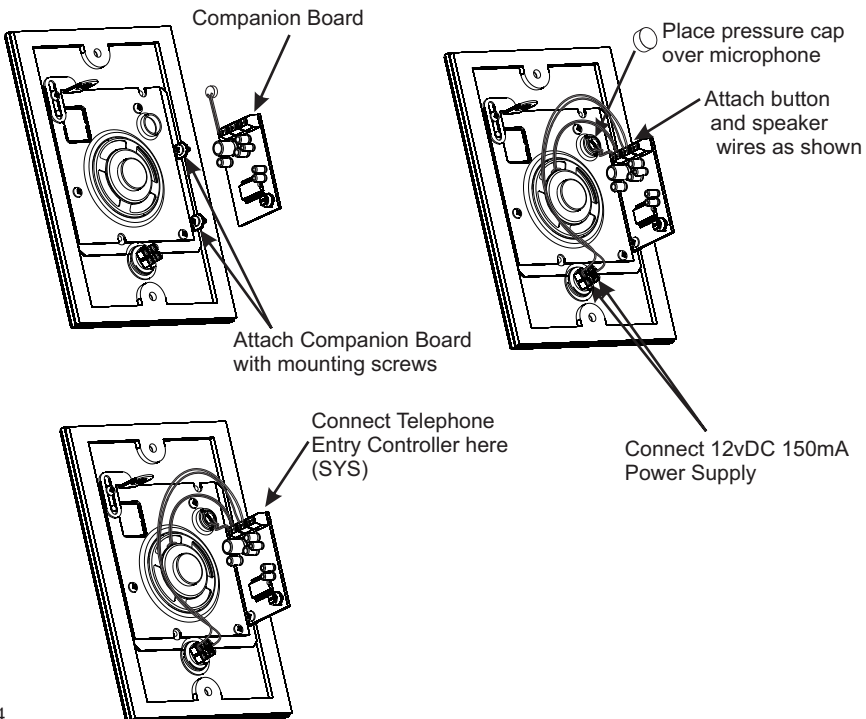

# Attaching the Camera (SI-XXXX and SI-XXXXP)

The SI-6xxx, SI-6xxxC, and SI-6xxxP come with a mini camera that can be attached to the integrated mount that allows the camera to see through the opening in the plate. The illustrations below show how to mount the camera.

## Mini Pinhole Camera

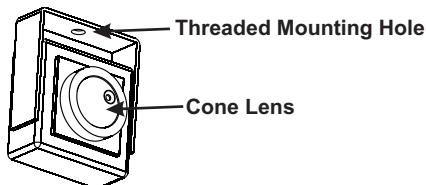

Break away the section of perforated metal screen that covers the camera opening by pushing a screwdriver through the slot on the front of the door plate. Press near the top or bottom of the section and the tabs that hold it in place will break free. Attach the camera to the mount so that the cone of the camera points through the opening. Adjust the camera to the desired position and secure it in place by tightening the screw in the mount.

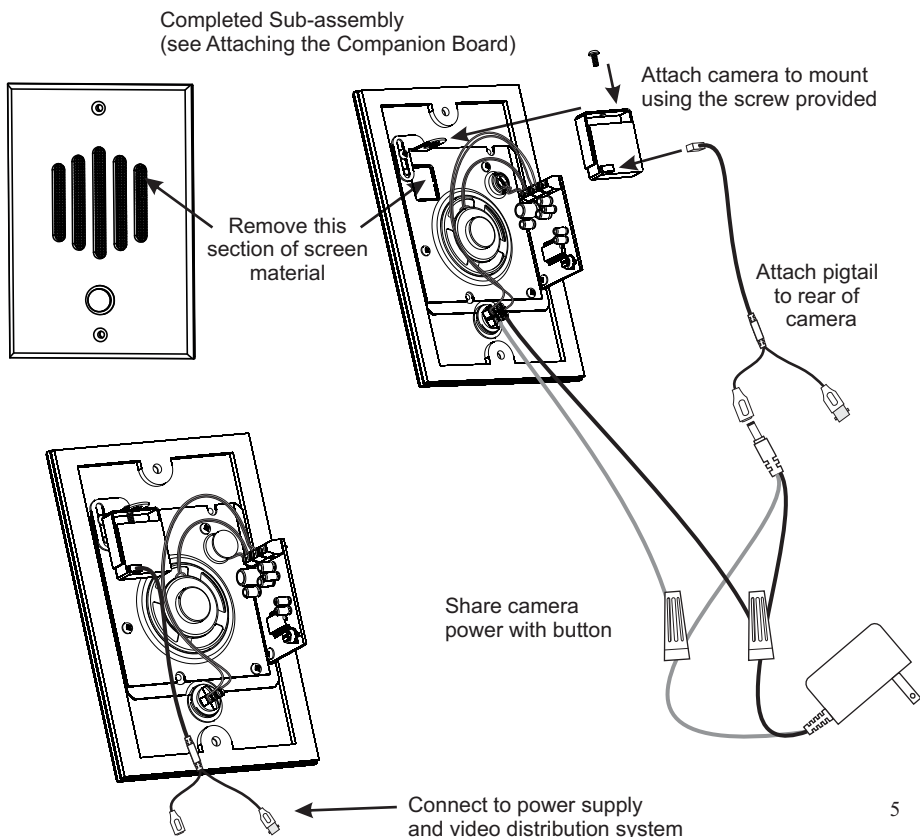

# Attaching the Companion Board (SI-XXXXC)

This door intercom product consists of two sub assemblies which must be attached to each other before the final assembly can be installed. In this guide the electronic sub assembly will be referred to as the "Companion Board" and the mechanical assembly will be referred to as the "Door Plate." Review the following diagrams and assemble as shown.

## Companion Board Connection Details

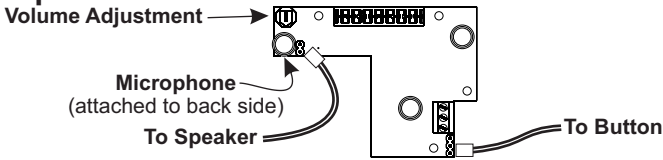

Position the companion board onto the three mounting tabs as shown below. The microphone attached to the back side of the companion board should line up with the microphone tube on the bracket. Bend the mounting tabs to secure the companion board. Connect the speaker and button wires by sliding the small connector over the exposed pins on the companion board as shown.

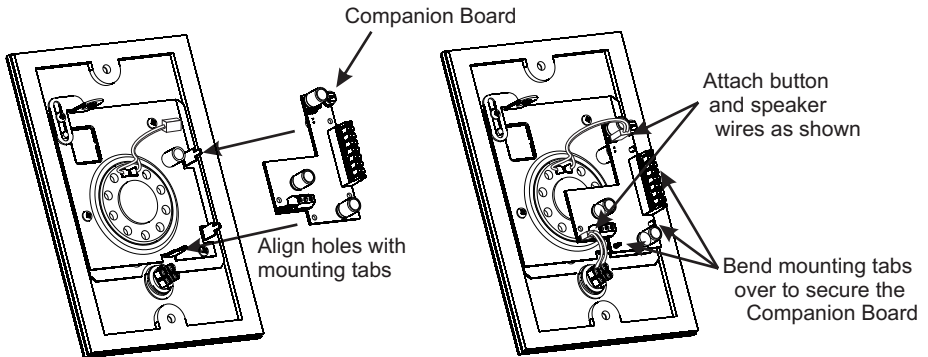

## Completed Sub-assembly

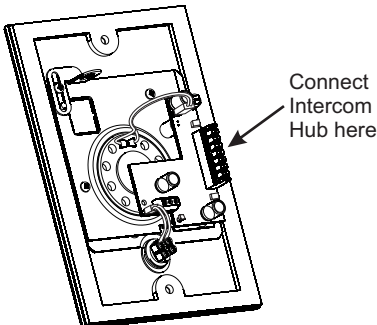

# Attaching the Camera (SI-XXXXC)

The SI-6xxxC come with a mini camera that can be attached to the integrated mount that allows the camera to see through the opening in the plate. The illustrations bellow show how to mount the camera.

## Mini Pinhole Camera

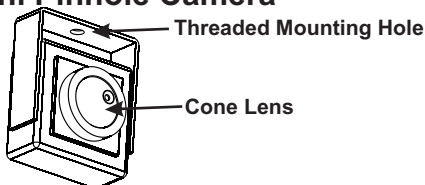

Break away the section of perforated metal screen that covers the camera opening by pushing a screwdriver through the slot on the front of the door plate. Press near the top or bottom of the section and the tabs that hold it in place will break free. Attach the camera to the mount so that the cone of the camera points through the opening. Adjust the camera to the desired position and secure it in place by tightening the screw in the mount.

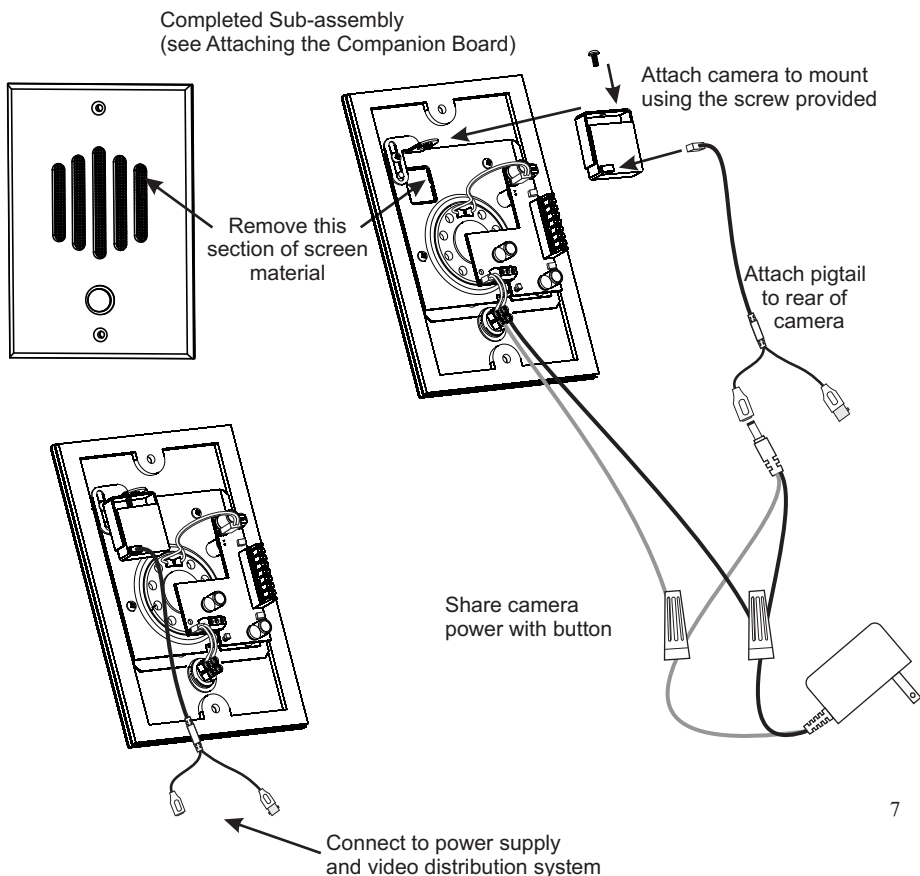

# Channel Vision Compatible (SI-xxxx)

Channel Vision's SI-0xxx does not come with a camera, but the SI-6xxx series door plates come with a mini camera which attaches to the integrated camera mount. The SI-6xxx contains a color camera. The SI-0xxx and SI-6xxx all interface with the Channel Vision's telephone entry controllers, TE-111, P-0920 and P-0921 to provide audio and video communication with the front door.

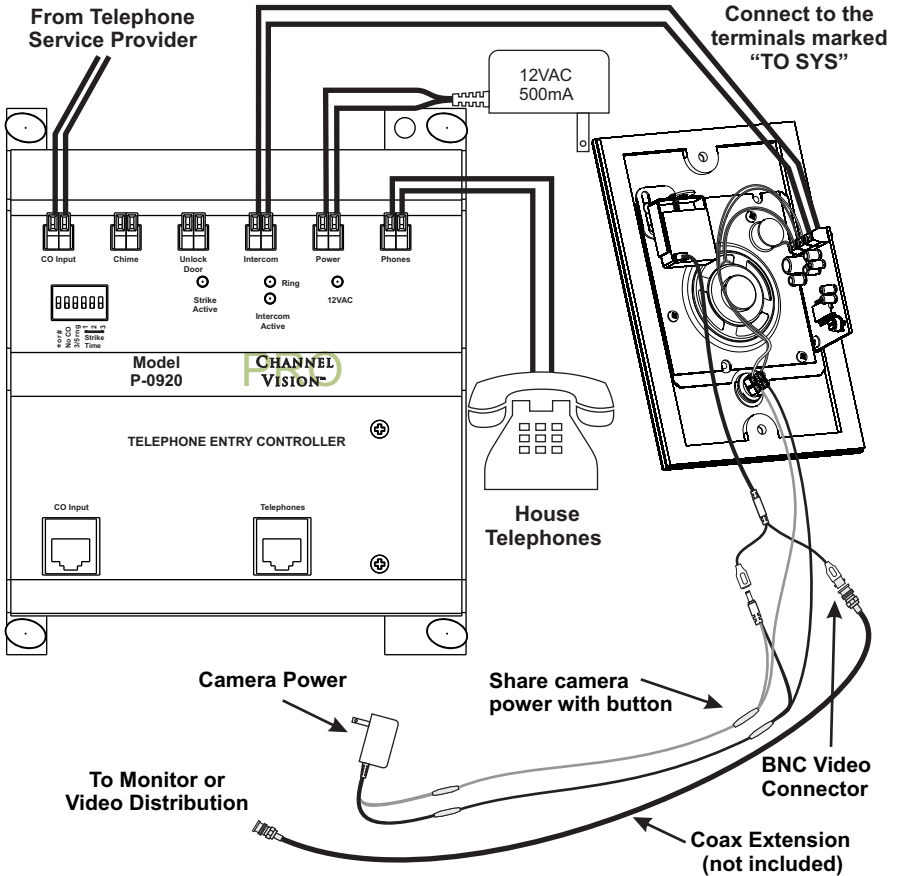

## Installation:

- Install a compatible mounting box at the desired location: DP-Rbox-II, DP-Rbox-III flush mount boxes, DP-9001 surface mount box, or DP-9002 surface mount box.
- Using a 2-conductor wire, connect the Telephone Entry Controller to the screw terminal block on the DP marked "SYS"
- If necessary, attach the camera's video output to a coax cable (RG-59 or RG-6).
- If necessary, cut the connector off of the end of the power supply and splice in an extension using crimp-on connectors.



# Panasonic® Compatible (DP-xxxxP)

Channel Vision's SI Panasonic Series models are a compatible upgrade for the Panasonic KXT series products. These 1/4" solid brass door plates provide an attractive alternative to the standard plastic door station sold by Panasonic. This product interfaces with Panasonic's KSU phone systems to provide communication with the front door. Model SI-6xxxP includes a color camera, and SI-0xxxP includes no camera.

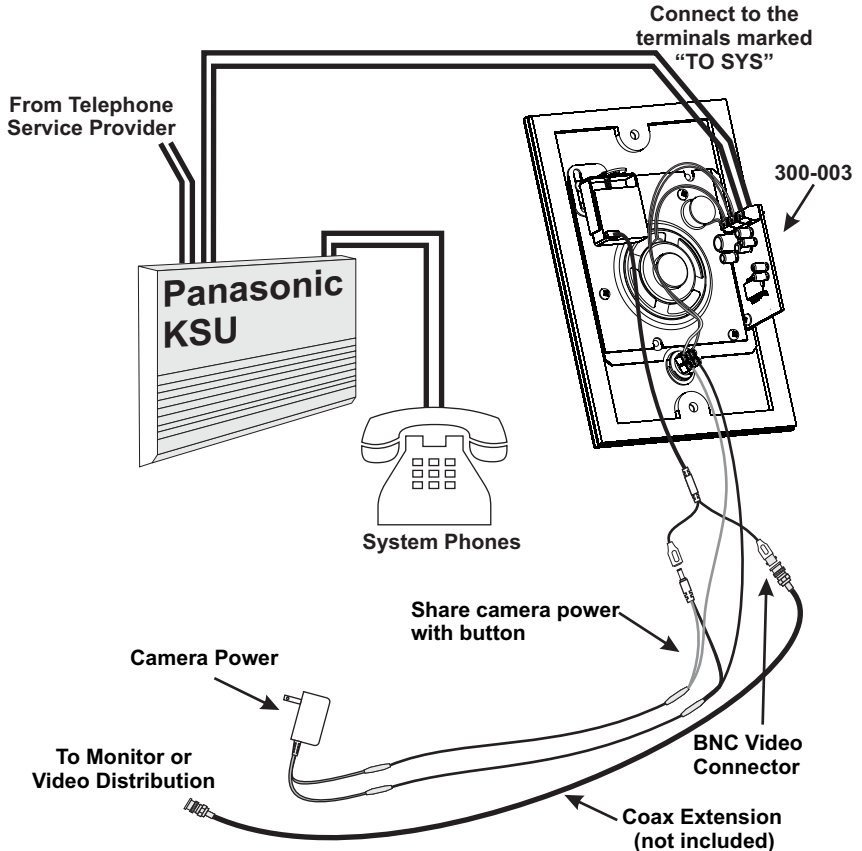

## Installation:

- Install a compatible mounting box at the desired location: DP-Rbox-II, DP-Rbox-III flush mount boxes, DP-9001 surface mount box, or DP-9002 surface mount box.
- Using a 2-conductor wire, connect the door phone output of your Panasonic KSU to the empty screw terminal block on the SI doorplate (see diagram).
- Consult your Panasonic manual for instructions regarding door phone operation.
- If necessary, attach the camera's video output to a coax cable (RG-59 or RG-6).
- If necessary, cut the connector off of the end of the power supply and splice in an extension using crimp-on connectors.

# Channel Vision CAT5 Intercom Compatible (SI-xxxxC)

The diagram below shows how to connect the SI-xxxxC to Channel Vision's CAT5 Whole-House Intercom system. When the button is pressed on the SI-xxxxC the ST-2000 Intercom Stations will generate a door chime. Pressing Answer/End will open communication with the SI-xxxxC. Model SI-6xxxC includes a color camera, and SI-0xxxC includes no camera.

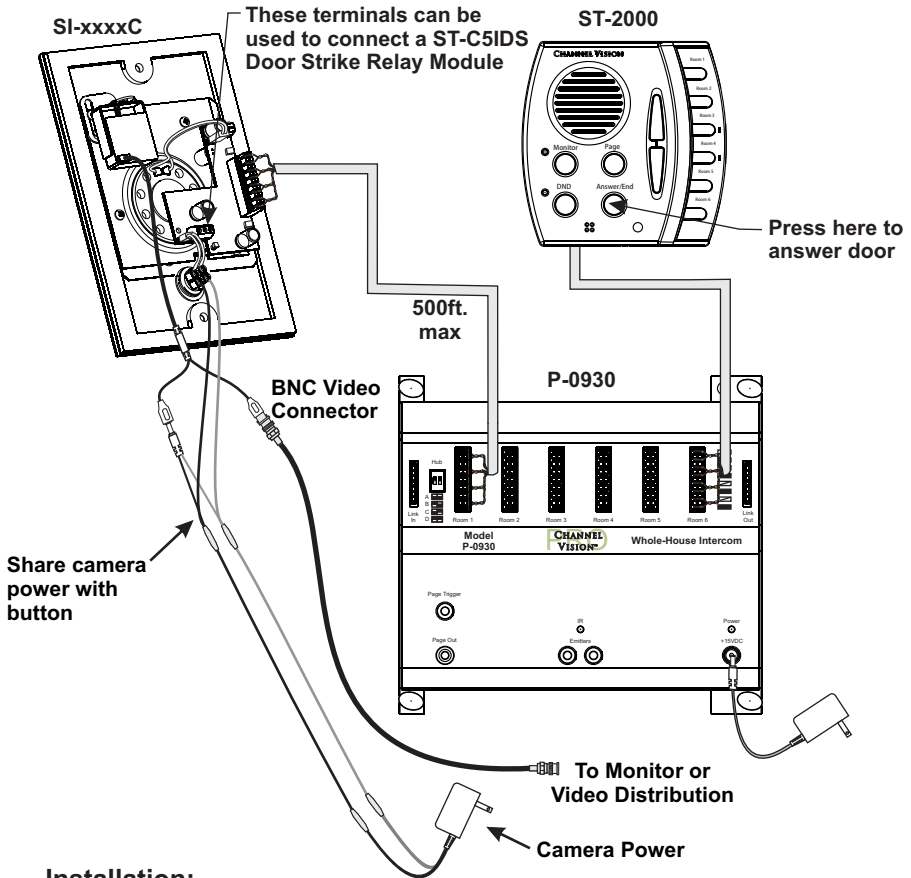

## Installation:

- Install a compatible mounting box at the desired locations: DP-Rbox-II, DP-Rbox-III flush mount boxes, DP-9001 surface mount box, or DP-9002 surface mount box.
- Using CAT5 wire, connect the P-0930 to the 110 connector on the SI doorplate using 110 punch tool or Channel Vision model J-110-Tool or 1014.
- If necessary, attach the camera's video output to a coax cable (RG-59 or RG-6).
- If necessary, cut the connector off of the end of the power supply and splice in an extension using crimp-on connectors.

# Specifications

## **Speaker:**

<b>Size (mm):</b>	50
<b>Depth (in):</b>	1.5
<b>Impedance:</b>	8 Ohms
<b>Power Peak (W):</b>	0.2
<b>Frequency Range:</b>	500 Hz - 4.5 kHz

## **Dimensions:**

<b>DP-Series plate only:</b>	6 1/2" (L) x 4 3/8" (W) x 1/4" (D)
<b>DP-Series assembly:</b>	6 1/2" (L) x 4 3/8" (W) x 1 3/4" (D)
<b>PCB Surface:</b>	Waterproof silicon protected
<b>DP Doorplate Surface:</b>	Solid Brass, Coated & Protected
<b>Button Color:</b>	Blue
<b>Button Power:</b>	12vDC 150mA

## **Color Camera: (SI-6xxx & SI-6xxxP only)**

<b>Signal System:</b>	NTSC
<b>Total Pixels</b>	1020 (H) x 508 (V) 520K
<b>Effective Pixels</b>	976 (H) x 494 (V) 480K
<b>Image Sensor</b>	1/3" 960H Super HD CCD II (Sony)
<b>Lens</b>	Pinhole, 5.5mm
<b>Signal Processing</b>	Digital
<b>Scanning System</b>	2:1 Interlace
<b>Sync System</b>	Internal
<b>Scanning Frequency</b>	59.94Hz (VD)
<b>Resolution</b>	700 TV Lines
<b>S/N Ratio</b>	More than 50dB (AGC Off)
<b>Video Output</b>	1.0 Vpp Composite (75Ω)
<b>Min Illumination</b>	0.0002 Lux@Sense-up
<b>OSD</b>	Yes
<b>Shutter</b>	Automatic
<b>Power Consumption</b>	12vDC 300mA total with button and camera (Power Supply model 5015PS, included)
<b>Operating Temperature</b>	14° - 122° Fahrenheit

## **\*Maintenance of Door Station plate**

Channel Vision recommends a light coating of vegetable oil on the surface and edging of the DP Doorplate for long lasting shine and protection. Quarterly to monthly maintenance is recommended.

# Two Year Limited Warranty

Channel Vision Technology will repair or replace any defect in material or workmanship which occurs during normal use of this product with new or rebuilt parts, free of charge in the USA, for two years from the date of original purchase. This is a no hassle warranty with no mail in warranty card needed. This warranty does not cover damages in shipment, failures caused by other products not supplied by Channel Vision Technology, or failures due to accident, misuse, abuse, acts of God, or alteration of the equipment. This warranty is extended only to the original purchaser when purchased through an authorized reseller. A purchase receipt, invoice, or other proof of original purchase date

will be required before warranty repairs are provided.

Mail in service can be obtained during the warranty period by calling (800) 840-0288 toll free. A Return Authorization number must be obtained in advance and can be marked on the outside of the shipping carton.

This warranty gives you specific legal rights and you may have other rights (which vary from state to state). If a problem with this product develops during or after the warranty period, please contact Channel Vision Technology, your dealer or any factory-authorized service center.

Channel Vision products are not intended for use in medical, lifesaving, life sustaining or critical environment applications. Channel Vision customers using or selling Channel Vision products for use in such applications do so at their own risk and agree to fully indemnify Channel Vision for any damages resulting from such improper use or sale.



• Intelligent Entertainment • Infrastructure • Security Solutions

234 Fischer Avenue, Costa Mesa, California 92626 USA

(714)424-6500 (800)840-0288 (714)424-6510 fax

email: [techsupport@channelvision.com](mailto:techsupport@channelvision.com)

[www.channelvision.com](http://www.channelvision.com)

500-363 rev A