

TORK[®]

POOL/SPA CONTROLS



JANUARY 2008

NSi

A DIVISION OF NSI INDUSTRIES, LLC

POOL/SPA PANEL PRODUCTS

FEATURES

POOL/SPA PANELS COMMON FEATURES	2
MECHANICAL & DIGITAL TIME SWITCH FEATURES	3
REMOVABLE/REVERSIBLE DOOR	4
INSIDE WIRING COMPARTMENT	
FOR (2) WHILE-IN-USE RECEPTACLE INSTALLATION	5

POOL/SPA PANELS (NO TIME SWITCHES INSTALLED)

40A Pool/Spa Panel with 20A, 120V, 2 circuit supplemental Load Center and provision for One Time Switch	6
100A Pool/Spa Panel with 120/240V, 5-space/10-circuit Load Center and provision for Two Time Switches	6
120A Pool/Spa Panel with 120/240V, 8-space/16-circuit Load Center and provision for Two Time Switches	6

POOL/SPA PANELS (WITH (1) OR (2) TIME SWITCHES INSTALLED)

40A Single Time switch Pool/Spa Panel with 20A, 120V, 2 circuit supplemental Load Center	7	P1101-M (120V)
40A Single Time switch Pool/Spa Panel with 20A, 120V, 2 circuit supplemental Load Center	7	P1104-M (240V)
40A 2-Time switch Pool/Spa Panel with 20A, 120V, 2 circuit supplemental Load Center	7	P1101-2M (120V)
40A 2-Time switch Pool/Spa Panel with 20A, 120V, 2 circuit supplemental Load Center	7	P1104-2M (240V)
100A, 2-Time switch Pool/Spa Panel with 120/240V, 5-space/10-circuit Load Center	8	P1104-M (240V)
100A, 2-Time switch Pool/Spa Panel with 120/240V, 5-space/10-circuit Load Center	8	P1104-M(240V), P1101-M (120V)
100A, 2-Time switch Pool/Spa Panel with 120/240V, 5-space/10-circuit Load Center	8	(2) P1104-M (240V)
120A, 2-Time switch Pool/Spa Panel with 120/240V, 8-space/16-circuit Load Center	9	P1104-M (240V)
120A, 2-Time switch Pool/Spa Panel with 120/240V, 8-space/16-circuit Load Center	9	(2) P1104-M (240V)

POOL/SPA PANELS (WITH TIME SWITCHES AND FIREMAN SWITCH INSTALLED)

100A 2-Time switch Pool/Spa Panel with 120/240V, 5-space/10-circuit Load Center	8	P1104-M (240V), P1104-FM-M (240V)
---	---	-----------------------------------

POOL/SPA PANELS (WITH TIME SWITCHES & LV TRANSFORMER INSTALLED)

120A, 2-Time switch Pool/Spa Panel with 120/240V, 8 space/16-circuit Load Center, 100Watt Transformer ..	10	P1104-M (240V)
120A, 2-Time switch Pool/Spa Panel with 120/240V, 8 space/16-circuit Load Center, 300Watt Transformer ..	10	P1104M (240V)

2 CIRCUIT WHILE-IN-USE POOL/SPA TIME SWITCHES WITH GFCI OUTLETS

11

TIME SWITCH MECHANISMS & ACCESSORIES

Time Switch Mechanisms: Mechanical, Digital, and Electromechanical	12
Accessories and Replacement Parts	13



TORK OFFERS **THE FIRST**
POOL/SPA PANELS TO
BE LISTED UNDER THE
NEW 2008 UL 1563,
CATEGORY WAWU

THE POOL/SPA PANEL: **REDESIGNED** FOR THE 21ST CENTURY

Tork has redesigned the pool/spa panel for the 21st century with numerous patented and unique features, reduced add-on material costs and less time to install – isn't that what everyone wants? Compact, elegant and best of all, **SAFE**; TORK offers the durable cost effective panels you've been waiting for! Add the listing under the new 2008 UL Standard, and it's a sure bet: **TORK** continues to be the leading industry innovator in time switch engineering.

All of our pool/spa panels accept custom designed time switch mechanisms AND conventional switches. The choices available in our panels can't be beat.

Enclosure only, or factory installed with the right time switch for your job, you'll find features that make an installation so easy and quick, you won't believe it!



TORK
A DIVISION OF **NSI** NSI INDUSTRIES, LLC

TORK POOL/SPA PANELS: COMMON FEATURES

EASY-HINGE PATENTED REMOVABLE AND REVERSIBLE DOOR

Change from left-opening to right-opening door in a snap! Allows for customized installations and solves installation problems in the field.

INTERCHANGEABLE TIMING MECHANISMS

Accepts both the new P Series time switch mechanisms as well as the TORK 1100 Series when installed with IAP adapter plate.

EASY FOLD & DROP 2-GANG SUPPLEMENTAL DEVICE PLATE

Allows additional wiring devices such as, X-10 or UPB devices for various control options. Device plate swings out, just drop devices in place & lock into position... that's it! No mounting screws, no labor.

DURABLE, NEMA 3R HIGH QUALITY SPEC GRADE STEEL ENCLOSURE WITH HIGH QUALITY FINISH

EASY FOLD & DROP INSIDE WIRING COMPARTMENT (IWC)

Unbelievably easy! Loosen one captive screw and the IWC folds out. Drop receptacles into place & lock into position... that's it! No mounting screws, no labor.

INSIDE WIRING COMPARTMENT (IWC)

Angled IWC allows the pool panel cover to act as a "while-in-use" cover for two (2) installed receptacles.

Also eliminates the need to pipe out to outdoor electrical box and "while-in-use" cover, cutting down on additional material cost and reducing installation time.

EASY-LATCH

Spring-loaded easy to operate lockable latch.

CAPTIVE SCREWS

All screws are captive, eliminating lost screws!

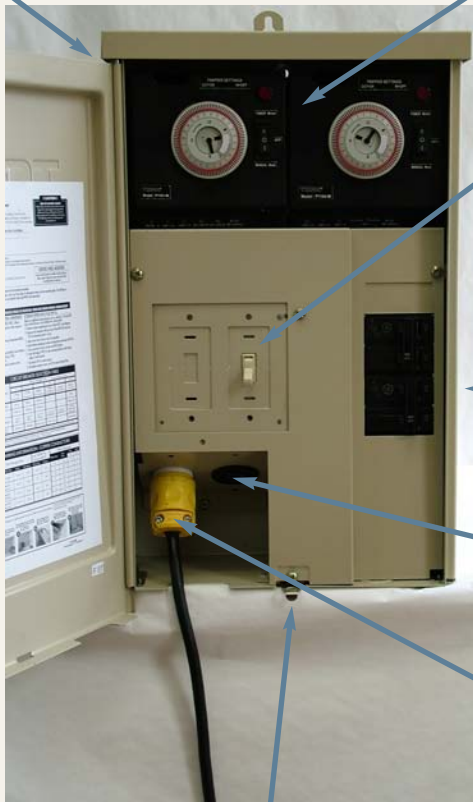

features

One or more of the following patents apply: 6.753.485, 6.791.039, 6.827.230B1, 6.930.268. Additional Patents pending.

TORK Pool/Spa Panels accept our custom designed P & PEW Series time switch mechanisms, as well as conventional 1100 Series mechanisms, with IAP adapter plate. Some of the unique features of our P & PEW Series are outlined below.

TORK
POOL/SPA
CONTROLS

MECHANICAL TIME SWITCH FEATURES

P SERIES 24 HOUR TIME SWITCH

QUICK INSTALL/RELEASE LEVER

for easy installation and removal when installing into pool panels

LOAD INDICATOR LAMP

REAL TIME SWITCH FACE

easy to set and check time

CAPTIVE TRIPPERS

15 minute intervals; no lost trippers

CONVENIENT EXTERNAL ROCKER SWITCH

3 position switch: Manual Mode Off-Timer Mode. To close down the pool without affecting the time settings, move the rocker switch to OFF, it is that simple!

ID LABELING

silkscreened labeling clearly displays time switch ratings as well as terminal identification for easy field installation



Conventional time switch mechanisms are easily adapted to all TORK Pool/Spa Panels.



**1101 M
1103 M
1104 M**

SAME ON/OFF TIMES EACH DAY

TIMING MOTOR: Heavy duty synchronous, self-starting high torque. Power consumption: 3 watts.

AUTOMATIC OPERATION:

Minimum ON setting:

20 minutes.

Minimum OFF setting:

75 minutes.

One pair of ON-OFF trippers supplied – accommodates up to 12 pairs.

TEMPORARY MANUAL OVERRIDE:

Standard.

40 Amp. Tungsten, 120VAC

40 Amp. Resistive, 120-277VAC Single Phase

40 Amp. General Purpose 120-277 VAC Single Phase

20 Amp. Inductive 120VAC, 277VAC, Single Phase

1000 VA Pilot Duty 120-277 VAC

2 HP (24 FLA) 120 VAC; 5 HP (28 FLA) 240 VAC

DIGITAL TIME SWITCH FEATURES

PEW SERIES 7-DAY PROGRAMMABLE DIGITAL TIME SWITCH

Allows for the control of various electrical equipment on a 7 day schedule. 15 different weekly programs:

- MON to SUN (same or different for each day)
- M/T/W/Th/F
- Sa/Su
- M/T/W/Th/F/Sa
- M/T/W
- Th/F/Sa
- M/W/F
- T/Th/Sa

QUICK INSTALL/RELEASE LEVER

for easy installation and removal when installing into pool panels

LOAD INDICATOR LAMP

LARGE LCD DISPLAY

7 DAY PROGRAMMING ONE MINUTE INTERVAL

BATTERY BACKUP

LARGE "MANUAL" BUTTON

- with three operating modes available:
 - Manual/Override
 - Timer/AUTO
 - OFF/Standby
- using the OFF mode, the pool can be closed down without disrupting the time settings



ID LABELING

silkscreened labeling clearly displays time switch ratings as well as terminal identification for easy field installation

SIMPLE LAYOUT

timer button layout makes programming easy!

EASY HINGE

PATENTED REMOVABLE & REVERSIBLE FRONT DOOR

ONLY A SCREWDRIVER IS NEEDED TO REVERSE THE OPENING DIRECTION OF THE DOOR!

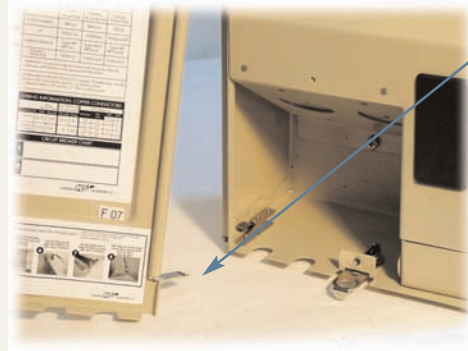

CLIP FEATURE
locks door, but
allows for easy
disengagement from
base



HINGE PIN
slides to allow left- or
right-opening
and easily re-inserts in
the other direction.
Enclosure comes factory
assembled with a left-
opening front cover.

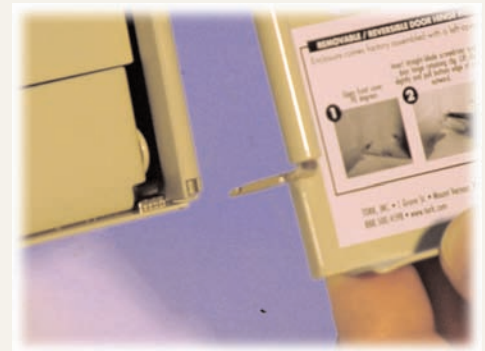

CLIP FEATURE
snaps to assure that
cover is firmly in place



One or more of the following patents apply: 6.753.485, 6.791.039, 6.827.230B1, 6.930.268. Additional Patents pending.

INSIDE WIRING COMPARTMENT

EASY FOLD & DROP INSIDE WIRING COMPARTMENT (IWC) MAKES IT SIMPLE TO INSTALL WIRING DEVICES QUICKLY!

TORK
POOL/SPA
CONTROLS

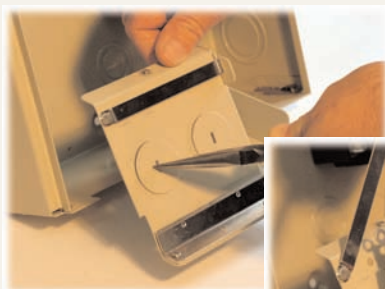

**IWC OPENED TO
INSTALL WIRING
DEVICES**



**KOs ARE REMOVED
AND WIRING
DEVICES DROPPED
IN PLACE**

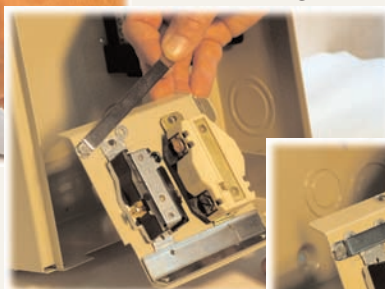

**HINGED LEVER
LOCKS**

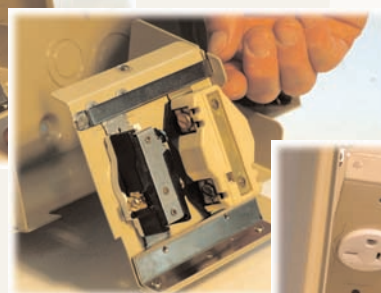

**IWC CLOSED
WITH DEVICES
INSTALLED**



EASY INSTALLATION

IWC swings out to allow for simple wiring installation



REMOVABLE KOs:

easily removed by opening the hinged lever arm & lifting out

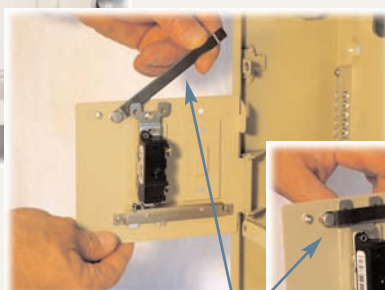

**Hinged lever arm
locks the devices in
place when closed**

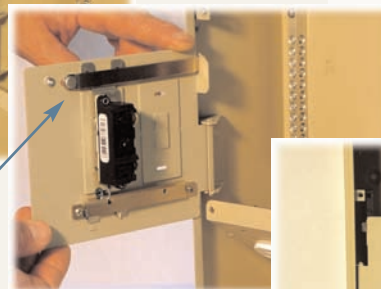

IWC IS SECURE

lower bracket holds wiring device mounting tabs in position



features

POOL/SPA PANELS – ENCLOSURE ONLY

TOTAL FLEXIBILITY:
YOUR CHOICE!
TORK pool/spa panel enclosures are available without time switches, allowing you to choose our new P1100 Series and PEW100 Series, or the customary 1100 Series time switch mechanism, depending on your requirements.



PP-100R
 SHOWN WITH
 DOOR CLOSED

CATALOG NO	UPC CODE	DESCRIPTION
PP-20R	94015	NEMA 3R 40A Pool/Spa Panel with Inside Wiring Compartment. Removable/reversible side opening door. Provisions for installing (1) time switch mechanism/module and (2) While-in-use wiring devices, 2-circuit 20A load center for supplemental 120V circuit/convenience outlet
PP-100R	94016	NEMA 3R 100 Amp Pool/Spa Panel with Inside Wiring Compartment. Removable/reversible side opening door. 100A, 120/240V 5 space, 10 circuit load center with provisions for installing (2) time switch mechanisms and Inside Wiring Compartment for (2) While-in-use wiring devices & (2) Device plates
PP-125R	94017	NEMA 3R 120 Amp Pool/Spa Panel with Inside Wiring Compartment. Removable/reversible side opening door. 120A, 120/240V 8 space, 16 circuit load center with provisions for installing (2) time switch mechanisms and Inside Wiring Compartment for (2) While-in-use wiring devices & (2) Device plates

One or more of the following patents apply: 6.753.485, 6.791.039, 6.827.230B1, 6.930.268. Additional Patents pending.

POOL/SPA PANELS WITH TIME SWITCHES



TORK
POOL/SPA
CONTROLS

TOTAL FLEXIBILITY:
YOUR WAY!

These and the panels on the following pages come with factory installed time switches as specified, speeding up your installation! TORK's part numbers make it easy to find the appropriate pre-installed panel for your requirements. Or call us to help you find the panel that fits your needs!



PP-20R-P1



PP-20R-2P4

CATALOG NO	UPC CODE	DESCRIPTION	TIME SWITCH RATINGS
PP-20R-P1	53000	NEMA 3R 40A Pool/Spa Panel with Inside Wiring Compartment. Removable/reversible side opening door. Complete with (1) installed P1101-M time switch. Provision for (2) While-in-use wiring devices, 2-circuit 20A load center for supplemental 120V circuit/convenience outlet	P1101-M 24 Hour Mechanical time switch DPST, 2NO: 40A Resistive/Inductive per pole, 3HP@120V 1NC: 15A Resistive & GP@120V
PP-20R-P4	53001	NEMA 3R 40A Pool/Spa Panel with Inside Wiring Compartment. Removable/reversible side opening door. Complete with (1) installed P1104-M time switch. Provision for (2) While-in-use wiring devices, 2-circuit 20A load center for supplemental 120V circuit/convenience outlet	P1104-M 24 Hour Mechanical time switch DPST, 2NO: 40A Resistive/Inductive per pole, 7.5HP@240V 1NC: 15A Resistive & GP@120V
PP-20R-2P1	53002	NEMA 3R 40A* Pool/Spa Panel with Inside Wiring Compartment. Removable/reversible side opening door. Complete with (1) installed P1101-2M time switch module. Provision for (2) While-in-use wiring devices, 2-circuit 20A load center for supplemental 120V circuit/convenience outlet	P1101-2M (2) 24 Hour Mechanical time switches, each DPST, 2NO: 40A Resistive/Inductive per pole 2HP@120V
PP-20R-2P4	53003	NEMA 3R 40A† Pool/Spa Panel with Inside Wiring Compartment. Removable/reversible side opening door. Complete with (1) installed P1104-2M time switch module. Provision for (2) While-in-use wiring devices, 2-circuit 20A load center for supplemental 120V circuit/convenience outlet	P1104-2M (2) 24 Hour Mechanical time switches, each DPST, 2NO: 40A Resistive/Inductive per pole, 5HP@120V

* UL RATED FOR 50A

† UL RATED FOR 60A

100 AMP POOL/SPA PANELS WITH TIME SWITCHES



PP-100R-P4

CATALOG NO	UPC CODE	DESCRIPTION	TIME SWITCH RATINGS
PP-100R-P4	53004	NEMA 3R 100 Amp Pool/Spa Panel with Inside Wiring Compartment. Removable/reversible side opening door. 100A, 120/240V, 10 circuit load center. Complete with (1) installed P1104-M time switch. Accepts (1) additional time switch. Provision for (2) While-in-use wiring devices & (2) Device plates	P1104-M 24 Hour Mechanical time switch DPST, 2NO: 40A Resistive/Inductive per pole, 7.5HP@240V 1NC: 15A Resistive & GP@120V
PP-100R-P4P1	53005	NEMA 3R 100 Amp Pool/Spa Panel with Inside Wiring Compartment. Removable/reversible side opening door. 100A, 120/240V, 10 circuit load center. Complete with (1) installed P1104-M and (1) installed P1101-M time switches. Provision for (2) While-in-use wiring devices & (2) Device plates	P1104-M 24 Hour Mechanical time switch DPST, 2NO: 40A Resistive/Inductive per pole, 7.5HP@240V 1NC: 15A Resistive & GP@120V P1101-M 24 Hour Mechanical time switch DPST, 2NO: 40A Resistive/Inductive per pole, 3HP@120V 1NC: 15A Resistive & GP@120V
PP-100R-2P4	53006	NEMA 3R 100 Amp Pool/Spa Panel with Inside Wiring Compartment. Removable/reversible side opening door. 100A, 120/240V, 10 circuit load center. Complete with (2) installed P1104-M time switches. Provision for (2) While-in-use wiring devices & (2) Device plates	(2) P1104-M (2) 24 Hour Mechanical time switches, each DPST, 2NO: 40A Resistive/Inductive per pole, 7.5HP@240V 1NC: 15A Resistive & GP@120V
P-100-P4P4FM	53009	NEMA 3R 100 Amp Pool/Spa Panel with Inside Wiring Compartment. Removable/reversible side opening door. 100A, 120/240V 10 circuit load center. Complete with (1) installed P1104-M time switch and (1) installed P1104FM-M time switch with Fireman switch (heater cut-off). Provision for (2) While-in-use wiring devices & (2) Device plates	P1104-M 24 Hour Mechanical time switch DPST, 2NO: 40A Resistive/Inductive per pole, 7.5HP@240V 1NC: 15A Resistive & GP@120V P1104-FM-M 24 Hour Mechanical time switch DPST, 2NO: 40A Resistive/Inductive per pole, 7.5HP@240V 1NC: 15A Resistive & GP@120V Fireman switch: SPST, 15A@120V

One or more of the following patents apply: 6.753.485, 6.791.039, 6.827.230B1, 6.930.268. Additional Patents pending.

120 AMP POOL/SPA PANELS WITH TIME SWITCHES



TORK
POOL/SPA
CONTROLS



PP-125R-P4



PP125R-2P4

CATALOG NO	UPC CODE	DESCRIPTION	TIME SWITCH RATINGS
PP-125R-P4	53007	NEMA 3R 120 Amp Pool/Spa Panel with Inside Wiring Compartment. Removable/reversible side opening door. 120A, 120/240V 16 circuit load center. Complete with (1) installed P1104-M time switch. Accepts (1) additional time switch. Provision for (2) While-in-use wiring devices & (2) Device plates	P1104-M 24 Hour Mechanical time switch DPST, 2NO: 40A Resistive/Inductive per pole, 7.5HP@240V 1NC: 15A Resistive & GP@120V
PP-125R-2P4	53008	NEMA 3R 120 Amp Pool/Spa Panel with Inside Wiring Compartment. Removable/reversible side opening door. 120A, 120/240V 16 circuit load center. Complete with (2) installed P1104-M time switches. Provision for (2) While-in-use wiring devices & (2) Device plates	(2) P1104-M (2) 24 Hour Mechanical time switches, each DPST, 2NO: 40A Resistive/Inductive per pole, 7.5HP@240V 1NC: 15A Resistive & GP@120V

120 AMP POOL/SPA PANELS WITH TIME SWITCH AND LV TRANSFORMER WITH 16 CIRCUIT LOAD CENTER



LIGHTING REQUIREMENTS?
These panels come with factory
installed time switches and a
100W or 300W transformer
for pool lighting.

PP-125R-P4-100X

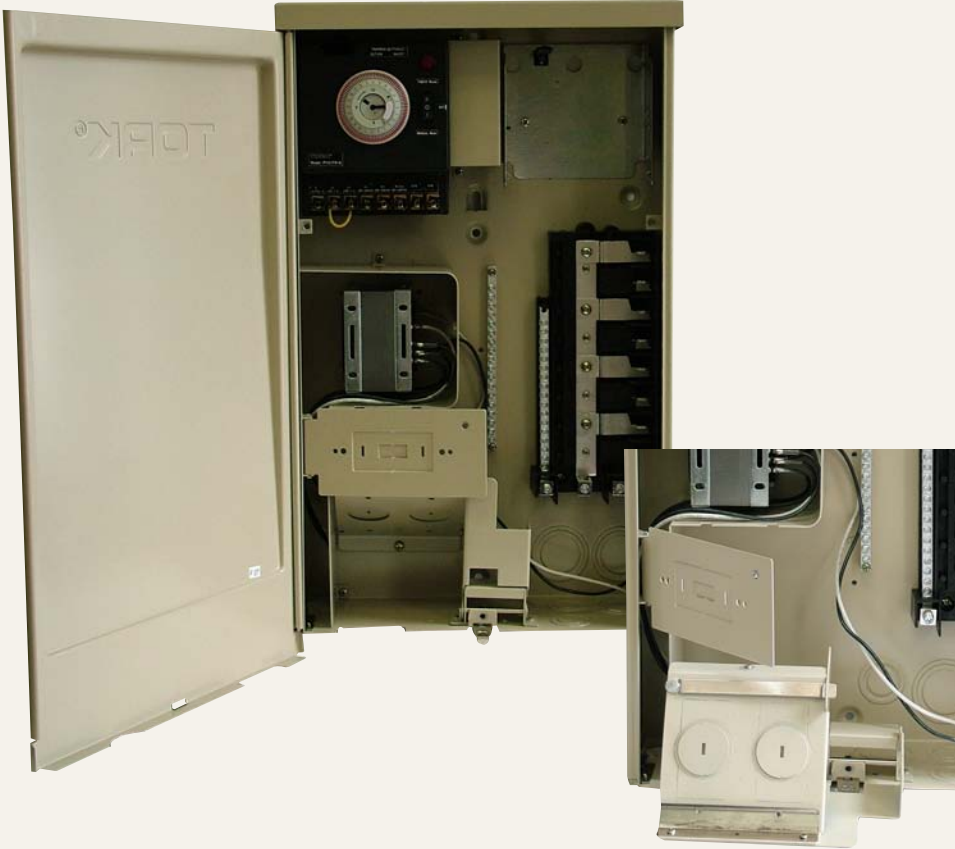

CATALOG NO	UPC CODE	DESCRIPTION	TIME SWITCH RATINGS
PP-125R-P4-100X	94018	NEMA 3R 120 Amp Pool/Spa Panel with Inside Wiring Compartment. Removable/reversible side opening door. 120A, 120/240V 16 circuit load center. Complete with (1) P1104-M time switch. Accepts one (1) additional time switch. Provision for (2) While-in-use wiring devices & (2) Device plates. With 100 Watt Transformer, 120V/ 12V, 13V installed. Low voltage nipple supplied.	P1104-M 24 Hour Mechanical time switch DPST, 2NO: 40A Resistive/Inductive per pole, 7.5HP@240V 1NC: 15A Resistive & GP@120V
PP-125R-P4-300X	94019	NEMA 3R 120 Amp Pool/Spa Panel with Inside Wiring Compartment. Removable/reversible side opening door. 120A, 120/240V 16 circuit load center. Complete with (1) P1104-M time switch. Accepts one (1) additional time switch. Provision for (2) While-in-use wiring devices & (2) Device plates. With 300 Watt Transformer, 120V/ 12V, 13V, 14V installed. Low voltage nipple supplied.	P1104-M 24 Hour Mechanical time switch DPST, 2NO: 40A Resistive/Inductive per pole, 7.5HP@240V; 1NC: 15A Resistive & GP@120V

One or more of the following patents apply: 6.753.485, 6.791.039, 6.827.230B1, 6.930.268. Additional Patents pending.

2 CIRCUIT POOL TIME SWITCHES WITH WHILE-IN USE GFCI OUTLETS

TORK
POOL/SPA
CONTROLS



These NEMA 3R outdoor while-in-use enclosures feature a time-controlled GFCI outlet as well as always ON GFCI outlet. The time switch can be either mechanical or digital depending on your preference. Ideal for small pools.



PP-10R-M-GFCI



PP-10R-E-GFCI

CATALOG NO	UPC CODE	DESCRIPTION
PP-10R-M-GFCI	53010	2 Circuit Mechanical Pool Time Switch in NEMA 3R outdoor while-in-use enclosure. With 1 timed GFCI outlet : 15A, ½HP @120V, GFCI protected and 1 always ON GFCI outlet : 15A, 120V
PP-10R-E-GFCI	53011	2 Circuit Digital Pool Time Switch in NEMA 3R outdoor while-in-use enclosure. With 1 timed GFCI outlet : 15A, ½HP @120V, GFCI protected and 1 always ON GFCI outlet : 15A, 120V

TIME SWITCH MECHANISMS

P SERIES MECHANICAL TIME SWITCHES

Mechanical time switches are effective and economical. The captive trippers are very easy to set, allowing for intervals as low as every 15 minutes. Best of all, they can't be lost! Additionally, these time switches are provided with an external manual/OFF/timer rocker switch and a load indicator light. The authentic clock face makes setting the time switch easy. All time switches are DPST (2 NO) and have an additional NC contact for ultimate flexibility.



CATALOG NO	UPC CODE	DESCRIPTION
P1101-M	10056	24 Hour Mechanical time switch – DPST, 2NO: 40A Resistive/Inductive per pole, 3HP@120V; 1NC 15A Resistive & GP@120V
P1104-M	10057	24 Hour Mechanical time switch – DPST, 2NO: 40A Resistive/Inductive per pole, 7.5HP@240V; 1NC 15A Resistive & GP@120V

P SERIES MECHANICAL TIME SWITCHES WITH FIREMAN SWITCH

All the same features as our standard time switches (above) with an additional switch which will turn off the pool heater before shutting the pool pump (Fireman Switch).

CATALOG NO	UPC CODE	DESCRIPTION
P1101FM-M	10060	24 Hour Mechanical time switch – DPST, 2NO: 40A Resistive/Inductive per pole, 3HP@120V; 1NC 15A Resistive & GP@120V Complete with fireman switch (heater cutoff): SPST, 15A@120V
P1104FM-M	10061	24 Hour Mechanical time switch – DPST, 2NO: 40A Resistive/Inductive per pole, 7.5HP@240V; 1NC 15A Resistive & GP@120V Complete with fireman switch (heater cutoff): SPST, 15A@120V

PEW SERIES DIGITAL TIME SWITCHES

Digital time switches provide ultimate flexibility and reliability. It offers 24 hour programming as well as 7 day programming, and can be programmed 7 different ways. Battery backup protects programs. Time switches are DPST (2 NO) and have an additional NC contact.



CATALOG NO	UPC CODE	DESCRIPTION
PEW101-M	82432	Digital time switch – 24 Hour, 7 Day programming, DPST, 2NO: 40A Resistive/Inductive per pole, 3HP@120V; 1NC: 15A Resistive & GP@120V
PEW104-M	82442	Digital time switch – 24 Hour, 7 Day programming, DPST, 2NO: 40A Resistive/Inductive per pole, 7.5HP@240V; 1NC: 15A Resistive & GP@120V

1100 SERIES ELECTROMECHANICAL TIME SWITCHES

All pool/spa panels accept conventional electromechanical time switch mechanisms with IAP adapter plate. For more information on the 1100 Series, see page 6 of our Electromechanical Catalog, or online at www.tork.com.

CATALOG NO	UPC CODE	DESCRIPTION
1101M	10022	24 Hour Dial, SPST, 1 NO, 40A Resistive & General Purpose, 20A Inductive, 2HP@120V
1103M	10023	24 Hour Dial, DPST, 1 NO, 40A Resistive & General Purpose, 20A Inductive, 2HP@120V
1104M	10024	24 Hour Dial, DPST, 1 NO, 40A Resistive & General Purpose, 20A Inductive, 5HP@240V
WITH FIREMAN SWITCH		
1101 FM M	10025	Same as 1101M above, complete with fireman switch (heater cutoff): SPST, 24V, 760VA
1104 FM M	10026	Same as 1101M above, complete with fireman switch (heater cutoff): SPST, 24V, 760VA
ADAPTER PLATE		
IAP	xxxxx	Adapter Plate to mount 1100 Series time switches into pool/spa panels



ACCESSORY & REPLACEMENT PARTS

TORK
POOL/SPA
CONTROLS



CATALOG NO	UPC CODE	DESCRIPTION
The following time switches are for <i>REPLACEMENT ONLY</i> in models PP-20R-2P1 and PP-20R-2P4. These cannot be installed in PP-20R, PP-20R-P1, or PP-20R-P4		
P1101-2M	10058	(2) 24 Hour Mechanical time switches, each DPST, 2NO: 40A Resistive/Inductive per pole, 2HP@120V
P1104-2M	10059	(2) 24 Hour Mechanical time switches, each DPST, 2NO: 40A Resistive/Inductive per pole, 5HP@240V
ACCESSORY		
WP-1GA	10062	Angular Single Gang (While-in-Use) Device Plate for models PP100R and for PP125R without transformer

ALPHANUMERIC INDEX

CATALOG NUMBER

PAGE

1101M, 1103M, 1104M	12
1101 FM M	12
1104 FM M	12
IAP	12
P1101, P1104	12
P1101-2M & 1104 -2M	13
P1101FM-M	12
P1104FM-M	12
PEW Series	12
PP-10R-E-GFCI	11
PP-10R-M-GFCI	11
PP-100R	6
PP-100R-P#	8
PP-100R-2P#	8
PP-100R-P4P1	8
PP-100R-P4P4FM	8
PP-125R	6
PP-125R-P4	9
PP-125R-2P4	9
PP-20R	6
PP-20R-P#	7
PP-20R-2P#	7
PP-125R-P4 -100X	10
PP-125R-P4 -300X	10
WP	13

TERMS OF SALE

TORK VENDOR NUMBER: 786261

1. Prices are F.O.B. our plant.
2. Prices do not include any sales tax.
3. Freight charges will be prepaid on all orders \$250.00 and over shipping within continental USA using standard shipping methods and service.
4. Minimum order – \$100.00.
5. Claims for shortage, erroneous charges or price corrections shall be deemed waived unless made in writing, delivered to NSi within 30 days of invoice.
6. Terms of payment – 2% 10th prox. net 25th following.
7. Warranties – NSi guarantees all products to be free of defects in material and workmanship for a period of 1 year from date of sale. Any claims for defective material must be agreed to in writing by NSi. Defective material will be replaced on an F.O.B. – our factory basis. NSi disclaims the implied warranty of fitness for a particular application.

OTHER PRODUCTS AVAILABLE

NSi can provide many other products for special applications which are not listed in this catalog. If you require an item which you do not find listed, please contact us. We would be pleased to provide a quotation upon receipt of a drawing or a sample.

GUARANTEE

It is our goal to provide extraordinary products and services on a daily basis. If our products or service do not meet with your satisfaction, please let us know immediately and we promise to make every reasonable effort to remedy the situation.

TORK TECHNICAL INFORMATION: 888.500.4598
REQUEST YOUR COMPLETE SET OF TORK CATALOGS TODAY!



NSI INDUSTRIES, LLC • USA • 800-321-5847 • FAX 800-841-5566 • www.nsiindustries.com

TORK