

CONSULT FACTORY FOR SPECIAL CONFIGURATIONS.

<p>POS 1</p>	<p>POS 2 (STD)</p>	<p>KEYWAY DIAGRAM</p> <p>IN OPEN POS.</p>	<p>GREASED FOR LIFE</p> <p>PLATED STANDARD SHAFT</p> <p>MAX STEM HEIGHT: 2.12 [53.8]</p> <p>WORM WHEEL RECESS: .10 [2.5]</p>	<p>HANDWHEEL</p> <p>RECOMMENDED <math>\phi</math>: 14 IN</p> <p>RIM PULL AT</p> <p>MAX TORQUE: 80 LBS</p> <p>TURNS FOR 360°: 30</p>	<p>RATIO: 30:1</p> <p>TORQUE: 4,500 IN LBS [509 N-M]</p> <p>TEMPERATURE: -20° TO 150°F [-29° TO 66°C]</p> <p>EST. WEIGHT: 7 LBS [3.2 KGS]</p>
--------------	--------------------	---	--	---	---

HOUSING MOUNTING PATTERN				BORE & KEY			MANUAL MULTI TURN WORM GEAR OPERATOR COMMERCIAL GRADE	
MAX	MAX ON CENTER	STD	MIN	MAX	STD	MIN	<b>DYNATORQUE</b>	<b>DT3</b>
$\phi$ 4.019 3/8-16 UNC	$\phi$ 3.750 3/8-16 UNC	$\phi$ 3.250 3/8-16 UNC	$\phi$ 1.968 1/4-20 UNC	$\phi$ 1.250 .250 X .188 KEY	$\phi$ 1.000 .250 KEY @C	$\phi$ .391		
							A BRAND OF	

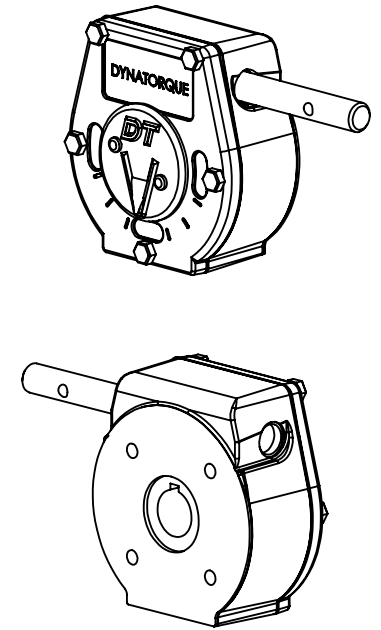
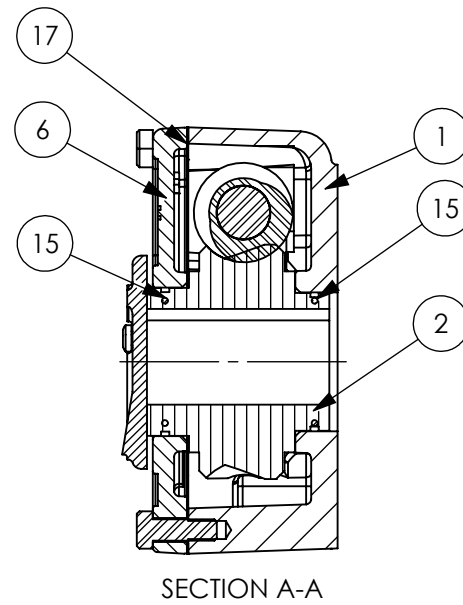
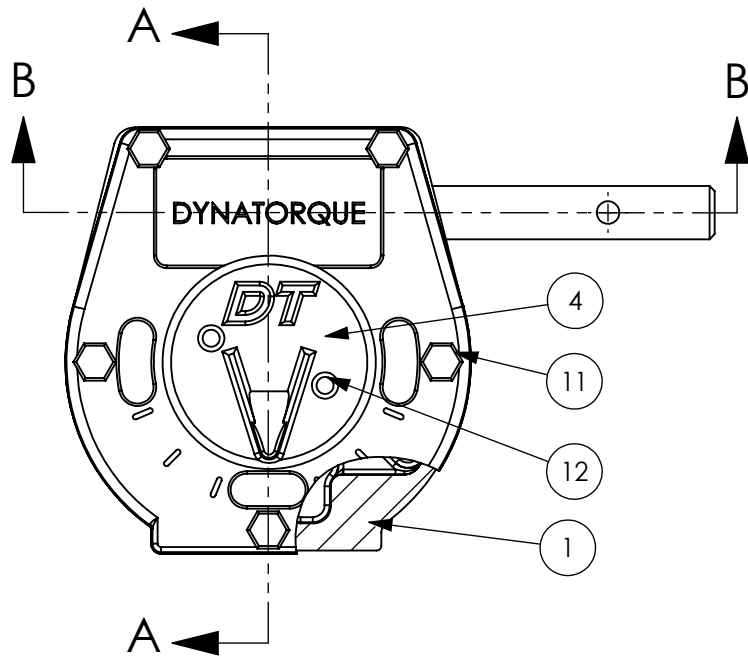

- 5 UNIT IS E-COATED.
- 9 UNIT BEARINGS, O-RINGS, AND GEAR TEETH ARE GREASED.
- 17 UNIT HAS SILICONE GASKET.

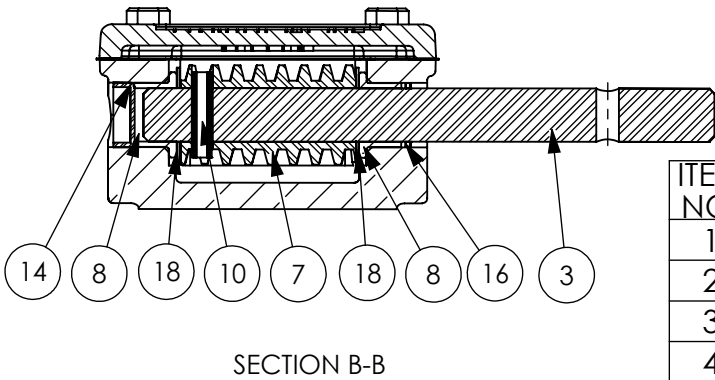

ITEM NO.	DESCRIPTION	QTY	ITEM NO.	DESCRIPTION	QTY
1	HOUSING,DT3,STD	1	11	HHCS,3/8-16 X 1.50 LG	5
2	W/WHEEL, DT3, 360	1	12	PHCS,8-32,S/TAP,.5	2
3	SHAFT,DT3/7,G=5.25,.266,STD	1	13	SET SCREW, 5/16-18, .50	2
4	INDICATOR,DT2/3	1	14	EXP. PLUG,.75,.25,SS	1
5	BLACK E-COAT	1	15	O-RING,2-028 VITON	2
6	COVER,DT3, 360/180	1	16	LIP SEAL,5/8	1
7	WORM,DT2/3/5	1	17	RTV SEALANT	1
8	BEARING,FLANGED,.750,.625,.500	2	18	THRUST WASHER,.625,.031	2
9	GREASE, COMMERCIAL GRADE	1	<b>DYNATORQUE</b> WWW.DYNATORQUE.COM <small>A BRAND OF</small>		<b>DT3</b>
10	COIL PIN,.250,1.00	1			