

## HOBIE MIRAGEDRIVE "V2"

- 80010001 MIRAGEDRIVE V2
- 80013011 MIRAGEDRIVE I-SERIES V2
- 80013001 MIRAGEDRIVE ST TURBO V2

### TECH TIP!

WHAT MAKES A V2 DRIVE? V2 Drums, V2 Chains, V2 Idler Cable and V2 (Threaded) masts / sprockets (USED IN 2009 production and newer)

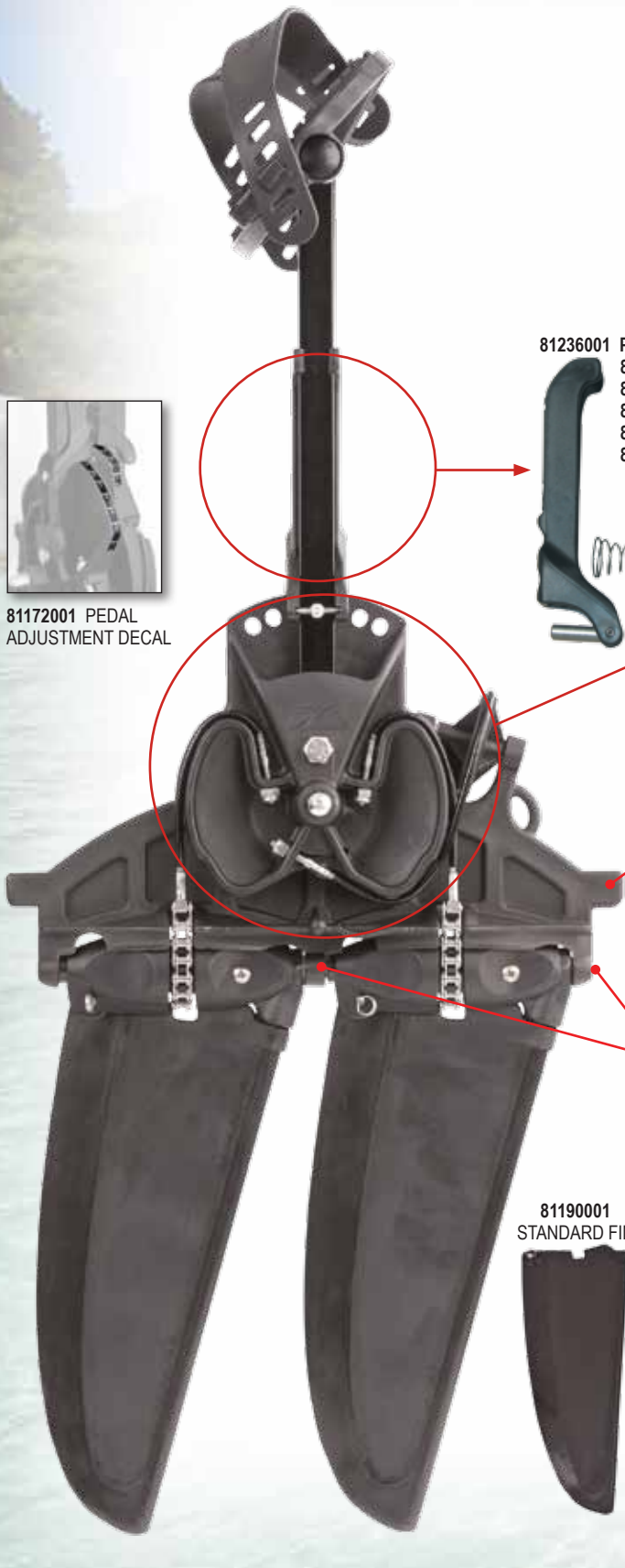

81172001 PEDAL ADJUSTMENT DECAL

81236001 PEDAL ADJ ASSY INCLUDES:

- 81240001 PLASTIC HANDLE
- 81230001 PIN
- 8031201 SCREW
- 81242001 SPRING
- 8034071 ALLEN WRENCH



72020034 PEDAL PAD KIT

- 81222001 PEDAL/CRANK ASSY. (R)
- 81221001 PEDAL/CRANK ASSY. (L)
- 81222011 PEDAL ONLY (R)
- 81221011 PEDAL ONLY (L)
- 81226001 PEDAL STRAP (R)
- 81227001 PEDAL STRAP (L)
- 81222101 CAP - PEDAL
- 8050111 NUT
- 8080541 WASHER

- 81050001 OUTHAUL BLOCK
- 8020041 CLEVIS PIN
- 10860001 LOCK RING

- 81055001 SPROCKET GUARD FWD
- 8031451 SCREW



81129001 SPROCKET V2 THREADED (W/ FWD GUARD)



81181001 SPINE NEW 2013

81080001 SPROCKET SHAFT SET SCREW

81190001 STANDARD FIN



81193001 ST FIN



81192001 ST TURBO FIN



UPDATE KIT - V2 SPROCKET (2 V2 SPROCKETS AND 2 V2 MASTS)  
 81129022 V2 STANDARD MAST KIT  
 81129122 V2 TURBO MAST KIT

- 81163001 MAST V2 THREADED
- 81198101 MAST / ST TURBO V2 THREADED
- 8000341 LOC-TITE .5ML

## HOBIE MIRAGEDRIVE "V2"

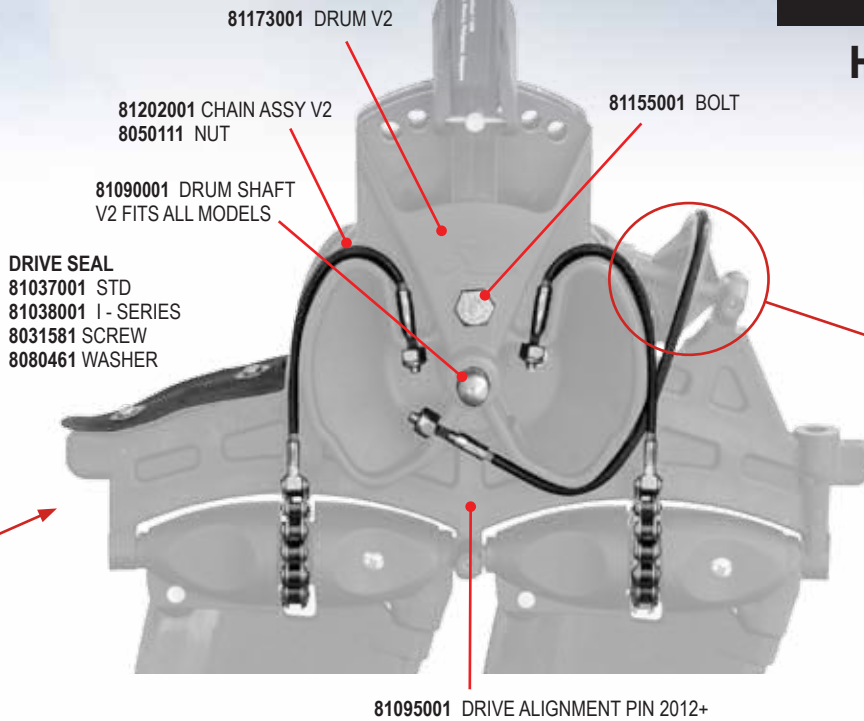

## HOBIE MIRAGEDRIVE "V1"

Drive with older plastic drum, plastic spine, Sprocket / mast connection is a set-screw

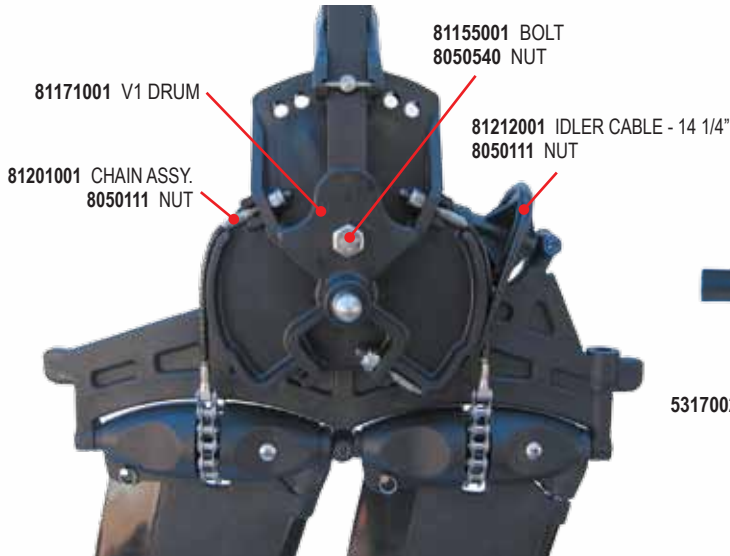

### TECH TIP!

**MAINTENANCE AND TUNING** - Maintenance and tuning information for MirageDrives is available on the Hobie Cat website support area. <http://www.hobiecat.com/support/history/>

Direct link to the support pages for kayaks is here: <http://www.hobiecat.com/support/products/kayaks/>

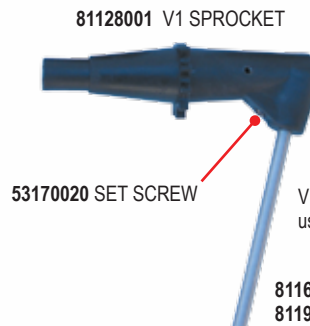

**UPDATE KIT - V2 SPROCKET**  
(2 V2 SPROCKETS AND 2 V2 MASTS)  
81129022 V2 STANDARD MAST KIT  
81129122 V2 TURBO MAST KIT

V1 Sprocket / mast connection uses a set-screw

### MIRAGEDRIVE SPARE PARTS KITS

Spare parts kits include a spare fin, mast, sprocket, chain, clevis pin and ring. All in a handy zippered pouch. Available for the standard fin drives or drives with ST Turbo fins. Standard kit shown.



### MIRAGEDRIVE V2 (THREADED MAST STYLE)

Includes parts listed above for V2 "threaded mast" drives.

- 80010301 KIT V2 STANDARD FIN
- 80013301 KIT V2 TURBO FIN

### MIRAGEDRIVE OLDER V1 (SET SCREW MAST STYLE)

Includes parts listed above plus: Set screw, allen wrench, and a cotter key.

- 80010201 KIT STANDARD FINS
- 80013201 KIT TURBO FINS

## HOBIE MIRAGEDRIVE— OLDER —

Original drive with aluminum spine, stainless sprocket / mast connection is cotter key.

- 81130001 SPROCKET (STAINLESS)
- 81340001 SPROCKET BUSHING (SS SPKT)
- 81420001 SPROCKET GUARD
- 8060111 COTTER KEY (MAST / SS SPKT)
- 81040001 OUTHAUL BLOCK (SS SPKT)
- 8020061 CLEVIS PIN
- 10860001 LOCK RING
- 81211001 IDLER CABLE 14 3/4" (SOLID PULLEY)
- 81150001 DRUM BUSHING (ALUM DRUM)
- 81105001 CRANK ARM RIGHT, THREADED
- 81100001 CRANK ARM LEFT, THREADED