



H A N D L I N G S A F E T Y



FABRICATED LIFTING PRODUCT HANDBOOK





CALL US

Dial 1300 722 999 and you will be connected to a customer service representative at your local Bullivants branch. Office Hours are Monday to Friday 8am - 5pm.



FAX US

Fax your order or request to 1300 722 899 and your local branch will deal with your enquiry.



VISIT US

Our network is strategically positioned to ensure that our customers across Australia can be serviced quickly and efficiently. You can find your nearest Bullivants location on the back page of this catalogue.



WEBSITE

To visit our website log on to www.bullivants.com and take time to browse all of our products, services and latest special offers.

Disclaimer

Some products may not be stocked in all branches. Unless otherwise specified by the customer when ordering products. Bullivants Pty Ltd ABN 47 087 887 072 reserves the right to substitute unavailable products or brands with the nearest alternative.

While the company has made all reasonable efforts to ensure that details given in this catalogue are accurate at the time of publication, full technical specifications are not included and the company reserves the right to alter specifications, details and information from time to time without notice to customers. Since the use of this information and the conditions in which these products are used are beyond the control of the company, a user must determine whether the products are suitable for the purpose for which they are to be used, and is responsible for the safe use of the products.

Unless otherwise agreed between the company and the customer in writing, the products are sold by the company to the customer pursuant to the "Terms & Conditions of Quotation and Sale" set out on the Bullivants website, as amended from time to time located at (<http://www.bullivants.com>).

Save for the warranties and representations which cannot be lawfully excluded or modified, all representations and warranties not expressly set out in this disclaimer or the "Terms & Conditions of Quotation of Sale" are excluded. To the extent permitted by law, any liability which may be incurred by the company as a result of the use of or the failure of a product is limited at the company's discretion to the repair or replacement of the product, and the company will not be liable for any economic loss, loss of points, indirect, special or consequential damages (including in the case of negligence).

Information on products has been prepared from manufacturers catalogues and literature. All detail is subject to change without notice and should be confirmed at time of purchase. Where availability may vary, products supplied are not necessarily the brand illustrated. However, alternate products of equal quality are able to be supplied. Customers with a particular brand preference should state this at the time of order placement.

Although all care has been taken in the preparation of this catalogue, the technical information including dimensions in illustrations, drawings and charts are non binding. Bullivants does not accept any responsibility for any typographical or other errors which may have occurred in the production of this catalogue.

| | |
|--|---|
| Company Profile | 4 |
| Bullivants Commitment to Safety, Environment, Quality & Technical Leadership | 5 |

THE COMPLETE SOLUTION **6 - 7**

| | |
|---|-------|
| Australian Standards Compliance | 6 |
| Stock Availability | 6 |
| Product Knowledge Within Our Team | 6 |
| Galvanised Finish For Offshore Applications | 6 |
| Frequently Asked Questions..... | 6 - 7 |

FORKLIFT APPLICATIONS **8 - 19**

| | |
|---|----|
| Forklift Attachments Specifications | 8 |
| 2 Tonne Extendable Forklift Boom | 9 |
| 5 Tonne Extendable Forklift Boom | 10 |
| 4.5 Tonne Incline Extendable Forklift Boom..... | 11 |
| 700 Kilogram Forklift Drum Lifting Tong | 12 |
| 500 Kilogram Forklift Drum Tipper | 13 |
| 2 Tonne Single Point Forklift Attachment | 14 |
| 3 Tonne Single Point Forklift Attachment | 15 |
| 2.5 Tonne Forklift Tines Extension Slippers | 16 |
| 4 Tonne Forklift Tines Extension Slippers | 17 |
| 1 Tonne Forklift Waste Dumping Bin | 18 |
| 250 Kilogram Forklift Work Platform | 19 |

CRANE & OVERHEAD LIFTING APPLICATIONS **20 - 56**

| | |
|---|---------|
| Crane & Overhead Lifting Specifications | 20 |
| 5 Tonne Spreader Beams..... | 21 - 22 |
| 35 Tonne Container Lifting Beam | 23 |
| 1 Tonne Conveyor Lifting Beam..... | 24 |
| Combination Beam Specifications | 25 |
| 8.6 Tonne Combination Beam | 26 |
| 15 Tonne Combination Beam | 27 |
| 15 Tonne Combination Beam (2.4 Metre) | 28 |
| 30 Tonne Combination Beam | 29 |
| 50 Tonne Combination Beam | 30 |

CRANE & OVERHEAD LIFTING APPLICATIONS (CONT.) **20 - 56**

| | |
|--|----|
| Pipe End Cap Specifications..... | 31 |
| 50 Tonne Pipe End Caps | 32 |
| 100 Tonne Pipe End Caps | 33 |
| 220 Tonne Pipe End Caps | 34 |
| 50T x 12m Spreader With End Caps | 35 |
| 100T x 12m Spreader With End Caps | 36 |
| 220T x 15m Spreader With End Caps | 37 |
| Pallet Lifting Specifications | 38 |
| 2 Tonne Pallet Lifting Fork | 39 |
| 2 Tonne Pallet Lifting Bars | 40 |
| 2 Tonne Pallet Lifting Frame | 41 |
| 700 Kilogram Drum Lifting Frame..... | 42 |
| 1 Tonne Double Drum Lifting Frame..... | 43 |
| 1 Tonne Bulka Bag With Fixed Arms | 44 |
| 2 Tonne Bulka Bag With Extendable Arms | 45 |
| 1.5 Tonne Rail Lifting Tongs | 46 |
| Work Cage Specifications | 47 |
| 250 Kilogram Single Person Work Cage | 48 |
| 300 Kilogram Two Person Work Cage..... | 49 |
| 250 Kilogram Single Person Circular Work Cage..... | 50 |
| 22 Tonne Eye Type Low Profile Container Lifting Hooks..... | 51 |
| 5 & 6 Tonne Coil Lifting Hook | 52 |
| 1.5, 3 & 5 Tonne Pipe Lifting Hooks..... | 53 |
| 1.5, 2.5 & 4 Tonne Crok-Lok Vertical Plate Clamp..... | 54 |
| 3 Tonne Horizontal Plate Clamps Pair (Non-Marring)..... | 55 |
| 6 Tonne Horizontal Plate Clamps Pair (Non-Marring)..... | 56 |

OXY & ACETYLENE APPLICATIONS **57 - 64**

| | |
|--|----|
| Oxy & Acetylene Specifications | 57 |
| 200 Kilogram 2 x Oxygen Bottle Trolley G Size..... | 58 |
| 100 Kilogram 2 x Bottle Trolley D Size | 59 |
| 150 Kilogram 2 x Bottle Trolley E Size | 60 |



| | |
|--|----------------|
| OXY & ACETYLENE APPLICATIONS (CONT.) | 57 - 64 |
| <hr/> | |
| 200 Kilogram 2 x Bottle Trolley G Size Pneumatic Tyres | 61 |
| 200 Kilogram 2 x Bottle Trolley G Size Solid Wheels..... | 62 |
| 200 Kilogram 2 x Bottle Lifting Frame..... | 63 |
| 400 Kilogram 4 x Bottle Lifting Frame..... | 64 |
| GOODS CAGES | 65 - 71 |
| <hr/> | |
| Goods Cage Specifications..... | 65 |
| 500 Kilogram Goods Cage..... | 66 |
| 750 Kilogram Goods Cage..... | 67 |
| 750 Kilogram Goods Cage With Drop Side | 68 |
| 1 Tonne Goods Cage | 69 |
| 1 Tonne Goods Cage With Drop Side..... | 70 |
| 1 Tonne Pallet Lifting Cage..... | 71 |
| ENGINEERED APPLICATIONS | 72 - 75 |
| <hr/> | |
| TECHNICAL SUPPORT | 76 |
| <hr/> | |

Company Profile

Bullivants is Australia's oldest, largest and yet most progressive specialist provider of lifting, rigging, safety and related services to the industrial sector. Since 1891 Bullivants have been providing a comprehensive solution to help our customers operate safely and efficiently.

Bullivants is a part of the Wesfarmers group of companies and operates as a separate business under the Industrial Specialists Division. The support provided by the group strengthens Bullivants ability to provide industry leading service and solutions to our customers.

Our people, products, services, facilities and systems are uniquely focused on providing expert safety and load management solutions for our customers. We have built our business by working with our customers and developing our range of products and services around their requirements.

Our customers choose Bullivants for many reasons.

- A proven track record for working with our customers to minimise risk and maximise their operating efficiencies;
- Comprehensive lifting, rigging and safety solutions covering the supply, installation, technical support, manufacture, inspection, testing, repair, training and hire;
- An extensive and expanding branch network enabling the best possible service levels;
- A breakdown service and management of parts and equipment critical to your operations;
- National supply solutions co-ordinated and delivered by local people;
- Highly skilled resources and extensive range of manufacturing and testing equipment;
- Stock on hand consisting of over 10,000 line items;
- Extensive product sourcing capabilities and the strongest buying power in our categories;
- An impeccable safety record internally and at our customers sites;
- Earned reputation as industry experts and we understand that safety regulations and efficiency requirements faced by our customers continue to change, therefore, we must continue to increase the value we offer customers.
- Ongoing innovation and enhancement of our products and service capability;

The whole team at Bullivants are extremely confident we can meet the objectives of our customers and exceed the service performance required.

Bullivants' Commitment to Safety, Environment, Quality & Technical Leadership

Bullivants maintains corporate membership to five major Australian/International standards which help us to achieve and maintain ongoing compliance to state regulations, continuously improve our business processes and lead best practices, which are unequalled in our industry.

The main standards are as follows:

- AS4801 Australian Standard for Occupational Health and Safety Management systems
- ISO9001 International Standard for Quality Managements systems
- ISO14001 International Standard for Environmental Management Systems
- ISO17025 International Standard for General Requirements for the Competence of Testing & Calibration of Laboratories
- ISO17020 International Standard for General Criteria for Operation of various types of bodies performing inspection

The philosophy behind corporate membership means no matter which Branch our Customers or Suppliers are dealing with (or combinations thereof), the infrastructure is always the same. Therefore, a product/service can be ordered from different sites and customers can feel confident of receiving the same goods/services to the same quality and standards irrespective of which site they deal with.

THE COMPLETE SOLUTION

Design - Manufacture - Supply - Test - Certify

Australian Standards Compliance

All fabricated lifting product supplied by Bullivants is manufactured, tested and certified to either AS4991 or AS1418 and is supplied with an individual test certificate at the time of despatch to the customer.

The standards require the equipment to be periodically inspected after the customer has made the purchase.

With our national network of accredited Technical Service Representatives we are able to offer this important ongoing service to our customers.

Stock Availability

We are committed to providing our customers with a timely and efficient supply chain. Stock is held in our branch locations and also centrally with our manufacturers ready to ship.

Product Knowledge Within Our Team

We have confidence that our market leading training ensures that our team can meet the demands of customer requirements and offer best practice advice and solutions.

Lifting & Rigging Equipment

We can supply fully tested chain slings and hardware with your fabricated lifting product as a complete unit so that everything is ready to go when it gets to site. Be sure to ask our trained staff about this option when you request your quote.

Galvanised Finish for Offshore Applications

Bullivants can supply Galvanised Finish on most products within our range as an added option. This is perfect for more adverse operating conditions such as off shore. Be sure to ask our trained staff about this option when you request your quote.

Frequently Asked Questions

Q - I have a 'one off job' that cannot be done by use of the Standard Product range, how can Bullivants help me?

A - Bullivants' Engineering Department can help by working closely with you to design, fabricate and certify an engineered product to safely complete your 'one off job'.

Q - Why choose Bullivants as your Engineered Product Supplier?

A - Peace of Mind.

When you choose Bullivants as your Engineered Product Specialist you can be assured that you are getting a SAFE and HIGH QUALITY product. Our standard Engineered Product range is:

1. Australian made - This means that the materials used to fabricate Bullivants' standard Engineered Product range are of high quality and manufactured locally, supporting Australian jobs.
2. Backed by Knowledge - We have our own Engineering Department at our head office and product specialists at each of our branches, located across Australia, dedicated to providing the upmost level of customer service.
3. In stock- We are committed to providing our customers with a timely and efficient supply chain. Stock is held in our branch locations and also centrally with our manufacturers ready to ship.
4. Compliant to Australian Standards - Not only is Bullivants' Engineered Product range made in accordance with stringent Australian Standards but your local branch can have the item added to your register before it gets to your worksite. This eliminates the gap between supply of the item and the first inspection of the item by utilising the Bullivants BEAM system (Bullivants Electronic Asset Management). Ask your local branch for details on the BEAM system.

Q - I have some Materials Handling gear on site which has no identification and I am unsure if it is safe to use, what should I do?

- #### A - All Materials Handling equipment, under Australian Standards, must have identification with traceability back to the manufacturer. If you do have non-identifiable gear on site Bullivants' Engineering Department can reverse engineer the item to determine what the item is capable of and certify/test accordingly.

Forklift Applications

Our Forklift attachments come in many different shapes, sizes and capacities. All of the Forklift Attachments in our standard range add versatility and safety to your Forklift, making it a useful addition to the workplace. All of the attachments within our range are manufactured to our high standards to ensure compliance to all workplace rules and regulations as required under Australian Standards.

We have a wide range of attachments available from low profile to high profile which are useful if you need to lift that little bit higher, also available are telescopic and extendable fork mounted jibs which can add extra reach when needed and be compacted/retracted when not, saving storage space.

Forklift Attachments

Forklift attachments turn your standard forklift into a more versatile, productive and safe materials handling tool. Bullivants' range of forklift attachments are sturdy, simple to fit and easy to use

Our Forklift Attachments are:

- Robustly designed
- Fully Certified
- Proof Tested
- Clearly marked with an identification plate
- Manufactured from Australian steel
- Powder Coated
- Simple to use
- Easily adjusted (relevant models)

With many features such as:

- Adjustable spans
- Swivel Hook lift points
- Inclined Jib
- Fitted with either safety chains or captive safety pins

WARNING!

- Before use a competent person shall check all lifting and structural components of the Forklift Attachment
- Before use a competent person shall check all lifting equipment to be used with the Attachment
- Always check the condition of the item or load to be lifted before lifting it
- Always work within the capacity of the Forklift and attachment being used. Ensure that the attachment is not rated with a higher capacity than that of the Forklift.
- Always be aware of the extra length that the attachment may add to the Forklift
- When using jib style attachments be cautious of the load swinging and keep the load as close to the floor as possible
- The Forklift being used shall be correctly maintained and inspected.

FORKLIFT APPLICATIONS

2 Tonne Extendable Forklift Boom

- Forklift requires 2 tonne at 1.3 metre centres for full boom capacity.

| Order Code | Maxi. WLL (tonnes) | | Closed (mm) | 1st Extension Point (mm) | 2nd Extension Point (mm) | Fully Open (mm) | A (mm) | Unit Weight (kg) |
|-----------------|--------------------|----------------------|-------------|--------------------------|--------------------------|-----------------|--------|------------------|
| S1539030 | 2 | Position Length (mm) | 1300 | 1525 | 1750 | 1975 | 720 | 46 |
| | | WLL (tonnes) | 2.0 | 1.65 | 1.3 | 0.95 | | |

Note: WLL will decrease depending on the position of the arms, see above



Fork Pocket Sizes: 160mm x 60mm

Fork Pocket Centers: 170mm

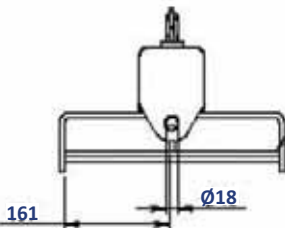

Features & Benefits:

- Fitted with safety chains
- Supplied with safety swivel hook
- Simple to fit and use
- Safe and easy to adjust
- Design calculations approved
- Tested and certified
- Powder coated safety yellow
- Clearly marked with WLL

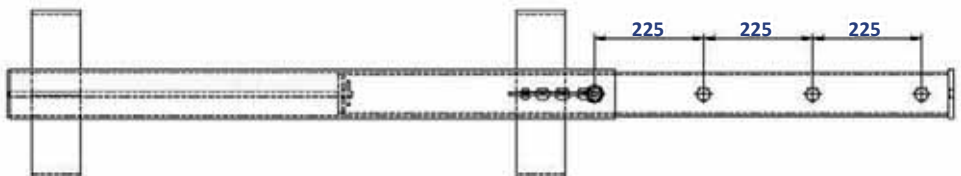
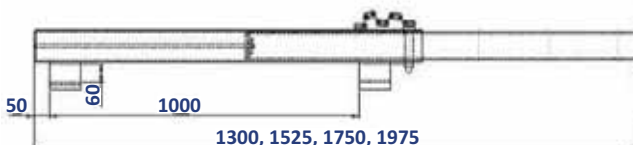

FORKLIFT APPLICATIONS

5 Tonne Extendable Forklift Boom

| Order Code | Maxi. WLL (tonnes) | | A (mm) | B (mm) | C (mm) | D (mm) | E (mm) | Unit Weight (kg) |
|-----------------|-----------------------|-------------------------|-----------|-----------|-----------|-----------|-----------|------------------------|
| S1539082 | 5 | Position Length (mm) | 450 | 1150 | 1420 | 1780 | 2140 | 120 |
| | | WLL (tonnes) | 5 | 3.5 | 2.5 | 1.75 | 1.25 | |

Note: WLL will decrease depending on the position of the arms, see above



Features & Benefits:

- Heavy duty
- Easy to fit and use
- Safety chains fitted
- Supplied with safety swivel hook
- Safe and easy to adjust
- Design calculations approved
- Tested and certified
- Powder coated safety yellow
- Clearly marked with WLL

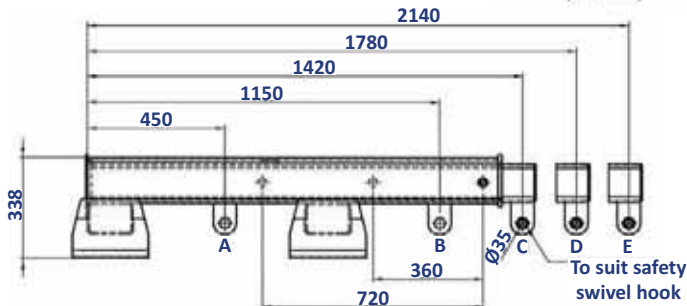
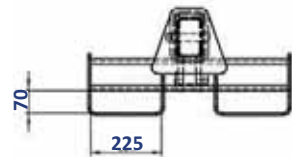
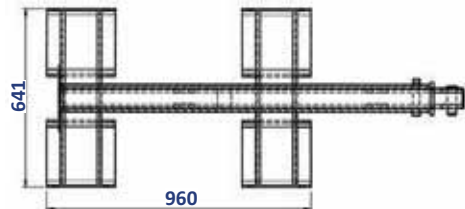

FORKLIFT APPLICATIONS

4.5 Tonne Incline Extendable Forklift Boom

| Order Code | Maxi. WLL (tonnes) | | A (mm) | B (mm) | C (mm) | D (mm) | E (mm) | Unit Weight (kg) |
|-----------------|-----------------------|-------------------------|------------|-------------|-------------|-------------|-------------|------------------------|
| S1539080 | 4.5 | Position Length (mm) | 481 | 1180 | 1440 | 1800 | 2160 | 120 |
| | | WLL (tonnes) | 4.5 | 3.5 | 2.5 | 1.75 | 1.25 | |

Note: WLL will decrease depending on the position of the arms, see above

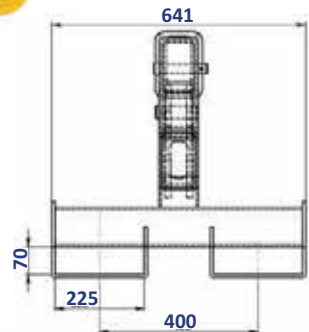

Fork Pocket Sizes: 225mm x 70mm

Fork Pocket Centers: 400mm

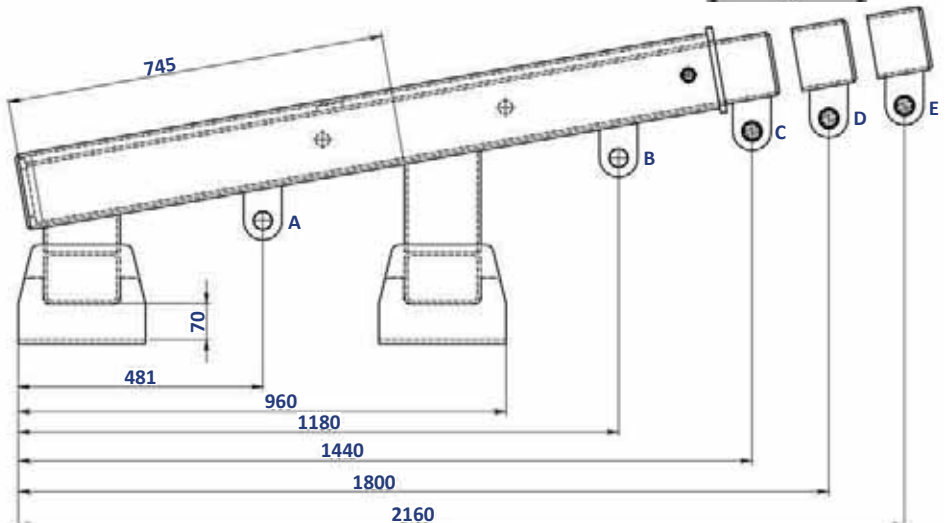

FORKLIFT APPLICATIONS

Forklift Drum Lifting Tongs

| Order Code | WLL (kg) | Drum Size (L) | Unit Weight (kg) |
|------------|----------|---------------|------------------|
| S1539100 | 700 | 200 | 70 |



Fork Pocket Sizes: 142mm x 66mm

Fork Pocket Centers: 438mm

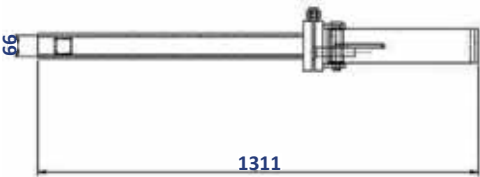

Features & Benefits:

- Lifts drums with lids on or off
- Simple to fit
- Fitted with safety chains
- Safe and easy to use
- Tested and certified
- Powder coated safety yellow
- Clearly marked with WLL

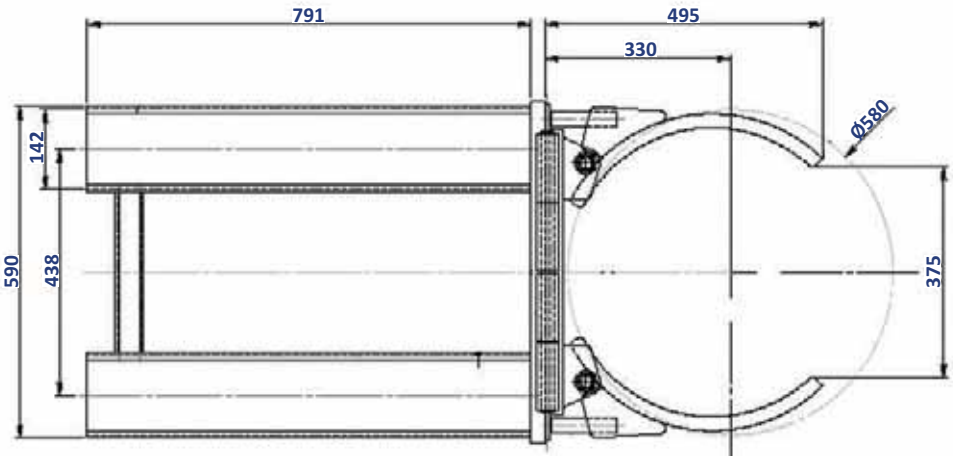

FORKLIFT APPLICATIONS

Drum Tipper

| Order Code | WLL (kg) | Drum Size (L) | Unit Weight (kg) |
|-----------------|------------|---------------|------------------|
| S1539095 | 500 | 200 | 69 |

Fork Pocket Sizes: 150mm x 75mm

Fork Pocket Centers: 810mm

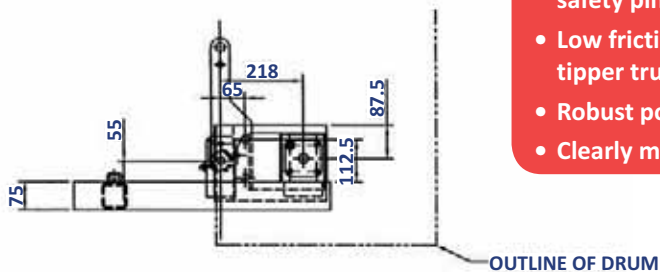
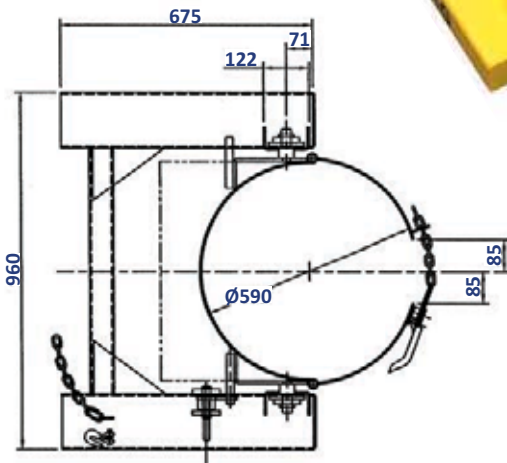

Features & Benefits:

- To suit 200ltr (44 gallon) drums
- Easy tipping release without leaving the seat
- Adjustable over centre locking device
- Adjustable boom safety chain
- Spring loaded release arm c/w safety pin
- Low friction sealed bearings on tipper trunion
- Robust powder coated finish
- Clearly marked with WLL

FORKLIFT APPLICATIONS

2 Tonne Single Point Fork Attachment

| Order Code | WLL (tonnes) | Unit Weight (kg) |
|-----------------|--------------|------------------|
| S1539040 | 2 | 20 |

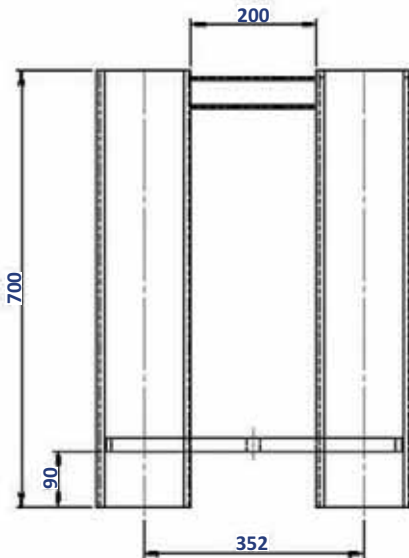

Fork Pocket Sizes: 142mm x 66mm

Fork Pocket Centers: 352mm

Features & Benefits:

- Converts your forklift into a single point lifting machine
- Supplied with safety swivel hook
- Fitted with safety chain
- Tested and certified
- Engraved ID tag welded on
- Powder coated safety yellow
- Other sizes/styles available

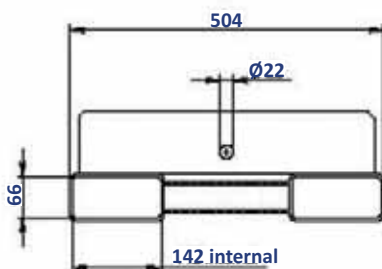

FORKLIFT APPLICATIONS

3 Tonne Single Point Fork Attachment

| Order Code | WLL (tonnes) | Unit Weight (kg) |
|-----------------|--------------|------------------|
| S1539050 | 3 | 22 |



Fork Pocket Sizes: 142mm x 66mm

Fork Pocket Centers: 452mm

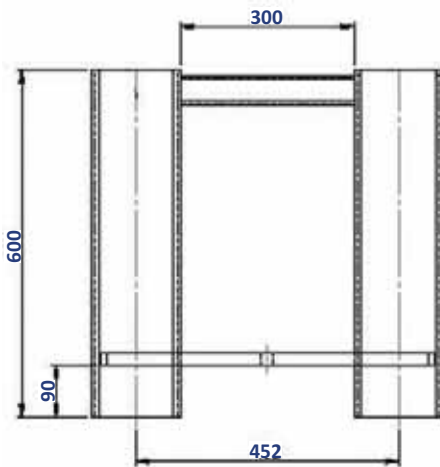

Features & Benefits:

- Converts your forklift into a single point lifting machine
- Supplied with safety swivel hook
- Fitted with safety chain
- Tested and certified
- Engraved ID tag welded on
- Powder coated safety yellow
- Other sizes/styles available

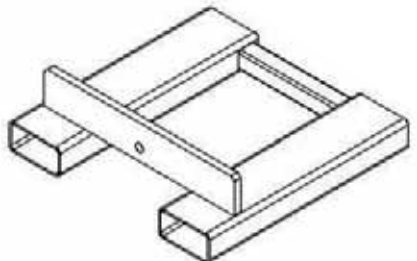
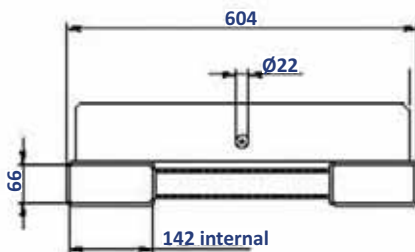

FORKLIFT APPLICATIONS

2.5 Tonne Forklift Tines Extension Slippers

- Supplied in pairs

| Order Code | WLL (tonnes) | Length (metre) | Maximum Tine Width (mm) | Unit Weight (kg) |
|------------|--------------|----------------|-------------------------|------------------|
| S1539110 | 2.5 | 1.9 | 130 | 57 |

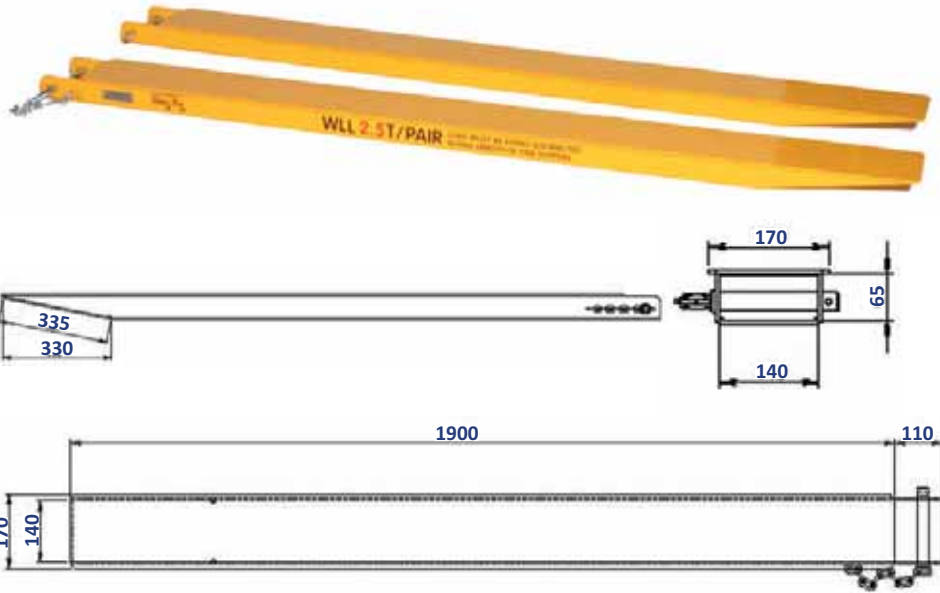

Features & Benefits:

- Tested and certified
- Powder coated safety yellow
- WLL clearly marked
- Engraved I.D. tag welded on
- We can manufacture slippers to suit any size fork blades if required



FORKLIFT APPLICATIONS

4 Tonne Forklift Tines Extension Slippers

- Supplied in pairs

| Order Code | WLL (tonnes) | Length (metre) | Maximum Tine Width (mm) | Unit Weight (kg) |
|-----------------|--------------|----------------|-------------------------|------------------|
| S1539112 | 4 | 2 | 160 | 82 |



Features & Benefits:

- Tested and certified
- Powder coated safety yellow
- WLL clearly marked
- Engraved I.D. tag welded on
- We can manufacture slippers to suit any size fork blades if required

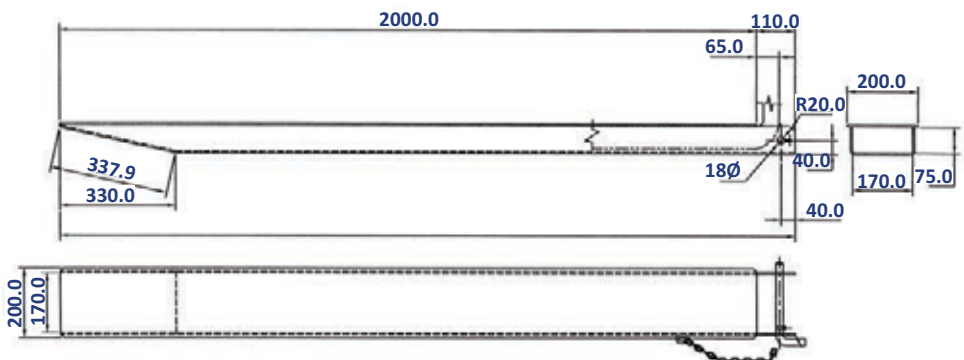

FORKLIFT APPLICATIONS

Forklift Waste Dumping Bin

| Order Code | WLL (tonnes) | Unit Weight (kg) |
|------------|--------------|------------------|
| S1537160 | 1 | 164 |

Features & Benefits:

- Versatile and mobile
- Simple to operate
- Instructions included on each bin
- Sturdy swivelling wheels
- Complete with securing chains
- Durable powder coated finish
- Tested and certified
- Clearly marked with WLL
- Engraved I.D. tag welded on

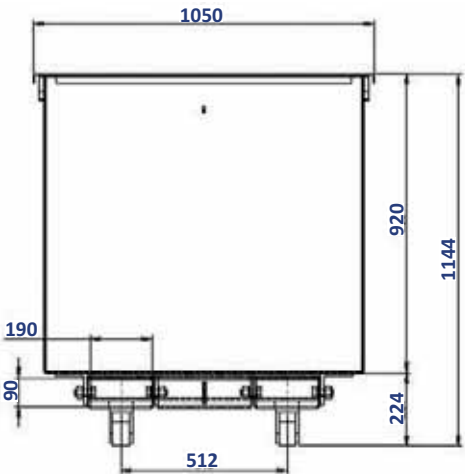
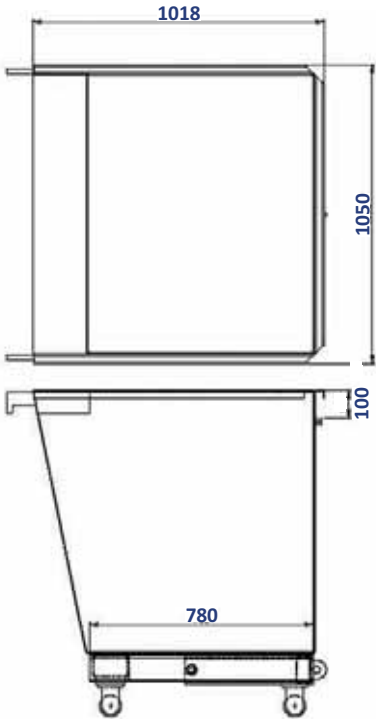

FORKLIFT APPLICATIONS

Forklift Work Platform

| Order Code | WLL (kg) | Unit Weight (kg) |
|---------------|------------|------------------|
| 201129 | 250 | 90 |

Ideal for:

- Maintenance/repair work
- Order picking
- Fabrication/installation
- Stores handling
- ...other at heights applications

Features & Benefits:

- High mesh back guard
- Toe boards on all sides
- Full length fork sleeves
- Inward opening self closing door
- One piece skid resistant floor
- Suitable for up to 2 persons and equipment (300kg)
- Handrails all around
- Locks onto forks
- D.L.I. approvals



Fork Pocket Sizes: 200mm x 75mm

Fork Pocket Centers: 690mm

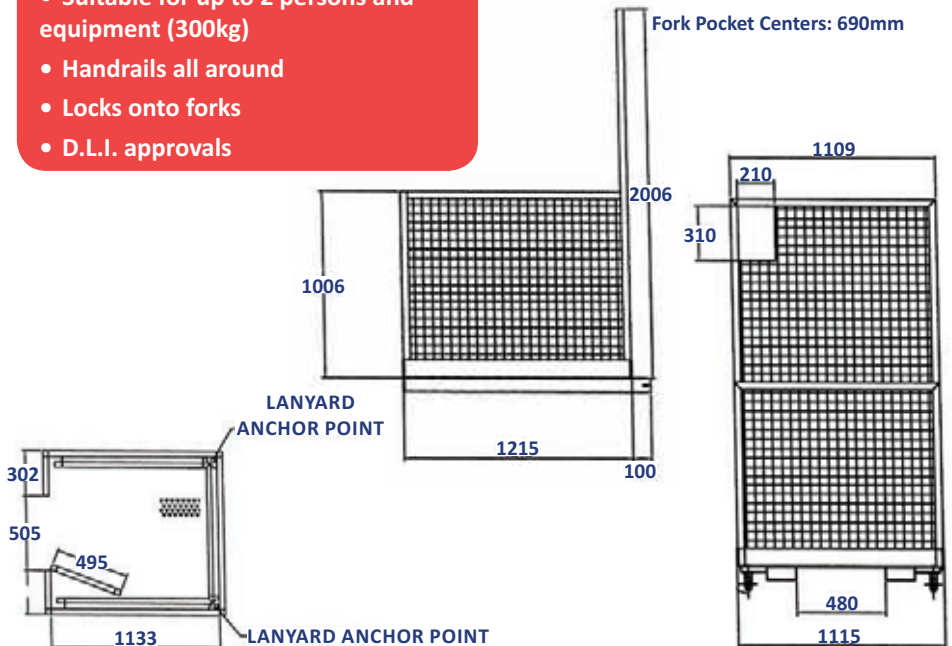

Crane & Overhead Lifting Applications

Bullivants prides itself on setting the highest standards for quality and safety with all of our Crane and Overhead Lifting Devices.

By offering engineering, manufacturing and reverse-engineering to industry we are able to support our customers with all of their lifting applications. Our Crane and Overhead Lifting Products are designed and manufactured in accordance with all relevant Australian Standards and are guaranteed to meet all criteria necessary to give our customers peace of mind.

Our experienced team can **custom design**, re-certify, manufacture and **repair** virtually any type of lifting device used in industrial applications. Whilst our standard range offers versatility across a variety of applications, we understand that you may have a very specific lifting situation and our experienced and professional engineers can custom design a solution tailored exactly to your needs.

Lifting & Rigging Equipment

We can supply fully tested chain slings and hardware with your fabricated lifting product as a complete unit so that everything is ready to go when it gets to site.

Be sure to ask our trained staff about this option when you request your quote.



Spreader Beams

5 Tonne Extendable Spreader Beam

| Order Code | WLL (tonnes) | Load Hole CTC Distance (mm) |
|------------|--------------|-----------------------------|
| S1523034 | 5.2 | 2100 |
| | 5.2 | 2600 |
| | 5.0 | 3100 |
| | 5.0 | 3600 |

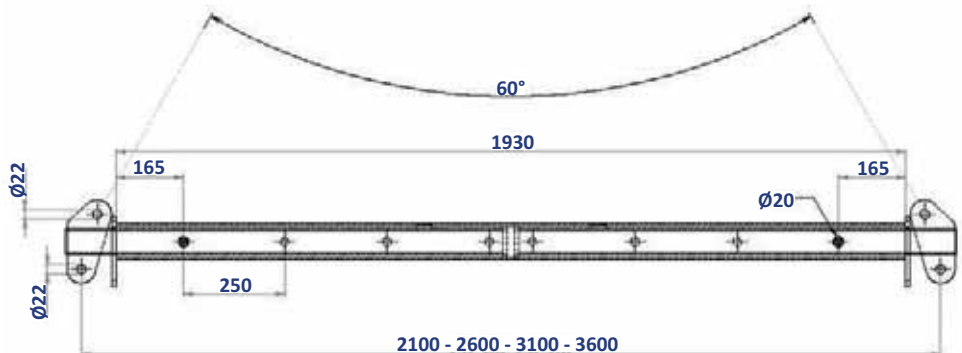
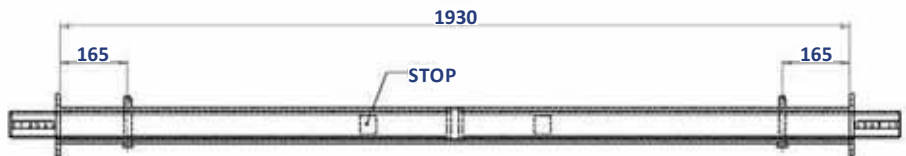
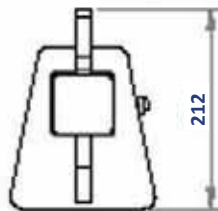

5 Tonne Extendable Spreader Beam

| Order Code | WLL (tonnes) | Load Hole CTC Distance (mm) |
|------------|--------------|-----------------------------|
| S1523035 | 5 | 1200 |
| | 5 | 1450 |
| | 5 | 1700 |
| | 5 | 1950 |

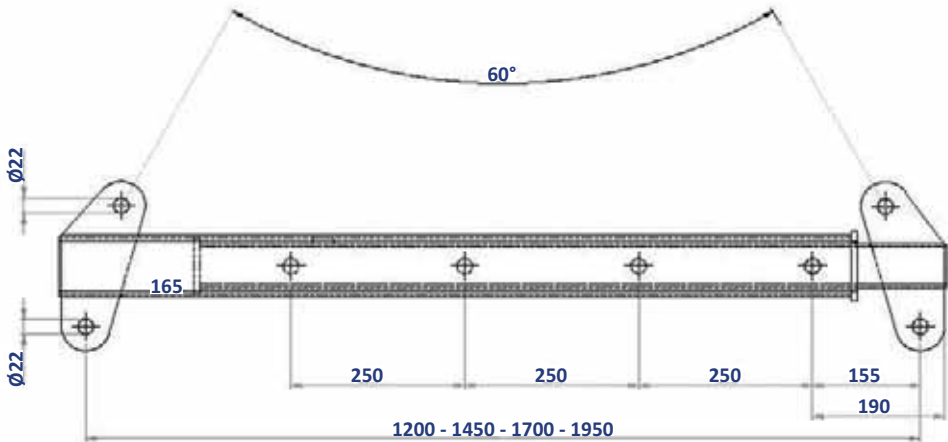
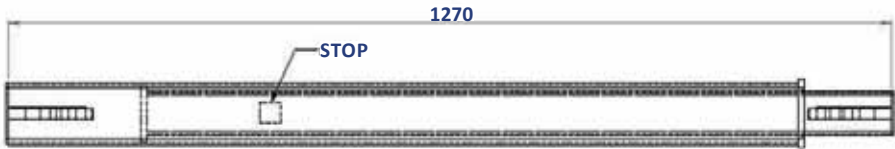
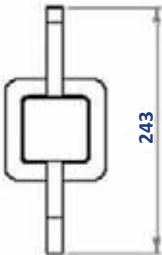
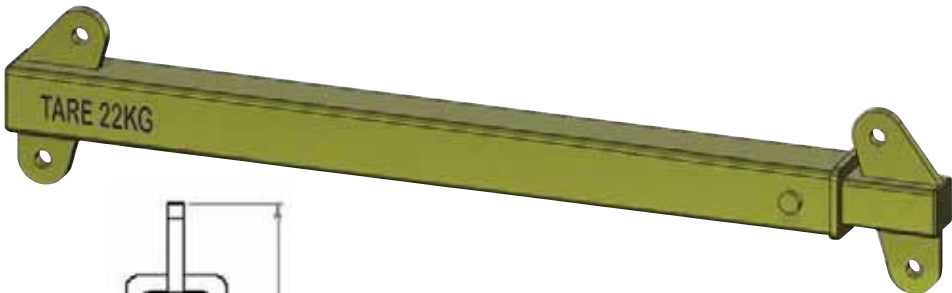

Lifting Beams

35 Tonne Container Lifting Beam

- 90° maximum sling angle
- Heavy duty.
- Approved, tested and certified with WLL clearly marked.
- Engraved ID tag
- Powder coated safety yellow.

| Order Code | WLL (tonnes) | Length (m) | Unit Weight (kg) |
|-----------------|--------------|------------|------------------|
| S1502361 | 35 | 2.6 | 152 |

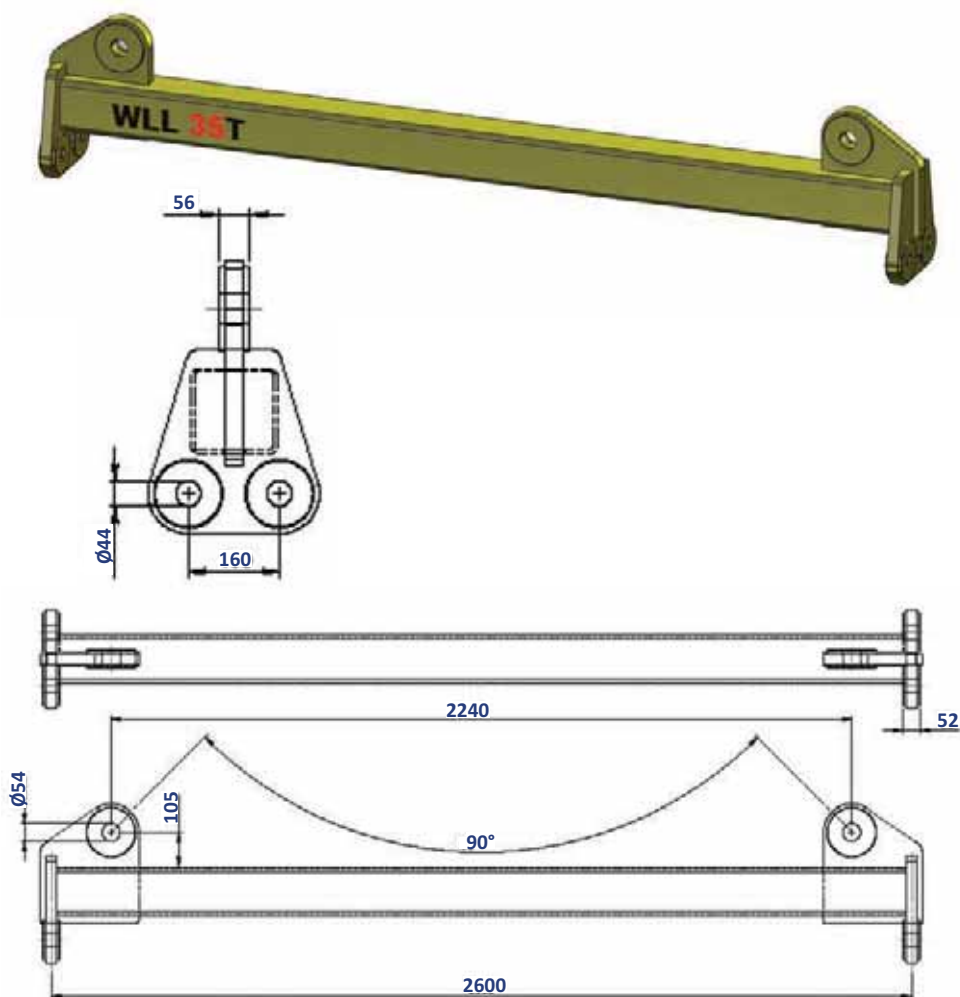

Conveyor Lifting Beam

- Heavy duty.
- Approved, tested and certified with WLL clearly marked.
- Powder coated safety yellow.

| Order Code | WLL (tonnes) | Length (m) | Unit Weight (kg) |
|------------|--------------|------------|------------------|
| S1504037 | 1 | 1.14 | 2.7 |
| S1504038 | 1 | 1.24 | 2.9 |
| S1504039 | 1 | 1.44 | 3.3 |
| S1504040 | 1 | 1.54 | 3.5 |
| S1504041 | 1 | 1.64 | 5.1 |
| S1504042 | 1 | 1.84 | 5.6 |
| S1504043 | 1 | 2.04 | 6.2 |

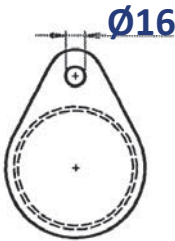
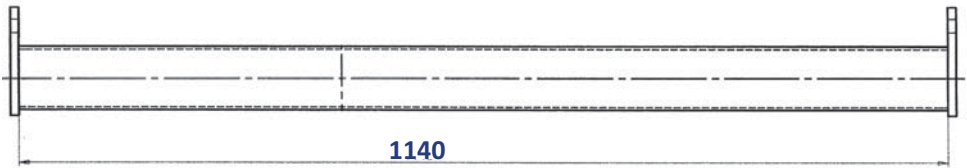

Extendable Combination Lifting & Spreader Beams

Bullivants' combination beams are the perfect addition to your rigging arsenal. The combination of both lifting and spreader configuration provide a versatile solution to your rigging needs. In its spreader configuration our combination beam offers greater WLL's and in its lifting configuration it eliminates head room issues (at lower WLL's).

Our Combination Beams are:

- Versatile
- Fully Certified
- Tested
- Clearly marked with an identification plate
- Adjustable
- Manufactured from Australian steel
- Powder Coated

And Come Complete With:

- Profile cut Spreader and Lifting Points
- Captive locking pins
- Ground stands allowing access to the underside of the beam when not in use
- A chart on the beam showing the beams WLL in all configurations

WARNING!

- Before use a competent person shall check the condition of the Beam
- Before use a competent person shall check all lifting equipment to be used with the Beam
- Never extend the Beam past its maximum allowable span
- Always remember; The tare weight of the Beam will increase the load on the crane or hoist being used
- Do not attempt to replace or repair any components of the Beam. Any repairs shall be conducted by Bullivants'
- Before lifting the load ensure that the adjustment of the Beam is even and that the locking pins are securely in place
- Never Modify the Beam to increase its adjustment range or capacity
- Never attempt to adjust the beam in any way whilst under load. If the load is uneven in any way it must be lowered, assessed and then adjusted accordingly
- Always ensure that the sling angles are correct before taking the load
- Always know the weight of the load and be sure that all lifting equipment has an adequate WLL for the lift!

8.6 Tonne Combination Beam

| Order Code | Open Length (mm) | WLL as Lifting Beam (tonnes) | WLL as Spreader Beam (tonnes) |
|-----------------|------------------|------------------------------|-------------------------------|
| S1504081 | 3600 | 0.8 | 6.6 |
| | 3100 | 0.9 | 6.9 |
| | 2600 | 1.1 | 7.3 |
| | 2100 | 1.3 | 8.6 |



Features & Benefits:

- Versatile telescopic beams providing ease of use and safety
- Supplied approved, tested and certified
- Powder coated safety yellow finish
- Engraved I.D. tag welded on, and WLL clearly marked
- Ground stands fitted as standard
- Chain slings and shackles to suit are available
- Units available for short or long term hire
- We can design and manufacture beams to suit your application if required.

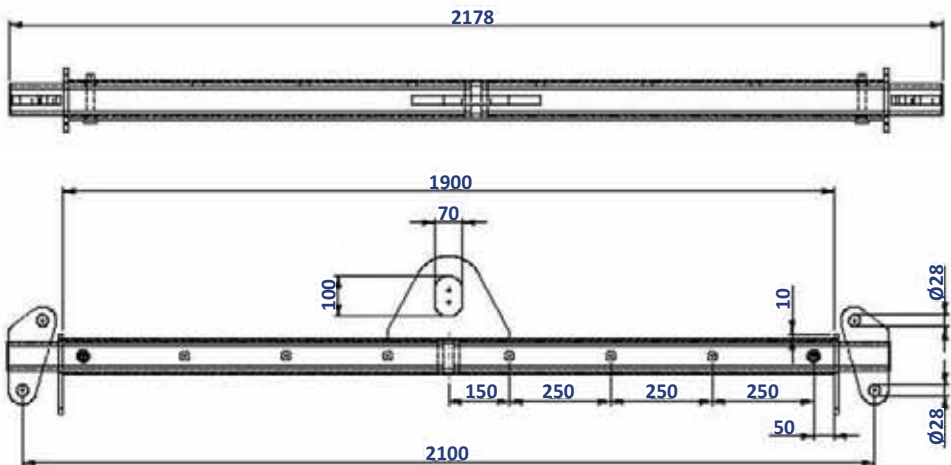
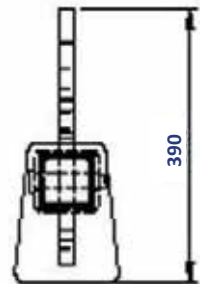

CRANE & OVERHEAD LIFTING APPLICATIONS

15 Tonne Combination Beam

| Order Code | Lug Centers (mm) | WLL as Lifting Beam (tonnes) | WLL as Spreader Beam (tonnes) |
|-----------------|------------------|------------------------------|-------------------------------|
| S1504151 | 2650 | 3.1 | 15 |
| | 3050 | 2.7 | 14 |
| | 3450 | 2.4 | 13 |
| | 3850 | 2 | 13 |

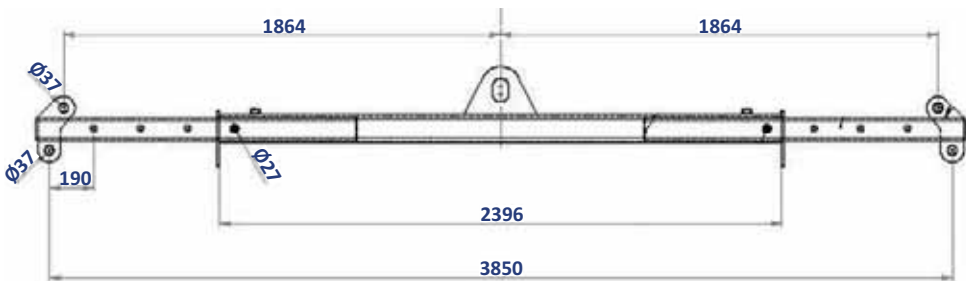
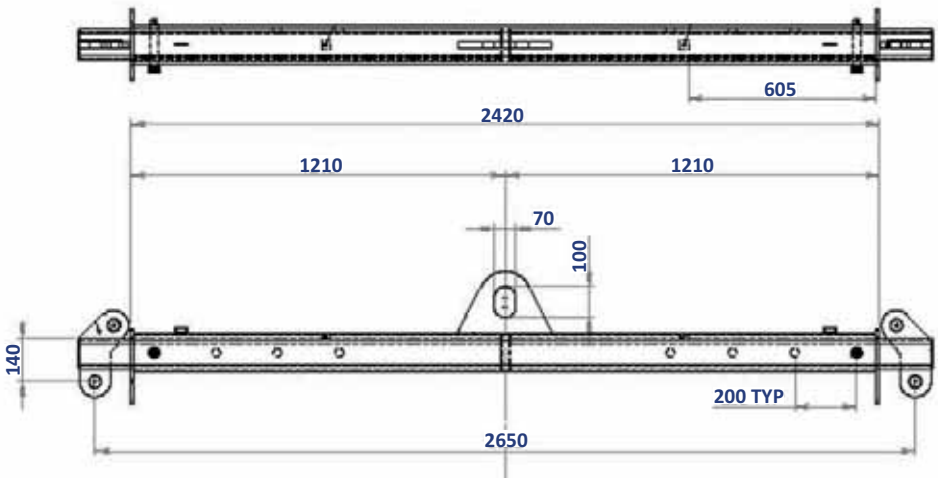

15 Tonne Combination Beam (2.4m)

| Order Code | Lug Centers (mm) | WLL as Lifting Beam (tonnes) | WLL as Spreader Beam (tonnes) |
|------------------|------------------|------------------------------|-------------------------------|
| S15040690 | 2290 | 3.1 | 15.0 |
| | 2690 | 2.7 | 15.0 |
| | 3090 | 2.4 | 15.0 |
| | 3490 | 2.0 | 15.0 |



Features & Benefits:

- Versatile telescopic beams providing ease of use and safety
- Supplied approved, tested and certified
- Powder coated safety yellow finish
- Engraved I.D. tag welded on, and WLL clearly marked
- Ground stands fitted as standard
- Chain slings and shackles to suit are available
- Units available for short or long term hire
- We can design and manufacture beams to suit your application if required.

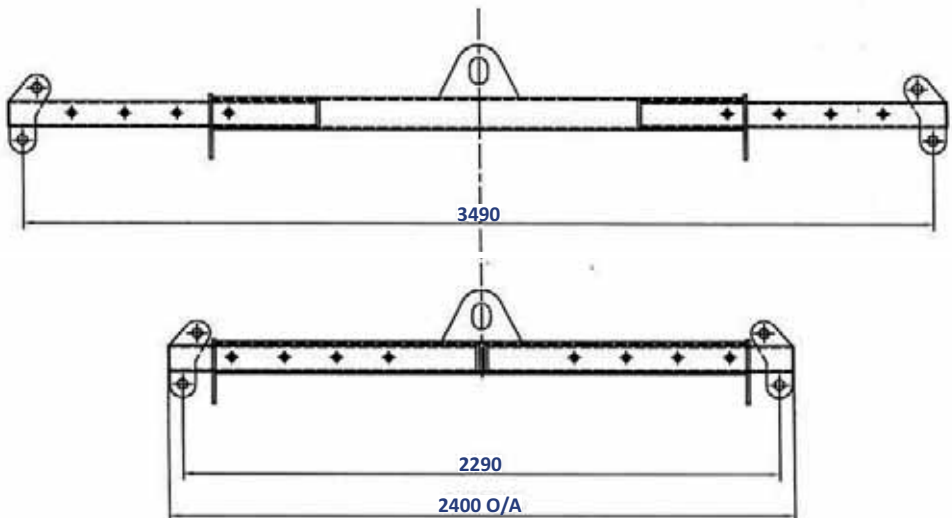

CRANE & OVERHEAD LIFTING APPLICATIONS

30 Tonne Combination Beam

| Order Code | Lug Centers (mm) | WLL as Lifting Beam (tonnes) | WLL as Spreader Beam (tonnes) |
|-----------------|------------------|------------------------------|-------------------------------|
| S1504311 | 4000 | 6.0 | 30 |
| | 4500 | 5.25 | 30 |
| | 5000 | 4.5 | 30 |
| | 5500 | 4.25 | 30 |
| | 6000 | 4.0 | 30 |



Features & Benefits:

- A versatile adjustable beam providing ease of use & safety
- Supplied approved, tested & certified with WLL clearly marked
- Ground stands fitted as standard
- Powder coated safety yellow finish
- Engraved I.D. tag welded on
- Chains & shackles are available to suit
- Units also available for long or short term hire
- We can design & manufacture beams to suit your application if required.

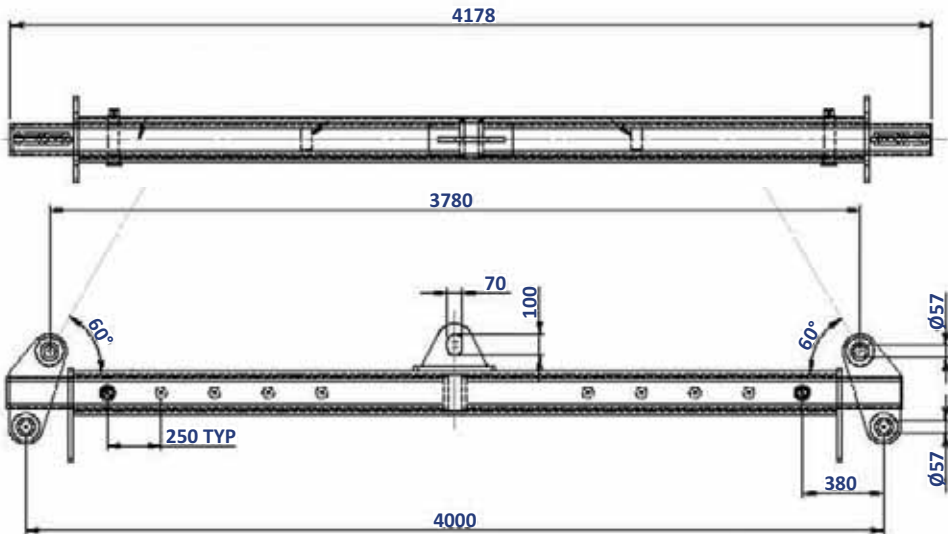
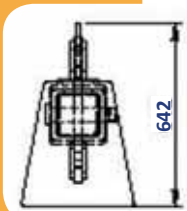

50 Tonne Combination Beam

| Order Code | Lug Centers (mm) | WLL as Lifting Beam (tonnes) | WLL as Spreader Beam (tonnes) |
|------------|------------------|------------------------------|-------------------------------|
| S1504350 | 4000 | 6.5 | 50 |
| | 4500 | 6.0 | 50 |
| | 5000 | 5.4 | 50 |
| | 5500 | 4.9 | 50 |
| | 6000 | 4.5 | 50 |

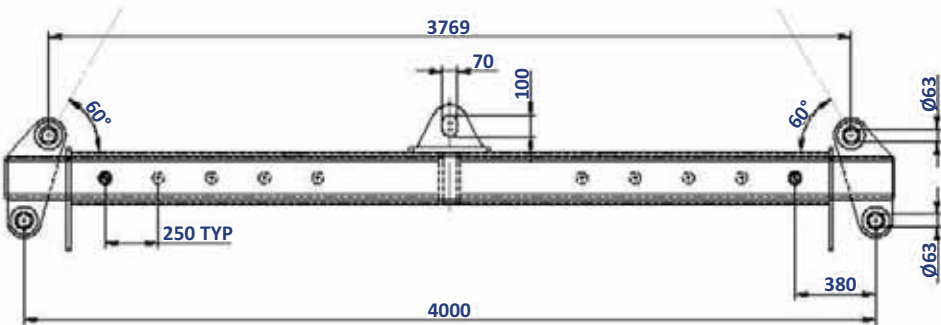
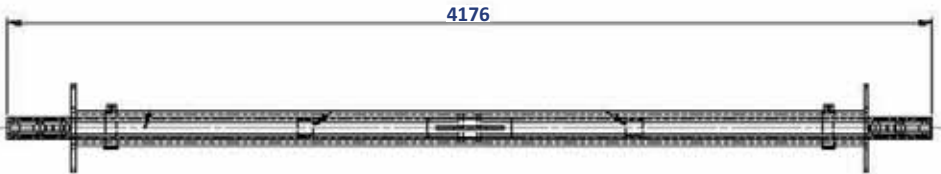
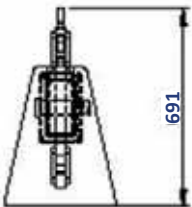

Pipe End Caps

Our End Cap range is the perfect versatile and affordable solution to your large lift needs. Offering high Working Load Limits (from 50T up to 220T), at greater spans than standard beams (up to 15mtrs). The Pipe End Caps simply slip over the end of the specified pipe and are then ready to go!

Our Pipe End Caps are:

- Versatile
- Heavy Duty
- Fully Certified
- Tested
- Clearly marked with an identification plate
- Adjustable
- Manufactured from Australian steel
- Galvanised

And Come Complete With:

- Transport Lugs
- Pipe Sections (optional – Ask your nearest Bullivants Branch for details)

WARNING!

- Before use a competent person shall check the condition of the Caps
- Before use a competent person shall check all lifting equipment to be used with the Caps (this includes the pipe)
- Always remember; The tare weight of the Beam will increase the load on the crane or hoist being used
- Do not attempt to alter or repair the End Caps. Any repairs shall be conducted by Bullivants'
- Before lifting the load ensure that the load is even and that the Pipe End Caps are securely in place
- Always ensure that the sling angles are correct before taking the load
- Always take the weight of the load slowly. Shock-loading the end caps could cause them to slip off the pipe
- Always know the weight of the load and be sure that all lifting equipment has an adequate WLL for the lift!

Pipe End Caps

- Supplied in pairs

| Order Code | WLL (tonnes) | Length (m) | Unit Weight (kg) |
|-----------------|--------------|---------------|------------------|
| S1504359 | 50 | max 12 | 341 |



Features & Benefits:

- Approved, tested and certified with WLL clearly marked
- Hot dipped galvanised finish
- Gives versatility to larger beams (see page 35 for more information)
- Engraved I.D. tag

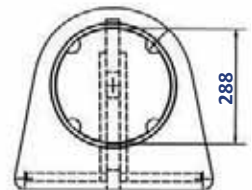
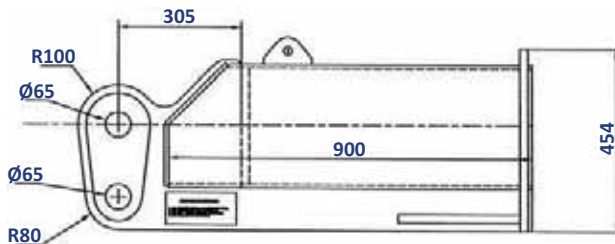
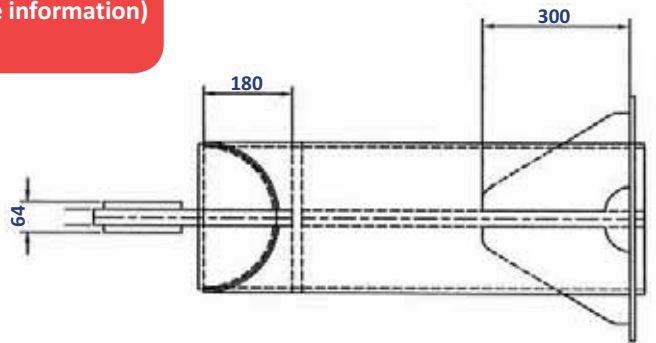

CRANE & OVERHEAD LIFTING APPLICATIONS

Pipe End Caps

- Supplied in pairs

| Order Code | WLL (tonnes) | Length (m) | Unit Weight (kg) |
|-----------------|--------------|---------------|------------------|
| S1504360 | 100 | max 12 | 638 |



Features & Benefits:

- Approved, tested and certified with WLL clearly marked
- Hot dipped galvanised finish
- Gives versatility to larger beams (see page 36 for more information)
- Engraved I.D. tag

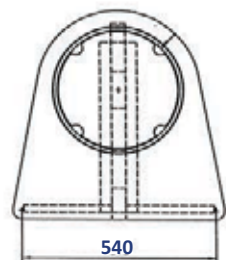
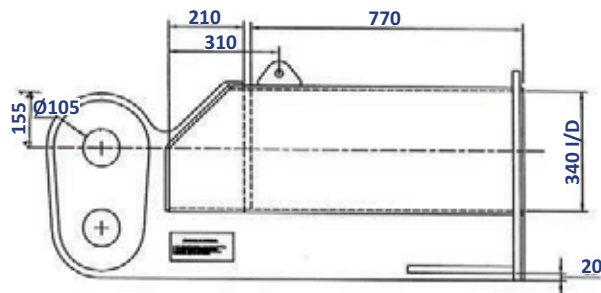
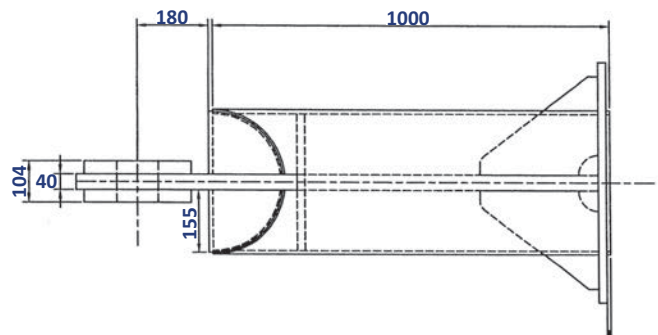

Pipe End Caps

- Supplied in pairs

| Order Code | WLL (tonnes) | Length (m) | Unit Weight (kg) |
|-----------------|--------------|---------------|------------------|
| S1404361 | 220 | max 15 | 938 |



Features & Benefits:

- Approved, tested and certified with WLL clearly marked
- Hot dipped galvanised finish
- Gives versatility to larger beams (see page 37 for more information)
- Engraved I.D. tag

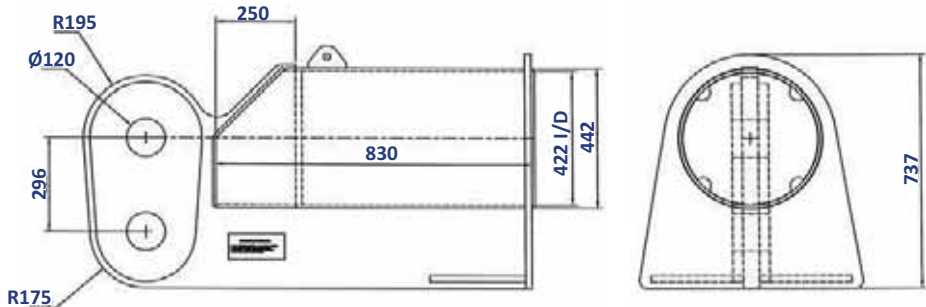
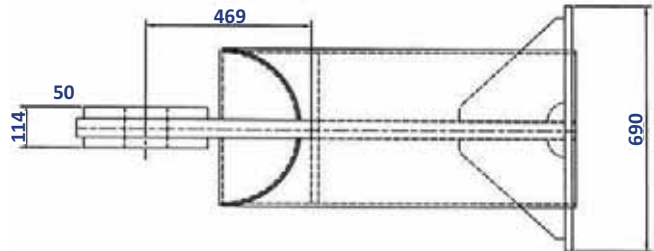

50T x 12m Spreader with End Caps

50T x 12m Spreader with End Caps

| ORDER CODE | DESCRIPTION |
|--|--|
| S1504359 | 50T x 12m Maximum Assembly Effective Length Spreader with End Caps |
| 160599 | SHACKLE: 35T GR'S' Safety Bow Shackle (Green Pin Vanbeest Safety Bow shackles only) |
| *PIPE: 273.1 x 9.5 AS 1163 GR350 | |
| *Bullivants accepts no responsibility should the grade and size of pipe used differ from that which we have stated above. | |

| ASSEMBLY EFFECTIVE LENGTH | SLING APEX ANGLE | | | |
|------------------------------|------------------|------------|------------|------------|
| | 90° | 75° | 60° | 45° |
| 3 (Metre) | 40T | 45T | 50T | 55T |
| 4 (Metre) | 40T | 45T | 50T | 55T |
| 5 (Metre) | 40T | 45T | 50T | 55T |
| 6 (Metre) | 40T | 45T | 50T | 55T |
| 7 (Metre) | 40T | 45T | 50T | 55T |
| 8 (Metre) | 40T | 45T | 50T | 55T |
| 9 (Metre) | 40T | 45T | 50T | 55T |
| 10 (Metre) | 40T | 45T | 50T | 55T |
| 11 (Metre) | 40T | 45T | 50T | 55T |
| 12 (Metre) | 40T | 45T | 50T | 55T |

End Cap Dimensions

50t End Caps add an additional 650mm total to lengths detailed (325mm each).

e.g. Using a 3mtr piece of pipe on 50T end caps will give a centre line of lug dimension 3650mm.

12mtr effective length = 11350mm length of pipe.

These end cap dimensions must be considered when calculating length of pipe to be used and you must always do a review of your lift and have your pipe cut and rigging selected to suit your individual application.

100T x 12m Spreader with End Caps

100T x 12m Spreader with End Caps

| ORDER CODE | DESCRIPTION |
|--|--|
| S1504360 | 100T x 12m Maximum Assembly Effective Length Spreader with End Caps |
| 160622 | SHACKLE: 85T GR'S' Safety Bow Shackle (Green Pin Vanbeest Safety Bow shackles only) |
| *PIPE: 323.9 x 9.5 AS 1163 GR350 | |
| *Bullivants accepts no responsibility should the grade and size of pipe used differ from that which we have stated above. | |

| ASSEMBLY EFFECTIVE LENGTH | SLING APEX ANGLE | | | |
|------------------------------|------------------|-------------|-------------|-------------|
| | 90° | 75° | 60° | 45° |
| 3 (Metre) | 100T | 115T | 110T | 125T |
| 4 (Metre) | 100T | 115T | 110T | 125T |
| 5 (Metre) | 100T | 115T | 110T | 125T |
| 6 (Metre) | 100T | 115T | 110T | 125T |
| 7 (Metre) | 100T | 115T | 110T | 125T |
| 8 (Metre) | 100T | 115T | 110T | 125T |
| 9 (Metre) | 100T | 115T | 110T | 125T |
| 10 (Metre) | 90T | 115T | 110T | 125T |
| 11 (Metre) | 80T | 100T | 110T | 125T |
| 12 (Metre) | 65T | 85T | 100T | 125T |

End Cap Dimensions

100t End Caps Add an additional 840mm total to lengths detailed (420mm each).

e.g. Using a 3mtr piece of pipe on 100T end caps will give a centre line of lug dimension 3840mm.

12mtr effective length = 11160mm length of pipe.

These end cap dimensions must be considered when calculating length of pipe to be used and you must always do a review of your lift and have your pipe cut and rigging selected to suit your individual application.

220T x 15m Spreader with End Caps

220T x 15m Spreader with End Caps

| ORDER CODE | DESCRIPTION |
|--|---|
| S1404361 | 220T x 15m Maximum Assembly Effective Length Spreader with End Caps |
| 160624 | SHACKLE: 150T GR'S' Safety Bow Shackle (Green Pin Vanbeest Safety Bow shackles only) |
| *PIPE: 406.4 x 12.7 AS 1163 GR350 | |
| *Bullivants accepts no responsibility should the grade and size of pipe used differ from that which we have stated above. | |

| ASSEMBLY EFFECTIVE LENGTH | SLING APEX ANGLE | | | |
|------------------------------|------------------|-------------|-------------|-------------|
| | 90° | 75° | 60° | 45° |
| 3 (Metre) | 205T | 230T | 250T | 260T |
| 4 (Metre) | 205T | 230T | 250T | 260T |
| 5 (Metre) | 205T | 230T | 250T | 260T |
| 6 (Metre) | 205T | 230T | 250T | 260T |
| 7 (Metre) | 205T | 230T | 250T | 260T |
| 8 (Metre) | 205T | 230T | 250T | 260T |
| 9 (Metre) | 205T | 230T | 250T | 260T |
| 10 (Metre) | 205T | 230T | 250T | 260T |
| 11 (Metre) | 205T | 230T | 250T | 260T |
| 12 (Metre) | 205T | 230T | 250T | 260T |
| 13 (Metre) | 180T | 230T | 250T | 260T |
| 14 (Metre) | 160T | 200T | 250T | 260T |
| 15 (Metre) | 135T | 170T | 220T | 260T |

End Cap Dimensions

220t End Caps Add an additional 980mm total to lengths detailed (490mm each).

e.g. Using a 3mtr piece of pipe on 220T end caps will give a centre line of lug dimension 3980mm.

15mtr effective length = 14020mm length of pipe.

These end cap dimensions must be considered when calculating length of pipe to be used and you must always do a review of your lift and have your pipe cut and rigging selected to suit your individual application.

Pallet Lifting

Our range of pallet lifting products are designed to safely move pallets when Forklift access is unavailable. Both the Pallet Lifting Fork and Pallet Lifting Bars have been designed with the highest levels of safety and efficiency in mind.

Our Pallet Lifting Products are:

- A safe “no fuss” solution to moving pallets without the use of a forklift
- Fully Certified
- Proof Tested
- Clearly marked
- Manufactured from Australian steel
- Powder Coated

And Come Complete With:

- Multi lift points for load balancing (Pallet Lifting Fork only)
- Square lifting frame (option only for Pallet Lifting Bars)

WARNING!

- Before use a competent person shall check all lifting and structural components of the Pallet Lifting Device
- Before use a competent person shall check all lifting equipment to be used with the Pallet Lifting Device
- Do lift uneven or unsteady loads
- Where possible the load should be wrapped before being lifted
- Always ensure that all movable components are in the correct position and secure before lifting the load
- Always travel loads at the lowest possible height to reduce the risk of falling objects harming personnel
- Always work within the capacity of the crane or hoist being used
- Always maintain appropriate exclusion zones at all times
- When moving loads with a crane care must be taken not to create a swinging load
- Always use good lifting and rigging practice when using these items

CRANE & OVERHEAD LIFTING APPLICATIONS

Pallet Lifting Fork

| Order Code | WLL (tonnes) | Unit Weight (kg) |
|------------|--------------|------------------|
| S1538011 | 2 | 116 |

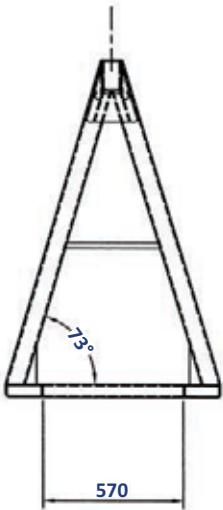
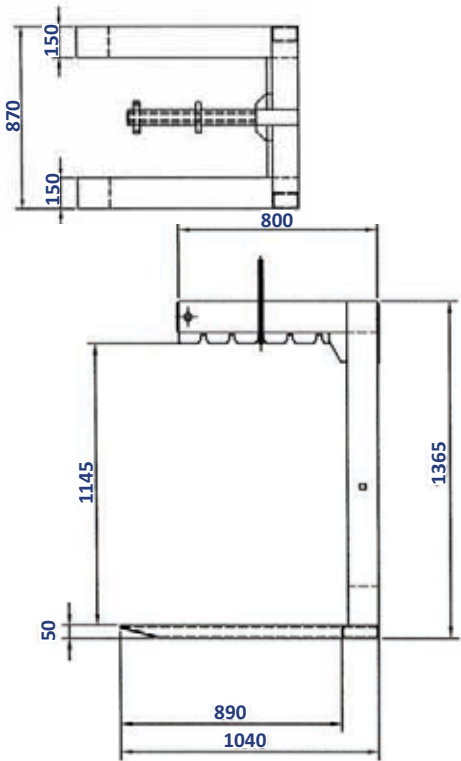

Pallet Lifting Bars

- Supplied in pairs

| Order Code | WLL (tonnes) | Unit Weight (kg) |
|------------|--------------|------------------|
| 201127 | 2 | 18 |

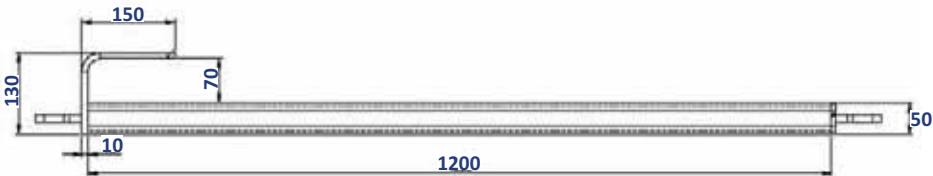
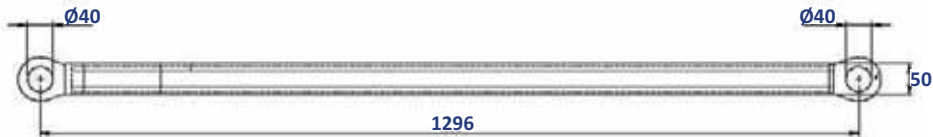

CRANE & OVERHEAD LIFTING APPLICATIONS

Pallet Lifting Frame (Square)

| Order Code | WLL (tonnes) | Unit Weight (kg) |
|-----------------|--------------|------------------|
| S1505003 | 2 | 20 |

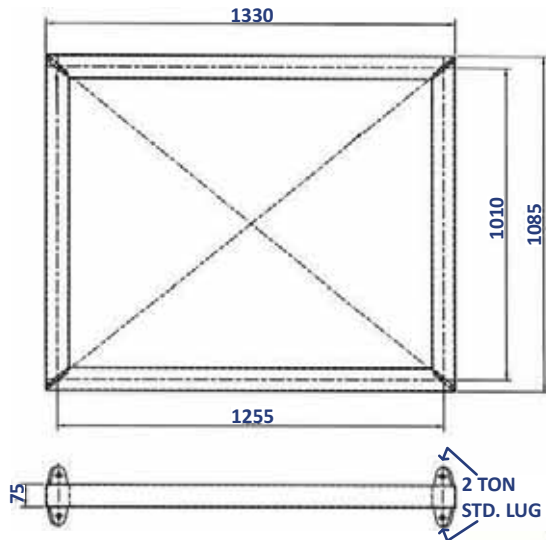

Features & Benefits:

- Various types of bottom slings available for pallet bar attachment
- Tested and certified
- Clearly marked with WLL
- Frame supplied powder coated yellow



Drum Lifting Frame

| Order Code | WLL (kg) | Drum Size (L) | Unit Weight (kg) |
|------------|----------|---------------|------------------|
| S1531020 | 700 | 200 | 53 |

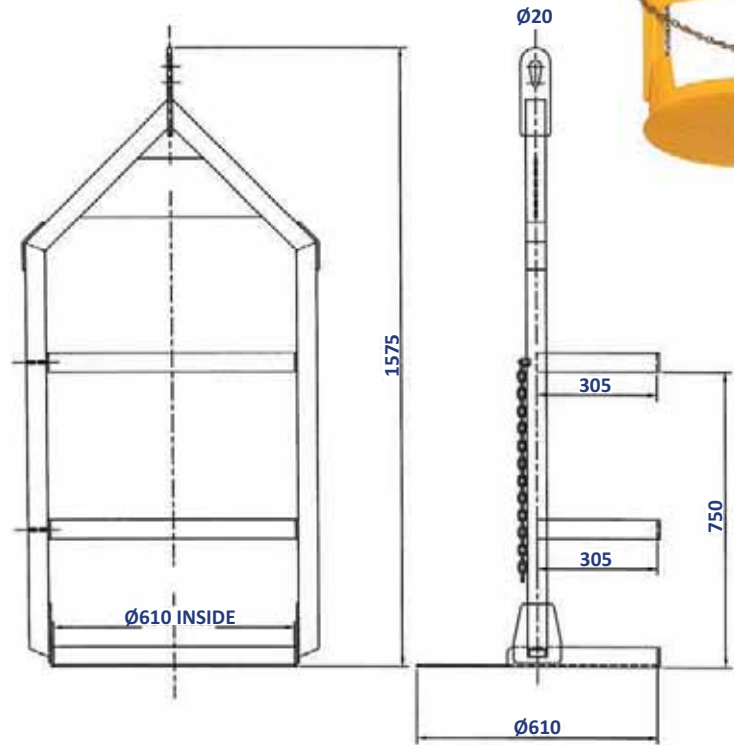

CRANE & OVERHEAD LIFTING APPLICATIONS

Double Drum Lifting Frame

| Order Code | WLL (tonnes) | Drum Size (L) | Unit Weight (kg) |
|-----------------|--------------|---------------|------------------|
| S1531022 | 1 | 200 | 102 |

Features & Benefits:

- Lifts two drums with lids on or off
- Fitted with safety chains
- Safe and easy to use
- Tested and certified
- Powder coated safety yellow
- Clearly marked with WLL

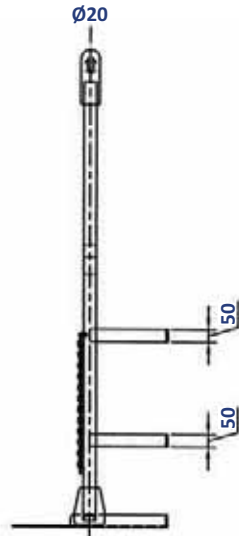
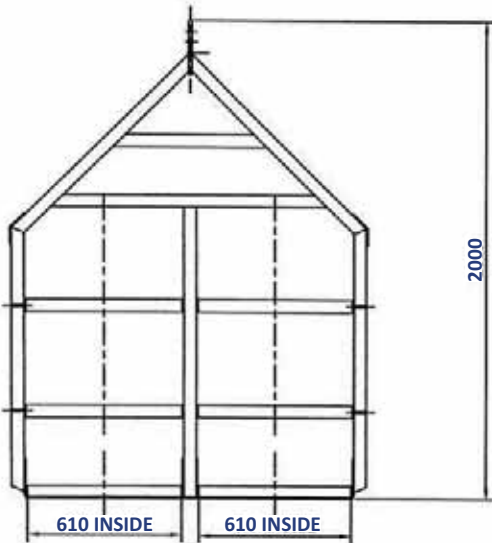
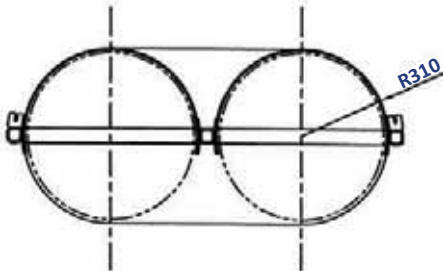

Bulka Bag With Fixed Arms

| Order Code | WLL (tonnes) | Effective Width (mm) | Unit Weight (kg) |
|------------|--------------|----------------------|------------------|
| S1505010 | 1 | 1000 | 30 |



Features & Benefits:

- Heavy duty centre point lifting frame with fixed arms
- Powder coated safety yellow
- Tested, certified and clearly marked with WLL

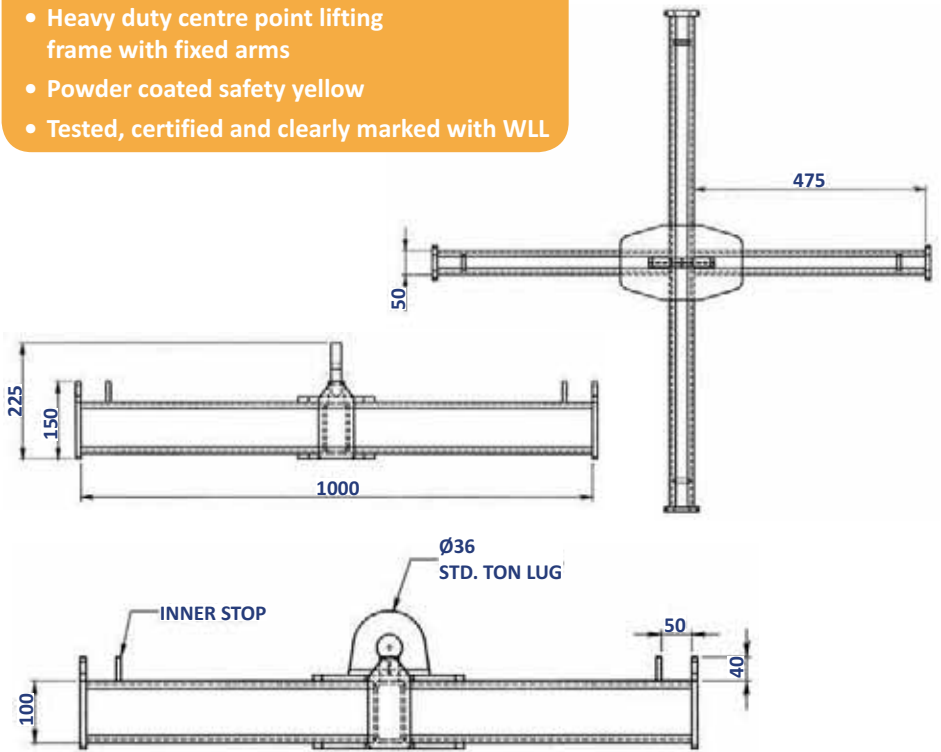

CRANE & OVERHEAD LIFTING APPLICATIONS

Bulka Bag With Extendable Arms

| Order Code | WLL (tonnes) | Effective Width (Closed) (mm) | Effective Width (Fully Open) (mm) | Unit Weight (kg) |
|-----------------|--------------|-------------------------------|-----------------------------------|------------------|
| S1505005 | 2 | 800 | 1100 | 40 |



Features & Benefits:

- Heavy duty centre point lifting frame with extendable arms
- Extendable model fitted with excavator hooks for easy bag attachment
- Powder coated safety yellow
- Tested, certified and clearly marked with WLL

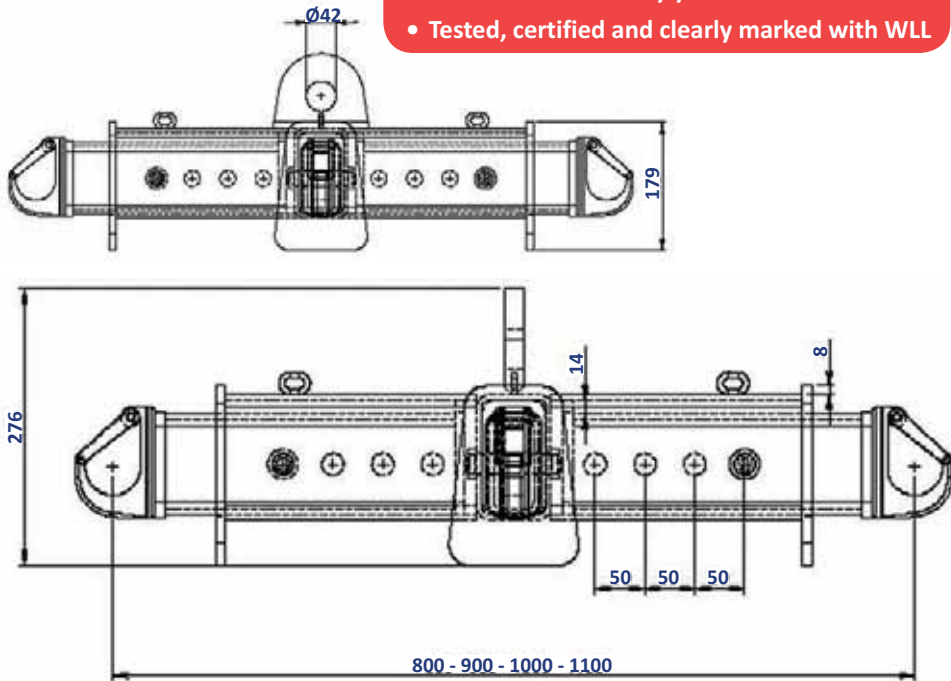

Railway Line Lifting Tongs

- Galvanised bow shackle.
- Approved, tested and certified with WLL clearly marked.

| Order Code | WLL (tonnes) | Maximum Jaw Opening (mm) | Unit Weight (kg) |
|-----------------|--------------|--------------------------|------------------|
| S1530201 | 1.5 | 80 | 7.5 |

Features & Benefits:

- Galvanised bow shackle
- Durable powder coated finish
- Tested and certified
- Stamped with WLL

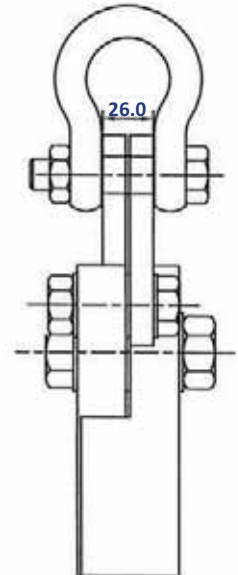
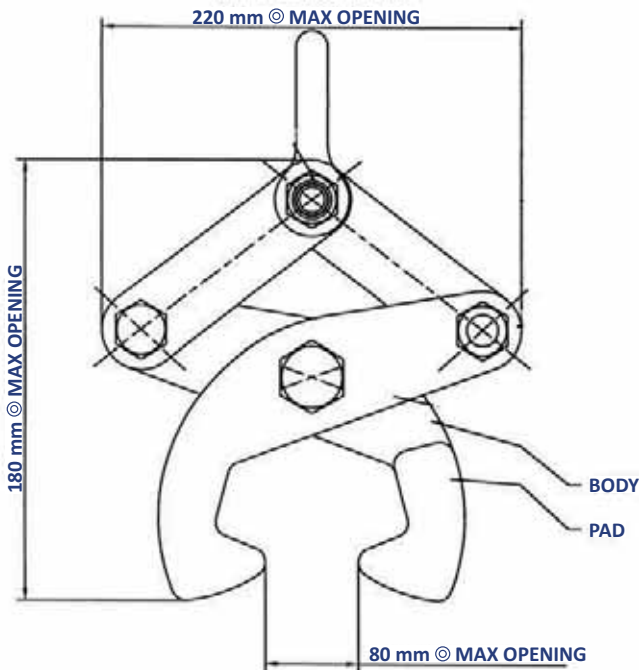

Work Cages

Bullivants' Work Cages are designed to go above and beyond the requirements of AS1418.17 (Design and construction of Workboxes) offering you peace of mind when it comes to transporting personnel by means of crane. All of our Work Cages go through stringent design and testing procedures to ensure safety is maintained at all times.

Our Work Cages are:

- A safe and secure method for working at heights
- Fully Certified
- Proof Tested
- Clearly marked with an identification plate
- Third Party Verified
- Manufactured from Australian steel
- Powder Coated

And Come Complete With:

- 4 lifting points for optimum stability
- Internal Handrails
- Overhead Harness anchor points (on models with overhead protection)
- Forklift slippers for transportation of empty work cage around the job site

WARNING!

- Before use a competent person shall check all lifting and structural components of the work cage
- Before use a competent person shall check all lifting equipment and attachment points
- Never enter or exit a suspended work cage except in the event of an emergency
- Always work within the capacity of the crane being used. Ensure that you are working within the cranes SWL at the required radius
- Never use work cages near live plant or equipment. Maintain appropriate exclusion zones at all times
- All personnel within the Work Cage must be attached to the anchorage point via approved fall arrest equipment
- The crane being used shall be correctly maintained and inspected as per AS2550.1
- Work Cages shall only be used when no other means of transportation is possible. Never use a work cage as a substitute for normal means of transportation
- Contact between the crane operator and the personnel in the cage must be maintained at all times and the operator shall stay at the crane controls at all times

Workcage - 1 Person

| Order Code | WLL (kg) | Unit Weight (kg) |
|------------|----------|------------------|
| S1537051 | 150 | 160 |



- Features & Benefits:
- Safe and secure method for working at heights
 - Sturdy design with 4 lifting lugs
 - Fitted with internal hand rails and overhead rail for securing safety harnesses
 - Approved, tested certified and supplied with appropriate signage
 - Top slings to suit, available in chain or wire rope
 - Harnesses and lanyards available
 - Can be transported by forklift
 - Units available for hire

Fork Pocket Sizes: 242mm x 76mm
Fork Pocket Centers: 630mm

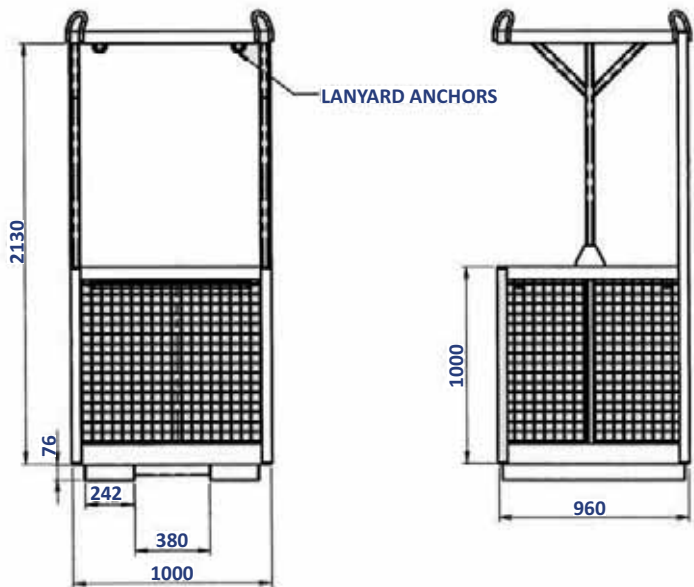

CRANE & OVERHEAD LIFTING APPLICATIONS

Workage - 2 Person

| Order Code | WLL (kg) | Height (mm) | Width (mm) | Length (mm) | Unit Weight (kg) |
|--------------------------------|------------|-------------|------------|-------------|------------------|
| S1537081 - with gate | 300 | 2200 | 950 | 1500 | 206 |
| S1537083 - without gate | 300 | 2200 | 950 | 1500 | 180 |

Features & Benefits:

- Safe and secure method for working at heights
- Sturdy design with 4 lifting lugs
- Fitted with internal hand rails and overhead rail for securing safety harnesses
- Approved, tested certified and supplied with appropriate signage
- Top slings to suit, available in chain or wire rope
- Harnesses and lanyards available
- Can be transported by forklift
- Units available for hire

Fork Pocket Sizes: 170mm x 65mm

Fork Pocket Centers: 922mm

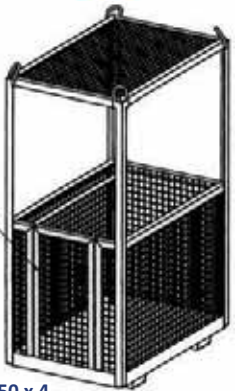

INWARD OPENING GATE HINGE, SELF CLOSER AND LATCH (NOT SHOWN) TO BE ADDED ON ASSEMBLY

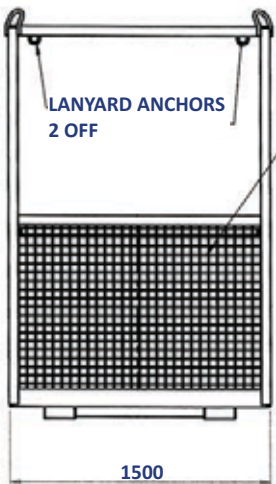
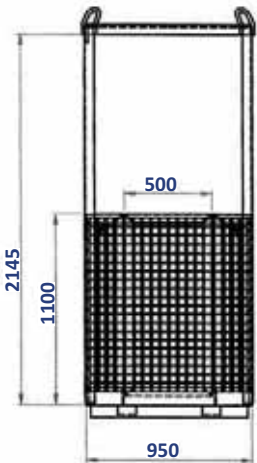

LANYARD ANCHORS
2 OFF

MESH 50 x 50 x 4
WELDMESH

Workcage - 1 Person (Circular)

| Order Code | WLL (kg) | Height (mm) | External Diameter (mm) | Internal Diameter (mm) | Unit Weight (kg) |
|------------|----------|-------------|------------------------|------------------------|------------------|
| S1537111 | 250 | 2400 | 1000 | 700 | 246 |

Features & Benefits:

- Safe and secure method for working at heights
- Sturdy design with 4 lifting lugs
- Fitted with internal hand rails and overhead rail for securing safety harnesses
- Approved, tested certified and supplied with appropriate signage
- Top slings to suit, available in chain or wire rope
- Harnesses and lanyards available
- Can be transported by forklift
- Units available for hire



Fork Pocket Sizes: 178mm x 75mm

Fork Pocket Centers: 636mm

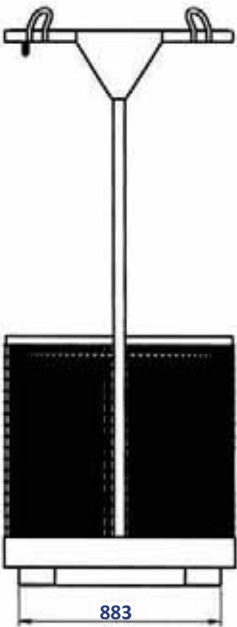
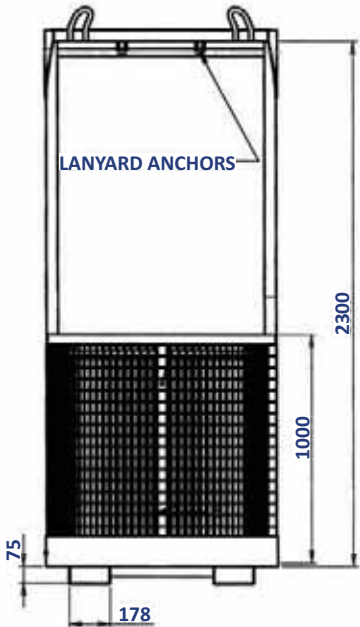

Lifting Hooks

Eye Type Low Profile Container Lifting Hooks

- Supplied in pairs

| Order Code | WLL (tonnes) (pair) | Type | Unit Weight (kg) (pair) |
|-------------------|---------------------|-----------------|-------------------------|
| S1543010-1 | 22 | Angled | 5 |
| S1543010-2 | 22 | Straight | 5 |

Features & Benefits:

- Unique design
- Ideal for low clearance applications
- Safe and easy to use
- Tested and certified
- Powder coated safety yellow
- Clearly marked with WLL

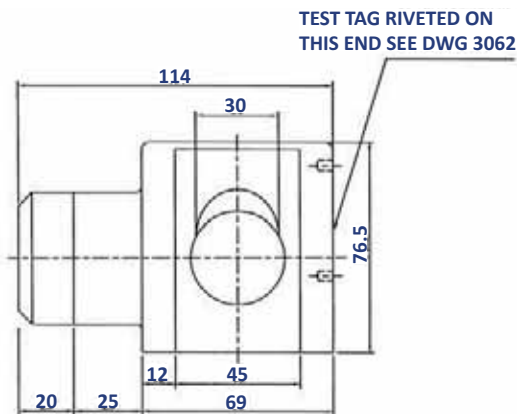
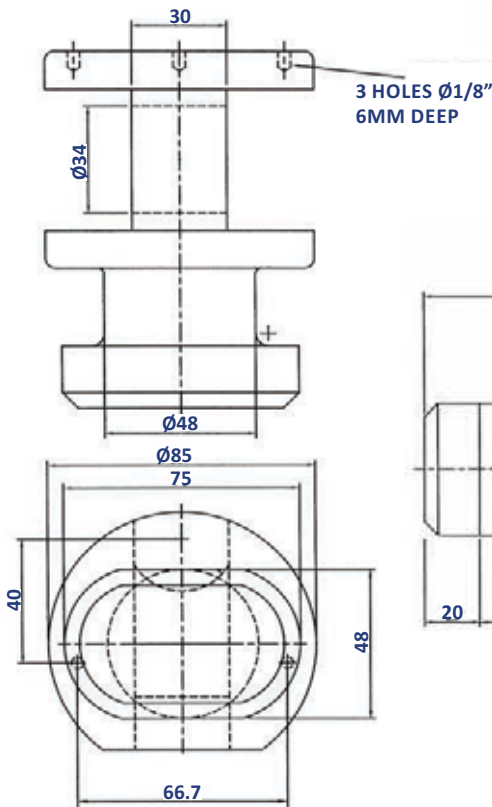

Self Adjusting Coil Lifting Hooks

| Order Code | WLL (tonnes) | Maximum Coil Width (mm) | Unit Weight (kg) |
|-----------------|--------------|-------------------------|------------------|
| S1543216 | 5 | 1220 | 130 |
| S1543220 | 6 | 940 | 130 |



Features & Benefits:

- Compact, light-weight, spring-loaded design, remains level when not loaded, no need for bulky counterweights
- Polyurethane shoe and buffers can be fitted if required
- Can be specially designed for any tonnage/coil size

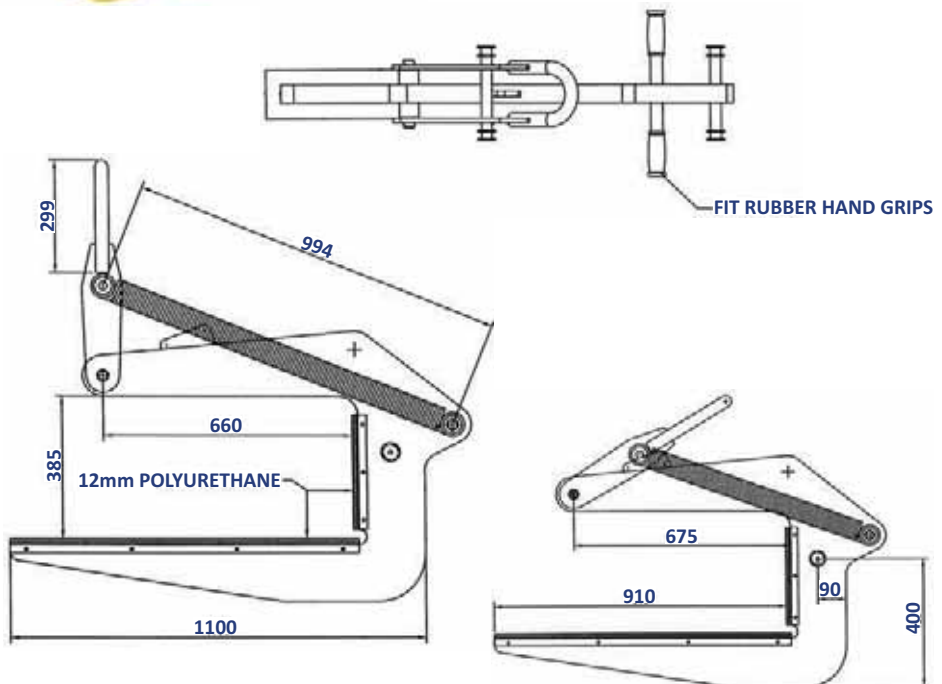

CRANE & OVERHEAD LIFTING APPLICATIONS

Pipe Lifting Hook

- Supplied in pairs

| Order Code | WLL (tonnes) (pair) | Fits Pipe Size (mm) | Unit Weight (kg) (pair) |
|-----------------|---------------------|---------------------|-------------------------|
| S1543151 | 1.5 | 0-20 | 3 |
| S1543212 | 3 | 0-32 | 7.6 |
| S1543218 | 5 | 15-50 | 10.4 |



Features & Benefits:

- Hi tensile alloy - smooth profile
- Powder coated finish
- Heavy duty steel grade pivot pin and return spring
- All clamps proof tested to twice the WLL
- Supplied with certificates

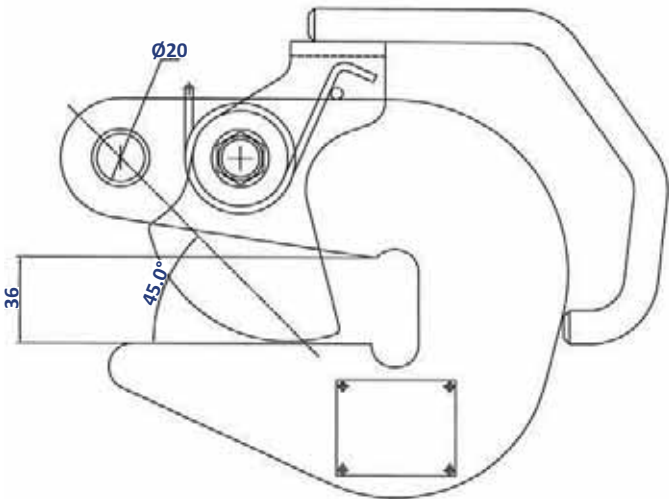

3T Horizontal Plate Clamps Pair (Non-Marring)

| Order Code | WLL (tonnes) (pair) | Clamp Range (mm) | Unit Weight (kg) (pair) |
|----------------|---------------------|------------------|-------------------------|
| S153386 | 3 | 0-60 | 10 |

Features & Benefits:

- Ergonomic design
- Spring loaded cam
- Polyurethane cam face
- Powder coated finish
- Engraved I.D. Tag welded on
- Tested and certified to as 4991-2004
- Chain slings available
- Sold in pairs
- Clearly marked with W.L.L.

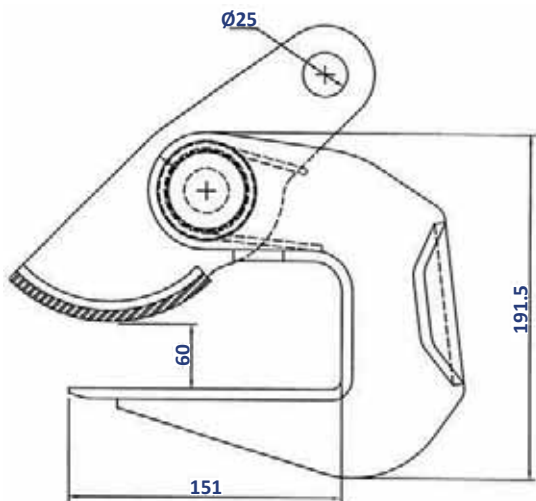
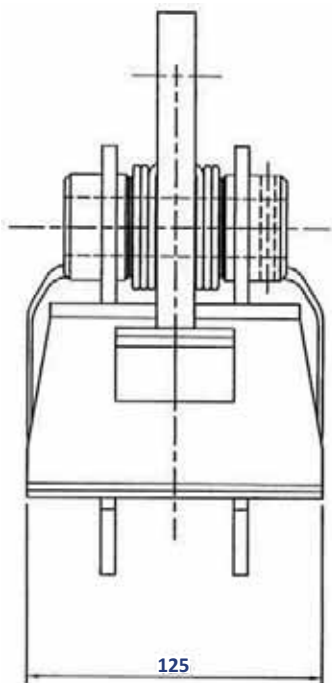

6T Horizontal Plate Clamps Pair (Non- Marring)

| Order Code | WLL (tonnes) (pair) | Clamp Range (mm) | Unit Weight (kg) (pair) |
|----------------|---------------------|------------------|-------------------------|
| S153387 | 6 | 0-60 | 17.5 |

Features & Benefits:

- Ergonomic design
- Spring loaded cam
- Polyurethane cam face
- Powder coated finish
- Engraved I.D. Tag welded on
- Tested and certified to AS4991-2004
- Chain slings available
- Sold in pairs
- Clearly marked with W.L.L.

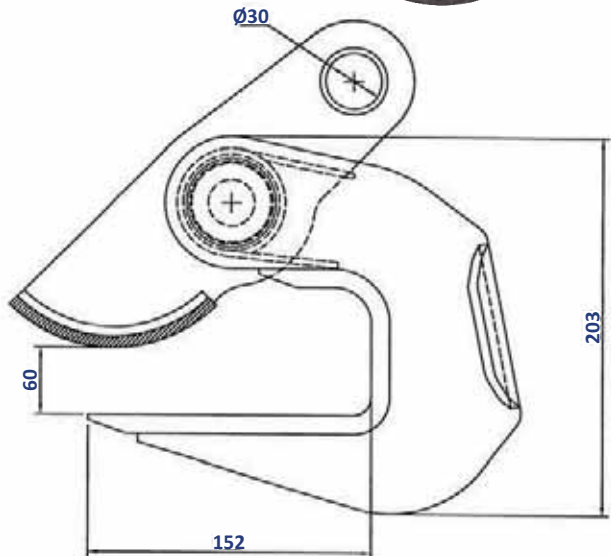
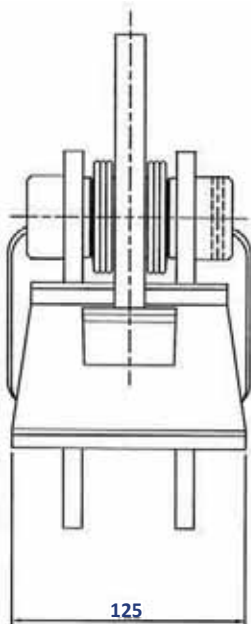

Oxy/Acetylene Handling

Handling gas bottles can be a very hazardous task if done incorrectly. That's why Bullivants have ensured that their range of trolleys and lifting frames are of the highest quality and provide the safest means of transporting these dangerous items.

Our Trolleys and Lifting Frames are:

- Safe and easy to use
- Versatile
- Fully Certified
- Proof Tested
- Clearly marked with a welded on I.D. tag
- Manufactured from Australian steel
- Powder Coated

And Come Complete With:

- Heavy Duty Toolbox (Trolley only)
- Available with fire extinguisher and/or fire blanket
- Supplied with pneumatic tyres (Trolley only. Other wheel options available)
- Captive locking pin (Trolley only)
- Fitted with safety chains (Lifting Frame only)
- Lifting Frame and Trolleys both come with single lifting point

Lifting & Rigging Equipment

We can supply fully tested chain slings and hardware with your fabricated lifting product as a complete unit so that everything is ready to go when it gets to site.

Be sure to ask our trained staff about this option when you request your quote.

WARNING!

- Before use a competent person shall check all lifting and structural components of the Trolley/Lifting Frame
- Before use a competent person shall check all lifting equipment to be used with the Trolley/lifting frame
- Always ensure that the bottles being moved are secured correctly with safety pins or safety chains in place
- Always use good lifting and rigging practice when using these items

OXY & ACETYLENE APPLICATIONS

200 Kilogram 2 x Oxygen Bottle Trolley G size

- Fits two Oxygen bottles
- Supplied with pneumatic tyres.

| Order Code | WLL (kg) | Unit Weight (kg) | Wheel Type |
|-----------------|------------|------------------|------------------------|
| S1537126 | 200 | 76 | pneumatic tyres |



Features & Benefits:

- Fitted with locator chain and pin
- Versatile and mobile
- Use as a trolley
- Use as a lifting frame
- Use with a forklift or crane
- Complete with tool box
- Tested and certified to AS4991
- Powder coated finish
- Engraved I.D. tag welded on
- Trolley to suit G size bottles
- Other sizes/styles designed and manufactured to your requirements

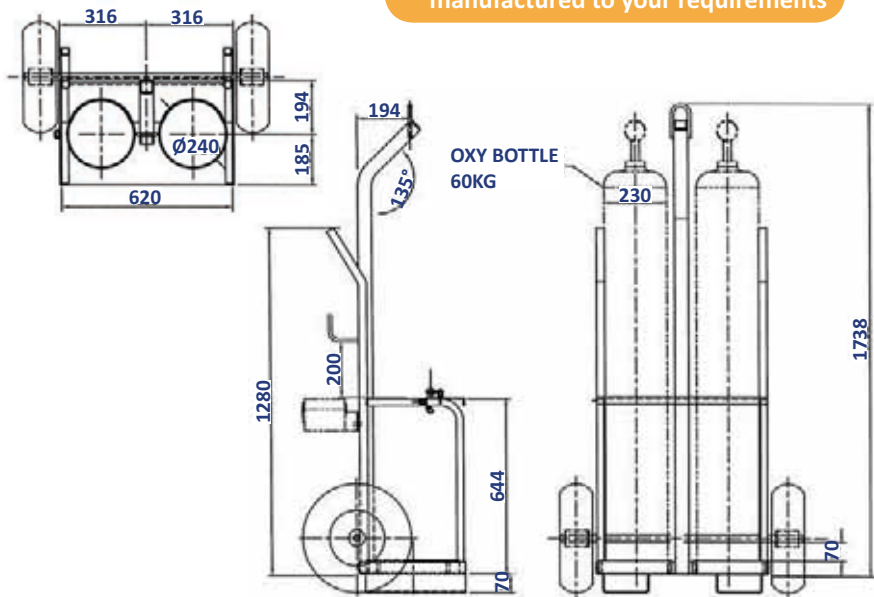

OXY & ACETYLENE APPLICATIONS

100 Kilogram 2 x Bottle Trolley D Size

- Fits one Oxygen bottle with either one of the following bottles: Acetylene, Propane or LPG
- Supplied with pneumatic tyres.

| Order Code | WLL (kg) | Unit Weight (kg) | Wheel Type |
|------------------|------------|------------------|------------------------|
| S1537121B | 100 | 60 | pneumatic tyres |

Features & Benefits:

- Fitted with locator chain and pin
- Versatile and mobile
- Use as a trolley
- Use as a lifting frame
- Use with a forklift or crane
- Complete with tool box
- Tested and certified to AS4991
- Powder coated finish
- Engraved I.D. tag welded on
- Trolley to suit D size bottles

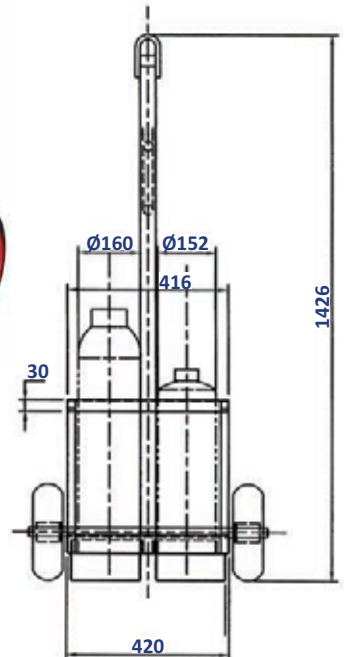
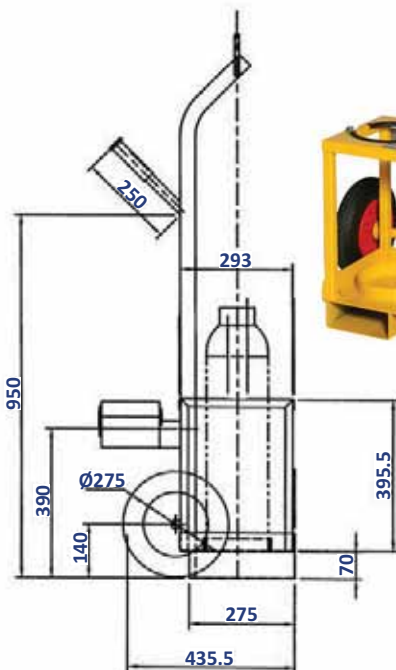
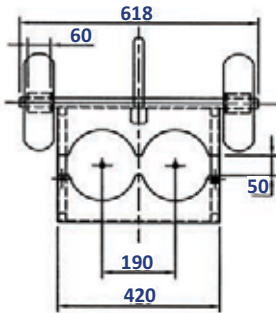

OXY & ACETYLENE APPLICATIONS

150 Kilogram 2 x Bottle Trolley E Size

- Fits one Oxygen bottle with either one of the following bottles: Acetylene, Propane or LPG
- Supplied with pneumatic tyres.

| Order Code | WLL (kg) | Unit Weight (kg) | Wheel Type |
|------------------|------------|------------------|------------------------|
| S1537122A | 150 | 60 | pneumatic tyres |



Features & Benefits:

- Fitted with locator chain and pin
- Versatile and mobile
- Use as a trolley
- Use as a lifting frame
- Use with a forklift or crane
- Complete with tool box
- Tested and certified to AS4991
- Powder coated finish
- Engraved I.D. tag welded on
- Trolley to suit E size bottles

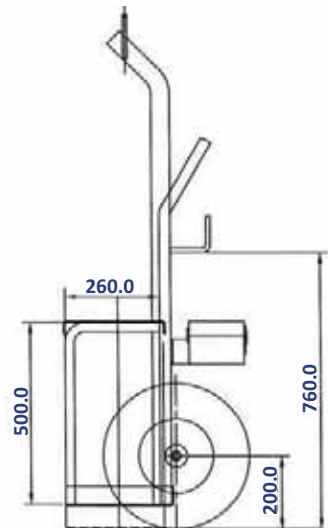
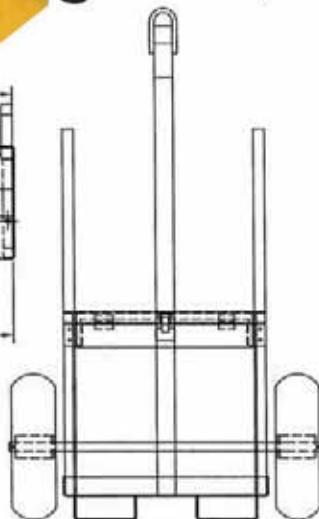
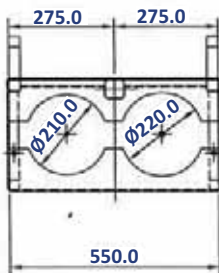

OXY & ACETYLENE APPLICATIONS

200 Kilogram 2 x Bottle Trolley G Size - Pneumatic Tyres

- Fits one Oxygen bottle with either one of the following bottles: Acetylene, Propane or LPG
- Supplied with pneumatic tyres.

| Order Code | WLL (kg) | Unit Weight (kg) | Wheel Type |
|-----------------|------------|------------------|------------------------|
| S1537122 | 200 | 76 | pneumatic tyres |

Features & Benefits:

- Fitted with locator chain and pin
- Versatile and mobile
- Use as a trolley
- Use as a lifting frame
- Use with a forklift or crane
- Complete with tool box
- Tested and certified to AS4991
- Powder coated finish
- Engraved I.D. tag welded on
- Trolley to suit G size bottles

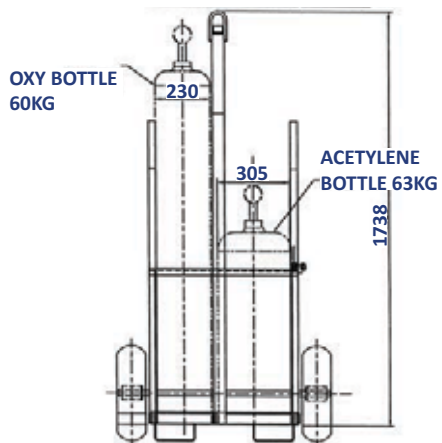
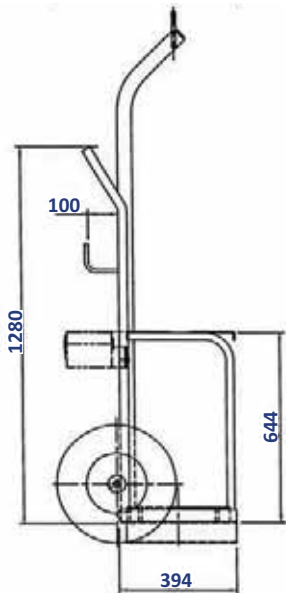

OXY & ACETYLENE APPLICATIONS

200 Kilogram 2 x Bottle Trolley G Size - Solid Wheels

- Fits one Oxygen bottle with either one of the following bottles: Acetylene, Propane or LPG

| Order Code | WLL (kg) | Unit Weight (kg) | Wheel Type |
|-----------------|------------|------------------|---------------------|
| S1537124 | 200 | 76 | solid wheels |



Features & Benefits:

- Fitted with locator chain and pin
- Versatile and mobile
- Use as a trolley
- Use as a lifting frame
- Use with a forklift or crane
- Complete with tool box
- Tested and certified to AS4991
- Powder coated finish
- Engraved I.D. tag welded on
- Trolley to suit G size bottles

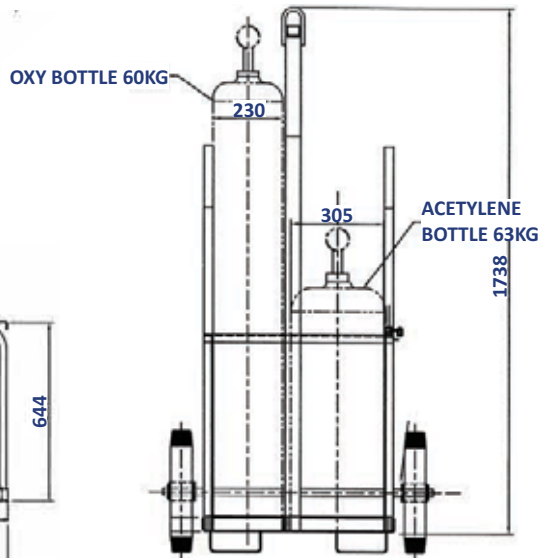
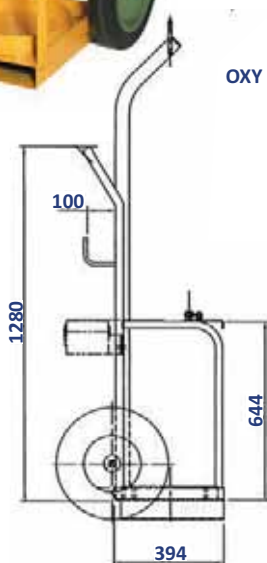

OXY & ACETYLENE APPLICATIONS

200 Kilogram 2 x Bottle Lifting Frame

- Fits one Oxygen bottle with either one of the following bottles: Acetylene, Propane or LPG

| Order Code | WLL (kg) | Height A (mm) | Width B (mm) | Length C (mm) | Unit Weight (kg) |
|-----------------|------------|---------------|--------------|---------------|------------------|
| S1537121 | 200 | 1890 | 400 | 645 | 35 |



Features & Benefits:

- Easy fitting of gas bottles
- Fitted with safety chains
- Safe and easy to use
- Tested and certified to AS4991
- Powder coated safety yellow
- Clearly marked with WLL

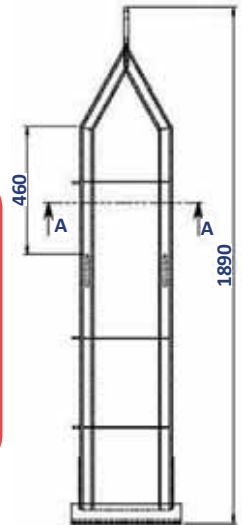

ACET. CHAIN
35 LINKS

OXY. CHAIN
32 LINKS

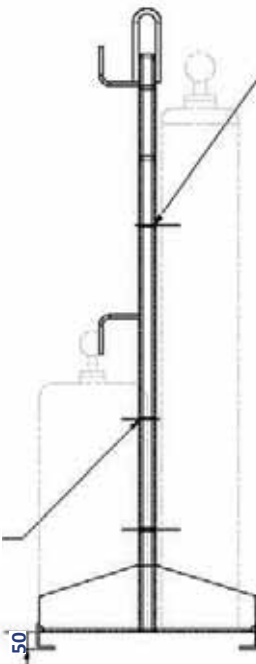

OXY & ACETYLENE APPLICATIONS

400 Kilogram 4 x Bottle Lifting Frame

- Fits two Oxygen bottles with a combination of either two Acetylene, Propane or LPG bottles
- Use as a lifting frame or with a forklift.

| Order Code | WLL (kg) | Height A (mm) | Width B (mm) | Length C (mm) | Unit Weight (kg) |
|------------------|------------|---------------|--------------|---------------|------------------|
| S1537121A | 400 | 1860 | 623 | 730 | 61 |



Features & Benefits:

- Easy fitting of 4 gas bottles
- Use as a lifting frame or with a forklift
- Fitted with locking pins & chains
- Safe and easy to use
- Tested and certified to AS4991
- Powder coated safety yellow
- Clearly marked with WLL

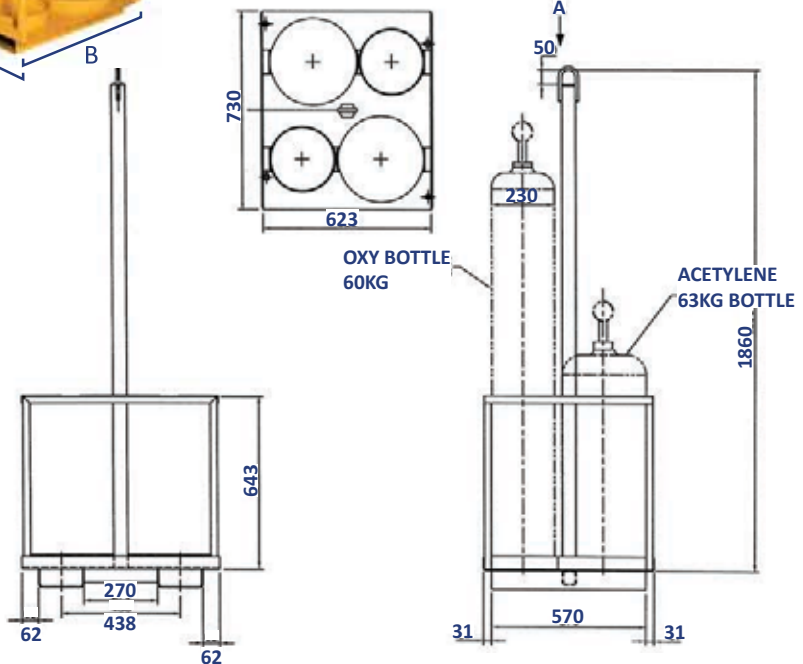

Goods Cages

Bullivants' range of Goods Cages have been designed to offer a wide range of options including various capacities and configurations without compromising on quality and value. Our goods cages provide the safest solution to the transportation and storage of loose loads and can be lifted by forklift or by sling.

Our Goods Cages are:

- A safe and secure method for Transporting and storing loose loads
- Fully Certified
- Tested
- Clearly marked with an identification plate
- Manufactured from Australian steel
- Powder Coated

And Come Complete With:

- 4 lifting points for optimum stability
- Drop sides or swinging gates (some models)
- Forklift Pockets (except on the Pallet Lifting Cage)

Lifting & Rigging Equipment

We can supply fully tested chain slings and hardware with your fabricated lifting product as a complete unit so that everything is ready to go when it gets to site.

Be sure to ask our trained staff about this option when you request your quote.

WARNING!

- Before use a competent person shall check all lifting and structural components of the goods cage
- Before use a competent person shall check all lifting equipment to be used with the goods cage
- Always know the weight of the load to be lifted
- Ensure that the load is even before lifting the cage
- Always ensure that the drop side or swinging gate are closed securely before lifting the cage
- Ensure that the contents of the cage cannot fall out. Wrapping the contents of the cage may be necessary to ensure the security of the load

GOODS CAGES

500 Kilogram Goods Cage

| Order Code | WLL (tonnes) | Height (mm) | Width (mm) | Length (mm) | Unit Weight (kg) |
|-------------------|--------------|-------------|------------|-------------|------------------|
| S1537005-2 | 0.5 | 500 | 500 | 500 | 45 |



Features & Benefits:

- Powder coated finish
- Tested and certified to as 4991-2004
- Top slings to suit, available in chain or wire rope
- Clearly marked with W.L.L.
- Engraved I.D. Tag fitted

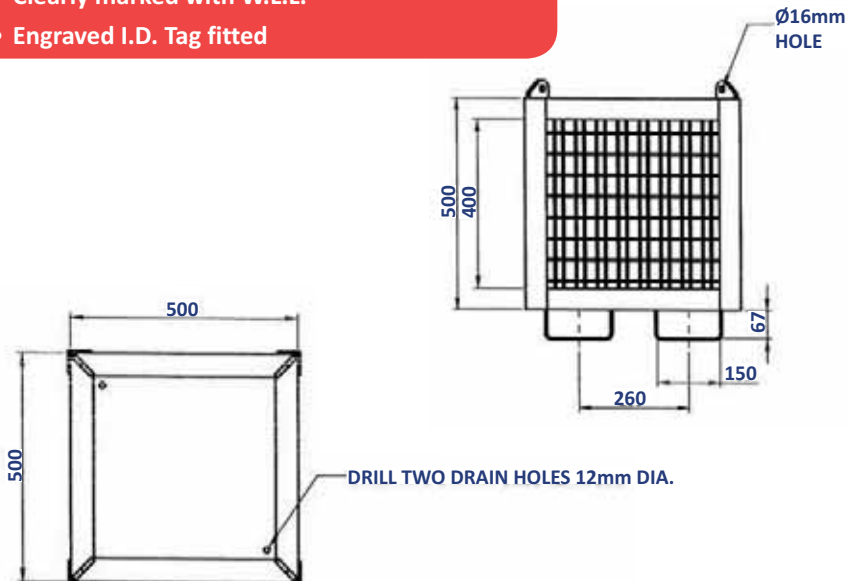

750 Kilogram Goods Cage

| Order Code | WLL (tonnes) | Height (mm) | Width (mm) | Length (mm) | Unit Weight (kg) |
|------------|--------------|-------------|------------|-------------|------------------|
| S1537005-4 | 0.75 | 750 | 760 | 760 | 73 |



Features & Benefits:

- Powder coated finish
- Tested and certified to as 4991-2004
- Top slings to suit, available in chain or wire rope
- Clearly marked with W.L.L.
- Engraved I.D. Tag fitted

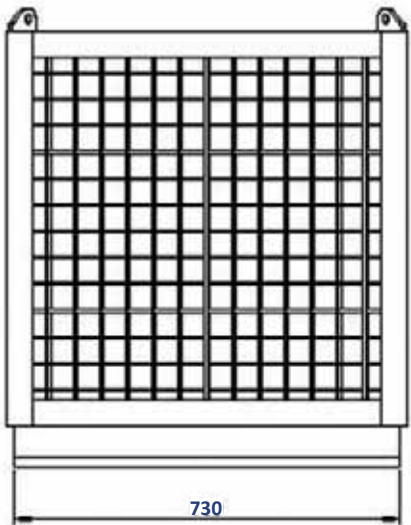
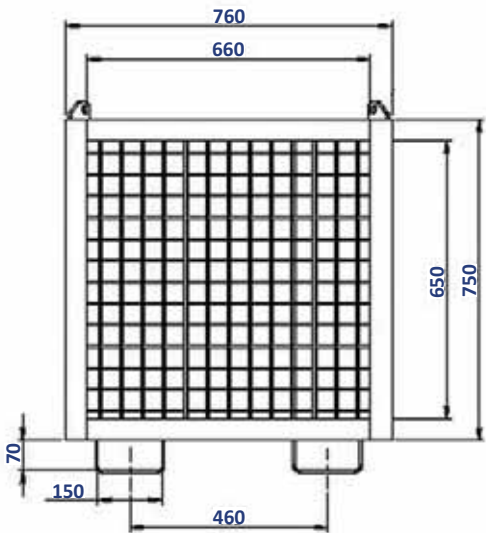

GOODS CAGES

750 Kilogram Goods Cage With Drop Side

| Order Code | WLL (tonnes) | Height (mm) | Width (mm) | Length (mm) | Unit Weight (kg) |
|------------|--------------|-------------|------------|-------------|------------------|
| S1537007-4 | 0.75 | 750 | 762 | 762 | 73 |



Features & Benefits:

- Powder coated finish
- Tested and certified to as 4991-2004
- Top slings to suit, available in chain or wire rope
- Clearly marked with W.L.L.
- Engraved I.D. Tag fitted

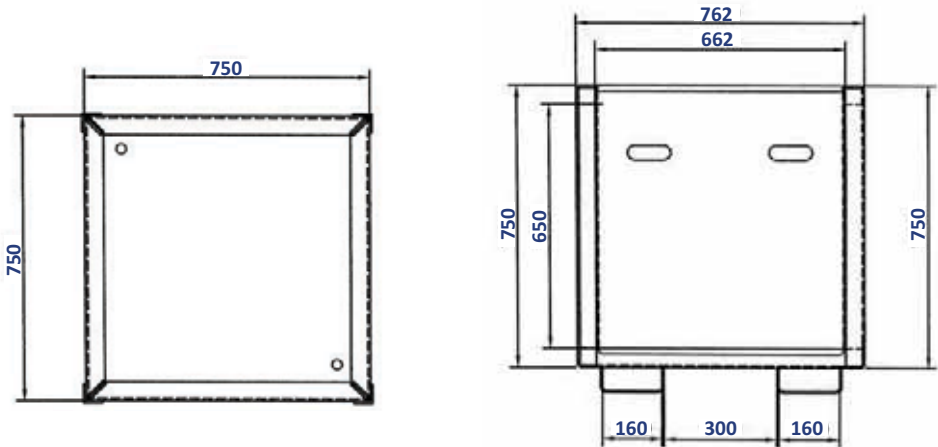

1 Tonne Goods Cage

| Order Code | WLL (tonnes) | Height (mm) | Width (mm) | Length (mm) | Unit Weight (kg) |
|------------|--------------|-------------|------------|-------------|------------------|
| S1537005-6 | 1 | 1000 | 1012 | 1012 | 126 |



Features & Benefits:

- Powder coated finish
- Tested and certified to as 4991-2004
- Top slings to suit, available in chain or wire rope
- Clearly marked with W.L.L.
- Engraved I.D. Tag fitted

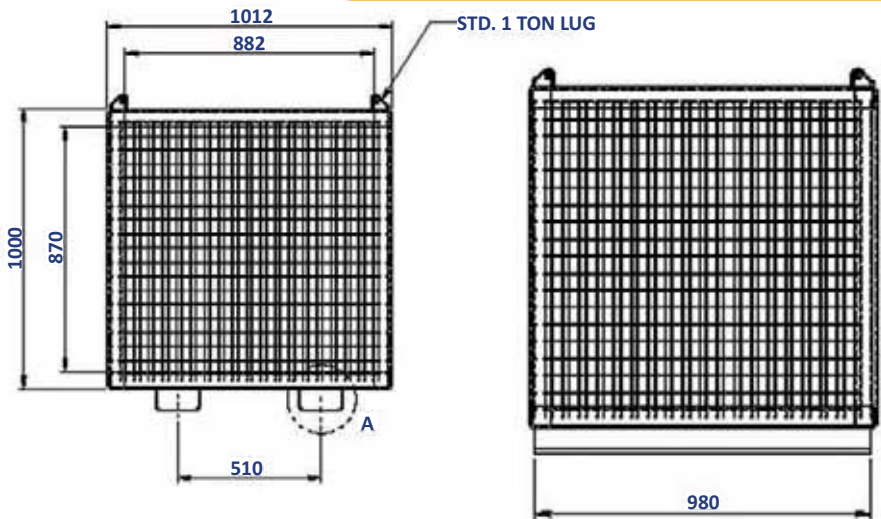

GOODS CAGES

1 Tonne Goods Cage With Drop Side

| Order Code | WLL tonnes) | Height (mm) | Width (mm) | Length (mm) | Unit Weight (kg) |
|-------------------|-------------|-------------|-------------|-------------|------------------|
| S1537007-6 | 1 | 1000 | 1000 | 1000 | 135 |



Features & Benefits:

- Powder coated finish
- Tested and certified to as 4991-2004
- Top slings to suit, available in chain or wire rope
- Clearly marked with W.L.L.
- Engraved I.D. Tag fitted

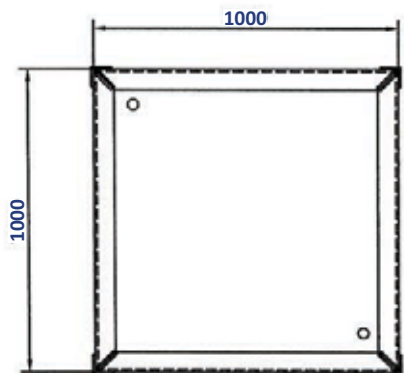
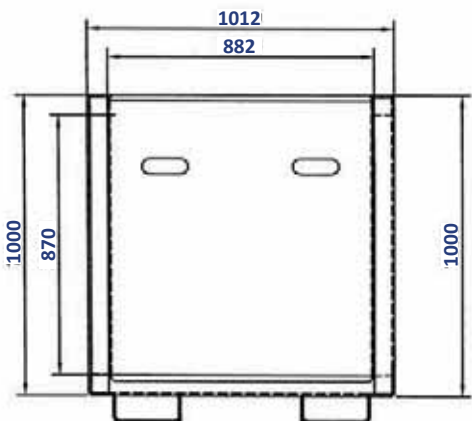

Pallet Lifting Cage

| Order Code | WLL (tonnes) | Height (mm) | Width (mm) | Length (mm) | Unit Weight (kg) |
|-----------------|--------------|-------------|-------------|-------------|------------------|
| S1537009 | 1 | 1250 | 1370 | 1370 | 160 |

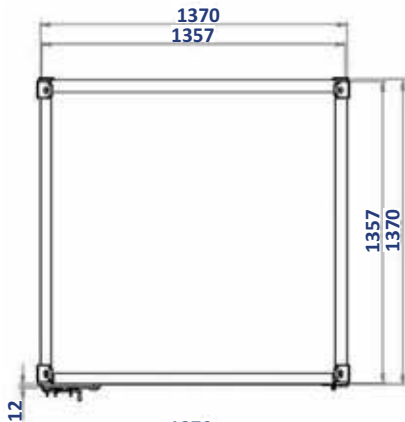

Features & Benefits:

- Powder coated finish
- Tested and certified to as 4991-2004
- Top slings to suit, available in chain or wire rope
- Clearly marked with W.L.L.
- Engraved I.D. tag fitted

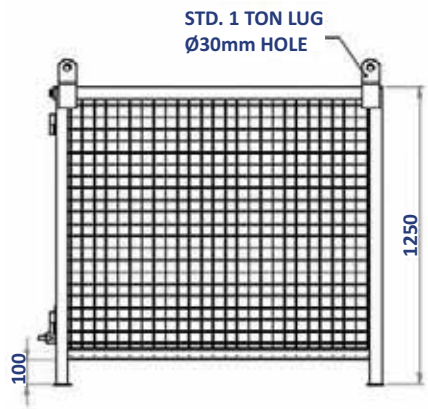
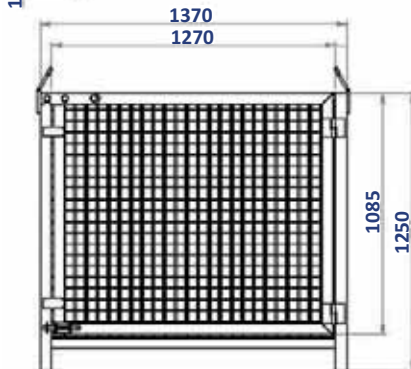

Our Engineering Solutions

Bullivants are long established and experienced in providing engineered lifting solutions to our customers. Whilst our standard range is broad there are often occasions when a specialised lifting application is required. To provide a first class service to our customers we employ design engineers to enable us to meet the demands of the market. Having this resource within our business allows us to respond quickly and efficiently to enquiries and provide a complete solution in assessment, design, manufacture, testing, certification, supply and ongoing inspections using our BEAM electronic gear register management system.

Our in house capability also allows us to incorporate reverse engineering into our standard offer.

Some of our custom designed lifting solutions can be seen on the following pages.

12 Tonne WLL Beam

This is a 12 Tonne WLL, 3 x 14 Meter, 3 section modular type beam. The beam can be disassembled into three sub assemblies, the middle beam and the two end beams, which allow for easy transport. This beam was manufactured and tested in Perth. The beam was fitted with three rail clamps at the bottom, three lifting points and was transported to Karratha and is being used as a rail line lifting beam.



23 Tonne WLL Multi-Hole Beam

This is a 23 tonne WLL x 10.45 Meter Multi-Hole Lifting Beam. It has two lifting points on top and multi-hole bottom load points. This beam was manufactured and tested in Perth and supplied to Cemex. The beam is lifted by a rubber tyred gantry and is used to lift different lengths and sizes of reinforced concrete pipes.



71 Tonne WLL Tank Lifting Beam

This is a 71 tonne Tank Lifting Beam. Bullivants were commissioned by the Department of Defence to come up with a solution to lift the Australian M1A1 Abram Army Tank. At first the solution seemed to be a straight forward Lifting Beam with 4 bottom load points. The challenge became more complicated as the Army required a beam that could hold 71 tonnes WLL, that was easy to use, and able to fit into a 20 foot vehicle for storage purposes with a maximum tare weight that was below 6 tonnes. This specification was sent to our Design Engineers and they came up with a successful solution which when demonstrated to the Defence engineering personnel was described as “brilliant”. This became the first of four Tank Lifting Beams which Bullivants have subsequently supplied to the Australian Army.



200 Tonne WLL Pipe Lifting Clamp

This is a 200 tonne WLL Pipe Lifting Clamp Test Jig. The Pipe Clamp is a customer supplied product which needs to be tested as per AS4991-2004. Bullivants designed and manufactured the test jig. Attached is a photo of the actual testing set-up taken whilst the pipe clamp was tested to 252 tonnes using the specially designed test jig. The Pipe Clamp was given a certification and Working Load Limit of 200 tonnes and is now being used to lift sections of pipe in an oil drilling operation.

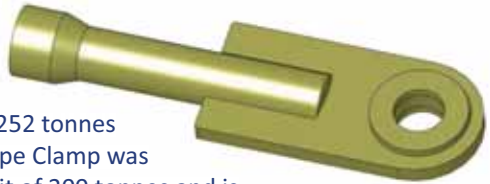

500kg WLL Goods Cage

This is a 500kg WLL goods cage that was specially designed for a customer who owns and operates a tavern/bottle shop. The cage has four top lifting points and castors like standard goods cages and lever activated bottom slide supports, which is a custom feature. The basic function of the cage is when it is lifted from the ground floor to the 2nd level through a square hole, the slide supports are activated so that it sits in the hole's edges holding the cage in place.

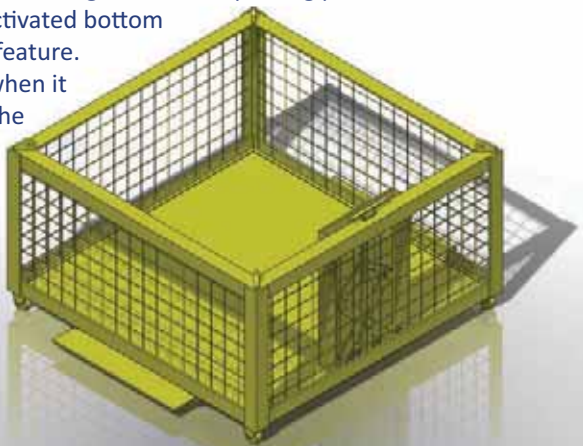

Dual Feed Coal Hopper

This is a dual feed coal hopper designed for BHP. It has two discharge feed mechanisms activated manually by handles. A critical part of this job was the design of the gear on the discharge feed mechanism. Provision for a center bar lifting point and fork pockets were added for easy lifting and handling.



3T Concrete Pipe Lifting C-Hook & 8T Forklift Boom

The first item shown below is a 3 tonne WLL Concrete Pipe Lifting C-Hook. This was designed to be attached to an overhead crane and used to lift reinforced concrete pipe products. We have also designed, manufactured, tested and supplied a 12 tonne WLL C-Hook of a similar set-up and use.

The second item shown below is an 8 tonne WLL Forklift Boom - forklift attachment. It was designed, manufactured, tested and supplied to a customer in Perth and is now being used as a primary lifting device for handling concrete pipe products.



Technical Support

Bullivants is recognised as the most technically capable and skilled supply partner in the areas of wire rope, rigging, lifting and specialist safety equipment. We have an unmatched depth of experience, engineering capability and logistics expertise to support our industry leading distribution network.

We employ dedicated customer service representatives, technical service representatives and site facilitators who have extensive knowledge, understanding and training in customer operations, procedures and safety standards, to ensure that customers receive the highest quality products, delivery and service at all times.



Bullivants Electronic Asset Management – BEAM

This is a system designed to provide maximum operational efficiency when dealing with our customers Visual Inspections and Lifting Gear Registers. It brings asset management into the 21st century and offers many benefits:

- Improved traceability of valuable assets
- 24 hour/7 day access to registers via a secure web portal
- Significantly improved time in the production of registers
- Removal of potentially dangerous errors which can occur when handwriting registers
- Highlighting of due or overdue registers in the online scheduler
- The removal of condemned assets is quicker resulting in faster replacement response ensuring compliance is maintained at all times
- Opportunity for your register to contain images of your assets for easy identification



Using the new BEAM technology we can provide a complete visual inspection service to the relevant Australian Standards requirements of all lifting, rigging and fall protection assets.

| BRANCH | ADDRESS | PHONE | FAX |
|--------------------|--|--------------------|--------------------|
| NEW SOUTH WALES | | | |
| Muswellbrook | 12 Enterprise Crescent, Muswellbrook NSW 2333 | Ph: (02) 6544 9000 | Fx: (02) 6542 5799 |
| Newcastle | 32 Parker Street, Carrington NSW 2294 | Ph: (02) 4969 4755 | Fx: (02) 4962 1468 |
| Sydney | 10-14 Kellogg Road, Glendenning NSW 2761 | Ph: (02) 9208 3600 | Fx: (02) 9625 3355 |
| Wollongong | 5 Investigator Drive, Unanderra NSW 2526 | Ph: (02) 4272 1455 | Fx: (02) 4272 1430 |
| NORTHERN TERRITORY | | | |
| Darwin | 2 Cato Street, Winnellie NT 0820 | Ph: (08) 8984 3299 | Fx: (08) 8984 4946 |
| QUEENSLAND | | | |
| Brisbane | 81 Colebard Street West, Acacia Ridge QLD 4110 | Ph: (07) 3277 9855 | Fx: (07) 3277 2182 |
| Cairns | 86-88 Aumuller Street, Cairns QLD 4870 | Ph: (07) 4035 4777 | Fx: (07) 4035 4784 |
| Emerald | Cnr of Cameron Road & Munro Road, Emerald QLD 4720 | Ph: (07) 4980 0900 | Fx: (07) 4987 5627 |
| Gladstone | 19 Beckinsale Street, Gladstone QLD 4680 | Ph: (07) 4972 9449 | Fx: (07) 4972 7881 |
| Mackay | 43-51 Diesel Drive, Paget QLD 4740 | Ph: (07) 4841 9600 | Fx: (07) 4952 2792 |
| Mt Isa | 1/16 Enterprise Road, Mount Isa QLD 4825 | Ph: (07) 4743 2849 | Fx: (07) 4743 2876 |
| Toowoomba | 335 Taylor Street, Toowoomba, QLD 4350 | Ph: (07) 4634 9155 | Fx: (07) 4634 2977 |
| Townsville | 2 Leyland Street, Garbutt QLD 4814 | Ph: (07) 4781 9400 | Fx: (07) 4775 2668 |
| SOUTH AUSTRALIA | | | |
| Adelaide | 1/334 Cormack Rd, Wingfield SA 5013 | Ph: (08) 8260 4711 | Fx: (08) 8260 5610 |
| Roxby Downs | 3 Gosse Street, Roxby Downs SA 5725 | Ph: (08) 8671 3255 | Fx: (08) 8671 3288 |
| VICTORIA | | | |
| Melbourne | 114 - 116 Boundary Road, Braeside VIC 3195 | Ph: (03) 9585 1288 | Fx: (03) 9585 8948 |
| WESTERN AUSTRALIA | | | |
| Bunbury | 5 Halifax Drive, Bunbury WA 6230 | Ph: (08) 9725 6380 | Fx: (08) 9725 6371 |
| Kalgoorlie | Unit 6/46 Great Eastern Highway, West Kalgoorlie WA 6430 | Ph: (08) 9022 0200 | Fx: (08) 9021 5760 |
| Karratha | Lot 120 Mooligunn Road, Karratha WA 6714 | Ph: (08) 9187 8200 | Fx: (08) 9185 6377 |
| Newman | 34 Shovelanna Street, Newman WA 6753 | Ph: (08) 9175 9000 | Fx: (08) 9175 5905 |
| Perth | 2-10 Kewdale Road, Welshpool WA 6106 | Ph: (08) 9451 8133 | Fx: (08) 9351 8073 |
| Port Hedland | 4 Manganese Street, Wedgefield WA 6721 | Ph: (08) 9160 2500 | Fx: (08) 9172 3635 |

1300 722 999
www.bullivants.com