

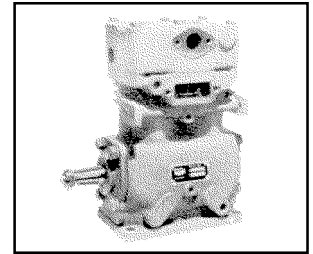

COMPRESSORS AND PARTS



REMANUFACTURED EXCHANGE COMPRESSORS



FLANGES	ENGINES	TU-FLO 500	TU-FLO 501	TU-FLO 700	TU-FLO 1400	TU-FLO 550	TU-FLO 750
	Caterpillar 3406	285131	286546	289349	-	-	-
	Caterpillar 3406B	-	103274	103278	104583	107509	107508
	Caterpillar 3408	284310	286552	289744	-	-	-
	Mack 6 Cylinder See Bulletin PRO-01-7 for Mack c/o Caterpillar 3116	284662	286544 102697*	289340	104584	107511	107510
	Mack 8 Cylinder	-	-	-	-	107981	-
		-	-	-	-	-	-
	Cummins NH, NTC, KT, KTA Series engines See Bulletin PRO-01-2	284718* 286554	286618* 286554	289339		107506	107507
	Cummins VTB-903	-	-	-			
	Cummins VT-903 Cummins VT-350 See Bulletin PRO-01-2	-	286570 286570	101590 101590			
	Series 60 Detroit Diesel 0° Tilt		286619(1)	106780(1)		107622(1)	107623(1)
	Detroit Diesel 0° Tilt	276962	286539	289941	108779	107513	107512
	Detroit Diesel 0° Tilt	285252	-	101158		-	-

(1) Series 60 compressors must be replaced with series 60 compressors only. Failure to do so will result in compressor damage.

* Top discharge cylinder head

** TU FLO-700 cylinder head incorporates both side and top discharge.

Note: Part numbers for all remanufactured parts in the New Life inventory have an "X" suffix to indicate a remanufactured part. The "X" has been left off all above numbers for clarity.

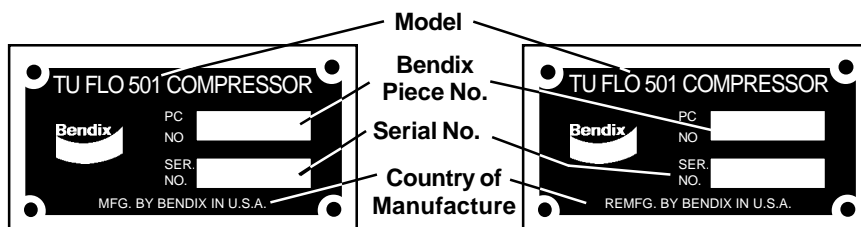



COMPRESSORS AND PARTS

REMANUFACTURED HALDEX COMPRESSORS

HALDEX BASE MOUNT, PULLEY DRIVE

ITEM	PART No.	CORE GROUP	TYPE	CATEGORY	COOLING	PORT LOC	DISCHARGE	NOTES
1	KN7010X	700	EL740	4 HOLE BASE	AC	RIGHT/RIGHT	FLANGE	BASE OIL OPTION
1	KN7020X	700	EL740	4 HOLE BASE	AC	LEFT/LEFT	FLANGE	BASE OIL OPTION
2	KN85020X	850	EL850	4 HOLE BASE	AC	RIGHT/TOP	THREADED	
2	KN86020X	850	EL850	4 HOLE BASE	WC/AC	RIGHT/TOP	THREADED	
3	EL13020X	1301	EL1300	4 HOLE BASE	WC	RIGHT/RIGHT	FLANGE	
3	EL13021X	1301	EL1300	4 HOLE BASE	WC	LEFT/LEFT	FLANGE	
3	EL13060X	1301	EL1300	4 HOLE BASE	WC	RIGHT/RIGHT	FLANGE	BASE OIL FEED

HALDEX FLANGE MOUNT - ENGINE DRIVE

CUMMINS APPLICATIONS, WATER COOLED

	PART No.	CORE GROUP	TYPE	CATEGORY	COOLING	PORT LOC	DISCHARGE	NOTES
4	EL13040X	1300	EL1300	CUM IN LINE	WC		RIGHT/RIGHT	TOP/FLANGE
4	EL16040X	1600	EL1300	CUM IN LINE	WC		RIGHT/RIGHT	TOP/FLANGE

DETROIT DIESEL APPLICATIONS, WATER COOLED

	PART No.	CORE GROUP	TYPE	CATEGORY	COOLING	PORT LOC	DISCHARGE	NOTES
5	EL13050X	1300	EL1300	DDC 0° TILT	WC	RIGHT/RIGHT	FLANGE	
5	EL13051X	1300	EL1300	DDC 0° TILT	WC	RIGHT/LEFT	FLANGE	60 SERIES NON-THRU DRIVE
5	EL13070X	1300	EL1300	DDC 1° TILT	WC	RIGHT/LEFT	FLANGE	
6	EL13053X	1353	EL1300	DDC 0° TILT	WC	RIGHT/LEFT	FLANGE	60 SERIES THRU DRIVE

1

KN7010X
KN7020X

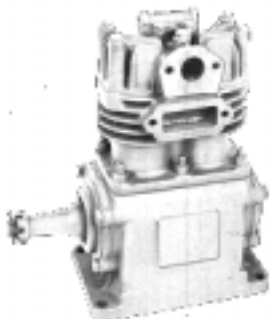

Haldex Repair Kits

RN33C EL740 Unloader Kit
RN26GV Gasket Kit
SN144AB Installation Kit

2

KN85020X
KN86020X

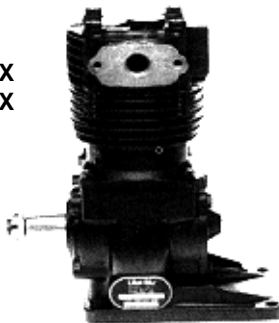

Haldex Repair Kits

RNT26JB EL850 Unloader Kit
RN26JH EL 850 Gasket Kit
SN144R Installation Kit

3

EL13020X
EL13021X
EL13060X

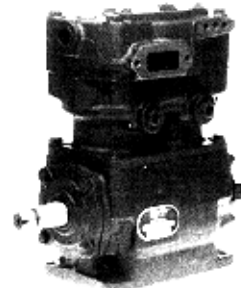

Haldex Repair Kits

RN26A EL1300 Unloader Kit
RN26GW EL1300 Gasket Kit
SN144 Installation Kit for EL13020X & EL13021X
SN144D Installation Kit for EL13060

4

EL13040X
EL16040X



Haldex Service Repair Kits

RNT26A EL1300, EL1600 Unloader Kit
RN26GX EL1300, EL1600 Gasket Kit
SN144B Installation Kit

5

EL13050X
EL13051X
EL13070X

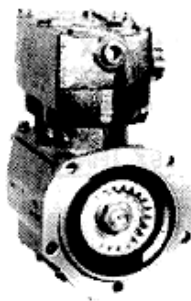

Haldex Repair Kits

RNT26A EL1300 Unloader Kit
RN26GY EL1300 Gasket Kit
SN144C Installation Kit for EL13050X
SN144AP Installation Kit for EL13051X
SN144E Installation Kit for EL13070X

6

EL13053X

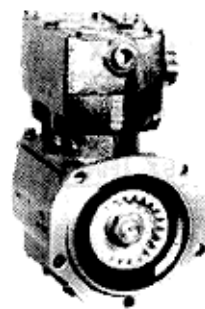

Haldex Repair Kits

RNT26A EL1300 Unloader Kit
RN26GY EL 1300 Gasket Kit
SN144BD Installation Kit



COMPRESSORS AND PARTS

REMANUFACTURED HALDEX COMPRESSORS

HALDEX FLANGE MOUNT - ENGINE DRIVE

DETROIT DIESEL APPLICATIONS - WATER COOLED

ITEM	PART No.	CORE GROUP	TYPE	CATEGORY	COOLING	PORT LOC	DISCHARGE	NOTES
7	EL13090X	1300	EL1300	DDC 41° TILT	WC	RIGHT/RIGHT	FLANGE	
7	EL13100X	1300	EL1300	DDC 50° TILT	WC	RIGHT/RIGHT	FLANGE	
7	EL13160X	1300	EL1300	DDC 45° TILT	WC	LEFT/RIGHT	FLANGE	
8	EL16050X	1600	EL1600	DDC 0° TILT	WC	RIGHT/RIGHT	FLANGE	
8	EL16051X	1600	EL1600	DDC 0° TILT	WC	RIGHT/LEFT	FLANGE	60 SERIES NON-THRU DRIVE
8	EL16070X	1600	EL1600	DDC 1° TILT	WC	RIGHT/LEFT	FLANGE	
8	EL16072X	1600	EL1600	DDC 4° TILT	WC	RIGHT/LEFT	FLANGE	

MACK APPLICATIONS

9	EL16111X	1600	EL1600	MACK EXT. FLG.	WC	LEFT/LEFT	FLANGE	POWER STEERING
9	EL16112X	1600	EL1600	MACK EXT. FLG.	WC	LEFT/LEFT	FLANGE	GEAR INCLUDED

7
EL13090X
EL13100X
EL13160X



8
EL16050X
EL16051X
EL16070X
EL16072X



9
EL16111X
EL16112X

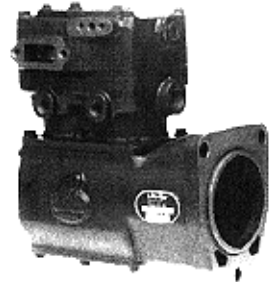

Haldex Repair Kits

RNT26A EL1300 Unloader Kit
RN26GY EL 1300 Gasket Kit
SN144G Installation Kit For EL13090X
SN144H Installation Kit For EL13100X
SN144M Installation Kit For EL13160X

Haldex Repair Kits

RNT26A EL1600 Unloader Kit
RN26GY EL 1600 Gasket Kit
SN144AP Installation Kit For EL16051X
SN144C Installation Kit For EL16050X
SN144E & Installation Kit For EL13170X
SN3711G (Need one of each)
SN144E Installation Kit For EL16072X

HaldexHaldex Repair Kits

RNT26A EL1600 Unloader Kit
RN26GZ EL 1600 Gasket Kit
SN144J Installation Kit

AIR CLEANER

For use with all compressor types. Provides greater atmospheric air intake capacity. Suitable for mounting on **Haldex** and competitive model compressors. May also be remote mounted by using accessory intake manifold connector kits SN3711AC and SN3711AD plus cut to length 3/4" ID hose with fittings and clamps. Includes 100696E element.

Mounting Centers: 2.75"
Overall Height: 4.44"
Diameter: 4.30"

Part No. KN19040

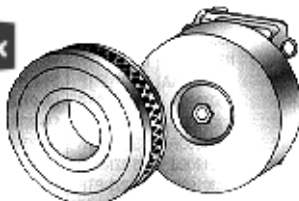

COMPRESSOR MANIFOLD KIT (INTAKE)

For 1/2" Pipe
Mounting Centers: 2.75"
Part No. SN3711AA



COMPRESSOR MANIFOLD KIT (INTAKE)

For 3/4" Hose
Mounting Centers: 2.75"
Part No. SN3711AD



INLET CHECK VALVE Part No. SN3711AJ



COMPRESSOR MANIFOLD KIT (DISCHARGE)

For 1/2" Pipe
For all EL1300 & EL1600
Compressors
Part No. SN3711J

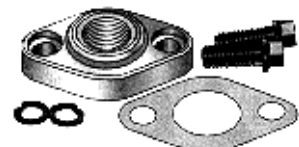



COMPRESSORS AND PARTS

UNLOADER KIT

Kit contains parts to install 3 piece unloader plungers in Tu-Flo compressors

Part No. 279615

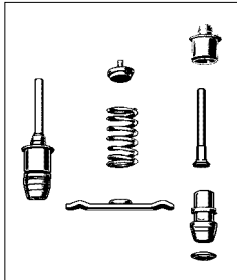

AIR STRAINER

For TF-400, 500, 501, 600, and 700

Bendix compressors

Air Strainer Part No. 278500

Contents:

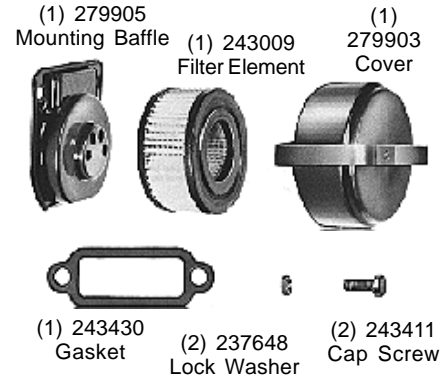

AIR DRYERS

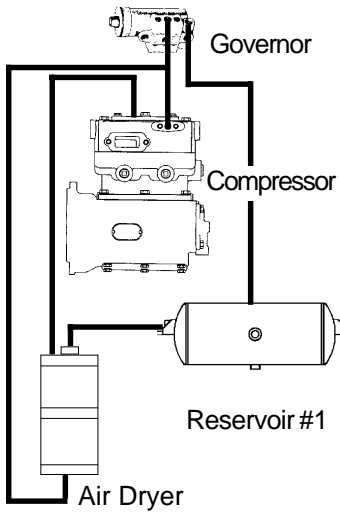

The primary duty of the air dryer

is to eliminate the moisture and dirt that would cause damage to valves and other system components.

The air dryer removes these pollutants, providing dry air, free of contaminants that can cause premature failure of the air and brake system.

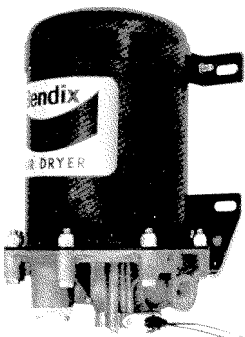
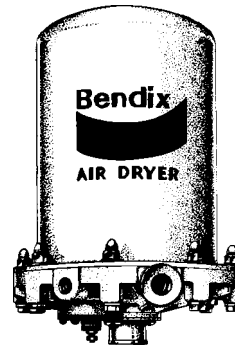

Bendix AD-9 Air Dryer 12 Volt

Description	PART No.
Complete New Unit	065225
Complete REMANUF. Unit	109685X
END COVER INFORMATION	
New Unit: (Special Order)	065231
Supply Port:	1/2" P. T.
Delivery Port:	1/2" P. T.
Control Port:	1/4" P. T.
Check Valve Ass'y	107800
Purge Valve & Heater Ass'y (REMANUF.)	5004341X
Remanuf. Desiccant Cartridge	107794X
Purge Valve Ass'y - Maint. Kit	5005037
Bracket Kit	107695

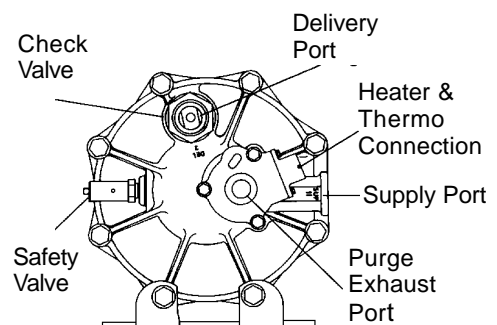

**End Cover Bottom View
AD-9 Air Dryer**



AIR DRYERS

AD-9 Air Dryer Parts List Kits and Service Replacement Assemblies

List #	Description	Part Number	
2	Remanuf. Purge Valve Ass'y Comp w/Heater. See List #2	12V 5004341X	24V 5004342X
3	New Replacement Purge Valve Ass'y Complete w/Heater (DLU) See List #3 Below	12V 800405	24V 5004342
4	Desiccant Cartridge Kit See List #4 Below	New 107796	Remanuf. 107794X
5	Purge Valve Maintenance Kit See List #5 Below	5005037 hard seat	5005893 soft seat
6	Heater & Thermostat Kit See List #6 Below	12V 109578	24V 109579
7	Check Valve Maintenance Kit See List #7 Below	3/4" 107799	1/2" 107800
8	Mounting Bracket Kit See List #8 Below	107695	

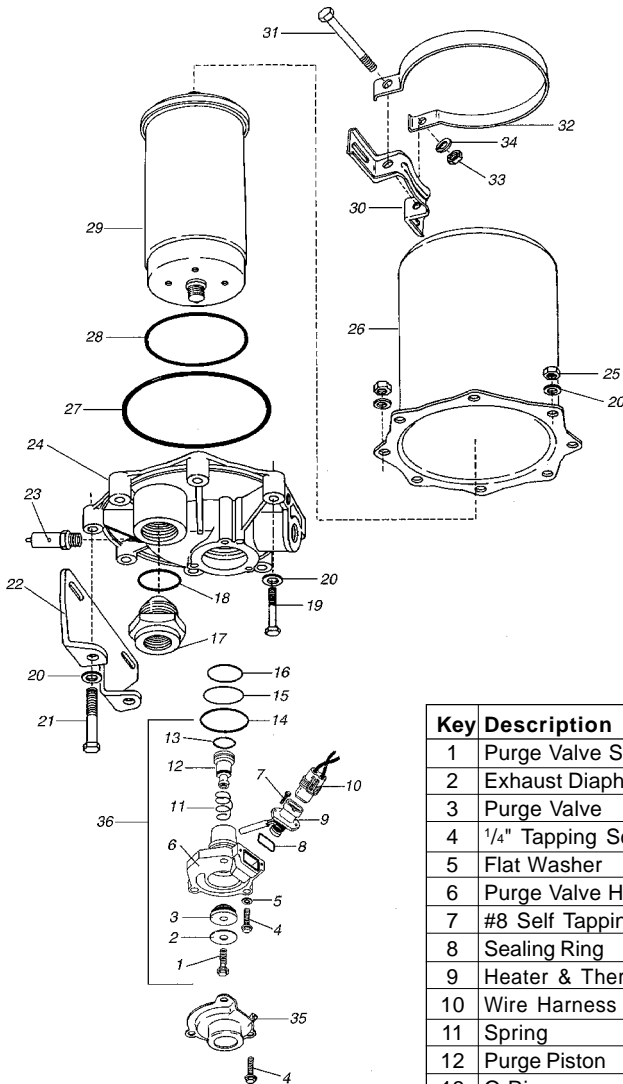

Note:

Old and new purge valve assemblies are interchangeable in all AD-9 air dryers.



**ARE YOU READY FOR COLD
WEATHER?**

Check your stock of air dryer parts BEFORE the season demands are here!

Key	Description	List 1	List 2	List 3	List 4	List 5	List 6	List 7	List 8
1	Purge Valve Shoulder Bolt					X			
2	Exhaust Diaphragm					X			
3	Purge Valve					X			
4	1/4" Tapping Screw	X-3	X-3	X-3					
5	Flat Washer	X-3	X-3	X-3					
6	Purge Valve Housing								
7	#8 Self Tapping Screw						X-2		
8	Sealing Ring						X		
9	Heater & Thermostat Ass'y						X		
10	Wire Harness & Connector				109869				
11	Spring					X			
12	Purge Piston								
13	O-Ring					X			
14	O-Ring	X	X	X		X	X		
15	O-Ring	X	X			X	X		
16	O-Ring	X	X	X		X	X		
17	Check Valve Ass'y							X	
18	Check Valve O-Ring							X	
19	3/8" X 2 1/8" End Cover Screw								
20	3/8" Special Washer								X-4
21	3/8" X 2 1/8" Bracket Screw								X-2
22	Lower Mounting Bracket								X
23	Safety Valve				285849				
24	End Cover								
25	Lock Nut								X-2
26	Housing								
27	O-Ring 298922				X				
28	O-Ring 298927				X				
29	Desiccant Cartridge Ass'y				X				
30	Upper Mounting Brkt.								X
31	5/16" x 4 1/2" Upper Brkt. Bolt								X
32	Upper Brkt. Strap								X
33	5/16" Nut								X
34	5/16" Lock Washer								X
35	Exhaust Cover				112399				
36	Complete Purge Valve Ass'y	X	X	X					



AIR DRYERS

BENDIX REPAIR KITS AD-2 AIR DRYER

102657	Thermostat Kit Includes Thermostat, gasket and "O" ring.
287053	Purge Valve Replacement Kit Includes purge valve, diaphragm, boot and "O" rings
287298	Check Valve Kit

AD-2



BENDIX REPAIR KITS AD-4 AIR DRYER

103817	Major Maintenance Kit Includes desiccant cartridge, end cover kit 103980, and sealing ring.
103818	Purge Valve Replacement Kit Purge valve and exhaust diaphragm
103879	Seal kit Includes check valve ass'y, boot, and sealing rings
103980	End Cover Kit "O" ring and piston spring

AD-4

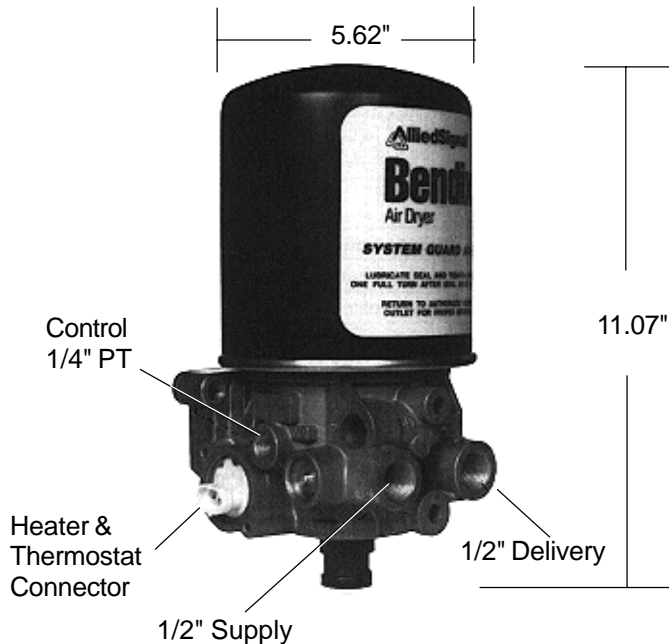
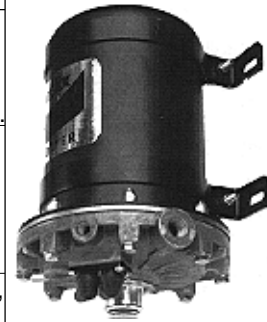

AD-SP Air Dryer System Purge

Service Part No.	Remanuf. Part No.	Heater & Thermostat Volts-Watts (See Note 2)
800887	109991X	12V - 980W
065594	109992X	24V - 90W

Note: 12 & 24 volt AD-SP air dryers are identified by connector color:
White - 12V, Gray = 24V.

AD-SP Air Dryer Kits

Part No.	
5008414	Cartridge Kit
Part No.	
5005624	Del Check Valve Kit

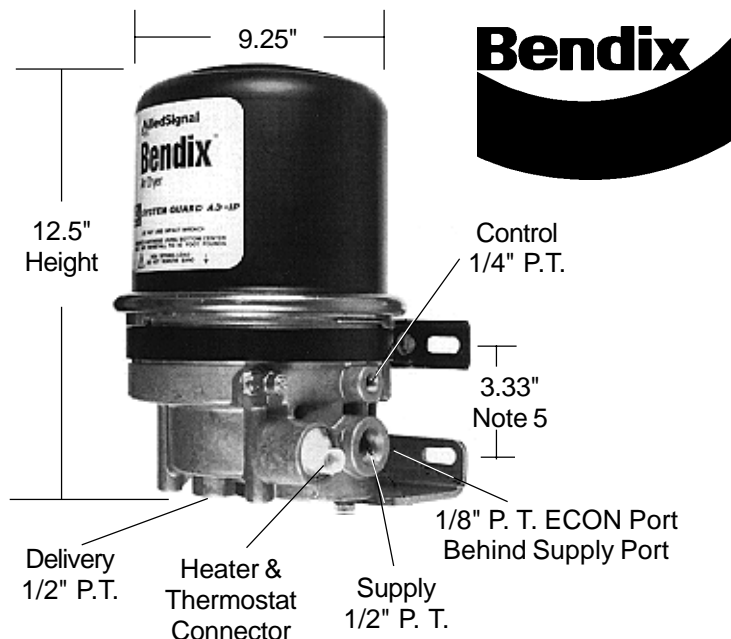

AD-IP Air Dryer Integral Purge

Service Part No.	Remanuf. Part No.	Heater & Thermostat Volts-Watts (See Note 2)
065612	109477X	12V - 90W
065613	109478X	24V - 90W

Note - All replacement air dryers include 109871 (wire harness and splice kit) and 5001247 (mounting bracket kit).

Note - 12 & 24 volt air dryers are identified by connector color.
White = 12V, Gray = 24V.

Note - Center to center of slots in both brackets is 5.64 inches.

AD-IP Air Dryer Kits

Part No.	Heater & Thermo Kit
109496	24 Volt
Part No.	Purge Valve Kit
5003547	12 volt



AIR DRYERS



PURest™ Air Dryer Part No. DA34100

- Multi-Treatment Cartridge employs 5 stages of cleaning to ensure dry system air.
- Universal mounting bracket eases retro-fit installations. Fits Pure Air Plus, Dryest, AD type and SS type air dryer bolt patterns.
- Integrated turbo protection.
- Built-In heater prevents freezing and damage to the dryer.

Heater: 12 Volt
 Desc: With Bracket, Left - Inlet Port
 OEM Part No: N4253AA

MTC Desiccant Cartridge
 Part No. DQ6050

Heater Kit 12 volt
 Part No. DQ6013



PURE AIR PLUS™ AIR DRYER Repair Kits

Major Repair Kit Includes purge, Turbo Saver™, & check valve. Part No. DQ6020	Desiccant Kit Includes desiccant cartridge & coalescing filter Part No. DQ6026	12V Heater kit Part No. DQ6011
		Coalescing filter kit Part No. DQ6032

Desiccant Cannister: Part No. DA33120

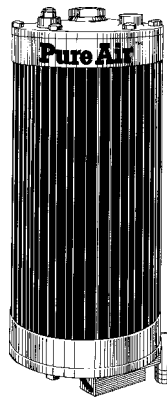

AIR DRYER PURE AIR™ Repair Kits

Triple action cools, filters and dries the air. May be mounted horizontally or vertically. Serviceable from either end.



Major Kit
 Part No. RN60A



Outlet
 Check Valve Kit
 Part No. RN60G



Minor Kit
 Part No. RN60



12V Lower
 Cover Ass'y
 Part No. RN60D



Purge Valve Kit
 Part No. RN60F

12V Heater Kit (Not Shown)
 Part No. RN60N

MERITOR WABCO

Dessicant Type Air Dryer Part No. R955205

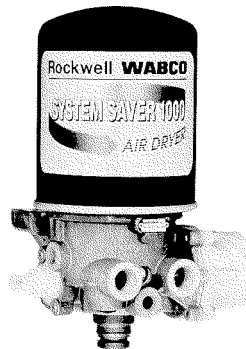

This air dryer from Meritor Wabco is just 11 inches tall! It has a spin-on cartridge that is replaceable in under 5 minutes. It has a 12V-100 Watt heater with an integral turbo cut-off valve and mounting bracket. The integral regeneration valve eliminates the need for a purge tank.

SERVICE KITS

Cartridge Kit Part No. R950011	Purge Valve Kit Part No. R950014	Outlet Check Valve Kit Part No. R950017
Turbo Cut-Off Valve Kit Part No. R950013	Heater Service Kit Part No. R950015	



ALCOHOL EVAPORATOR - ISOLATION VALVE - GOVERNOR

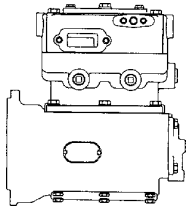

ISOLATION VALVE

(Turbo Cut-Off Valve)

Used with air driers not equipped with this feature. Allows use of air dryer on turbo charged engines without affecting engine performance. Installs directly (1/2"-14 NPTF) to air line inlet port of air dryer.

Part No. KN23500

Haldex



ALCOHOL EVAPORATOR

An automatic vaporizing device for keeping air lines and air reservoir free of ice.

- Easy to install
- Pressure protected
- Holds 40 oz. of methyl alcohol.
- 1/2" NPTF Ports

Part No. A72420



FLEETCRAFT GOVERNOR

Features ball check design with filtered ports. Can be mounted at a remote location or directly to compressor. Preset to open at 120 PSI, close at 100 PSI. Can be Adjusted. Includes 4 pipe plugs, mounting gasket and instructions.

New, outright.

Part No. FC18530

Haldex Micromax™ GOVERNOR

New, outright.

Part No. KN18537

1/3 the size of a standard governor. Fully interchangeable, complete installation kit, mistake proof exhaust port eliminates failures.

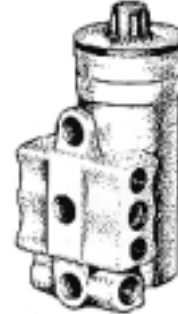

Bendix D-2 Governor

Remanufactured. No Core.

For mounting to the compressor or mounted remotely. Pressure range 100 - 120 PSI.

5" overall height.

1/8" NPT ports.

Sold outright.

Part No. OR275491X

Part No. 275491 (NEW)

PRESSURE RELIEF (SAFETY) VALVES



PRESSURE RELIEF VALVE

For air reservoir installations.

Made of brass and stainless steel.

Will not corrode.

Factory set at 150 PSI. 3/8" NPTF.

Part No. KN31250

Haldex

PRESSURE RELIEF VALVE

Brass body and stainless steel spring.

Factory set at 150 PSI. 1/4" NPTF

Part No. 1031200

ST-3 SAFETY VALVE

75PSI Pressure setting, 1/4" port

Part No. 285850

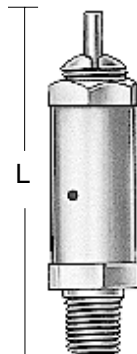

(A)
L=3.25"

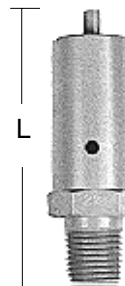

(B)
L=2.56"

SAFETY VALVE

Protects against excessive pressure in air system. Installs in the supply reservoir. Factory set at 150 PSI. Can be adjusted. Automatically closes after excess pressure is released to atmosphere. 1/4" NPT.

(A) Part No. 205105

(B) Part No. 284142

Bendix

PRESSURE PROTECTION VALVE (SAFETY) VALVES

PRESSURE PROTECTION VALVE TYPE PR-4

Closes at a preset pressure. Factory set at 85 PSI. Many different applications. Can be used to protect one reservoir system from another if a reservoir system failure occurs. Nonadjustable. 1/4" PT supply and delivery ports.

Part No. 286500



Safety Valve Kit ST-4

The ST-4 Safety Valve is installed in the extra compressor discharge port, if available, or the discharge line to prevent compressor damage in the event of discharge line blockage. Because of this a standard safety valve may not be used.

Part No. 131081



PRESSURE PROTECTION VALVE TYPE PR-2

Closes at a preset pressure. Factory set at 65 PSI. Can be adjusted. Many different applications. Can be used to protect one reservoir system from another if a reservoir system failure occurs. 1/4" PT supply and delivery ports.

Part No. 277147

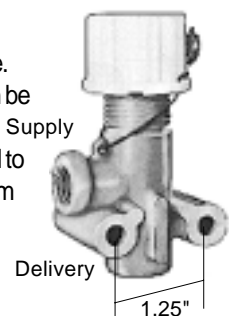



PRESSURE PROTECTION VALVES

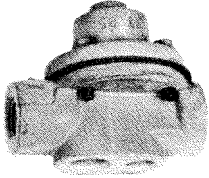

Haldex

PRESSURE PROTECTION VALVE

Used to protect air brake system from accessory failure.

Nonadjustable.

1/8" NPTF inlet port,

1/4" NPTF outlet port.

Part No.	Operating PSI	
	Open	Closed
KN31000	65	45
KN31010	95	75

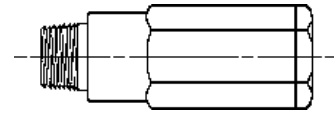

PRESSURE PROTECTION VALVE with one way check valve

Used to protect air brake system from accessory failure. Nonadjustable. 3/8" NPTF inlet port, 1/2" NPTF outlet port.

Part No.	Opening Pressure
KN31170	50PSI
KN31171	75 PSI

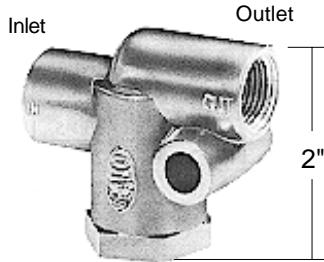

PRESSURE PROTECTION VALVE

3/8" NPTF Inlet,

3/8" NPTF Outlet

Part No.	Operating PSI	
	Open	Closed
110257	75	70
110258	95	90

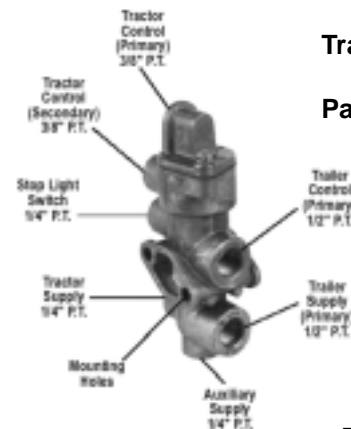

Tractor Protection Valve

Part No. 065706

Bendix



PRESSURE CONTROL VALVE

Pressure setting from 0 PSI to reservoir pressure.

1/4" NPTF inlet and outlet,

1/4" NPTF exhaust

Part No. 5400

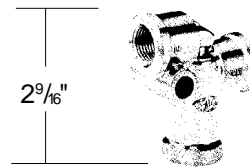

PRESSURE PROTECTION VALVE

3/8" NPTF Inlet and Outlet

Part No.	Operating PSI	
	Open	Closed
140270	70	60

CHECK VALVES

Bendix

SINGLE CHECK VALVE SC-2 Steel Seat

Part No.	A	B	C
800372	1/2" PT	1/2" PT	2.92"
800373	3/8" PT	3/8" PT	2 5/32"

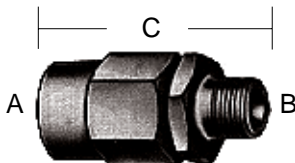

SINGLE CHECK VALVE SC-1 Steel Seat

Part No.	A	B	C
800375	1/4" PT	1/4" PT	2 3/32"

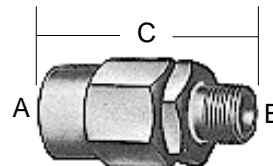

Haldex

SINGLE CHECK VALVE SC-2 Steel Seat

Part No.	TYPE	A	B	C
KN23000	A	1/2" PT	1/2" PT	2.46"
KN23010	A	3/8" PT	3/8" PT	2.47"
KN23060	B	1/2" PT	1/2" PT	1.85"



Type A

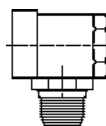

Type B
(90 Degree)

**AIR
SEALCO
CONTROLS**

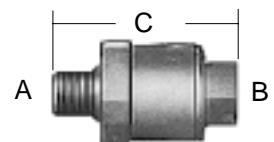

SINGLE CHECK VALVE SC-1 Rubber Seat

Part No.	A	B	C
10200-3/8	3/8" PT	3/8" PT	2 13/16"
10200-1/2	1/2" PT	1/2" PT	2 13/16"



CHECK VALVES

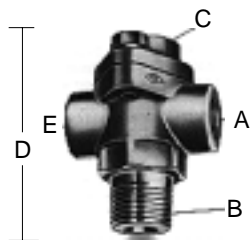

The double check valve is used when a single function or component must be controlled by either of two valves. The double check valve permits either, but not both control valves to operate the device connected to its outlet port.

DC-4 DOUBLE CHECK VALVE

Part No.	A	B	C	D	E
278595	1/4" PT	1/2" PT	1/4"	2.75"	1/4"
278598	3/8" PT	3/8" PT	1/4"	2.75"	3/8"

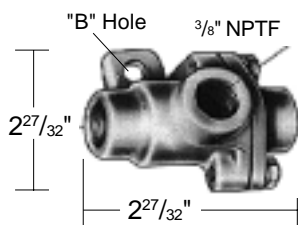

DC-4 DOUBLE CHECK VALVE

All Ports: 3/8" NPTF
"B" Hole: 1 1/32" Dia.
Part No. 278614

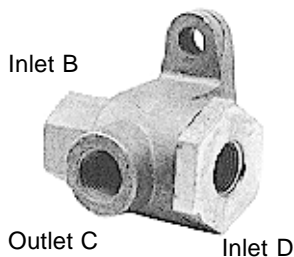

TWO WAY CHECK VALVE (Diaphragm Type)

Mount in any position
Use in place of ball or shuttle types
Used when two inputs must become one input.

Inlet B: 3/8"
Inlet D: 3/8"
Outlet C: 3/8"
Part No. KN25060

QUICK RELEASE VALVES

QUICK RELEASE VALVE

Aluminum Die Cast Body
Supply/Delivery Differential 0 PSI

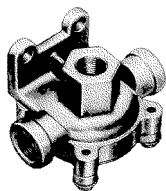

Part No.	Ports	
	Supp	Del
1032005	3/8"	3/8"
1032011	1/2"	3/8"



QRN QUICK RELEASE VALVE

Lightweight, nonmetallic.
Mounting holes 1 1/32" diameter
on 1 1/2" centers.

Part No.	A	B Supply	Supp/Delivery Differential Del. (PSI)
065066	1/2" PT	3/8" PT	1 Max.
065067	3/8" PT	3/8" PT	1 Max.
065068	3/8" PT	3/8" PT	5-8



QUICK RELEASE VALVE QR-1

Supply Ports: 1/2"
Delivery Ports: 3/8"
Mounting holes on
1 1/2" centers
Part No. 229860

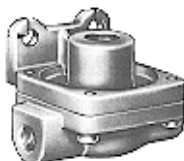

Supply Ports: 3/8"
Delivery Ports: 3/8"
Mounting holes on
1 1/2" centers
Part No. 229859



QR-1C QUICK RELEASE VALVE With Double Check Valve

A dual function valve. The QR serves the spring brake chambers as a QR valve; the double check valve prevents a service and emergency brake application from occurring at the same time.

Part No.	Supply	Delivery
289182	1/4"	1/4"
289714	1/4"	3/8"



QUICK RELEASE VALVES

QUICK RELEASE VALVES

Used wherever a quick release function is required in the air brake system. Made of Engineering Grade Plastic. Aids in meeting FMVSS 121 timing requirements.

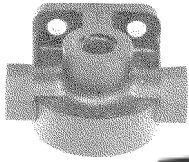
**Bendix**

QRN-2 Part No.	Inlet Port	Delivery Ports	Differential PSI
800064	3/8"	3/8"	0
800063	1/2"	3/8"	0

Haldex

Part No.	Inlet Port	Delivery Ports	Differential PSI
KN32050	1/2"	3/8"	6
KN32060	3/8"	3/8"	6

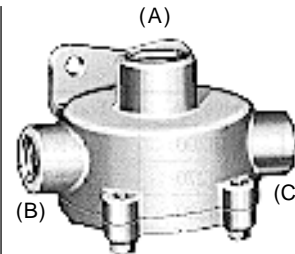

**AIR
SEALCO
CONTROLS**
QUICK
RELEASE
VALVES

Part No.	Cracking Pressure	Port Size (NPTF)		
		(A)	(B)	(C)
2000D1/2	0-1PSI	1/2"	3/8"	3/8"
2000D3/8	0-1PSI	3/8"	1/4"	1/4"

BRAKE (FOOT) VALVES

DUAL BRAKE VALVE

The E-6 dual brake valve is a floor mounted treadle or lever operated valve with two separate supply and delivery circuits for service and secondary braking, providing graduated control for applying and releasing vehicle brakes.

Part No. 286171

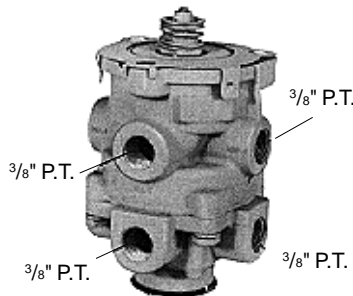

Shown with
valve.

Valve not
included.

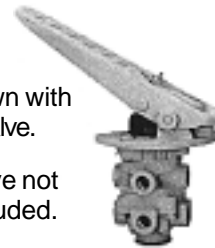

Part No. 238888
Folcrum Pin

Part No. 236979
Mounting Plate

RUBBER COVERED TREADLE ASSEMBLY

Includes:

229939 Treadle

236288 Roller

240069 Treadle Cover

Part No. 229938

Bendix

TREADLE ASSEMBLY

Aluminum assembly with no-slip design. Replaces most steel pedals
Part No. SN4017A

**Haldex**

E8P BRAKE VALVE

Lower Body
Rotated 90°
Replaces E-12
065313 AND 800583

Part No. 800629



FOOT OPERATED VALVE DUAL CIRCUIT

Provides smooth and consistent pedal feel over competitive application valves.

Requires minimal modification for change over.

3/8" ports.

Bottom portion of valve made of EGP plastic.

Part No. KN22150



CONTROL VALVES

MV-2 CONTROL MODULE

An integrated control assembly for control panel mounting in tractor. It provides all the federal legal requirements for trailer air supply and parking brake control and permits the tractor parking brakes to be applied while air is supplied to the trailer. Six 1/4" ports.

Nonmetallic.

Part No. 101437

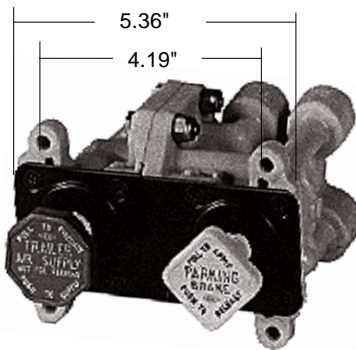
**Bendix**

MV-2 SPOOL INSERTS

The MV-2 control module is serviced by replacement of the complete spool inserts.



Spool Ass'y
Part No. 101569



Spool Ass'y
Part No. 101570



CONTROL VALVES

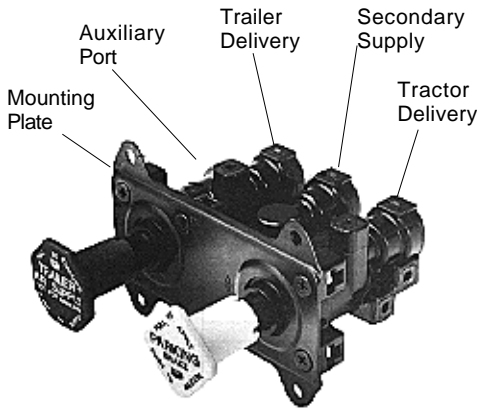

MV3 CONTROL MODULE

An integrated control assembly for control panel mounting in tractor. It provides all the federal legal requirements for trailer air supply and parking brake control and permits the tractor parking brakes to be applied while air is supplied to the trailer. Six 1/4" ports. Nonmetallic. Designed to supersede the MV-2 valve. Different mounting separates styles.

Part No. 800519

Part No. 800573

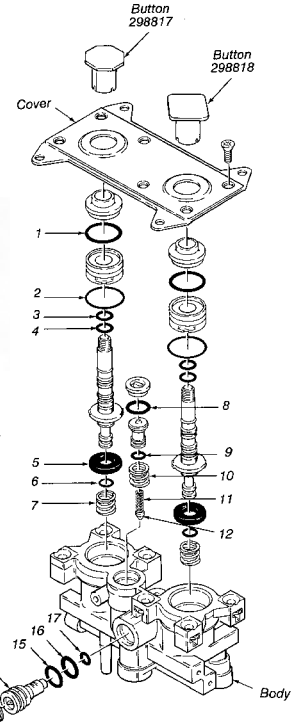
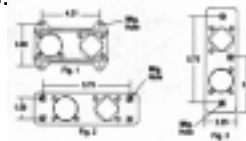
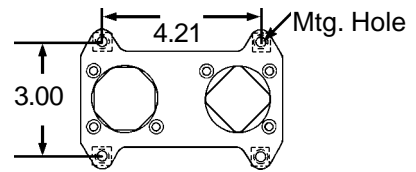

MV-3 MODULE MAINTENANCE KITS

MAINTENANCE KIT PART No. 107216 CONSISTING OF:

KEY No.	QTY	DESCRIPTION	Key No.	QTY.	DESCRIPTION
1	2	O-RING	7	2	PLUNGER SPRING
2	2	O-RING	8	1	O-RING
3	2	O-RING	9	1	O-RING
4	2	O-RING	10	1	Override SPRING
5	2	EXHAUST SEAL	11	1	SPRING
6	2	O-RING	12	1	CHECK VALVE

SHUTTLE KIT PART No. 107217

KEY No.	QTY.	DESCRIPTION
13	1	RETAINING RING
14	1	SHUTTLE VALVE
15	1	O-RING
16	1	O-RING
17	1	O-RING



PUSH PULL CONTROL VALVE PP-5

A pressure sensitive on-off control commonly used with vehicle torque converter system, engine speed control, and some parking brake systems. Automatic release pressure 40 PSI. 1/8" supply, 1/8" delivery and exhaust, all NPTF.

Part No. 281946



PUSH PULL CONTROL VALVE PP-1

A pressure sensitive on-off control usually used to control parking and emergency brakes. 1/8" supply, 1/4" delivery and exhaust, all NPTF.

Part No.	Automatic Release Pressure
276566	20 PSI
276567	40 PSI



PUSH-PULL STYLE VALVE

Controls parking/emergency brakes. Pop pressure: 35±10 PSI. 7/8" mounting hole required. Knob included. Made of Engineering Grade Composite. All ports 1/8" NPTF.

Part No. KN20021

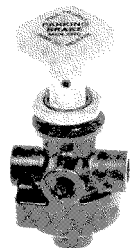

FLIPPER STYLE VALVE

Panel mount. On-off nonautomatic two position valve. Made of Engineering Grade Composite.

All Ports 1/8". Mounting holes on 1.5" centers.

Part No. KN20001

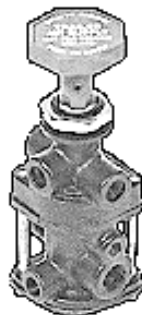

PUSH-PULL STYLE VALVE

Controls tractor protection. Made of Engineering Grade Composite.

Exhaust and delivery ports: 1/4-18 NPTF.

Supply and control ports: 1/8-27 NPTF.

Pop Pressure: 35 PSI.

7/8" mounting hole required.

Part No. KN20025

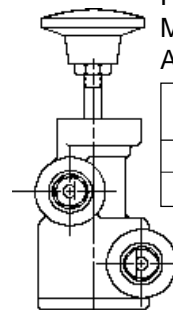

PUSH-PULL STYLE VALVE

Panel mount. Made of EGC plastic. All ports 7/8" NPTF.

Part No.	Pop Pressure
KN20031	25-35 PSI
KN20033	7-17 PSI





CONTROL VALVES

MANIFOLD DASH MODULE

One piece body construction - no center body leakage. Smaller valve size offers more room behind the dash for hoses and accessibility. Made of Engineering Grade Composite - all ports have molded identification. All ports 1/4" NPTF.

Red and Yellow knobs included.

Part No. KN20615

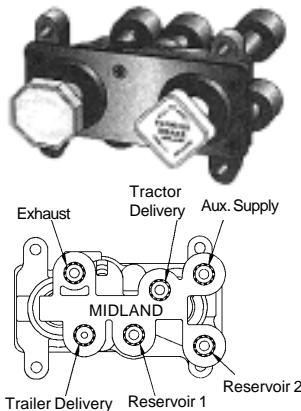

PP-DC Control Valve

Part No. 065661

Mounting Hole

1/4-20 THD.

Port Type

Push to connect
w/ 3/8" O.D. tubing

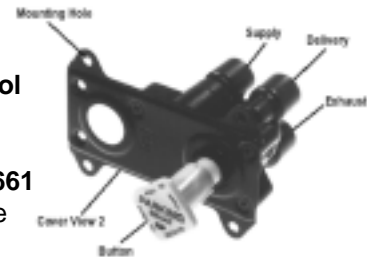

PUSH-PULL STYLE VALVE

Control tractor only parking. Bulkhead mount; 7/8" hole required. Will not stay in half-on, half-off position. All ports 1/8-27 NPTF. Pop pressure 17.7

Part No. KN20035



PUSH-PULL VALVE

3-way

Bulkhead mount, fits 5/8" dashboard hole. All ports 1/4". Made of aluminum. Complete with boot and knob.

Part No. A83580

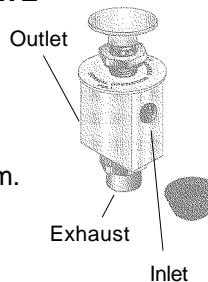

HAND CONTROL VALVE

Pull-push with Automatic Shut-Off. Shut-off 30±5 PSI. 1/4" outlet and inlet, 1/8" exh. Includes knob and nameplate shown below.

Part No. 99600B

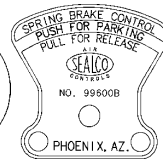

Part No. 13 **Part No. 819**



KNOB FOR PUSH-PULL VALVES



Pin type.
RCCC red.
Pin included.
Part No.
KN20900



Pin type.
RCCC yellow.
Pin included.
Part No.
KN20901



Pin type.
RCCC blue.
Pin included.
Part No.
KN20902

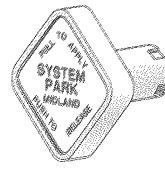

Pin type.
RCCC yellow.
Pin included.
Part No.
KN20903



Threaded type.
RCCC yellow.
Pin included.
Part No.
12509



Threaded type.
RCCC red.
Pin included.
Part No.
12501

NOTES:

All knobs made of Engineering Grade Composite.
Threaded knobs have 1/4-20 threads.



LEVER STYLE VALVES

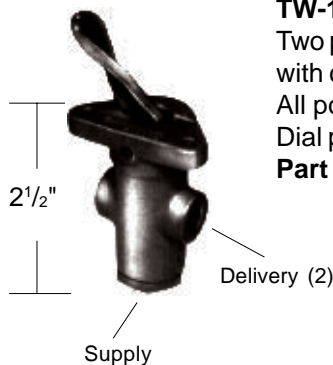

TW-1 CONTROL VALVE

Two position steel valve with chrome handle. All ports 1/8" NPTF. Dial plate not included.

Part No. 229635

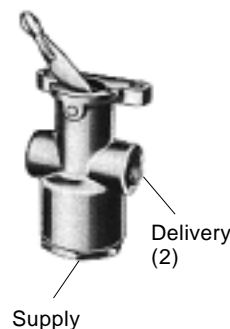

TW-3 LEVER TYPE CONTROL VALVE

Used in parking and emergency brake systems. 1/4" supply and delivery ports.

Part No. 283040X





LEVER STYLE VALVES / TRAILER BRAKE CONTROL VALVES

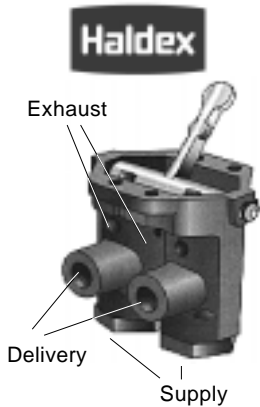

DOUBLE FLIPPER STYLE VALVES
Panel mount, directional air control valve. May be used for control of push-pull air cylinders or various other air operated devices.
Supply ports 1/4" NPTF
Delivery Ports (2) 1/8" NPTF

PART No.	APPLY/RELEASE POSITIONS
KN20080	3 position with manual release only.
KN20090	3 position with automatic release when supply "A" is applied

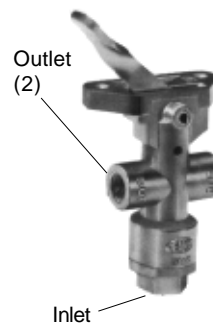

LEVER CONTROL VALVE
All ports 1/8" NPTF
Complete with face plate.
Part No. 21600



TRAILER BRAKE CONTROL VALVES



TRAILER BRAKE CONTROL VALVE
In column mount.
Made of Engineering Grade Composite.
Handle applies 50° maximum.
Handle and knob not supplied.
All 1/4" ports.
Holding Type:
Part No. KN20541



TRAILER BRAKE CONTROL VALVE
External steering column mount. Handle applies 70° maximum. Chrome handle. All ports 1/4" NPTF.
Holding Type:
Part No. KN20561

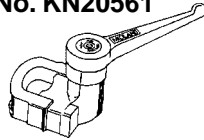

TRAILER BRAKE CONTROL VALVE
GM in-column mount. Made of Engineering Grade Composite.
Handle rotates 72° maximum.
3/8" NPTF deliver and supply ports, 1/8" exhaust.
Special tube nuts in ports.
Holding Type:
Part No. KN20551

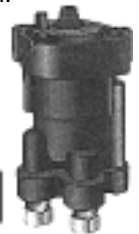

TRAILER BRAKE CONTROL VALVE



TW-4 CONTROL VALVE
1/8" Ports

Part No. 276635



TRACTOR PROTECTION VALVES

Tractor Emerg.
1/4" NPTF

(A) Trailer Emerg.
NPTF



Tractor Service
3/8" NPTF

(B) Trailer Service
NPTF

TP-3 TRACTOR PROTECTION VALVE

Part No.	A	B
279000	1/2"	1/2"



TRAILER EMERGENCY VALVE

TEV Valve Provides Spring Brake Priority
-Retains the ability of the driver to repeatedly apply and release the Parking/Emergency Brakes even with a damaged tank.
Part No. 51301



TRAMEC

STEV Valve Provides Spring Brake Priority
-Assures that the trailer parking brakes will not release before there is sufficient air pressure in the reservoir to apply service brakes.
Part No. 51321



TRAMEC

SYNCHRONIZING VALVES

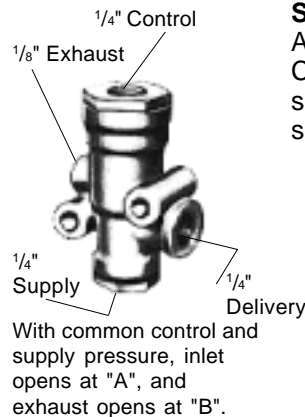

SV-1 SYNCHRONIZING VALVE
A pneumatic control valve. Controls air from remote air supply other than control air supply. All threads NPTF.



Part No.	A PSI	B PSI
278825	42	28
282472	21	11
283700	62	50



SPRING BRAKE CONTROL VALVES

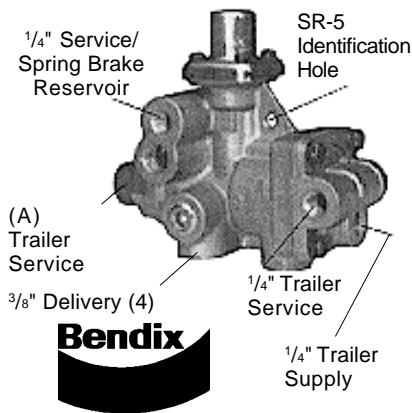

SR-5 TRAILER SPRING BRAKE VALVE

Die-cast aluminum, reservoir mounted valve that controls up to four spring brake actuators during parking or emergency applications. All threads NPTF.

Anti-Compounding:
Part No. 065437

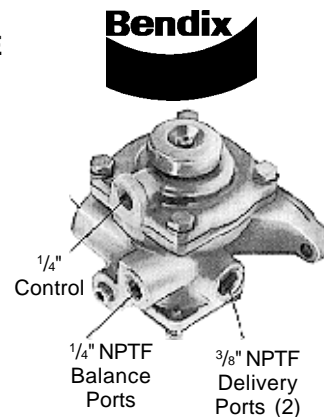

R-7 MODULATING VALVE
Usually found on vehicles with dual air brake systems, the R-7 modulates the spring brakes thru the application of the foot brake valve in the event of loss of rear axle service brake pressure.

Spring brake pressure is limited to 90-95 PSI by the R-7.

Part No. 103081

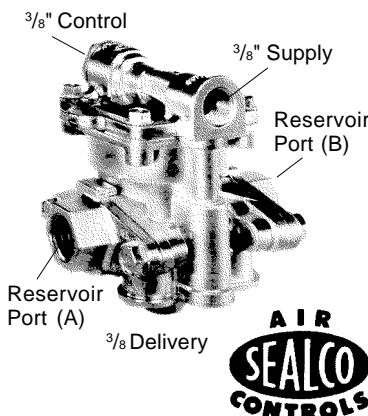

SPRING BRAKE CONTROL VALVES

Protected Reservoir System
Four delivery ports

Part No.	Port (A)	Port (B)
110170	1/2" NPTF	1/2" NPTF
110191	3/8" NPTF	1/2" NPTF

FOR QUICK FIX SERVICE



Part No.
110175



Part No.
110165

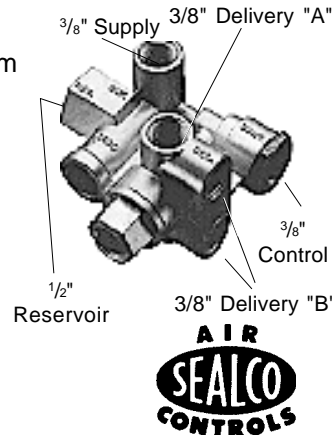

SPRING BRAKE CONTROL VALVE

Spring Brake Priority System
Complies with all changes to FMVSS121, Docket 90-3
Designed for use with a single reservoir on a typical single or tandem axle trailer application.

Part No. 110500 single

Part No. 110315 *

Part No. 110800 *

*Note: can be used with (2) 1400 cu. in. reservoirs on tandem axle trailers.

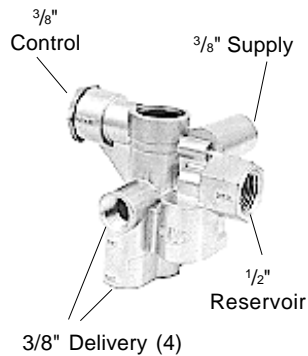

SPRING BRAKE CONTROL VALVE

Service Reservoir
Priority System

Complies with all changes to FMVSS121, Docket 90-3
Designed for use with a single reservoir on a typical single or tandem axle trailer application.

Part No. 110700

Note: can be used with (2) 1400 cu. in. reservoirs on tandem axle trailers.



SPRING BRAKE EXHAUST VALVE

Part No. 3800

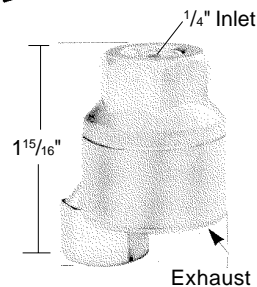

LINE FILTER

Used in trailer supply line ahead of spring brake control valve or relay emergency valve.

Part No. 2550

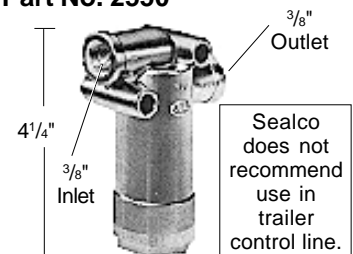

Sealco does not recommend use in trailer control line.

RELAY VALVES



RELAY VALVES

2 & 4 Horizontal Delivery Ports.
A multipurpose, low differential, high capacity, straight relay. Meets FMVSS-121 timing requirements. Cover can be rotated without affecting performance or warranty.

3/8" delivery ports.

1/2" reservoir ports

3/8" control port

2 Delivery Ports

4 PSI crack pressure

Part No. KN28060

4 Delivery Ports

7 PSI Crack Pressure

Part No. KN28080



RELAY VALVES

Four delivery ports facing down. Cracking pressure 3 ± 1 PSI. Meets or exceeds FMVSS-121 requirements. Cover may be rotated without affecting warranty.

PART No.	CONTROL	DELIVERY	SUPPLY	AUX SUPPLY
A103600	1/4	3/8	3/4	(1)

(1)=Plugged



RELAY VALVES



EMERGENCY RELAY VALVE

4 port. Suitable for pre-121 trailers, converter dollies, or exempt trailers. Cracking pressure 4.5 ±1 PSI

Haldex

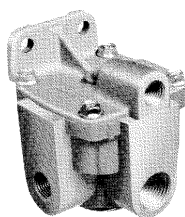

RELAY VALVES(RG2)

2 Delivery Ports. Compact size. A fast, low cracking pressure straight relay for tractor-trailer-truck applications. Cracking pressures 6 PSI. Cover may be rotated without affecting warranty.

PART No.	SERVICE INLET	EMERG. INLET	DELIVERY	AUX RES.	RES.
KN30300	1/4	1/4	1/4	(1)	3/4
KN30400	1/4	1/4	3/8	(1)	3/4

(1)=Plugged

PART No.	RESERVOIR		DELIVERY		INCLUDED WITH VALVE:
	A	B	C	D	
KN28500	3/8	3/8	3/8	3/8	(1) 3/8" PLUG.
KN28510	3/8	1/2	3/8	3/8	(1) 1/2", (1) 3/8" PLUG.
KN28520	1/2	1/2	1/2	1/2	(1) 1/2" PLUG.

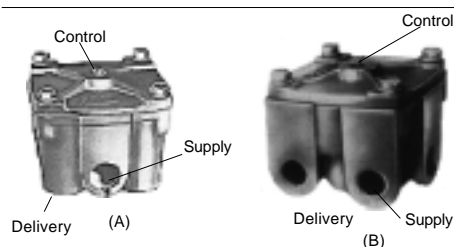

R12 RELAY VALVE

Piston operated, with 4 delivery ports for service or parking brakes.

Delivery Ports: See below

Supply Port: 1/2" NPTF

Control Port: 1/4" NPTF

Crack pressure: 4 PSI

Delivery Ports: 3/8" NPTF

(A) 3/8" Vertical Delivery Ports

Part No. 065104

1/2" Vertical Delivery Parts

Part No. 102626

(B) 3/4" Horizontal Delivery Ports

Part No. 103009



R12DURADRAIN™ RELAY VALVE

Supply Port: 1/2" NPTF

Crack pressure: 5.5 PSI

Delivery Ports: 1/2" NPTF

(C) 3/4" Horizontal Delivery Ports

Part No. 065125

MAINTENANCE KIT For R12 & R14 Valves.

Key	Qty.	Description
1	1	O-Ring
2	1	O-Ring
3	1	Valve Retainer
4	1	Inlet & Exhaust Valve
5	1	Valve Spring
6	1	Retaining Ring
7	1	Exhaust Cover Complete
8	1	O-Ring
9	1	O-Ring
10	1	Diaphragm
11	1	O-Ring

Kit Part No. 102802

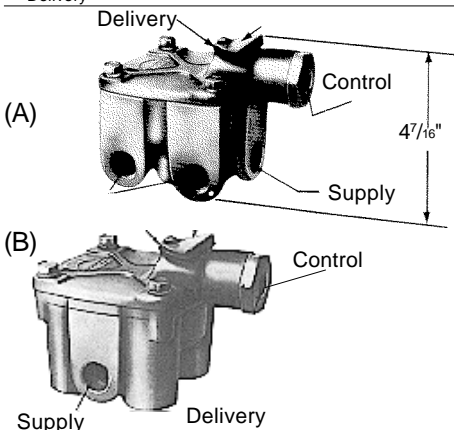

R14 RELAY VALVE

Anti-compounding feature permits control of spring brakes as well as service brakes. Has 4 delivery ports.

Delivery Ports: 1/2" NPTF

Supply Port: 1/2" NPTF

Control Port: 1/4" NPTF

Crack Pressure: 4 PSI

(A) Horizontal Delivery Ports

Part No. 103010

(B) Vertical Delivery Ports

Part No. 103028

Bendix

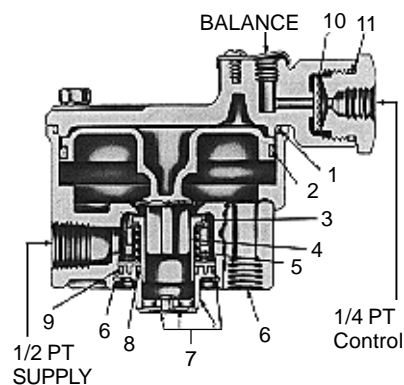

Bendix

BP-R1 Bobtail Brake Proportioning Relay Valve

- Maintenance Kit 106392
- Universal Mounting Bracket 296010 furnished with valve exchange.
- Remanufactured - Core Charge

PART No.	SERVICE	SUPPLY	DELIVERY	AUX RES.	CON-TROL
065145X	1/4	1/2	3/8	(1)	1/8
065146X	1/4	1/2	3/8	(1)	1/8

Crack Pressure for 065145X is 4.
Crack Pressure for 065146X is 5.5.

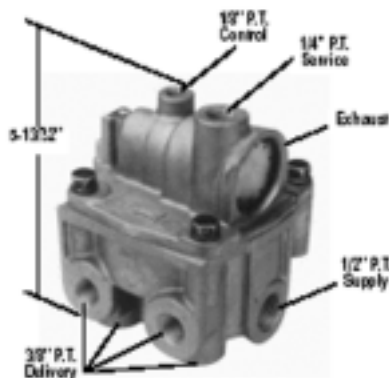



RELAY VALVES

2 PORT DELIVERY

Used primarily for single axle trailer service brakes, or axle by axle trailer brake designs.

Nipple mounted.

Crack Pressure 4 PSI.

Control Port: $\frac{3}{8}$ " NPTF

Reservoir Port: $\frac{1}{2}$ " NPTF

Delivery Ports: $\frac{3}{8}$ " NPTF

Part No. 110410

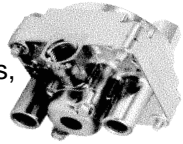

4 PORT DELIVERY

Used primarily for tandem axle trailer service brakes with four brake chambers.

Nipple mounted.

Crack Pressure 4 PSI.

Control Port: $\frac{3}{8}$ " NPTF

Reservoir Port: $\frac{3}{4}$ " NPTF

Delivery Ports: $\frac{3}{8}$ " NPTF

Part No. 110415

RELAY EMERGENCY VALVE

4 Delivery Ports

The Original "Quick Fix"

Nipple mounted.

Crack Pressure 1.5 PSI.

Control Port: $\frac{1}{4}$ " NPTF

Reservoir Port: $\frac{1}{2}$ " NPTF

Emerg.-Supply: $\frac{1}{4}$ " NPTF

Delivery Ports: $\frac{1}{4}$ " NPTF

Part No. A1000S



CHARGING RELAY EMERGENCY VALVE

Serv-Control Port (2): $\frac{3}{8}$ " NPTF

Emerg.-Supply Port: $\frac{3}{8}$ " NPTF

Reservoir Port: $\frac{3}{4}$ " NPTF

Delivery Ports (4): $\frac{3}{8}$ " NPTF

Cracking Pressure 4.5 PSI

Part No. 110470

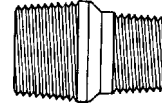
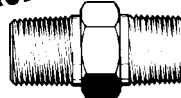
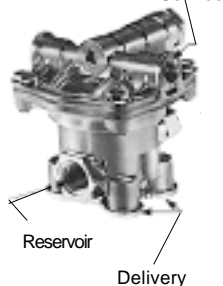

HEAVY DUTY MOUNTING NIPPLES

Straight nipple

$\frac{1}{2}$ " NPT, $1\frac{5}{8}$ " long

Part No. 6002S

$\frac{3}{4}$ " NPT, $1\frac{5}{8}$ " long

Part No. 6006

Reducing Nipple

$\frac{3}{4}$ " to $\frac{1}{2}$ " NPT, $1\frac{5}{8}$ " long.

Part No. 6003

Mounting Nipple

for A1000S

Part No. 616

**QUICK FIX SERVICE:
PLUG UNIT ASS'Y**
Part No. 110143



Note: Some valves available remanufactured

NON-CHARGING

RELAY EMERGENCY VALVE

Commonly used on converter dollies, turntable axles, and air lift axles with service brake chambers.

Serv-Control Port (2): $\frac{3}{8}$ " NPTF

Emerg.-Supply Port: $\frac{3}{8}$ " NPTF

Reservoir Port: $\frac{3}{4}$ " NPTF

Supply-Out Port: $\frac{3}{8}$ " NPTF

Delivery Ports (4): $\frac{3}{8}$ " NPTF

Cracking Pressure 4.5 PSI

Part NO. 110338X

TRAILER VALVES

FF2 FULL FUNCTION TRAILER VALVE

Replaces 2 and 3 valve multifunction trailer air brake systems by providing:

- Trailer spring brake control. •Pressure protection with one-way check.
- Trailer service relay. •Fully complies with FMVSS-121 trailer regulations, for spring brake control and other requirements

Single valve for tandem axle:

- 1 or 2 reservoir systems •Protects supply to 70 PSI; no dragging spring brakes with 70 PSI or higher supply line. •3 second spring brake apply
- Service brake functions •Anti-compounding

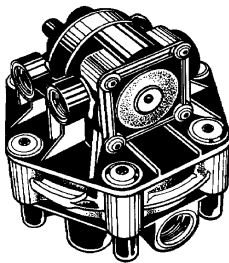

Heavy steel walled pipe nipple included with each valve, conforming to NFPA/T3.8.3 R2-1977 standard.

SPECIAL
ORDER

Haldex

PART No.	CRACK PRESSURE	RESERVOIR	CONTROL	SUPPLY	SPRING BRAKE	SERVICE BRAKE
KN28600	3 PSI	$\frac{3}{4}$ "	$\frac{1}{4}$ "	$\frac{3}{8}$ "	$\frac{3}{8}$ "	$\frac{3}{8}$ "
KN28601	3 PSI	$\frac{1}{2}$ "	$\frac{1}{4}$ "	$\frac{3}{8}$ "	$\frac{3}{8}$ "	$\frac{3}{8}$ "
KN28602*	5 PSI	$\frac{3}{4}$ "	$\frac{1}{4}$ "	$\frac{3}{8}$ "	$\frac{3}{8}$ "	$\frac{3}{8}$ "
KN28603*	5 PSI	$\frac{1}{2}$ "	$\frac{1}{4}$ "	$\frac{3}{8}$ "	$\frac{3}{8}$ "	$\frac{3}{8}$ "

MULTIFUNCTION RT-4 TRAILER VALVES

Meets all FMVSS-121 trailer requirements for spring brake control and other regulations.

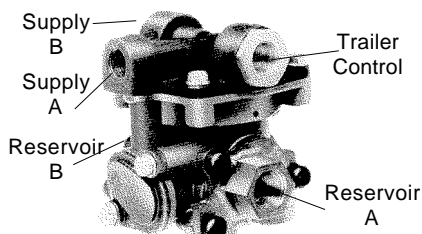

	TRAILER SUPPLY		TRAILER CONTROL	RESERVOIR			PPV CLOSING PRESSURE
PART No.	A	B		A	B	DEL'Y	
KN26010	$\frac{3}{8}$ "	X	$\frac{3}{8}$ "	$\frac{1}{2}$ "	$\frac{3}{8}$ "	(4) $\frac{3}{8}$ "	70 PSI
KN26020	X	$\frac{3}{8}$ "	$\frac{3}{8}$ "	$\frac{1}{2}$ "	$\frac{3}{8}$ "	(4) $\frac{3}{8}$ "	70 PSI



LOW PRESSURE SWITCHES



Bendix

**LP-3
LOW PRESSURE
INDICATOR**
Single Terminal

Part No.	Cut-out Pressure PSI	"A" Pipe Thread
104246	66±6	1/4"
279416	60±6	1/4"
279472	75±6	1/4"
280530	70±6	1/4"
289397	75±6	1/8"

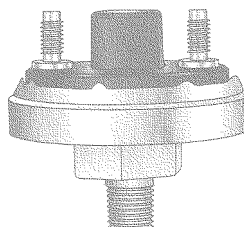

LOW AIR SWITCH
Single Pole,
2 terminal Design
Circuit normally closed
at 0 PSI
1/8-27 Thread
Part No. BE13241

Haldex

STOP LIGHT SWITCHES

**SL-5
STOP LIGHT SWITCH**



Part No.	Terminal Thd. Size
286392	#8-32
286404	#10-32

**DS-2
DOUBLE CHECK VALVE & STOP
LIGHT SWITCH**



Part No.	A	B	C	E
286452	3/8"	3/8"	3/8"	#8-32
286453	3/8"	3/8"	3/8"	#10-32

**SL-4
STOP LIGHT SWITCH**
Part No. 274746

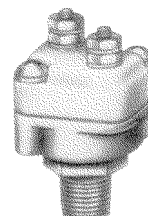

**TRACTOR
SPRING BRAKE CIRCUIT
LIGHT SWITCH**

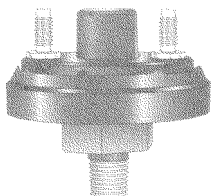

Actuates at 55 PSI.
Single pole, 2 terminal design.
Circuit normally closed at 0 PSI.
Part No. BE13240

**SERVICE CIRCUIT
STOP LIGHT SWITCH**

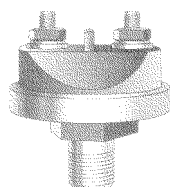

Actuates at 3 - 5 PSI.
Single pole, 2 terminal design.
Circuit normally open at 0 PSI.
Solid state contacts.
Part No. BE13250

**TRAILER EMERGENCY STOP
LIGHT SWITCH**

Actuates at 55 PSI. Single pole,
double throw, 3 terminal
design. Circuits are normally one
open, one closed.

Part No. BE13255

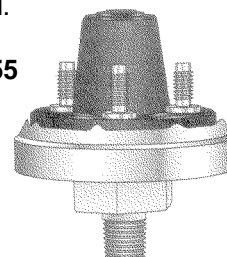

STOP LIGHT SWITCH
Part No. 8100

#8-32
Reverse Polarity

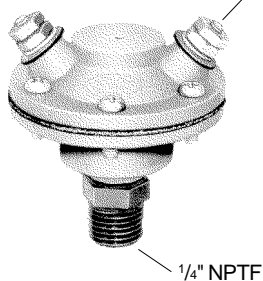

1/4" NPTF

STOP LIGHT SWITCH
Meets the requirements of DOT121.
Brass body with silver and cadmium
contacts for long life and low voltage
drop. Rated at full 24 amp load.
1/4 - 18 NPTF.
Part No. 1013250



Haldex

Bendix

**AIR
SEALCO
CONTROLS**



SHUT OFF VALVES / DRAIN VALVES

SHUT OFF VALVE

Ball type valve with
1/2" NPTF both ends.
Working pressure 150 PSI.

Part No. 12116

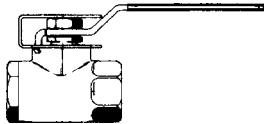

DRAIN VALVES WITH CABLE

Use on wet or dry tanks. 1/4" NPTF.
Brass body with stainless spring.
Nylon coated stainless cable.

4' Cable
Part No. FC12104
5' Cable
Part No. FC12105



DRAIN VALVES WITH CABLE

Use on wet or dry tanks.
1/4" NPTF. Nylon coated
stainless cable.

4' Cable:
Part No. 12104
5' Cable:
Part No. 12105



Haldex

EXTERNAL SEAT DRAIN COCK

NPTF	Part No.
1/8"	DC604-2
1/4"	DC604-4
3/8"	DC604-6
1/2"	DC604-8

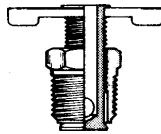

NPTF	Part No.
1/4"	DC601-4
3/8"	DC601-6
1/2"	DC601-8

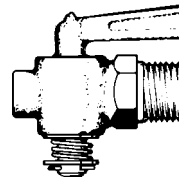

NPTF	Part No.
1/8"	DC603-2
1/4"	DC603-4
3/8"	DC603-6

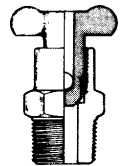

DRAIN COCK
NPTF Part No.
1/4" **DCR601-4**

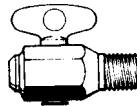

DRAIN VALVES, AUTOMATIC

Mounted to side or bottom of wet
tank. Functions when pressure
varies in air tank. 5 Foot cable.
1/4" NPTF Threads

Non-Heated.
Part No. KN24000

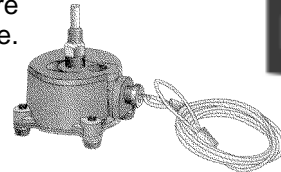

Haldex

TRUCK VALVES

GROUND PLUG SHUT OFF COCK

Female Pipe
To
Male Pipe

Part No.	Female Pipe Thread	Male Pipe Thread
V402P-2-2	1/8"	1/8"
V402P-4-4	1/4"	1/4"
V402P-6-6	3/8"	3/8"

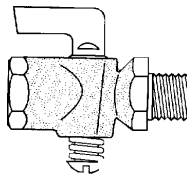

Part No.	Hose I.D.	Pipe Thread
SV404P-6-6	3/8	3/8
SV404P-10-6	5/8	3/8
SV404P-10-8	5/8	1/2
SV404P-12-6	3/4	3/8
SV404P-12-8	3/4	1/2

TRUCK VALVE
Hose
To
Male Pipe



TRUCK VALVE

Female Pipe
to
Male Pipe

Part No.	Hose I.D.	Pipe Thread
V405P-6-6	3/8	3/8
V405P-6-8	3/8	1/2
V405P-8-8	1/2	1/2



TRUCK VALVE

Flare
To
Male Pipe

Part No.	Hose I.D.	Pipe Thread
V409F-8-6	1/2	3/8
V409F-8-8	1/2	1/2
V409F-10-8	5/8	1/2
V409F-12-8	3/4	3/8

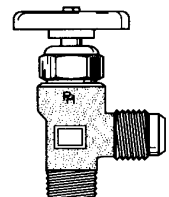



VALVE INTERCHANGE LISTS

COMPETITIVE TO SEALCO					
THESE COMPETITIVE VALVES				Can Be Replaced By This SEALCO Valve	
Bendix	Berg	Haldex	Sealco	Wagner	
RE4	11675	KN3000		AF-71890	A1000S
229434	12350	KN30010		A-99036	110200
277446		N-3714J			110205
RE6		KN30100			110460
281865		KN30300	110268		110470
281860		KN30400			110475
RE-6NC		KN30200			110338
102168					110338
R-12P					110580
109001		KN28300	3100		110580
109002					110580
R-8P					110570
287114			KN28300		110570
SR-2					110170
287375	12360		110147		110170
287376	12361				110170
SR-4*					110170
101112*					110170
101121*					110170
101622*					110170
		RT-4			110171
		KN26010		AF-88802	110171
				AF-88812	110171
		RT-4		RT-2	110191
		KN26000		A-98730	110191
				A-99370	110191
				AE-83336	110191
				AE-83335	110191
SR-5					110500
065437					110500
065438					110500
065439					110500
065440					110500
R-12					110410
103009	12346	KN28510	110197	AE-78889	110410
	12341			A-80070	110410
R-12					110415
102626	12345	A-103600	110139	A-85490*	110415
065104	12343	A-86477	110450	A-97600*	110415
R-6			110600		110415
279952					110415
R-5	12344	KN28060	9125	AE-78880	110416
229467				AE-78887	4 Delivery
R-6		KN28500		AE-78889	
279180		KN28510			or
R-8		KN28520			
286370					
R-12					110412
102626					2 Delivery



VALVE INTERCHANGE LISTS

COMPETITIVE TO BENDIX

Bendix	To	Bendix	Berg	To	Bendix	Haldex	To	Bendix
R-1		103009	12340		103009	KN28060		103009
R-1C		103009	12341		103009	KN28061		103009
R-5		102626, 103009	12342		102626, 103009	KN28071		103010
R-6		102626, 103009	12343		102626, 103009	KN28132		103009
R-8		103010	12344		102626, 103009	KN28140		103010
R-12		102626	12345		102626, 103009	Sealco To Bendix		
R-12H		103009	12346		103009	9125		102626, 103009
R-14		103028	12352		101112 & 102626	A1100		102626
R-14H		103010	12360		101112, 101622	Wagner To Bendix		
RE-1C		229434	A86473		102626	A78882		102626, 103009
RE-4		229434	A86477		102626	A78887		102626, 103009
RE-6		281865	Haldex To Bendix			A88802		101112, 101622
SR-1		286364	A104001		101112, 101622	A88812		101112, 101622
SR-2		287376	A104002		101112, 101622	A98730		101112, 101622
SR-4		101112	A104003		101112, 101622	A98731		101112, 101622
			A104010		101112, 101622	A98732		101112, 101622
			KN20541		101112, 101622			

COMPETITIVE TO HALDEX

Bendix Part No.	Can be Replaced by	Haldex Part No.	Sealco	Haldex
SR2	KN26000/KN26010/KN26020		A1100	A103600 or A86477
SR4	KN26000/KN26010/KN26020		110139	A103600 or A86477
R6	A103600 or A86477		110147	KN26000/KN26010/KN26020
R10	A103600 or A86477		110171	KN26000/KN26010/KN26020
R12	A103600 or A86477		110180	KN26000/KN26010/KN26020
R12H	KN28550		110190	KN26000/KN26010/KN26020
R14	A103600 or A86477		110197	KN28550
			110230	KN26000/KN26010/KN26020
			3100	KN28550
			9125	KN28550
Midland			Wagner	
12360	KN26000/KN26010/KN26020	Midland-Grau	A80070	KN28550
KN28160		KN28550	A88802	KN26000/KN26010/KN26020
KN28500		KN28550	A88812	KN26000/KN26010/KN26020
KN28520		KN28550	A83335	KN26000/KN26010/KN26020
			A83336	KN26000/KN26010/KN26020
Berg				
12343		A103600 or A86477		
12345		A103600 or A86477		
11661		A103600 or A86477		
12343		A103600 or A86477		
12346		KN28550		



FLEETCRAFT VALVES



VALVES



FC28600



FC28601



FC28500



FC28510



FC28520



FC26000



FC2103028



FC065104



FC065437



FC102626



FC103009



FC103010



FC281865



FC103081



FC229635



FC18530



FC276566



FC276567



FC286171



FC288239



FC289714



FC950011



FC800372 & FC800373



FC54007



FC12104 & FC12105

****ONE YEAR WARRANTY****
****ALL VALVES NEW OUTRIGHT****

**FLEETCRAFT VALVES****FLEETCRAFT**
QUALITY PARTS FOR THE TRUCKING INDUSTRY**VALVES******ONE YEAR WARRANTY****
**** ALL VALVES NEW OUTRIGHT****

<i>Fleetcraft Part Number</i>	<i>Description</i>
FC18530	D2 Governor
FC28500	RG2 Valve
FC28510	RG2 Valve
FC28520	RG2 Valve
FC28600	FF Valve, 3/4 port
FC28601	FF Valve, 1/2 port
FC26000	RT4 Valve
FC065104	R-12 Valve
FC065437	SR-5 Valve
FC102626	R-12 Valve
FC103009	R-12 Valve
FC103010	R-14 Valve (Horizontal)
FC103028	R-14 Valve (Vertical)
FC103081	R-7 Valve
FC229635	TW1 Valve
FC276566	PP1 Valve (20 psi)
FC276567	PP1 Valve (40 psi)
FC281865	RE-6 Valve
FC286171	E-6
FC288239	PP7
FC289714	QR DBL Check
FC950011	Meritor Cartridge 1200
FC800372	Check Valve
FC800373	Check Valve
FC54007	Leveling Valve
FC229859	QR Valve (3/8 - 3/8)
FC229860	QR Valve (1/2 - 1/2)
FC12104	1/4" Drain valve - 4' cable
FC12105	1/4" Drain Valve - 5' cable



VELVAC AIR VALVES

Four-Way Push/Pull Valves

Part No. 320121 - Two Position Valve

Part No. 320122 - Three Position, Holding Type Valve



The "Viper"
Part No. 320124

- Compact, high flow valve provides flow performance comparable to larger valves
- One piece stainless steel shaft
- Can be mounted using (2) 3/16" dia. body mounting holes or through a 1/2" dia. through hole.
- (3) 1/8" NPT ports and (2) 10-32 exhaust ports
- Includes pull to open/push to close faceplate



Four-Way Electronic Solenoid Valve

Part No. 320131

- Features newly designed orifice area increasing airflow
- Manual override switch for manual operation
- (3) 9/32" dia. valve body mounting holes, (5) 1/4"-18 FPT ports
- Exhaust cone filters included



Four-Way Rotary Handle Valve

Part No. 320123

- Includes solid one-piece knob and TWO faceplates (Raise/Lower & Open/Close)
- (3) 1/4"-18 FPT ports



HYDRAULIC BRAKE WHEEL CYLINDERS



Single End Cylinder



Typical Double End, Straight or Step Bored

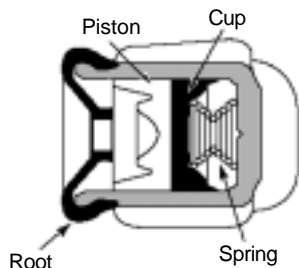
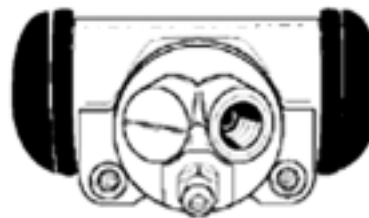

Single-Ended
Wheel Cylinder uses one cup,
piston, and dust boot.

Double-Ended
Wheel Cylinder uses two
cups, pistons, and dust boots
with the same size bore.

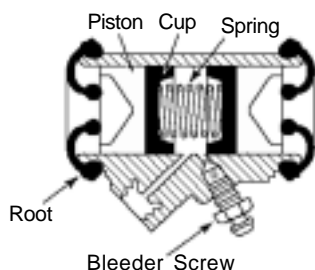

Part No.

E-5170
E-5178
E-5179
E-5407
E-5407
E-5408
E-5413
E-5414

Description

Single RH Wheel Cylinder, Upper & Lower
Single LH Wheel Cylinder, Upper
Single LH Wheel Cylinder, Upper & Lower
Single LH Wheel Cylinder
Single LH Reman Wheel Cylinder
Single RH Wheel Cylinder
LH Expander Wheel Cylinder
RH Expander Wheel Cylinder

Part No.

033314
033321
033338
033400
033581
033582
033708
033709

Description

LH Wheel Cylinder Assy
RH Wheel Cylinder Assy
Wheel Cylinder
Wheel Cylinder
Wheel Cylinder
Wheel Cylinder
Wheel Cylinder Assy
Wheel Cylinder Assy

Bendix



VELVAC AIR CYLINDERS



- Stainless steel cylinder shaft provides excellent corrosion resistance and extended cycle life.
- Lightweight, corrosion resistant, aluminum cylinder tube with die cast aluminum end caps.
- Rear Clevis cast as integral part of the cover for improved durability and mounting integrity.
- Double acting, Emralon-coated piston cup assures smooth, long lasting operation even in cold weather conditions.
- Front end cap assembly includes pressure seal, dirt seal and oil impregnated bronze bushing.
- Cylinder tube is imprinted with part number and date code for quick identification.
- ALL cylinders are factory pressure and leak tested prior to shipping.

Part No. 100122

Air Cylinder - 2-1/2" I.D. x 4" Stroke. Cylinder Type: Push / Pull; Retracted Length: 9.37"

Part No. 100123

Air Cylinder - 2-1/2" I.D. x 6" Stroke. Cylinder Type: Push / Pull; Retracted Length: 11.37"

Part No. 100124

Air Cylinder - 2-1/2" I.D. x 8" Stroke. Cylinder Type: Push / Pull; Retracted Length: 13.37"

Part No. 100125

Air Cylinder - 2-1/2" I.D. x 4" Stroke. Cylinder Type: Spring Return (Norm. Ext.);

Part No. 100126

Air Cylinder - 2-1/2" I.D. x 6" Stroke. Cylinder Type: Spring Return (Norm. Ret.);

Part No. 100131

Air Cylinder - 3-1/2" I.D. x 6" Stroke. Cylinder Type: Push / Pull; Retracted Length: 13.60"

Part No. 100132

Air Cylinder - 3-1/2" I.D. x 8" Stroke. Cylinder Type: Push / Pull; Retracted Length: 15.60"

Part No. 100133

Air Cylinder - 2-1/2" I.D. x 6" Stroke. Cylinder Type: Spring Return (Norm. Ext.);

Part No. 100136

Air Cylinder - 3-1/2" I.D. x 8" Stroke. Cylinder Type: Push / Pull; Retracted Length: 18.35"

Part No. 100137

Air Cylinder - 3-1/2" I.D. x 8" Stroke. Cylinder Type: Push / Pull; Retracted Length: 15.60"

Part No. 100143

Air Cylinder - 3-1/2" I.D. x 8" Stroke. Features: Perpendicular Ports; Cylinder Type: Push / Pull





ABS GENERAL INFORMATION

General Air Brake Requirements

Basic design requirements for trailer air brake systems are set forth in FMVSS-121. FMVSS-121 covers requirements for new construction. Once put into operation, the trailer's brake systems must be maintained in accord with the following FHWA/OMC standards:

FMCSR 393 - Covers required equipment

FMCSR 396 - Covers inspection and repair

Air Timing Requirements

FMVSS-121 specifies the maximum times that are permitted for application and release of brake chamber pressure. ABS equipped trailers must meet the same air timing requirements as prior, non-ABS equipped trailers.

Reservoirs

Trailers must be equipped with air reservoirs that provide a volume of air eight times that of the service brake chambers.

A type 30 air chamber has an effective surface area of 30 square inches. For short stroke type 30 air chambers, the volume is typically 89 CID. For a typical two axle trailer, the minimum required volume is therefore 2848 CID. Reservoir size requirements for non-ABS and ABS equipped systems are the same.

Trailer ABS Configurations

Application Recommendations

Refer to the chart on this page to determine a recommended ABS installation for your application.

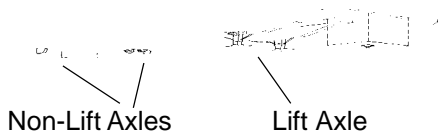

SYSTEM APPLICATION CHART				
Trailer Type	2S/1M	2S/2M	SIDE CONTROL 4S/2M	AXLE CONTROL 4S/2M
	1 or 1			
	1 or 1	or 1		
			1 or 1	
		1 or 1		
			1	
		1		
		2 or 2		
		2 or 2		
	2 and 1	or 2	or 2	
	2 and 1			
		1 or 1		
		1 or 1		
	1 or 1	or 1		
	1 or 1			
			1 or 1	
		2 or 2		
	1			
	1			
		1		

Sensor Placement

When more than one wheel is controlled by a single valve, sensors should be mounted at the axle which tends to lock first. For spring suspensions this is usually the forward axle. For air suspensions this is usually the rear most axle.



ABS ELECTRIC CONFIGURATION - 2S/1M - HALDEX COMPONENTS

Kit Part No. AQ960804

PARTS LIST Consisting of:		
Qty	Part No.	Description
1	AL919310	ECU
1	AL430624	Full Function ABS Valve
2	AL919804	7.5' Sensor Cable Ext
1	AL918600	60' Power Cord
1 box	-	Tie Down Clips

Kit Part No. AQ961404

PARTS LIST Consisting of:		
Qty	Part No.	Description
1	AL919310	ECU
1	AL430624	Full Function ABS Valve
2	AL919804	7.5' Sensor Cable Ext
1	AL919901	12' Power Cord Ext
1 box	-	Tie Down Clips

ABS AIR CONFIGURATION - 2S/1M FFABS

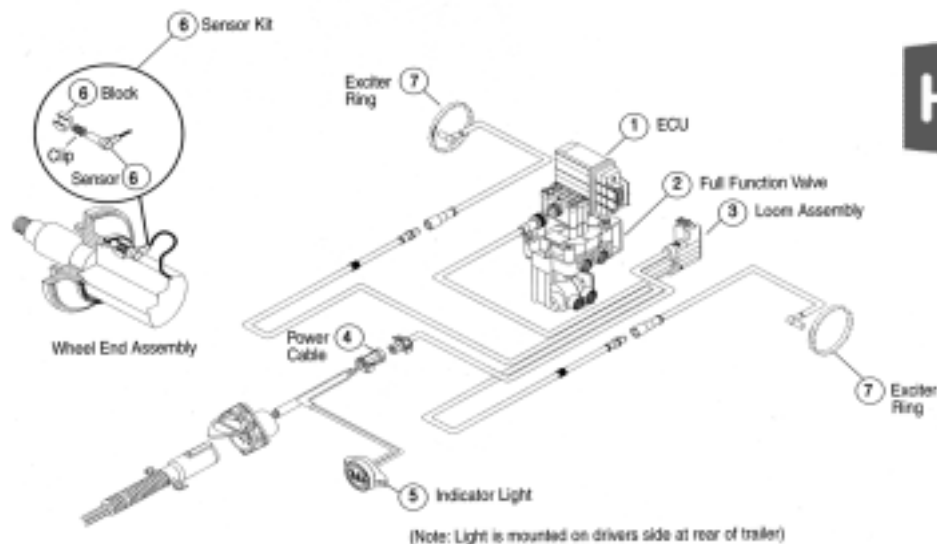

ABS AIR CONFIGURATION - UNIVERSAL 2S/1M REPLACEMENT KIT

The AQ960503 Universal PLC Select ABS Kit will replace all competitive brands and generations of trailer 2S/1M (2 Sensor - One Modulator Valve) ABS systems. These are any systems that utilize a single ABS valve, two sensors, and a separate spring brake control valve. Some additional components unique to the vehicle being upgraded should be expected. Do not use this kit to replace the Haldex FFABS ABS System as this is a single valve per vehicle and spring brake control is integral to the FFABS valve.

Kit Part No. AQ960503

PARTS LIST Consisting of:	
Qty	Description
1	PLC Select Valve ECU Assy. 6 Port
1	6 Foot Power Cord Ext.
2	18 Inch Sensor Extensions
1	Installation Instructions L31203
1	PLC Service Manual L30030

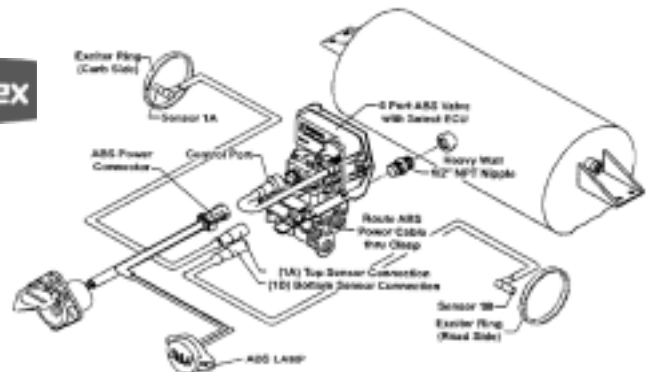



ABS ELECTRICAL CONFIGURATION - 4S/2M - COMPONENTS

Kit Part No. AQ961002

PARTS LIST Consisting of		
Qty	Part No.	Description
1	AL919311	ECU
1	AL430624	Full Function ABS Valve
2	AL919802	4.5' Sensor Cable Ext.
2	AL919804	7.5' Sensor Cable Ext.
1	AL918600	60' Power Cord
1	AL364040	Modulator Valve
1	AL40900	Loom Assembly
1 box	-	Tie Down Clips

Kit Part No. AQ961605

PARTS LIST Consisting of:		
Qty	Part No.	Description
1	AL919311	ECU
1	AL430624	Full Function ABS Valve
2	AL919802	4.5' Sensor Cable Ext.
2	AL919804	7.5' Sensor Cable Ext.
1	AL919901	12' Power Cord Ext.
1	AL364040	Modulator Valve
1	AL40900	Loom Assembly
1 box	-	Tie Down Clips

ABS AIR CONFIGURATION - 4S/2M FFABS

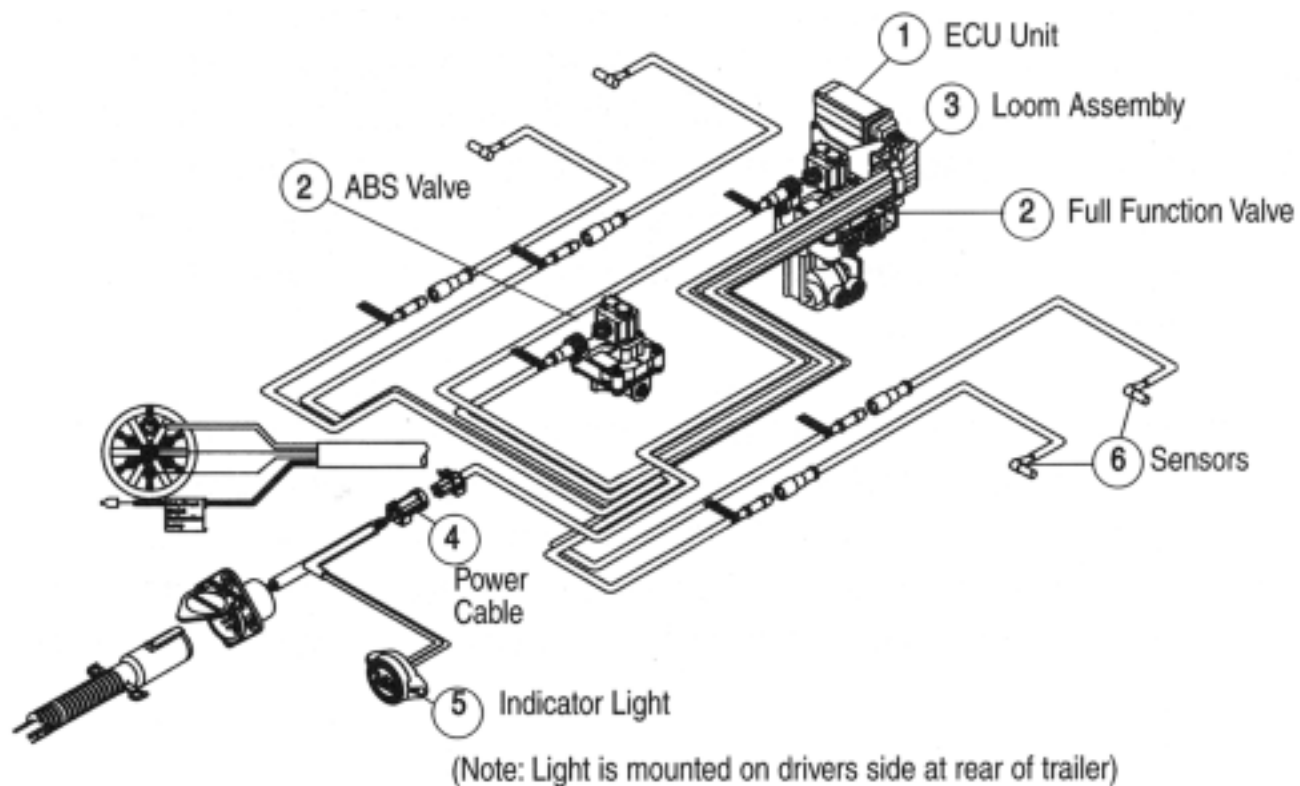

Haldex

**ABS ELECTRIC CONFIGURATION - 2S/1M - MERITOR/WABCO COMPONENTS**

2 Sensor/1 Modulator Valve
(2S/1M) Configuration Shown
Suggested Electrical Diagram
Tandem Suspension,
Two Wheels Sensed

KIT PART NO. 1542014**REPLACEMENT PARTS LIST**

Qty	Part No.	Description
1	4005001010	ECU
1	4493260300	10' Power cable
2	4497130180	6' Sensor Ext cable
1	---	Installation Guide
1	---	End of Line Test

MERITOR WABCO**Enhanced Easy-Stop™**

**Kits are now PLC
Enhanced Easy Stop
and available to OEM
Manufacturers ONLY
SEE PAGES FOLLOWING.**

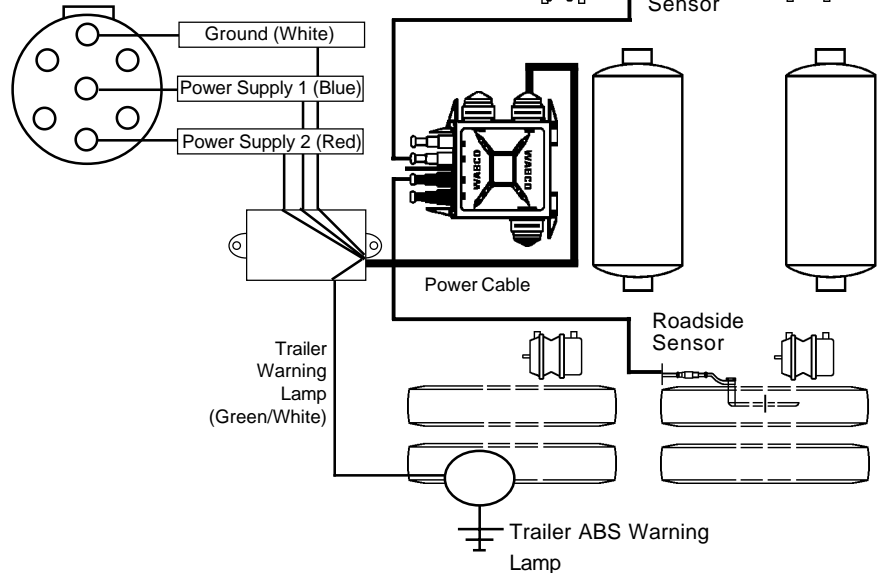
**SUGGESTED ABS AIR CONFIGURATION - 2S/1M
TO FINISH THE AIR BRAKE AFTER ABS.**

Valves & Tanks		
Qty	Part No.	Description
1	110500	Sprg brake c'trol valve
1	6003	Valve mount'g nipple
2	1010330	Air Tank
Air Hoses, 3/8" Diameter, 3/8" Fittings		
4	16628	Hose ass'y, 28" long
4	16648	Hose ass'y, 48" long
Gladhands & Misc. Fittings		
1	1011451	Emerg. gladhand
1	1011452	Service gladhand
6	1010403	Hose separator
2	11304	Frame coupling
2	68NTA-6-6	Female connector
4	269NTA-6-6	Fitting
3	218P-12	3/4" hex head plug
2	218P-6	3/8" hex head plug
2	269-NTA-6-4	Fitting
2	264NTA-6	Fitting
8	3/8"-24x1 1/4"	Cap screw
8	3/8"-24	Lock nut
8	3/8"	Lock washer
4	HT-1068	Tank cushion pads
2	DC604-4	Tank drain valve
8	1011123	1/2" tube clamp
8	#10	Metal screw1
2	6006	3/4" X 3/4" Hex Nipple
1	TL30257Y	Marker light
1	TL52200	Light pigtail
1	TP95172	ABS Label For Lamp

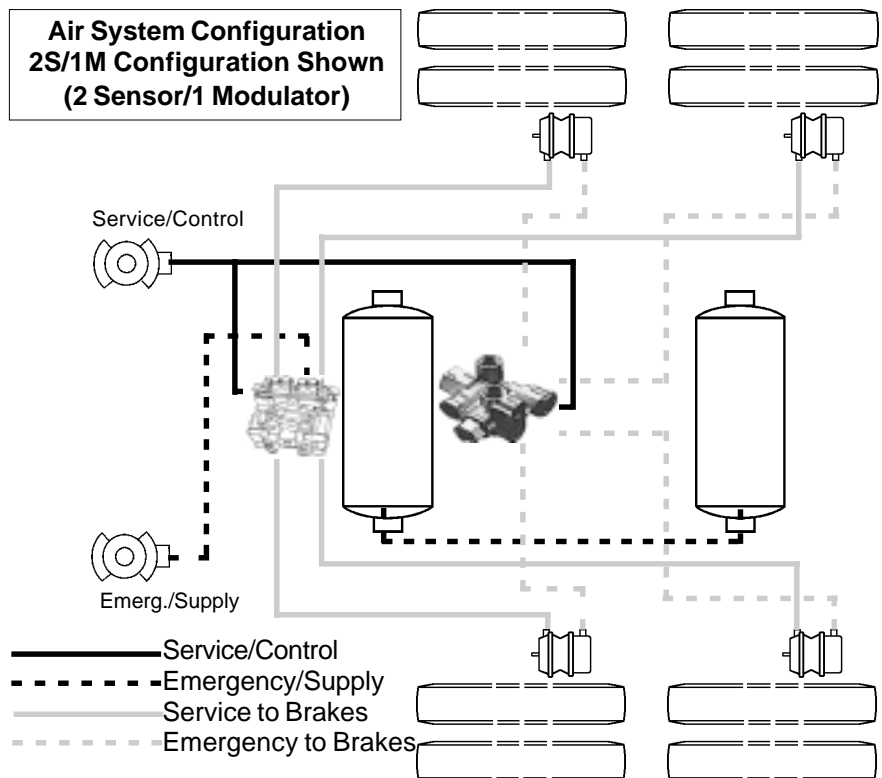
**Air System Configuration
2S/1M Configuration Shown
(2 Sensor/1 Modulator)****Optional:**

1 15-961 Junction Box



ABS ELECTRIC CONFIGURATION - 2S/1M - MERITOR/WABCO COMPONENTS

2 Sensor/1 Modulator Valve
(2S/1M) Configuration Shown
Suggested Electrical Diagram
Tandem Suspension,
Two Wheels Sensed

KIT PART NO. 1542015

REPLACEMENT PARTS LIST FOR		
Qty	Part No.	Description
1	4005001010	ECU
1	PEC4-48	48' Power Ext cable
1	4493260050	1.6' Power Cable
2	4497130180	6' Sensor Ext.cable
1	---	ABS Label For Lamp
1	---	Installation Guide
1	---	End of Line Test

MERITOR WABCO

Enhanced Easy-Stop™

Kits are now PLC
Enhanced Easy Stop
and available to OEM
Manufacturers ONLY
SEE PAGES FOLLOWING.

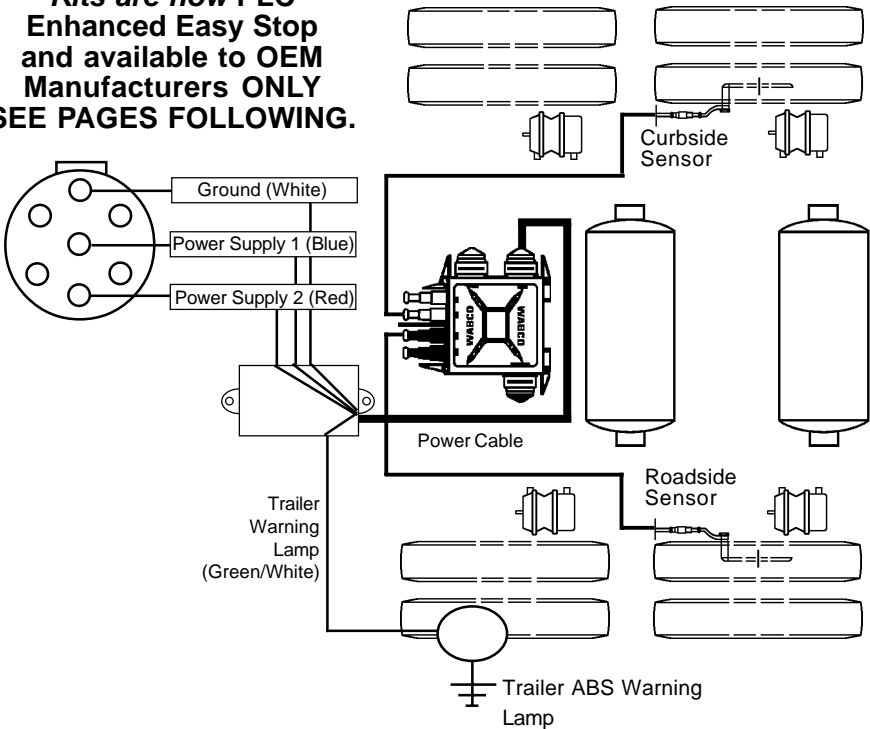

SUGGESTED ABS AIR CONFIGURATION - 2S/1M
TO FINISH THE AIR BRAKE AFTER ABS.

Valves & Tanks		
Qty	Part No.	Description
1	110500	Sprg brake c'trol valve
1	6003	Valve mount'g nipple
2	1010330	Air Tank
Air Hoses, 3/8" Diameter, 3/8" Fittings		
4	16628	Hose ass'y, 28" long
4	16648	Hose ass'y, 48" long
Gladhands & Misc. Fittings		
1	1011451	Emerg. gladhand
1	1011452	Service gladhand
6	1010403	Hose separator
2	11304	Frame coupling
2	68NTA-6-6	Female connector
4	269NTA-6-6	Fitting
3	218P-12	3/4" hex head plug
2	218P-6	3/8" hex head plug
2	269-NTA-6-4	Fitting
2	264NTA-6	Fitting
8	3/8"-24x1 1/4"	Cap screw
8	3/8"-24	Lock nut
8	3/8"	Lock washer
4	HT-1068	Tank cushion pads
2	DC604-4	Tank drain valve
8	1011123	1/2" tube clamp
8	#10	Metal screw1
2	6006	3/4" X 3/4" Hex Nipple
1	TL30257Y	Marker light
1	TL52200	Light pigtail

Air System Configuration
2S/1M Configuration Shown
(2 Sensor/1 Modulator)

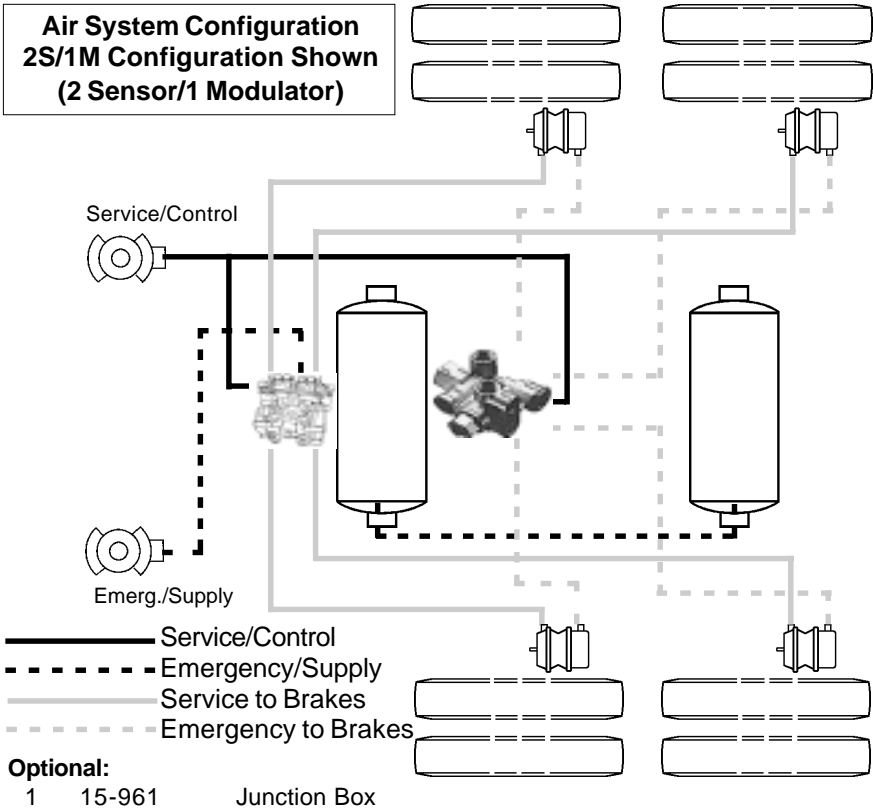

**ABS ELECTRIC CONFIGURATION - 2S/2M - MERITOR/WABCO COMPONENTS**

**2 Sensor/2 Modulator Valve
(2S/2M) Configuration Shown
Suggested Electrical Diagram
Tandem Suspension,
Two Wheels Sensed**

KIT PART NO. 1542023

REPLACEMENT PARTS LIST FOR

Qty	Part No.	Description
1	4005001020	ECU
1	PEC4-48	48' Power Ext Cable
1	4493260050	1.6' Power Cable
2	4497130300	10' Sensor Ext Cable
1	---	ABS Label For Lamp
1	---	Installation Guide
1	---	End of Line Test

MERITOR WABCO

Enhanced Easy-Stop™

**Kits are now PLC
Enhanced Easy Stop
and available to OEM
Manufacturers ONLY
SEE PAGES FOLLOWING.**

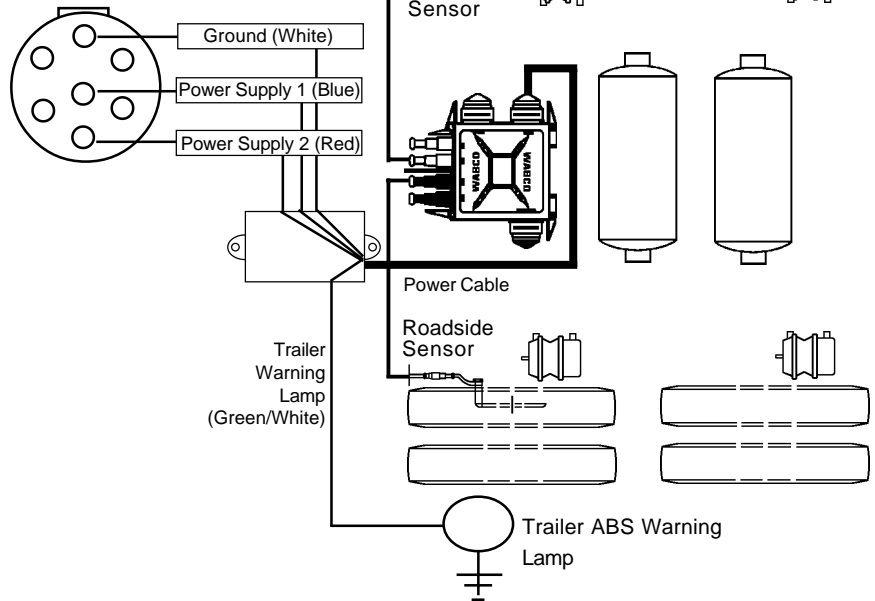
**SUGGESTED ABS AIR CONFIGURATION - 2S/2M
TO FINISH THE AIR BRAKE AFTER ABS.**

Valves & Tanks		
Qty	Part No.	Description
1	110500	Sprg brake c'trol valve
1	6003	Valve mount'g nipple
2	1010330	Air Tank
Air Hoses, 3/8" Diameter, 3/8" Fittings		
4	16628	Hose ass'y, 28" long
4	16648	Hose ass'y, 48" long
Gladhands & Misc. Fittings		
1	1011451	Emerg. gladhand
1	1011452	Service gladhand
6	1010403	Hose separator
2	11304	Frame coupling
2	68NTA-6-6	Female connector
4	269NTA-6-6	Fitting
3	218P-12	3/4" hex head plug
2	218P-6	3/8" hex head plug
2	269-NTA-6-4	Fitting
2	264NTA-6	Fitting
8	3/8"-24x1 1/4"	Cap screw
8	3/8"-24	Lock nut
8	3/8"	Lock washer
4	HT-1068	Tank cushion pads
2	DC604-4	Tank drain valve
8	1011123	1/2" tube clamp
8	#10	Metal screw
2	6006	3/4" X 3/4" Hex Nipple
1	TL30257Y	Marker light
1	TL52200	Light pigtail

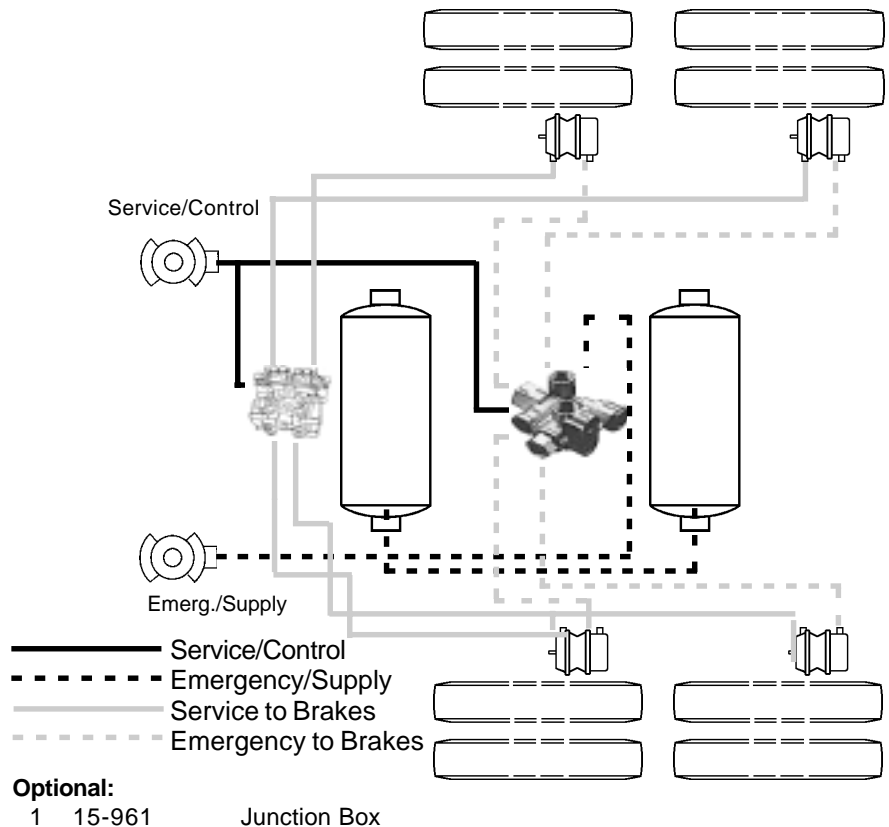



ABS ELECTRIC CONFIGURATION - 4S/2M - MERITOR/WABCO COMPONENTS

4 Sensor/2 Modulator Valve
(4S/2M) Configuration Shown
Suggested Electrical Diagram
Tandem Suspension,
Four Wheels Sensed

KIT PART NO. 1544023

REPLACEMENT PARTS LIST		
Qty	Part No.	Description
1	4005001030	ECU
1	PEC4-48	48' Power Ext Cable
1	4493260050	1.6' Power Cable
4	4497130180	6' Sensor Ext cable
1	---	ABS Label For Lamp
1	---	Installation Guide
1	---	End of Line Test

MERITOR WABCO

Enhanced Easy-Stop™

Kits are now PLC
Enhanced Easy Stop
and available to OEM
Manufacturers ONLY
SEE PAGES FOLLOWING.

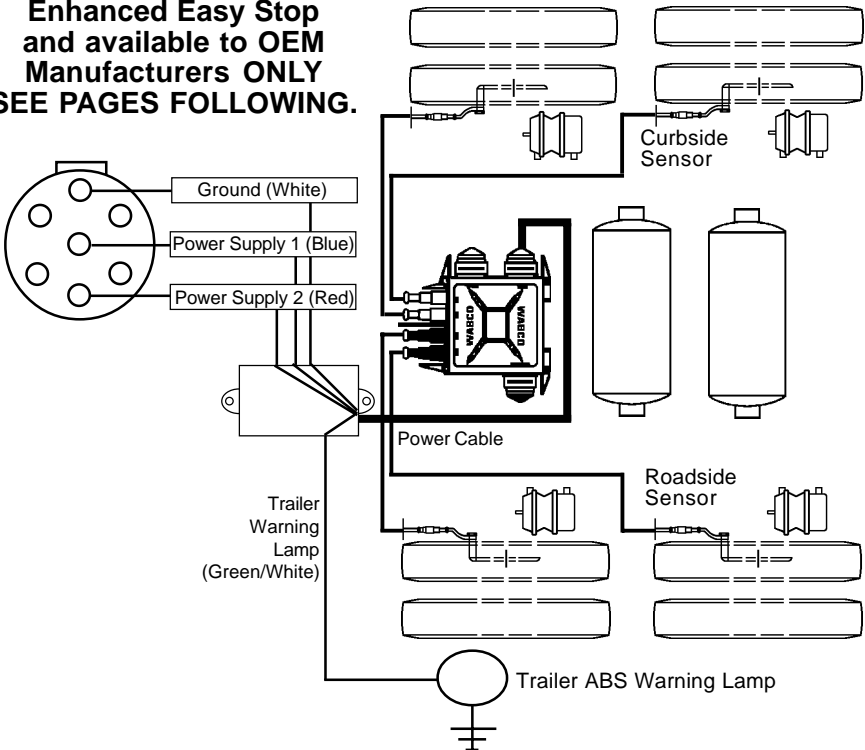

SUGGESTED ABS AIR CONFIGURATION - 4S/2M
TO FINISH THE AIR BRAKE AFTER ABS.

Valves & Tanks		
Qty	Part No.	Description
1	110500	Sprg. brake c'trol valve
1	6003	Valve mount'g nipple
2	1010330	Air Tank
Air Hoses, 3/8" Diameter, 3/8" Fittings		
4	16628	Hose ass'y, 28" long
4	16648	Hose ass'y, 48" long
Gladhands & Misc. Fittings		
1	1011451	Emerg. gladhand
1	1011452	Service gladhand
6	1010403	Hose separator
2	11304	Frame coupling
2	68NTA-6-6	Female connector
4	269NTA-6-6	Fitting
3	218P-12	3/4" hex head plug
2	218P-6	3/8" hex head plug
2	269-NTA-6-4	Fitting
2	264NTA-6	Fitting
8	3/8"-24x1 1/4"	Cap screw
8	3/8"-24	Lock nut
8	3/8"	Lock washer
4	HT-1068	Tank cushion pads
2	DC604-4	Tank drain valve
8	1011123	1/2" tube clamp
8	#10	Metal screw
2	6006	3/4" X 3/4" Hex Nipple
1	TL30257Y	Marker light
1	TL52200	Light pigtail

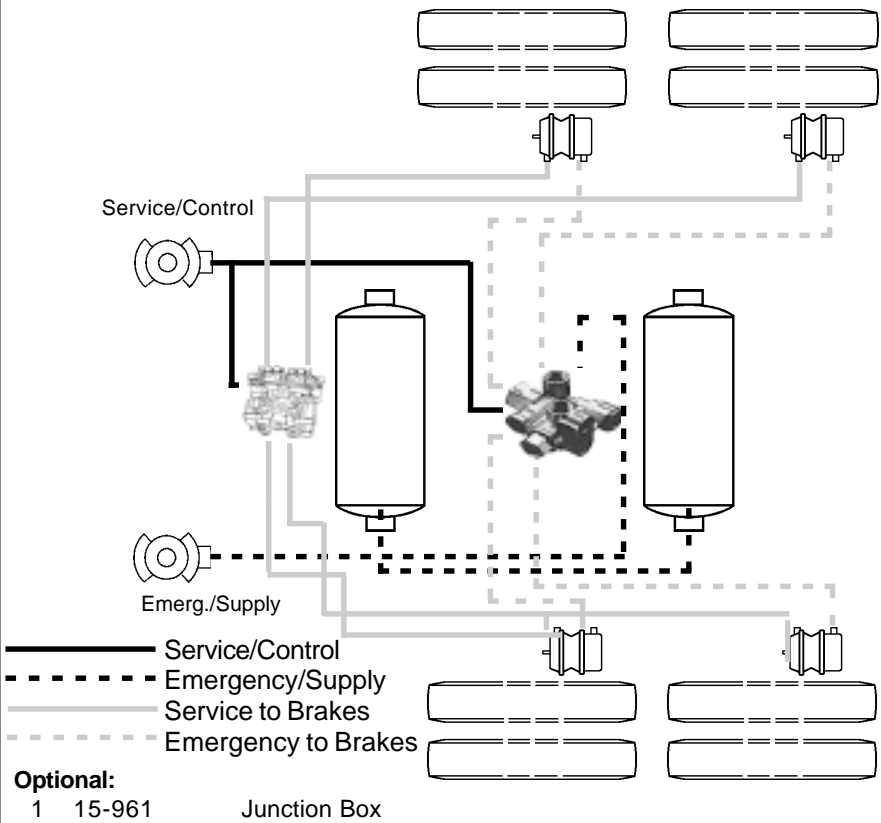

**ABS ELECTRIC CONFIGURATION - 4S/2M - MERITOR/WABCO COMPONENTS**

4 Sensor/2 Modulator Valve
(4S/2M) Configuration Shown
Suggested Electrical Diagram
Tandem Suspension,
Four Wheels Sensed

KIT PART NO. 1544222

REPLACEMENT PARTS LIST		
Qty	Part No.	Description
1	4005001030	ECU
1	4493260300	Power Cable 10 ft
4	4497130300	10' Sensor Ext Cable
1	---	ABS Label For Lamp
1	---	Installation Guide
1	---	End of Line Test

MERITOR WABCO**Enhanced Easy-Stop™**

Kits are now PLC
Enhanced Easy Stop
and available to OEM
Manufacturers ONLY
SEE PAGES FOLLOWING.

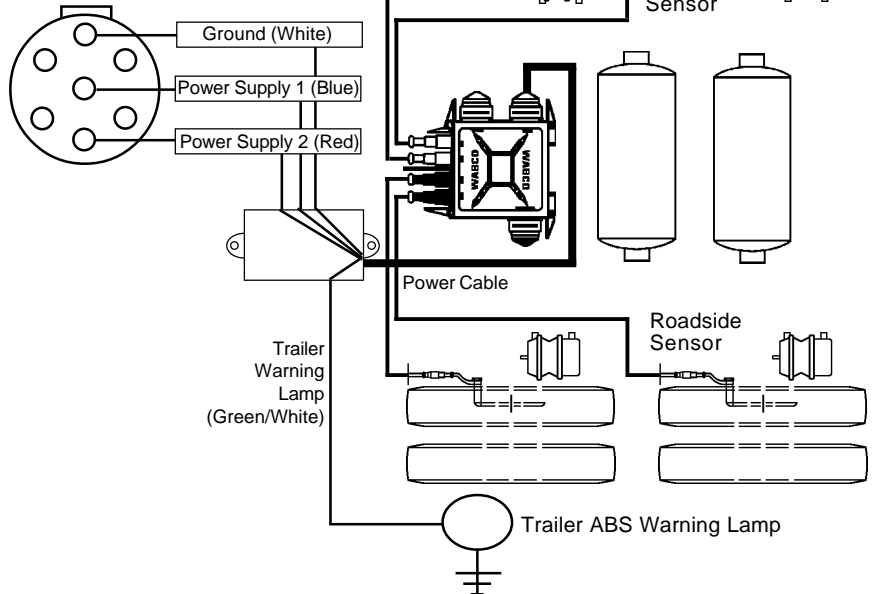
**SUGGESTED ABS AIR CONFIGURATION - 4S/2M
TO FINISH THE AIR BRAKE AFTER ABS.**

Valves & Tanks		
Qty	Part No.	Description
1	110500	Sprg. brake c'trol valve
1	6003	Valve mount'g nipple
2	1010330	Air Tank
Air Hoses, 3/8" Diameter, 3/8" Fittings		
4	16628	Hose ass'y, 28" long
4	16648	Hose ass'y, 48" long
Gladhands & Misc. Fittings		
1	1011451	Emerg. gladhand
1	1011452	Service gladhand
6	1010403	Hose separator
2	11304	Frame coupling
2	68NTA-6-6	Female connector
4	269NTA-6-6	Fitting
3	218P-12	3/4" hex head plug
2	218P-6	3/8" hex head plug
2	269-NTA-6-4	Fitting
2	264NTA-6	Fitting
8	3/8"-24x1 1/4"	Cap screw
8	3/8"-24	Lock nut
8	3/8"	Lock washer
4	HT-1068	Tank cushion pads
2	DC604-4	Tank drain valve
8	1011123	1/2" tube clamp
8	#10	Metal screw
2	6006	3/4" X 3/4" Hex Nipple
1	TL30257Y	Marker light
1	TL52200	Light pigtail

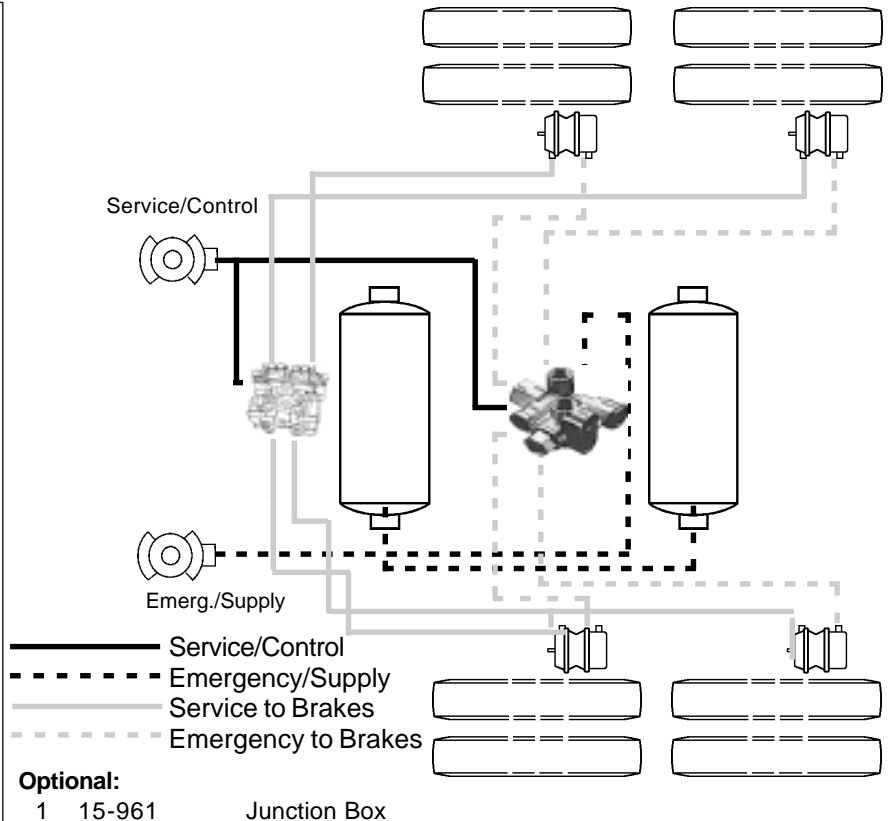



ABS ELECTRIC CONFIGURATION - 4S/2M - MERITOR/WABCO COMPONENTS

4 Sensor/2 Modulator Valve
(4S/2M) Configuration Shown
Suggested Electrical Diagram
Tandem Suspension,
Four Wheels Sensed

KIT PART NO. 1544223

REPLACEMENT PARTS LIST		
Qty	Part No.	Description
1	4005001030	ECU
1	4493260300	10' Power Cable
2	4497130300	10' Sensor Ext cable
2	4497130180	6' Sensor Ext cable
1	---	ABS Label For Lamp
1	---	Installation Guide
1	---	End of Line Test



Enhanced Easy-Stop™

Kits are now PLC
Enhanced Easy Stop
and available to OEM
Manufacturers ONLY
SEE PAGES FOLLOWING.

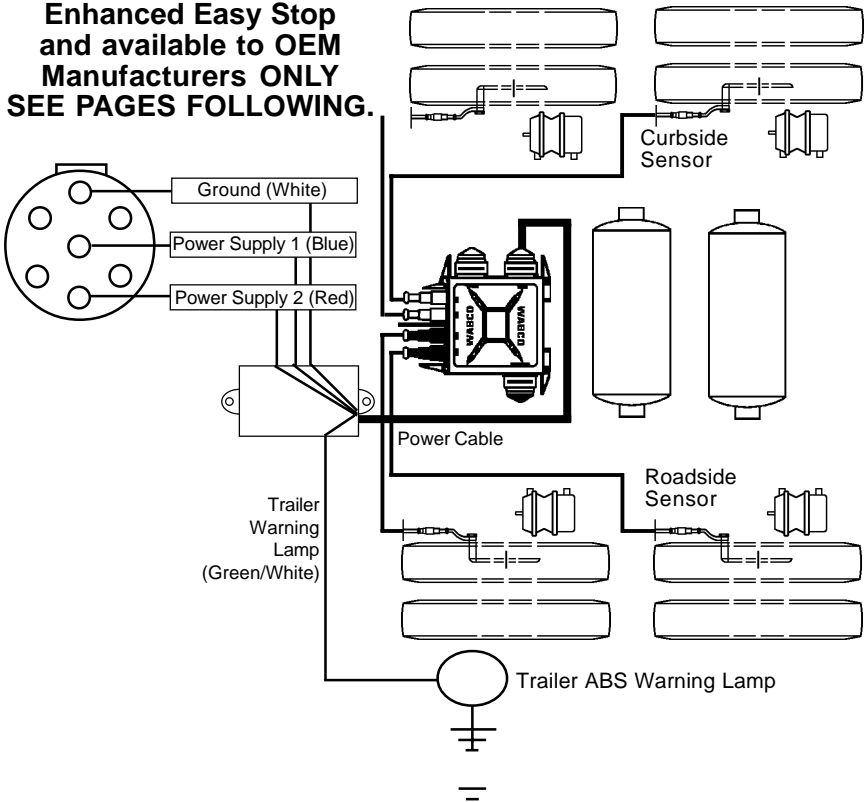

SUGGESTED ABS AIR CONFIGURATION - 4S/2M
TO FINISH THE AIR BRAKE AFTER ABS.

Valves & Tanks		
Qty	Part No.	Description
1	110500	Sprg. brake c'trol valve
1	6003	Valve mount'g nipple
2	1010330	Air Tank
Air Hoses, 3/8" Diameter, 3/8" Fittings		
4	16628	Hose ass'y, 28" long
4	16648	Hose ass'y, 48" long
Gladhands & Misc. Fittings		
1	1011451	Emerg. gladhand
1	1011452	Service gladhand
6	1010403	Hose separator
2	11304	Frame coupling
2	68NTA-6-6	Female connector
4	269NTA-6-6	Fitting
3	218P-12	3/4" hex head plug
2	218P-6	3/8" hex head plug
2	269-NTA-6-4	Fitting
2	264NTA-6	Fitting
8	3/8"-24x1 1/4"	Cap screw
8	3/8"-24	Lock nut
8	3/8"	Lock washer
4	HT-1068	Tank cushion pads
2	DC604-4	Tank drain valve
8	1011123	1/2" tube clamp
8	#10	Metal screw
2	6006	3/4" X 3/4" Hex Nipple
1	TL30257Y	Marker light
1	TL52200	Light pigtail

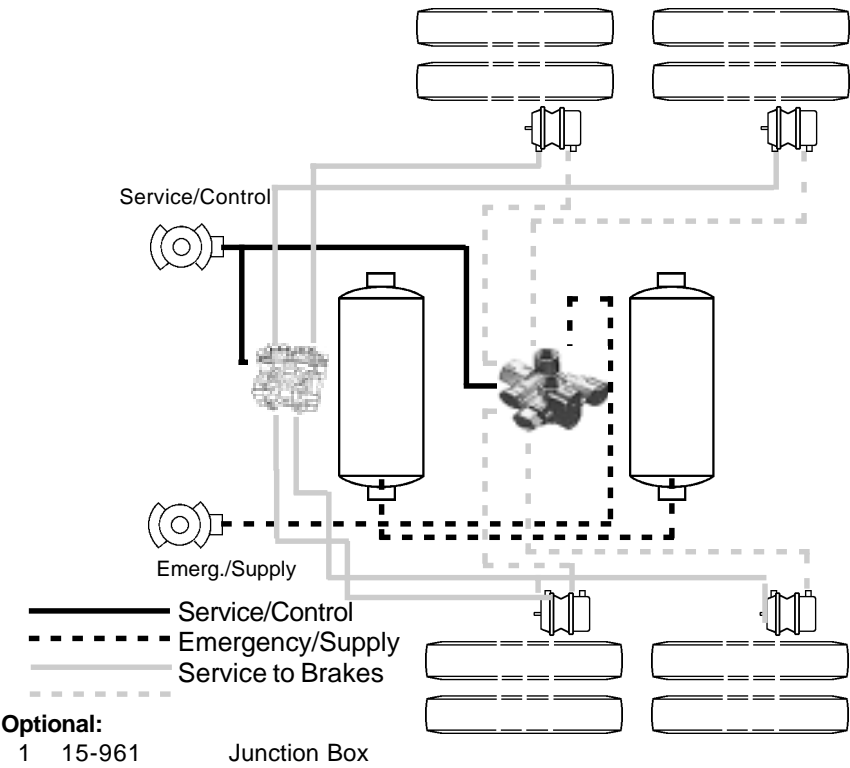



EASYSTOP™ TO ENHANCED EASYSTOP™ CONVERSION KITS

Differences Between Easy-Stop and Enhanced Easy-Stop 2S/2M, 4S/2M and 4S/3M

There are some changes to Enhanced Easy-Stop that you need to be aware of before you begin the installation:

- Enhanced Easy-Stop includes Power Line Communication (PLC) function.
- The ECU/dual modulator valve assembly must be mounted as one unit.
- The LED on top of the ECU has been eliminated.
- Blink Code Diagnostics through external or ABS indicator lamp.

Differences Between Easy-Stop and Enhanced Easy-Stop 2S/1M Basic

There are some changes to Enhanced Easy-Stop that you need to be aware of before you begin the installation:

- Enhanced Easy-Stop includes Power Line Communication (PLC) function.
- The ECU/single modulator valve assembly may be mounted as one unit or the ECU and the valve may be mounted or serviced separately.
- The assembly is shipped with valve cable between the ECU and valve disconnected from the ECU.
- The LED on top of the ECU has been eliminated.
- Blink Code Diagnostics through external or ABS indicator lamp.
- The control port on the Enhanced Easy-Stop single modulator valve is 3/8-inch — on previous versions it was 1/4-inch.

R955320

4S/2M ECU plus
old style/new style power cord
adapter--no diagnostic cable.

R955321

4S/2M ECU plus
old style/new style power cord
adapter--with diagnostic "Y" cable.

R955322

ECU/Modulator Valve Assembly,
2S/1M. ***DOLLY USE ONLY***

R955344

2S/1M ECU plus
old style/new style power cord
adapter with power line adapter
for trailer applications.

MERITOR WABCO



MERITOR WABCO ABS ENHANCED EASYSTOP™ CONVERSION KITS

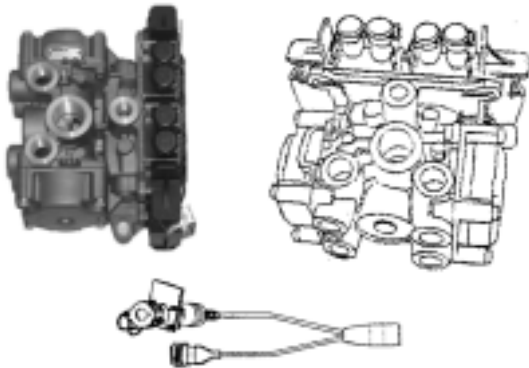

MERITOR WABCO

Meritor WABCO 2S/2M and 4S/2M Enhanced Easy-Stop™ Replacement Kit for ECU/Modulator Valve Assembly *with* external diagnostics "Y" cable

Part No. R955321

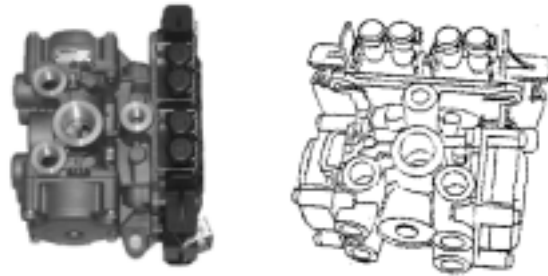

MERITOR WABCO

Meritor/WABCO ECU/Valves
Application: Use on 2S/1M, 2S/2M & 4S/2M systems *without* external diagnostic cable.

Part No. R955320



MERITOR WABCO

Meritor WABCO Enhanced Easy-Stop™ Trailer ABS Replacement Kits for Easy-Stop™ ECU/Modulator Valve Assembly, 2S/1M, with power line adapter.

For Trailer Applications Only (NO Dolly)

Replaces Meritor Part No. 4725000110, 4725000210.

Part No. R955344



MERITOR WABCO

Meritor WABCO Enhanced Easy-Stop™ Trailer ABS Replacement Kits for Easy-Stop™ ECU/Modulator Valve Assembly, 2S/1M.

DOLLY USE ONLY

Replaces Meritor Part No. 4725000110

Part No. R955322

**ENHANCED EASYSTOP™ PARTS STOCKED**

(Add "S" to OE number for the aftermarket number)

PART NUMBER	DESCRIPTION
S4005001010	ECU Only (figure 1)
S4005001030	ECU Only (figure 2)
S4493260100	3.3 ' Power Cable (figure 3)
S4493260300	10' Power Cable (figure 3)
S4493260470	15.4' Power Cable (figure 3)
S4493641500	13.1' / 9.8' Power "Y" Cable (figure 4)
S4493641530	20' / 10' Power "Y" Cable (figure 4)

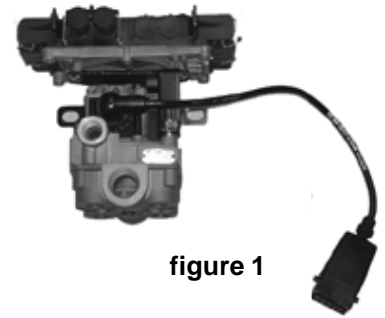

figure 1



figure 2



figure 3



figure 4

Sensors and Sensor Extensions are Universal to Both Systems

ArvinMeritor.



MISCELLANEOUS EASYSTOP™ COMPONENTS



MERITOR WABCO

Meritor/WABCO	
Part No.	Description
S4493151500	ABS Power Cable, 4 Cond., 15m (49 ft.)



MERITOR WABCO

Meritor/WABCO	
Part No.	Description
SA13237L1130 (Pre-PLC)	ABS Diagnostic Cable with Tool



MERITOR WABCO

Part No.	Description
S8946049440	ABS Power Cable, 1m (39.37") With industry standard plug

**Your Source
For Complete
ABS
Systems and Parts**

Meritor/WABCO

Haldex

Bendix



Bendix

1810000
1810002
1810003

MERITOR WABCO

1810001

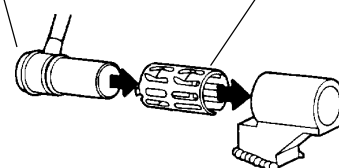

Sensor Holder
(welded to axle spindle)

Common ABS Components

Part No.	Description
1810000	Bendix (Eaton/Bosch) 1' Sensor
1810001	Friction Bushing
1810002	Meritor/Wabco 1' Sensor
1810003	Meritor/Wabco 3' Sensor



MERITOR WABCO

Meritor Wabco ABS	
Part No.	Description
R955212	ABS Relay Valve
Second modulator valve for use on 2S/2M and 4S/2M Systems	



MERITOR WABCO

Meritor/WABCO	
Part No.	Description
S4497130180	Sensor Extension Cable, 1.78m (6 ft.)
S4497130300	Sensor Extension Cable, 3.00m (10 ft.)



MERITOR WABCO

Right Angle (90°) Sensors		
Part Number	Feet	Meters
R955342	6.6	2.0



MISCELLANEOUS HALDEX & BENDIX ABS COMPONENTS

Modular Valve

Part No. AL364040

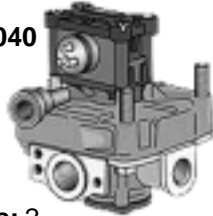

Number of Ports: 2
Mounting Port Size: 1/2 inch
Delivery Port Size: 3/8 inch
Mount: Reservoir
Application: 24mm 12 volt Solenoid

Trailer ABS Modular Valve - Less ECU

- ECU and bracket may need to be transferred from existing valve.
- 27mm, 12 volt valves require A41111000 adapter ring and 24mm replacement valve.

FFABS Valve

Part No. AL430611



Number of Delivery Ports: 4
Delivery Ports Size: 3/8 inch
Pipe Thread: 1/2 inch NPT
ID Exhaust Cover: Black - Service Brake Priority

Trailer Service Brake Priority FFABS Valve

- ECU & bracket may need to be transferred from existing valve.
- Use inlet filter A906960 in off-highway applications.

FFABS Valve

Part No. AL430614



Number of Delivery Ports: 4
Delivery Ports Size: 3/8 inch
Pipe Thread: 3/4 inch NPT
ID Exhaust Cover: Black - Service Brake Priority

Trailer Service Brake Priority FFABS Valve

- ECU & bracket may need to be transferred from existing valve.
- Use inlet filter A906960 in off-highway applications.

Electronic Control Unit



Trailer ABS Modal ECU & Box Assembly

- Power Cord Adapter AL914627.
- Pre-March 1998 Modal Systems do not include interchange with Post-March 1998 Systems.

Part No. AQ154113

Pin Measurements:

- **Application/Notes:**
 Service As Assembly

**Your Source
 For Complete
 ABS
 Systems and Parts
 Meritor/WABCO
 Haldex
 Bendix**

Electronic Control Unit

Part No. AL919302



Trailer ABS, MOD 1 ECU - SLH-A5-19 Pin

- OEM part no. is located on top of ECU.
- Post mandate ECU's include bail latch.

Pin Housing Dimensions:

3-1/2 inch Height x 5-3/8 inch Width

Application/Notes: 2 Keys - Diagonal



Bendix Pressure Modulator Valve

Part No.	System
300073	Modular 12V ABS Valve

Loom Assembly

Trailer ABS 2S/1M - Mod 1 - SLH-A5 or SLH-A8 - 19 Pin Loom Assembly

- 1.5 foot (0.5m) power cord adapter.
- OEM part number is located on loom decal

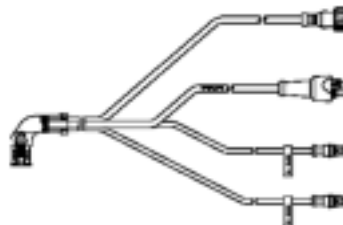

Part No. AL902104

Relay Valve Cable Extension



Trailer ABS Extension for Relay Valve Cable Extension

- Cable includes 100317N junction connector.

Length: 6 Feet (2M)

Part No. AL919813