

Universal Spider Monitor Arm
UTMM-S1

Assembly Instructions



How can we improve our assembly instructions?
Your comments and suggestions are important to us.
Please e-mail us at: support@versatables.com.

Hardware & Parts List

Universal Spider Monitor Arm

Monitor Bracket



Qty:1

UTMM Pole



Qty:1

8mm Machine Screw



Qty:4

Lock Nut



Qty:1

Exploded View



Monitor Arm



16" Pole



Lock Nut

Step 1

Wood Grommet

Remove Wood Grommet.



Step 2

16" Pole

Insert 16" Pole to Grommet cutout. From underneath the surface screw on Lock Nut, teeth facing upward. Then turn the Pole to tighten and place cutout where desired.

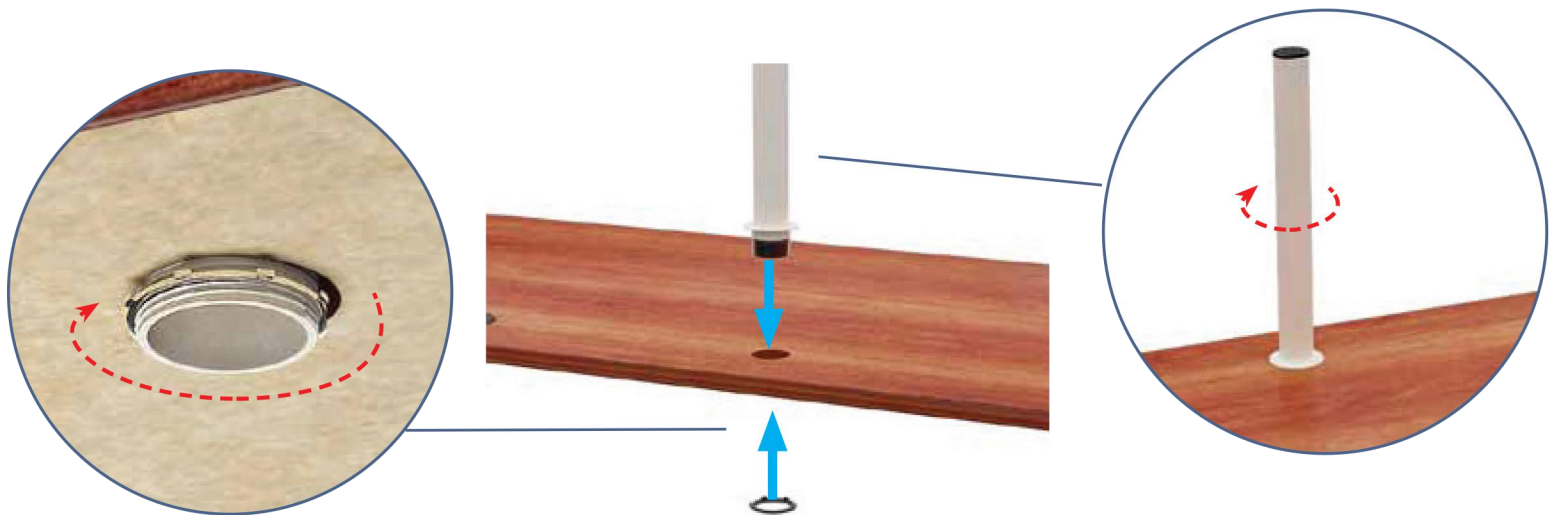

Step 3 Monitor Arm

Slide Monitor Arm on to 16" Pole and tighten in place with 'T' knob.

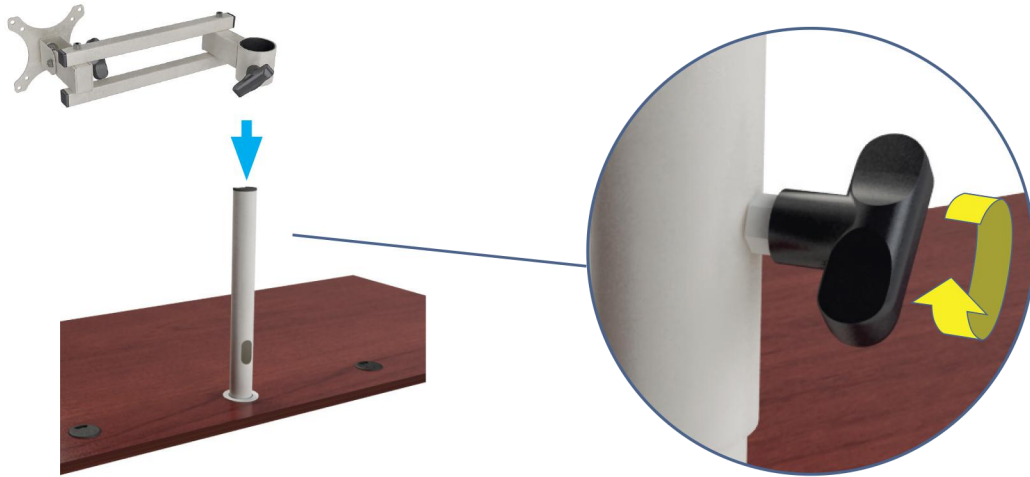

Step 4 LCD Monitor

Attach LCD monitor to the Vesa Plate with (4) 8mm Phillips Machine Screws.

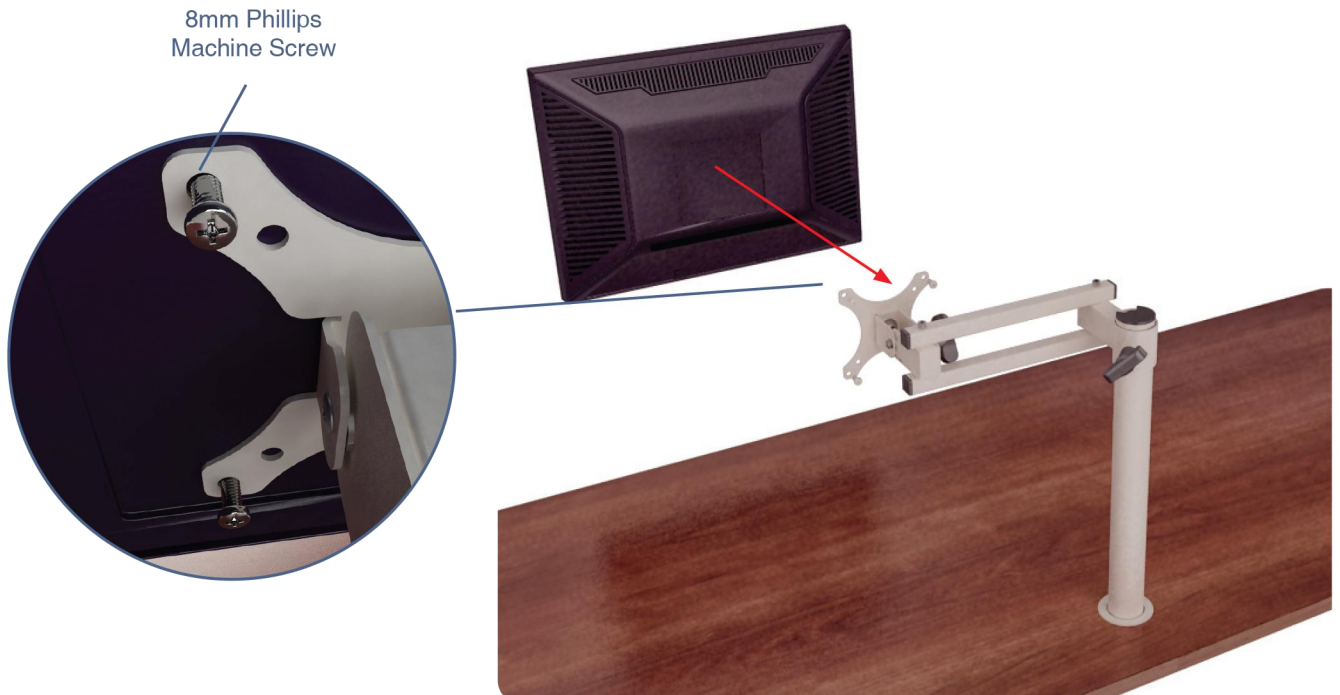

How can we improve our assembly instructions?
Your comments and suggestions are important to us.
Please e-mail us at: support@versatables.com.