



VINCE
CAMUTO

WATCH INSTRUCTIONS AND
5 YEAR LIMITED WARRANTY

Introducing...



THE VINCE CAMUTO WOMEN'S TIMEPIECE COLLECTION

is an extension of the Vince Camuto brand's unique commitment to contemporary design, luxe quality and attention to rich detail. With a focus on classic designs with a fresh, innovative edge the Vince Camuto women's timepiece collection is jewelry inspired, polished, at times oversized; and utilizes premium finishes in rose gold, gunmetal and brushed metals to compliment a trend-driven wardrobe. Style details include the signature pyramid stud, a hardware detailed crown, layered dials, brilliant Swarovski® crystals and lustrous ceramic links. The Vince Camuto timepieces are sophisticated, eye-catching and elegant with modern attitude.

THE VINCE CAMUTO MEN'S TIMEPIECE COLLECTION

appeals to the man with a strong sense of individual style. The men's timepieces, inspired by land, air and sea, carefully consider authentic utility and are crafted with specialty details and sophisticated movements that are atypical in the current watch market. Land gave way to masculine timepieces inspired by the art of automobiles and motorcycles. Air inspired a mechanical design direction, including vintage airplanes and parts. Sea led to innovative wristwatches inspired by the ocean, unexpected materials and colors. Vintage inspired case shapes, mixed materials; including solid stainless steel, silicon and aluminum, paired with textured and layered dials. 21-jewel automatic movements, complex flyback movements and exhibition casebacks are signature features of the Vince Camuto men's timepiece collection.

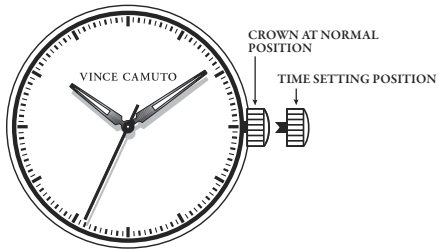

SETTING THE TIME

1. Pull the crown out to the time setting position.
2. Turn the crown to set hour and minute hands.
3. When the crown is pushed back to the normal position, second hand begins to run.

NOTE: Never pull the Crown when the watch is wet.

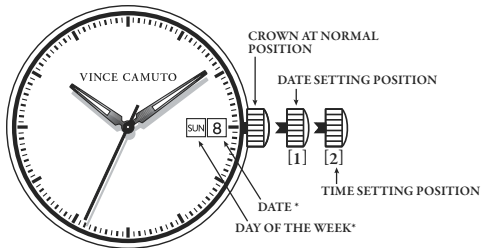

*NOTE: *Date & Day of the week position may be located at different position depends on models. Day of the week may not be available.*

SETTING THE TIME

1. Pull the crown out to the 2nd position.
2. Turn the crown to set hour and minute hands.
3. When the crown is pushed back to the normal position, second hand begins to run.

NOTE: Never pull the Crown when the watch is wet.

SETTING THE DATE

1. Pull the crown out to the 1st position.
2. Turn the crown counter-clockwise to set the date.
3. After the date has been set, push the crown back to the normal position.

SETTING THE DAY **(If your watch has a Day Window)*

1. Pull the crown out to the 1st position.
2. Turn the crown clockwise to set the day of the week.
3. After the day of the week has been set, push the crown back to the normal position.

*NOTE: * If the date and/or day of the week is set between the hours of around 9:00 PM and 1:00 AM, it may not change on the following day.*

6P29 *An Analog Quartz watch which was designed with multi bands, to enhance perfection. The hands in the small displays show Day, Date, and 24 hour time.*

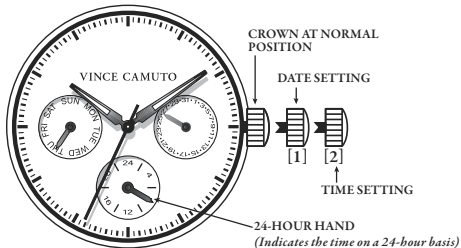

NOTE: Actual watch case may be different. Look for the position of the Day, Date, Month or 24 Hour Sub Dials to see if this is your watch.

SETTING THE TIME

1. Pull the crown out to the 2nd position and rotate the crown clockwise or counter-clockwise until the desired Time and Day are obtained.
2. Push the crown back in to the normal position to re-engage time keeping.

NOTE: Never pull the Crown when the watch is wet.

SETTING THE DATE

1. Pull the crown out to the 1st position.
2. Turn the crown counter-clockwise to set the date.
3. After the date has been set, push the crown back to the normal position.

NOTE: The 24 hour (Military Time) adjusts automatically when the Time is set.

VX 45

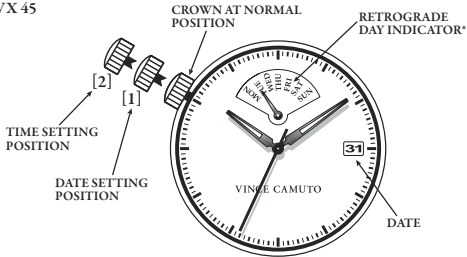

*NOTE: *After the day hand reaches the last day of the week, the hand will jump to the first day of the week.*

SETTING THE TIME

1. Pull crown out to the 2nd position when the second hand is at the 12 o'clock position.
2. Turn clockwise to advance the hour and minute hands past 12:00 AM.
Doing so will advance the date to the next date.
3. Set the hour and minute hands to the desired time taking AM or PM into consideration. When setting the minute hand, advance it 4 to 5 minutes ahead of the desired time and then turn it back to the exact time.
4. When the crown is pushed back to the normal position, second hand begins to run.

NOTE: Never pull the Crown when the watch is wet.

SETTING THE DATE

1. Pull the crown out to the 1st click position.
2. Turn the crown counter-clockwise to set the date.
3. Turn the crown clockwise to set day of the week.
4. After the date has been set, push the crown back to the normal position.

*NOTE: *Do not set the day and date between 9:00 p.m. and 4:00 a.m. Otherwise, it may not turn properly. After the day hand reaches the last day of the week, turn the crown clockwise and the hand will return to the first day of the week.*

GP 50

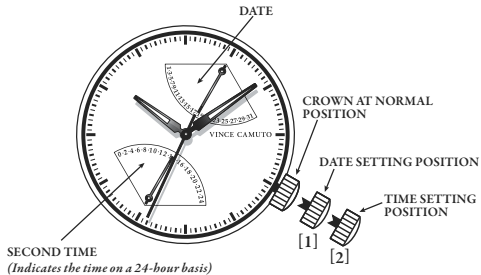

SETTING THE TIME

1. Pull the crown out to the 2nd position.
2. Turn the crown to set hour and minute hands.
3. When the crown is pushed back to the normal position, second hand begins to run.

NOTE: Never pull the Crown when the watch is wet.

SETTING THE DATE

1. Pull the crown out to the 1st position.
2. Turn the crown clockwise to set the date.
3. After the date has been set, push the crown back to the normal position.

*NOTE: *If the date is set between the hours of around 9:00 PM and 2:00 AM, the date may not change on the following day.*

SETTING THE SECOND TIME (24 hours)

1. Pull the crown out to the 1st position.
2. Turn the crown counter-clockwise to set the second time(24h).
3. After the second time(24h) has been set, push the crown back to the normal position.

VD 54 B

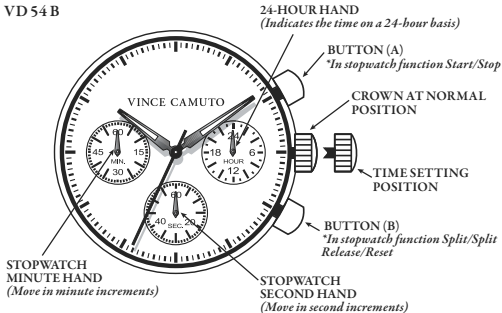

Before setting the time, check if the stopwatch second and minute hands are in the "60"(12 o'clock) position. If either of the stopwatch hands are not in the "60" position, reset them following the procedure below:

1. Pull out the crown.
2. Press button **A** or **B** to reset the stopwatch second and minute hands to "60" position. By pressing button **A** the hands move counter clockwise. By pressing button **B** the hands move counter clockwise.
3. Push the crown back in to the normal position.

SETTING THE TIME

1. Pull out the crown when the second hand is at the 12 o'clock position. The second hand will stop on the spot. Do not press any buttons, otherwise the chronograph hands will move.
2. Turn the crown to set the hour, minute and the 24-hour hands to the desired time. As the hour hand moves, the 24-hour hand moves correspondingly. When setting the hour hand, check if the 24-hour hand is set properly.
3. Push the crown back in to the normal position to re-engage time keeping.

NOTE: Never pull the Crown when the watch is wet.

HOW TO USE THE STOPWATCH

The measured time indicated by the stopwatch hands, move independently of the center and 24-hour hands. The stopwatch can measure up to 60 minutes in seconds.

* Seconds elapsed up to one minute (6 o'clock eye)

* Minutes elapsed up to one hour (9 o'clock eye)

Before using the stopwatch, reset the stopwatch hands to the "60"(12 o'clock) position.

STANDARD STOPWATCH MEASUREMENT:

1. Press button **A** to start timing.
2. Press button **A** to stop timing. Restart and stop of the stopwatch can be repeated as many times as necessary by pressing button **A**.
3. Press button **B** to reset.

SPLIT TIME MEASUREMENT:

1. Press button **A** to start timing.
2. Press button **B** to stop timing.
3. Press button **A** to stop timing of second event.
4. Press button **B** to view time of second event.
5. Press button **B** to reset.

WATER RESISTANCE

If your watch is water resistant, the watch is tested to be water resistant to 3-5 atmospheres (100-165 feet).

NOTE: Over time, the gaskets of the case may become worn and reduce the water resistance of the watch. A trained specialist should change the gaskets and the O-ring each time the battery is changed. To avoid any unwanted condensation, watches of all specifications (water resistant or not) should not be exposed to extreme temperatures such as cold or heat.

CHANGING THE BATTERY

Replace batteries when the watch becomes slow or does not operate.

Replace with same or equivalent.

NOTE: Battery change should be performed by a qualified technician who should also check the condition of the gaskets at the same time.

BATTERIES ARE NOT COVERED UNDER WARRANTY.

AUTOMATIC MOVEMENT

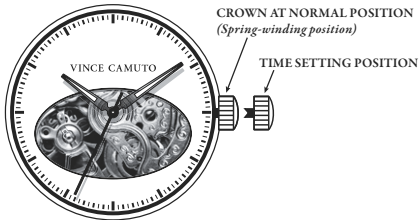

THE AUTOMATIC COLLECTION

The Automatic Self-Winding Mechanical Watch (since it is not operating by a Battery) must be wound at least six or seven times before you wear it. After that, your daily activity should wind the watch sufficiently to keep it running at night when it is not being worn. If your normal daily activity is not sufficient, occasional supplementary manual winding may be necessary. It is suggested that your mechanical watch be cleaned and oiled periodically to insure optimum performance. As this is a mechanical watch, quartz watch accuracy cannot be expected.

SETTING THE TIME

1. Pull the crown out to the time setting position.
2. Turn the crown to set hour and minute hands.
3. When the crown is pushed back to the normal position, second hand begins to run.

NOTE: Never pull the Crown when the watch is wet.

DIAGRAMS FOR ADJUSTABLE BRACELET WATCHES

1. CLASP EXTENDER

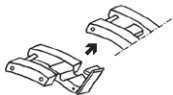

2. ONE SCREW SYSTEM

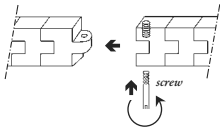

3. TWO SCREW SYSTEM

Screw in one at a time

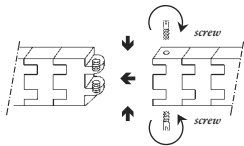

4. CONNECTION SYSTEM

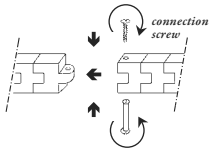

5. METAL INSERT

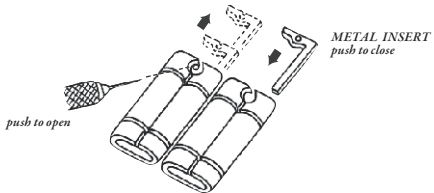

6. HAIRCLIP PIN

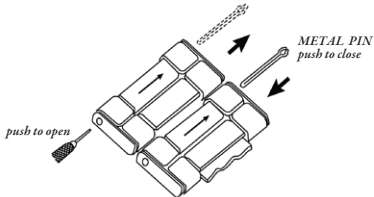

Turn over the watch to look for arrows on the underside of the links, showing you which way you need to push the pin out of the link. Use a pin remover tool to push out the "hair clip pin" from the hole located on the side of the link. After the links are removed, simply follow these steps in reverse to re-assemble the bracelet.

7. PIN & TUBE 1



Side view "B" of Link



Side view "A" of Link

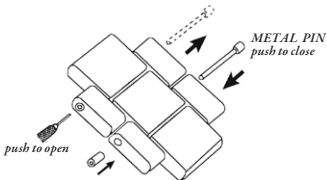

Check the side edge of the watch link, to determine which side of the link is "A" or "B". Take a pin remover tool and push out the pin from the hole located on side "B". After the desired links are removed, simply follow these steps in reverse to re-assemble the bracelet.

8. PIN & TUBE 2

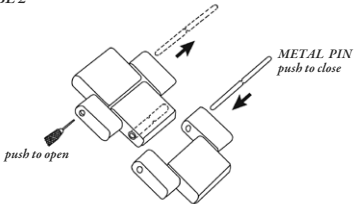

In order to adjust links for this watch construction, you must switch the pin on the tool kit to the longest pin (approximately 10mm long) found under the tool kit. Then use the pin remover tool to push out the pins from either side of the links. After the desired links are removed, simply follow these steps in reverse to re-assemble the bracelet.

9. SLIDING BAR

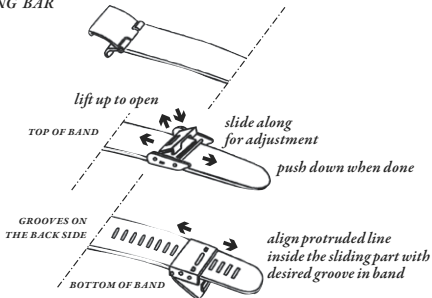

10. FOLD-OVER BUCKLE

Compress the push pin, and put the ends into the suitable holes along the buckle.

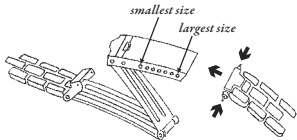

EXTENDER TO MAXIMIZE THE SIZE OF THE FOLD-OVER CLASP FOR A LARGER WRIST (For a Smaller Size Wrist discard the Extender)

If your watch did not come with the Extender, please call with the style number (which is engraved on the case back) and the Extender will be shipped to you.

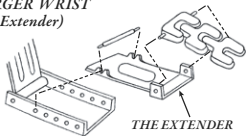

11. QUICK-RELEASE BUTTERFLY CLASP

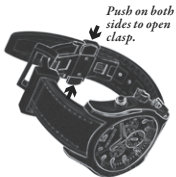

Fitting the watch may take some trial and error. Start by identifying the small pin that's attached to the back of the buckle. Insert the pin into a hole in the strap. For thicker wrists use the holes closer to the end of the strap or, for thinner wrists, closer to the watch.

Dear Customer:

Help your watch/jewelry retailer protect our environment by properly recycling the button cell battery in your watch. Professional jewelers and watch retailers are best equipped to replace the battery in your watch without damage to the watch case and movement inside. They have the specialized tools and experience to do the job right. Inexperienced people can scar the case and damage the water resistant seal – voiding your warranty. It is important to recycle your watch battery in an environmentally safe way. Watch batteries contain very small amounts of mercury, which is required to prevent corrosion of the battery and damage to your watch. There is no danger to you or your watch from the mercury because it is in the sealed battery. But you need to recycle your watch battery properly. Your professional watch/jewelry retailer is the best person to do this for you. These professionals collect used batteries and recycle them through licensed waste management companies.

Do our environment and your watch a favor. Ask your watch/jewelry professional to replace your battery when it expires.

**TO RETURN YOUR WATCH FOR SERVICING:
RETURN IT TO VINCE CAMUTO WATCHES OR
TO AN AUTHORIZED SERVICE CENTER;
IT SHOULD NOT BE RETURNED TO PLACE OF PURCHASE.**

If your watch requires cleaning, lubrication, battery changing, or needs a crystal replaced, VINCE CAMUTO® watches approved Service Centers are available in your area. These repair facilities use VINCE CAMUTO® watches parts and components to assure quality and future performance. Free estimates are available in advance, should you need servicing or repairs not covered under the warranty. Repairs covered under the warranty may require proof of purchase, so retain the purchase receipt.

TO RETURN YOUR WATCH FOR SERVICING:

FROM THE UNITED STATES: Please call 718.482.4195 for a listing of all approved and authorized stations and locations.

FROM OUTSIDE OF THE UNITED STATES:

Clarity Ltd.

Flat A - B, 12/F, Sing Mei Industrial Building

29 - 37 Kwai Wing Road, Kwai Chung, N.T. Hong Kong

tel: 852.2424.2211 fax: 852.2424.2077

Carefully pack your watch in a sturdy box (do not send in a gift box for same will not be returned) and mail to the nearest approved authorized service station. Because of possible loss, we recommend that you insure your watch, return receipt requested, when using the mail. If your watch requires cleaning, lubrication, battery changing, or needs a crystal replaced, VINCE CAMUTO® watches approved Service Centers may be available in your area. These repair facilities use VINCE CAMUTO® watches parts and components to assure quality and future performance. Free estimates are available in advance, should you need servicing or repairs not covered under the warranty. Repairs covered under the warranty may require proof of purchase, so retain the purchase receipt. For further information regarding VINCE CAMUTO® watches approved Service Stations and locations, please call the Service Centers listed above.

5 YEAR LIMITED WARRANTY

This VINCE CAMUTO® watch is warranted to you, the owner, for 5 years against all defects in material or workmanship. This warranty does not apply to normal wear and tear or abuse and excludes batteries, case, strap, crystal, or bracelet. A copy of the receipt, or dealer stamp in the warranty booklet, is required for proof of purchase. In the event of a defect or malfunction of the movement within this period it will be repaired or replaced, at our option, provided that it is returned prepaid with a check or money order for \$14.95 to cover the cost of handling and return postage for a Quartz Movement Watch or \$24.95 for an Automatic Movement Watch. (This is not a repair charge.) DO NOT SEND CASH. No additional charge will be made unless additional servicing is necessary for reasons beyond our control such as accident, misuse, neglect or replacement of parts not warranted is required such as case, crystal, strap, bracelet or batteries in which event a moderate charge will be made.

The movement of any timepiece requires periodic cleaning/timing which is not a defect and, as such not warranted. After one year from the date of purchase each cleaning/timing will be performed as required without charging a fee in excess of the

specified \$14.95 or \$24.95 handling charge. The above remedy is exclusive. VINCE CAMUTO® watches shall not be liable for any incidental or consequential damages. Should any other part of your watch require repair, please use our Service Center for quick and inexpensive repairs on your watch. This warranty gives you specific legal rights and you may also have other rights which may vary from state to state. Some states do not allow limitations on how long an implied warranty lasts, or the exclusion or limitation of incidental or consequential damages, so the above limitations and exclusions may not apply to you. In the event of a problem with warranty service or performance, you may be able to go to Small Claims Court, a State Court or a Federal District Court.

* SPECIFICATIONS SUBJECT TO CHANGE
WITHOUT PRIOR NOTICE FOR PRODUCT IMPROVEMENT,
DESIGN MAY VARY DEPENDING ON THE MODEL.

For the latest information on sizing, service and repairs, please go to:

www.vincecamuto.com/watchwarranty



©2012 E. GLUCK CORPORATION

VINCE CAMUTO® is a registered trademark of Camuto Consulting, Inc. All other identified trademarks or servicemarks are or may be the intellectual property rights of their respective owners.



VENDOR STAMP

VENDOR STAMP

VINCECAMUTO.COM