

SBT1009 User Manual

SHARPER IMAGE®

Tailgate Speaker



User Guide
SBT1009

In the box

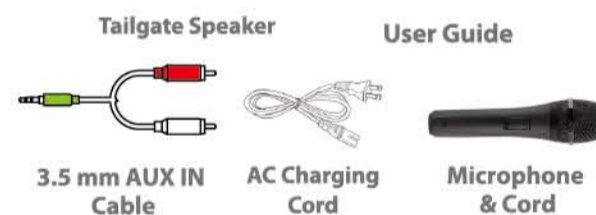
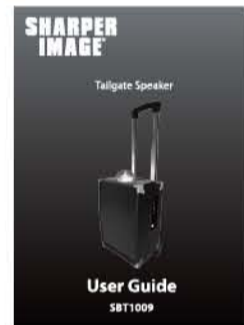

Charging the Tailgate Speaker

1. Attach the AC charging cord to the socket on the back of the Tailgate Speaker.
2. Plug the AC charging cord into a wall socket.
3. Turn speaker ON by pressing the Main Power switch.
4. The LED charging indicator light will illuminate blue while charging. It will shut off when the speaker has completed charging.

i In order to charge the Tailgate Speaker with the AC charging cord, the AC Power switch must be turned ON.

Using a DC car charger (not included)

1. Before connecting a DC car charger, please make sure that the **Main Power Switch is in the OFF position.**
2. Unscrew the RED and Black DC Wire Harness until the metal contact below is exposed.
3. Place the wired end of the DC car charger against the metal post and tightly fasten the harness.
 - a. The striped white wire is fastened to the RED post.
 - b. The solid BLACK wire is fastened to the BLACK post.
4. Connect the DC car charger to your vehicle's charging port.
5. Switch the Tailgate Speaker's Main Power Switch to the ON position.

i To order a DC car charger, please call 1-877-768-8481.

Location of controls

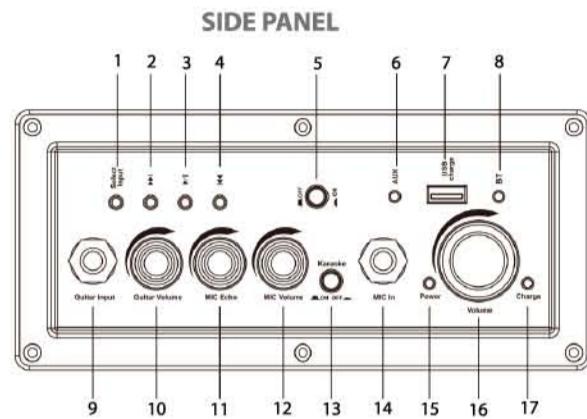

1. **[SELECT INPUT] button:** Change playing mode: AUX mode, Bluetooth mode
2. **[▶/⏸] button:** Next track (in Bluetooth mode)
3. **[▶/⏸] button:**
 - Quick press = play/pause (in Bluetooth mode)
 - Long press = enter Bluetooth pairing mode or unpair
 - Long press = mute volume (in AUX mode)
4. **[◀/⏮] button:** Previous track (in Bluetooth mode)
5. Disco ball ON/OFF button
6. LED AUX indicator light
7. USB charging port
8. LED Bluetooth indicator light
9. Guitar Input jack
10. Guitar Volume knob
11. MIC Echo knob
12. MIC Volume knob
13. Karaoke ON/OFF button
14. MIC In jack
15. LED Power indicator light
16. Volume knob: turn left to decrease volume, turn right to increase volume
17. LED Charging indicator light

BACK PANEL

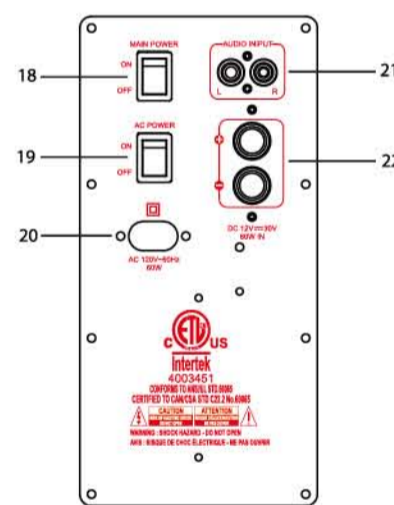

18. Main Power switch
19. AC Power switch
20. AC charging cord socket
21. Audio Input jacks
22. DC speaker harness

Pairing the speaker with a Bluetooth enabled device

1. Turn the Tailgate Speaker ON by pressing the Main Power switch on the back panel.
2. Press the **[SELECT INPUT]** button. The voice prompt "Bluetooth pairing" will be heard as the LED Bluetooth indicator light turns on and blinks BLUE.
3. Keep the speaker and Bluetooth enabled device within 3 feet of each other during the pairing process.
4. Set your mobile phone or other Bluetooth enabled device to search for Bluetooth devices.

i If there are no paired devices in range when Bluetooth mode is enabled, it will go into pairing mode automatically. If the last paired device is in range, the speaker will connect to it automatically.

On an iPhone

- Go to **SETTINGS > BLUETOOTH** (Make sure Bluetooth is turned ON)

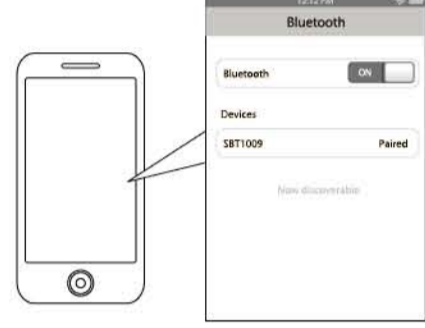

On a BlackBerry

- Go to **SETTINGS/OPTIONS > BLUETOOTH**
- Enable **BLUETOOTH** (Make sure Bluetooth is turned ON)



On an Android Phone

- Go to **SETTINGS > BLUETOOTH > MENU > Search for devices** (Make sure Bluetooth is turned ON)

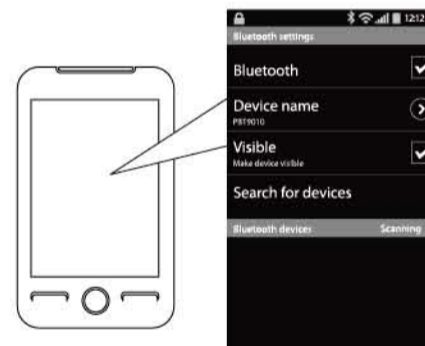

On other Cell Phones/Devices

- Review the instruction manual that came with your phone/device.

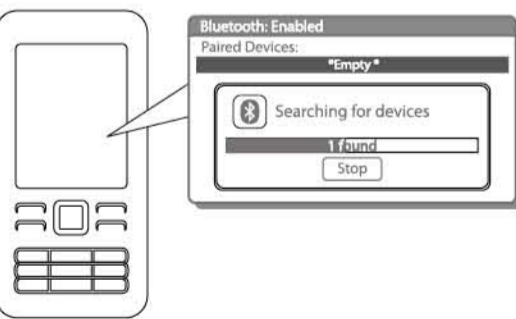

5. When the Bluetooth enabled device finds the speaker, select "SBT1009" from the list of found devices.
6. If required, enter the password 0000. Select OK or Yes to pair the two units.
7. After a successful pairing, the voice prompt "Bluetooth is connected" will be heard and the LED Bluetooth Indicator light will be a solid BLUE.

NOTE: If you would like to connect the speaker to another device, you must disconnect the speaker from the currently paired device first. On your device's Bluetooth settings, select "SBT1009," then select "disconnect" or "unpair"; or long press the **[▶/⏸]** button. When the speaker has been unpaired, repeat the pairing process.

i The screenshots above are typical of many Bluetooth enabled devices in the market today, and are used to assist in the explanation of the pairing process. Your Bluetooth enabled device's interface and interaction with the speaker may slightly differ from the illustrations above.

Using the speaker

Powering ON/OFF

- Use the Main Power switch on the back of the speaker to turn ON and OFF if the speaker has been fully charged.
- Use the AC Power switch on the back of the speaker to turn ON and OFF when the AC charging adapter is plugged in.

Adjusting the volume
Turn the Volume knob on the side of the speaker to the left to decrease the volume. Turn it to the right to increase the volume.

i You can also adjust the volume from your connected device's volume control.

Switching Modes

- Press the **[SELECT INPUT]** button on the speaker repeatedly to switch between modes:
- AUX (line in)
 - Bluetooth

Disco Ball

Press to turn the disco ball light ON and OFF.

Guitar Input

Plug the jack of any electric guitar into the Guitar input port to use as an amplifier.

Guitar Volume

Adjust the volume of the connected guitar.

MIC Echo

Adjust the reverberation effect of the connected microphone.

MIC Volume

Adjust the volume of a connected microphone.

Karaoke

Press to enable the karaoke function. Bluetooth or AUX signal will automatically adjust to highlight vocals when a microphone is connected.

MIC In

Plug the microphone jack into the MIC In port to enable microphone use.

Charging devices

1. Attach your device to the speaker's USB port using your device's USB charging cord.
2. The device will start charging automatically.
3. Check your device's charging indicator for charging status.

Playing Music

To enjoy wireless music on your Tailgate Speaker, make sure you are connected to a Bluetooth enabled device. Once connected, you can control the music with the controls on your connected device and on the Tailgate Speaker.

Play/pause

- Press the **[▶/⏸]** button to pause/resume play in Bluetooth mode.

Skipping tracks

- Press the **[▶/⏸]** button to skip to the next track in Bluetooth mode.
- Press the **[◀/⏮]** button to skip to the previous track in Bluetooth mode.

Adjusting the volume

Turn the Volume knob on the side of the speaker to the left to decrease the volume. Turn it to the right to increase the volume.

i You can also adjust the volume from your connected device's volume control.

Using as a wired speaker

1. Connect the white and red AUX cable plugs to the white (L) and red (R) jacks on the back of the speaker, and the green plug of the cable to the other end to an external device's headphone jack (smartphone, tablet, or MP3 player).
2. Open a media player on your device and click on PLAY to start playing your music.
3. Use the controls on your connected device to control music playback and volume.

i When a device is plugged into the Audio Input jack, the speaker controls have limited function. You must use your connected device to control music playback.

Troubleshooting tips

i I can pair the Tailgate Speaker with my Bluetooth device, but I cannot hear any music.

1. Make sure your Bluetooth device supports A2DP profile.
2. Turn up the volume on your Bluetooth device.
3. You may have to unpair the speaker, then re-pair to your device.

i I cannot get the Tailgate Speaker into Pairing Mode.

1. Press the **[SELECT INPUT]** button until the LED Bluetooth indicator lights up. The voice prompt "Bluetooth pairing" will be heard and the LED indicator light will blink BLUE.
2. The speaker is now in pairing mode.

i My Bluetooth Device is not able to pair with the Tailgate Speaker.

1. Keep the Tailgate Speaker and Bluetooth enabled device within 3 feet of each other during the pairing process.
2. Press the **[SELECT INPUT]** button until the LED Bluetooth indicator lights up. The voice prompt "Bluetooth pairing" will be heard and the LED indicator light will blink BLUE.
3. Check that YOUR device's Bluetooth feature is turned ON.
4. Try repeating the pairing process, see "Pairing the speaker with a Bluetooth enabled device".

Safety instructions

1. Read these instructions.
2. Keep these instructions.
3. Heed all warnings.
4. Follow all instructions.
5. Do not use this apparatus near water.
6. Clean only with a dry cloth.
7. Do not block any ventilation openings. Install in accordance with the manufacturer's instructions.
8. Do not install near any heat sources such as radiators, heat registers, stoves, or other apparatus (including amplifiers) that produce heat.
9. Do not defeat the safety purpose of the polarized or grounding-type plug. A polarized plug has two blades with one wider than the other. A grounding type plug has two blades and a third grounding prong. The wide blade or the third prong are provided for your safety. When the provided plug does not fit into your outlet, consult an electrician for replacement of the obsolete outlet.
10. Protect the power cord from being walked on or pinched particularly at plugs, convenience receptacles, and the point where they exit from the apparatus.
11. Only use attachments/accessories specified by the manufacturer.
12. Use only with a cart, stand, tripod, bracket, or table specified by the manufacturer, or sold with the apparatus. When a cart is used, use caution when moving the cart/apparatus combination during lightning storms or when unused for long periods of time.



13. Unplug the apparatus during lightning storms or when unused for long periods of time.
14. Refer all servicing to qualified service personnel. Servicing is required when the apparatus has been damaged in any way, such as power-supply cord or plug is damaged; liquid has been spilled or objects have fallen into the apparatus; the apparatus has been exposed to rain or moisture, does not operate normally, or has been dropped.
15. **WARNING:** The mains plug is used as a disconnect device; the disconnect device shall remain readily operable.
16. **WARNING:** To reduce the risk of fire or electric shock, do not expose this apparatus to rain or moisture. The apparatus shall not be exposed to dripping or splashing, and objects filled with liquids, such as vases, shall not be placed on apparatus.
17. **Ⓢ** This equipment is a Class II or double insulated electrical appliance. It should be designed in such a way that it does not require a safety connection to electrical earth.



CAUTION: The lightning flash with arrowhead symbol, within an equilateral triangle, is intended to alert the user to the presence of unshielded live parts within the products enclosure that may be of sufficient magnitude to constitute a risk of electric shock to persons. The enclosure design and the equipment design is intended to alert the user to the presence of the hazard of operating and maintenance (servicing) instructions in the literature accompanying the appliance.

Additional warnings and precautions

- Battery shall not be exposed to excessive heat such as sunshine, fire or the like. Danger of explosion if battery is incorrectly replaced. Replace only with the same or equivalent type.
- Batterie (batterie ou piles installées) ne doit pas être exposée à une chaleur excessive comme le soleil, le feu, etc. Danger d'explosion si la pile n'est pas remplacée correctement. Ne remplacer que par le même type ou un type équivalent.

CAUTION: TO PREVENT ELECTRIC SHOCK, MATCH WIDE BLADE OF PLUG TO WIDE SLOT; FULLY INSERT.

CAUTION: Use of controls or adjustments or performance of procedures other than those specified may result in hazardous radiation exposure.

WARNING: Changes or modifications to this unit not expressly approved by the party responsible for compliance could void the user's authority to operate the equipment.

WARNING: Do not place this unit directly onto furniture surfaces with any type of soft, porous, or sensitive finish. As with any rubber compound made with oils, the feet of this unit may cause marks or staining where they reside. We recommend using a protective barrier such as a cloth or a piece of glass between the unit and the surface to reduce the risk of damage and/or staining.

WARNING: Use of this unit near fluorescent lighting may cause interference regarding use of the remote. If the unit is displaying erratic behavior move away from any fluorescent lighting, as it may be the cause.

WARNING: Shock hazard - Do Not Open.

WARNING: TO REDUCE THE RISK OF ELECTRIC SHOCK, DO NOT REMOVE COVER (OR BACK). NO USER-SERVICEABLE PARTS INSIDE. REFER SERVICING TO QUALIFIED SERVICE PERSONNEL.

Legal information

Caution: Any changes or modifications not expressly approved could void the user's authority to operate the equipment.

Note: This equipment has been tested and found to comply with the limits for a Class B digital device, pursuant to part 15 of the FCC Rules. These limits are designed to provide reasonable protection against harmful interference in a residential installation. This equipment generates, uses and can radiate radio frequency energy and, if not installed and used in accordance with the instructions, may cause harmful interference to radio communications. However, there is no guarantee that interference will not occur in a particular installation. If this equipment does cause harmful interference to radio or television reception, which can be determined by turning the equipment off and on, the user is encouraged to try to correct the interference by one or more of the following measures:

- Reorient or relocate the receiving antenna.
- Increase the separation between the equipment and receiver.
- Connect the equipment into an outlet on a circuit different from that to which the receiver is connected.
- Consult the dealer or an experienced radio/TV technician for help.

Do not attempt to repair or modify this equipment. Warning: Changes or modifications to this equipment not expressly approved by the party responsible for compliance could void the user's authority to operate the equipment. *This device complies with Part 15 of the FCC Rules. Operation is subject to the following two conditions:

- (1) this device may not cause harmful interference, and
- (2) this device must accept any interference received, including interference that may cause undesired operation.*

This equipment complies with FCC radiation exposure limits set forth for an uncontrolled environment. This equipment should be installed and operated with minimum distance of 20cm between the radiator and your body.

Limited Warranty

90 Days Limited Warranty

In the unlikely event that this product is defective, or does not perform properly, you may within ninety (90) days from your original date of purchase return it to the authorized service center for repair or exchange.

TO OBTAIN WARRANTY SERVICE:

- Provide proof of the date of purchase within the package (Dated bill of sale).
- Prepay all shipping costs to the authorized service center, and remember to insure your return.
- Include a return shipping address (no P.O. Boxes), a telephone contact number, and the defective unit within the package.
- Describe the defect or reason you are returning the product.

Your product will be repaired or replaced, at our option, for the same or similar model of equal value if examination by the service center determines this product is defective. Products received damaged as a result of shipping will require you to file a claim with the carrier.

The shipping address of the authorized service center is:

Southern Telecom, Inc.
Attention: Customer Service (2nd Floor)
14-C 53rd Street
Brooklyn, NY 11232

Should you have any questions or problems concerning this product, please contact our customer service department at:

Customer Support:
Phone: 1-877-768-8481
Monday-Friday 8AM-10PM(EST)

www.southern telecom.com
Click on "Product Support"

Warranty service not provided

This warranty does not cover damage resulting from accident, misuse, abuse, improper installation or operation, lack of reasonable care, and unauthorized modification. This warranty is voided in the event any unauthorized person opens, alters or repairs this product. All products being returned to the authorized service center for repair must be suitably packaged.

Limitation of Warranty:

• THE WARRANTY STATED ABOVE IS THE ONLY WARRANTY APPLICABLE TO THIS PRODUCT. ALL OTHER WARRANTIES, EXPRESS OR IMPLIED (INCLUDING ALL IMPLIED WARRANTIES OF MERCHANTABILITY OR FITNESS FOR A PARTICULAR PURPOSE) ARE HEREBY DISCLAIMED. NO VERBAL OR WRITTEN INFORMATION GIVEN BY AIT, INC. IT'S AGENTS, OR EMPLOYEES SHALL CREATE A WARRANTY OR IN ANY WAY INCREASE THE SCOPE OF THIS WARRANTY.

• REPAIR OR REPLACEMENT AS PROVIDED UNDER THIS WARRANTY IS THE EXCLUSIVE REMEDY OF THE CONSUMER. AIT, INC. SHALL NOT BE LIABLE FOR INCIDENTAL OR CONSEQUENTIAL DAMAGES RESULTING FROM THE USE OF THIS PRODUCT OR ARISING OUT OF ANY BREACH OF ANY EXPRESS OR IMPLIED WARRANTY ON THIS PRODUCT. THIS DISCLAIMER OF WARRANTIES AND LIMITED WARRANTY ARE GOVERNED BY THE LAWS OF THE STATE OF NEW YORK. EXCEPT TO THE EXTENT PROHIBITED BY APPLICABLE LAW, ANY IMPLIED WARRANTY OF MERCHANTABILITY OR FITNESS FOR A PARTICULAR PURPOSE ON THIS PRODUCT IS LIMITED TO THE APPLICABLE WARRANTY PERIOD SET FORTH ABOVE.

Some states do not allow the exclusion nor limitation of incidental or consequential damages, or limitations on how long an implied warranty lasts so the above limitations on exclusions may not apply to you. This warranty gives you specific legal rights, and you also may have other rights that vary from state to state.

Sharper Image® name and logo are registered trademarks. Manufactured and marketed by Southern Telecom under license. © Sharper Image. All Rights Reserved.

SHARPER IMAGE®