

SBT1015 User Manual

FRONT

BACK

**SHARPER
IMAGE**



User Guide
SBT1015

Location of Controls

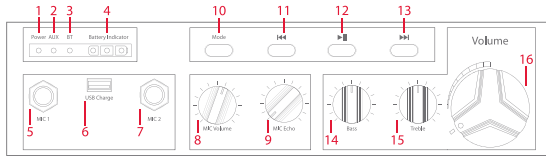

(Front Panel - above)

1. Power LED indicator
2. AUX LED indicator
3. Bluetooth LED indicator
4. Battery LED indicator
5. MIC 1-in
6. USB charge out
7. MIC 2-in
8. MIC volume knob
9. MIC echo knob

(Front Panel, cont'd)

10. [Mode] button
11. [◀▶] button
12. [⏸] button
13. [▶▶] button
14. Bass knob
15. Treble knob
16. Volume knob

(Back Panel - side)

17. AC 120V port
18. [LIGHT] switch
19. [POWER] switch
20. Left & Right audio input

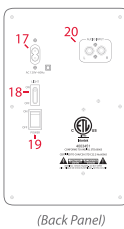

(Back Panel)

In the Box

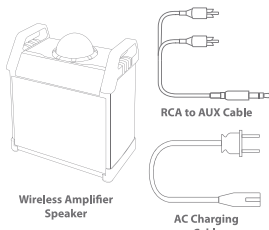

RCA to AUX Cable

AC Charging Cable

Pairing the Speaker

1. Press the [POWER] switch to turn the speaker ON.
2. Press the [Mode] button to switch to Bluetooth mode. The Bluetooth LED indicator will flash BLUE.
3. Set your Bluetooth-enabled device to search for Bluetooth devices.
4. When the Bluetooth enabled device finds the speaker, select "SBT1015" from the list of found devices.
5. After a successful pairing, the LED indicator will stay solid BLUE.

! If a previously paired device is in range when the headphones are turned on, the speaker will connect to it automatically.

Charging the Speaker

To charge the speaker, connect the supplied AC power cable to the AC 120V port on the back panel of the speaker. Plug the other end into a working outlet. The Battery LED indicator will turn RED while charging.

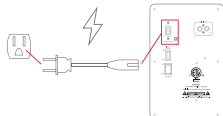

As the speaker loses power, the Battery LED indicator will turn off to indicate the Battery level:

- 100% Battery
- ~66% Battery
- ~33% Battery

! Make sure you charge your speaker for at least 6 to 8 hours before using them for the first time.

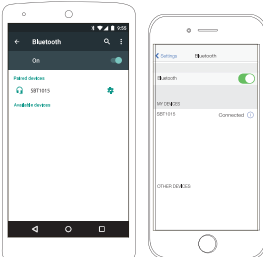

! The screenshots above are typical of many Bluetooth-enabled devices in the market today, and are used to assist in the explanation of the pairing process. Your Bluetooth-enabled device's interface and interaction with the headphones may differ slightly from the illustrations above.

Using the Speaker

Powering ON/OFF

- To turn the speaker ON, press the [POWER] switch on the back panel of the speaker to the ON position.
- To turn the speaker OFF, press the [POWER] switch on the back panel of the speaker to the OFF position.

Changing Modes

Bluetooth mode allows the pairing of Bluetooth devices to the speaker to play media wirelessly. AUX mode allows the playing of media through a device connected with the supplied RCA to AUX cable.

- To change between Bluetooth and AUX mode, press the [Mode] button once. The corresponding LED indicator will light up.

NOTE: The speaker will default to AUX mode when powered ON.

Using the USB Charging Port

USB devices can be charged using the USB Charging Port. Simply plug a USB cable into the Charging port and attach the other end to the USB device.

Playing Music

To enjoy music wirelessly on your speaker, make sure that the speaker is properly paired to your Bluetooth-enabled device. If you are pairing the device for the first time, please consult the "Pairing the Speaker" section of this user guide.

Playing/Pausing Music

- Press the [▶▶] button to pause media playback.
- Press the [⏸] button to resume media playback.

Skipping Songs

- Press the [◀▶] button to skip to the previous song.
- Press the [▶▶] button to skip to the next song, p.

Adjusting Volume

- Turn the Volume knob to the left to lower the volume.
- Turn the Volume knob to the right to raise the volume.

Adjusting Bass/Treble

- Turn the Bass knob to the right to increase the bass output of media playback.
- Turn the Treble knob to the right to increase the treble output of media playback.

Using the Microphones

The speaker can support two microphones (not included). To use a microphone, plug an 1/8" microphone into either the MIC 1 or MIC 2 jacks.

Adjusting Mic Volume

- Turn the Mic Volume knob to the right to increase microphone volume.
- Turn the Mic Volume knob to the left to decrease microphone volume.

Adjusting Mic Echo

- Turn the Mic Echo knob to the right to increase microphone echo.
- Turn the Mic Echo knob to the left to decrease microphone echo.

NOTE: Music will continue to play while using the microphones

Using the Light

To use the Light, turn the speaker ON by pressing the [POWER] switch to the ON position. A tone will play indicating that the speaker is powered on.

Press the [LIGHT] switch on the back panel of the speaker. The Light will turn on and began to spin.

WARNING: Do NOT grab, turn or twist the Disco Light while it is or is not turned ON. This can damage the motor and cause the light to not work properly.

WARNING: Do NOT look directly at the Disco Light while it is turned ON. This may cause damage to the observer's vision.

Using as a Wired Speaker

To use the speaker as a wired device, attach the WHITE connector of the supplied RCA to AUX cable to the LEFT audio input on the back panel of the speaker, and the RED connector to the RIGHT audio input. Then, attach the green AUX end to your media-playing device's headphone jack.

Media playback and volume adjustment can be controlled through the wired device.

Volume can also be adjusted with the Volume Knob on the speaker and bass and treble can be adjusted with the Bass and Treble Knobs.

Media can be played/paused with the [▶▶] button.

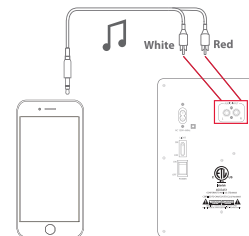

Questions and Customer Support

For further assistance or troubleshooting, please call our customer support line:

☎ Phone: 1-877-768-8481
Monday-Friday 8AM-10PM (EST)

🌐 www.southern telecom.com
Click on "Product Support"

Legal Information

READ CAREFULLY AND KEEP THIS MANUAL

Warning:
Changes or modifications to this unit not expressly approved by the part responsible for compliance could void the user's authority to operate the equipment.

This device complies with Part 15 of the FCC Rules. Operation is subject to the following two conditions:

- (1) This device may not cause harmful interference, and
- (2) This device must accept any interference received, including interference that may cause undesired operation.

Note: This equipment has been tested and found to comply with the limits for a Class B digital device, pursuant to part 15 of the FCC Rules. These limits are designed to provide reasonable protection against harmful interference in a residential installation. This equipment generates, uses and can radiate radio frequency energy and, if not installed and used in accordance with the instructions, may cause harmful interference to radio communications. However, there is no guarantee that interference will not occur in a particular installation. If this equipment does cause harmful interference to radio or television reception, which can be determined by turning the equipment off and on, the user is encouraged to try to correct the interference by one or more of the following measures:

- Reorient or relocate the receiving antenna.

• Increase the separation between the equipment and receiver.

- Connect the equipment into an outlet on a circuit different from that to which the receiver is connected.

- Consult the dealer or an experienced radio/TV technician for help.

FCC Radiation Exposure Statement:

The device has been evaluated to meet general RF exposure requirement. The device can be used in portable exposure condition without restriction.

Limited Warranty

90 Days Limited Warranty

In the unlikely event that this product is defective, or does not perform properly, you may within ninety (90) days from your original date of purchase return it to the authorized service center for repair or exchange.

TO OBTAIN WARRANTY SERVICE:

- Call the Customer Support number located below, or go to our website portal to receive a SRO number.
 - Provide proof of the date of purchase within the package (dated bill of sale).
 - Prepay all shipping costs to the authorized service center, and remember to insure your return.
 - Include a return shipping address (no P.O. Boxes), a telephone contact number, and the defective unit within the package.
 - Describe the defect or reason you are returning the product.
- Your product will be repaired or replaced, at our option, for the same or similar model of equal value if examination by the service center determines this product is defective. Products received damaged as a result of shipping will require you to file a claim with the carrier.

The shipping address of the authorized service center is:

☎ Southern Telecom, Inc.
Attention: Customer Service (2nd Floor)
1445 53rd Street
Brooklyn, NY 11232

Should you have any questions or problems concerning this product, please contact our customer service department at:

☎ Customer Support
Phone: 1-877-768-8481
Monday-Friday 8AM-10PM (EST)

🌐 www.southern telecom.com
Click on "Product Support"

Warranty service not provided

This warranty does not cover damage resulting from accident, misuse, abuse, improper installation or operation, lack of reasonable care, and unauthorized modification. This warranty is voided in the event any unauthorized person opens, alters or repairs this product. All products being returned to the authorized service center for repair must be suitably packaged.

Limitation of Warranty:

• THE WARRANTY STATED ABOVE IS THE ONLY WARRANTY APPLICABLE TO THIS PRODUCT. ALL OTHER WARRANTIES, EXPRESS OR IMPLIED (INCLUDING ALL IMPLIED WARRANTIES OF MERCHANTABILITY OR FITNESS FOR A PARTICULAR PURPOSE) ARE HEREBY DISCLAIMED. NO VERBAL OR WRITTEN INFORMATION GIVEN BY A.T.I. INC. ITS AGENTS, OR EMPLOYEES SHALL CREATE A WARRANTY OR IN ANY WAY INCREASE THE SCOPE OF THIS WARRANTY.

• REPAIR OR REPLACEMENT AS PROVIDED UNDER THIS WARRANTY IS THE EXCLUSIVE REMEDY OF THE CONSUMER. A.T.I. INC. SHALL NOT BE LIABLE FOR INCIDENTAL OR CONSEQUENTIAL DAMAGES RESULTING FROM THE USE OF THIS PRODUCT OR ARISING OUT OF ANY BREACH OF ANY EXPRESS OR IMPLIED WARRANTY ON THIS PRODUCT. THIS DISCLAIMER OF WARRANTIES AND LIMITED WARRANTY ARE GOVERNED BY THE LAWS OF THE STATE OF NEW YORK, EXCEPT TO THE EXTENT PROHIBITED BY APPLICABLE LAW. ANY IMPLIED WARRANTY OF MERCHANTABILITY OR FITNESS FOR A PARTICULAR PURPOSE ON THIS PRODUCT IS LIMITED TO THE APPLICABLE WARRANTY PERIOD SET FORTH ABOVE.

Some states do not allow the exclusion nor limitation of incidental or consequential damages, or limitations on how long an implied warranty lasts so the above limitations on exclusions may not apply to you. This warranty gives you specific legal rights, and you also may have other rights that vary from state to state.



Sharper Image® name and logo are registered trademarks. Manufactured and marketed by Southern Telecom under license. © Sharper Image. All Rights Reserved.

SHARPER IMAGE