

SBT2002 User Manual

SHARPER IMAGE

Multimedia Speaker



User Guide
SBT2002

In the box

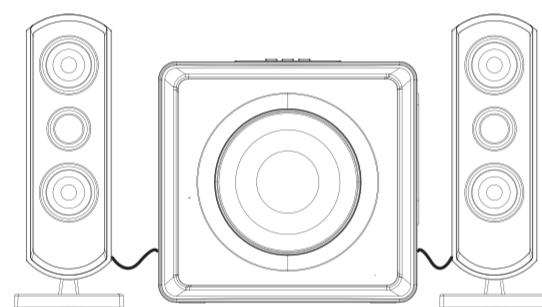

Bluetooth Speaker System with Subwoofer



User Guide
SBT2002

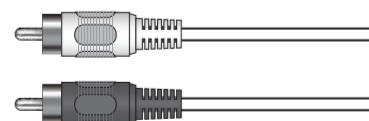

RCA Audio Cable

Location of controls

Top panel

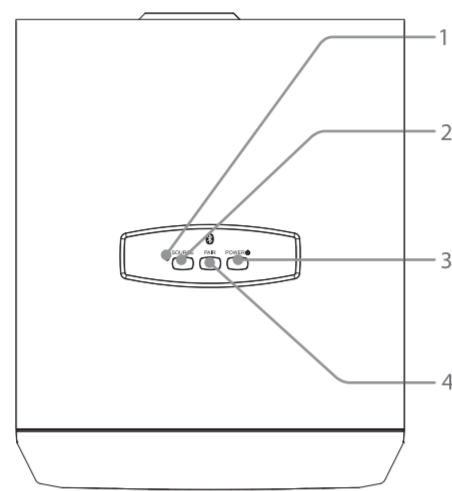

1. Pairing indicator light
2. Source: Press to switch between Bluetooth mode and in line
3. Power
4. Pair: Press to begin pairing

Side panel

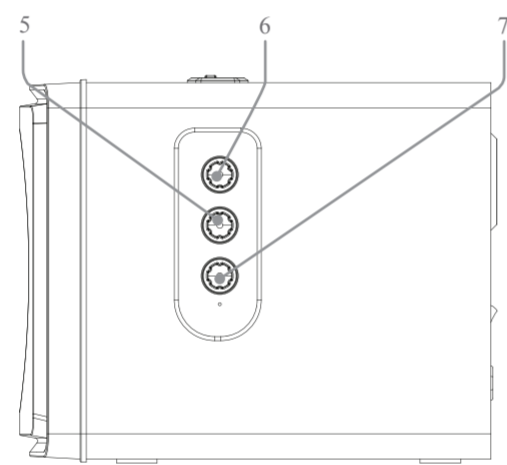

5. Treble
6. Volume
7. Bass

Back panel

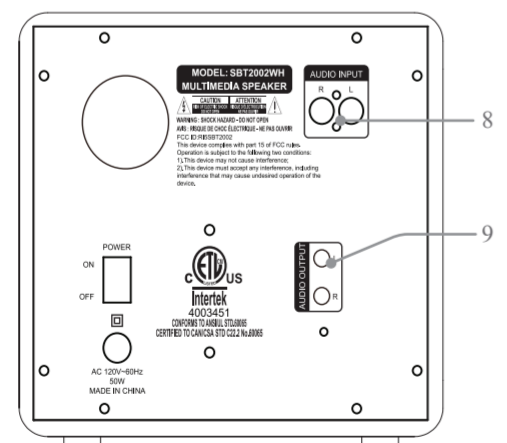

8. RCA audio inputs
9. Speaker connections

Pairing the speaker with a Bluetooth enabled device

1. Power on the unit by pressing the Power button.
2. The Indicator light will turn BLUE and flash quickly.
3. Press the Pair button.
4. Keep the speaker and Bluetooth enabled device within 3 feet of each other during the pairing process.
5. Set your mobile phone or other Bluetooth enabled device to search for Bluetooth devices.



On an iPhone
• Go to **SETTINGS > GENERAL > BLUETOOTH** (Make sure Bluetooth is turned ON)

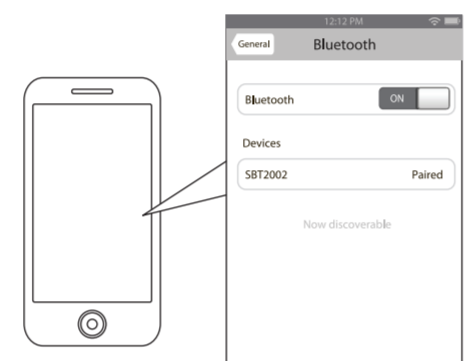

On a BlackBerry
• Go to **SETTINGS/OPTIONS > BLUETOOTH**
• Enable BLUETOOTH

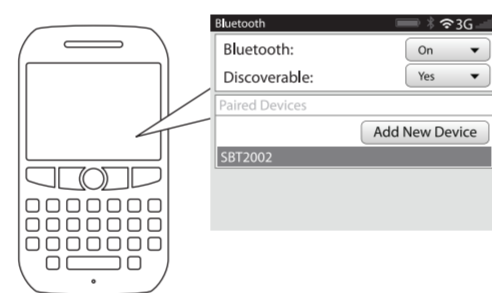

On an Android Phone
• Go to **SETTINGS > BLUETOOTH > MENU > Search**

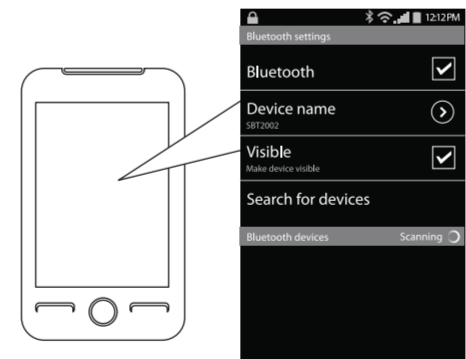

On other Cell Phones/Devices
Review the instruction manual that came with your phone/device.

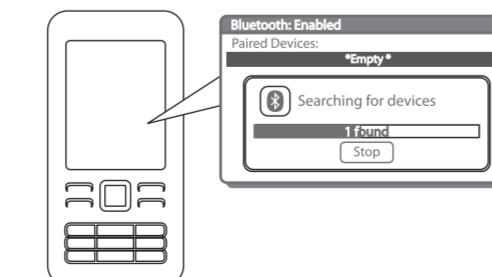

6. When the Bluetooth enabled device finds the speaker, select "SBT2002" from the list of found devices.
7. If required, enter the password 0000. Select OK or Yes to pair the two units.
8. After a successful pairing, the Indicator light will become solid BLUE.

The unit will stay paired unless unpaired manually by the user or erased due to a reset of the device. If your device should become unpaired or you find it is unable to connect, repeat the above steps or press the Pair button to start the pairing process pairing again.

Note: If the speaker has already been connected to the Bluetooth device/phone, the speaker will reconnect with the Bluetooth device/phone automatically.

i The screenshots above are typical of many Bluetooth enabled devices in the market today, and are used to assist in the explanation of the pairing process. Your Bluetooth enabled device's interface and interaction with the **Bluetooth Speaker** may slightly differ from the illustrations above.

Using your Bluetooth Speaker

Connecting the Speakers
Connect the included speakers to the corresponding speaker connections on the back of the speaker system.

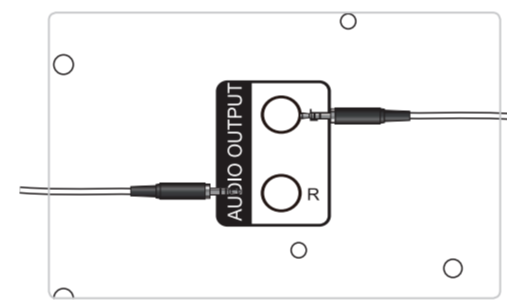

Using the RCA Audio Inputs

Requires a 3.5mm to RCA audio cable (included).

1. Plug the RCA audio cable into the RCA audio inputs on the speaker system and into a 3.5mm audio output on an audio source.
2. Use the controls on the connected audio source to play, pause, and control audio.

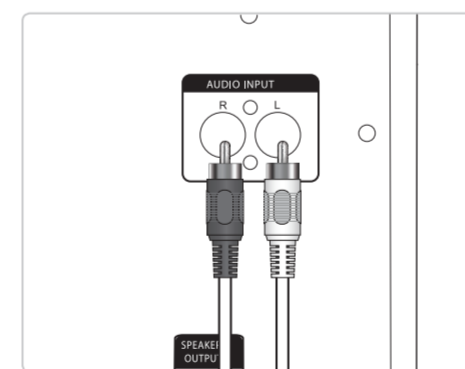

To make a call

Dial the number and press the send button on your mobile phone. The call is automatically transferred to the speaker.

Answering / Ending a call
Use the controls on your mobile phone to answer and end a call.

Playing Music

To enjoy wireless music on your Bluetooth Speaker System, make sure you are connected to a Bluetooth enabled device. Once connected, use the controls on the Bluetooth device to select, play, or pause a track.

Once playback has begun, you can control the music or answer phone calls with devices that have the AVRCP Bluetooth profile.

i Most media enabled smart phones will display "Connected to phone audio and media" when connecting to the Bluetooth Speaker. This means you can make phone calls and enjoy your music.

Adjusting the volume

Turn the Volume knob on the side panel to adjust the volume to the desired level.

i You may also adjust the volume from your mobile phone's volume control.

Troubleshooting tips

i I can pair the Bluetooth Speaker with my Bluetooth device, but I cannot hear any music?

1. Make sure your Bluetooth device supports A2DP profile.
2. Turn up the volume on your Bluetooth device.
3. You may have to unpair the speaker, then re-pair to your device.

i I cannot get the Bluetooth Speaker into Pairing Mode.

1. Make sure the Bluetooth Speaker System is turned ON before beginning the pairing process.
2. Press the Pair button and wait for the Indicator light to flash BLUE.
3. The speaker is now in pairing mode.

i My Bluetooth Device is not able to pair with the Bluetooth Speaker.

1. Make sure the Bluetooth Speaker is turned ON before beginning the pairing process.
2. Keep your Bluetooth Speaker and Bluetooth enabled device within 3 feet of each other during the pairing process.
3. Press the Pair button and wait for the Indicator light to flash Blue.
4. Check that YOUR device's Bluetooth feature is turned ON.
5. Try repeating the pairing process, see "Pairing the Speaker with a Bluetooth enabled device".

Safety instructions

1. Read and keep this manual and follow all instructions
2. Heed all warnings.
3. Do not use this apparatus near water.
4. Clean only with a dry cloth.
5. Do not block any ventilation openings. Install in accordance with the manufacturer's instructions.
6. Do not install near any heat sources such as radiators, heat registers, stoves, or other apparatus (including amplifiers) that produce heat.
7. Do not defeat the safety purpose of the polarized or grounding-type plug. A polarized plug has two blades with one wider than the other. A grounding type plug has two blades and a third grounding prong. The wide blade or the third prong are provided for your safety. When the provided plug does not fit into your outlet, consult an electrician for replacement of the obsolete outlet.
8. Protect the power cord from being walked on or pinched particularly at plugs, convenience receptacles, and the point where they exit from the apparatus.
9. Only use attachments/accessories specified by the manufacturer.

10. Use only with a cart, stand, tripod, bracket, or table specified by the manufacturer, or sold with the apparatus. When a cart is used, use caution when moving the cart/apparatus combination during lightning storms or when unused for long periods of time.



11. Unplug the apparatus during lightning storms or when unused for long periods of time.
12. Refer all servicing to qualified service personnel. Servicing is required when the apparatus has been damaged in any way, such as power-supply cord or plug is damaged, liquid has been spilled or objects have fallen into the apparatus, the apparatus has been exposed to rain or moisture, does not operate normally, or has been dropped.
13. **WARNING:** The mains plug is used as a disconnect device; the disconnect device shall remain readily operable.
14. **WARNING:** To reduce the risk of fire or electric shock, do not expose this apparatus to rain or moisture. The apparatus shall not be exposed to dripping or splashing and that objects filled with liquids, such as vases, shall not be placed on apparatus.
15. **⚠** This equipment is a Class II or double insulated electrical appliance. It has been designed in such a way that it does not require a safety connection to electrical earth.



The Lightning Flash with arrowhead symbol, within an equilateral triangle, is intended to alert the user to the presence of uninsulated "dangerous voltage" within the product's enclosure that may be of sufficient magnitude to constitute a risk of electric shock to persons.

The exclamation point within an equilateral triangle is intended to alert the user to the presence of important operating and maintenance (servicing) instructions in the literature accompanying the appliance.

Additional warnings and precautions

- Battery shall not be exposed to excessive heat such as sunshine/fire or the like.
- Caution marking is located at the rear or bottom of the apparatus.

CAUTION: TO PREVENT ELECTRIC SHOCK, MATCH WIDE BLADE OF PLUG TO WIDE SLOT, FULLY INSERT.

CAUTION: Use of controls or adjustments or performance of procedures other than those specified may result in hazardous radiation exposure.

WARNING: Changes or modifications to this unit not expressly approved by the party responsible for compliance could void the user's authority to operate the equipment.

WARNING: Do not place this unit directly onto furniture surfaces with any type of soft, porous, or sensitive finish. As with any rubber compound made with oils, the feet could cause marks or staining where the feet reside. We recommend using a protective barrier such as a cloth or a piece of glass between the unit and the surface to reduce the risk of damage and/or staining.

WARNING: Use of this unit near fluorescent lighting may cause interference regarding use of the remote. If the unit is displaying erratic behavior move away from any fluorescent lighting, as it may be the cause.

WARNING: Shock hazard - Do Not Open.

WARNING: TO REDUCE THE RISK OF ELECTRIC SHOCK, DO NOT REMOVE COVER (OR BACK). NO USER-SERVICEABLE PARTS INSIDE. REFER SERVICING TO QUALIFIED SERVICE PERSONNEL.

Legal information

FCC Part 15:

This equipment has been tested and found to comply with the requirements for a Class B digital device under Part 15 of the Federal Communications Commission (FCC) rules. These requirements are intended to provide reasonable protection against harmful interference in a residential installation. This equipment generates, uses and can radiate radio frequency energy and, if not installed and used in accordance with the instructions, may cause harmful interference to radio communications. However, there is no guarantee that interference will not occur in a particular installation. If this equipment does cause harmful interference to radio or television reception, which can be determined by turning the equipment off and on, the user is encouraged to try to correct the interference by one or more of the following measures:

- Re-orient or relocate the receiving antenna.
- Increase the separation between the equipment and receiver.
- Connect the equipment into an outlet on a circuit different from that to which the receiver is connected.
- Consult the dealer or an experienced radio/TV technician for help.

Do not attempt to repair or modify this equipment. Warning: Changes or modifications to this equipment not expressly approved by the party responsible for compliance could void the user's authority to operate the equipment. *This device complies with Part 15 of the FCC Rules. Operation is subject to the following two conditions:

- (1) this device may not cause harmful interference, and
- (2) this device must accept any interference received, including interference that may cause undesired operation.*

This equipment complies with FCC radiation exposure limits set forth for an uncontrolled environment. This equipment should be installed and operated with minimum distance of 20cm between the radiator and your body.

Limited Warranty

90 Days Limited Warranty

In the unlikely event that this product is defective, or does not perform properly, you may within ninety (90) days from your original date of purchase return it to the authorized service center for repair or exchange.

TO OBTAIN WARRANTY SERVICE:

- Provide proof of the date of purchase within the package (Dated bill of sale).
- Prepay all shipping costs to the authorized service center, and remember to insure your return.
- Include a return shipping address (no P.O. Boxes), a telephone contact number, and the defective unit within the package.
- Describe the defect or reason you are returning the product.

Your product will be repaired or replaced, at our option, for the same or similar model of equal value if examination by the service center determines this product is defective. Products received damaged as a result of shipping will require you to file a claim with the carrier.

The shipping address of the authorized service center is:

Southern Telecom, Inc.
Attention: Customer Service (2nd Floor)
14-C 53rd Street
Brooklyn, NY 11232

Should you have any questions or problems concerning this product, please contact our customer service department at:

Customer Support:
1-877-768-8483 (Toll Free)
cs@southern telecom.com

Monday - Friday: 8AM - 10PM (EST)

www.southern telecom.com

Warranty service not provided

This warranty does not cover damage resulting from accident, misuse, abuse, improper installation or operation, lack of reasonable care, and unauthorized modification. This warranty is voided in the event any unauthorized person opens, alters or repairs this product. All products being returned to the authorized service center for repair must be suitably packaged.

Limitation of Warranty:

• THE WARRANTY STATED ABOVE IS THE ONLY WARRANTY APPLICABLE TO THIS PRODUCT. ALL OTHER WARRANTIES, EXPRESS OR IMPLIED (INCLUDING ALL IMPLIED WARRANTIES OF MERCHANTABILITY OR FITNESS FOR A PARTICULAR PURPOSE) ARE HEREBY DISCLAIMED. NO VERBAL OR WRITTEN INFORMATION GIVEN BY A.I.T. INC. ITS AGENTS, OR EMPLOYEES SHALL CREATE A GUARANTEE OR IN ANY WAY INCREASE THE SCOPE OF THIS WARRANTY.

• REPAIR OR REPLACEMENT AS PROVIDED UNDER THIS WARRANTY IS THE EXCLUSIVE REMEDY OF THE CONSUMER. A.I.T. INC. SHALL NOT BE LIABLE FOR INCIDENTAL OR CONSEQUENTIAL DAMAGES RESULTING FROM THE USE OF THIS PRODUCT OR ARISING OUT OF ANY BREACH OF ANY EXPRESS OR IMPLIED WARRANTY ON THIS PRODUCT. THIS DISCLAIMER OF WARRANTIES AND LIMITED WARRANTY ARE GOVERNED BY THE LAWS OF THE STATE OF NEW YORK. EXCEPT TO THE EXTENT PROHIBITED BY APPLICABLE LAW, ANY IMPLIED WARRANTY OF MERCHANTABILITY OR FITNESS FOR A PARTICULAR PURPOSE ON THIS PRODUCT IS LIMITED TO THE APPLICABLE WARRANTY PERIOD SET FORTH ABOVE.

Some states do not allow the exclusion or limitation of incidental or consequential damages, or limitations on how long an implied warranty lasts so the above limitations on exclusions may not apply to you. This warranty gives you specific legal rights, and you also may have other rights that vary from state to state.

SHARPER IMAGE