

# Instruction Manual

# SYLVANIA

Active Multimedia Subwoofer System



SHTIB1046-BT

## WARNING

Don't place the product in the high temperature. Moist and place the product on a secure, stable surface. The product can cause serious damage if it fall.

Never open the product by yourself. It is an electrical shock hazards. If the repair is needed, It should be done by qualified electrician.

Take out all power cords immediately and do not use the product if damaged or water enter into the product with carelessness.

Do not maximize the volume when it is connected with the equipment which has output power. Or it may cause sound distortion.

Use the product only in indoor.

Unplug the power outlet, if you won't use more than two days.

## SPECIFICATION

- Output - R.M.S : 75W ( On product Right hand side )
- Frequency Response : 30Hz~20kHz
- Satellite Unit : 1.5" x 4 / 2 ohm
- Subwoofer Unit : 5" / 6 ohm
- Power Input : AC •120V/60Hz
- Subwoofer Size : W184xH184xD221mm
- Satellite Size : W86xH230xD74mm



Plug the 3.5mm audio cable into the 3.5mm audio input on the speaker system to begin the AUX-IN mode. If the 3.5mm audio cable not plug into the 3.5mm audio input will be Bluetooth mode and begin to pair automatically. Using the native controls on your Bluetooth device, select the "SHTIB1046-BT" in your Bluetooth settings to pair. If your device requests a password, enter the default password "0000". If the speaker system need to connected others Bluetooth device, should turn off the currently connected Bluetooth device to start the pairing process again.

1

## OPERATION STEP

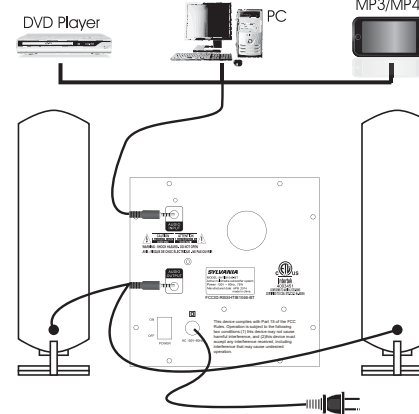

Note: This equipment has been tested and found to comply with the limits for a Class B digital device, pursuant to part 15 of the FCC Rules. These limits are designed to provide reasonable protection against harmful interference in a residential installation. This equipment generates, uses and can radiate radio frequency energy and, if not installed and used in accordance with the instructions, may cause harmful interference to radio communications. However, there is no guarantee that interference will not occur in a particular installation. If this equipment does cause harmful interference to radio or television reception, which can be determined by turning the equipment off and on, the user is encouraged to try to correct the interference by one or more of the following measures:  
—Reorient or relocate the receiving antenna.  
—Increase the separation between the equipment and receiver.  
—Connect the equipment into an outlet on a circuit different from that to which the receiver is connected.  
—Consult the dealer or an experienced radio/TV technician for help.

2

## IMPORTANT SAFETY INSTRUCTIONS

- 1) Read these instructions
- 2) Keep these instructions
- 3) Read all warnings
- 4) Follow all instructions
- 5) Do not use this apparatus near water
- 6) Clean only with dry cloth.
- 7) Do not block any ventilation openings. Install in accordance with the manufacturer's instructions.
- 8) Do not install near any heat sources such as radiators, heat registers, stoves, or other apparatus (including amplifiers) that produce heat.
- 9) Do not defeat the safety purpose of the polarized or grounding plug. A polarized plug has two blades with one wider than the other. A grounding plug has two blades and a third grounding prong. The wide blade or the third prong is provided for your safety. If the provided plug does not fit into your outlet, consult an electrician for replacement of the obsolete outlet.
- 10) Protect the power cord from being walked on or pinched particularly at the plugs, convenience receptacles, and at the point where they exit from the apparatus.
- 11) Only use attachments/accessories specified by the manufacturer.
- 12) Use only with the cart, stand, tripod, bracket, or table specified by the manufacturer, or sold with the apparatus. When a cart or rack is used, use caution when moving the cart/apparatus combination to avoid injury from tip-over.



- 13) Unplug the apparatus during lightning storms or when unused for long periods of time.
- 14) Refer all servicing to qualified personnel. Servicing is required when the apparatus has been damaged in any way, such as power supply cord or plug is damaged, liquid has been spilled or objects have fallen into the apparatus has been exposed to rain or moisture, does not operate normally, or has been dropped.
- 15) WARNING: The mains plug is used as disconnect device, the disconnect device shall remain readily accessible.
- 16) WARNING: To reduce the risk of fire or electric shock, do not expose this apparatus to rain or moisture. The apparatus shall not be exposed to dripping or splashing and that objects filled with liquids, such as vases, shall not be placed on apparatus.
- 17) This equipment is a Class II or double insulated electrical appliance. It has been designed in such a way that it does not require a safety connection to electrical earth.



3

# Mode D'emploi

# SYLVANIA

Système Multimédia Active De Caisson De Basses



SHTIB1046-BT

## AVERTISSEMENT

Ne pas placer le produit dans la haute température. Humide et placer le produit dans un environnement sécurisé, une surface stable.

Le produit peut causer de graves dommages si elle tombe.

Ne jamais ouvrir le produit par vous-même. Il s'agit d'un risque de choc électrique.

Si la réparation est nécessaire, elle doit être effectuée par un électricien qualifié.

Sortez tous les cordons d'alimentation immédiatement et ne pas utiliser le produit s'il est endommagé ou de l'eau entrer dans le produit avec insouciance.

Ne pas maximiser le volume quand il est connecté avec l'équipement qui a une puissance de sortie. Elle provoque des sons qu'il dispropotion.

Utilisez le produit uniquement dans l'intérieur.

Débranchez la prise d'alimentation, si vous voulez pas utiliser plus de deux jours.

## SPÉCIFICATIONS

- Sortie -R.M.S : 75W
- Fréquence de réponse : 30Hz-20kHz
- Unité de satellite : 1.5" x 4 / 2 ohm
- Unité de caisson de basses : 5" / 6 ohm
- Entrée d'alimentation : AC • 120V/60Hz
- Taille de caisson de basses : W184xH184xD221mm
- Taille de satellite : W86xH230xD74mm

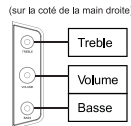

Plug the 3.5mm audio cable into the 3.5mm audio input on the speaker system to begin the AUX-IN mode. If the 3.5mm audio cable not plug into the 3.5mm audio input will be Bluetooth mode and begin to pair automatically. Using the native controls on your Bluetooth device, select the "SHTIB1046-BT" in your Bluetooth settings to pair. If your device requests a password, enter the default password "0000". If the speaker system need to connected others Bluetooth device, should turn off the currently connected Bluetooth device to start the pairing process again.

5

## ETAPE D'OPERATION

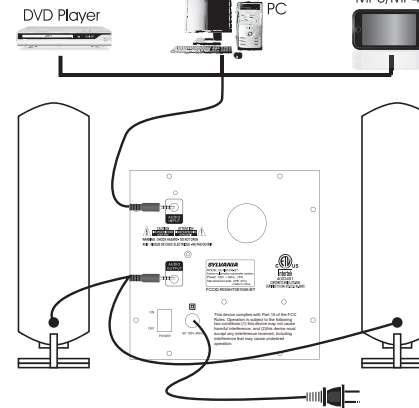

Note: This equipment has been tested and found to comply with the limits for a Class B digital device, pursuant to part 15 of the FCC Rules. These limits are designed to provide reasonable protection against harmful interference in a residential installation. This equipment generates, uses and can radiate radio frequency energy and, if not installed and used in accordance with the instructions, may cause harmful interference to radio communications. However, there is no guarantee that interference will not occur in a particular installation. If this equipment does cause harmful interference to radio or television reception, which can be determined by turning the equipment off and on, the user is encouraged to try to correct the interference by one or more of the following measures:  
—Reorient or relocate the receiving antenna.  
—Increase the separation between the equipment and receiver.  
—Connect the equipment into an outlet on a circuit different from that to which the receiver is connected.  
—Consult the dealer or an experienced radio/TV technician for help.

6

## CONSIGNES IMPORTANTES DE SÉCURITÉ

- 1) Lisez ces instructions
- 2) Conservez ces instructions
- 3) Respectez tous les avertissements
- 4) Suivez toutes les instructions
- 5) Ne pas utiliser ce appareil pris de l'eau
- 6) Nettoyer seulement avec un chiffon sec
- 7) Ne pas bloquer la ventilation openings. Install conformément aux instructions du fabricant.
- 8) Ne pas installer soignée toute source de chaleur comme les radiateurs, registres de chaleur, poêles ou autres appareils (y compris les amplificateurs) qui produisent de la chaleur.
- 9) Ne supprimez jamais la sécurité de la fiche polarisée ou d'échouement. Un bouchon polarized a deux lames with one est plus large que l'autre. Une fiche de terre a deux broches et Blades grounding tiers. La lame large ou la troisième broche est fournie pour votre sécurité. Si la fiche fournie ne rentre pas dans votre prise, consultez un électricien pour remplacer la prise obsolète.
- 10) Protégez le cordon d'alimentation ne soit piétiné ou pincé, particulièrement au niveau des bouchons, réceptacles commodité, et au point où ils sortent de l'appareil.
- 11) N'utilisez que des fixations / accessoires spécifiés par le fabricant.
- 12) Utilisez uniquement le chariot, stand, trépied, support ou table spécifiés par le fabricant ou vendu avec le appareil. When un chariot ou un support est utilisé, faites attention lorsque vous déplacez l'ensemble chariot / appareil pour éviter de vous blesser plus.



13) Débranchez l'appareil pendant les orages ou si inutilisé pendant de longues périodes de temps.

14) Confier toute réparation à un personnel qualifié. Une réparation est nécessaire lorsque l'appareil a été endommagé de quelque façon que ce cordon d'alimentation ou la fiche est endommagé, du liquide a été renversé ou des objets sont tombés dans l'appareil a été exposé à la pluie ou l'humidité, ne fonctionne pas normalement, ou s'il est tombé.

15) ATTENTION: La prise secteur est utilisée comme dispositif de déconnexion, le dispositif de déconnexion doit rester facilement accessible.

16) ATTENTION: Pour réduire le risque d'incendie ou de choc électrique, n'exposez pas cet appareil à la pluie ou appareils moisture. The ne doit pas être placé sur l'appareil.

17) Cet équipement est une classe II ou double isolation appareil électrique. Il a été conçu de telle façon qu'il ne nécessite pas une connexion à la terre de sécurité électrique.



7

耳神电声科技有限公司		型号:	设计:
技 术 要 求	1. 检测外观是否良好,不可有掉漆、刮伤、染色、印刷模糊、字迹、重影、污点、裂纹、脏污等。	规格: 100*140MM	审核:
	2. 漆面镀锌丝印部分, 应无掉漆、模糊等不良现象。	材质: 单本装订 128G 铜版纸	批准:
	3. 丝印颜色是否符合工厂或客户要求。	图号:	时间:
		版本:	页次: 1 / 1