

Bluetooth headset

BT801

User Manual

1 Appearance and parameter:

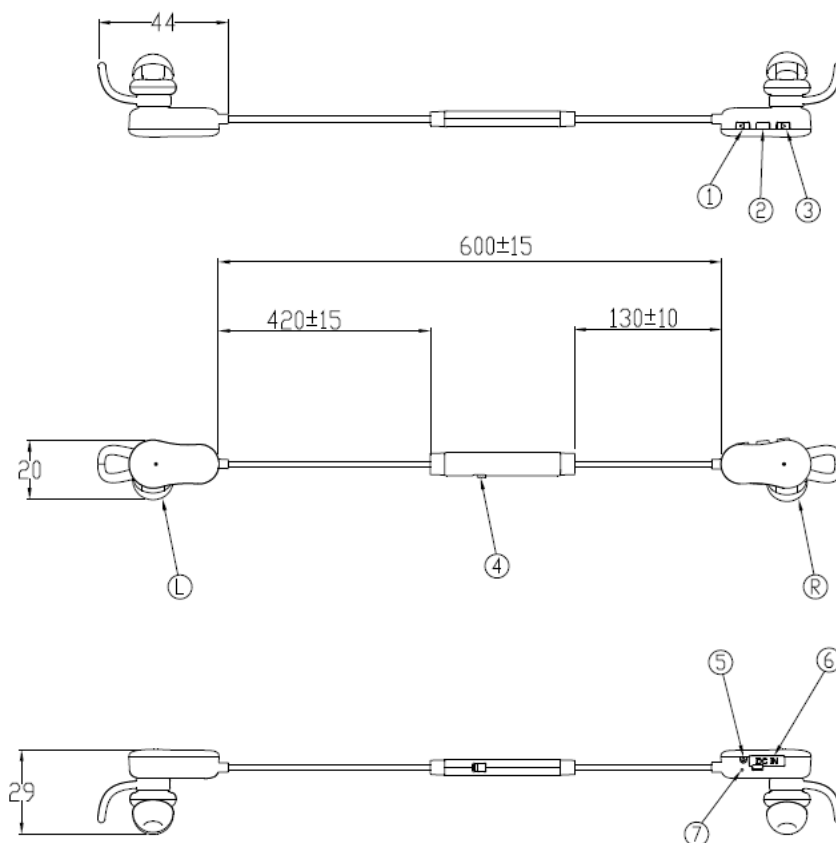

Button illustration:

1. Volume-
2. Multi-function button
3. Volume+
4. ANC-button
5. MIC
6. MICRO USB
7. LED

2.Basic Parameter

Product size: 688*29*20mm

Weight : TBD (bare unit)

Working Voltage: 3.7 V

Low battery voltage prompt: 3.4 V

Playing time: around 6 hours

Charging voltage: DC 5 V

Charging interface : MICRO USB

Charging time: about 1hours

Charging current: 120mA

Auto-shut-off time without connection : 5 minutes

ANC function: support active noise cancelling technology

Multi-point connection: Support one earbud connect two bluetooth mobile phones

Battery indicate: Support IOS system battery indication

Voice Prompt: Optional

APP extended function: Optional(Smart device should install APP first)

Audio Transmission :Support APTX

3 Components

3.1 Bluetooth

Bluetooth IC	CSR8645		
Bluetooth Version	4.1		
Profile	A2DP AVRCP HSP HFP		
RF carrier frequency	2402~2480MHz		
Receiving distance	360° 10meters		

3.2 ANC spec

ANC Spec:AMS AS3421

Noise cancelling: 10-20db(100Hz-1000Hz)

3.3MIC

MIC Spec:3.7*2.2*1.1mm MEMS MIC, Sensitivity: -42 ± 3 db

ANC Spec:3.7*2.2*1.1mm MEMS MIC, Sensitivity: -42 ± 3 dB

3.4 Battery

Battery Spec: 3.7V 120 mAh Polymer Li-ion Batteries

Battery size: 60*11*22 mm

Battery life: 300 times (discharge capacity \geq 80%)

3.5 Driver

Driver Spec: Φ 13MM

Resistance: 32 Ω

Rated Power: 3mW (Max:5mW)

Frequency response: 100Hz~10KHz;

Sensitivity: 100dB±3dB;

3.6 Finished product sound frequency: IEC711 test



4. Operation instruction:

Power ON: Press and hold the power button till the blue light is on.

Power off: Press and hold the power button till the red light is on.

ANC button : Push the ANC button to “1” ,ANC open ; push the ANC button to “0” ,ANC close

Pairing: In power-off mode, press and hold the power button until the red and blue light glitters in turn, then the unit comes into pairing mode.

Volume control: In music or conversation mode, press the Vol+ button to increase the volume, then press the Vol - button to decrease the volume.

Skip songs: In music mode, push and hold the Vol+ button for long to next song, then press and hold the Vol - button for long to previous song.

Pause /Play: Press the power button to pause or play the music.

Answering/ ending calls: Press the power button once to answer the incoming calls or ending the conversation.

Rejecting calls: Press and hold the power button for 2 seconds to reject the incoming calls.

Call mute: during the calling,press and hold the Vol+ & Vol- button,open/close the Call mute function.

Redial latest number: Double press the power button to redial last dialed phone number in user's cellphone automatically.

Voice dialing: In connection mode,press and hold the multi-functional button for 1second(need bluetooth device support voice dialing first)

Battery electric quantity checking: In power-on mode(not pairing mode),press the Vol+ or Vol- to check the electric quantity status.

App Extended function :Optional

Photo-taking function(Optional): Press power button to take photos(Smart device should install APP first)

5. LED indicator:

Low power warning: Red light glitters.

Charging : Red light is on.

Charging finished: Blue light is on.

Bluetooth connection: Blue light glitters slowly

Bluetooth disconnection: Blue light glitters quickly.

Pairing: red and blue lights glitters in turn.

6. Voice Prompt (optional)

POWER ON: 开机

POWER OFF: 关机

Connected: 已连接

Pairing: 配对

Battery Low: 电池电量低

7 . Optional accessories

Charging cable: 50CM Black micro USB cable

Silicon earhooks

Cable fastener/ Cable clip

Silicon eartips: large, medium,small

8. Working Environment

Working Temperature: -5~45℃。

Storage temperature: -20~70℃

9. FCC Statement

Changes or modifications not expressly approved by the party responsible for compliance could void the user's authority to operate the equipment.

This equipment has been tested and found to comply with the limits for a Class B digital device, pursuant to Part 15 of the FCC Rules. These limits are designed to provide reasonable protection against harmful interference in a residential installation. This equipment generates uses and can radiate radio frequency energy and, if not installed and used in accordance with the instructions, may cause harmful interference to radio communications. However, there is no guarantee that interference will not occur in a particular installation. If this equipment does cause harmful interference to radio or television reception, which can be determined by turning the equipment off and on, the user is encouraged to try to correct the interference by one or more of the following measures:

- Reorient or relocate the receiving antenna.
- Increase the separation between the equipment and receiver.
- Connect the equipment into an outlet on a circuit different from that to which the receiver is connected.
- Consult the dealer or an experienced radio/TV technician for help

This device complies with part 15 of the FCC rules. Operation is subject to the following two conditions (1) this device may not cause harmful interference, and (2) this device must accept any interference received, including interference that may cause undesired operation.