



TRUE VIEW™ COLOR VIDEO MONITOR

Birth & Up

08028

User Guide



At Safety 1st, we're not only about safety, we're also about your satisfaction. If you have any questions, please call our Consumer Relations department and let us help. We want to hear from you. 1-800-544-1108 or email us at consumer@safety1st.com.

⚠️ WARNING:

Please read the following instructions and warnings carefully. Keep these instructions for future reference. Tools needed: Flat Head Screwdriver (not included)

 **DANGER!**

To prevent electric shock, NEVER use the Transmitter or Receiver near water, such as a bathtub, sink, laundry tub, in a wet basement, etc.

 **WARNING!**

To prevent strangulation with power cord, never place transmitter within reach of child.

Important!

- Please read all warnings and assembly instructions carefully before using the video monitor.
- Parent Unit is a receiver. Baby unit is a transmitter.
- Check your child's activity at regular intervals, as this monitor will not alert parents to the silent activities of a child.
- To prevent entanglement with the adapter cord, NEVER PLACE THE CORD IN OR NEAR A CRIB OR PLAYPEN. DO NOT place the Receiver anywhere its AC adapter cord is near children.
- ALWAYS KEEP TRANSMITTER, RECEIVER AND AC ADAPTERS OUT OF REACH OF CHILDREN
- This product is not a medical monitor and its use should not replace adult supervision.
- Check the reception regularly.
- NEVER use the Transmitter or Receiver near water. For example, do not use near a bath tub, bathroom sink, laundry tub, kitchen sink, in a wet basement, etc.
- Always unplug the AC adapters from wall outlets during long periods of non-use.
- Position the Transmitter, Receiver and AC adapters to allow adequate ventilation and prevent these components from overheating.
- To prevent overheating, keep the Transmitter, Receiver and AC adapters away from heat sources such as radiators, heat registers, stoves or other appliances (including amplifiers) that produce heat. Also keep these components out of direct sunlight.
- Use only the AC adapters provided. Use of any other adapters may damage the Transmitter and/or Receiver. Plug the AC adapters into standard household current only 120V AC outlet! To prevent entanglement and overheating, DO NOT use extension cords.
- The AC adapters may become slightly warm to the touch during operation. This is normal.
- Position the AC adapter cords so that they are not walked on or pinched by items placed upon or against them, paying particular attention to cords at AC adapter plugs, wall plugs and the point where the cords attach to the Transmitter and Receiver.
- The LEDs emit IR (infra red) light that is not harmful.
- This product should be serviced only by qualified service personnel at Dorel Juvenile Group when:
 - An AC Adapter or its plug is damaged
 - The Transmitter or Receiver has fallen
 - Liquid has spilled into the Transmitter or Receiver, or
 - The Transmitter or Receiver do not appear to operate normally or exhibit a marked change in performance.
- DO NOT attempt to service this product beyond that described in the Troubleshooting section. All other servicing should be referred to qualified personnel at Dorel Juvenile Group.

 **WARNING!** 

TO REDUCE THE RISK OF FIRE OR ELECTRICAL SHOCK, DO NOT EXPOSE THIS PRODUCT TO WATER OR MOISTURE. NEVER ATTEMPT TO OPEN THE CASE OF THE PRODUCT. THIS IS DANGEROUS AND WILL VOID THE WARRANTY.

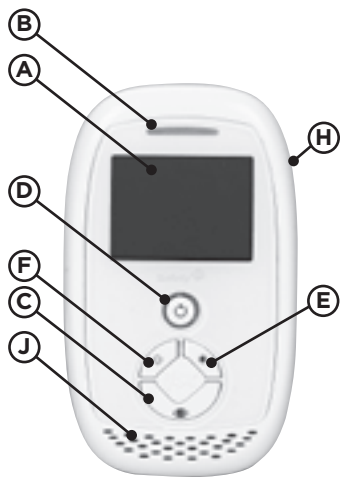

Parent Unit

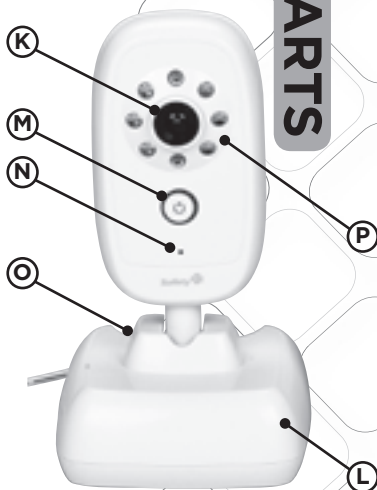

Baby Unit



2 AC Adapters



AAA Rechargeable Battery Pack

(already installed in Parent Unit)

Parent Unit

- A** Video Screen
- B** Sound Light Bar - Shows your baby's sounds
- C** Video Screen On/Off Button
- D** Power On/Off Button
- E** More Bright/Scroll Right
- F** Less Bright/Scroll Left
- G** AC Adapter Jack
- H** Volume Control
- I** Belt Clip
- J** Speaker

Baby Unit

- K** Camera Lens
- L** Base
- M** Power On/Off Button
- N** Microphone
- O** A/C Adapter Jack
- P** Nighttime Viewing Lights

QUICK START



1 Connect AC adapter to the side of the Parent Unit.

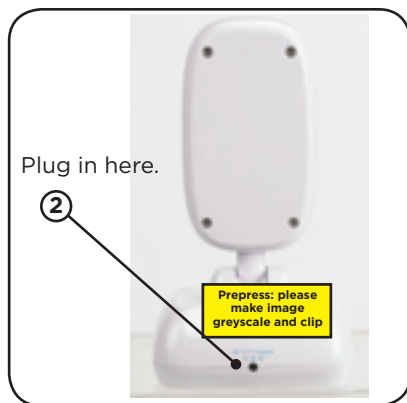

2 Connect AC adapter to the back of the Baby Unit.



3 Plug Parent Unit and Plug Baby Unit into wall to charge or to operate AC power.



4 Turn Parent Unit on. Hold down Power On/Off button until light comes on.

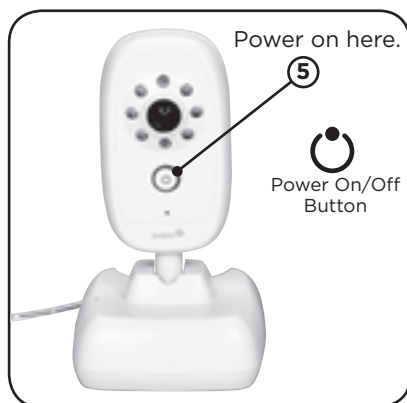

5 Turn Baby unit on. Hold down Power On/Off button until light comes on.



- Place the Baby Unit 4 to 6' (1.5 to 2m) away from the baby.
- To reduce audio feedback, position the Parent and Baby Units far enough away from each other to avoid interference. Turning the volume down will help.
- This monitor has indoor/outdoor range. During use of the monitor, if the sound quality deteriorates you may be reaching the limits of the monitor's range. If this happens, you will need to move the Parent Unit closer to the Baby Unit. You can verify using the link icon.
- Adjust the volume to a comfortable level for your environment.
- Night Vision lets you see the baby in a darkened room. The video display during this time is in black and white. For best view of your baby in a dark room, increase brightness control until desired brightness is achieved.
- Baby Unit can also be wall mounted. (See pg. 9.)

More Features, More Functions

Once you've set up your monitor and powered on, it's time to learn about the other parent convenience features your monitor has to offer. Keep reading to explore these features, including Video Screen On/Off button, Brightness control and the ability to make the Baby Unit portable for room-to-room or on-the-go convenience. You can set it up to conserve battery life as well.

Let's get started!

SOUND LIGHT BAR

The sound light bar will illuminate red from left to right as baby gets louder.



VOLUME ADJUST

Volume button is on side of Parent Unit. To adjust volume, press up (+) or down (-). Volume bars will display on screen. No bars means Parent Unit is on mute.

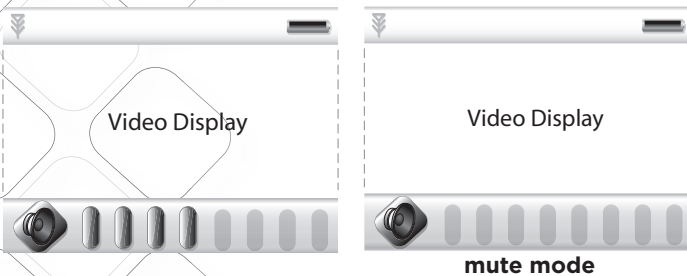

Volume Control is on side of Parent Unit

VIDEO SCREEN ON/OFF

Pressing the Video Screen On/Off button will turn the video screen on or off. When video is off, you can still hear your baby. Use this feature to help conserve battery life while still listening to your baby.

CONTROL PANEL

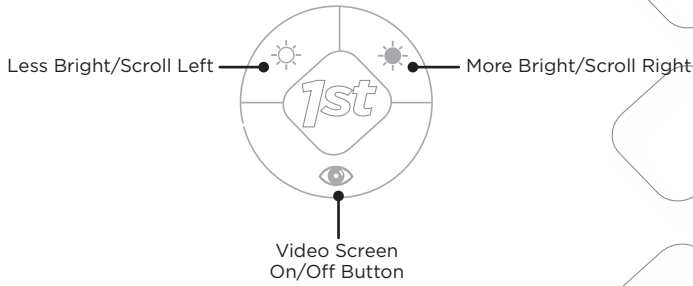

BRIGHTNESS

1-8.

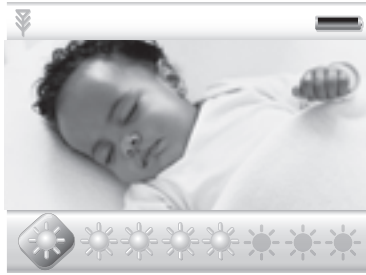

Scroll left/right for desired brightness setting.

MENU BAR



LINK INDICATOR



OUT OF RANGE:
will display when out of range



IN RANGE:
will display when units are linking

NIGHT VISION

Night Vision lets you see the baby in a darkened room. The video display during this time is in black and white. For best view of your baby in a dark room, increase brightness control until desired brightness is achieved.

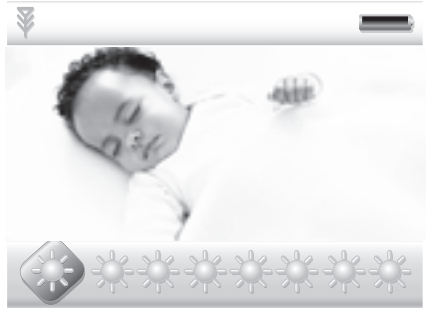

BATTERY CHARGING

With power off: When plugging in Parent Unit, Safety 1st screen will come on for 2 seconds, then a large flashing green battery will fill the center of the screen indicating charging. Also, the blue ring around the Power On/Off button will flash.

After approximately 10 seconds, the flashing battery turns off leaving a black screen, while the blue ring will continue to flash. Once charging is complete, a large flashing black battery will flash on screen for 10 seconds, then screen will go black and blue light ring will turn off.

With power on: When plugging in Parent Unit, it will boot up normally. The battery icon on the top menu bar will flash green to black and the blue light ring will flash blue. This will continue during charging cycle. When charging is complete, battery in menu bar will turn to solid black and the blue light ring will remain solid blue.

Battery Flashing Green



LOW BATTERY

With power on, the unit will have a large flashing red battery that pops up on a black screen to let the user know the battery is dying. Unit will sound quick beeps as well. This red battery will flash for 5 seconds, then return to normal video use for 30 seconds and the battery icon in the menu bar will flash red. Sequence will start again until unit is plugged in or turned off. You need to plug in the unit within about 10 to 15 minutes after flashing red battery starts or battery power will fail.

Battery Flashing Red



BATTERY CAUTION!

- DO NOT mix old and new batteries.
- DO NOT mix alkaline, standard (carbon zinc), or rechargeable (nickel-cadmium) batteries.
- Non-rechargeable batteries are not to be recharged.
- Check that all contact surfaces are clean and bright before installing batteries.
- The supply terminals are not to be short-circuited.
- DO NOT submerge any part of the product in water.
- Dispose of batteries safely.
- Remove batteries when stored for long periods of non-use.
- Unplug power cord before replacing batteries.
- Use only the adapters supplied with this product. Incorrect adapter polarity or voltage can seriously damage the product.
- THERE IS A RISK OF EXPLOSION IF THE BATTERIES ARE REPLACED BY AN INCORRECT TYPE.
- Use 3.6V AAA rechargeable battery pack ONLY for Parent Unit.

Figure 1

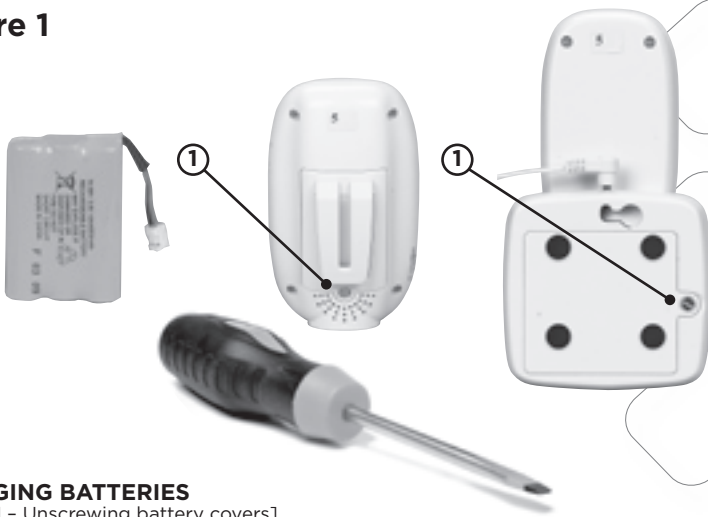

CHANGING BATTERIES

[Figure 1 - Unscrewing battery covers]

Unscrew battery covers (Figure 1) to remove and insert 4 AAA alkaline batteries in the camera (optional). Rechargeable battery pack is included in the Parent's unit. Secure each battery cover with the screw.

Contact Consumer Relations at 1-800-544-1108 to order a new battery pack. Use reference number 08096.



Use for Wall Mount

WALL MOUNTING THE CAMERA

Mounting the Baby Unit on a wall is similar to mounting a lightweight picture.

- Install a screw with a 5/16 head into the wall.
- Hang at the opening in back of the Unit.

TO TEST THE RECEPTION

IMPORTANT:

The first time you use your monitoring system two adults should test it in the following way:

Place the Parent Unit at least 20' (6m) away from the Baby Unit.

Have an adult speak into the Baby Unit at various levels (soft to loud) while another adult checks the Parent Unit for the proper sound and picture reception.

Try the Parent Unit in every location that it will be used.

TROUBLESHOOTING

PROBLEM	POSSIBLE CAUSE	SOLUTION
Unit has no sound/picture	<ul style="list-style-type: none"> - Volume is too low - Sound is off [symbol] - Out of range 	<ul style="list-style-type: none"> - Adjust the volume - Bring Parent Unit closer to Baby's Unit - Press [View icon] and hold for 2 seconds
Low Battery LED turns on, unit emits beeping sound	<ul style="list-style-type: none"> - Batteries are low 	<ul style="list-style-type: none"> - Recharge/replace batteries or use AC adaptor
On/Off button does not illuminate	<ul style="list-style-type: none"> - Unit is not turned on - Batteries are dead - Power is turned off 	<ul style="list-style-type: none"> - Push the button on the front of Receiver to the ON position - Charge battery/Make certain any light switches that control power to the wall outlet are on (when using AC) - Check AC Adapter jack-to-socket and plug-to-outlet connections
Audio feedback (squealing)	<ul style="list-style-type: none"> - Parent Unit is too close to the Baby Unit 	<ul style="list-style-type: none"> - Move the Parent Unit further away from Baby Unit - Turn down volume on Parent Unit to Mute to get minimum feedback
Weak sound coming from Parent's Unit	<ul style="list-style-type: none"> - Volume too low - Battery may be low - Baby is too far away from Camera on Baby Unit 	<ul style="list-style-type: none"> - Adjust volume - Change batteries - Move the Camera within 4' to 6' of Baby - Make certain nothing is blocking camera microphone
Picture is not clear	<ul style="list-style-type: none"> - Picture is blurry or not centered 	<ul style="list-style-type: none"> - Move camera location
Picture is Black & White during the day	<ul style="list-style-type: none"> - Room is too dark 	<ul style="list-style-type: none"> - Add more light to the room
Product battery life seems shorter than expected	<ul style="list-style-type: none"> - Video is ON all the time 	<ul style="list-style-type: none"> - Typical battery life with video ON all the time is 2 to 3 hours. Use the Quick View button to turn off video when not looking at the monitor to extend battery life.

Contact Consumer Relations at 1-800-544-1108 to order a new battery pack. Use reference number 08028.

FCC STATEMENT

Note: This equipment has been tested and found to comply with the limits for a Class B digital device, pursuant to part 15 of the FCC Rules. These limits are designed to provide reasonable protection against harmful interference in a residential installation.

This equipment generates, uses and can radiate radio frequency energy and, if not installed and used in accordance with the instructions, may cause harmful interference to radio communications. However, there is no guarantee that interference will not occur in a particular installation. If this equipment does cause harmful interference to radio or television reception, which can be determined by turning this equipment off and on, the user is encouraged to try to correct the interference by one or more of the following measures:

- Reorient or relocate the receiving antenna
- Increase the separation between the equipment and the receiver
- Connect the equipment into an outlet on a circuit different from that to which the receiver is connected.
- Consult the dealer or an experienced radio/TV technician for help.

WARNING: Changes or modifications not expressly approved by Dorel Juvenile Group can void your authority to operate this equipment.

ONE YEAR LIMITED WARRANTY

Dorel Juvenile Group, Inc. warrants to the original purchaser that this product (Prism Color Video Monitor) is free from material and workmanship defects when used under normal conditions for a period of one (1) year from the date of purchase. Should the product contain defects in material or workmanship Dorel Juvenile Group, Inc., will repair or replace the product, at our option, free of charge. Purchaser will be responsible for all costs associated with packaging and shipping the product to Dorel Juvenile Group Consumer Relations Department at the address noted on front page and all other freight or insurance costs associated with the return. Dorel Juvenile Group will bear the cost of shipping the repaired or replaced product to the purchaser. Product should be returned in its original package accompanied by a proof of purchase, either a sales receipt or other proof that the product is within the warranty period. This warranty is void if the owner repairs or modifies the product or the product has been damaged as a result of misuse.

This warranty excludes any liability other than that expressly stated previously, including but not limited to any incidental or inconsequential damages.

SOME STATES DO NOT ALLOW THE EXCLUSION OR LIMITATION OF INCIDENTAL OR CONSEQUENTIAL DAMAGES, SO THE ABOVE LIMITATION OR EXCLUSION MAY NOT APPLY TO YOU.

THIS WARRANTY GIVES YOU SPECIFIC LEGAL RIGHTS, AND YOU MAY ALSO HAVE OTHER RIGHTS THAT MAY VARY FROM STATE TO STATE.

Thank you for purchasing a Safety 1st product. We are not only about safety, we're also about your satisfaction. If you have any questions or comments, please call our Consumer Relations department at 1-800-544-1108 or e-mail us at consumer@djgusa.com.

We hope you love this product!