

Slim-Profile TV Mount

QUICK SETUP GUIDE

DX-TVM111

Thank you for choosing the Dynex DX-TVM111. The DX-TVM111 TV mount is designed to support a TV weighing up to 30 lbs. (13.6 kg).

Package contents

- A Wall plate (1)
- B TV bracket (1)
- C Locking bar (1)

M4 Bag

- D M4 × 12 mm screws (4)
- E M4 × 30 mm screws (4)
- F M4 spacers (4)
- G M4 washers (4)

Lag Bolt Bag

- H Concrete wall anchors (2)
- I 1/4 in. × 2 1/2 in. lag bolts (2)

Tools you will need:

- Power drill
- 1/8 in. wood drill bit
- 1/2 in. masonry drill bit
- Phillips screwdriver
- Level
- Socket wrench with 7/16 in. socket or adjustable wrench
- Pencil
- Stud finder
- Awl

1 Attach the TV bracket

NOTE: Make sure there will be enough space between the back of the TV and the wall to connect all your cables.

You can use the optional M4 spacers to provide additional space.

Without spacers: Attach the TV bracket (B)

to the back of the TV using the M4 washers (G) and the M4 × 12 mm screws (D).

With spacers: Attach the TV bracket (B) to the back of the TV using the M4 spacers (F), M4 washers (G), and M4 × 30 mm screws (E).

NOTE: You can mount the TV vertically or at an angle (tilt mount). See Step 3 for more information.

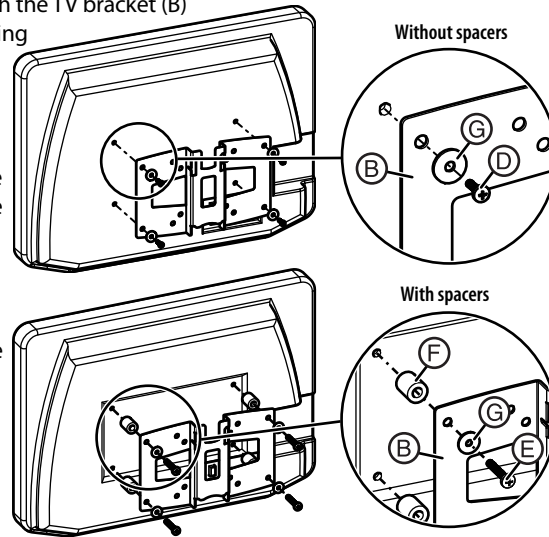

2 Install the wall plate

Option 1: Installing to a wood stud wall

- 1 Locate the stud. Verify the center of the stud with an awl or thin nail or use an edge to edge stud finder.
- 2 Level the wall plate (A) and mark the hole locations.
- 3 Drill the pilot holes as illustrated.
- 4 Align the wall plate with the pilot holes, insert the lag bolts (I) through the holes in the wall plate, then tighten the lag bolts only until they are pulled firmly against the wall plate (A). DO NOT over-tighten the lag bolts (I).

CAUTION: Avoid potential injuries or property damage! Any material covering the wall must not exceed 5/8 in. (16 mm).

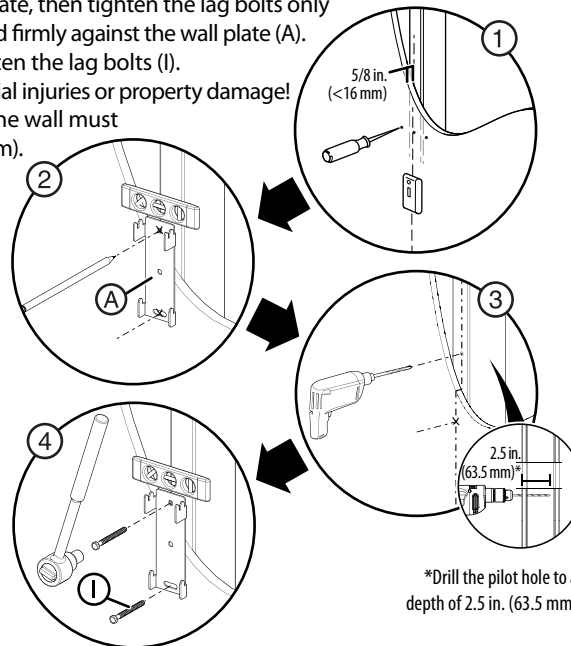

Option 2: Installing to a concrete wall

- 1 Level the wall plate (A) and mark the hole locations.
- 2 Drill the pilot holes as illustrated.
- 3 Insert the concrete wall anchors into the pilot holes and make sure that the anchors (H) are seated flush with the surface.
- 4 Align the wall plate with the anchors, insert the lag bolts (I) through the holes in the wall plate, then tighten the lag bolts (I) only until they are pulled firmly against the wall plate (A). DO NOT over-tighten the lag bolts (I).

CAUTION: Avoid potential injuries or property damage!

Any material covering the wall must not exceed 5/8 in. (16 mm).

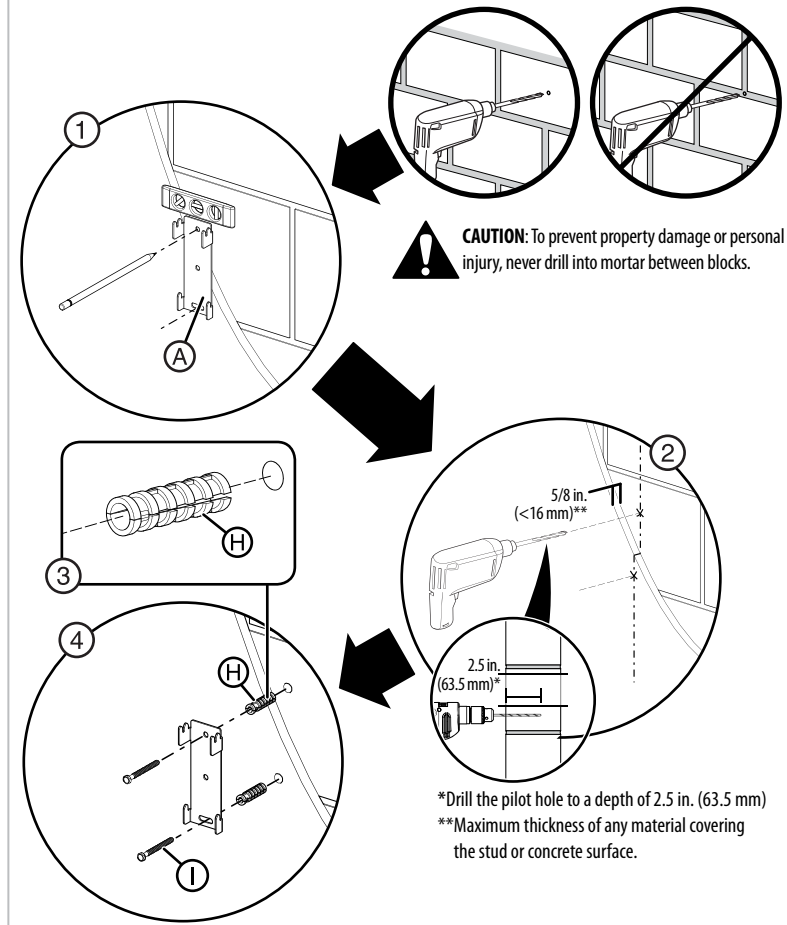

*Drill the pilot hole to a depth of 2.5 in. (63.5 mm)
**Maximum thickness of any material covering the stud or concrete surface.

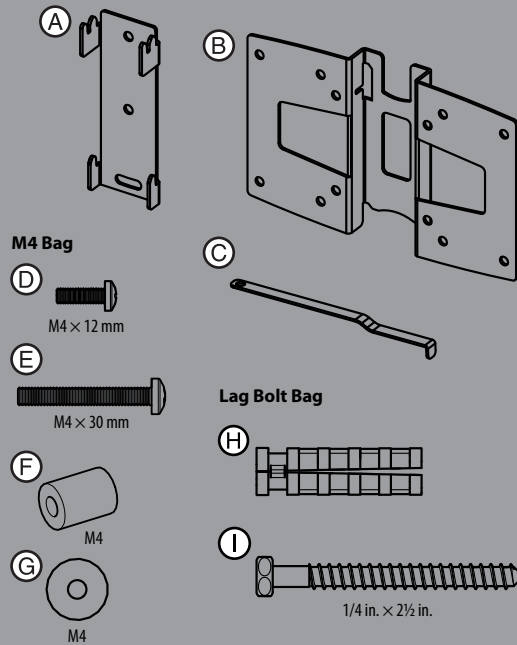

3 Mount the TV to the wall

Place the TV bracket into the slotted flanges of the wall plate. The TV can be mounted either (1) vertically or (2) with a 5-degree tilt.

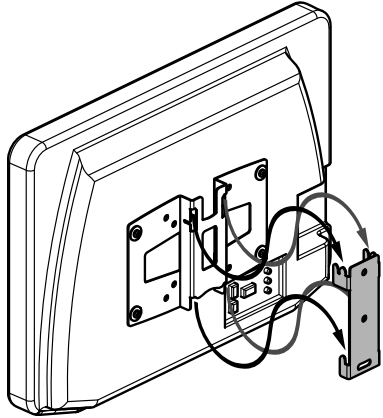

HEAVY! You will need assistance with this step.

Vertical mount

Note: Attach the TV bracket to the flange that is closest to the wall plate.

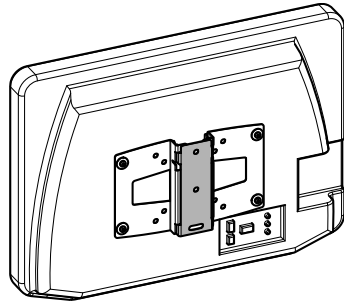
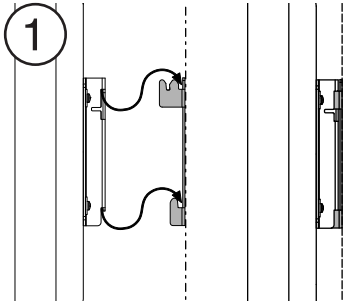

Tilt mount

Note: Attach the TV bracket to the flange that is farthest from the wall plate.

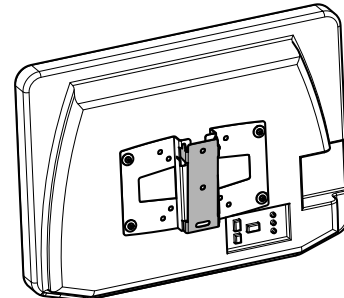
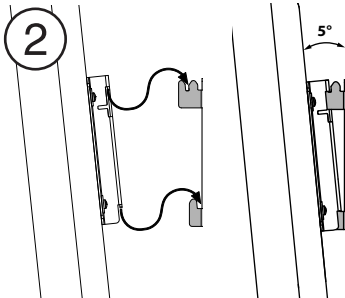

4 Lock the TV to the wall plate

Slide the locking bar (C) through the TV bracket (B) and the wall plate (A) to secure the TV. A padlock (not included) may be used for extra security.

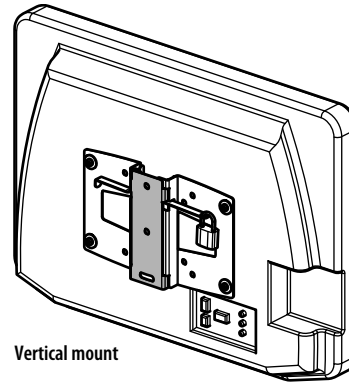
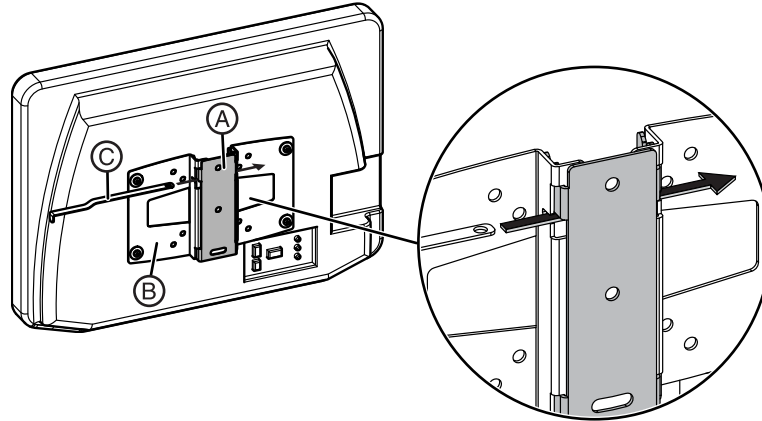

Vertical mount

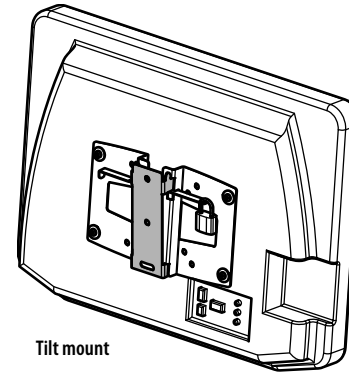

Tilt mount

DYNEX™

IMPORTANT SAFETY INSTRUCTIONS SAVE THESE INSTRUCTIONS

CAUTION: Do not use this product for any purpose not explicitly specified by Dynex. Improper installation may cause property damage or personal injury. If you do not understand these directions, or have doubts about the safety of the installation, contact Customer Service or call a qualified contractor. Dynex is not responsible for damage or injury caused by incorrect installation or use.

The weight of your TV must not exceed 30 lb (13.6 kg). The wall must be capable of supporting five times the weight of the TV and wall mount combined.

This product contains small items that could be a choking hazard if swallowed. Keep these items away from young children!

3-year limited warranty

Visit www.dynexproducts.com for details.

We're here for you

www.dynexproducts.com

For customer service, call:

800-305-2204 (U.S./Canada markets)

01 800-926-3020 (Mexico market)

© 2010 BBY Solutions, Inc., All Rights Reserved.

Distributed by Best Buy Purchasing, LLC 7601 Penn Avenue South, Richfield, MN USA 55423-3645

Best Buy Imports, S. de R.L. de C.V. Av. Santa Fe 485, Segundo Piso, Colonia Cruz Manca, Programa Parcial de Desarrollo Santa Fe, Delegación Cuajimalpa, Distrito Federal, México 05349

© 2010 Best Buy UK Distributions Limited. All rights reserved. Distributed by Best Buy Europe Distributions Limited, 1 Portal Way, London W3 6RS

DYNEX is a trademark of BBY Solutions, Inc. Registered in some countries. All other products and brand names are trademarks of their respective owners.

6907-002009 <00>

ENGLISH 10-0163