

bēm[®]
WIRELESS

speaker mojo II

USER GUIDE

Product Overview

In order to make sure you get the best possible results from your new Speaker Mojo II, please thoroughly read and carefully follow all instructions in this User's Manual or on the product. Keep this User's Manual in a convenient location for future reference.

Package Contents:

Speaker Mojo II x 1
Power cradle x 1
Power adapter x 1
Micro USB charging cable x 1
Aux cable x 1
User's Manual x 1

If any of the above contents were missing or damaged, please visit bemwireless.com/support/ to obtain a replacement. Please do not return to Club, please call 855-839-8616 if you have any questions or issues with the Speaker Mojo II.

Compatibility

All devices enabled with Bluetooth technology, including iPhones, iPads, iPods, smartphones, laptops, tablets and more.

Also compatible with any device that has a standard 3.5mm earphone jack such as MP3 players, PSP, mobile phones, etc.

Meet the Speaker Mojo II

Before learning about your Speaker Mojo II, take a moment to look it over and familiarize yourself with its features.

2

IMPORTANT : SELECT SPEAKER MODE PRIOR TO TURNING ON SPEAKER (S)

Product Interface

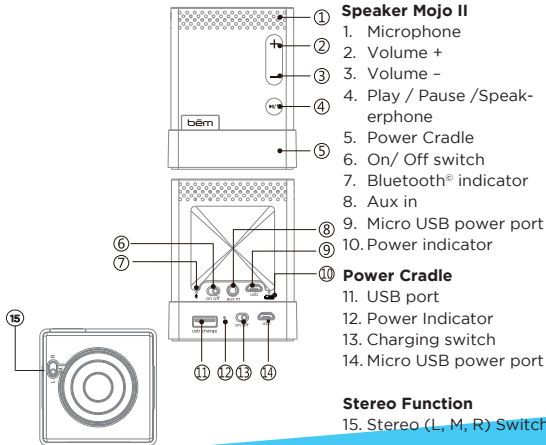

Speaker Mojo II

1. Microphone
2. Volume +
3. Volume -
4. Play / Pause / Speakerphone
5. Power Cradle
6. On/ Off switch
7. Bluetooth® indicator
8. Aux in

9. Micro USB power port
10. Power indicator

Power Cradle

11. USB port
12. Power Indicator
13. Charging switch
14. Micro USB power port

Stereo Function

15. Stereo (L, M, R) Switch

IMPORTANT: SELECT SPEAKER MODE PRIOR TO TURNING ON SPEAKER(S)

Charging Modes

1. Direct Speaker Charge

Connect the standard USB end of the supplied USB cable to a USB power source (PC, USB power adapter...etc.). Connect the Micro USB jack to the USB charging port on the Speaker Mojo II. It will take about 2 hours to fully charge the Speaker Mojo II alone.

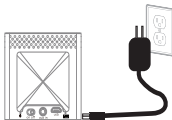

Charging Indicator Light Modes

Power indicator on Speaker Mojo II

- Red LED: Speaker Mojo II is charging;
- No LED: Battery is fully charged
- Note: When the battery is low, you will hear a tone signaling you to charge the unit soon

2. Power Cradle Charge

The Power cradle is a backup battery pack for Speaker Mojo II and your Bluetooth device. Connect the standard USB end of the supplied USB cable to a USB power source (PC, USB power adapter...etc.). Connect the Micro USB jack to the USB charging port on the power cradle. The charging indicator will light up while charging. It will take about 3 hours to fully charge the power cradle.

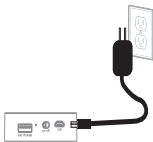

Charging Modes (Cont.)

Indicator on power cradle

- Red LED : Charging, it will go off when it is fully charged;
- Blue LED : power output is on.

3. Wireless Conductive Charging via Power Cradle

Connect the standard USB end of the supplied USB cable to a USB power source (PC, USB power adapter... etc.). Connect the Micro USB jack to the USB charging port on the power cradle. The charging indicator will light up while charging. If you put Speaker Mojo II onto the power cradle, it will charge them both at the

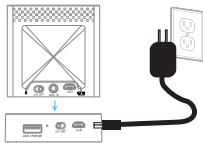

same time whether you connect the power to the Speaker Mojo II or power cradle. It will take about 5 hours for charging them at the same time. Once both are fully charged, the battery life of the Speaker Mojo II can be doubled. This can be done by turning on the power cradle, placing the Speaker Mojo II on the cradle and turning it on while playing music.

Please note, the Speaker Mojo II LED charging indicator will not light up when the speaker is charging on the Power Cradle

IMPORTANT: SELECT SPEAKER MODE PRIOR TO TURNING ON SPEAKER(S)

Charging Modes (Cont.)

4. Charging Other USB Enabled Devices via Power Cradle

The included Power Cradle can also be used to charge other USB enabled devices. Simply follow the steps listed in number 2 to charge up the Power Cradle. You can now take the power cradle with you on the go to charge various other smart devices via USB. You can do so by connecting the standard USB end of a USB cable to the USB port in the back of the Power Cradle. Then plug the other end into your smart device.

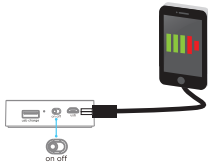

Slide the power switch to “on” to turn it on and begin charging other smart devices. The blue indicator light will light up to signify the unit is on. Slide the power switch to “off” to turn off the power cradle. The blue indicator light will go out and your smart devices will no longer charge via USB.

Play Modes

Speaker Selection (Mode)

Important: Before you go to turn on the Speaker Mojo II please stop and read these instructions carefully.

The Speaker Mojo II can be played in a couple of different ways. Mono mode will allow you to work with just one speaker or stereo mode which allows you to pair up two speakers.

6

IMPORTANT: SELECT SPEAKER MODE PRIOR TO TURNING ON SPEAKER(S)

Play Modes (Cont.)

Playing in Mono Mode: Make sure the switch on the bottom of the speaker is switched to "M" before turning on the speaker

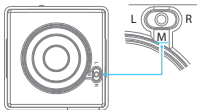

Playing in Stereo Mode: One speaker must be switched to "L" on the bottom and the other must be switched to "R" before turning them on.

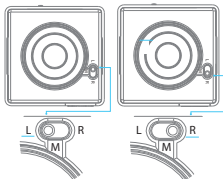

Power on / Power off

Slide the power switch to "on" to turn on the Speaker Mojo II. The Bluetooth indicator will light up blue to signify the unit is on and ready to be paired.

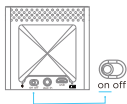

Slide the power switch to "off" to turn off the unit and the Bluetooth indicator light will go out.

IMPORTANT: SELECT SPEAKER MODE PRIOR TO TURNING ON SPEAKER(S)

Play Modes (Cont.)

Single Speaker

- **Bluetooth mode:** Play an audio signal from the connected Bluetooth device. Before turning the Speaker Mojo II on, turn the speaker over so that the bottom of the speaker is facing up. Locate the stereo switch (L,M,R) on the speaker and make sure that it is set to the “M” or mono setting.
- Now turn on the Speaker Mojo II. Once the Speaker Mojo II has entered Bluetooth mode, the Bluetooth icon will light up blue and the tone confirming that the unit is currently in Bluetooth pairing mode will sound.
- Go to the Bluetooth settings on your smart device to find the device named “Mojo II”. A tone will sound to confirm the device has paired successfully. Next time the Speaker Mojo II and connected device will pair automatically.
Please note: Mojo II will not show up as an available device unless you have set the stereo switch to “M”. Your device must be within 40 feet of the speaker while in bluetooth mode.
- **Direct Connection Mode (Aux In):** To play music via direct connection simply insert the included Aux cable into the Aux in port on the back of the Speaker. Direct connection mode is not supported in Stereo Mode.

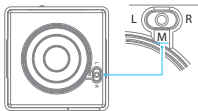

Play Modes (Cont.)

- *Please Note: If an Aux cable is connected to the speaker it will not play music from Bluetooth® connected devices.*

Stereo Speaker Mode (Two Speakers)

- **Bluetooth mode:** The Speaker Mojo II has the ability to be connected together with another Speaker Mojo II to enter into stereo speaker mode. To enter into stereo speaker mode, begin by selecting either one of the Speaker Mojo II speakers and slide the stereo switch on the bottom of the speaker to “L” which stands for left.
- Take the other speaker and slide the stereo switch to “R” which stands for right. Now turn on the speakers and they will auto pair to each other within 10 seconds of being turned on.
- Go to the Bluetooth settings on your smart device to find the device named “Mojo II”. A tone will sound to confirm the device has paired successfully. Next time the Speaker Mojo II and connected device will pair automatically.



IMPORTANT: SELECT SPEAKER MODE PRIOR TO TURNING ON SPEAKER(S)

Play Modes (Cont.)

- *Note: If you are in Stereo Mode and the “R-speaker” disconnects due to being too far apart, the music playing on the “L-speaker” will pause. In stereo mode the speakers can be no more than 20 feet apart from each other. Once you are back in the above range of operation for the two speakers, they will reconnect by themselves automatically. When paired successfully again, there will be indication sound signaling a reconnection, and the two speakers will begin playing music within 3 seconds.*
- **Direct Connection Mode (Aux In):** Direct connection via Aux In is not supported in Stereo Speaker mode. Please refer to the “Direct Connection Mode” section on Page 8 for information on how to connect to a single speaker.

Operation Details

Audio Use

Follow the connection steps to pair a Bluetooth® device with the Speaker Mojo II. At this point you can send any kind of audio signal to your speaker (music, video, gaming, etc.). Just use your device as normal and the audio will play through your Speaker Mojo II.

Controls

Press the Play/Pause button to play or pause the music when using a music player through your Bluetooth® connected device.

Pressing the + and - buttons will increase or decrease the volume on the Speaker Mojo II. Please note that this will not affect the volume levels on the connected device. When the volume level on the speaker has reached capacity you will hear a tone. In stereo mode either speaker can be used to control volume level and play/pause.

Connection

Laptop / Notebook / PC

As the Bluetooth® versions for these types of devices varies greatly, the connection methods will differ as well. If you can not connect with the Speaker Mojo II using the previous method instructed you may need to install a new version of the Bluetooth® driver.

Please reference the instructions of device for details.

IMPORTANT: SELECT SPEAKER MODE PRIOR TO TURNING ON SPEAKER(S)

Operation Details (cont.)

Speaker Phone

After pairing your mobile phone to Speaker Mojo II with Bluetooth, the speaker phone function can be used.

- Making a call: Call will automatically transfer to the speakerphone. If not, tap play/pause button;
- Answering a call: Tap play/pause button to answer the incoming call;
- Ending a call : Tap play/pause button during the call to end the call;
- Rejecting a call : Hold play/pause button to reject the incoming call;
- Redial last number: Double tap play/pause button to redial the last number when it is not in a call.

If you are using the speaker phone function in Stereo Speaker Mode, please note that the call will come through the "L" speaker. The volume and microphone functions will only work on the "L" speaker.

Troubleshooting

Issue: Pairing is unsuccessfully after multiple attempts

Solution:

- Check if the Bluetooth indicator light is on. If the indicator light is off, please press the power button to turn the unit on. If the Bluetooth indicator light still doesn't come on after pressing the power button, please charge the unit.
- Check for other Bluetooth devices around the surroundings that may interfere with searching and turn devices off.
- If pairing in single "Mono Mode" make sure the switch on the bottom of the speaker is sitting on "M".
- Power off and then power on the unit to restart the Bluetooth. Unplug any cables plugged into the AUX IN, restart all devices and then attempt pairing again.

Issue: Pairing in Stereo Mode is unsuccessfully after multiple attempts

Solution:

- First check to see that one speaker is switched to "L" on the bottom, and the other is switched to "R". Turn off the speakers then turn them back on.
- Check to make sure that all cables are unplugged from the AUX IN port.
- If you would like to enter into "Stereo Mode" from "Mono Mode" you will need to turn off both speakers. Then select one of the speakers to be the "L" speaker and one to be the

IMPORTANT: SELECT SPEAKER MODE PRIOR TO TURNING ON SPEAKER(S)

Troubleshooting (cont.)

“R” speaker by sliding the switch on the bottom of each speaker.

- Be sure to make your mode selection (Mono or Stereo) while the speakers are powered off. Then turn them on.

Issue: Interference or static during playback

Solution:

- Avoid using the device between concrete or other building structures that may interfere with the signal.
- Please check if the battery level of the unit and the Bluetooth® device and charge if necessary.

For more troubleshooting help go to <http://bemwireless.com>

Maintenance

Please follow the instructions below for cleaning your Speaker Mojo II

- Power off the unit and unplug the power adapter from wall outlet
- Use a soft, dry, lint-free cloth and wipe gently
- Do not use alcohol, benzene, thinners or other chemical detergents as these can cause the casing to be warped or discolored

For questions, comments or to purchase more bēm wireless products go to bemwireless.com

Storage

- Power off the Speaker Mojo II If the unit will not be used for an extended period of time.
- Do not set the unit in a damp environment, high temperatures or in direct sunlight.

More Info

For questions, comments or to purchase more bēm wireless products go to: **bemwireless.com**

You can also follow us at:



facebook.com/bemwireless



twitter.com/bemwirelessco



youtube.com/bemwireless

For information on your product's warranty go to:
bemwireless.com/support

IMPORTANT: SELECT SPEAKER MODE PRIOR TO TURNING ON SPEAKER(S)

FCC Statement

1. This device complies with Part 15 of the FCC Rules.

Operation is subject to the following two conditions:

- This device may not cause harmful interference.
- This device must accept any interference received, including interference that may cause undesired operation.

2. Changes or modifications not expressly approved by the party responsible for compliance could void the user's authority to operate the equipment.

NOTE: This equipment has been tested and found to comply with the limits for a Class B digital device, pursuant to Part 15 of the FCC Rules. These limits are designed to provide reasonable protection against harmful interference in a residential installation.

This equipment generates uses and can radiate radio frequency energy and, if not installed and used in accordance with the instructions, may cause harmful interference to radio communications. However, there is no guarantee that interference will not occur in a particular installation. If this equipment does cause harmful interference to radio or television reception, which can be determined by turning the equipment off and on, the user is encouraged to try to correct the interference by one or more of the following measures:

- Reorient or relocate the receiving antenna.
- Increase the separation between the equipment and receiver.
- Connect the equipment into an outlet on a circuit different from that to which the receiver is connected.
- Consult the dealer or an experienced radio/TV technician for help

FCC Radiation Exposure Statement

This equipment complies with FCC radiation exposure limits set forth for an uncontrolled environment. This equipment should be installed and operated with minimum distance 20cm between the radiator & your body.

CE2200

IC Caution.

- English:

This device complies with Industry Canada licence-exempt RSS standard(s).

Operation is subject to the following two conditions: (1) This device may not cause interference, and (2) This device must accept any interference, including interference that may cause undesired operation of the device.

This equipment should be installed and operated with a minimum distance of 20 cm between the radiator and your body.

- French:

Le présent appareil est conforme aux CNR d'Industrie Canada applicables aux appareils radio exempts de licence. L'exploitation est autorisée aux deux conditions suivantes:

- (1) l'appareil ne doit pas produire de brouillage, et
- (2) l'utilisateur de l'appareil doit accepter tout brouillage radioélectrique subi, même si le brouillage est susceptible d'en compromettre le fonctionnement.

Cet équipement doit être installé et utilisé à une distance minimale de 20 cm entre le radiateur et votre corps.

IMPORTANT : SELECT SPEAKER MODE PRIOR TO TURNING ON SPEAKER (S)

Technical Specifications

Note: All specifications are subject to change without notice

Product Name : Speaker Mojo II

Model Number : HL2750

Power Supply: 5V,1A

Output Power: 1.5W X 2

USB charging output: 5V,1A x 1

Bluetooth V2.1+EDR , profile Supported: A2DP, AVRCP

Working Range: Approximately 40ft, 12m

Working atmosphere: 0°C-40°C / 20%-90%RH

bēm wireless

<http://bemwireless.com/>

bēm wireless LLC.

1725 Kilkenny Ct.

Woodstock, IL, USA

Made in China

Safety Instructions

This product is specially designed based on the full attention to safety; in order to make sure the accident-free operation, please abide the guidelines listed below:



- Always position the unit on a stable and level surface. Unstable surface can cause the unit to topple and fall, resulting in possible damage or injury
- Do not drop, unpack, open, beat, curve, prink and burn the unit
- Avoid using the unit nearby basins or sinks where it may come in contact with water
- Do not place any ware with full water on the top of the unit, such as vase, glass, pot, and please avoid placing candle on the speaker surface as well
- Protect the using of the unit from any overheating devices (such as radiator, heating installation, cooking stove or other heating devices)
- Regardless of what reasons cause the unit damage, please ask for the maintenance personnel to repair
- If you want to do the cleaning, please turn off the unit and unplug the power cable from the outlet first
- Set the volume properly to prevent injury to the unit and your personal health.

IMPORTANT : SELECT SPEAKER MODE PRIOR TO TURNING ON SPEAKER (S)

Safety Instructions (cont.)

Correct Disposal of this product. This marking indicates that this product should not be disposed with other household wastes throughout the EU. To prevent possible harm to the environment or human health from uncontrolled waste disposal, recycle it responsibly to promote the sustainable reuse of material resources. To return your used device, please use the return and collection systems or contact the retailer where the product was purchased. They can take this product for environmental safe recycling

WARNING:

- The battery (battery or batteries or battery pack) shall not be exposed to excessive heat such as sunshine, fire or the like.
- No naked flame sources, such as lighted candles, should be placed on the apparatus.
- CAUTION: Danger of explosion if battery is incorrectly replaced. Replace only with the same or equivalent type.

bemwireless.com

bēm wireless | 1725 Kilkenny Court | Woodstock IL 60098

TEL: 855-839-8616

© 2015 bēm wireless