

***10.2" Roof-Mounted DVD Combo***



**User's Manual**



# Table of Contents

<b>Introduction</b> .....	2
<b>Important Notice</b> .....	2
<b>Before Use</b> .....	3
<b>Product Features</b> .....	3
<b>Optional Devices</b> .....	4
<b>Basic Functions</b>	
RSE Panel Button Functions. ....	5
Remote Control Functions. ....	7
IR Earphones Functions. ....	9
<b>General Operations</b>	
DVD/VCD/MP3/CD. ....	10
Status Settings. ....	13
Monitor .....	16
FM Transmitter .....	17
IR Transmitter .....	18
LED Button. ....	19
<b>Disc Playback</b>	
DVD/VCD Video Disc Playback. ....	20
CD/MP3 Disc Playback. ....	22
<b>A/V Source</b> .....	24
<b>DLNA(Digital Living Network Alliance)</b> .....	25
<b>MIRACAST Function</b> .....	32
<b>USB Source</b> .....	35
<b>Specification</b> .....	37
Supportable File Types for USB .....	38
Turning off the machine. ....	38
<b>Glossary</b> .....	39
<b>Basic Trouble Shooting</b> .....	41

Thank you for your Purchase!

Please read through this instruction manual thoroughly and carefully, in order to properly operate this equipment. Please keep this instruction manual in a safe place for further reference after reading.

## ***Important Notice***

- To prevent the risk of traffic accidents and violation of traffic laws and regulations, this equipment should not be installed within the driver's line of sight.
- It is illegal for passengers to view the screen in some countries or states. If situated in such regions where these regulations apply, these regulations must be complied with.



### **Note**

- Please keep this instruction manual in an easily accessible storage area for easy reference on operating procedures and notices.
- Please do not let the product get in contact with water.
- Please close the screen before turning off the engine to ensure the product's longevity.
- If the product cannot operate normally, please contact the dealer or a nearby service center.
- Do not attempt to disassemble the machine yourself, in case of possible danger or further malfunctions. The insurance does not cover this issue.
- Please do not use mobile phone while operating this product to prevent the sound disturbance.

## ***Before Use***

---

Please make sure that the items listed below are in the package. If there is something missing, please contact the dealer where the product was bought. Please read and understand the operation of this product before using, and please follow this user's manual instruction.

## ***Product Features***

---

- Adopt 10.2" TFT-LCD monitor with monitor angle memory.
- Support three kinds of aspect ratios [FULL, WIDE (16:9), NORMAL (4:3)].
- Allow CD-ROM of DVD, VCD, CD, CD-R, CD-RW and MP3 formats.
- Allow automatic switching to NTSC/PAL system.
- AV input x 2 (AV1& AV2).
- Panel angle, 90 to 115 degree, is not affected by vibration.
- Can be controlled by Remote Control.
- Support USB 2.0
- Support Miracast and DLNA.
- IR earphones are optional.

**Optional Devices**



**Remote Control  
(With Battery)**



**IR Earphones  
(With 2 AAA Battery)**

**Note: Available in some vehicles.**



**DVD Player &  
10.2" TFT LCD Panel**

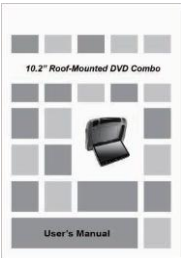

**User's Manual**

# Basic Functions

## RSE Panel Button Functions



1. TFT & DVD disc tray release button: Press once to open the TFT monitor (the monitor will automatically drop down), and press twice to open the disc tray (pickup and place the disc in the tray).
2. IR emitter and receiver: Use the IR emitter to transmit the sound to the IR earphones and receive the signal from the remote control.
3. SRC buttons (When press SRC button, media can be selected as following.)
  - (1) DVD
  - (2) AV1 video signal from DVD of main head unit.
  - (3) AV2 video signal from any video player
  - (4) Miracast / DLNA
  - (5) USB
4. TFT angle adjustment knob (Rotate it up to adjust the monitor towards users and rotate it down to adjust monitor turning out from users.)
5. 10.2" TFT Panel
6. Dome lamp switch: Switch to select to ON, DOOR or OFF.
7. AV IN connects one external video and audio input.
8. Average lifetime of LED lamp is 10,000 hrs.
9. Power button (Press PWR button to turn ON or OFF the RSE.)

10. Menu Button (Press MENU to enter OSD setting.)
11. Next chapter button: (Press it: For OSD setting, press to move selection to the right. For USB mode, press to skip to next section, song, video or photo.)
12. Play / Pause button (Press it: For OSD setting, press to confirm, enter or choose the selection. For USB mode, press the button to play or pause.)
13. Previous button (Press it: For OSD setting, press to move selection to the left. For USB mode, press twice to go back to previous section, song, video or photo.)
14. Volume Up (General function: increase the volume. In OSD setting mode, move selection up.)
15. Volume Down (General function: reduce the volume. In OSD setting mode, move selection down.)
16. Mute (Press to mute audio and press again to unmute.)
17. USB Port



### **Note**

- Use only LED from original LED manufacturer. Other LED may overheat causing damage due to melting.



# Basic Functions

## Remote Control Functions

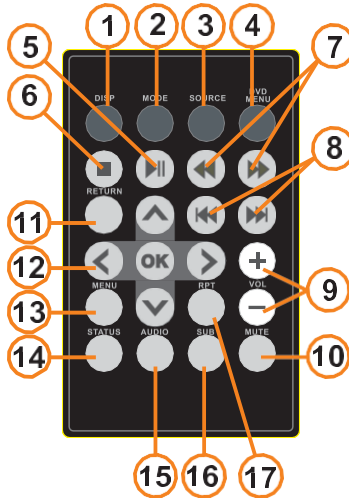

1. DISP button (Use only for roof monitor with DVD.)
2. MODE button (Press it to choose a source of multimedia such as DVD, AV1, AV2, MIRACAST / DLNA or USB.)
3. SOURCE button (Press it to choose a source of multimedia such as DVD, AV1, AV2, MIRACAST / DLNA or USB respectively.)
4. DVD Menu button (Press it to get into the DVD menu page. Use for roof monitor with DVD only.)
5. PLAY / PAUSE button (Press it to play or pause the video or audio, and press it again to continue playing the video or audio. This function is similar to other general entertainment products.)
6. STOP button (Press it to stop playing video.)
7. REWIND / FORWARD: Rewind/Fast forward playback.(x2, x4, x8, x16)
8. PREVIOUS / NEXT button: Press to skip to previous or next file.
9. Volume adjustment button: Press + or - to adjust the volume.

10. MUTE button (Press to mute audio and press again to unmute.)
11. RETURN button (Press to return the file or folder.)
12. Orientation button: Press to move up, down, left, right or OK (in the center) on the screen.
13. MENU button (Press it to enter OSD setting.)
14. STATUS button (Press it to enter DISC playback setting. It is used only for roof monitor with DVD.)
15. AUDIO button (Press it to change the language of DVD. It is used only for roof monitor with DVD.)
16. SUB button (Press it to change subtitle of DVD. It is used only for roof monitor with DVD.)
17. RPT button (Press it to repeat.)



### **Note**

- While using this products, these buttons on the panel ( </> / VOL + / VOL- / ► ) will operate as the orientation button and OK button on the remote control.

# Basic Functions

## How to Operate IR Earphones



### IR Earphones Functions

#### 1. POWER:

- Switch to OFF to turn the earphones off.
- Switch to A to output one-sided sound only.
- Switch to B to output both sides sound.

#### 2. VOLUME:

- Adjust the knob for volume control.

#### 3. IR sound receiver.



### **Caution**

- Do not cover this part with hands or other objects. Otherwise, it will affect the sound quality.

#### 4. Power LED indicator.

- Indicate the status of the earphones.

#### 5. Battery cover: Needs 2 AAA batteries.

## DVD/VCD/MP3/CD



### Caution

- This should be operated under DVD/VCD/MP3/CD mode.
- Some functions settings are operative in particular circumstance depends on the disc standards.

- Press MENU to open OSD setting.
- Select DVD/VCD/MP3/CD.



- There are items can be changed while playing the disc.



# General Operations

By selecting AUDIO, sound tracks can be changed.



- Tracks can be selected by entering the numbers, shown as below.



- Select ZOOM to enlarge the screen while playing the disc.



- Select REPEAT mode A to B mode to make repeating of the tracks.

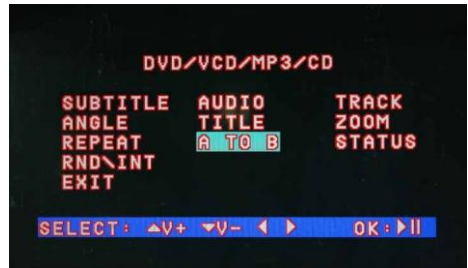

- Select STATUS, setting interface will be shown.



# General Operations

## Status Settings

To run this setting, it must be operated under disc mode.

Press STATUS on the remote control to enter setting sections, system setup, language setup, or video setup.

### 1. System setup



Select SYSTEM SETUP and press OK. After entering the mode, there are seven options on the screen, TV system, screen saver, video, TV type, password, rating and default. You can choose the sections you would like to modify.





# General Operations

## 3. Video Setup



Move downward and select VIDEO SETUP on the screen. In video setup, you can adjust brightness, contrast, hue, saturation and sharpness.

## MONITOR

- Press MENU to open OSD setting menu.
- Select MONITOR .



### 1. Screen Mode

- Press the SCREEN MODE to display the screen modes: full, wide and normal.



- Choose EXIT to Exit.

### 2. Picture Mode

- Press PICTURE MODE to display picture modes; brightness, contrast, color, tint and default.

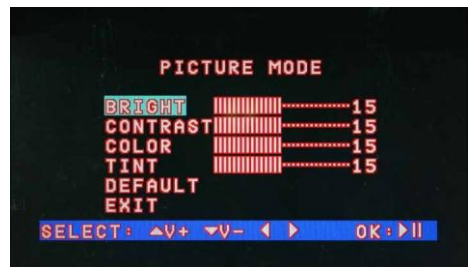

- Choose EXIT to Exit.

# General Operations

## FM TRANSMITTER

- Press MENU to open OSD setting menu.
- Select FM TRANSMITTER option.



- Select "FREQUENCY" to set the channel that you would like to interact with the main head unit by using navigation arrows on the panel or on the remote control.



- Press "OK" or "▶|| play/pause" on the panel to confirm.
- Select "ON" of Transmitter option to turn this function on.
- Select "OK" on the remote control or use "▶|| play/pause" on RSE panel.
- Choose EXIT to exit.



### Note

- If users must transmit the audio from the roof-mounted monitor, use FM Transmitter to transmit the signal to the front car radio device.
- Normally, while playing media files via FM transmitter function, sound quality is equivalent to the radio.
- If the environmental FM frequency is too strong, the signal could be interfered.

### IR TRANSMITTER

- Press MENU to open OSD setting menu.
- Select IR TRANSMITTER.



- Select "ON" of Transmitter option to transmit the sound to the IR earphones.



- Select "OK" on the remote control or press "play/pause" on RSE panel.
- Choose EXIT to exit.

# General Operations

## LED BUTTON

- Press MENU to open OSD setting menu.
- Select "BUTTON LED"



- Select setting
- AUTO: LED will be automatically on. It will be automatically off within 10 seconds
- ON: LED will be always on.
- OFF: LED will be always off.



- Select "OK" on the remote control or use "play/pause" on RSE panel.
- Choose EXIT to exit.

### Note

- Default setting of LED is ON.

## DVD/VCD Video Disc Playback

Turn the monitor on (ACC ON) and press the SRC or MODE button on the panel to go to DVD/VCD mode, or users press SOURCE or MODE button on the remote control.

### Basic Operations of DVD/VCD Video Discs

1. Press DVD MENU on the remote control to select the required menu options. If the DVD/VCD has a menu, the menu will be displayed.
2. Press MENU → DVD/VCD/MP3/CD → TRACK to select the chapters by entering the numbers directly.

### 3. Pause the DVD/VCD Video Disc Playback

The pause function enables you to pause while the disc is playing.

- When the DVD/VCD disc is playing, press ►|| on the panel or remote control. The playback on the screen will be paused.
- To retrieve playback, press ►|| again on the panel or remote control, it will return to the playback.

### 4. To fast forward or fast rewind, press and hold the ►► or ◀◀ on the remote control.

- If you press the ►► or ◀◀, ►►X2 or ◀◀X2 will show on the upper left screen. It means that the fast forward or fast rewind is at 2X speed.
- Press again on ►► or ◀◀. ►►X4 or ◀◀X4 will show on upper left screen. It means that the fast forward or fast rewind is at 4X speed.
- Press ►► or ◀◀ for the third time, ►►X8 or ◀◀X8 will show on upper left screen. It means that the fast forward or fast rewind is at 8X speed.
- Press ►► or ◀◀ for the fourth time, ►►X16 or ◀◀X16 will show on upper left screen. It means that the fast forward or fast rewind speed is at 16X speed. (The fastest speed)

5. To enter or return the other chapters, press ►►| or |◀◀ on the remote control or press > or < on the panel. Press ►►| to skip to the starting place of next chapter. Then, press |◀◀ to turn to the starting place of current chapter. Press again to skip to the previous chapter.

## Disc Playback

6. To stop playing, press ■ on the remote control.
  - If you press ■ to stop DVD/VCD playback, the stop scene on the screen will be memorized. ▶■ will be shown on upper left screen. When you play the disc next time, you may play from the scene that you stopped last time.
  - To retrieve playback, press ▶||.
  - To clear the memory, press ■ again. ■ will be shown on upper left screen.
  - To play from the beginning, press ▶||.



### Note

- The ways for the menu display differ from disc to disc. Please refer to additional description on discs for more details.

## CD/MP3 Disc Playback

Turn the monitor on (ACC ON) and press the MODE or SRC button on the panel to go to CD/ MP3 mode, or users press MODE or SOURCE button on the remote control.

### Basic Operations of CD/MP3 Video Discs

1. Press MENU → DVD/VCD/MP3/CD → TRACK to select the tracks by entering the numbers directly.



2. Pause the CD/MP3 Video Disc Playback

The pause function enables you to pause while the disc is playing.

- When the CD/MP3 disc is playing, press ►|| on the panel or remote control. The playback on the screen will be paused.
- To retrieve playback, press ►|| again on the panel or remote control, it will return to the playback.

3. To fast forward or fast rewind, press and hold the ►► or ◀◀ on the remote control.

- If you press the ►► or ◀◀, ►►X2 or ◀◀X2 will show on the upper left screen. It means that the fast forward or fast rewind is at 2X speed.
- Press again on ►► or ◀◀. ►►X4 or ◀◀X4 will show on upper left screen. It means that the fast forward or fast rewind is at 4X speed.
- Press ►► or ◀◀ for the third time, ►►X8 or ◀◀X8 will show on upper left screen. It means that the fast forward or fast rewind is at 8X speed.
- Press ►► or ◀◀ for the fourth time, ►►X16 or ◀◀X16 will show on upper left screen. It means that the fast forward or fast rewind speed is at 16X speed. (The fastest speed)



## Disc Playback

4. To enter or return the other track, press ►►| or |◄◄ on the remote control and press > or < on the panel.
  - Press ►►| to skip to the starting place of next track. Then, press |◄◄ to turn to the starting place of current track. Press again to skip to the previous track.
5. To stop playing, press ■ on remote control.
  - If you press ■ to stop CD/MP3 playback, the stop playback will be memorized. ►■ will be shown on upper left screen. When you play the disc next time, you may play from the playback that you stopped last time.
  - To retrieve playback, press ►||.
  - To clear the memory, press ■ again. ■ will be shown on upper left screen.
  - To play from the beginning, press ►||.



### **Note**

- The ways for the menu display differ from disc to disc. Please refer to additional description on discs for more details.

1. Enter A/V mode (AV1 & AV2) by SRC button on the panel
  - Press SRC button until AV1 or AV2 shows on the screen.
2. Enter A/V mode (AV1 & AV2) by SOURCE button on the remote control
  - Press SOURCE button until AV1 or AV2 shows on the screen.
3. Enter A/V mode (AV1 & AV2) by MODE button on the panel or on the remote control
  - Press "MODE"
  - Select AV1 or AV2



### **Note**

- AV1: The connection of audio and video from main unit via connector.  
AV2: The connection of audio and video from main unit via port of the roof monitor.
- NTSC/PAL are supportable on A/V source.

## DLNA (Digital Living Network Alliance) Function

Prior to using DLNA function on the 10.2" Roof-Mounted Monitor, please install APP(Airfun) to your mobile phone first.

Attention : For APP installation, please refer to user's manual of mobile phone.

1. Enter DLNA by SRC button on the panel.

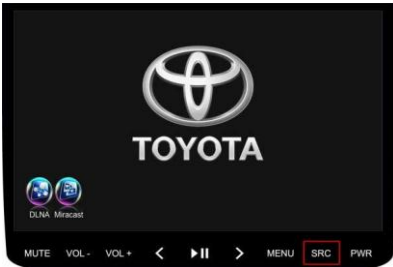

- 1.1 Press "SRC" until DLNA/ Miracast show on the monitor.
2. Enter DLNA by MODE button on the remote control.
  - 2.1 Press Mode on the remote control.
  - 2.2 Select DLNA/Miracast.
3. Enter DLNA by SOURCE button on the remote control.
  - 3.1 Select the channel until DLNA/ Miracast show on the screen.
4. Turn "Wi-Fi" on your mobile phone and it is connected with 10.2" Roof-Mounted Monitor. Make sure the 10.2" Roof-Mounted Monitor has already connected successfully. Wifi name will be Toyota RSE XXX.

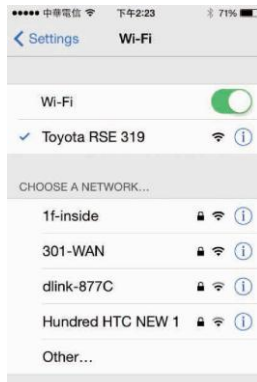

5. Open Airfun on mobile as below photo.



6. Select the icon  as below photo.

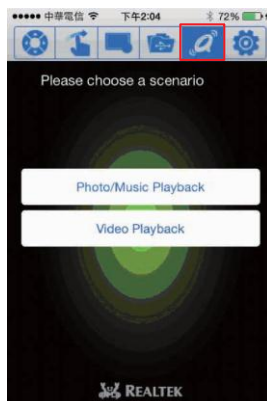

7. Picture playback in DLNA

7.1 Choose Photo/Music/Playback on mobile.

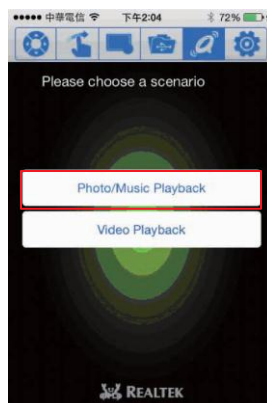

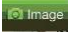
7.2 Select photo display  mode and select the photo you want to show on the monitor screen.

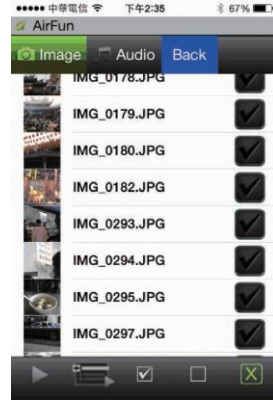

## Note

- You can select more than 1 photo(s) to show on the roof monitor.

7.3 Press  to play the photo on the screen as the slide show.

7.4 Press  on mobile for the next photo immediately.

7.5 Press  on mobile to pause photo slide show.

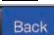
7.6 Press  on mobile to back to the former layer.

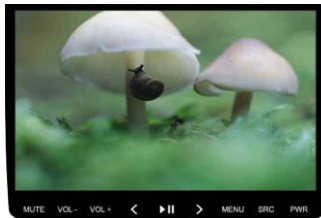

## Note

- When slideshow runs and reaches the last photo, it will be back to the former layer.

## 8. Audio Playback for DLNA Mode

### 8.1 Select Photo/Music playback option on the mobile phone.

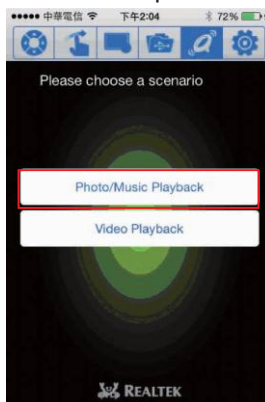

### 8.2 Select Audio option and select the song you want.

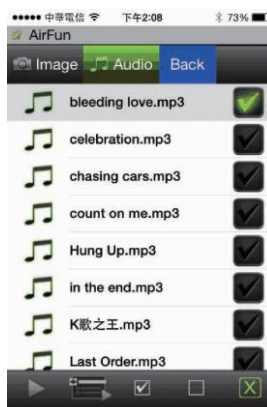



#### Note

- You can select more than 1 music file(s) to play.

8.3 Press  on Screen to play the song.



8.4 Press  on mobile for next song.

8.5 Press  on mobile for previous song.

8.6 Press  on mobile to pause the song.

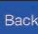
8.8 Press  on mobile to back to music former layer.

## 9. Video Playback in DLNA mode

9.1 Select Video playback option on the mobile phone and select video you want to show on the roof monitor screen.

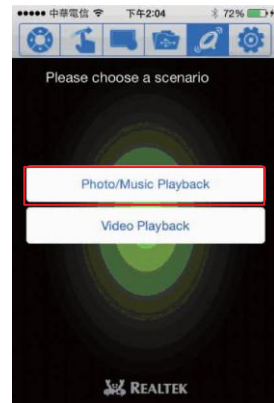

9.2 Press  to auto play on the roof monitor screen. (slide show)

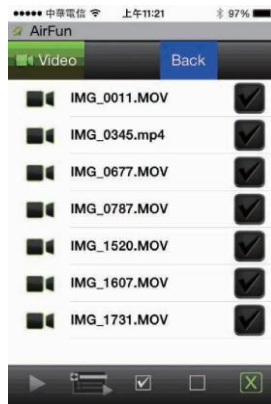

### Note

- You can select more than 1 video file(s) to play.

9.3 Press  on Screen to play video.

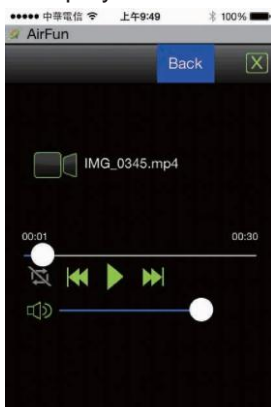

9.4 Press  on mobile for next video.

9.5 Press  on mobile for previous video.

9.6 Press  on mobile to pause video.

9.7 Press  on mobile to back to video former layer.





## **Note**

- The current demonstration is using an iOS phone, please note that the iOS phones and Android phones are different in operation interfaces. Moreover, the name of the device will not be the same, according to the model of the roof monitor.
- The connection quality depends on Wifi signal stability.
- Only mobile phones with Android version 4.2 or above are supported DLNA function
- Only mobile phones with iOS version 6 or above are supported DLNA function
- The roof monitor can connect only 1 mobile via Wifi. In case, you want to connect roof monitor with another device. Please stop connection of the current using phone with the roof monitor firstly.

## Miracast Function

1. Enter Miracast by “SRC” button on the panel.
  - 1.1 Press “SRC” button until DLNA/ Miracast show on the screen.

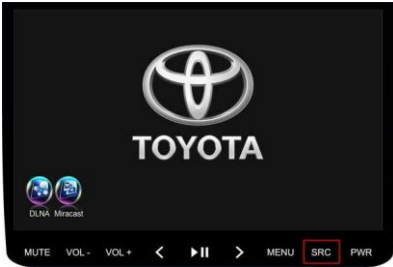

2. Enter Miracast by “MODE” button on the remote control
  - 2.1 Press the button to select the channel until DLNA/ Miracast show on the screen.
3. Enter Miracast by SOURCE button on the remote control
  - 3.1 Press the button to select the channel until DLNA/ Miracast show on the screen.
4. Go to Settings on phone.
  - 4.1 Select Display.

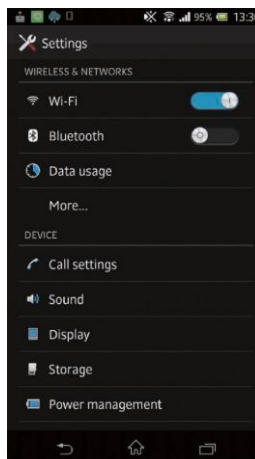

4.2 Select Screen mirroring.

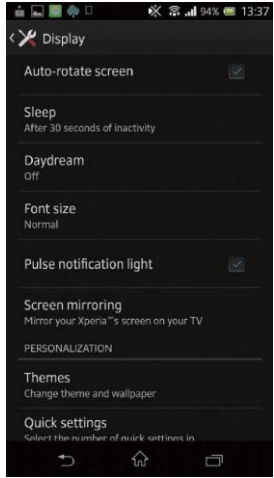

4.3 Open “Screen mirroring” on mobile to connect roof monitor “Toyota RSE XXX”.



4.4 Select Screen mirroring function to turn on Screen mirroring function.  
This is to connect with roof monitor, TOYOTA RSE XXX.



(The current demonstration is using an Sony Xperia ZL. The phones are different in operation interfaces. Please read and understand it from your mobile manual.)



## Note

- The device name "Toyota RSE XXX" will show under Toyota Logo.

4.5. When connecting to Miracast successfully, the screen of the mobile will display on screen on roof monitor.

Example:

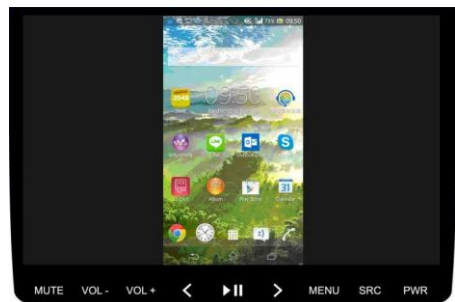
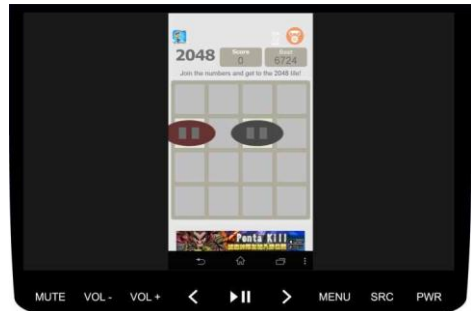

## USB Input playback

1. Enter USB by “SRC” button on the panel.

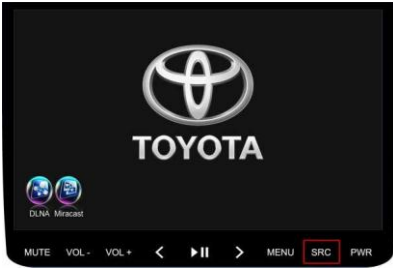



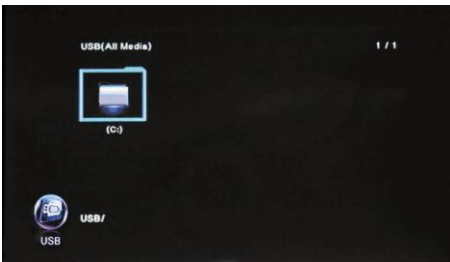

- 1.1 Press “SRC” button until USB shows on the screen.
2. Enter USB by “MODE” button on the remote control.
  - 2.1 Press MODE button on the screen.
  - 2.2 Select USB.
3. Enter USB by SOURCE button on the remote control.
  - 3.1 Press the button to select the channel until USB shows on the screen.

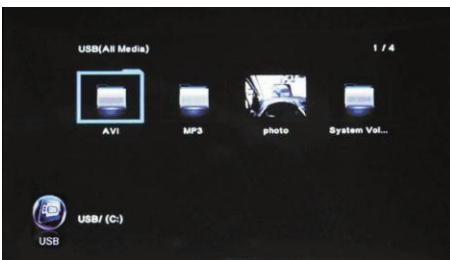

4. Files or Folder Selection for Playing



**Note**

1. You can play the next file by pressing  on the remote control twice or press  on the panel once.
2. You can play the previous file by pressing  on the remote control twice or press  on the panel once.

**Note**

- If the USB is encrypted, it cannot be read on RSE.
- iPod is not supportive.

# Specifications

1. Applicable voltage: D/C10.5V~16 V
2. Storage temperature:-40°C ~85°C
3. Operating temperature: -20°C ~ 70°C
4. Main unit weight : 2040g.±50g.(not include accessories)
5. External dimensions: 340.5X 254.5X86.1mm
6. Video system: NTSC / PAL / AUTO
7. Audio Signal input (max) Analog input 1.5 V p.p (Volume 30).
8. Audio Signal output (max) Analog output 1.5 V p.p (Volume 30).
9. Connection port: Image port → Video input X1(connector) 、Video input X1(RCA terminal)  
Audio port → Analog input L / R X1 (RCA terminal)
10. Power consumption: < 33W.

## LCD monitor

1. Dimension: 10.2 inches (16: 9)
2. Display Resolution: 800 (W) X 480 (H)
3. Brightness: 250cd/m2.

## Remote control

1. IR remote control
2. IR function key: 24 keys
3. Affective range: <= 3 meters
4. Battery: Lithium (3V).

## Supportable File Type for USB

	Format
Video File Types	RMVB 、VOB 、MP4(480P 、720P 、1080P) 、3PG 、AVI 、FLV 、F4V 、MKV 、MOV 、MPG
Audio File Types	OGG 、MP3 、M4A 、AAC
Photo File Types	BMP 、JPG

## Supportable Mobile Phones and Setting

Brand	Model Name	How to Access Miracast Function
Asus	Padfone Infinity 8	Setting→Display→Wi-Fi Mirror Share
Coolpad	YL-9960	Setting→Display→Wi-Fi Mirror Share
HTC	New One, Butterfly	Settings→Media output
Sony Electronics Inc.	Xperia AX, Xperia TL, Xperia ZL, Xperia TX, Xperia T, Xperia V, Xperia Z	Settings→Display→Screen Mirroring
Samsung	Galaxy S3, Galaxy Note 2, Galaxy Tab 10.1, Galaxy S4	Settings→More→AllShare Cast (The software should be version 4.1.2 or above version)Mirroring
Google Inc.	Nexus 4	Settings→Display→Wireless display
LG Electronic Inc.	OptimusG,F200L/S/K(Vu2,) 240K(G Pro)	Settings→More→Miracast
Oppo	TD, X909	Setting→Display→Wi-Fi Mirror Share
Pantech	IM-A860K/S/L	Setting→Display→Wi-Fi Mirror Share
Sharp	SH-10D, SH-02E, SH-04E, SH-09D, SH-10D, 203SH	Settings→Wireless Output
Xiaomi	MI-2,MI-2A,MI-2S	Wlan display settings→Menu→Wlan Display

\* If Miracast application is not provided in your android phone, it means your mobile does not support Miracast function.

\* Miracast using method depends on each mobile

## Turning off the machine

Turn off the car's power so that the roof monitor is completely turned off (ACC OFF when dashboard lamp is extinguished)



### Note

- After turning off the power of the car, playback will completely stop.



- MP3

MP3 is an abbreviation for “MPEG AUDIO Layer 3” and established by ISO (International Standard Organization) MPEG working group. It is a standard format for storing compressed music. The audio data can be compressed to about one tenth of the original size.

- Title

A DVD video disc has a higher data capacity and several movies can be recorded on single DVD disc. For example, if a disc contains three movies, they are marked as Title 1, Title 2, and Title 3. This allows you to use the convenient title search function and other functions.

- Region Code

The DVD player and DVD disc have their region codes specifying the place of purchase. Playback is not allowed unless the region codes of the DVD disc and DVD player are identical.

- Linear PCM (LPCM)/ Pulse Code Modulation

Linear pulse code modulation is used in the recording signal system for the audio CD and DVD. DVD is usually encoded in a higher sampling rate and bit rate than CD. Therefore, DVD offers higher sound quality.

- Multi-session data

A session refers to the complete recorded data written into CD-ROM and CD-R/CD-RW during the span of single recording. Multi-session data refers to data from two sessions or more on a disc.

- ID3 Tag

ID3 tag is a method of storing the information about audio in a MP3 file. The information that can be stored includes the track name, artist, and album name. The content can be freely edited using ID3 editing software.

- DVD Region Code

The current protection measure for DVD films (region code restrictions) is proposed by the 8 major film studios in U.S. The main goal is to protect the rights of the dealers and agents and prevent the grey products from being imported. The DVD region codes are classified into six different regions as below.

DVD Region Code List	
Region 1	United States, Canada, Eastern Pacific Islands
Region 2	Japan, West Europe, North Europe, South Africa, Middle East, Egypt
Region 3	Taiwan, Hong Kong, South Korea, Thailand, South Asian countries
Region 4	Australia, New Zealand, Latin America and South America, Oceania
Region 5	Russia, Indian Peninsula, North Africa, North Korea, Mongolia, East Europe, Central and North West Asia
Region 6	People's Republic of China

※The malfunction of the machine and relevant legal responsibilities arising from unauthorized modification of the DVD region code are not covered by the warranty provided by the manufacturer, dealer, and vehicle manufacturers.

# Basic Trouble Shooting

## Problem and Resolution

Situation	Cause	Countermeasure
Unable to turn device on	The cables do not connect to each other firmly.	Check the connection of the cables
	The fuse blew.	Please contact your dealer for replacement.
	Malfunction or noise occur	Turn off the machine then turn it on. If problem still occurs please contact dealers to In-stall new batteries.
Unable to operate the remote control	The battery has too little or no power.	Install new batteries.
The screen is stretched and the aspect ratio is not correct	The settings of the aspect ratio are not correct for the display.	Select the settings fit for the display
Sound distorted	The volume is possibly too high.	Decrease the volume.
Color difference	The color settings may incorrect.	Reset Color Setting.
Black/White image	The playback source is not the correct.	Confirm that the appropriate mode of image signals is correctly switched on (AUTO, NTSC or PAL, according to different video)
No audio from IR earphone	The status of MUTE is set as ON.	During video playback, check that the power LED indicator of IS ear-phone lights on. Check MUTE status and set it to OFF.
The video /audio export is not correct under AV IN	The connector is not correctly connected.	Confirm whether each connector is correctly connected. Refer to user's guide for more details.



### Note

- When you flip up the DVD display, the force point should be in the middle of the TFT edge. Otherwise, it may not close properly.

# **Federal Communication Commission Interference Statement**

This equipment has been tested and found to comply with the limits for a Class B digital device, pursuant to Part 15 of the FCC Rules. These limits are designed to provide reasonable protection against harmful interference in a residential installation. This equipment generates, uses and can radiate radio frequency energy and, if not installed and used in accordance with the instructions, may cause harmful interference to radio communications. However, there is no guarantee that interference will not occur in a particular installation. If this equipment does cause harmful interference to radio or television reception, which can be determined by turning the equipment off and on, the user is encouraged to try to correct the interference by one of the following measures:

- Reorient or relocate the receiving antenna.
- Increase the separation between the equipment and receiver.
- Connect the equipment into an outlet on a circuit different from that to which the receiver is connected.
- Consult the dealer or an experienced radio/TV technician for help.

**FCC Caution:** Any changes or modifications not expressly approved by the party responsible for compliance could void the user's authority to operate this equipment.

This device complies with Part 15 of the FCC Rules. Operation is subject to the following two conditions: (1) This device may not cause harmful interference, and (2) this device must accept any interference received, including interference that may cause undesired operation.

## **FCC RF Radiation Exposure Statement:**

This equipment complies with FCC radiation exposure limits set forth for an uncontrolled environment. End users must follow the specific operating instructions for satisfying RF exposure compliance. This transmitter must not be co-located or operating in conjunction with any other antenna or transmitter.

There will be some discrepancy in the contents of this user's manual due to the technical evolution and the software improvement. Please follow the actual function display. This manual is only for users' operating reference.



52171900001-00