



USER' S MANUAL

DoubleSight™ Dual 17" & 19"

LCD MONITOR

(Model : DS- 1700S & 1900S)

For the latest updates and more information, visit our website at
www.doublesight.com

Trademarks

DoubleSight, DoubleSight Displays, the DoubleSight logo, and other DoubleSight trademarks are the property of DoubleSight Displays, LLC and may be registered in the United States and/or other countries.

Microsoft, Windows, and the Microsoft logo are trademarks or registered trademarks of Microsoft Corporation in the United States and/or other countries. Apple and Macintosh are trademarks or registered trademarks of Apple Computer, Inc. in the United States and/or other countries. Energy Star is a U.S. registered trademark. All other product names, logos, designs, or titles mentioned within this manual may be trademarks of their respective owners.

Disclaimer

DOUBLESIGHT DISPLAYS, LLC MAKES NO WARRANTIES, EITHER EXPRESS OR IMPLIED, REGARDING THIS MANUAL AND THE INFORMATION CONTAINED HEREIN.

DOUBLESIGHT DISPLAYS, LLC HEREBY EXPRESSLY DISCLAIMS ANY IMPLIED WARRANTIES OF MERCHANTABILITY OR FITNESS FOR ANY PARTICULAR PURPOSE AND UNDER NO CIRCUMSTANCES SHALL DOUBLESIGHT DISPLAYS, LLC BE LIABLE FOR ANY INCIDENTAL, CONSEQUENTIAL, OR SPECIAL DAMAGES, WHETHER BASED ON TORT, CONTACT, OR OTHERWISE, ARISING OUT OF OR IN CONNECTION WITH THIS MANUAL, INFORMATION CONTAINED HEREIN, OR THE USE THEREOF.

Copyright 2003–2004 DoubleSight Displays, LLC. All rights reserved. This manual may not be copied, photocopied, reproduced, translated, or converted to any electronic form in whole or in part without prior written consent of DoubleSight Displays, LLC.

DoubleSight Displays, LLC reserves the right to make any modification to this manual or the information contained herein at any time without notice. DoubleSight Displays, LLC assumes no responsibility for errors or omissions in this manual. For the latest modifications and more information, visit our website at <http://www.doublesight.com>.

Second Edition: November 2005

DoubleSight Displays, LLC
18 Technology # 161
Irvine, CA 92618, U.S.A.
TEL: 1-877-TwoLCDs (1-877-896-5237) (U.S. only)
E-mail: info@doublesight.com

Correct posture for effective use of the LCD monitor.

Placement

Correct placement and adjustment of the monitor can reduce eye, shoulder, and neck fatigue. Check the following when you position the monitor:

Keep the top of the monitor screen slightly below eye level. Your eyes should look slightly downward when viewing the middle of the screen.

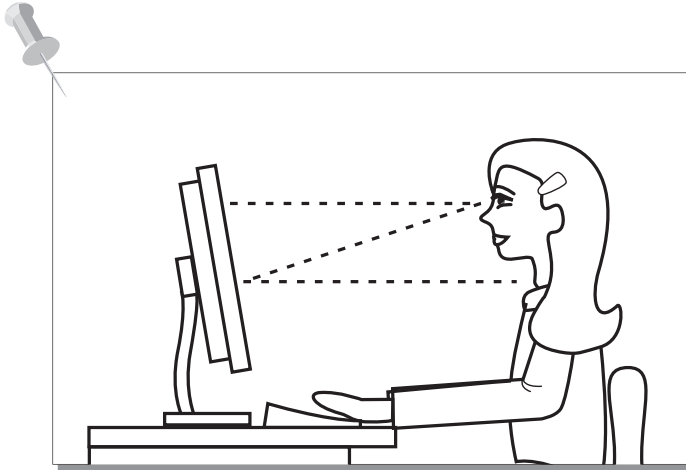

Position your monitor no closer than 16 inches and no further away than 30 inches from your eyes. The optimal distance is 25 inches.

Components

- ※ Check if all the components are included in the package. Contact the sales outlet if any components are missing.
- ※ Contact the sales outlet if you wish to purchase optional extras.

Actual components may look different from the pictures below.



Dual LCD Monitor



Quick Guide



Adaptor X2



RGB cable X2



DVI cable X2



Install CD



Handle X2



VESA BRKT



BOL TS(M8)



WASHER/NUT



Power cable X2

Prior to use

Safety Precautions	5-7
Component Name & Introduction	8

Connection & Installation

Setting up the Monitor	9-11
Adjust The Monitor Position	12
Connecting the Monitor to a Computer	13-14

OSD(On Screen Display)screen select & control

Installing the Monitor Driver	15-18
Adjusting the Monitor Screen	19
Picture	20
Color	21
OSD	22
Option	23

Additional Information

Recommendations	24
Self-Diagnosis Function	25
Troubleshooting	26
Product Specification	27
Supported mode table	28
Power Save Mode	29

- ※ Limited Warranty
- ※ Regulatory Information

This device has passed the electromagnetic wave test and may be used in any place including residential areas.

Safety Precautions

The contents of this section are intended to protect the user from danger and prevent physical accidents. Please read through the contents for proper use.

 Ignoring the safety precautions may lead to accidents causing injury or fatality and structural damage.

Cautions are categorized into two types, "Warning" and "Caution" depending on their level of importance.

 **Warning** : May lead to accidents causing serious human injury

 **Caution** : May lead to minor accidents and damage

Do not use a damaged power cord or plug, or connect to a loose power outlet. Doing so may cause electric shock or fire.

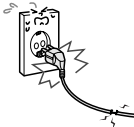

 **Warning**

Do not pull the power cord when unplugging the power, and do not touch the power plug with wet hands. Doing so may cause electric shock or fire.



 **Warning**

Connect the power plug to grounded power outlets only. Failure to do so may cause electric shock or injury.

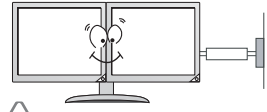

 **Warning**

Insert the power plug securely into the outlet. Insecure and unstable electrical contact may lead to fire.



 **Warning**

Do not bend the power cord excessively or allow the cord to be compressed under a heavy object. Doing so may cause electric shock or fire.

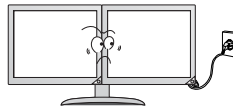

 **Warning**

Do not connect more than one plug to a single wall outlet. Doing so may lead to fire.

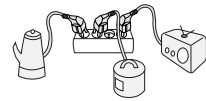

 **Warning**

Provide sufficient space between the monitor and the wall for ventilation (cooling). Overheating may lead to fire.

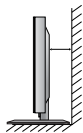

 **Warning**

Make sure that the ventilation holes ARE not covered by fabrics, curtains, other do the like material, etc.

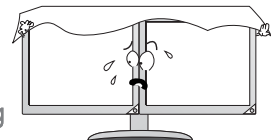

 **Warning**

Safety Precautions

Place the monitor on a firm flat surface and be careful when handling the monitor.

Mishandling the product may cause short circuits and damage the product or cause injury.

 **Warning**

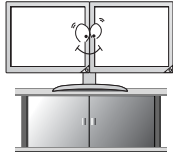

Do not place candles, lighted cigarettes, or other heat-radiating objects on the monitor or near the monitor.

Doing so may lead to fire.

 **Warning**

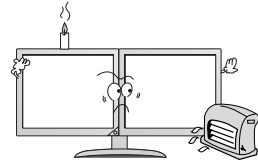

Disconnect the power when cleaning the product

Failure to do so may cause electric shock or fire.

 **Warning**

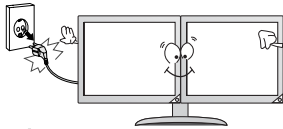

Do not use flammable sprays or substances near the product.

Doing so may lead to explosion or fire.

 **Warning**

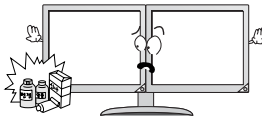

Do not place the product in a place where the ventilation is poor (eg. inside a cabinet).

Doing so may lead to fire.

 **Warning**



Set the PC to match the resolution and frequency of the monitor.

17", 19" Types - 1280 x 1024 @ 60Hz

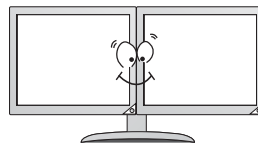

 **Caution**

Safety Precautions

The contents of this section are intended to protect the user from danger and prevent physical accidents. Please read through the contents for proper use.



Set the PC to activate power save mode (DPMS) when the monitor is not used for a while. Set the screen saver function and select a type that maintains motion in the whole screen.

Do not insert metallic objects into the ventilation holes. They may cause electric shock or fire.

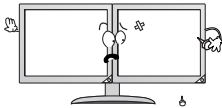

Warning

Do not allow children to climb onto the product or hang on it. The product may fall over and cause serious injury.

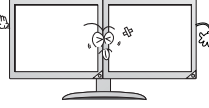

Warning

Do not attempt to dismantle, repair, or modify the product yourself. This may cause fire or electrical failures.

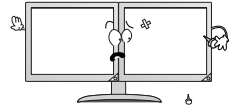

Warning

Unplug the monitor when not using for a long period of time.

Dust build-up on the product (near the vents) may cause overheating and lead to fire. Use a dry soft cloth for cleaning purposes.

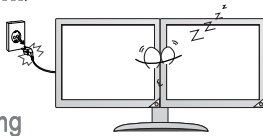

Warning

Carefully unplug the monitor if you see any signs of smoke or smell odor of burning. Contact the manufacturer for further information.

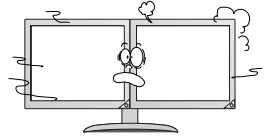

Warning

Use a soft dry cloth to clean the monitor, and unplug it before cleaning.

Do not use any chemical solutions on the monitor for cleaning purposes. Do not use a wet cloth on the monitor.

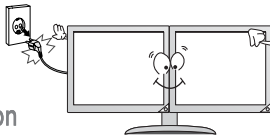

Caution

Do not spray water directly onto the product. It may cause electrical faults or fire.



Warning

Do not install the monitor where water (rain) drops can enter the enclosure, or where there is oil or humidity.

It may cause electrical faults, fire, or lead to damage to the monitor.



Warning

Clean any dirt, dust or water from the power plug contacts.

They may cause electrical faults or fire.



Warning

Component Name & Introduction

Front of the DS-1700S / DS-1900S

■ DS-1700S



■ DS-1900S



■ Power Indicator : This will enable you to see the overall power status of the system.

Normal(ON)	Blue
Off	White
Energy Saving	Amber Orange
Cable not Connected	Amber Blue



- ① SOURCE – pressing the button switches the input signal (Analog ⇄ Digital / Digital ⇄ Analog)
- ② MENU – Brings up the OSD menu
- ③ SELECT – Selects the menu. Pressing the button automatically adjusts the monitor settings to optimal. (Automatic adjustment is not supported for digital RGB signal input)
- ④ ◀, ▶ – Move within the OSD menu or adjust values

Rear of the DS-1700S / DS-1900S

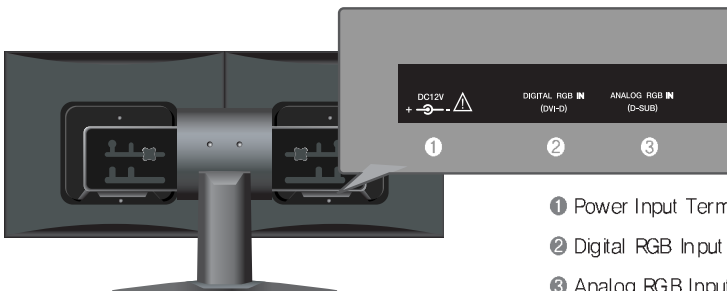

- ① Power Input Terminal
- ② Digital RGB Input Terminal
- ③ Analog RGB Input Terminal

Setting up the Monitor

Setting up the Monitor

Place a large soft cloth on a flat secured surface area and place the monitor panels face down. Make sure you place the monitor down without making any scratches. Again, place monitor down gently.

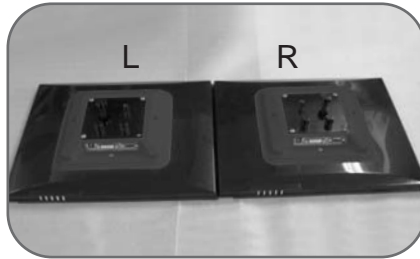

Position the monitor support as shown in the picture.

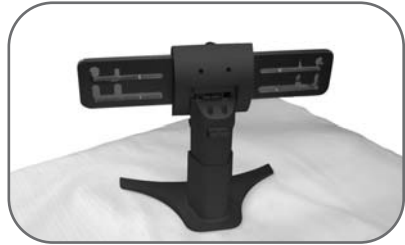
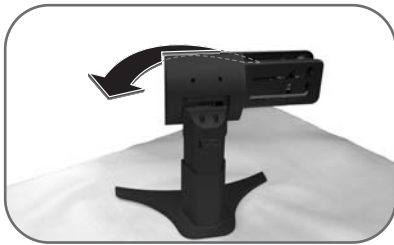

Follow the instructions in the picture to assemble the monitor support.

Adjust the spacing between the monitor and fasten the handle.

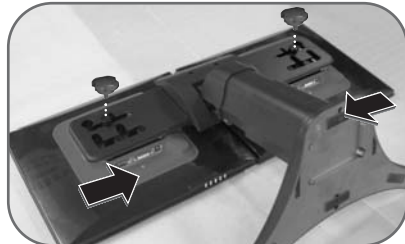
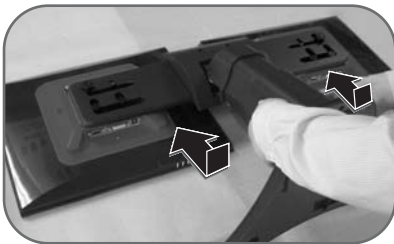

Setting up the Monitor

Handling the LCD Monitor

Do not hold the stand when handling the monitor. Make sure to hold the monitor when carrying.



Fixating the monitor stand

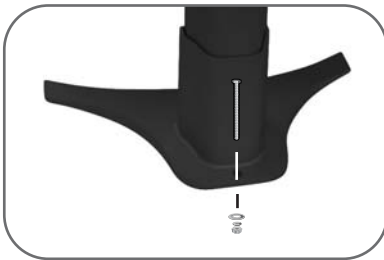

For safety set the monitor on the table as shown on the left and fixate the bottom of the monitor stand with screws.

Disconnecting The Monitor

When disassembling the monitor, please be careful when packing the stand back into the box. First, disconnect the panels from the stand. Second, when unfolding or closing the arms of the stand, you must press down the small silver latch/lever in order to close the right arm of the stand.

DO NOT FORCE THE ARM PANEL TO CLOSE, JUST PRESS DOWN THE SILVER LATCH/LEVER, THE ARM WILL CLOSE SMOOTHLY.

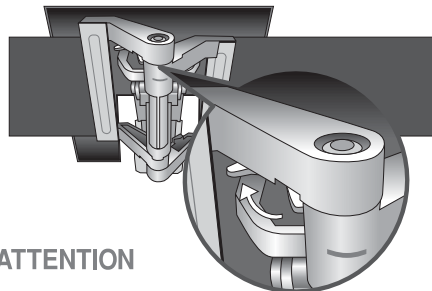

 **ATTENTION**

Setting up the Monitor

Wall Mounting Installation Procedure

Unscrew all 4 points of the rear cover and remove the cap as shown.

* When the rear cap is removed, all parts will be dismantled as shown.



Please hold the wings while unscrewing so the parts do not fall apart.

Take the wings and assemble to the monitor as shown.
Adjust the spacing between the monitor and fasten the handle.

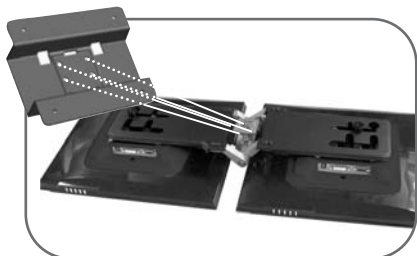
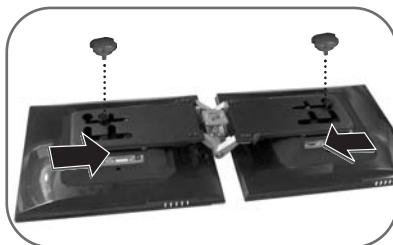
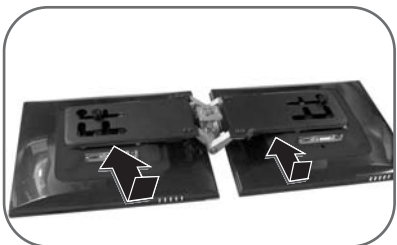

Place the given VESA bracket as shown.
VESA bracket is a bracket made to fit any VESA standard wall bracket which can be purchased at the store.

Adjust The Monitor Position

Adjust The Monitor Position

The monitor may be tilted by -5° to $+20^{\circ}$ vertically and rotated by 15° left and right. It can also be moved vertically and horizontally by 60mm and 20mm respectively. Do not apply excessive force, and hold both sides when adjusting the monitor position.



Vertical tilt $-5^{\circ} + 20^{\circ}$

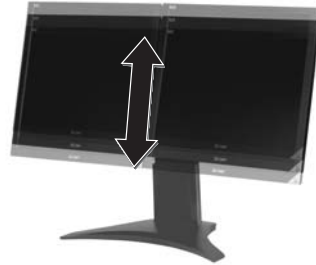

Vertical movement 60mm



Left -15° , Right -15°

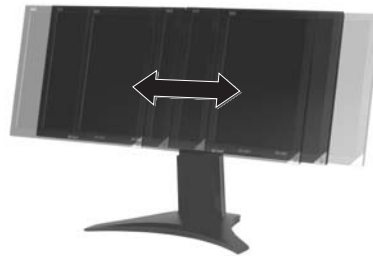

Horizontal movement 20mm

Connecting the Monitor to a Computer

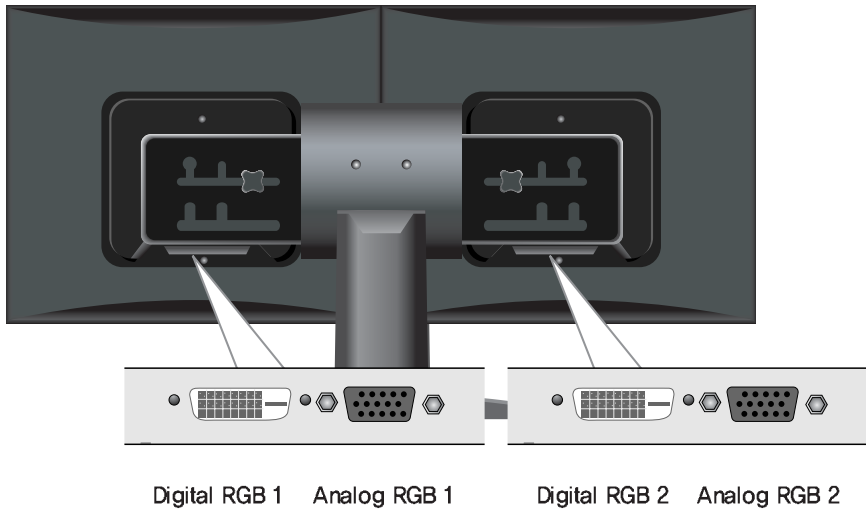

Tilt the monitor back and connect the jack.

Connecting the Monitor to a Computer



Warning

Only use the correct power cord for your local voltage. The power adapter included in the box automatically supports 100V~240V.

Depending on the configuration of your computer, there are different methods for connecting it to your DoubleSight monitor. If your computer already has two VGA ports, connect the opposite ends of the VGA 1 and 2 cables into each VGA port. If your computer has one VGA port and a DVI port, you will need a DVI-VGA connector.

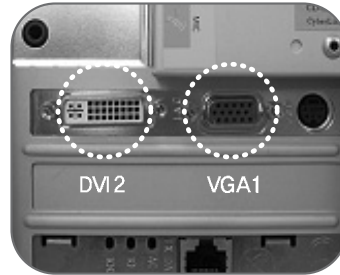

NOTE

If your computer does not specify VGA 1 and 2, you can change the order later using your computer display setting or monitor On-Screen Display setting. Refer to the "Setting Up Computer Display Properties" of this section and "Source Select" of "Key Function Controls" section of this User's Manual.

If your computer has only one VGA port, you will need to install an additional graphics card to support a dual monitor. Refer to the "Troubleshooting & Support" section of this User's Manual for details. Additionally, DoubleSight may be connected to two separate computers by attaching one VGA cable to each computer.

If this is the first time for a dual monitor configuration with your computer, you may need to set up your computer display properties. Refer to the next section. If no display appears even after setting up your computer display properties, refer to the "Warning Messages and Troubleshooting Checklist" in the "Troubleshooting & Support" section of this User's Manual.

Installing the Monitor Driver

Automatic Installation

1. The monitor will automatically detect Plug & Play installation functions for Windows 95 and higher OS.
2. Installation completes after the following procedures. (Installed as a Plug & Play monitor)



Click on the "Next" button



Search for a suitable driver
Click on the "Next" button



Click on the "Next" button



Click on the "Finish" button

Installing the driver specially designed for the product automatically sets the optimal frequency and resolution, producing the best quality display for the user.

Installing the Monitor Driver

- >1. Turn on the monitor and PC.
- >2. Insert the monitor installation CD into CD-ROM. In a few second, the installation screen will be displayed.
(The installation screen can not be displayed depending on OS's setting status. "If the screen are not appeared, execute MonitorAutorun.exe In CD.")



- >3. Select "Monitor Driver" in the installation screen.
- >4. The window requesting you to install monitor driver will be come out. When you click on the "Yes" button, main screen will be appeared.

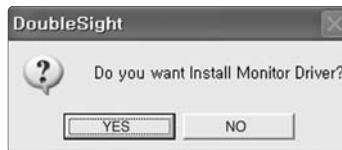

- >5. When the main installation screen of monitor driver is come out, please follow the step of next page.

Installing the Monitor Driver

For Windows 95 / 98 / ME



Click on the "OK" button



Click on the "OK" button

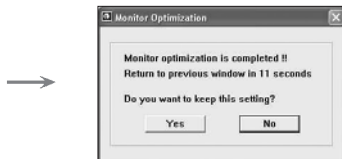

Click on the "Yes" button

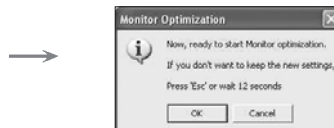

Click on the "OK" button

※ Monitor driver installation complete.

Installing the Monitor Driver

For Windows 2000 / XP



Click on the "OK" button



Click on the "OK" button

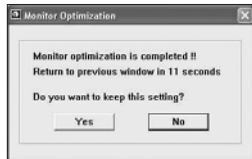

Automatically adjusts the screen.
Click on the "Yes" button

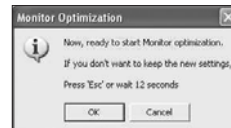

Click on the "OK" button

※ Monitor driver installation complete

Adjusting the Monitor Screen

[OSD] main screen

DoubleSight features an intuitive, menu-driven On-Screen Display (OSD) that provides a full range of customizable tools to optimize your display. The OSD can be accessed anytime your computer is powered up. (Note: If your computer is in a power saving mode or is powered down, the OSD will be inaccessible.)

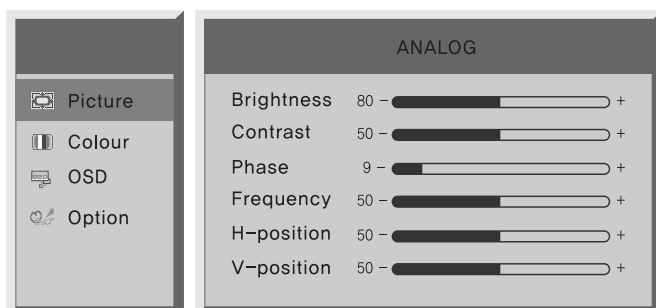

OSD (On Screen Display) screen selection and screen control procedures.

1. Press the "Menu" button to bring up the OSD screen.
2. Press the ◀/ ▶ buttons to select the main option.
3. Press the "Select" button after selecting the main option
4. Brings up the sub-menu. Use the ◀/ ▶ buttons to select the desired option.
5. Press the "Select" button after selecting the desired sub-menu option
6. Use the ◀/ ▶ buttons to adjust the set value.
7. Pressing the "Menu" button three times saves and exits the setting mode.

※ Pressing the "Menu" button moves back to the previous stage.

※ The value may vary depending on the saved setting.



Selecting and adjusting OSD screen

> Brightness

Adjusts brightness.

- ◀ : Dims the screen.
- ▶ : Brightens the screen.

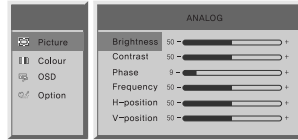

> Contrast

Adjusts contrast.

- ◀ : Darkens the contrast.
- ▶ : Lightens the contrast.

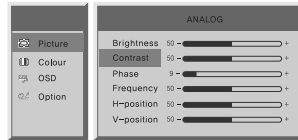

> Phase

Fine adjustment of phase.

This cannot be adjusted in the digital mode.

- ◀ : The fine adjustment value decreases.
- ▶ : The fine adjustment value increases.

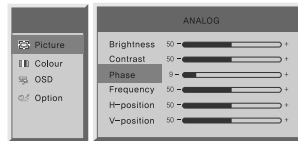

> Frequency

Adjusts frequency sampling.

This cannot be adjusted in the digital mode.

- ◀ : Reduces sampling frequency value.
- ▶ : Increases sampling frequency value.

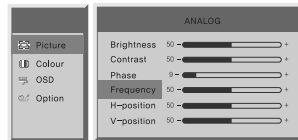

> H position

Adjusts H position.

This cannot be adjusted in the digital mode.

- ◀ : Screen moves toward the left.
- ▶ : Screen moves toward the right.

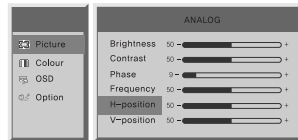

> V position

Adjusts V position.

This cannot be adjusted in the digital mode.

- ◀ : Screen moves toward the bottom.
- ▶ : Screen moves toward the top.

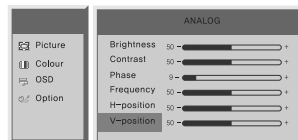

2. Color



Color adjustment detailed categories

>Color Tone – adjusts color temperature to set the desired color output

Default value is 7500 K

- [6500K] Warm color
- [7500K] Standard color
- [9300K] Cool color

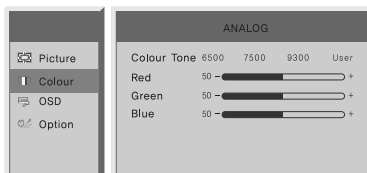

[User] option lets the user adjust "red", "green", and "blue" color density.

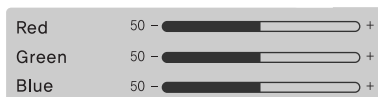



OSD

> OSD timeout

Adjusts the duration of the menu display

◀▶ : Adjusts the displayed (active) time for the OSD menu.

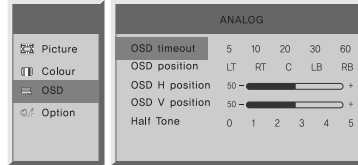

> OSD Position

Controls the menu position

◀▶ : Adjusts the OSD menu position on the screen.

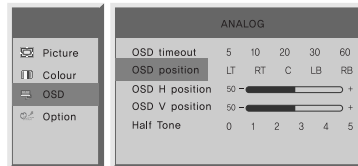

> OSD H Position

Adjusts the horizontal position of the menu

◀ : Moves the OSD menu to the left.
▶ : Moves the OSD menu to the right.

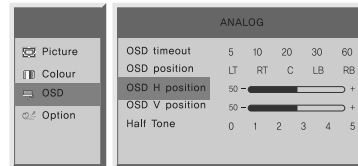

> OSD V Position

adjusts the vertical menu position.

◀ : Moves the OSD menu down.
▶ : Moves the OSD menu up.

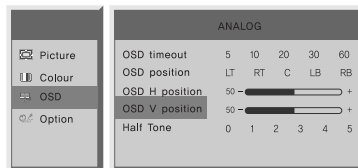

> Half Tone

option makes the menu background transparent.

◀/▶ : Adjusts the transparency level of the OSD background.

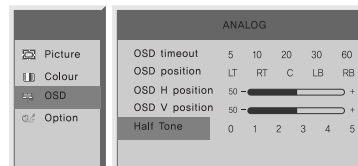

4. Option



Options

>Reset

Select Factory reset and click "▶" key to reset the monitor's settings.



>Language

Select Language and use ◀▶ buttons to select the desired language.

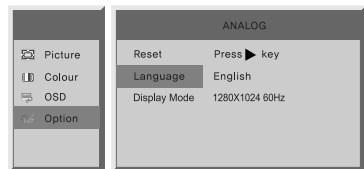

>Display mode

Shows the current resolution.

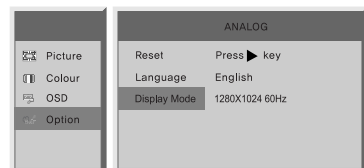

To enjoy optimal display

- 1. Due to the TFT-LCD monitor panel's characteristics, the optimal resolution is limited to one choice for each monitor size. Other resolution settings may decrease the display quality. Therefore it is recommended that the optimal resolution be used.

Optimal 17"/19" resolution by screen size (type) 17"/19" types : 1280 x 1024 @ 60Hz

- 2. The product may output a display of up to 1 PPM (one pixel per million) brighter or dimmer due to technical limitations in LCD Panel manufacturing. This characteristic does not affect the performance of the product.

Number of pixels by LCD panel size: 17 " / 19 " types : 3,932, 160 pixels

- 3. Use a soft dry cloth with a special cleansing solution for cleaning the monitor. Do not apply excessive force when cleaning the display panel. Using excessive force may leave marks.
- 4. Run the "Auto" (Auto-Adjust) function when dissatisfied with the display quality. This will enhance the quality. However, use the fine-tuning facility (phase/frequency control) if noise remains after automatic adjustment.
- 5. Having the monitor display fixed images may leave after-images or unwanted marks on the screen. Set the monitor power save mode from the PC or use a screen saver to protect the monitor.

Effects of Surroundings

The monitor position and location may affect viewing quality.

- 1. Do not place an amplifying speaker near the monitor.
- 2. Maintain at least 1m distance from any electronic appliances such as radios, fans, clocks, and telephones.

Self-Diagnosis Function

Execute self-diagnosis when the monitor remains blank even when the power and connections are correct.

Cable Connection Test Function

1. Turn off the PC and monitor.
2. Disconnect the video cable from the monitor or video card.
3. Turn on the monitor.

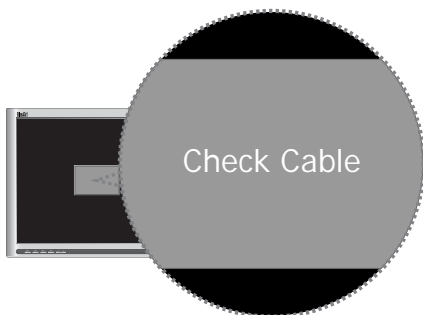

This monitor provides a connection test function for testing the PC connection.

Check if the cable has been disconnected from the monitor when the box shown is displayed on screen.

4. Turn off the monitor and re-connect the cable. Then turn the computer and monitor on.

Contact your service center when the message remains displayed even after making the connections correctly with a new cable.

Input Signal Bandwidth Detection



The power indicator light goes red when there is a problem with the input signal, and the following message appears. This message appears when the input signal resolution is over the supported limit or if there is a fault in the signal cable.

Boot the PC in safe mode and adjust the scanning rate to optimal resolution.

Problem	Solution
Color appears abnormal. It is in black and white.	Reconnect the PC connecting cables. Insert the PC's video card correctly. Re-boot the PC. Set the video card again after referring to the video card manual.
The displayed screen position suddenly changes or tilts inward.	Use the screen control to adjust the displayed screen shape. Set the resolution and/or frequency on the video card (refer to the supported mode table). Differences in the signal period of the video card may cause changes in the displayed position from time to time. Use the screen control functions to correct the displayed screen position.
Displays 16 colors only. The color has changed after replacing the video card.	Windows ME /XP /2000: Re-set the color from the Control Panel → Display → Setting Re-install the video card driver.
Power indicator lamp blinks orange.	Monitor is in Sleep Mode
Cannot control the screen with the buttons on the front of the monitor.	Contact technical support
There are colored spots on the screen	There may be a few colored (red, green, white, black) pixel spots on the screen during use. This is a natural characteristic in LCD panels. It is not a malfunction and does not affect the monitor's performance.
The power indicator lamp is off	Check if the power cable is intact. Reconnect the power cable correctly if necessary.
The "Check Cable" message appears on the screen.	Check if the connection between the PC and monitor is intact. Reconnect the cable correctly if necessary.
The "Out of range" message appears on screen.	The output signal from the video card exceeds the monitor's maximum resolution or frequency limit. Set the maximum resolution and frequency to suit the product limits.
The screen appears to be sliding downwards.	Check the connection between the PC and monitor. Re-connect if necessary. Run the auto-adjusting function.
The screen is unclear.	Run the auto-adjusting function.
The screen appears unstable and flickers. The screen leaves shadows.	Check if the computer or video card output resolution and frequency is set within the limits. Re-set the screen display by referring to the resolution information and standard supported mode table.
The screen is too bright or dark.	Use the brightness or contrast controls to adjust the display.
The color on the screen is not uniform.	Use the color density control to set the color.
Lines appear on the screen and the screen flickers.	Turn off any cordless phones, hair dryers, electrical drills etc. that are in use.



Caution Use a soft dry cloth to clean the product.

- Do not scratch the monitor panel with your fingernails or other sharp objects
- Do not use flammable substances such as benzene or paint thinner on the product. Do not use a wet cloth.

Use a clean cloth with special screen cleanser.

- Do not use acetone, benzene, or paint thinner on the product.



Warning Screen Setting

Refer to the video card manual for problems regarding screen division on two monitors.
The setting method may be different for different video cards.

Product Specification

Model Name		DS-1700S	DS-1900S
LCD	Visible Screen Area	337.92(H) × 270.336(V) 17.0 inch	376.32(H) × 301.056(V) 19.0inch
	Pixel Pitch	0.264(H) × 0.264(W)	0.294(H) × 0.294(W)
	Maximum Visible Angle	75° / 60° / 75° / 75° (Top/Bottom/Left/Right)	75° / 60° / 75° / 75° (Top/Bottom/Left/Right)
	Displayed Color	16.2M	16.7M
	Response Time	8msec	8msec
	Brightness	300cd/m ²	300cd/m ²
	Contrast Rate	700:1	700:1
	Recommended Resolution	1280 × 1024 (60Hz)	
Video Signal	Horizontal Frequency	31KHz~81KHz	
	Vertical Frequency	56Hz~75Hz	
Power	AC (Adaptor)	110V ~ 240V, 50Hz/60Hz	
	DC (Monitor)	(12V, 3.5A) × 2	
	Power Consumption	Max. 70W, Power Save Mode 3W	
Stand angle adjustment		Upward +20°, Downward -5°	
Characteristics		Graphic OSD, Auto adjustment	

※ The above specifications may vary without prior notice to improve performance.

Supported mode table

Resolution	Horizontal frequency (Khz)	Vertical frequency (Hz)
640 × 480	31.47	60
	37.86	72
	37.50	75
720 × 400	31.47	70
800 × 600	35.16	56
	37.88	60
	48.08	72
	46.88	75
1024 × 768	48.36	60
	56.48	70
	60.02	75
1280 × 1024	63.98	60
	79.98	75

Power Save Mode

This monitor comes with a power save function that activates when the monitor has not been used for a while. Power consumption is reduced in power save mode, and this is indicated by the power indicator lamp's color. Pressing a key on the keyboard or mouse turns the monitor back on. However this function is only enabled when the monitor is connected to a PC that has a power save function.

The power save function operates as described below.

Power save mode	Normal mode	Standby mode
Power indicator lamp color	Green	Orange (blinks every second.)
Power Consumption	70W	Below 3 W

Limited Warranty

INTRODUCTION

This Warranty covers DoubleSight Displays, LLC's ("DSD") DS-1700S & DS-1900S DoubleSight Dual 17" & 19" LCD Monitors ("Product") sold by DSD or DSD's authorized resellers. DSD provides a limited warranty for the originally purchased Products for use, not resale ("Original Purchase"), located in the United States. No DSD authorized reseller may claim any right or interest under this limited warranty.

Notice

DoubleSight Displays now include a 3year standard warranty for DS-1700S and DS-1900S models only from Original Date of Purchase.

Thank you for your support!

DoubleSight Displays LLC

LIMITED WARRANTY

DSD warrants this Product to be free from defects in material and workmanship for a period of three (3) year from the date of Original Purchase. Spare parts are warranted for ninety (90) days. Subject to the conditions set forth below, if a Product proves to be defective in material or workmanship during the warranty period, DSD will, at its sole option, repair or replace the Product with a similar Product. Replacement Product or parts may include remanufactured or refurbished parts or components and will meet the specifications of the original parts or unit.

This warranty is extended by DSD only to the original purchaser ("you") of the Product and is not transferable. During the warranty period, DSD shall provide you with limited telephone technical support providing assistance to you solely for the purpose of defining any problem. Repair or replacement of the Product is limited to the United States.

CUSTOMER RESPONSIBILITIES

As the original purchaser you have thirty (30) days in which to review the contents of the Product's packaging for any missing or broken items. After the first thirty (30) days of ownership, beginning from the date of Original Purchase, a charge will be incurred for replacement of any item you, the original purchaser, may wish to order from DSD. Such charges will include handling and shipping costs incurred for delivery of any such items.

WARRANTY EXCLUSIONS

This warranty does not cover:

1. Any Product on which the serial number has been defaced, modified or removed.
2. Damage, deterioration or malfunction resulting from:
 - A. Accident, disaster, misuse, neglect, fire, water, lightning, or other acts of nature, unauthorized product modification, or failure to follow instructions and environment specifications supplied with the Product.
 - B. Repair or attempted repair by anyone not authorized by DSD.
 - C. Customer supplied interfacing.
 - D. Improper site preparation and maintenance.
 - E. Damage to or loss of any programs, data or removable storage media.
 - F. Software or data loss occurring during repair or replacement.
 - G. Any damage of the Product due to shipment.
 - H. Removal or installation of the Product.
 - I. Causes external to the Product, such as electric power fluctuations or failure.
 - J. Use of supplies or parts not meeting DSD's specifications.
 - K. Normal wear and tear.
 - L. Subjecting the Product to displaying of fixed images for long periods of time resulting in image persistence (afterimage effects) or image burn-in.
 - M. Any other cause which does not relate to a product defect.
3. Removal, installation, and set-up service charges.

HOW TO OBTAIN WARRANTY SERVICE

1. For information on warranty service, call DSD customer service toll-free in the U.S.A. by calling 1-877-TwoLCDs (1-877-896-5237), or email DSD at support@doublesight.com.
2. To obtain warranty service, you will be required to provide
 - A. The original dated sales slip.
 - B. Your name.
 - C. Your address.
 - D. The serial number of the product.
 - E. A description of the problem.
3. Bring or ship the Product prepaid and insured in the original container, with the associated accessories, to the DSD depot repair site. All Products returned to the DSD depot repair site for service MUST have prior approval which may be obtained by calling the telephone number above.



DISCLAIMER OF WARRANTIES

THERE ARE NO WARRANTIES, EXPRESS OR IMPLIED, WHICH EXTEND BEYOND THE DESCRIPTION CONTAINED HEREIN. THE WARRANTIES CONTAINED HEREIN ARE IN LIEU OF ALL OTHER WARRANTIES EXPRESS OR IMPLIED, INCLUDING, BUT NOT LIMITED TO, THE IMPLIED WARRANTY OF MERCHANTABILITY AND FITNESS FOR A PARTICULAR PURPOSE. DSD MAKES NO OTHER EXPRESS OR IMPLIED WARRANTY OR CONDITION WHETHER WRITTEN OR ORAL. SOME STATES DO NOT ALLOW THE EXCLUSION OF IMPLIED WARRANTIES SO THE ABOVE EXCLUSIONS OR LIMITATIONS MAY NOT APPLY TO YOU.

THIS WARRANTY GIVES YOU SPECIFIC LEGAL RIGHTS AND YOU MIGHT ALSO HAVE OTHER RIGHTS THAT VARY FROM STATE TO STATE.

EXCLUSIVE REMEDIES

THE REMEDIES PROVIDED IN THIS STATEMENT OF LIMITED WARRANTY ARE YOUR SOLE AND EXCLUSIVE REMEDIES. IN NO EVENT, WILL DOUBLESIGHT DISPLAYS, LLC BE LIABLE FOR DIRECT, INDIRECT, INCIDENTAL, CONSEQUENTIAL, OR OTHER TYPES OF DAMAGES RESULTING FROM ANY BREACH OF WARRANTY, OR CONTRACT OR ANY TORT (INCLUDING NEGLIGENCE) OR UNDER ANY OTHER LEGAL THEORY, INCLUDING LOST PROFIT, DOWNTIME, GOODWILL, DAMAGE TO OR REPLACEMENT OF EQUIPMENT AND PROPERTY, AND ANY COSTS OF RECOVERING, REPROGRAMMING, OR REPRODUCING ANY PROGRAM OR DATA SORTED IN OR USED WITH THIS PRODUCT, EVEN IF DSD OR A DSD AUTHORIZED RESELLER FOR THIS PRODUCT HAS BEEN ADVISED OF THE POSSIBILITY OF SUCH DAMAGES, OR FOR ANY CLAIM BASED ON ANY THIRD PARTY CLAIM. DSD LIABILITY WILL BE NO MORE THAN THE AMOUNT YOU PAID FOR THE PRODUCT THAT IS THE SUBJECT OF A CLAIM. THIS IS THE MAXIMUM AMOUNT FOR WHICH DSD WILL BE RESPONSIBLE. SOME STATES DO NOT ALLOW THE LIMITATION OR EXCLUSION OF LIABILITY FOR INCIDENTAL OR CONSEQUENTIAL DAMAGES SO THE ABOVE EXCLUSIONS OR LIMITATIONS MAY NOT APPLY TO YOU.

This Product is warranted in accordance with the terms of this limited warranty. You are cautioned that Product performance is affected by system configuration, software, the application, customer data, and operator control of the system, among other factors. While DSD Products are considered to be compatible with many systems, specific functional implementation by the original purchaser of the Product may vary. Therefore, suitability of a Product for a specific purpose or application must be determined by the original purchaser and is not warranted by DSD.

Regulatory Information

FCC Compliance

This device complies with Part 15 of the FCC Rules. Operation is subject to the following two conditions: (1) This device may not cause harmful interference, and (2) this device must accept any interference received, including interference that may cause undesired operation. This equipment has been tested and found to comply with the limits for a Class B digital device, pursuant to Part 15 of the FCC Rules.

These limits are designed to provide reasonable protection against harmful interference in a residential installation. This equipment generates, uses and can radiate radio frequency energy and, if not installed and used in accordance with the instructions, may cause harmful interference to radio communications. However, there is no guarantee that interference will not occur in a particular installation.

If this equipment does cause harmful interference to radio or television reception, which can be determined by turning the equipment off and on, the user is encouraged to try to correct the interference by one or more of the following measures:

- Reorient or relocate the receiving antenna.
- Increase the separation between the equipment and receiver.
- Connect the equipment to an outlet on a circuit different from that to which the receiver is connected.
- Consult the dealer or an experienced radio/TV technician for help.

FCC WARNING

To assure continued FCC compliance, the user must use a ground power supply cord and the provided shielded video interface cable with bonded ferrite cores. If a BNC cable is going to be used, use only a shielded BNC (5) cable. Any unauthorized changes or modifications not expressly approved by the party responsible for compliance could void the user's authority to operate this device.

User Information

Users may find the following booklet, prepared by the Federal Communications Commission, helpful: "How to Identify and Resolve Radio-TV Interference Problems." This booklet is available from the U.S. Government Printing Office, Washington, D.C. 20402



www.doublesight.com