

User Manual



10" tablet

Attention:

This manual contains important instructions about the correct use of the tablet. Please make sure to read the manual carefully before using the tablet for the first time.

- Avoid using the tablet in areas of high temperature, moisture or very dusty places
- Avoid leaving the tablet in areas of high temperature.
- Do not drop or hit the tablet as this may cause damage to the tablet or the screen.
- Please choose an appropriate volume on the tablet and when using headphones avoid having the volume too high.
- You will need to charge your tablet in the following situations:
 - The battery power icon shows you have no power.
 - The system automatically shuts off or when you start up the tablet it powers off automatically.
 - The Power On button has no response.
 - The tablet has a red icon in the top right corner.
- When the tablet is in the process of formatting, resetting, or during a file upload or download, please do not suddenly disconnect or shut down the tablet. This can cause an application error.
- Do not disassemble the tablet.
- Do not use alcohol, thinner or benzene to scrub or clean the tablet.
- Do not use the tablet in any places that prohibit the use of electronic equipment (such as a plane).
- Do not use the Tablet when you are driving or walking down the street.
- The micro-USB input can only be used for data transmission.

Tablet Design

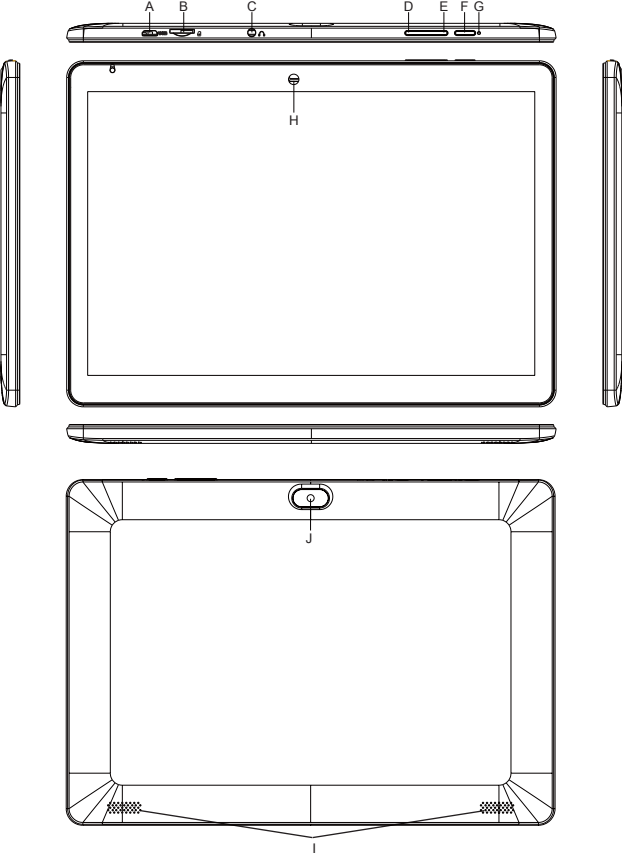

Name	Function
A. Micro-USB	Connect to a computer via a USB cable to transfer data (music, videos, photo, etc.)
B. TF Card Slot	To insert your micro-SD card
C. Earphone input	To connect your earphones
D. Volume +	Press to increase the volume
E. Volume -	Press to decrease the volume
F. Power and Lock Key	Hold and press to turn on or turn off the tablet. Briefly press to turn on or turn off the screen when the tablet is powered on.
G. Reset key	Press to reset the tablet
H. Front Camera	0.3 Megapixel Camera
I. Speaker	Built-in Speaker
J. Rear Camera	2.0 Megapixel Camera

Password Recovery

If you forget your password, then please follow these steps:

- turn off your tablet
- when the tablet has been powered off, then press and hold down the Volume+ button, and then press and hold down the power button (hold down both buttons for a few seconds and then the tablet will start to boot up)
- when the tablet starts to boot up, then release the Power button (but keep holding the Volume + button)
- when the Robot screen appears on the tablet, then you can release the Volume + button
- press and hold the Power button again, and then press the Volume + button
- the tablet will now go to the Android™ Recovery screen
- select Wipe data/factory reset
- the tablet will then reset and reboot. This will take a few minutes to complete.

Please note: this will reset your tablet and do a clean install of Android, and you will lose any stored data, files and settings.

GETTING STARTED

Turning the Tablet On or Off

Turn on the tablet: Press and hold the power button to start device.

Turn off the tablet: Press and hold the power button to power off the interface. Touch the "Power off" button to turn off the device.

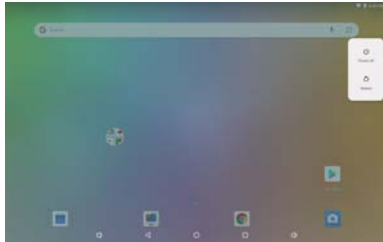

Turning the Screen On or Off

When the screen is bright, briefly press the power key to turn off the screen.

Briefly press the power key again to turn on screen.

To conserve battery power, the screen can be set to turn off automatically when the tablet is not in use (between 1 minute and 30 minutes). This "Screen timeout" option can be found in the Display menu.

Unlocking the Screen

When the screen turns off, you will have to unlock the screen when you turn it back on. To unlock the screen, drag the lock icon upward across the screen.



APPLICATIONS

To open an application, touch the application icon on the home screen or in the Launcher where you can tap the icon right up on the home screen to get in.

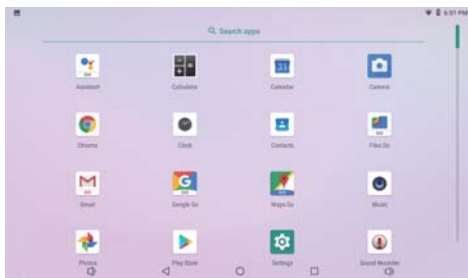

The screen shown above is for illustrative purposes only. The right to modify and improve the final list of applications available on the tablet is reserved.

Preinstalled Applications

Some applications have been installed on your tablet for your convenience. These applications include:



Photos: View your stored images.



YouTube Go: Watch online videos.



Gmail: Check your e-mail.



Chrome: Browse the Web.



Sound Recorder: Record voice notes.



Calculator: Perform simple mathematical operations.



Maps Go: Check your location.



Calendar: Mark dates or events.



Camera: Take pictures or videos.



Play Store: Download Apps and Games.



Files: View your stored files.

Installing Applications

You can also download and install additional applications from the device's applications marketplace, the web browser, or other sources.

The tablet must be set to allow installation of applications from non-Market sources. The "Unknown Sources" option can be set in the Application Settings menu.

Quick Settings & Notifications

Swipe down from the top of your home screen to view your Notifications.

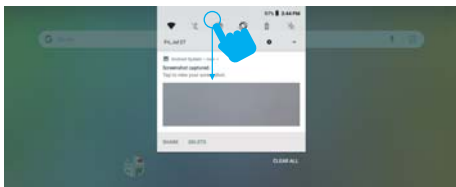

Use two fingers to swipe from the top of your home screen or swipe down again from notifications to view your Quick Settings.

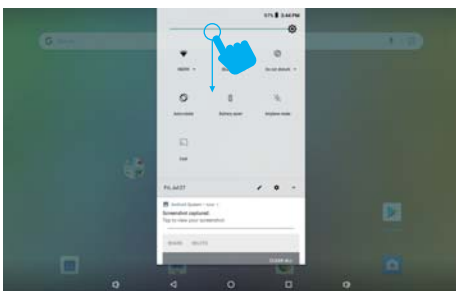

Managing Notifications

Tap on "Sounds & Notifications" in the Settings Menu. You can manage what notifications you see, set notification priority level by app, and see what apps have access to your notifications. You can set up your device so that notifications only appear on at certain times, for certain types of notifications, and from specific contacts.

Widgets, Wallpapers, and other Settings

Tap and hold your finger on any open space on your home screen. A list of options appears. Here, you choose to add widgets, such as calendars, clocks, music, and more. Change your wallpaper and other home settings here.

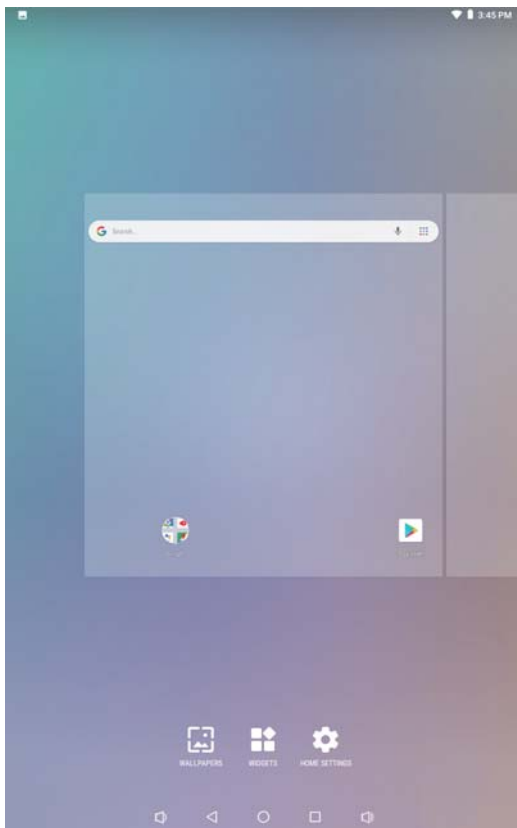

CONNECTING TO A WI-FI NETWORK

1) Turn on W-Fi:

Turn on the Wi-Fi button in the settings menu.

The tablet will search and display a list of the available Wi-Fi networks.



2) Connect to a Wi-Fi Network

Choose the wifi network you wish to join, then input the password to be connected.

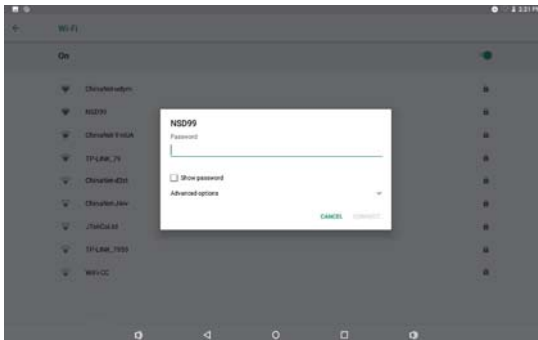

3) Other Functions

Scan, WPS pin entry, Wi-Fi direct, and advanced functions in the Wi-Fi menu.



4) Add a Network

Press the "Add" button in the Wi-Fi screen to add a network. Input the SSID, choose the security, then input the password.



OPTIONAL CONNECTIONS

Connecting to a Computer

1. Connect your tablet to the computer. With the included USB cable, plug the small end of the cable into the USB 2.0 high-speed connector of the tablet. Plug the large end of the cable into an available USB 2.0 high-speed port on the computer.
2. When your tablet is connected, slide up the USB icon right on the screen and then touch the “USB connected” icon.

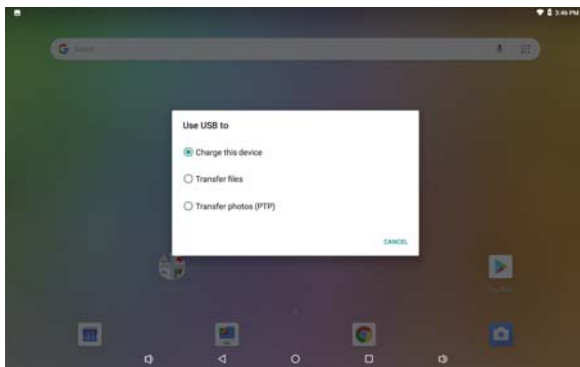

Model:	
Operating System:	Android™ 8.1 (Go edition)
CPU:	RK3326 Cortex-A35 Quad-core 1.5GHz processor
RAM & Memory:	1GB & 16GB
Display LCD:	10.1" 1280x800 IPS
Camera:	Front 0.3MP/2.0MP
Battery:	3.8V/5000mAh Li-polymer battery
Adapter:	AC100~240V, 50/60Hz, 5V/2A
BT:	4.0
Wi-Fi:	802.11b/g/n
Sensor:	G-Sensor
MicroSD input:	Support TF card up to 64GB
I/O port:	Micro-USB x1 MicroSD Card x1 Reset Jack x1 Earphone Jack x1
Size:	244mm*173mm*9.2mm

WARRANTY EXCLUSIONS

The warranty will not be valid if:

1. The product has not been installed, operated or maintained in accordance with the manufacturers operating instructions provided with the product.
2. The product has been used for purposes other than its intended function.
3. The product has been used for purposes other than household use.
4. The damage or malfunction of the product is caused by any of following conditions:
 - Incorrect voltage
 - Accidents (including liquid or moisture damage)
 - Misuse or abuse of the product
 - Faulty or improper installation
 - Mains supply problems including power spikes or lightning damage
 - Infestation by insects
 - Tampering or modification of the product by persons other than authorised service personnel
 - Exposure to abnormally corrosive materials
 - Insertion of foreign objects into the unit
 - Used with accessories not pre-approved

Please refer to and heed all warnings and precautions in the User Manual.

Google, Android, Google Play and other marks are trademarks of Google LLC.

Made in China

FCC Caution:

This device complies with part 15 of the FCC Rules. Operation is subject to the following two conditions: (1) This device may not cause harmful interference, and (2) this device must accept any interference received, including interference that may cause undesired operation.

Any Changes or modifications not expressly approved by the party responsible for compliance could void the user's authority to operate the equipment.

Note: This equipment has been tested and found to comply with the limits for a Class B digital device, pursuant to part 15 of the FCC Rules. These limits are designed to provide reasonable protection against harmful interference in a residential installation. This equipment generates uses and can radiate radio frequency energy and, if not installed and used in accordance with the instructions, may cause harmful interference to radio communications. However, there is no guarantee that interference will not occur in a particular installation. If this equipment does cause harmful interference to radio or television reception, which can be determined by turning the equipment off and on, the user is encouraged to try to correct the interference by one or more of the following measures:

- Reorient or relocate the receiving antenna.
- Increase the separation between the equipment and receiver.
- Connect the equipment into an outlet on a circuit different from that to which the receiver is connected.
- Consult the dealer or an experienced radio/TV technician for help.

The device has been evaluated to meet general RF exposure requirement. The device can be used in portable exposure condition without restriction.