

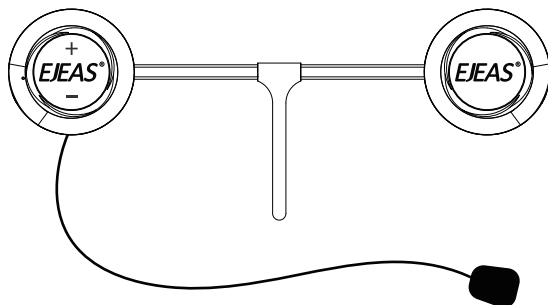

More
Languages



Certified
Model

Version
Model

S2

4-people

User Manual

**Ski Helmet
Intercom
System**

🔍 www.ejeas.com

Product Details

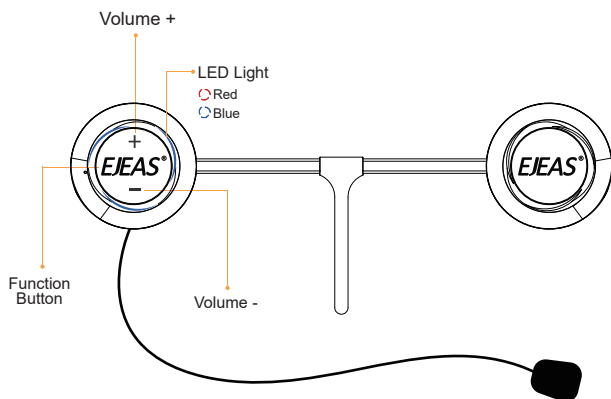

MESH 4
People Intercom



Voice
Assistant



Music
Share



Simultaneous
Intercom and Music



Firmware
Upgrade Supported



IP67



Super
Penetrating Power



Support
Mobile App

Product Operation

Operation Diagram

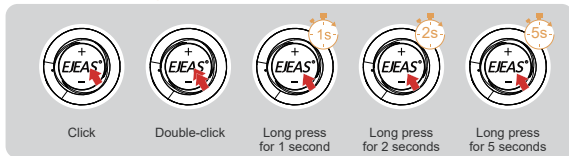

Basic Operation

Power ON/OFF Please charge it before using

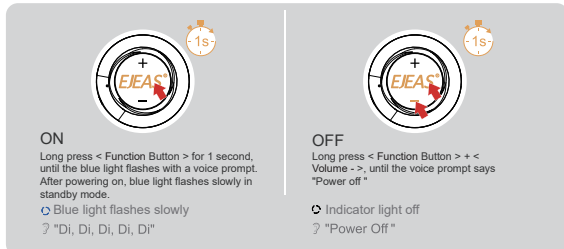

Reset: It will automatically power off while charging and can be used while charging after powering on.

Low Battery Indication

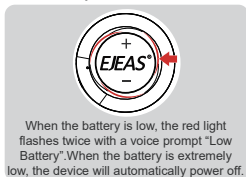

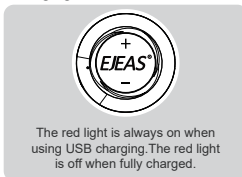

Charging Indication



Battery Inquiry: After connecting to the phone via Bluetooth, you can see the power icon on the phone side.

Menu Options

① Simultaneously press and hold the < Volume + > / < Volume - > for about 1 second to open the menu option, and the voice prompt "Menu" will appear.

- Blue light flashing
- "Menu"

② Short press the < Volume + > / < Volume - > to move the option, voice broadcast the current option, and short press the <Function Button> to execute the option.

- Blue light flashing
- "Current Options"

③ If there is a numerical value selection, continue to short press the < Volume + > / < Volume - > to select the value, then long press the < Function Button> to exit the menu. The voice prompts "Exit menu".

- Blue light flashing
- "Exit Menu"

If there is no numerical selection, execute the option directly and automatically exit the menu.

Option	Restore Default Settings	Mesh Channel (1)	Listen Mesh Pairing
Numerical Value	None	1~5	None

Note (1): Can only be selected when Mesh intercom is turned on.

Mobile App APP provides intercom group, music control, FM control, switch off, check authenticity and other functions.



iOS



Android





- ① Download and install SafeSiding mobile APP for the first time.
- ② Press and hold (approx. 5s) <Function Button> until the red and blue lights flash alternately to enter phone pairing.
- ③ Open the APP, click on the Bluetooth icon in the top right corner, the interface shows the name of the intercom device searched, select the intercom device to be connected, click to connect.
- ④ Open the APP the next time you use it. Click the Bluetooth icon in the top right corner and click to select Intercom for connection from the paired devices.

Mesh Intercom

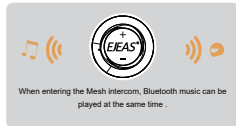

Mesh intercom is a multi-hop technology mesh network intercom (Communication frequency 470-488MHz). On account of large number of participants and unrestricted location, people are able to move at will within the effective range. It is not only superior to the traditional Bluetooth chain intercom, but has a longer transmission distance and better anti-interference ability.



Microphone Mute

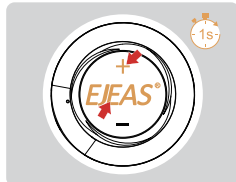

?

?

Press <Volume + >+<Function Button> to unmute.

?

Note: Only valid for Mesh intercom.

Pairing Steps as Members:



Red and blue lights flash alternately

?

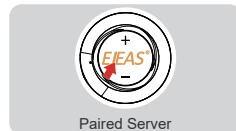

Red and blue lights flash alternately

?

Paired Server

Wait a few moments and you hear the prompt "Channel n" from all the intercoms, you can start communicating and hear each other's voices.

Intercom Reconnection



When you power on the intercom for the next use, short press the <Volume + >+<Function Button>. You will hear the prompt "Join the Mesh." Wait for a moment, and you will hear the prompt "Channel n", you can talk to each other.

Turn off MESH Intercom



Press and hold the <Volume + >+<Function Button> (about 1s) to turn off Mesh Intercom. The voice prompts "Mesh Close".

Intercom Channel Switching



There are a total of 5 channels, which can be changed through the menu (as explained in the menu on page 3 of the manual). Channels can be switched forward or backward, note that the entire team needs to be on the same channel to talk to each other.

When the signal is unstable, you can switch channels to adjust.

If the device is powered off without turning the intercom off, the intercom will be automatically restored upon the next power-on.

Pairing Steps as Listeners:

In the case that other intercoms have formed a team, you can become the listener of the team through pairing.



- 1 Take the intercom to be paired, enter listening mode pairing, open the menu (as explained in the menu on page 3 of the manual.), select Mesh listening mode pairing, and prompt "Mesh system listening mode pairing". The red light and blue light flash alternately.
Red and blue lights flash alternately
? "Listen Mesh Pairing"



Paired Server

- 2 Take the intercom to be paired, enter listening mode pairing, open the menu (as explained in the menu on page 3 of the manual), select Mesh listening mode pairing, and prompt "Mesh system listening mode pairing".
Note: Unjoined machines can only be joined again through the server.
? "Listen Mesh Pairing"



Paired Server

- 3 Short press the <Function Button> again, and you will hear a "beep" sound, with alternating red and blue lights flashing.
Red and blue lights flash alternately
? "Du"

Wait a moment and hear "Pairing Successful" from all intercoms. Wait a few more minutes and hear "Channel n". This means that you have joined the intercom network and can communicate with others.

Mobile Phone Pairing

This intercom supports connection to mobile phones for playing songs, making calls, and waking up voice assistants. Up to 2 mobile phones can be connected at the same time.

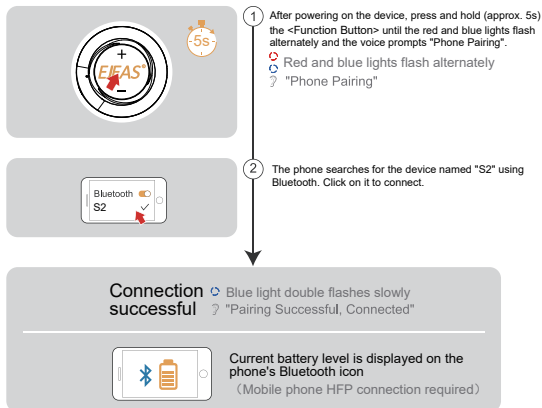

Bluetooth Reconnection With Mobile Phones

After switching on, it automatically connects back to the last connected phone Bluetooth. When there is no connection, click on the <Function Button> to reconnect with the last mobile device that was connected to Bluetooth.



Mobile Control

Call Answering

When a call comes in, click on the <Function Button>



Call Rejection



When a call come, press the <Function Button> for about 1s

Hang Up



During a call, click on the <Function Button>

Call Redial



When standby/playing music, quickly double-click the <Function Button>

Cancel Redial



During redial, click on <Function Button>

Phone Priority

When a call comes in, it will interrupt Bluetooth music, FM radio, intercom, and resume after hanging up.

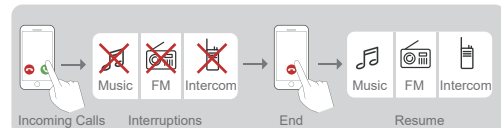

Voice Assistant

When in standby/playing music, press and hold <Function Button>, it depends on your mobile phone.

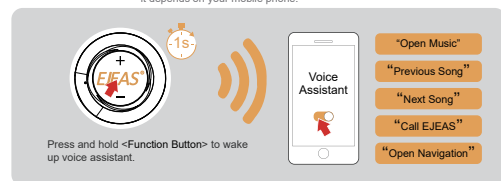

Music Control

Play/Pause



Music Playing



Previous Song



Volume -



Next Song



Volume +



Music Share

Share the music played by Bluetooth on your phone to another device, and this function cannot be used during Bluetooth intercom.

This function cannot be used when two phones are connected simultaneously.

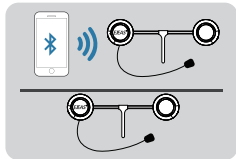

- 1 Take an intercom as the host, connect it to the phone, and the other one is the slave.



- 2 Press the <Function Button>+<Volume -> at the same time between the host and slave to enter the music sharing search connection state.
? "Music Share"

After the connection is successful, play the phone music of the host, and the music can also be played from the speaker.

? "Music Share Connected"



Press the <Function Button>+<Volume -> again to exit music sharing.

? "Music Share Disconnected"

Firmware Upgrades



Connect to the computer with a USB data cable. Download and open the "EJEAS Upgrade.exe" upgrade software. Click on the "Upgrade" button to start and wait for the upgrade to complete.

Note: Upgrading must use the standard data cable from EJEAS.

NOTE: This equipment has been tested and found to comply with the limits for a Class B digital device, pursuant to part 15 of the FCC Rules. These limits are designed to provide reasonable protection against harmful interference in a residential installation. This equipment generates, uses and can radiate radio frequency energy and, if not installed and used in accordance with the instructions, may cause harmful interference to radio communications. However, there is no guarantee that interference will not occur in a particular installation. If this equipment does cause harmful interference to radio or television reception, which can be determined by turning the equipment off and on, the user is encouraged to try to correct the interference by one or more of the following measures:

- Reorient or relocate the receiving antenna.
- Increase the separation between the equipment and receiver.
- Connect the equipment into an outlet on a circuit different from that to which the receiver is connected.
- Consult the dealer or an experienced radio/TV technician for help.

Changes or modifications not expressly approved by the party responsible for compliance could void the user's authority to operate the equipment.

This device complies with Part 15 of the FCC Rules. Operation is subject to the following two conditions:

(1) this device may not cause harmful interference, and (2) this device must accept any interference received, including interference that may cause undesired operation.