

⚠ Important

This device complies with part 15 of the FCC rules.

Operation is subject to the following two conditions :

- (1) This device may not cause harmful interference and
- (2) This device must accept any interference received, including interference that may cause undesired operation.

Federal Communications Commission Requirements

The equipment has been tested and found to comply with the limits for Class B Digital Device, pursuant to part 15 of the FCC Rules. These limits are designed to provide reasonable protection against harmful interference in a residential installation.

This equipment generates, uses and can radiate radio frequency energy and, if not installed and used in accordance with the instruction, may cause harmful interference to radio communication. However, there is no guarantee that interference will not occur in a particular installation.

If this equipment does cause harmful interference to radio or television reception, which can be determined by turning the equipment off and on, the user is encouraged to try to correct the interference by one or more of the following measures :

- Reorient or relocate the receiving antenna.
- Increase the separation between the equipment and receiver.
- Connect the equipment into an outlet on a circuit different from that to which the receiver is connected.
- Consult the dealer or an experienced radio/TV technician for help.

The changes or modifications not expressly approved by the party responsible for compliance could void the user's authority to operate the equipment.

⚠ Troubleshooting :

Wireless RF Mouse not detected

If the mouse doesn't respond to activity, follow below steps :

- (1) Ensure that the receiver dongle is properly connected to the USB ports.
- (2) Ensure that the batteries have been installed correctly.
- (3) Ensure that you have established a connection between the RF receiver and the mouse.

**Wireless RF Mouse doesn't work after changing batteries :
If the Mouse doesn't respond to activity after replacing the batteries, follow these steps :**

- (1) Ensure that the batteries have been installed correctly.
- (2) Ensure that the batteries are not discharged.
- (3) Ensure that you have established a connection between the RF receiver and mouse.

Cursor does not Move properly on the screen If the cursor does not move or the motion is erratic, follow below steps :

- (1) Ensure that you have established a connection between the RF receiver and mouse.
- (2) Change the position of the RF receiver. There should be a distance of at least 20 inches(50cm) between the receiver and electrical appliance (such as speakers, the monitor, or the computer).
- (3) Ensure that the mouse batteries are not discharged. If they are discharged replace them.

QUICK GUIDE

2.4GHz Wireless Optical Mouse

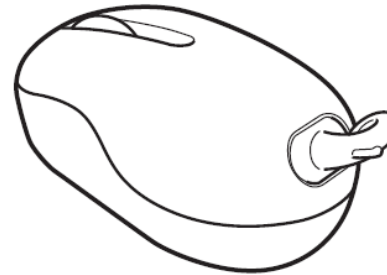

1. Package Contents :

(A) Mouse

(B) Receiver



(C) Battery

(D) Quick Guide



1.5V / AAAx1



2. Specification :

(A) Input : DC 1.5V(min).

(B) Power Consumption : 8mA(max).

(C) Available Distance : 8~10m(max).

(D) Wireless RF : 2.4Ghz.

(F) System Requirements : Windows NT 4.0 / 98SE / 2000 / ME / XP / Vista / 7.

3. Installation :

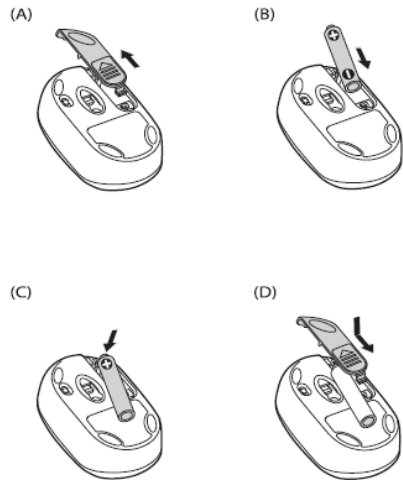

4. Installation :

(A) Plug-in the receiver.

(B) LED on receiver will flash for 20 seconds.

(C) Press ID button on Wireless RF Mouse within 20 seconds. When ID matched, the LED will stop flashing. Then the Device could work.

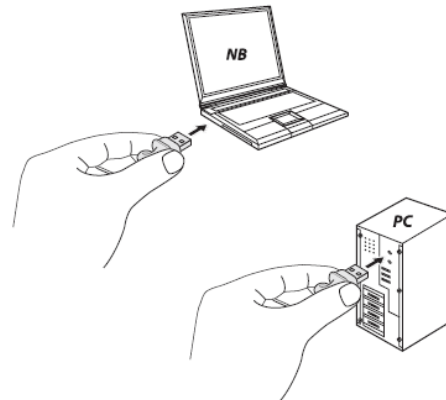

ID Select ⚠ Important :

※ Note ! Repeat this Step when connecting the Mouse for the first time and after replacing the batteries.

※ Place the receiver at least 20 inches (50cm) from electrical devices such as the computer or monitor.

Federal Communication Commission Interference Statement

This equipment has been tested and found to comply with the limits for a Class B digital device, pursuant to Part 15 of the FCC Rules. These limits are designed to provide reasonable protection against harmful interference in a residential installation.

This equipment generates, uses and can radiate radio frequency energy and, if not installed and used in accordance with the instructions, may cause harmful interference to radio communications. However, there is no guarantee that interference will not occur in a particular installation. If this equipment does cause harmful interference to radio or television reception, which can be determined by turning the equipment off and on, the user is encouraged to try to correct the interference by one of the following measures:

- Reorient or relocate the receiving antenna.
- Increase the separation between the equipment and receiver.
- Connect the equipment into an outlet on a circuit different from that to which the receiver is connected.
- Consult the dealer or an experienced radio/TV technician for help.

FCC Caution: To assure continued compliance, any changes or modifications not expressly approved by the party responsible for compliance could void the user's authority to operate this equipment. (Example - use only shielded interface cables when connecting to computer or peripheral devices).

This device complies with Part 15 of the FCC Rules. Operation is subject to the following two conditions:

- (1) This device may not cause harmful interference, and (2) This device must accept any interference received, including interference that may cause undesired operation.