

### 3 STARTING SETUP

1 ASSEMBLE CLOUD FRAME: Screw in stand.

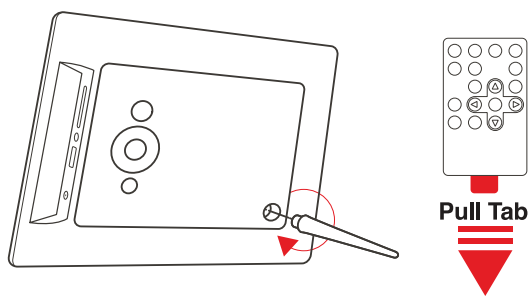

2 It's important to PLACE YOUR CLOUD FRAME NEXT TO A COMPUTER FOR SET UP.



3 PLUG IN THE POWER ADAPTOR TO YOUR CLOUD FRAME: Then plug your Cloud Frame into a power source.

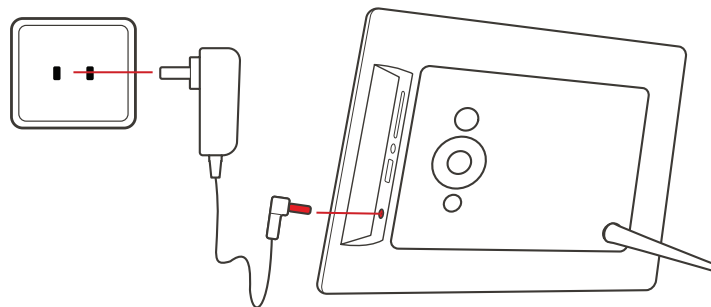

4 PRESS THE POWER BUTTON: This is located on the back of your Cloud Frame. Please be patient as your Cloud Frame may take a minute to load.

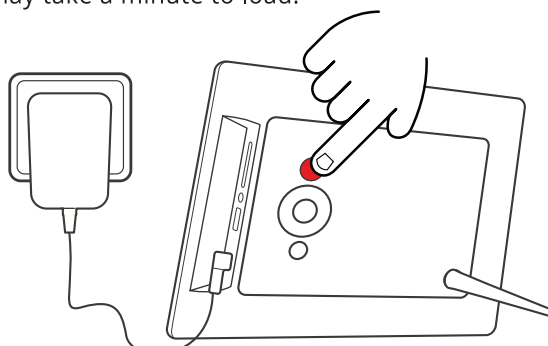

Please Wait... 1 min approx

5 CONNECT TO YOUR WiFi: Use the UP/DOWN arrows on the Remote or the 4-way key on the back of the Cloud Frame, press OK to select your WiFi.

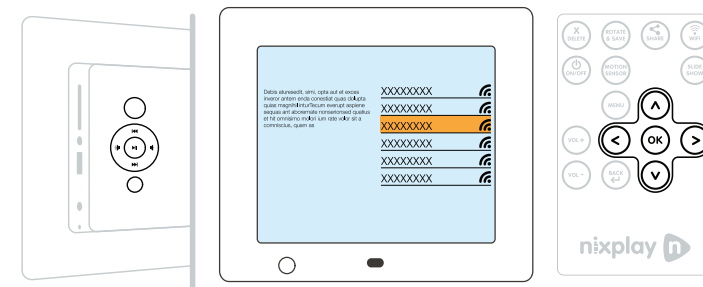

ENTER YOUR WiFi PASSWORD (if required) and then select the CONNECT button.



### STARTING SETUP

6 WAIT FOR THE UPDATE: Once your Cloud Frame is connected, it may automatically update to ensure your Cloud Frame has the latest features and functions. It is critical that you do not switch your Cloud Frame off during this process.

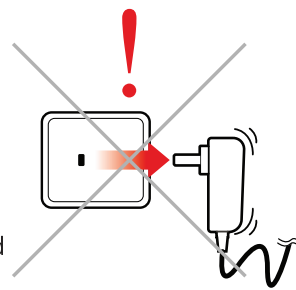

Please Wait... 10 min approx

7 16 DIGITAL SERIAL NUMBER: Your Frame should display a 16 digit serial number that you will need to enter on the www.nixplay.com website, after step 8.

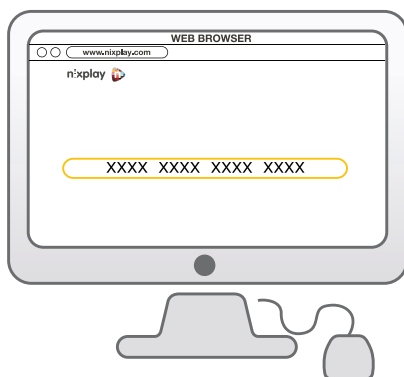

8 ON YOUR COMPUTER: Please login to www.nixplay.com to create your account. Click the CONNECT FRAME button on the website. Please ensure that you're using the latest browser version.

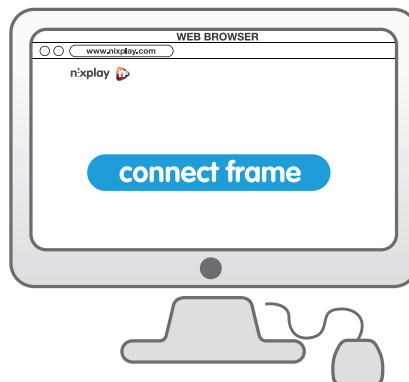

**FANTASTIC!**  
**YOU'RE NOW READY TO PAIR YOUR FRAME TO ITS OWN NIXPLAY CLOUD ACCOUNT**

9 changes or modifications not expressly approved by the party responsible for compliance could void the user's authority to operate the equipment.

This equipment has been tested and found to comply with the limits for a Class B digital device, pursuant to Part 15 of the FCC Rules. These limits are designed to provide reasonable protection against harmful interference in a residential installation. This equipment generates, uses and can radiate radio frequency energy and, if not installed and used in accordance with the instructions, may cause harmful interference to radio communications. However, there is no guarantee that interference will not occur in a particular installation. If this equipment does cause harmful interference to radio or television reception, which can be determined by turning the equipment off and on, the user is encouraged to try to correct the interference by one or more of the following measures:

- Reorient or relocate the receiving antenna.
- Increase the separation between the equipment and receiver.
- Connect the equipment into an outlet on a circuit different from that to which the receiver is connected.
- Consult the dealer or an experienced radio/TV technician for help.