

# NEXBANG

## Visual Controller For Garage Door Opener User Manual

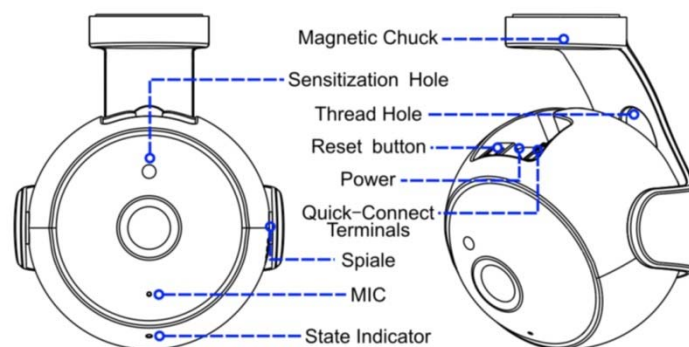

### Product Description



## Packing list



1) Camera Host\*1



2) Power Adaptor\*1



3) Power Cord\*1



4) Connection Cable\*1



5) User Manual\*1



6) Installation Kits

Expansion wall plug\*4

Twin adhesive\*1, Sheet iron\*1, Screws\*4

PS: There are two spare screws.

## User Guide

### Step 1

#### Download app and Connect camera

A. Download the app

Download free app from Apple Store or Google Play Simply search for **Danale+**.

B. Connect to camera

1. Use your mobile phone number or email to create an account and sign in.

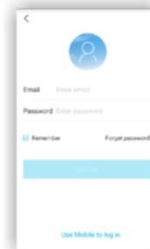
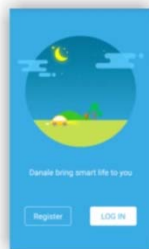

2. Connect to power

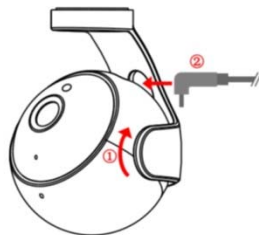

- ① Rotate the sphere upward
- ② Put USB cable through the circular hole

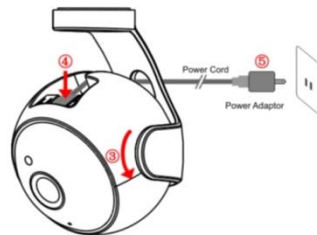

- ③ Rotate the sphere downward
- ④ Press and insert to USB head
- ⑤ Plug the power adapter

Please make sure the camera is in the area where Wifi signal fully covers.

Add device by scanning QR Code or using AirLink Auto.



### 3.State Indicator instructions

#### Red light is on

Power on process,it will be off when connecting to internet

#### Blue light flickers

Slow flashing:On the process of LAN connection

Quick flashing:Successfully connected to LAN,connecting to P2P server

#### Blue light is on

Successfully connected to P2P server

#### Red light flickers

Slow flashing(1s/time):AirLink status waiting for configuration

#### Red light alternates with Blue light

Device is waiting for upgrade,do not power off under this status

**TIPS:The camera may fail to connect wifi if the wifi password is wrong.If so,it may need to be reset.**

## Step 2

### Connect to garage controller and install

#### 1.Connect to garage door opener

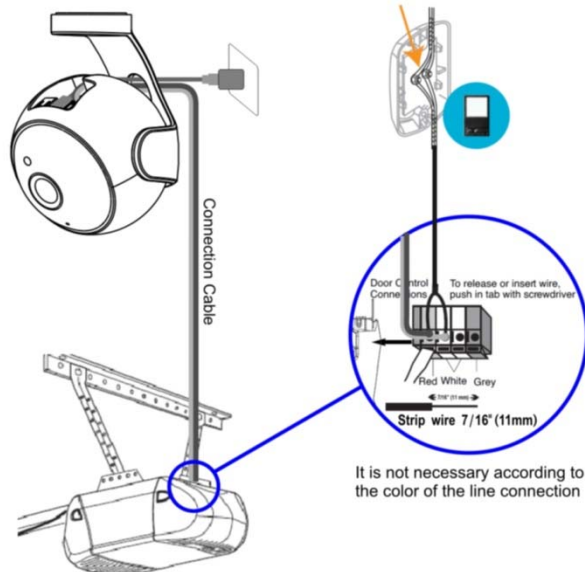

## 2. Fix the camera

Below several ways to install and fix the camera:

- ① Magnetic Chuck on camera directly adhesives to iron surface
- ② Stick sheet iron with twin adhesive to smooth surface for camera fixation
- ③ Punching and fix the sheet iron with screws for camera fixation

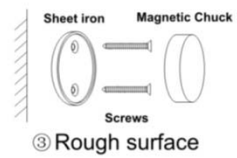
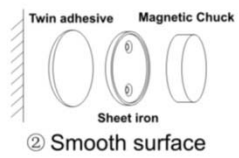
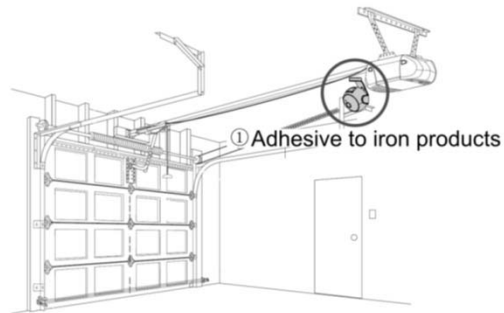

4.Adjust the angle after installation

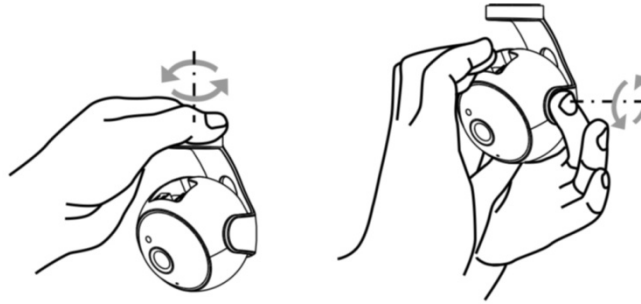

Horizontal direction adjustment

Vertical direction adjustment

**Tips:**In order to avoid any damage to device  
please strictly follow the picture instruction.

This device complies with Part 15 of the FCC Rules. Operation is subject to the following two conditions: (1) this device may not cause harmful interference, and (2) this device must accept any interference received, including interference that may cause undesired operation.

Changes or modifications not expressly approved by the party responsible for compliance could void the user's authority to operate the equipment.

This device and its antenna(s) must not be co-located or operating in conjunction with any other antenna transmitter. This equipment should be installed and operated with a minimum distance of 20 centimeters between the radiator and your body.

**Note:** This equipment has been tested and found to comply with the limits for a Class B digital device, pursuant to part 15 of the FCC Rules. These limits are designed to provide reasonable protection against harmful interference in a residential installation. This equipment generates, uses and can radiate radio frequency energy and, if not installed and used in accordance with the instructions, may cause harmful interference to radio communications. However, there is no guarantee that interference will not occur in a particular installation. If this equipment does cause harmful interference to radio or television reception, which can be determined by turning the equipment off and on, the user is encouraged to try to correct the interference by one or more of the following measures:

- Reorient or relocate the receiving antenna.
- Increase the separation between the equipment and receiver.
- Connect the equipment into an outlet on a circuit different from that to which the receiver is connected.
- Consult the dealer or an experienced radio/TV technician for help.