

Quick Start Guide

Kushion Audio Pillow C80-00001-NA0



Important

Read and understand all instructions before you use your product. If damage is caused by failure to follow instructions, the warranty does not apply.

Important safety instructions

- Read these instructions.
- Keep these instructions.
- Heed all warnings.
- Follow all instructions.
- Do not use this apparatus near water.
- Clean only with dry cloth.
- Do not block any ventilation openings. Install in accordance with the manufacturer's instructions.
- Do not install near any heat sources such as radiators, heat registers, stoves, or other apparatus (including amplifiers) that produce heat.
- Protect the power cord from being walked on or pinched, particularly at plugs, convenience receptacles, and the point where they exit from the apparatus.
- Only use attachments/accessories specified by the manufacturer.



- Use only with the cart, stand, tripod, bracket or table specified by the manufacturer or sold with the apparatus. When a cart is used, use caution when moving the cart/apparatus combination to avoid injury from tip-over.
- Unplug this apparatus during lightning storm or when unused for long periods of time.
- Refer all servicing to qualified service personnel. Servicing is required when the apparatus has been damaged in any way, such as power-supply cord or plug is damaged, liquid has been spilled or objects have fallen into the apparatus, the apparatus has been exposed to rain or moisture, does not operate normally, or has been dropped.
- Apparatus shall not be exposed to dripping or splashing.
- Do not place any sources of danger on the apparatus (for example, liquid filled objects, lighted candles).
- Where the MAINS plug or an appliance coupler is used as the disconnect device, the disconnect device shall remain readily operable.
- CAUTION: To prevent electric shock, match wide blade of plug to wide slot, fully insert.
- A warning that batteries(battery pack or batteries installed)shall not be exposed to excessive heat such as sunshine, fire or the like.
- CAUTION: Danger of explosion if battery is incorrectly replaced, Replace only with the same or equivalent type.



- CAUTION: Removal of the built-in battery invalidates the warranty and can destroy the product.

- CAUTION: These servicing instructions are for use by qualified service personnel only. To reduce the risk of electric shock do not perform any servicing other than that contained in the operating instructions unless you are qualified to do so.
- Date of manufacture label inside the product

Care of the environment



Your product is designed and manufactured with high quality materials and components, which can be recycled and reused. Never dispose of your product with other household waste. Please inform yourself about the local rules on the separate collection of electrical and electronic products and batteries. The correct disposal of these products helps prevent potentially negative consequences on the environment and human health. The batteries supplied do not contain the heavy metals mercury and cadmium. Nevertheless, in many areas batteries may not be disposed of with your household waste. Please ensure you dispose of batteries according to local regulations. For perchlorate material, special handling may apply. Visit www.dtsc.ca.gov/hazardouswaste/perchlorate.

Notice of compliance

The device complies with the FCC rules, Part 15. Operation is subject to the following two conditions:

- ① This device may not cause harmful interference, and
- ② This device must accept any interference received, including interference that may cause undesired operation.

FCC rules

This equipment has been tested and found to comply with the limits for a Class B digital device, pursuant to part 15 of the FCC Rules. These limits are designed to provide reasonable protection against harmful interference in a residential installation. This equipment generates, uses and can radiate radio frequency energy and, if not installed and used in accordance with the instruction manual, may cause harmful interference to radio communications.

However, there is no guarantee that interference will not occur in a particular installation. If this equipment does cause harmful interference to radio or television reception, which can be determined by turning the equipment off and on, the user is encouraged to try to correct the interference by one or more of the following measures:

- Relocate the receiving antenna.
- Increase the separation between equipment and receiver.
- Connect the equipment into an outlet on a circuit different from that to which the receiver is connected.
- Consult the dealer or an experienced radio/TV technician for help.

Warning: Any changes or modifications made to this device that are not expressly approved by KUSHION audio may void the user's authority to operate the equipment.

Model number: C80-00001-NA0

Trade Name: KUSHION







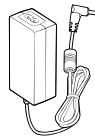
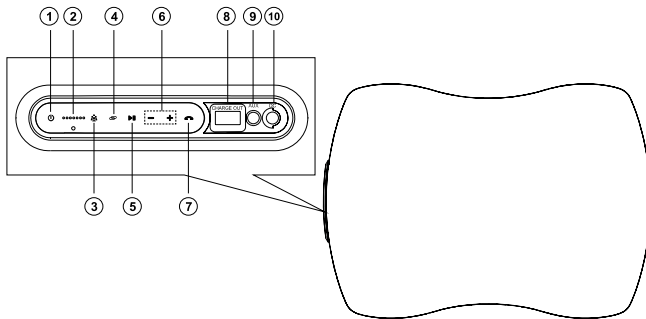

The Bluetooth® word mark and logos are registered trademarks owned by Bluetooth SIG, Inc. and any use of such marks by KUSHION audio is under license. Other trademarks and trade names are those of their respective owners.

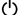
Specifications

- Power supply:
 - Input: 100-240V~ 50/60 Hz, 1.5A
 - Output: 12.0V , 5.0A
- Standby power consumption: $\leq 0.5W$
- Speaker impedance: 6 ohm
- Bluetooth version: 4.1
- Dimensions (L x W x H): 610 x 445 x 150 mm
- Weight: 3.15 kg

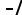

- ①  (Power indicator)
 - Long press Power button 3 seconds– Power ON
 - Long press Power button 3 seconds– Power OFF
 - Blinking indicates pairing mode.
- ② Battery indication
If battery is charging, the dots will light up one by one in cycle.
- ③  (Party mode)
Turn party mode on or off.
- ④  (True wireless)
Turn true wireless on or off.
Linking pairs two pillows together, allowing them to be controlled by a single smart device.
- ⑤  (Play/Pause)
 - Pause or resume play music.
 - Press and hold for three seconds, the pillow enter the pairing mode.
- ⑥  (Volume)
Increase or decrease volume
- ⑦  (Phone)
Control all phone functions.
- ⑧ CHARGE OUT
Charge a USB device.
- ⑨ AUX
Audio input from an MP3 player (3.5mm jack).
- ⑩ DC
Connect to the power supply.

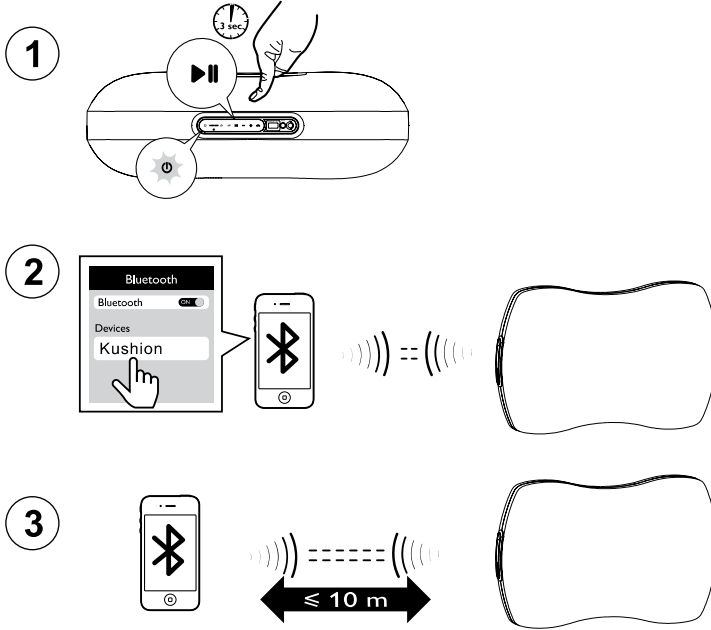

- 1 Press and hold for three seconds, the product enters the pairing mode.
↳ The power logo blinks.
- 2 On the Bluetooth device, switch on Bluetooth, search for and select **KUSHION 6 digit ID** to start connection.
- 3 Select and play audio files or music on your Bluetooth device.

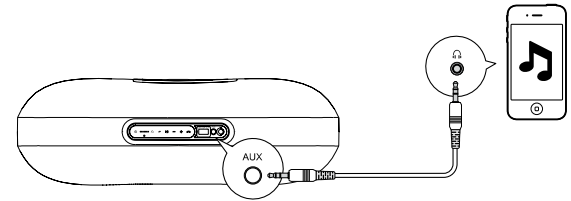

Connect your MP3 player to play your audio files or music.

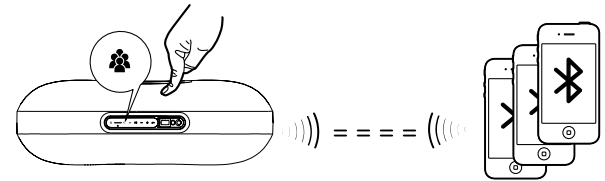

Allows 3 users to access the pillow simultaneously and send audio signal/play music through the pillow.

- Press : Party mode is initiated.
- Press : End party mode

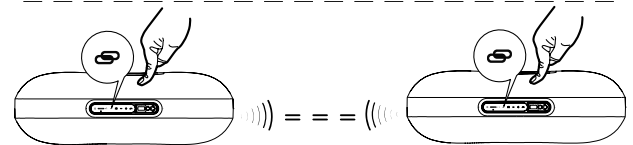

True wireless pairs two pillows together, allowing them to be controlled by a single smart device

- Press : respectively press this button on two Pillows, to activate the TWS mode.
- Press : press this button again, to exit the TWS mode.

*Note: Please do not activate Party mode and TWS mode at the same time.
Exit the previous selected mode to switch to next desired mode.*

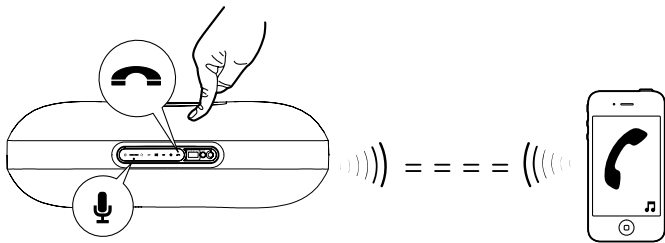

1 With an incoming call

- Press : Answer the call.
- Hold : Reject an incoming call.

2 While on call

- Press : End a current call.

3 With an incoming call while on call

- Press : Hold current call and answer incoming call.
- Press : End current call and return to call on hold.
- Hold : End both calls.

4 When call mode is not in use

- Press : Voice commands activated.
- Hold : Voice commands deactivated.

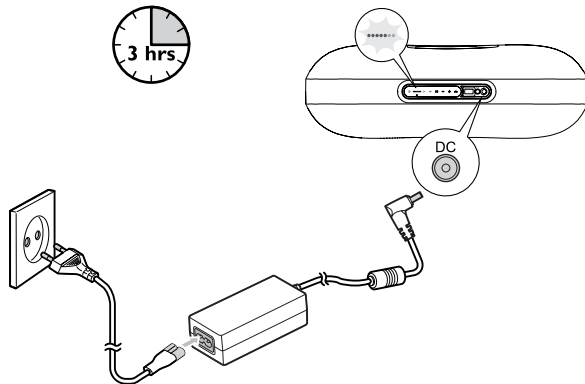

Battery level is indicated by the indicators on the pillow.

- 7 dots are alight: full battery or more than 75% capacity remaining.
- 5 dots are alight: less than 75% remaining.
- 3 dots are alight: less than 50% remaining.
- 1 dot are alight: less than 25% remaining.

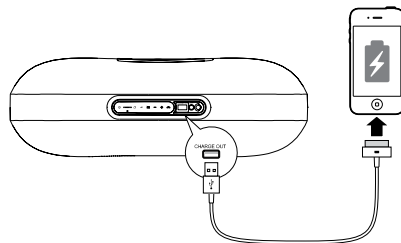

Note: For external device charging when Kushion Audio in Standby mode, please connect the adaptor and power supply.



KUSHION

