

Mini Keyboard User manual

Thank for selecting our Mini Keyboard! It is very convenient for you to enjoy.

Features:

- Compatibility Desktop PC、notebook PC compatible。
- Support USB1.1 and USB 2.0.
- Support operating system
Windows98/ME/2000/XP、 Mac OS 9.x etc.
- Mini Keyboard.

Battery installation

- 1.Press Mini keyboard bottom battery cover.
- 2.Put 2 pcs AAA battery.
- 3.Push the battery cover .

★ **Note:** Please change the new battery when keyboard green LED change to red LED.

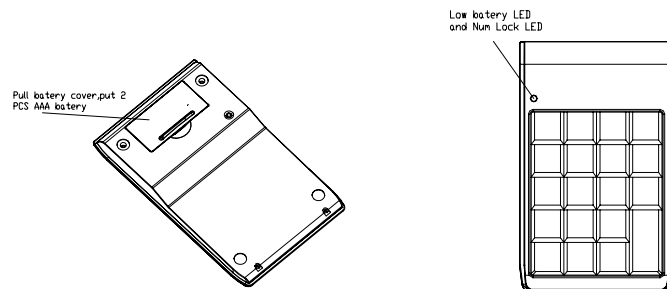

Connect ID instruction

1. First press receivers ID switch.
2. 2.Then press keyboard ID switch.

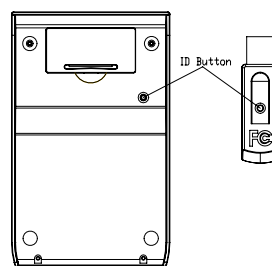

User instruction

- 1,Insert Number

When the keyboard green LED to light, it can use.

- 2.The direction input.

When the green LED light, the keyboard can use.

★ Attention :

When connect the keyboard, but the PC right side shows "can't identity

equipment" please Consult the dealer nearby.

Federal Communication Commission Interference Statement

1. This device complies with Part 15 of the FCC Rules. Operation is subject to the following two conditions:
 - (1) This device may not cause harmful interference, and
 - (2) This device must accept any interference received, including interference that may cause undesired operation.
2. Changes or modifications not expressly approved by the party responsible for compliance could void the user's authority to operate the equipment.

Note

Note: This equipment has been tested and found to comply with the limits for a Class B digital device, pursuant to part 15 of the FCC Rules. These limits are designed to provide reasonable protection against harmful interference in a residential installation. This equipment generates, uses and can radiate radio frequency energy and, if not installed and used in accordance with the instructions, may cause harmful interference to radio communications. However, there is no guarantee that interference will not occur in a particular installation. If this equipment does cause harmful interference to radio or television reception, which can be determined by turning the equipment off and on, the user is encouraged to try to correct the interference by one or more of the following measures:

- Reorient or relocate the receiving antenna.
- Increase the separation between the equipment and receiver.
- Connect the equipment into an outlet on a circuit different from that to which the receiver is connected.
- Consult the dealer or an experienced radio/TV technician for help.

*The equipment is to be supplied from an identified USB port complying with the requirements of Limited Power Source.