

OPERATING INSTRUCTIONS

Please read carefully before starting to operate.
It is recommended to operate the Road Shocker under the adult supervision.
Cannot play or race 2 cars together in the same frequency.

FEATURES

7 Functions—runs forward and backward, turns left and right, stops.

BATTERY REQUIREMENT

- 1) One "9V" battery for the transmitter.
- 2) One "6V" rechargeable Ni-Cd battery pack for the Road Shocker.
- 3) The battery, battery pack and charger included.

BATTERY INSTALLATION

(A) TRANSMITTER

- 1) Slide ON/OFF to OFF.
- 2) Press and pull the battery compartment cover in the direction of the arrow to remove it.
- 3) Put the "9V" battery in the compartment according to the polarity symbols (+ and -) marked inside.
- 4) Replace the battery door.

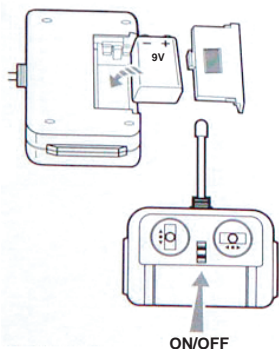

(B) ROAD SHOCKER

- 1) Make sure the battery pack has been fully charged.
- 2) Slide ON/OFF to OFF.
- 3) Use a coin to turn the battery door stopper and remove the battery door.
- 4) Insert the battery pack into the battery compartment.
- 5) Replace the battery door and use a coin to turn the stopper back.

HOW TO OPERATE

- 1) Slide ON/OFF on the bottom of the Road Shocker to ON.
- 2) Slide ON/OFF on the transmitter to ON.
- 3) Use the transmitter's levers to control the movement and direction of the Road Shocker.

Left Control Lever

Push forward to move forward.
Pull backward to move backward.
Release to stop.

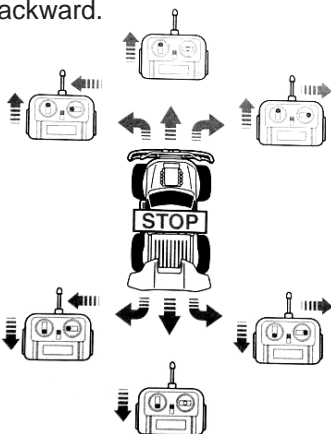

Right Control Lever

Push left to turn left.
Push right to turn right.
Release to go straight.

TRIM CONTROL SWITCH

Trim control switch is located on the underside of the Road Shocker between its front tires.

It is used to align the wheels of the Road Shocker for consistent turning and driving. Move the switch left or right until desired alignment is reached.

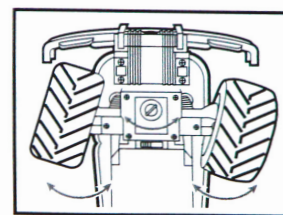

BATTERY CHARGING

NOTE: Follow the instruction on the 6V rechargeable Ni-Cd battery pack and charger system.

- 1) The 6V rechargeable Ni-Cd battery pack must be charged prior to use.
- 2) When charging the battery pack, plug the charger into a household outlet. Connect the charger with the battery pack.
- 3) 4 hours is all that required for fully charging the battery pack, charging the battery pack for more than 4 hours will not prolong the running time.
- 4) When the Road Shocker begins to move slowly or not at all, it's time to recharge the battery pack.
- 5) After use, the battery pack will be hot. Wait at least 10 minutes until it cools down before charging it. Recharging a hot battery pack will reduce its recharging life greatly.

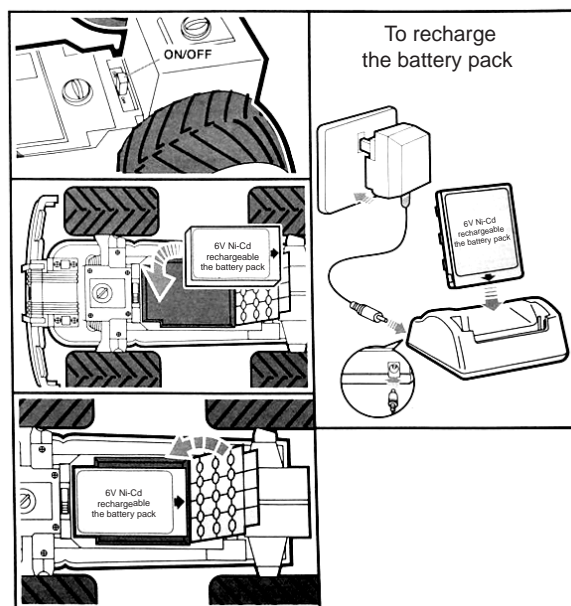

CAUTION

- Do not charge battery packs that show leakage or corrosion.
- Do not charge hot battery packs.
- Do not dispose battery packs of fire.
- Do not attempt to disassemble battery packs.

THE FCC WANTS YOU TO KNOW

NOTE: The manufacturer is not responsible for any radio or TV interference caused by unauthorized modifications to this equipment. Such modifications could void the User's authority to operate the equipment.

