

S2000 Pro

Active Monitor Speaker

User manual

Section 1: Important safety instruction

WARNING: To reduce risk of fire or electric shock, do not expose this apparatus to rain or moisture.

Thank you for purchasing Edifier S2000 Pro multimedia speakers. Please read this manual carefully before operating this system.



The lightning flash with arrowhead inside the triangle, is intended to alert the user to the presence of un-insulated dangerous voltage within the product's enclosure that may be of a sufficient magnitude to constitute a risk of electric shock to persons.

To prevent the risk of electric shock, do not remove cover (or back). No user-serviceable Parts inside. Refer servicing to qualified Service personnel only.

The exclamation point inside the triangle is intended to alert the user to the presence of important operating and maintenance (servicing) instructions in the literature accompanying the product.

1. Read these instructions.
2. Heed all warnings.
3. Follow all instructions.
4. Clean only with dry cloth.
5. Do not use this apparatus near water and never put this apparatus into liquids or allow liquids to drip or spill onto it.
6. Do not place appliance filled with water on this apparatus, such as vase; nor place any form of open fire such as lit candle.
7. Do not block any ventilation openings. Please leave enough space around the speakers to ensure good ventilation (the distance should be above 5cm)._Install in accordance with the manufacturer's instructions.
8. Do not place near any heat sources such as radiator, heat register, stove, or other apparatus (including amplifier) that produce heat.
9. Do not disregard the safety purpose of the polarized or grounding-type plug. A polarized plug has two blades with one wider than the other. A grounding type plug has two blades and a third grounding prong. The wide blade or the third prong is provided for your safety. If the provided plug does not fit into your outlet, consult an electrician for replacement of the outlet.
10. Protect the power cord from damage or getting pinched particularly at plugs, receptacles, and the point where they exit from the apparatus.
11. Only use attachments/accessories specified by the manufacturer.
12. Unplug this apparatus during lightning storms or when unused for long periods of time.
13. Refer all servicing to qualified service personnel. Servicing is required when the apparatus is damaged, such as power supply cord or plug, liquid spilled or objects fallen into the apparatus, the

apparatus has been exposed to rain or moisture, does not operate normally, or has been dropped.
14. The MAIN plug is used as the disconnecting devices, the disconnecting device shall remain readily operable.

15. The Maximum ambient temperature is **45°C / 113°F**

16. Do not use strong acid, strong alkali and other chemical solvents to clean the product surface. Please use neutral solvent or water to clean the product.



Use only with the cart, stand, tripod, bracket, or table specified by the manufacturer, or sold with the apparatus. When a cart is used, use caution when moving the cart/apparatus combination to avoid injury from tip-over.



Correct Disposal of this product. This marking indicates that this product should not be disposed with other household wastes throughout the EU. To prevent possible harm to the environment or human health from uncontrolled waste disposal, recycle it responsibly to promote the sustainable reuse of material resources. To return your used device, please use the return and collection systems or contact the retailer where the product was purchased. They can take this product for environmental safe recycling.



This equipment is a Class II or double insulated electrical appliance. It has been designed in such a way that it does not require a safety connection to electrical earth.

Section 2: In The Box

Box Contents:

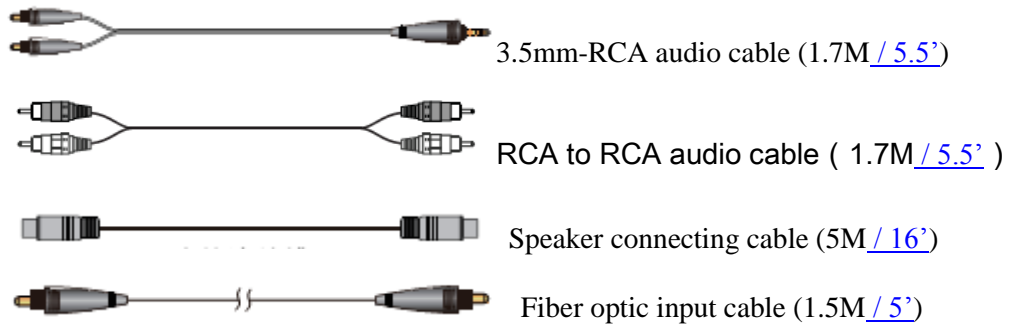

User manual

Section 3: Speaker Controls

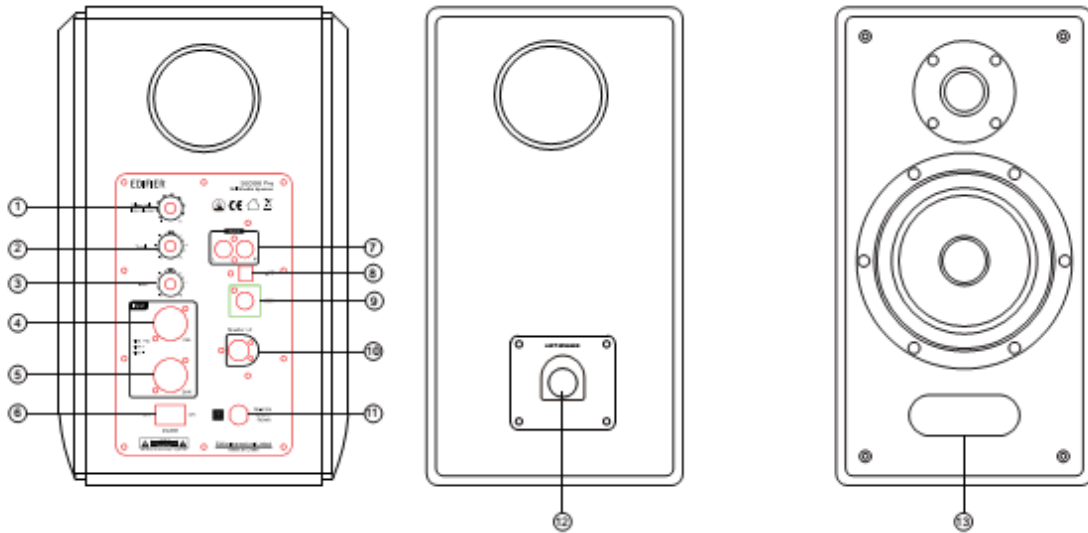

1. Master volume control/ input selection
[Press in to](#) navigate between audio [sources](#): BAL->AUX->Optical->Coaxial->Bluetooth.
Note: [Press and hold](#) the Master volume control to [disconnect](#) from [Bluetooth](#) devices
2. Treble trimmer
3. Bass trimmer
4. Left Channel of the Balanced
5. Right Channel of the Balanced
6. Power switch
7. Auxiliary input port
8. Optical input port
9. Coaxial input port
10. Connect to passive ([left](#)) speaker
11. Power cord
12. Connect to active ([right](#)) speaker
13. [Display screen](#)

Mode selection:

When switching to Monitor mode: [the icon on the display screen](#) blinks once

When switching to Dynamic mode: [the icon on the display screen](#) blinks twice

When switching to Classic mode: [the icon on the display screen](#) three times

When switching to Vocal mode: [the icon on the display screen](#) four times

Section 4: Remote Control

Remote control

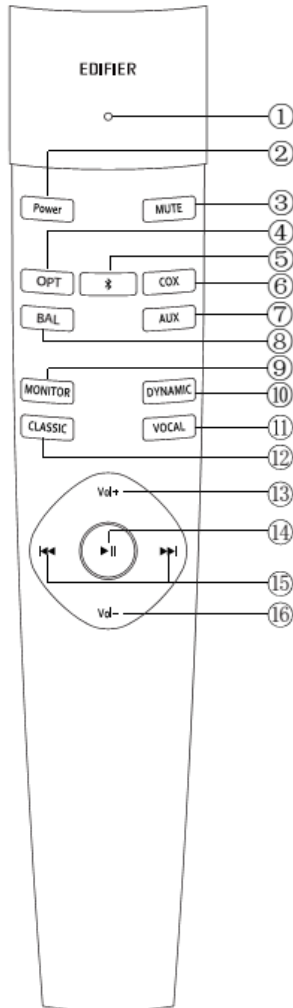

1. Remote control indicator
2. Power ON/OFF
3. Mute key
4. Optical input selector
5. Bluetooth input selector
6. Coaxial input selector
7. Auxiliary input selector
8. Balance input selector
9. Monitor mode
10. Dynamic mode
11. Vocal mode
12. Classic mode
13. Volume increase
14. Pause/play (for Bluetooth only)
15. Previous/next track (for Bluetooth only)
16. Volume decrease

Note:

CLASSIC Mode: reproduces a classic HIFI sound.

MONITOR Mode: features a flat audio response curve, for sound with no decoration.

DYNAMIC Mode: more punching, more dynamics.

VOCAL Mode: human voice emphasized, singer's position will be closer to listener.

Section 5: Battery Installation

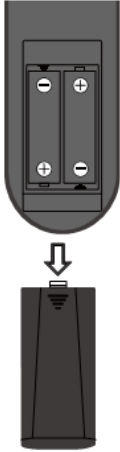

Note:

1. Install the batteries: take off the remote control battery cover in the direction of the arrow according to the illustration, and then correctly install two AAA batteries into the battery compartment.
2. The batteries normally last for about six months. Please replace the batteries when the remote control becomes insensitive.
3. Do not put the remote control in a place with high moisture or high temperature.
4. Do not put the remote control under direct sunlight, near a fire or in any high temperature environment.
5. Do not use old and new batteries together.
6. When the remote control is not in use for long periods, take out the batteries to prevent damage.

Section 6: Connections

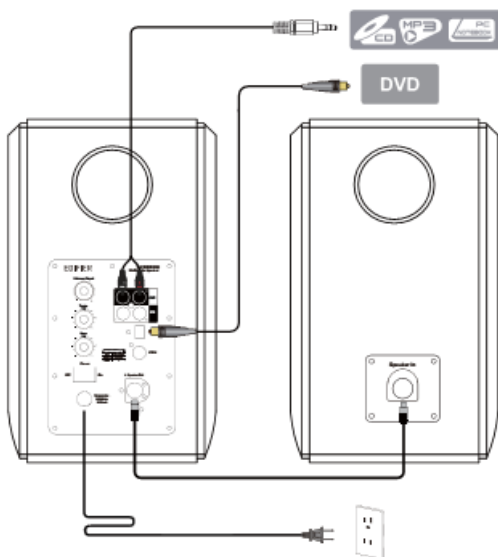

Section 7: Balance Input



1. Press the master volume control on the active speaker or press the “BAL” button on the remote control to select Balance input.
2. Using XLR compatible cable to connect audio source with the speaker.
3. Play [from](#) your device and adjust the volume accordingly.

Tips:

Benefit of using balanced XLR connection is that it can reduce noise and hum from the surroundings.

Section 8: AUX Input



1. Press the master volume control on the active speaker or press the “AUX” button on the remote control to select AUX input.
2. Using the included audio cable to connect audio sources (mobile phones, tablets etc) to your speaker.
3. Play [from](#) your device and adjust the volume accordingly.

Section 9: Optical and Coaxial Input

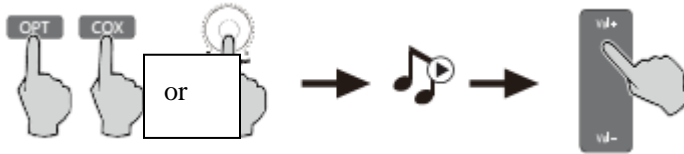

1. Press the master volume control on the active speaker or press the “OPT/COX” button on the remote control to select the optical/coaxial input.
2. Using optical or coaxial cable (optical cable included) to connect audio sources to your speaker.
3. Play [from](#) your devices and adjust the volume accordingly.

Note:

1. In optical and coaxial modes, only PCM signal with 44.1KHz/48KHz/96KHz/192KHz can be decoded.

Section 10: Bluetooth Input

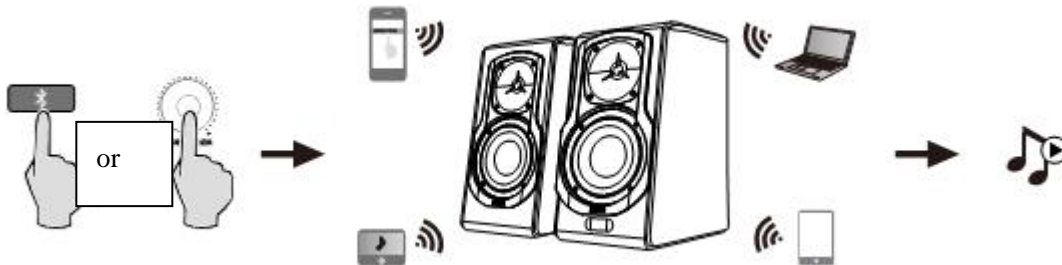

Bluetooth® Pairing

1. Turn on speaker and switch to Bluetooth mode by pressing the Bluetooth button on the remote control or press the master volume control on back panel of the active speaker.
2. Go to setup section on your source devices (mobile phones, tablets, etc.) and search for nearby Bluetooth devices, you will find “EDIFIER S2000 Pro” in the list.
3. Pair your device with “EDIFIER S2000 Pro”.
4. Play audio tracks on your device and adjust the volume to a desired level.

Other operations

- 5 After pairing, using the pair record on your source device to re-connect to the speaker;
- 6 Bluetooth of the product will be powered off after switching away from Bluetooth mode, so in other audio mode Bluetooth connection can not be made.
- 7 When switch to Bluetooth mode, the speaker will try to connect the last connected Bluetooth source device.
- 8 To disconnect Bluetooth, press and hold the master volume control for about 2 seconds.

Note:

1. Bluetooth connectivity and compatibility may be different among different source devices, depending on the software versions of source devices.
2. To enjoy the full Bluetooth functions of this product, please ensure your mobile device supports A2DP and AVRCP profile.
3. PIN code for connection is “0000” if needed.

Section 1: Specifications

Power output with limited distortion:	L/R (treble): 12W+12W L/R (mid-range and bass): 50W + 50W
Signal to noise ratio dB(A):	≥94 dB(A)
Noise level:	≤25dB(A)
Input sensitivity:	Balance input: 700 ± 50mV Auxiliary input: 600 ± 50mV Bluetooth input: 350 ± 50mFFs Optical input: 350 ± 50mFFs Coaxial input: 350 ± 50 mFFs
Rated sound frequency response range:	48Hz~20KHz
Audio input:	Balance/Auxiliary/Optical/Coaxial/Bluetooth
Tweeter unit:	Planar diaphragm tweeters
Mid-range and bass driver:	5.5 inch (148mm)

Section 12: Troubleshooting

Problem	Solution
No sound	Check if the power indicator light is ON
	Try to turn up the volume using either the master volume control or remote control.
	Ensure the audio cables are firmly connected and the input is set correctly on the speakers.
	Check if there is signal output from the audio source.
Cannot connect via Bluetooth	Make sure the speaker is switched to Bluetooth input, in other audio input mode Bluetooth can not be paired or connected. Disconnect from any Bluetooth device by press and hold the volume dial in Bluetooth mode, then try again.
	Effective Bluetooth transmission range is 10 meters, please make sure operation is within the range.
	Try another Bluetooth device for connection.
The S2000DB Pro does not turn on	Check if mains power is connected. or if the wall outlet is switched on.

If you want to find out more about EDIFIER, please visit our website at www.edifier.com
For Edifier warranty queries, please visit the relevant country page on our www.edifier.com and review the section Warranty Terms.

USA and Canada: service@edifier.ca

South America: Please visit www.edifier.com (English) or www.edifierla.com (Spanish/Portuguese)
for local contact information