

MP270  
Portable multimedia speaker  
User manual

Section 1 Important safety instructions

**WARNING:** To reduce the risk of fire or electric shock, do not expose this apparatus to rain or moisture.

1. Keep these instructions.
2. Follow all instructions.
3. Do not use this apparatus under water.
4. Clean only with dry cloth.
5. Do not install near any heat sources such as radiators, heat registers, stoves, or other apparatus (including amplifiers) that produce heat.
6. Only use attachments/accessories specified by the manufacturer.
7. Refer all servicing to qualified service personnel. Servicing is required when the apparatus has been damaged in any way, such as power-supply cord or plug is damaged, liquid has been spilled or objects have fallen into the apparatus, the apparatus has been exposed to rain or moisture, does not operate normally, or has been dropped.
8. Recommence to use the speaker under 0~35° C

Note: There is a built-in rechargeable lithium-ion battery in the speaker. Danger of explosion if disassemble the speaker. The speaker shall not be placed close to excessive heat such as fire or the like.



Use only with the cart, stand, tripod, bracket, or table specified by the manufacturer, or sold with the apparatus. When a cart is used, use caution when moving the cart/apparatus combination to avoid injury from tip-over.



Correct Disposal of this product. This marking indicates that this product should not be disposed with other household wastes throughout the EU. To prevent possible harm to the environment or human health from uncontrolled waste disposal, recycle it responsibly to promote the sustainable reuse of material resources. To return your used device, please use the return and collection systems or contact the retailer where the product was purchased. They can take this product for environmental safe recycling.

## Section 2 Box content



音响

Speaker



USB connecting cable



3.5mm audio cable



Portable bag



User manual

Note: the photos on this manual will have difference from the actual product, please prevail with the product at hand.

## Section 3 Charge and power on



Charge

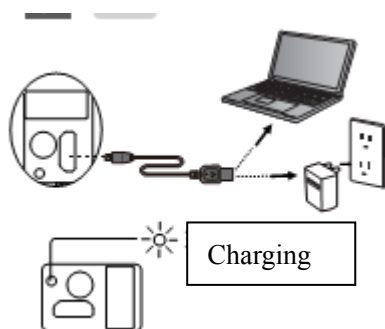

- Using the micro USB connecting cable, connect speaker to a USB power source on a computer or USB AC adapter (please use DC5V 2A adapter or above for charging when the speaker is charging and playing, to avoid power shortage).
- The charging indicator is lit when in charging, and it will be off when speaker is fully charged.
- Please fully charge the speaker before the first time use (about 7 hours).
- To ensure a full charge and for optimal audio playback, please fully charge the speaker once a month.
- When un-use the speaker, please turn off the speaker.

 Power on/ off



Power on: slide the power switch from OFF to ON, the indicator is on and speaker emits a prompt.

Power off: slide the power switch from ON to OFF.

 Warning: Need to properly handle the recharging battery for recycling use, and do not put the battery into fire to avoid explosion.

#### Section 4 Illustrations

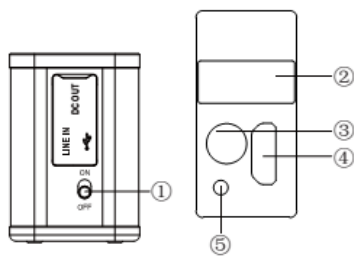

1. Power switch
2. USB connector port / DC output
3. AUX input port
4. micro USB port
5. Charging indicator

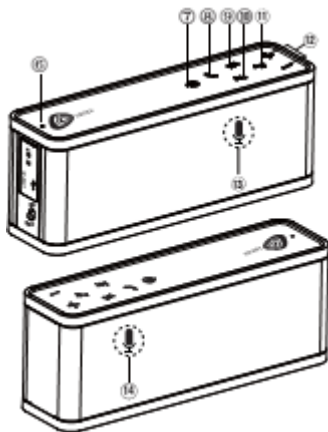





6. Function indicator
7. Audio source input selector
8. Bluetooth phone key
9. Next track/folder
10. Previous track/folder
11. Play/Pause
12. Volume up/down
13. Build-in microphone 1
14. Build-in microphone 2

Note:

1. Previous/next track are only available in Bluetooth and USB flash disk input mode (support AVRCP protocol).
2. Please make sure your device supports A2DP protocol.
3. The functions of build-in microphone 1 and build-in microphone 2 are the same.

## Section 5 Function indicator introductions

Function indicator introductions	
Blue	 Bluetooth mode
Orange	 USB audio mode
Red	 USB flash disk mode
Green	 LINE IN mode (3.5mm)

### Operational guide (Bluetooth mode)



### Pairing

1. Turn on speaker and switch to Bluetooth mode by pressing the  key until the function indicator turns to blue.
2. Go to setup section on your source devices (mobile phones, tablets, etc.) and search for nearby Bluetooth devices, you will find “EDIFIER MP270” in the list.
3. Pair your device with “EDIFIER MP270”. After pair successful, the speaker will emits a prompt and the LED indicator is steady lit.
4. Play audio tracks on your device and adjust the volume to a desired level.

### Note:

1. Bluetooth connectivity and compatibility may be different among different source devices, depending on the software versions of source devices.
3. PIN code for connection is “0000” if needed.

## Section 6 Operational guide (Bluetooth speaker phone)

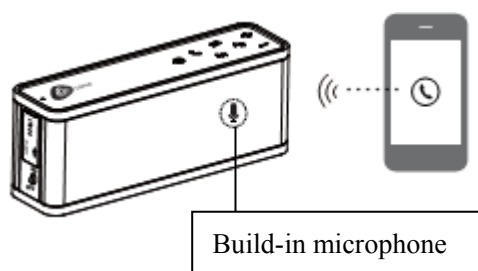

Coming a call when speaker is playing in Bluetooth mode:

- Press and hold this key to reject the call
- Press once this key to answer the call, press again to end the call
- When in answering, press and hold this key to switch the call to mobile phone



In Bluetooth mode, press & hold this key to disconnect Bluetooth connection.

## Operational guide (USB audio mode)



USB audio input

①



②



Connect the speaker to a USB connector port on PC with included micro USB connecting cable, after successfully connected, LED indicator is steady lit.

③



Playing the music on PC and adjust the volume to a comfortable level.

*Note:*

1. You may need to access your system settings on your computer to choose the “EDIFIER MP270” as your sound output device.
2. Under USB flash disk mode, the data reading time varies depending on the capacity of USB flash disk.
3. Some Bluetooth devices may vary depending on the software settings when connected to the unit.

## Section 7 Operational guide (USB flash disk mode)

### USB flash disk input

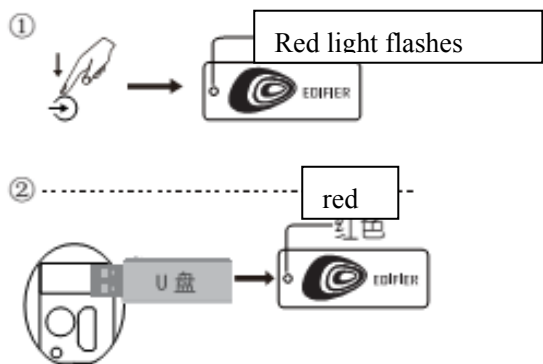

Insert the USB flash disk into the USB connector port on the speaker, after successfully connect, LED indicator will turn to red. And the speaker will automatically play the music on the USB flash disk (Max. is 32G).

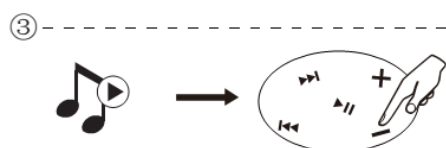

: Press once: previous/next track

Press and hold: previous/next folder

: Play/pause

## Operational guide (Spare power source output)

### Spare power source output

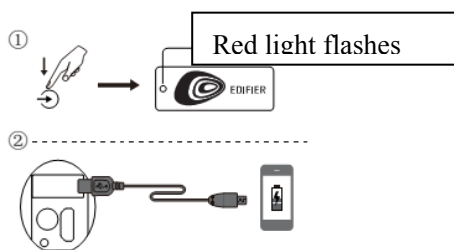

The USB output can be used to charge your mobile device up to 5V maximum 500mA DC using the included USB connecting cable (not included).

## Section 8 Operational guide (LINE IN mode)

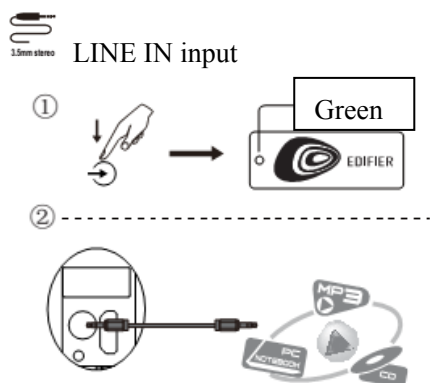

Connect LINE IN connector port to audio source (PC sound card, phones and etc.) with the included 3.5mm audio cable.



Play the music and adjust the volume to a comfortable level.

## Operational guide (NFC (Near Field Communication) function)

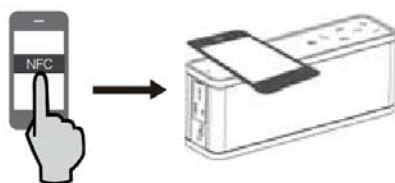

1. Turn on the speaker
2. Switch on the NFC function on your device
3. Put your device near the speaker. The Bluetooth connection will be made automatically by NFC. Your device is now connected to the speaker.
4. Play the music on your device and adjust the volume to a desired level.

### Disconnection:

You can switch off NFC function after the Bluetooth successfully connected, and the speaker will remain Bluetooth connection.

### Note:

1. The speaker will emit a prompt when power on, connect /disconnect Bluetooth and battery is in low level.
2. When adjust the volume to the maximum level, the speaker will be a rat-tat prompt when you continue to press the + key.
3. Battery use time (After fully charged, the speaker offers up to approximately 18 hours playing in Bluetooth mode) will vary depending on different audio source and volume settings.

### Section 9 Specification

Power output: L/R: 3.5W+3.5W

Signal to noise ratio: L/R:  $\geq 80$  dBA

Noise level: 25dBA

Input sensitivity: Line in:  $850 \text{ mV} \pm 50 \text{ mV}$

Bluetooth:  $830 \text{ mV} \pm 50 \text{ mV}$

Frequency response: 180 Hz ~20 KHz

Speaker unit: 1 3/4 inches (48mm)

Input type: Bluetooth/Line in/USB audio/USB flash disk

### Section 10 Troubleshooting

- Turn the EDIFIER MP270 off then on and reconnect to the audio source.
- Ensure Bluetooth function is enabled on your Bluetooth devices.
- Move the devices closer and retry the connection.
- Try another Bluetooth device for connection.
- Check for proper connections of the audio input cable.
- Check audio source to confirm that it is functioning properly.

Thank you for purchasing this EDIFIER product. For warranty information regarding your new purchase, please visit [www.edifier.com](http://www.edifier.com)

If you have any further questions or concerns regarding EDIFIER Products anywhere in the world. Please visit our website at: [www.edifier.com](http://www.edifier.com), or email EDIFIER Support for further assistance at: [main@edifier.com](mailto:main@edifier.com).

To contact us by phone: 1-877-EDIFIER (334-3437) in US and Canada; for South America: Please visit [www.edifier.com](http://www.edifier.com) (English) or [www.edifierla.com](http://www.edifierla.com); (Spanish/Portuguese) for detailed local contact information.



Manual Edition 1.0, March. 2017  
IB-200-M02700-01

Edifier International Ltd.,  
Suite 1610  
16th Floor, Tower II,  
Lippo Centre,  
89 Queensway  
Hong Kong

Tel: +852 2522 6989  
Fax: +852 2522 1989

[www.edifier-international.com](http://www.edifier-international.com)

© 2015 Edifier International Limited.

All rights reserved.

Printed in China

**NOTICE:**

For the need of technical improvement and system upgrade, information contained herein may be subject to change from time to time without prior notice.

Products of EDIFIER will be customized for different applications. Pictures and illustrations shown on this manual may be slightly different from actual product. If any difference is found, the actual product prevails.