

Electrolux Handling System

Pre-wash tables R>L for rack type

Some Electrolux dishwasher models can perform to their full potential, if combined with the Electrolux Handling System range. The modular system allows to design ergonomic and reliable solutions to handle, transport and sort kitchenware, obtaining the most effective flow in the dishwashing room. The Basic range has been specifically designed to create an ergonomic and efficient small dishwashing area to satisfy specific capacity and space requirements. The range consists of loading and unloading tables, prewash tables and sorting units.



865322

EASY TO INSTALL

- The tables are supplied knocked-down and are easy to assemble.
- As standard, the tables are to be secured to the dishwasher and fitted with one pair of legs at the other end.
- The stainless steel feet can be adjusted ± 50 mm to ensure that the tables drain back into the dishwasher.

EASY TO USE

- All models incorporate an overflow siphon.
- Model 865324 is equipped with a scraping hole.

- 700x500x300mm bowl is available upon request.
- Splashback included on all tables.
- Designed for 500x500 mm dishwashing racks.
- Can be equipped with useful accessories such as plain undershelves and pre-rinse units.

EASY TO CLEAN

- The deep anti-drip profiles are completely folded with a lower edge for safe and easy cleaning.
- All surfaces are smooth with a polished finish.

EASY TO MAINTAIN

- Constructed in AISI 304 stainless steel.
- Square 40x40 mm tubular legs in AISI 304 stainless steel.

EASY ON THE ENVIRONMENT

- 98% recyclable by weight.
- CFC free packaging.
- Developed and produced in ISO 9001 certified factory.



Electrolux

865322

865326

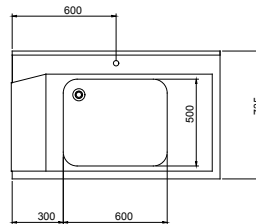
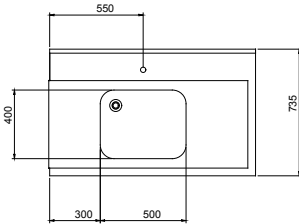
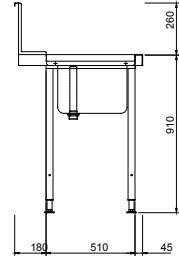
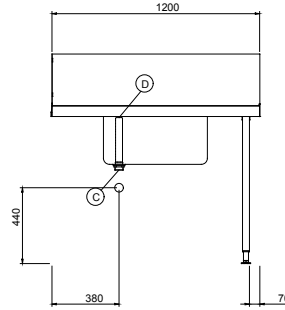
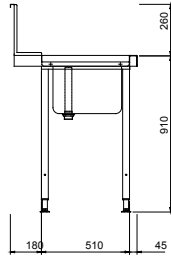
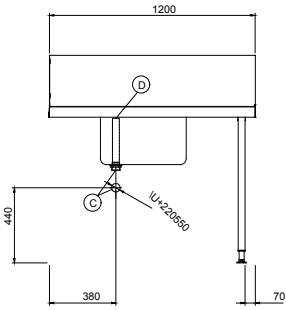

865324

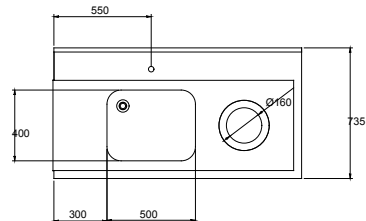
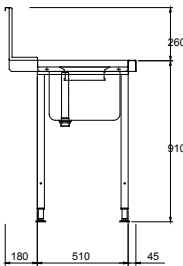
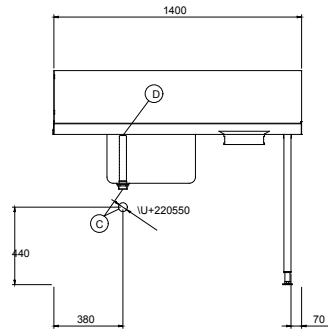

Electrolux Handling System

Pre-wash tables R>L for rack type

IIAA030

2009-06-19

Subject to change without notice

	BHRPTB12R 865322	BHRPT6B12R 865326	BHRPTB14R 865324
TECHNICAL DATA			
External dimensions - mm			
width	1200	1200	1400
depth	735	735	735
height	1170	1170	1170
Upstand dimensions - mm			
height	300	300	300
Basin dimensions	500x400x300h	600x500x300h	500x400x300h
Max. speed, m/min			
Net weight - kg.	8	8	12
INCLUDED ACCESSORIES			
SINGLE PLASTIC SYPHON 2"	1	1	1
ACCESSORIES			
BASKET GUIDE FOR DW TABLES W/BOWL 600MM		865370	
FLOOR FASTENING KIT FOR 2 SQUARE LEGS	865386	865386	865386
PRE-WASH SPRAY UNIT, SINGLE HOLE	855315	855315	855315
STRAINER BASKET FOR PREWASH TABLES	864068		864068
UNDERSHELF FOR DISHWASHING TABLES 1200MM	865352	865352	
UNDERSHELF FOR DISHWASHING TABLES 1400MM			865353