

Introduction

This User Guide provides basic instructions for the successful deployment of the BTE Baby Tag.

⚠ CAUTION! Reasonable effort was made to ensure that the specifications and other information in this guide are accurate and complete at the time of its publication. Nonetheless, all information contained in this document is subject to change at any time without prior notice. Modifications made to this equipment without the prior written consent of Elpas Solutions Ltd. will void all warranties including the pertinent regulatory certifications and as such revoke your authority to operate this product.

Furthermore If this equipment is modified, appropriate inspection and testing must be conducted to ensure continued safe use of the device. Elpas will provide upon request circuit diagrams. Component part lists, descriptions, calibration instructions or other information to assist service personnel to repair parts.

Product Description

The Elpas BTE Baby Tag is a small, baby friendly Active RFID Tag that provides wireless abduction and mother-baby mismatch deterrence from the time of birth until discharge.

The Tag employs a disposable, size-adjustable, tamper-resistant band made from hypo-allergenic materials to guard against unapproved attempts to detach the device from the protected baby.

The Tag transmits real-time indoor positioning data so that medical personnel can always know the whereabouts, movement and status of the protected infant.

For added security, the BTE Baby Tag also supports instantaneous near-exit location alerting to help guard against unauthorized departmental transfers and to assist in enforcing staff and family escort policies between hospital departments.

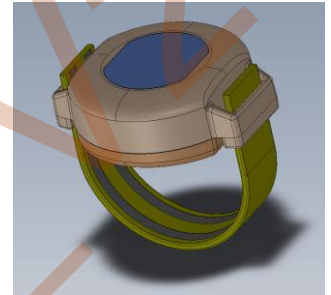

Tamper Transmissions

Transmission Rate: 3 RF transmissions (each transmission @ 2ms in duration), 250ms-400ms apart

Event Transmission Rates in LF Zones

Moving Tag

LF Response Time: Onboard LF receiver activates every 250 milliseconds to check if the tag is in a LF zone.

Transmission Rate: 3 RF transmissions (each transmission @ 2ms in duration), 250m-400ms apart.

Transmitted Message Type: RF Data Message includes ID code of LF Beacon.

Motionless Tag

LF Response Time: Onboard LF receiver polls every 60 seconds to check if the tag is in a LF zone.

Transmission Rate when in LF: 3 RF transmissions (each transmission @ 2ms in duration), 250m-400ms apart.

Transmitted Message Type: RF Data Message includes ID code of LF Beacon.

Important Usage & Safety Considerations

It is important that you read, understand, and follow the instructions in this user guide.

Should you have any questions, please contact your local Elpas support representative before proceeding.

Training: It is the responsibility of the System Installer to ensure that all appropriate staff members are suitably trained in the usage & care of the BTE Baby Tag.

Supervisory Alerts: should be configured in the Host RTLS Application to notify staff members that the BTE Baby Tag is:

- In a Low Battery Condition
- Not properly transmitting location and status data.

Additionally all Supervisory Alerts should be triggered periodically to ensure system integrity.

(Refer to your Eiris Configuration Guides for additional details.)

Tag Attachment

1. Insert the band into one of the tag slits and pull until approximately 1cm or 0.5inches of conductive material has been pulled through.
2. Pull back on the band so that the contact pins make a secure contact with the conducting sheath.

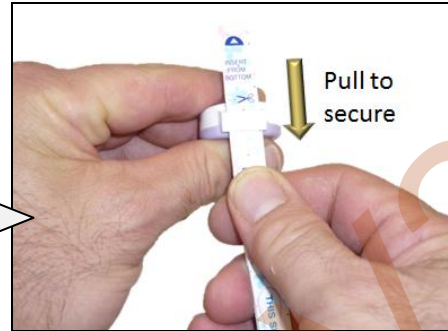
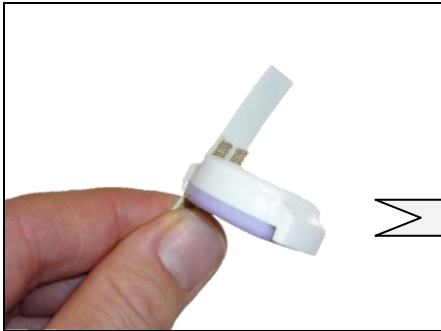

3. Using safety scissors cut the band so that the edge of the band is level with the face of the tag and trim the corners.
4. Insert second end into second leaving sufficient band length to slide the bracelet over the infant's heel.



5. Slide bracelet over foot and onto ankle with tag facing outwards with the cut band end towards the heel
6. Pull the exposed end until secure however be careful not to over-tighten the band. Confirm that the tag is snug enough to prevent removal over the baby's heel, yet loose enough to allow circulation.
7. Using safety scissors cut the band so that the edge of the band is level with the face of the tag and trim the corners

Band Tightening

Should the infant lose weight during his/her stay, the bracelet band may be shortened by pulling on one of the exposed ends. After the band is tightened, the excess band may be cut and corners trimmed.

Tag Removal

1. Use safety scissors to cut bracelet band.
2. Pull remaining band sections through slits from the top of the tag.

Note See Eiris system user guide for tag discharge procedure.

Cleaning & Disinfection Procedures

Use an appropriate antibacterial disinfectant such as Dispatch® Hospital Cleaner Disinfectant with Bleach from Caltech Industries (<http://www.caltechind.com>) to clean the Baby Tag.

Since 'Cleaning Procedures' may vary according to facility guidelines, thus the procedures given below are for illustrative purposes only:

Option 1 – Using Dispatch Disinfectant Spray

1. Lightly wet a disposable towel with Dispatch spray
2. Do not saturate the towel
3. Wipe the outer surfaces of the sensor
4. Next wipe the sensor with a dry disposable towel
5. Allow the sensor to air dry
6. Return the clean sensor to inventory or usage
7. Dispose of used towels per facility policies

Option 2 – Using Dispatch Disinfectant Towels

1. Open a new Dispatch pre-moistened towel
2. Wipe the outer surfaces of the sensor
3. Next wipe the sensor with a dry disposable towel
4. Allow the sensor to air dry
5. Return the clean sensor to inventory or usage
6. Dispose of used towels per facility policies

Product Specifications

Item	Description
RTLS Technologies	RF (433MHz) LF (125KHz)
RF Under LF	2 seconds; after 10 minutes returns to 10 seconds when in motion or 60 seconds when stationary
LF Sampling	Every 250ms
LF Timeout	Transmits burst of 3 non-LF messages when LF signal is not received for approximately 2 seconds
Supervision Events Band Connected (B2 up), Low Battery Band Disconnected / Tamper (B2 down) LF (Entry/Exit), Matching, Pairing	3 RF transmissions (each transmission @ 2ms in duration), 250m-400ms apart (user configurable).
Power Source	Two Internal 3V Lithium batteries (Type: CR2025)
Average Battery Life (Active 80% of the time)	2 years approximate
Red LED Status Indicator	Initial activation: Once for 3 seconds Low Battery: Flashes once every 10 seconds Entry/Exit LF zone, Band connected/disconnected: Flashes 3 times
Green LED Status Indicator	Positive mother/baby match result
Tag ID	Unique, factory-programmed ID
Construction	Nylon base & cap (IP-67)
Dimensions (H x W x D)	3.5 x 2.9 x 12cm (1.4 x 1.2 x 0.5 inches)
Weight	12 grams (0.4 ounces)
Storage Environment	Temp: -30°C to 70°C (-22°F to 159°F) Humidity: 100% non-condensing
Operating Temperature	Temp: -10°C to 70°C (14°F to 158°F) Humidity: 20% to 80% non-condensing
Management Software	Eiris V4.8 or higher (standard functionality) Elpas V4.8 or higher ((local mother baby matching functionality)
Regulatory	IC, FCC & CE compliant
Warranty	1 year limited (excluding battery)

* Anti-tamper detection requires the usage of the Mounting Clip (Elpas P/N: 5-ETC09001) to attach the Tag to the asset to be protected

Product Accessories

Part Number	Description
TBD	Disposable Tamper Detection Band

Elpas BTE Baby Tag – User Guide

FCC & IC Compliance Standards

This device (FCC# TBD and IC# TBD) complies with FCC Rules Part 15 and with Industry Canada license-exempt RSS standard(s). Operation is subject to two conditions: (1) This device may not cause harmful interference, and (2) this device must accept any interference that may be received or that may cause undesired operation.

For Industry Canada: Le présent appareil est conforme aux CNR d'Industrie Canada applicables aux appareils radio exempts de licence. L'exploitation est autorisée aux deux conditions suivantes : (1) l'appareil ne doit pas produire de brouillage, et (2) l'utilisateur de l'appareil doit accepter tout brouillage radioélectrique subi, même si le brouillage est susceptible d'en compromettre le fonctionnement.

Note: This equipment has been tested and found to comply with the limits for a Class B digital device, pursuant to part 15 of the FCC Rules. These limits are designed to provide reasonable protection against harmful interference in a residential installation. This equipment generates; uses and can radiate radio frequency energy and, if not installed and used in accordance with the instructions, may cause harmful interference to radio communications. However, there is no guarantee that interference will not occur in a particular installation.

If this equipment does cause harmful interference to radio or television reception, which can be determined by turning the equipment off and on the user is encouraged of:

- Reorient or relocate the receiving antenna.
- Increase the separation between the equipment and receiver.
- Connect the equipment into an outlet on a circuit different from that to which the receiver is connected.
- Consult the dealer or an experienced radio/TV technician for help

Changes or modifications to this equipment not expressly approved by the party responsible for compliance (Elpas Solutions Ltd.) could void the user's authority to operate the equipment.

This equipment complies with FCC and IC RF radiation exposure limits set forth for an uncontrolled environment.

Company Contact

Elpas, Inc.
Westford, Massachusetts (USA) - Tel: 1-800-223-0020

EU Declaration of Conformity

This equipment is in compliance with the essential requirements and other relevant provisions of Directive 1999/5/EC

Product Warranty

Elpas Solutions, Ltd. (Elpas or the Company), and its affiliates, warrants its products (hereinafter referred to as "the Product") to be free of defects in materials and workmanship under normal operating conditions and use for a period of one year from the date of shipment by Elpas. The Company's obligations shall be limited within the warranty period, at its option, to repair or to replace the defective Product or any defective component or part thereof. To exercise this warranty, the product must be returned to the manufacturer freight prepaid and insured.

This warranty does not apply to repairs or replacement caused by improper installation, Product misuse, failure to follow installation or operating instructions, alteration, abuse, accident, tampering, repair by anyone other than Elpas, external causes, and failure to perform required preventive maintenance. This warranty also does not apply to any products, accessories, or attachments used in conjunction with the Product, including batteries, which shall be covered solely by their own warranties, if any. Elpas shall not be liable for any damage or loss whatsoever, whether directly, indirectly, incidentally, consequentially or otherwise, resulting from a malfunction of the Product due to products, accessories, or attachments of others, including batteries, used in conjunction with the Product.

ELPAS MAKES NO EXPRESS WARRANTIES EXCEPT THOSE STATED IN THIS STATEMENT. ELPAS DISCLAIMS ALL OTHER WARRANTIES, EXPRESS OR IMPLIED, INCLUDING WITHOUT LIMITATION IMPLIED WARRANTIES OF MERCHANTABILITY AND FITNESS FOR A PARTICULAR PURPOSE. ELPAS'S SOLE RESPONSIBILITY FOR WARRANTY CLAIMS IS LIMITED TO REPAIR OR TO REPLACE AS SET FORTH IN THIS STATEMENT.

Elpas shall have no liability for any death, personal injury, property damage, or other loss whether direct, indirect, incidental, consequential, or otherwise, based on a claim that the Product failed to function. However, if Elpas is held liable, whether directly or indirectly, for any loss or damage arising under this limited warranty or otherwise, regardless of cause or origin, the company's maximum liability shall be limited to the purchase price of the Product, which shall be fixed as liquidated damages and not as a penalty, and shall be the complete and exclusive liability of Elpas.

Elpas shall not, under any circumstances whatsoever, be liable for any inaccuracy, error of judgment, default, or negligence of Elpas, its employees, officers, agents, or any other party, or of the purchaser or user, arising from any assistance or communication of any kind regarding the configuration, design, installation, or creation of security system involving the Product, that being the responsibility of the purchaser or user. If Elpas is unable to make such repair or replacement, the company's entire liability shall be limited to the cost of a reasonable substitute product. Elpas shall not be responsible for any dismantling, installation, reinstallation, purchasing, shipping, insurance, or any similar charges.

Elpas shall have no liability for any damages, including without limitation, any direct, indirect, incidental, special, or consequential damages, expenses, costs, profits, lost savings or earnings, or other damages arising out of the use of the Product or the removal, installation, reinstallation, repair or replacement of the Product or any related events. In the event that there is any liability against Elpas, such liability shall be limited to the purchase price of the Product which amount shall be fixed as liquidated damages.

The purchaser and user understand that this Product may be compromised or circumvented by intentional acts; that the Product will not in all cases prevent death, personal injury, property damage, or other loss resulting from burglary, robbery, fire or other causes; and that the Product will not in all cases provide adequate warning or protection. The purchaser and user also understand that a properly installed and maintained alarm may reduce the risk of events such as burglary, robbery, and fire without warning, but it is not insurance or a guarantee that such events will not occur or that there will be no death, personal injury, property damage, or other loss as a result of such events.

By purchasing the Product, the purchaser and user shall defend, indemnify and hold Elpas, its officers, directors, affiliates, subsidiaries, agents, servants, employees, and authorized representatives harmless from and against any and all claims, suits, costs, damages, and judgments incurred, claimed, or sustained whether for death, personal injury, property damage, or otherwise, because of or in any way related to the configuration, design, installation, or creation of a security system involving the Product, and the use, sale, distribution, and installation of the Product, including payment of any and all attorney's fees, costs, and expenses incurred as a result of any such events.

The purchaser or user should follow the Product installation and operation instructions and test the Product and the entire system at least once each week. For various reasons, including but not limited to changes in environmental conditions, electric, electronic, or electromagnetic disruptions, and tampering, the Product may not perform as expected. The purchaser and user are advised to take all necessary precautions for the protection and safety of persons and property.

This statement provides certain legal rights. Other rights may vary by state or country. Under certain circumstances, some states or countries may not allow exclusion or limitation of incidental or consequential damages or implied warranties, so the above exclusions may not apply under those circumstances and in those states or countries.

Elpas reserves the right to modify this statement at any time, in its sole discretion without notice to any purchaser or user. However, this statement shall not be modified or varied except by Elpas in writing, and Elpas does not authorize any single individual to act on its behalf to modify or vary this statement. Any questions about this statement should be directed to Elpas.



W.E.E.E. Product Recycling Declaration

For information regarding the recycling of this product you must contact the company from which you originally purchased it. If you are discarding this product and not returning it for repair then you must ensure that it is returned as identified by your supplier.

This product is not to be thrown away with everyday waste - Directive 2002/96/EC Waste Electrical and Electronic Equipment.