



Excellence in Compliance Testing

Certification Exhibit

**FCC ID: QZC-REXU
IC: 4557A-REXU**

**FCC Rule Part: 15.247
IC Radio Standards Specification: RSS-210**

ACS Project Number: 12-0259

**Manufacturer: Elster Solutions, LLC
Model: REXU**

Manual

REX® meter family installation instructions

General

This leaflet contains installation instructions for the solid-state, residential electricity meters in the REX family (referred to as "REX" within this IL) with the following form factors:

- self-contained: Forms 1S, 2S, and 12S
- transformer-rated: Forms 3S and 4S

All meters are calibrated and sealed before shipment. For proper installation, accuracy, and maximum life of the meters, use the following procedures.

⚠ WARNING

Use authorized utility procedures to install and service metering equipment. Dangerous voltages are present. Equipment damage, personal injury, or death can result if safety procedures are not followed.

⚠ WARNING

When using the REX meter with the internal service control switch, follow authorized utility procedures to reconnect electrical service. Property damage, personal injury, or death can result if proper safety precautions are not followed.

Installing the REX meter

1. Make sure the meter to be installed matches the service type (that is, form), current, capacity, voltage, and service socket.
2. Check the socket and verify that the wiring is correct. See "Internal Wiring Diagrams" on page 2 and "Installation Wiring Diagrams" on page 3 for wiring diagrams.
3. Make sure that the voltage disconnect or test link on the back of the meter is closed, if installed.
4. Line up the meter blades to the socket jaws and rock the meter into place. Make sure that the meter is in the upright position.
5. Make sure the LCD turns on and the energy use indicator flashes if load is present.
The LCD has two pulse arrows. The arrow pointing to the left indicates energy received; the arrow pointing to the right indicates energy delivered. For more information, see the technical manual for your meter.
6. Apply all seals and record any necessary information.

Internal wiring diagrams

▲ WARNING

Circuit closing devices must be used on current transformer secondaries. This applies to Form 3S and 4S meters. Dangerous voltages may be present if current transformer secondaries are open-circuited while the transformer is energized. Equipment damage, personal injury, or death can result if circuit-closing devices are not used.

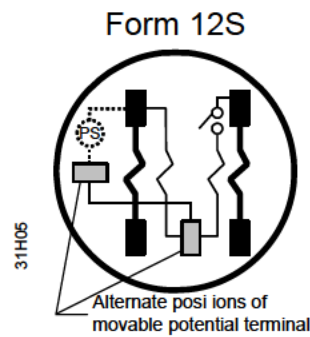
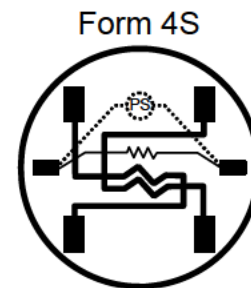
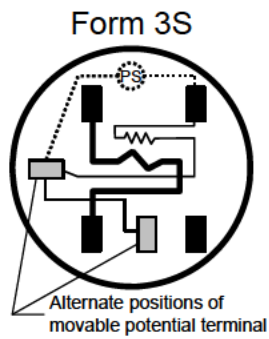
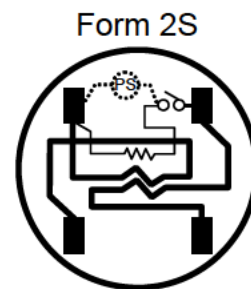
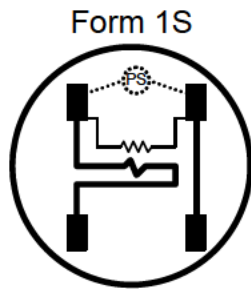

Installation wiring diagrams

▲ WARNING

Circuit closing devices must be used on current transformer secondaries. This applies to Forms 3S and 4S meters. Dangerous voltages are present if current transformer secondaries are open-circuited while the transformer is energized. Equipment damage, personal injury, or death can result if circuit-closing devices are not used.

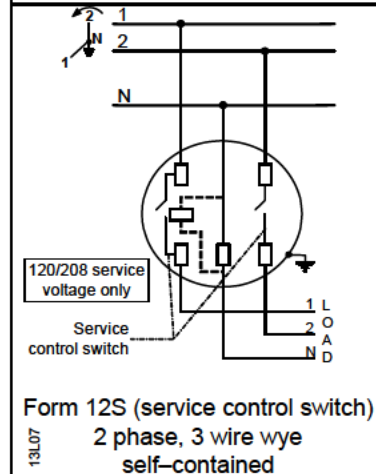
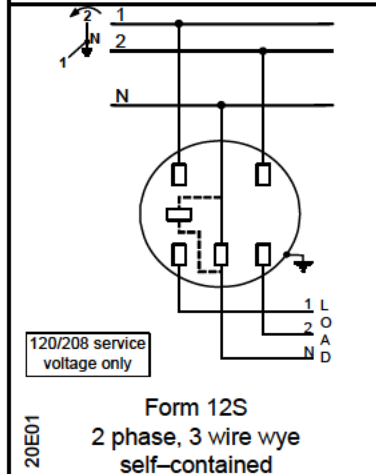
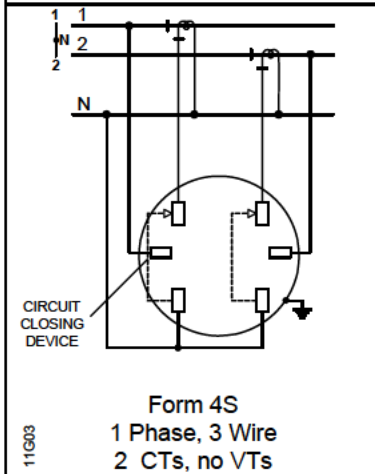
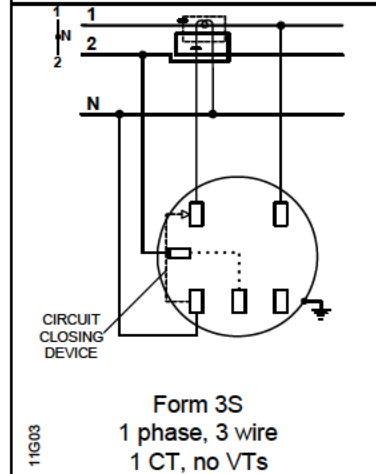
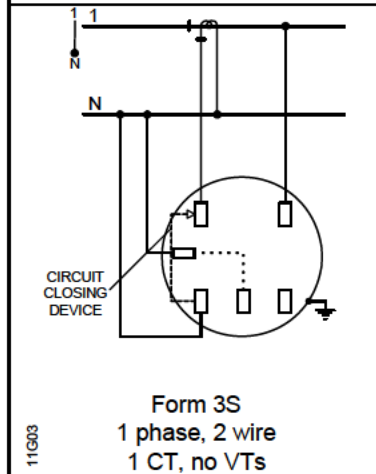
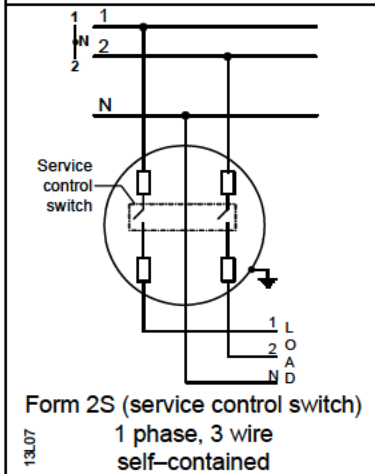
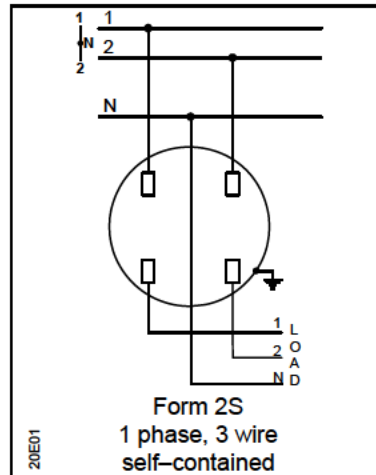
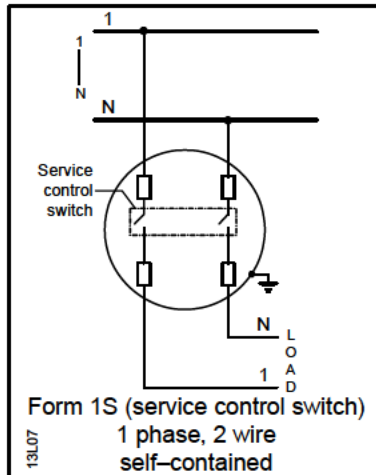
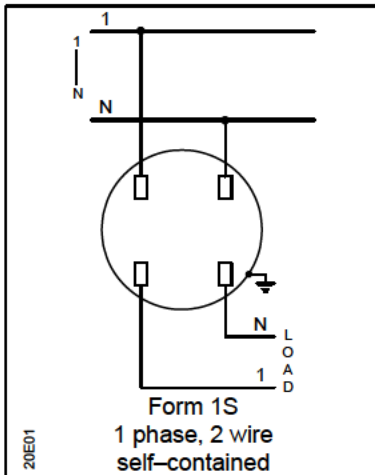

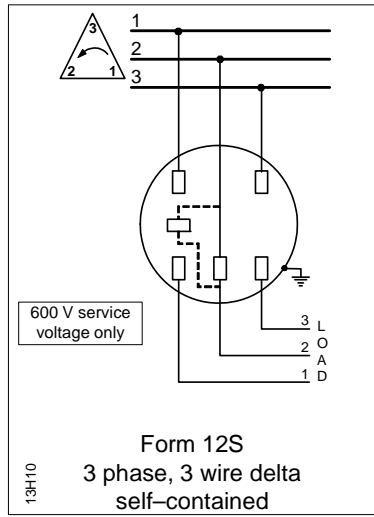

FCC and Industry Canada Compliance

User Information (Part 15.105)

This equipment has been tested and found to comply with the limits for a Class B digital device, pursuant to part 15 of the FCC Rules. These limits are designed to provide reasonable protection against harmful interference in a residential installation. This equipment generates, uses and can radiate radio frequency energy and, if not installed and used in accordance with the instructions, may cause harmful interference to radio communications. However, there is no guarantee that interference will not occur in a particular installation. If this equipment does cause harmful interference to radio or television reception, which can be determined by turning the equipment off and on, the user is encouraged to try to correct the interference by one or more of the following measures:

- reorient or relocate the receiving antenna
- increase the separation between the equipment and the receiver
- connect the equipment into an outlet on a circuit different from that to which the receiver is connected
- consult the dealer or an experienced radio/TV technician for help

If you experience trouble with this equipment, please use the Return Material Authorization (RMA) feature available at the Online Customer Services at www.elstersolutions.com. Do not attempt to repair this equipment yourself unless you are replacing the entire module.

Compliance Statement (Part 15.19)

This device complies with Part 15 of the FCC Rules and Class B digital apparatus requirements for ICES-003. Operation is subject to the following two conditions: (1) This device may not cause harmful interference, and (2) this device must accept any interference received, including interference that may cause undesired operation of the device.

This device complies with Industry Canada licence-exempt RSS standard(s). Operation is subject to the following two conditions: (1) this device may not cause interference, and (2) this device must accept any interference, including interference that may cause undesired operation of the device.

Énoncé de conformité

Cet appareil est conforme à la Partie 15 des règles de la FCC et aux exigences relatives aux appareils numériques de classe B conformément à l'avis sur la compatibilité électromagnétique ACEM-3. L'utilisation de cet appareil est soumise aux deux conditions suivantes : (1) Cet appareil ne doit pas provoquer d'interférences nocives et (2) cet appareil doit accepter toutes les interférences reçues notamment celles pouvant provoquer un fonctionnement intempestif de l'appareil.

Antenna Compliance

To reduce potential interference to other users, the antenna type and its gain should be so chosen that the equivalent isotropically radiated power (e.i.r.p.) is not more than permitted for successful communication. Under Industry Canada regulations, this radio transmitter may only operate using an antenna of a type and maximum (or lesser) gain approved for the transmitter by Industry Canada.

Conformément à la réglementation d'Industrie Canada, le présent émetteur radio peut fonctionner avec une antenne d'un type et d'un gain maximal (ou inférieur) approuvé pour l'émetteur par Industrie Canada. Dans le but de réduire les risques de brouillage radioélectrique à l'intention des autres utilisateurs, il faut choisir le type d'antenne et son gain de sorte que la puissance isotrope rayonnée équivalente (p.i.r.e.) ne dépasse pas l'intensité nécessaire à l'établissement d'une communication satisfaisante.

Warning (Part 15.21)

Changes or modifications not expressly approved by Elster could void the user's authority to operate the equipment.

RF Radiation Safety Guidelines

This equipment complies with FCC radiation exposure limits set forth for an uncontrolled environment. This equipment should be installed and operated to provide a separation distance of at least 20cm from all persons.

Collocation Statement

This transmitter must not be co-located or operating in conjunction with any other antenna or transmitter.

Notes:

Notes:

Notes:

DISCLAIMER OF WARRANTIES AND LIMITATIONS OF LIABILITY

There are no understandings, agreements, representations, or warranties either express or implied, including warranties of merchantability or fitness for a particular purpose, other than those specifically set out by any existing contract between the parties. Any such contract states the entire obligation of the seller. The contents of this document shall not become part of or modify any prior existing agreement, commitment, or relationship. The information, recommendations, descriptions, and safety notices in this document are based on Elster experience and judgment with respect to operation and maintenance of the described product. This information should not be considered as all-inclusive or covering all contingencies. If further information is required, Elster should be consulted.

No warranties, either expressed or implied, including warranties of fitness for a particular purpose or merchantability, or warranties arising from the course of dealing or usage of trade, are made regarding the information, recommendations, descriptions, warnings, and cautions contained herein.

In no event will Elster be responsible to the user in contract, in tort (including negligence), strict liability or otherwise for any special, indirect, incidental, or consequential damage or loss whatsoever, including but not limited to: damage or loss of use of equipment, cost of capital, loss of profits or revenues, or claims against the user by its customers resulting from the use of the information, recommendations, descriptions, and safety notices contained herein.

