



Basics

Contents

Welcome!	2
Prepare to Print	5
Choose Photos and Print	9
Do More With Your Photos	12
Save Your Photos and Print From a Computer	15
Print From a Digital Camera or Bluetooth Device	30
Replace Print Pack	33
Take PictureMate Pal With You	37
Set PictureMate Pal Preferences	38
Printer Care and Troubleshooting	40
Notices	50
Index	59

Welcome!

PictureMate® Pal is your easy-to-use, personal photo lab. Just insert a digital camera memory card and you're ready to print brilliant, long-lasting photos. Because PictureMate Pal is light and portable, you can print with it almost anywhere. Plus, your PictureMate Pal photos are archival; generations from now your PictureMate Pal prints will be as vibrant as they are today.

A Quick Introduction to the Digital Photography Process

With film cameras, the process was simple; buy film, take pictures, leave the film at the photo lab, and come back later for your photos and negatives. Since you had negatives, you could take them back later if you wanted reprints.

The digital process even simpler, and it gives you complete control. Just follow the basic steps shown on the right.



1. Review and Delete

After taking your photos, review them on your digital camera's screen. Delete the photos you don't want.

2. Print

Insert your camera's memory card in PictureMate Pal, choose your photos, and print.

3. Save

To preserve your digital photo files (just like film negatives), save them to your computer. Then you can reprint them any time.

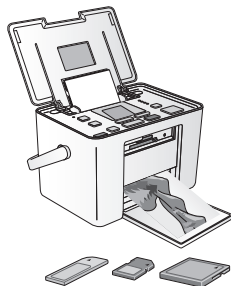

4. Clear the Memory Card

After you save your photo files, use your camera to delete them from your memory card (or format your memory card) so you have space for more photos.

Special Features

Printing with your PictureMate Pal becomes even easier with these special features:



You can select all your photos for printing by pressing  **Select All**, or select just the ones you want from the photo viewer screen. (See page 9.)



If you have a PictBridge®- or USB DIRECT-PRINT™-enabled camera, you can connect it to PictureMate Pal and control printing right from your camera. (See page 30.)



DPOF

If your camera supports DPOF™ (Digital Print Order Format), you can pre-select photos for printing while the memory card is still in your camera. Then, when you insert the card into PictureMate Pal, you just select a layout and press  **Print**. (See page 10.)



If you have a Bluetooth®-enabled PDA, cell phone, or computer, you can send photos wirelessly to PictureMate Pal for printing using the optional Epson® Bluetooth Photo Print Adapter. (See page 31.)

Note: PictureMate Pal also supports the Exif Print image enhancement standard that is built into many cameras.

Supported Photo Formats

Make sure your photos meet these requirements for printing with PictureMate Pal (without a computer):

- JPEG files or uncompressed TIFF files only
- Resolutions ranging from 80 × 80 to 9200 × 9200 pixels

PictureMate Pal recognizes and prints the first 999 photos on your memory card.

Where to Find Information



See your **Start Here** sheet to unpack, set up, and use your PictureMate Pal.



Basics (this book) explains how to print photos directly from your memory card. It also covers how to print from your computer and other devices, replace the PictureMate 200 Series Print Pack, and solve problems.



The on-screen **User's Guide** installed from the CD provides comprehensive information and instructions for using PictureMate Pal.

Where to Get a Print Pack and Accessories



The PictureMate 200 Series Print Pack has everything you need to print in one box: photo paper and a photo cartridge.

You can buy a Print Pack wherever PictureMate Pal is sold or from retailers that sell printer supplies.

The following Print Packs are available:

Print Pack contents	Part number	Supported PictureMate models
Glossy photo paper (150 sheets) and photo cartridge	T5846	PictureMate Pal and all other PictureMate 200 Series models
Matte photo paper (100 sheets) and photo cartridge	T5845-M	

You can also buy a Print Pack and other PictureMate Pal accessories from an Epson authorized reseller. To find the nearest reseller, call 800-GO-EPSON (800-463-7766). Or you can purchase online at **www.epsonstore.com** (U.S. sales) or **www.epson.ca** (Canadian sales).

Prepare to Print

Before you print with PictureMate Pal, you need to:

- Load paper (below)
- Insert your memory card (see page 6)

When you finish printing, you can remove your memory card. (See page 7.)

PictureMate Pal turns off its screen automatically to save power. See page 8 for details.

Loading Paper

Caution: Don't load plain paper; this may damage PictureMate Pal.

- 1 Move the handle to the back.

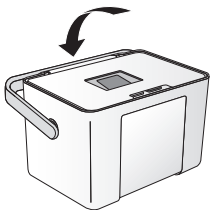

- 2 Open the paper support.

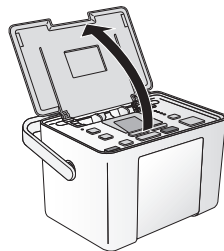

- 3 Firmly press the **Open** button to open the output tray.

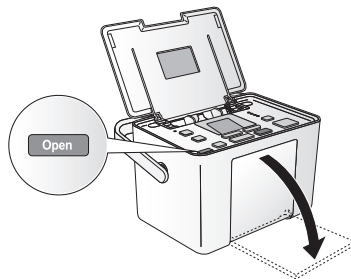

- 4** Slide the edge guides outward.

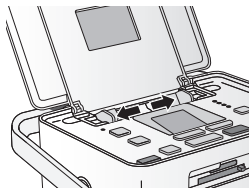

- 5** Create a stack of up to 20 sheets of paper and separate the sheets slightly by fanning them.
- 6** Place your paper into the slot between the edge guides with the glossy or whiter side up. Slide the edge guides inward slightly.

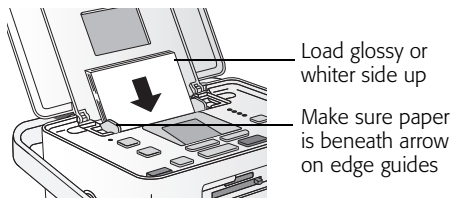

Note: Load a maximum of 20 sheets at a time. Load your paper glossy or whiter side up to prevent smearing.

- 7** Store any unused paper in the original package and keep it flat in a dry area to prevent curling.

Note: When you need more paper, order a PictureMate 200 Series Print Pack. See page 33 for more information.

Inserting Your Memory Card

- 1** Press the I/⏻ **On** button to turn on PictureMate Pal.
- 2** Press the **Open** button to open the output tray, if necessary.
- 3** Insert the memory card into the correct slot, as shown on the next page. Insert just one card at a time.
- 4** Push the card in carefully until it stops (it won't go in all the way).

Note: PictureMate Pal can't read multiple cards at once.

When the card is in, the memory card light comes on.

Top slot: Memory card light

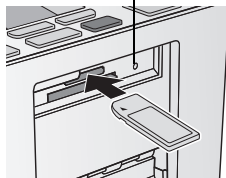

SD™ (Secure Digital) and SDHC™ (High Capacity)
miniSD™ * and miniSDHC *
microSD * and microSDHC *
MMC™ (MultiMediaCard™)
xD-Picture Card™
xD-Picture Card (Type M and Type H)
Sony Memory Stick® **
Memory Stick Duo™ *
Memory Stick PRO™
Memory Stick PRO Duo™ *
MagicGate™ Memory Stick **
MagicGate Memory Stick Duo™ *

Bottom slot:

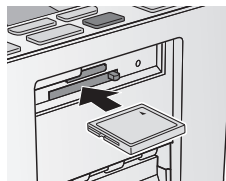

Microdrive™
CompactFlash® (Type I and II)

- * Requires adapter
- ** Maximum capacity 128MB

Now you are ready to choose your photos and layout, and start printing (see page 9).

Removing Your Memory Card

When you are ready to remove a memory card, first make sure the memory card light is not flashing.

Caution: Do not remove a card while the memory card light is flashing; you may lose photos on your card.

Top slot: Push in the card and release it, then pull it straight out of the slot.

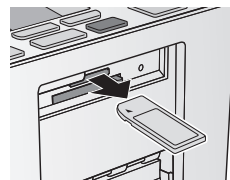

Bottom slot: Push in and release the card release button so it pops out. Then push in the button again to eject your card and pull it straight out of the slot.

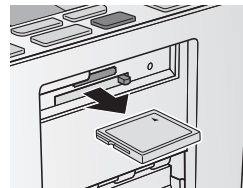

Saving Power

If you are not using PictureMate Pal, the screen goes dark after 13 minutes. Press any button to turn it back on.

Choose Photos and Print

PictureMate Pal's photo viewer screen makes it easy to select the photos you want to print.



You can:

- Print all the photos on your card (to the right)
- Select individual photos to print (see page 10)
- Pre-select photos to print from your camera, if your camera supports it (see page 10)

Note: You can also select a variety of layouts, include the date, enhance photos, and customize printing. See page 12 for information.

Printing All Photos

- 1 Press the  **Select All** button.
- 2 To print more than one copy of each photo, press ◀ or ▶ to select the number of copies (up to 999).

You can also press **Menu** to adjust settings or print a proof sheet containing thumbnail images of all your photos. See page 12 for details.

- 3 Press **Layout** to select the layout of your photos on the paper.
- 4 Press  **Print**.
- 5 Press ◀ or ▶ to review your photos on the Print Preview screen.

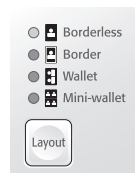

Note: To change the number of copies for individual photos, press **Cancel**, press ◀ or ▶ to select the photo, then press **OK** to increase or **Cancel** to decrease the number of copies. You cannot change individual layouts.

- 6 Press  **Print** to start printing.

Note: If you see a **Paper out** message, load more paper and press **OK** to continue. To cancel printing, press **Cancel**.

Printing Selected Photos

- 1 Press ◀ or ▶ to view the photo you want to print.
- 2 Press **OK** to select it.
- 3 To print more than one copy of the photo, press **OK** to increase the number of copies (up to 999). Press **Cancel** to decrease the number.
- 4 Repeat steps 1 through 3 for each photo you want to print.

You can also press **Menu** to adjust settings if necessary. See page 12 for details.

- 5 Press **Layout** to select the layout of your photos on the paper.
- 6 Press  **Print**.
- 7 Press ◀ or ▶ to review your selected photos on the Print Preview screen.

Note: You cannot change the layout while previewing your photos.

- 8 Press  **Print** to start printing.

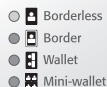

Printing Camera-Selected DPOF Photos

If your camera supports DPOF (Digital Print Order Format), you can use it to pre-select the photos and copies you want to print.

See your camera manual to choose photos for printing with DPOF, then insert your memory card in PictureMate Pal. You see this symbol on the screen:



- 1 Press **Layout** to select the layout of your photos on the paper.

You can also press **Menu** to adjust settings if necessary. See page 12 for details.

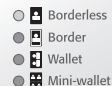

- 2 Press  **Print** to print your pre-selected photos.

Storing and Displaying Your PictureMate Pal Prints

Photos printed on PictureMate Pal photo paper are beautiful, long-lasting images. Follow these guidelines to make sure they will look great for generations.

Storing Your Prints

- Do not rub the printed side of the photo.
- Do not stack photos with the printed sides touching.

Displaying Your Prints

- Let prints sit for 24 hours before framing.
- To ensure prints will last as long as possible, display them under glass or in photo albums.
- Keep prints out of the sun to help prevent fading.

Storing Unused Paper

Return unused paper to the original package. Store paper flat to prevent curling, and keep it away from extreme temperatures, high humidity, and bright light.

Do More With Your Photos

By pressing the **Menu** or **Layout** button, you can:

- Choose from a variety of layouts (see below)
- Print in black and white or sepia (see page 13)
- Print photos with their date (see page 13)
- Enhance photos (see page 14)

Note: These features do not change your original digital photo file; they affect only your prints.

Choosing a Layout

Press the **Layout** button to print your photos at the full 4 x 6 size—with or without borders—or print 2 wallet or 4 mini-wallet size photos per sheet.

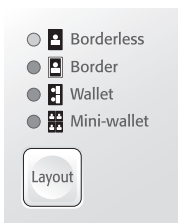

You can also print proof sheets containing thumbnail images of all your photos. Each proof sheet contains 20 images and their file names.

Note: Photos printed without borders are automatically expanded. To control the amount of expansion, see page 38.

- 1 Select the photos and number of copies you want to print.
- 2 To print 4 x 6-inch, wallet, or mini-wallet size photos, press **Layout** to select the layout of your photos on the paper.

To print a proof sheet of all your photos, press **Menu**, press ◀ or ▶ to highlight **Proof Sheet**, and press **OK**.
- 3 Press  **Print**.
- 4 Press ◀ or ▶ to review your selected photos on the Print Preview screen.

Note: If you are printing portrait-oriented photos, they may appear to be rotated, but they will print correctly.

- 5 Press  **Print** to start printing.

Printing Photos in Black and White or Sepia



You can print your photo in black and white or in a sepia tone even when the original is in color. Your original image is not changed.

Note: A sepia print has a brownish, old-fashioned photo look.

- 1 Select the photos and number of copies you want to print.
- 2 Press **Menu**.
- 3 Press ◀ or ▶ to highlight **Color Effect** and press **OK**.
- 4 Press ◀ or ▶ to select **Black & White** or **Sepia**, and press **OK**.



- 5 The color effect you select is applied to all photos until you go back to the Color Effect menu and select a different setting.

- 6 Press **OK**. You see your photo with the color effect you selected.
- 7 Press **Layout** to select the layout of your photos on the paper.
- 8 Press  **Print**.
- 9 Press ◀ or ▶ to review your selected photos on the Print Preview screen.
- 10 Press  **Print** to start printing.

Including the Date on Your Prints



You can include the date your photo was originally taken on the corner of your print.

Note: The date comes from your camera, not from the printer. If the date is incorrect, adjust the date setting on your camera. The date does not appear on photos printed using the Mini-wallet layout setting.

- 1 Select the photos and number of copies you want to print.
- 2 Press **Menu**.

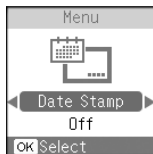
- 3 Press ◀ or ▶ to highlight **Date Stamp** and press **OK**.



- 4 Press ◀ or ▶ to select **On** and press **OK**. You see your photo and number of copies.
- 5 Press **Layout** to select the layout of your photos on the paper.
- 6 Press  **Print**.
- 7 Press ◀ or ▶ to review your selected photos on the Print Preview screen.
- 8 Press  **Print** to start printing.



Enhancing Photos

PictureMate Pal lets you correct photos that are too dark, too light, or backlit with the **PhotoEnhance™** feature. This setting improves your photos' colors and increases contrast and sharpness.

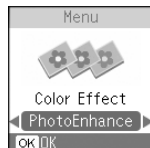
- 1 Select the photos and number of copies you want to print.
- 2 Press **Menu**.
- 3 Press ◀ or ▶ to highlight **Color Effect** and press **OK**.
- 4 Press ◀ or ▶ to select **PhotoEnhance** and press **OK**.



Note: If you see a color cast in the gray areas of color photos, select **None** as the Color Effect setting. Depending on your photo, you may get different results using PhotoEnhance in your computer printing software.

- 5 Press **Layout** to select the layout of your photos on the paper.
- 6 Press  **Print**.
- 7 Press ◀ or ▶ to review your selected photos on the Print Preview screen.
- 8 Press  **Print** to start printing.

Save Your Photos and Print From a Computer

To use PictureMate Pal with your computer, you must first:

- Install the PictureMate Pal software on your computer from the PictureMate Pal CD as described here.
- Connect PictureMate Pal to your computer with a USB cable. If you don't have a USB cable, you can buy one from your local computer dealer or from Epson.



Once your software is installed and PictureMate Pal is connected to your computer, you can:

- Save photos to your computer (see page 20)
- Print photos from your computer on PictureMate Pal (see page 20)

Tip: Periodically, it's a good idea to check Epson's support website at epson.com/support for free updates to your PictureMate Pal printer software. Download instructions are posted for your convenience.

Installing Software and Connecting PictureMate Pal

DO NOT connect PictureMate Pal to your computer before installing the software.

REMOVE your memory card from PictureMate Pal before you begin.

Follow the installation steps for your computer:

- Windows (below)
- Macintosh (page 18)

Note: If you have problems installing the software, see page 45.

Installing Software for Windows

- 1 Make sure PictureMate Pal is **NOT** connected to your computer and does **NOT** have a memory card inserted in it.
- 2 Press the I/⏻ **On** button to turn on PictureMate Pal.
- 3 Turn on your computer.

- 4 After Windows starts up, insert the PictureMate Pal CD in your CD-ROM or DVD drive.
- 5 With Windows Vista, you see this screen



Click **Run Esetup.exe**, then click **Continue** at the User Account Control screen.

- 6 After a moment, you see this screen:



Click **Next**.

Note: If you see a screen like this one, click **Cancel** and disconnect PictureMate Pal from your computer. Then turn off your computer and begin again at step 3.



- 7 Read the license agreement screen and click **Agree**. You see this screen:

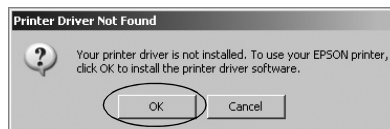

- 8** Click **OK**. After a moment, you see this screen:

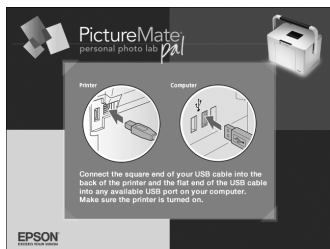

- 9** Connect the USB cable to any open USB port on your computer. Then connect the other end to the  USB port on the back of PictureMate Pal.

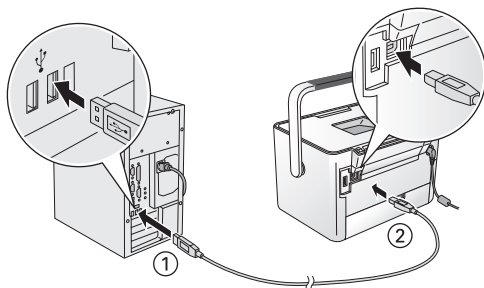

The installer installs your PictureMate Pal software.

Note: If you see a screen like this one, remove your memory card and click the **X** in the window to close it.



- 10** When you see the screen below, click **No** if you have another printer connected to your computer.

If PictureMate Pal is your only printer, click **Yes**.

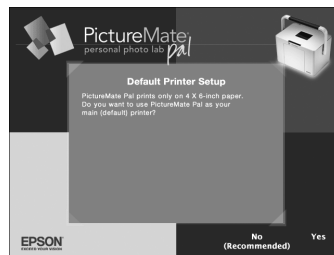

- 11 When you see a message that your printer driver is installed, click **Next**. Your on-screen *User's Guide* is installed.
- 12 After a moment, you see this screen:

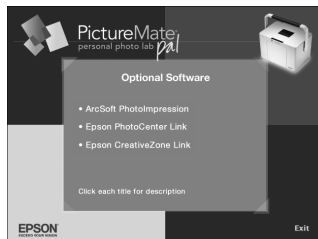

Follow the on-screen instructions to install the optional software.

- 13 When you're finished, click **Exit**. You see the registration screen.
- 14 Follow the on-screen instructions to register PictureMate Pal.
- 15 Remove the CD and restart your computer.

Now you can:

- Save photos to your computer (see page 20)
- Print photos from your computer on PictureMate Pal (see page 20)

Installing Software for Macintosh

- 1 Make sure PictureMate Pal does **NOT** have a memory card inserted in it.
- 2 Connect the USB cable to any open USB port on your Macintosh. Then connect the other end to the  USB port on the back of PictureMate Pal.

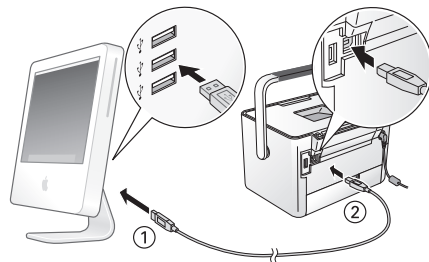

- 3 Press the I/⏻ **On** button to turn on PictureMate Pal.

- 4 Turn on your Macintosh.
- 5 After the Macintosh starts up, insert the PictureMate Pal CD in your CD-ROM or DVD drive.
- 6 Double-click the **PictureMate** CD icon to open it, then double-click the **PictureMate** icon. You see a screen reminding you to connect PictureMate Pal.
- 7 Click **Next**.
- 8 Read the license agreement and click **Agree**.
- 9 Click **Install Printer Driver**, then follow the on-screen instructions to install the driver.

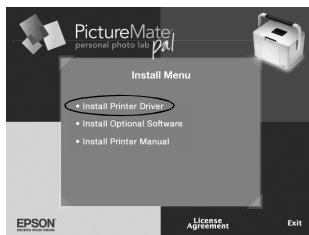

- 10 When you return to the Install Menu, click **Install Optional Software**.

- 11 Follow the on-screen instructions to install the optional software.

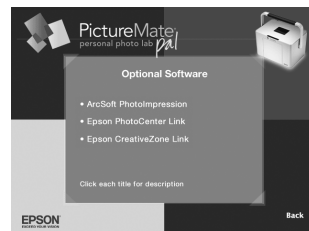

- 12 When you return to the Optional Software menu, click **Back**.
- 13 At the Install Menu, click **Install Printer Manual** to install your on-screen *User's Guide*.
- 14 When you're finished, click **Exit**. You see the registration screen.
- 15 Follow the on-screen instructions to register PictureMate Pal.
- 16 Remove the CD and restart your Macintosh.
- 17 To select PictureMate Pal as your printer, open the **Applications > Utilities** folder and double-click **Printer Setup Utility (Print Center in OS X 10.2)**.

18 Click **Add**.

19 In OS X 10.4, select **PictureMate PM 200**. (In OS X 10.2 or 10.3, select **EPSON USB** at the top and **PictureMate PM 200** below.)

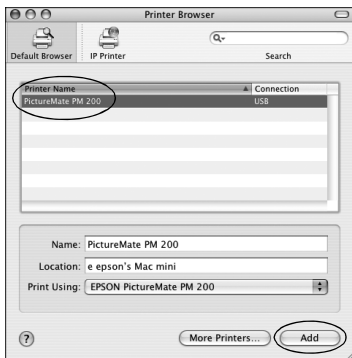

20 Click **Add**, then quit the Printer Setup Utility (or Print Center).

Now you can:

- Save photos to your Macintosh
- Print photos from your Macintosh on PictureMate Pal

Saving Photos to a Computer

You can connect PictureMate Pal to your computer and view, copy, or print files on the memory card as if it were a drive on your computer. You can even copy files from your computer to the memory card.

Make sure you've installed your software and connected PictureMate Pal to your computer. Then double-click the **PictureMate Pal User's Guide** icon on your computer screen to view your on-screen *User's Guide*. It gives for instructions on saving photos to your computer and vice-versa.

Printing From a Computer

Follow these basic printing instructions for your computer:

- Windows (see page 21)
- Macintosh (see page 27)

For instructions on printing using ArcSoft® PhotolImpression™, see your on-screen *User's Guide*.

Printing From a Windows Computer

You can print photos from an imaging application, the Windows Photo Gallery in Windows Vista (below), or the Picture and Fax Viewer in Windows XP (page 23).

Printing With the Windows Vista Photo Gallery

- 1 Locate the photo you want to print on your computer.
- 2 Right-click the photo, highlight **Open With**, and select **Windows Photo Gallery**.



- 3 Click the **Print** icon at the top of the screen, then select **Print** from the drop-down menu that appears.

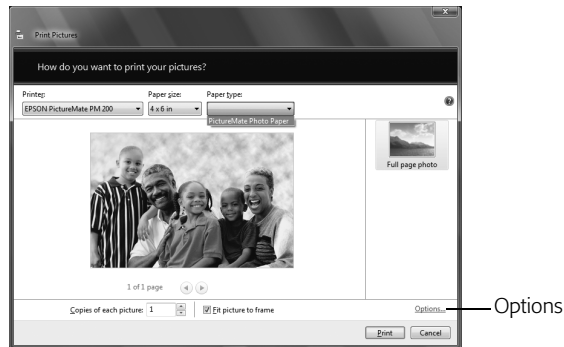

- 4 Make sure your printer is selected, then choose **PictureMate Photo Paper** as the Paper type setting. (**4 × 6 in** is automatically selected as the Paper size setting.)
- 5 Click **Options** in the lower right corner of the screen and select **Printer Properties**.

You see the printer settings window:



Sample photo

- You can change the Color Option and see the effects on the sample photo (the changes don't affect your original).

Auto Correction improves the quality of photos that are too dark or have a color cast.

Sepia changes the colors to brown for an old-fashioned look.

Black & White changes color photos to black and white.

- If your photo was taken with a digital camera, select **Digital Camera Correction** to minimize common digital flaws.
- Select **Enhance Fine Details** to bring out the fine details of a particularly intricate photo (printing may be slower).
- Select **Print Preview** to see what your photo will look like before you print.
- Select the number of copies you want to print.

Tip: For more information about printer settings, click Help.

- 7** Click **OK**.

6 Choose from the following settings:

- Select **Borderless** to print a photo without borders. Select **Borders** to print with a white border all around.
- Borderless prints are automatically expanded. If too much of your photo edges are cut off, set the Expansion slider to **Min**. If you see a white edge on your photo, select **Mid** or **Max**.

- 8** When you return to the Windows Photo Gallery, click **Print** to start printing.

During printing, this window appears on your computer screen showing the progress of your print job. You can cancel, pause, or resume printing, and view your Print Pack status.

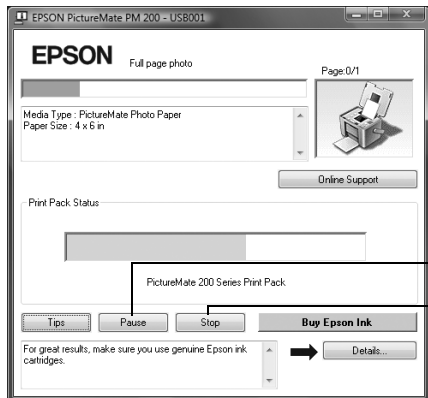

Printing With the Windows XP Picture and Fax Viewer

- 1** Locate the photo you want to print on your computer.
- 2** Right-click the photo, highlight **Open With**, and select **Windows Picture and Fax Viewer**.



- 3** Click the  Print icon at the bottom of the screen.

4 Click Next.



5 Select the photo(s) you want to print and click Next.

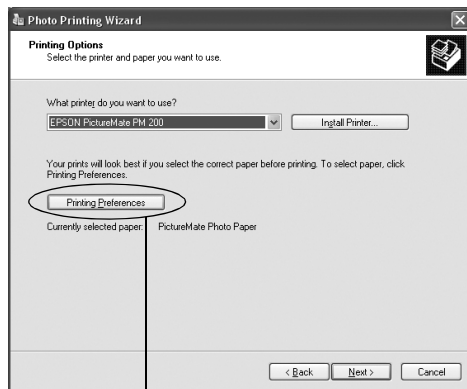

Printing Preferences

6 Select EPSON PictureMate PM 200 and click Printing Preferences.

You see the printer settings window:



Sample image

- You can change the Color Option and see the effects on the sample photo (the changes don't affect your original).

Auto Correction improves the quality of photos that are too dark or have a color cast.

Sepia changes the colors to brown for an old-fashioned look.

Black & White changes a color photo to black and white.

- If your photo was taken with a digital camera, select **Digital Camera Correction** to minimize common digital flaws.
- Select **Enhance Fine Details** to bring out the fine details of a particularly intricate photo (printing may be slower).
- Select **Print Preview** to see what your photo will look like before you print.
- Select the number of copies you want to print.

Tip: For more information about printer settings, click **Help**.

- 8 Click **OK**.

7 Choose from the following settings:

- Select **Borderless** to print a photo without borders. Select **Borders** to print with a white border all around.
- Borderless prints are automatically expanded. If too much of your photo edges are cut off, set the Expansion slider to **Min**. If you see a white edge on your photo, select **Mid** or **Max**.

9 At the Photo Printing Wizard screen, click **Next**.

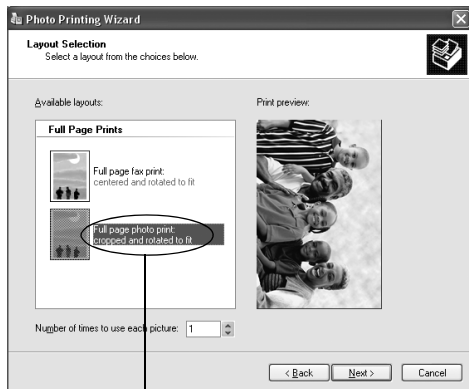

Full page photo print

10 Select **Full page photo print** and click **Next**.

During printing, this window appears on your computer screen showing the progress of your print job. You can cancel, pause, or resume printing, and view your Print Pack status.

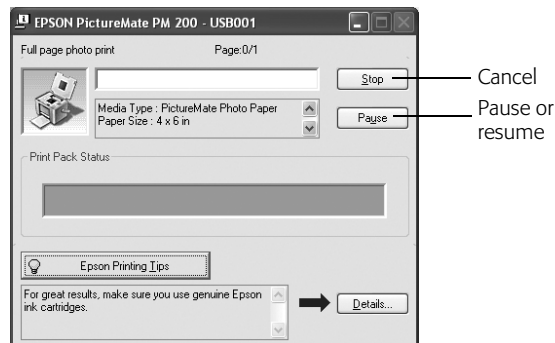

Printing From a Macintosh

You can print your photos from any Macintosh imaging application.

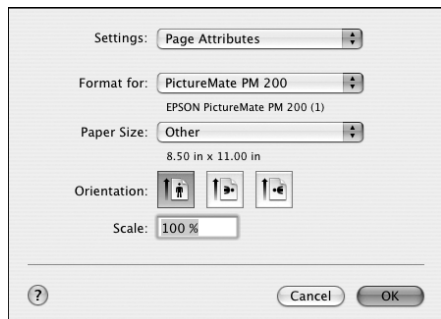

- 1 Start your print program and open the photo you want to print.
- 2 From the File menu, select **Page Setup**.



- 3 Select **PictureMate PM 200** from the Format for menu.

- 4 Open the Paper Size menu and place your cursor on the **4 x 6 in** option. You see extended options:



- Select **4 x 6 in (Borderless)** to print without any borders.
 - Select **4 x 6 in (Borders)** to print with white borders all around.
- 5 Select the direction you want your photo to print ( for portrait,  for landscape facing right, or  for landscape facing left) as the Orientation.
 - 6 Click **OK**.
 - 7 Select **Print** from the File menu.

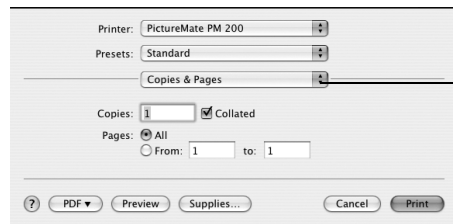

Select Print Settings

8 Select **Print Settings** from the pop-up menu.

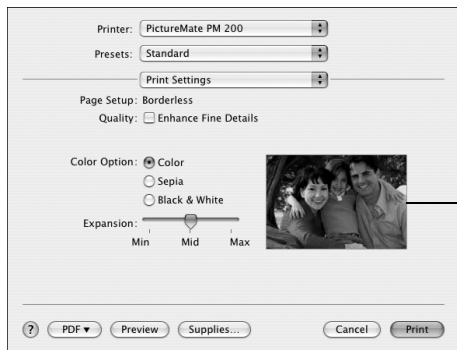

Sample
image

Tip: For more information about printer settings, click ?.

9 Choose from the following settings:

- Select **Enhance Fine Details** to bring out the fine details of a particularly intricate photo (printing may be slower).
- You can change the Color Option and see the effects on the sample photo (the changes don't affect your original).

Sepia changes the colors to brown for an old-fashioned look.

Black & White changes a color photo to black and white.

- Borderless prints are automatically expanded. If too much of your photos edges are cut off, set the Expansion slider to **Min**. If you see a white edge on your photo, select **Mid** or **Max**.

Note: iPhoto® expands two sides of an image to the maximum print area, so you may see small borders in iPhoto prints.

10 You can also choose other options in the pop-up menu, including:

- **Copies & Pages**, to select the number of copies or a page range
- **Summary**, to view a list of all your selections

11 Click **Print**.

12 To monitor the progress of your print job, click the  **PictureMate PM 200** or **Print Center** icon when it appears in the dock.

If you clicked the Print Center icon, double-click **PictureMate PM 200**.



13 From this window, you can do the following:

- To cancel printing, click the print job and click **Delete**.
- To pause printing, click the print job and click **Hold**.
- To resume printing, click a print job marked "Hold" and click **Resume**.
- If multiple print jobs are listed and you want one to print before the other(s), select the job and click the **Status** arrow to move it up.

14 When you're finished, exit the PictureMate PM 200 or Print Center program.

Print From a Digital Camera or Bluetooth Device

PictureMate Pal can print photos stored on a:

- PictBridge- or USB DIRECT-PRINT-enabled digital camera (below)
- Bluetooth-enabled device (requires an optional Bluetooth Photo Print adapter. See page 31)

Printing From a Camera

You can connect a digital camera that supports PictBridge or USB DIRECT-PRINT printing to PictureMate Pal and use the camera to control printing. (Check your camera manual to see if it supports PictBridge or USB DIRECT-PRINT. A cable may not be included with your camera.)

- 1** Make sure PictureMate Pal is on but not printing.
- 2** Make sure there are no memory cards in PictureMate Pal's slots.

Note: You must remove your memory card or the printer will read photos from the card, not from a camera.

- 3** Turn on your camera.
- 4** Connect your camera's USB cable to your camera and the  port on the back of PictureMate Pal.

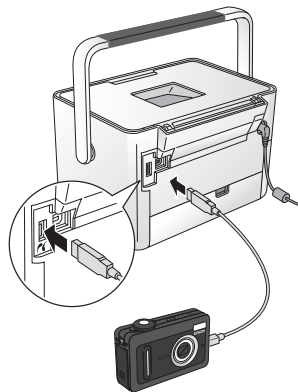

- 5** Use your camera's controls to select and print photos on PictureMate Pal. (See your camera manual for instructions.)

- 6 When you are finished, disconnect your camera from PictureMate Pal before inserting a memory card in PictureMate Pal.

Printing Wirelessly From a Bluetooth Device



You can print photos wirelessly from your Bluetooth-enabled PDA, cell phone, or computer when you use the optional Epson Bluetooth Photo Print Adapter. The adapter (part# C12C824383) is available from your local reseller or Epson (see page 33).

Note: While PictureMate Pal complies with the Bluetooth specification, it is not guaranteed to work with all devices enabled with Bluetooth wireless technology. Make sure your photos meet the requirements listed on page 3.

- 1 Make sure PictureMate Pal is on but not printing.

Caution: Do not connect or remove the Bluetooth Photo Print Adapter while it is communicating with device or while PictureMate Pal is printing; this may cause PictureMate Pal to malfunction.

- 2 Plug the adapter all the way into the  port on the back of PictureMate Pal.

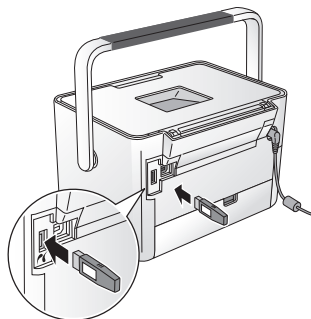

- 3 Make sure you are within about 30 feet of PictureMate Pal.

- 4 Select the photo you want to print from your Bluetooth device and send it to PictureMate Pal as follows:

- **Windows:** Send photos directly to PictureMate Pal with your Bluetooth file sharing program. See the documentation included with your computer's Bluetooth adapter for details.
- **Macintosh:** Double-click **Bluetooth File Exchange** in your **Utilities** folder. Follow the on-screen steps to choose a photo file, discover PictureMate Pal, and send photos.
- **Cell phones or PDAs:** See your product's documentation for instructions on setting up Bluetooth file sharing and sending files.

Printing starts automatically.

If you see a Bluetooth error message on the PictureMate Pal screen, try printing the photo from a memory card or your computer instead.

Note: For instructions on selecting PictureMate Pal's Bluetooth settings, see the on-screen *User's Guide*.

Disconnecting the Adapter

Make sure PictureMate Pal is not printing, then pull the adapter out of its port.

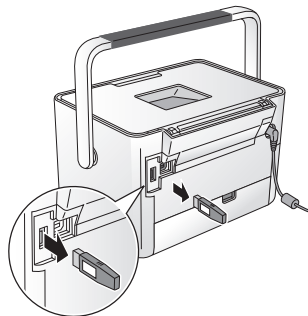

Caution: Do not connect or remove the Bluetooth Photo Print Adapter while it is communicating with your device or while PictureMate Pal is printing; this may cause PictureMate Pal to malfunction.

Replace Print Pack

When PictureMate Pal needs a new Print Pack, you see a message on the photo viewer screen.

The Print Pack contains a new photo cartridge and photo paper.

When you need a new Print Pack, see these sections:

- Buy a PictureMate 200 Series Print Pack (right)
- Replace the Print Pack (see page 34)

If you want to check the status of your Print Pack, see page 36.

Tip: If you see a replacement message while printing, you can replace the Print Pack and continue the current print job. Just replace it without turning off and unplugging PictureMate Pal.

Note: Use your PictureMate 200 Series photo cartridge within six months of installing it and before the expiration date on the package.

Caution: To ensure good results, use a genuine PictureMate 200 Series photo cartridge and do not refill it. Other products may cause ink spills or other damage to your printer not covered by Epson's warranty.

Buying a Print Pack



You can buy a PictureMate 200 Series Print Pack wherever PictureMate Pal is sold or from retailers that sell printer supplies.

The following Print Packs are available:

Print Pack contents	Part number	Supported PictureMate models
Glossy photo paper (150 sheets) and photo cartridge	T5846	PictureMate Pal and all other PictureMate 200 Series models
Matte photo paper (100 sheets) and photo cartridge	T5845-M	

You can also buy a Print Pack and other PictureMate Pal accessories from an Epson authorized reseller. To find the nearest reseller, call 800-GO-EPSON (800-463-7766). Or you can purchase online at **www.epsonstore.com** (U.S. sales) or **www.epson.ca** (Canadian sales).

Replacing the Print Pack

Make sure you have a new PictureMate 200 Series Print Pack before you remove the old photo cartridge. Once you remove the cartridge, you must install the new one right away.

Caution: Before you replace the cartridge, read the "Photo Cartridge Safety Instructions" on page 52.

- 1 Make sure PictureMate Pal is on but not printing.
- 2 Open the cartridge door on the back of PictureMate Pal.

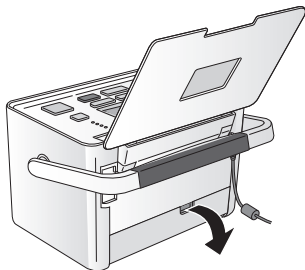

- 3 Slide the cartridge lever left, to the **Release** position.

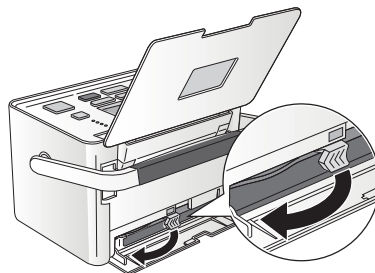

Caution: Do not try to pull out the cartridge without moving the lever.

- 4** Pull out the cartridge and dispose of it properly. (For appropriate disposal, check local resources for recycling guidelines.)

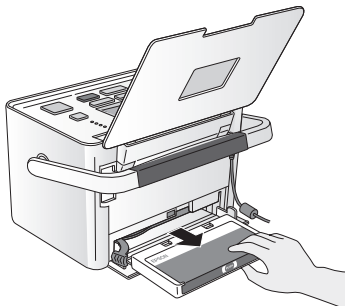

Warning: Keep photo cartridges out of the reach of children and do not drink the ink.

If ink gets on your hands, wash them thoroughly with soap and water. If ink gets in your eyes, flush them thoroughly with water. If discomfort or vision problems continue after flushing, see a doctor immediately.

Caution: Do not attempt to refill the photo cartridge. This could result in ink spills or other damage to PictureMate Pal not covered by Epson's warranty.

- 5** Remove the new photo cartridge from its package.

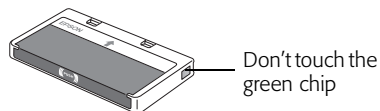

Caution: Don't touch the small green circuit board. Install the photo cartridge immediately. If you leave a cartridge unpacked for a long time before using it, normal printing may not be possible.

- 6** Slide the cartridge straight into the slot, label side up, until it clicks into place.

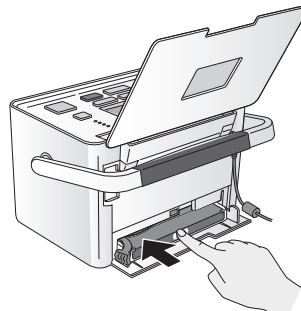

Note: The cartridge won't go in all the way. You need to use the cartridge lever to lock it in place.

- 7** Slide the lever all the way right, to the **Lock** position.

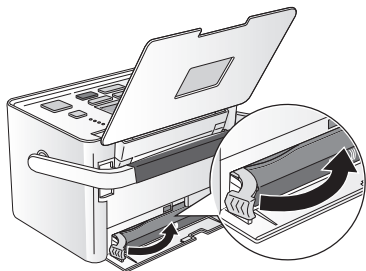

Caution: If the cartridge is not inserted correctly, PictureMate Pal will not be able to print.

- 8** Close the cartridge door all the way.

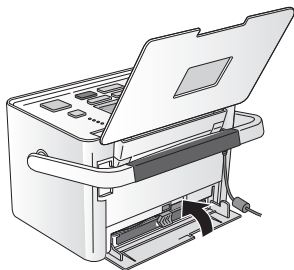

PictureMate Pal starts charging and displays a message.

- 9** When it's finished charging, press **OK**.

Checking Print Pack Status

You can check the status of your Print Pack at any time.

- 1** Press **Menu**.
- 2** Press **◀** or **▶** to highlight **PrintPk Status** and press **OK**. You see the status displayed on the photo viewer screen.

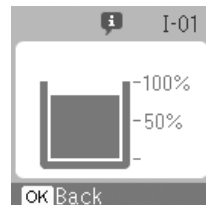

- 3** Press **Cancel** to exit.

Note: If the screen displays a **Print Pack low** message, you should buy a new PictureMate 200 Series Print Pack. See page 33 for details.

Take PictureMate Pal With You

PictureMate Pal's handle makes it easy to carry short distances. If PictureMate Pal is going to travel a longer distance, pack it carefully to protect it from damage.



Caution: Keep PictureMate Pal out of the sun and don't leave it in your car or other location where it can get too hot or too cold. Otherwise PictureMate Pal may be damaged or ink may leak.

- 1** Press the I/⏻ **On** button to turn off PictureMate Pal.
- 2** Wait until the **On** light goes out, then unplug the power cable from the power outlet.
- 3** Remove all paper and printed photos.
- 4** Unplug the power adapter and USB cables from PictureMate Pal.
- 5** Close the paper support and output tray.

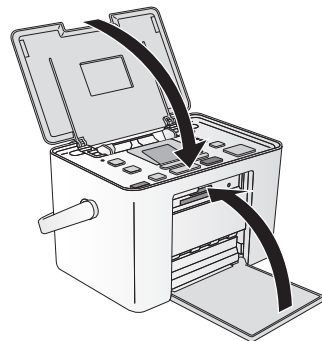

- 6** Pack PictureMate Pal in the box that it came in or the optional carrying case. Place the power cable and adapter in the accessory box that came with PictureMate Pal and pack it with PictureMate Pal.

Caution: Make sure the photo cartridge is installed. Do not remove the photo cartridge before transporting. Don't place PictureMate Pal on its side or upside down, or ink may leak.

Note: If your prints don't look as good after PictureMate Pal has been moved, try aligning the print head (see page 41).

Set PictureMate Pal Preferences

You can change the way PictureMate Pal works as follows:

- Adjust the amount of expansion used in borderless printing
- Turn print preview on or off
- Adjust the photo viewer screen contrast
- Return the settings to the original defaults



Adjusting Borderless Expansion

When you print borderless photos, your images are automatically expanded. If too much of your photos are cut off around the edges, you can adjust the amount of expansion.

- 1** Press **Menu**.
- 2** Press ◀ or ▶ to highlight **Borderless Exp** and press **OK**.
- 3** Press ◀ or ▶ to select **MIN** (to reduce the amount of expansion).
- 4** Press **OK**.
- 5** Press **Cancel** to exit.

If you see white edges on your photos, repeat these steps, but select **MID** or **MAX**.

Turning Print Preview On or Off

When Print Preview is **On** and you press  **Print**, you see a screen that lets you confirm your selected photos, number of copies, layout, and other settings. Then you press  **Print** again to start printing.

When Print Preview is **Off**, PictureMate Pal does not display a preview screen before printing. You can press  **Print** just once to start printing.

- 1** Press **Menu**.
- 2** Press ◀ or ▶ to highlight **Print Preview** and press **OK**.
- 3** Press ◀ or ▶ to select **On** or **Off**, and press **OK**.
- 4** Press **Cancel** to exit.

The Print Preview setting remains in effect until you change it or return to default settings.

Adjusting the Photo Viewer Screen Contrast

If the screen is too light or too dark, you can adjust it.

- 1** Press **Menu**.
- 2** Press ◀ or ▶ to highlight **LCD Contrast** and press **OK**.
- 3** Press ▶ to increase the contrast of the screen or ◀ to reduce the contrast. Then press **OK**.
- 4** Press **Cancel** to exit.

Returning to Default Settings

You can return your settings to the PictureMate Pal original default settings.

- 1** Press **Menu**.
- 2** Press ◀ or ▶ to highlight **Reset Defaults** and press **OK**.
You see a confirmation message.
- 3** Press **OK** to return to the original settings, or press **Cancel** to exit without changing the settings.

Printer Care and Troubleshooting

If you have a problem with your PictureMate Pal, or you want to improve print quality, read these sections:

- Cleaning the print head (to the right)
- Aligning the print head (on page 41)
- Cleaning PictureMate Pal (on page 42)
- Error messages (on page 43)
- Printing and operation problems (on page 44)
- Software installation problems (on page 45)
- Print quality problems (on page 46)
- Problems with paper feeding (on page 47)
- Miscellaneous printout problems (on page 47)
- Where to get help (on page 48)

Cleaning the Print Head

If your print quality is not as good as it used to be—if photos are too light, are missing colors, or have lines running through them—PictureMate Pal's print head nozzles may need cleaning.

Note: If you see a **Print Pack low** message on the photo viewer, you can't clean the print head until you replace the Print Pack.

Follow these steps to clean the print head:

- 1** Load paper in PictureMate Pal so you can print a nozzle check pattern after cleaning the print head. (See page 5 for details.)
- 2** Press **Menu**.
- 3** Press ◀ or ▶ to highlight **Maintenance** and press **OK**.
- 4** Press ◀ or ▶ to select **Auto Cleaning** and press **OK**.

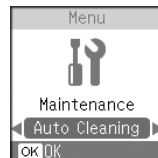

- 5** Press **OK** again to clean the print head. Cleaning takes about 60 seconds. PictureMate Pal makes some noise and you see a **Cleaning** message.

When cleaning is complete, PictureMate Pal prints a nozzle check pattern.

- 6** Check the pattern to see if there are any gaps in the lines.

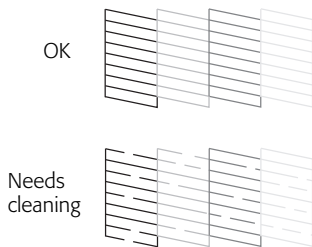

- 7** If there are no gaps, press **OK** to go back to the Maintenance menu.

If there are gaps, press **Cancel** to clean the print head again. You may need to clean it two or three times before the nozzles are clean.

If you don't see any improvement after cleaning three times, see "Print Quality Problems" on page 46.

You can also turn PictureMate Pal off and wait overnight to allow any dried ink to soften. Then try cleaning the print head again.

Aligning the Print Head

If you have moved PictureMate Pal and print quality is not as good as it used to be—if your prints look fuzzy or have light or dark lines running through them—you may need to align the print head.

- 1** Load paper in PictureMate Pal so you can print the head alignment pattern. (See page 5 for details.)
- 2** Press **Menu**.
- 3** Press **◀** or **▶** to highlight **Maintenance** and press **OK**.
- 4** Press **◀** or **▶** to select **Head Alignment** and press **OK**.



- 5** Press  **Print**. The following alignment pattern is printed:

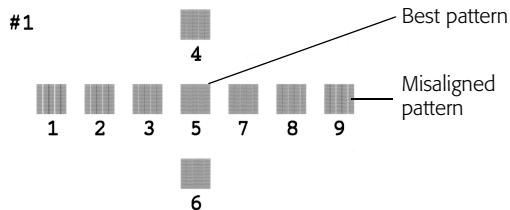

- 6** Look at the printed squares to determine which one is the most even, with no streaks or lines. (You may need to use a magnifying glass.)
- 7** Press **◀** or **▶** to highlight the number for the best square (1 to 9). Then press **OK**.

PictureMate Pal aligns the print head and exits the Maintenance menu.

Note: The number that you enter becomes the default setting (#5) the next time you align the print head.

Cleaning PictureMate Pal

To keep PictureMate Pal working at its best, you should clean it several times a year. Follow these steps:

- 1** Turn off PictureMate Pal, unplug the power cable, and disconnect the power adapter and any USB cables.
- 2** Remove all paper, then use a soft brush to clean any dust or dirt from the paper feeder and output tray.
- 3** Clean the PictureMate Pal exterior with a soft, damp cloth.
- 4** Use a soft, dry cloth to clean the PictureMate Pal photo viewer screen. Do not use liquid or chemical cleaners on it.

Caution: Never use a hard or abrasive brush, or alcohol or thinner for cleaning; they can damage the components and case.

Don't get water on the components and don't spray lubricants or oils inside PictureMate Pal.

Error Messages

If your PictureMate Pal has any problems, check the screen for a message. If you see one of these messages, here's what to do:

Message	What to Do
Not initial cartridge. Use initial cartridge.	You need to insert the initial photo cartridge that comes with PictureMate Pal the first time you charge it. Remove the installed photo cartridge and install the initial photo cartridge instead.
Print Pack is low. Replace Print Pack soon. or Print Pack is very low. Replace Print Pack soon.	Your Print Pack is running low. If you are trying to clean the print head, you must replace the Print Pack first. Purchase a PictureMate 200 Series Print Pack and replace it. See page 33.
Replace Print Pack now.	Purchase a PictureMate 200 Series Print Pack and replace the photo cartridge. If the cartridge is new, make sure it is inserted correctly. See page 33.
Paper out. Load paper and press OK.	Load paper, or remove and reload paper, then press OK to clear this message and resume printing. See page 5 for loading instructions.

Message	What to Do
Paper jam. Clear jam and press OK.	Remove any sheets behind the jammed paper and press OK to eject the jammed paper. Don't pull out jammed paper from the top of PictureMate Pal. See page 47.
Close the cartridge door.	The cartridge door is not closed completely on the back of PictureMate Pal. Make sure the door clicks shut.
No cartridge installed. Insert cartridge now.	The photo cartridge was removed or not installed correctly. Install a new photo cartridge. See page 33.
Cartridge not recognized. Replace Print Pack.	Install a genuine PictureMate 200 Series photo cartridge. See page 33.
No photos on memory card.	No compatible photos are on the inserted memory card. Insert a card with photos or one with compatible file types. See page 3.
Memory card not recognized.	Use a compatible memory card. Format the card with your camera, not a computer. See the card types you can use on page 7 and the supported file types on page 3.

Message	What to Do
Error in data. Printouts may be affected.	Data in your photo files may be corrupted and may affect your printouts.
Bluetooth adapter error.	Disconnect the adapter, then reconnect it to PictureMate Pal. See page 31.
The image is too large.	The image you are trying to print from a Bluetooth device is too large. Print the photo from a memory card or your computer instead.
The image is too complex.	The image you are trying to print from a Bluetooth device is too complex. Print the photo from a memory card or your computer instead.
External device not recognized	An unsupported device is connected to the  port on the back of PictureMate Pal. Disconnect the device.
Printer error.	Turn off PictureMate Pal, wait a few seconds, then turn it on again. If the error does not clear, contact Epson as described on page 48.
Service required.	Parts inside PictureMate Pal are near or at the end of their service life. Contact Epson as described on page 48.

Printing and Operation Problems

The On light and photo viewer screen don't turn on.

- Press the I/⏻ **On** button again to turn on PictureMate Pal.
- Make sure the power cable and AC adapter are securely connected at both ends.
- Make sure your power outlet works and is not controlled by a wall switch or timer.

The photo viewer screen goes blank.

The screen shuts off after 13 minutes if PictureMate Pal is not used. Press any button to turn it back on.

PictureMate Pal makes an unexpected noise after you install a Print Pack.

The first time you install the photo cartridge, PictureMate Pal will charge its print head for about three minutes. Wait until charging finishes before you turn it off, or it may charge improperly and use more ink the next time you turn it on.

PictureMate Pal makes an unexpected noise when you turn it on or after it has been sitting for a while.

PictureMate Pal is performing routine maintenance.

PictureMate Pal sounds as though it is printing, but nothing prints.

- PictureMate Pal may be preparing to print.
- The print head may need cleaning. See page 40.
- PictureMate Pal won't work properly if it's tilted or at an angle. Place it on a flat, stable surface.
- Make sure paper is not jammed and is loaded correctly, and make sure the handle is not resting on the paper. See page 5.

Your memory card does not work correctly.

- Insert only one card at a time.
- Make sure you are using a compatible memory card. See page 6.
- PictureMate Pal recognizes and can print the first 999 photos on a memory card.
- Photos must be in JPEG or uncompressed TIFF format and taken with a DCF-compliant camera.
- PictureMate Pal cannot read progressive-scan JPEG files or RAW files.
- Make sure to format your memory card in your camera.

Printing is too slow.

- It takes a few moments for PictureMate Pal to process your images before printing them.
- If PictureMate Pal is in a hot or sunny location, move it to a cooler place and try printing again.

For faster printing, try these tips:

- Photos with borders print faster than borderless photos.
- Before you print, press **Menu**, select **Color Effect**, and set it to **None**.
- JPEG photo files print faster than TIFF files.

Software Installation Problems

- Follow the instructions beginning on page 15 to install your software. Don't connect PictureMate Pal to your computer until you are instructed to.
- Close other programs, including screen savers and virus protection software, and try installing again.
- Make sure your system meets the requirements listed in your on-screen *User's Guide*.
- To print over a network, see the on-screen *User's Guide* for instructions on setting up printing.

Print Quality Problems

You see banding (light lines) in your prints.

- The print head may need cleaning. See page 40.
- Make sure the glossy side of the paper is face up.
- The Print Pack may need replacing. See page 33.
- The print head may need aligning. See page 41.

Your print is blurry or smeared.

- Use PictureMate 200 Series photo paper to ensure proper saturation, absorption of ink, and quality.
- Make sure the glossy side of the paper is face up.
- Make sure your paper isn't damp or curled, or loaded face down (load it glossy side up). If it's damp or curled, load a new stack of paper.
- The print head may need cleaning. See page 40.
- The print head may need aligning. See page 41.
- Remove each photo from the output tray after printing. Let each photo sit for a minute before handling it.

Your print is grainy.

The print head may need aligning. See page 41.

Your print is faint or has gaps in the image.

- The print head may need cleaning. See page 40.
- The photo cartridge may be old or low. See page 33 to replace it.
- Make sure your paper isn't damaged, old, dirty, or loaded face down. If it is, load new paper with the glossy side up.

Colors in your photo are wrong or missing.

- Press **Menu** and make sure the Color Effect setting is not set to **Black and White** or **Sepia**. See page 13.
- The print head may need cleaning. See page 40.
- The photo cartridge may be old or low. See page 33 to replace it.
- Colors may change slightly after your print dries. Wait for 24 hours and check your photo again.

Problems With Paper Feeding

Paper doesn't eject fully or is wrinkled.

The paper may be damp. Load new paper.

Paper doesn't feed correctly or jams.

- Make sure the handle is not resting on the paper.
- If paper doesn't feed, remove it, separate the sheets slightly, reload it between the edge guides, and make sure the guides aren't too tight. See page 5.
- If multiple pages feed at once, remove the paper, separate the sheets, and carefully reload it.
- If paper jams, remove any sheets behind the jammed paper and press **OK** to eject the jammed paper. Don't pull out jammed paper from the top of PictureMate Pal.

If paper loads incorrectly or jams frequently:

- Use new paper loaded paper glossy or whiter side up and separate the sheets slightly.
- Load a maximum of 20 sheets.
- Make sure your paper is beneath the arrow on the edge guides.

- Don't load plain paper; this may damage PictureMate Pal.
- Use only PictureMate 200 Series photo paper or Epson Premium Photo Paper Glossy.
- Store paper flat to help prevent curling.

Miscellaneous Printout Problems

PictureMate Pal prints blank pages.

The print head may need cleaning. See page 40.

The borders or layout are incorrect.

- Check the Layout setting to see if it is correct. See page 12 (if printing directly from PictureMate Pal) or page 20 (if printing from a computer).
- When you print borderless photos, PictureMate Pal automatically expands your images. If too much of your photos are cut off around the edges, you can adjust the amount of expansion. See page 38 (if printing directly from PictureMate Pal) or page 20 (if printing from a computer).

The wrong photo is printed.

- If your camera supports DPOF, you can pre-select photos so PictureMate Pal knows exactly what to print. See page 10.
- If your camera supports PictBridge or USB DIRECT-PRINT printing, you can print from the camera. See page 30.
- For instructions on selecting photos, see page 9.

Too many copies print.

Make sure that the **Copies** option in your software or on PictureMate Pal is set for the number of copies you want to print. See page 9 (if printing directly from PictureMate Pal) or page 20 (if printing from a computer).

Where to Get Help

Epson Technical Support

Epson provides these technical support services:

Internet Support

Visit Epson's support website at **epson.com/support** and select your product for solutions to common problems. You can download drivers and documentation, get FAQs and troubleshooting advice, or e-mail Epson with your questions.

Speak to a Support Representative

Before you call Epson for support, please have the following information ready:

- Product name (PictureMate Pal)
- Product serial number (located on the bottom of PictureMate Pal)
- Proof of purchase (such as a store receipt) and date of purchase
- Computer configuration
- Description of the problem

Then call :

- U.S.: (562) 276-7282, 6 AM to 8 PM, Pacific Time, Monday through Friday and 7 AM to 4 PM, Saturday.
- Canada: (905) 709-2567, 6 AM to 6 PM, Pacific Time, Monday through Friday.

Toll or long distance charges may apply.

Purchase Supplies and Accessories

You can purchase genuine PictureMate 200 Series Print Packs and accessories from an Epson authorized reseller. To find the nearest reseller, call 800-GO-EPSON (800-463-7766). Or you can purchase online at **www.epsonstore.com** (U.S. sales) or **www.epson.ca** (Canadian sales).

Other Software Technical Support

ArcSoft PhotoImpression

Telephone: (510) 440-9901, 8:30 AM to 5:30 PM,
Pacific Time, Monday through Friday

Fax: (510) 440-1270

Online: www.arcsoft.com

E-mail: support@arcsoft.com

Notices

Important Safety Instructions

Before using PictureMate Pal, read the following safety instructions to make sure you use it safely and effectively:

- Be sure to follow all warnings and instructions marked on the printer.
- If you use the printer in places where the use of printers is restricted, such as in airplanes or hospitals, follow all instructions in those places.
- Do not insert objects through the slots in the printer.
- Take care not to spill liquid on the printer and the AC adapter.
- Do not put your hand inside the printer or touch the photo cartridge during printing.
- Do not use aerosol products that contain flammable gases inside or around the printer. Doing so may cause fire.
- Always turn the printer off using the I/⏻ **On** button. Do not unplug the printer or turn off the power to the outlet until the **On** light goes out.
- Before transporting the printer, make sure that the photo cartridge is installed.
- Leave the photo cartridge installed. Removing the cartridge can dehydrate the print head and may prevent the printer from printing or cause ink to leak out.

- Do not remove the memory card or turn off the printer while the computer and the memory card are communicating (when the memory card light is flashing).
- The methods for using memory cards vary according to card type. Be sure to refer to the documentation packaged with your memory card for details.
- Use only memory cards compatible with the printer (see page 6).
- Place the printer on a flat, stable surface that extends beyond the base of the printer in all directions. The printer will not operate properly if it is tilted at an angle. If you place the printer by the wall, leave more than 4 inches (10 cm) between the back of the printer and the wall.
- When storing or transporting the printer, do not tilt it, stand it on its side, or turn it upside down. Otherwise, ink may leak from the cartridge.
- Leave enough space in front of the printer for the paper to be fully ejected.
- Avoid places subject to rapid changes in temperature and humidity. Also, keep the printer and the AC adapter away from direct sunlight, strong light, water, or heat sources.

Caution: Keep PictureMate Pal out of the sun and don't leave it in your car or other location where it can get too hot or too cold. Otherwise PictureMate Pal may be damaged or ink may leak.



- Avoid places subject to dust, shock, or vibration.
- Leave enough room around the printer to allow for sufficient ventilation.
- Place the AC adapter near a wall outlet where the plug can be easily unplugged.
- Do not place or store the printer or the AC adapter outdoors.
- Do not block or cover the vents and openings in the printer.
- Power supply cords should be placed to avoid abrasions, cuts, fraying, crimping, and kinking. Do not place objects on top of power-supply cords and do not allow the AC adapter or power-supply cords to be stepped on or run over. Be particularly careful to keep all power-supply cords straight at the ends and the points where they enter and leave the AC adapter.
- Use only the power-supply cord that comes with this product. Use of another cord may result in fire or electrical shock, or injury.
- The AC adapter model A381H is designed for use with the printer with which it was included. Do not attempt to use it with other electronic devices unless specified.
- Use only the type of power source indicated on the AC adapter's label, and always supply power directly from a standard domestic electrical outlet with the AC power cord that meets the relevant local safety standards.
- Avoid using outlets on the same circuit as photocopiers or air control systems that regularly switch on and off.
- Avoid using electrical outlets controlled by wall switches or automatic timers.
- Keep the entire computer system away from potential sources of electromagnetic interference, such as loudspeakers or the base units of cordless telephones.
- Do not use a damaged or frayed power cord or AC adapter.
- If you use an extension cord with the printer, make sure that the total ampere rating of the devices plugged into the extension cord does not exceed the cord's ampere rating. Also, make sure that the total ampere rating of all devices plugged into the wall outlet does not exceed the wall outlet's ampere rating.
- Never disassemble, modify, or attempt to repair the AC adapter, power cord, printer, and options by yourself except as specifically explained in the printer's guides.
- Unplug the printer and the AC adapter and refer servicing to qualified service personnel under the following conditions:
The power cord or plug is damaged; liquid has entered the printer or the AC adapter; the printer or the AC adapter has been dropped or the casing damaged; the printer or the AC adapter does not operate normally or exhibits a distinct change in performance. (Do not adjust controls that are not covered by the operating instructions.)
- Do not use with wet hands.

Warning: The cords included with this product contain chemicals, including lead, known to the State of California to cause birth defects or other reproductive harm. **Wash hands after handling.** (provided in accordance with Proposition 65 in Cal. Health & Safety Code §25249.5 et seq)

Photo Cartridge Safety Instructions

- Keep photo cartridges out of the reach of children and do not drink the ink.
- Do not shake the photo cartridge after removing it from the bag; this can cause leakage.
- Be careful when you handle used photo cartridges, as there may be some ink remaining around the ink supply ports. If ink gets onto your skin, wash the area thoroughly with soap and water. If ink gets into your eyes, flush them immediately with water. If discomfort or vision problems continue after a thorough flushing, see a doctor immediately.
- Do not remove or tear the label on the cartridge; this can cause leakage.
- Do not dismantle photo cartridges or try to refill them. This could damage the print head.
- Install the photo cartridge immediately after you remove it from its package. If you leave a cartridge unpacked for a long time before using it, normal printing may not be possible.
- Do not use a photo cartridge beyond the date printed on the cartridge carton; otherwise, it may result in reduced print quality. For best results, use up the photo cartridge within six months of installing it.
- After bringing a photo cartridge inside from a cold storage site, allow it to warm up at room temperature for at least three hours before using it.
- Store photo cartridges in a cool, dark place.
- Store each photo cartridge so that the bottom of its packaging faces down.
- Do not touch the green IC chip on the bottom of the cartridge. Doing so may prevent normal operation and printing.
- The IC chip on the photo cartridge retains a variety of cartridge-related information, such as the amount of ink remaining, so that the cartridge may be removed and reinstalled freely. However, each time the cartridge is inserted, some ink is consumed because the printer automatically performs a reliability check.
- If you remove the photo cartridge for later use, protect the ink supply ports from dirt and dust and store it in the same environment as the printer. A valve in the ink supply ports makes covers or plugs unnecessary, but the ink may stain items that come into contact with this area of the cartridge. Do not touch the ink supply ports or the surrounding area.

Photo Viewer Screen Safety Instructions

- The screen contains a few small bright or dark spots. These are normal and do not mean that the screen is damaged in any way.
- Only use a dry, soft cloth to clean the screen. Do not use liquid or chemical cleansers.
- If the screen is damaged, contact your dealer. If the liquid crystal solution gets on your hands, wash them thoroughly with soap and water. If the liquid crystal solution gets into your eyes, flush them immediately with water. If discomfort or vision problems remain after a thorough flushing, see a doctor immediately.
- Please consult your state and local regulations regarding disposal or recycling. Do not put in the trash.

Epson America, Inc. Limited Warranty

What Is Covered: Epson America, Inc. ("Epson") warrants to the original retail purchaser that the Epson printer covered by this limited warranty statement, if purchased and operated only in the United States or Canada, will be free from defects in workmanship and materials for a period of one (1) year from the date of original purchase. For warranty service, you must provide proof of the date of original purchase.

What Epson Will Do To Correct Problems: Should your Epson printer prove defective during the warranty period, please call the Epson ConnectionSM at (562) 276-7282 (U.S.) or (905) 709-2567 (Canada) for warranty repair instructions and return authorization. An Epson service technician will provide telephone diagnostic service to determine whether the printer requires service. If service is needed, Epson will, at its option, exchange or repair the printer without charge for parts or labor. If Epson authorizes an exchange for the defective unit, Epson will ship a replacement printer to you, freight prepaid, so long as you use an address in Canada or the U.S. (excluding Puerto Rico and U.S. Possessions). Shipments to other locations will be made freight collect. You are responsible for securely packaging the defective unit and returning it to Epson within five (5) working days of receipt of the replacement. Epson requires a debit or a credit card number to secure the cost of the replacement printer in the event that you fail to return the defective one. If your printer is being repaired, Epson will direct you to send your printer to Epson or its authorized service center, where the printer will be fixed and sent back to you. You are responsible for packing the printer and for all costs to and from the Epson authorized service center. When warranty service involves the exchange of the printer or a part, the item replaced becomes Epson property. The replacement printer or part may be new or refurbished to the Epson standard of quality, and, at Epson's option, may be another model of like kind and quality. Epson's liability for replacement of the covered printer will not exceed the original retail selling price of the covered printer. Exchange products and parts assume the remaining warranty period of your original product covered by this limited warranty.

What This Warranty Does Not Cover: This warranty does not apply to refurbished or reconditioned products. This warranty covers only normal use in the United States and Canada. Using this product for continuous production or similar high duty purposes is not considered normal use; damage, maintenance or service from such use will not be covered under this warranty. This warranty is not transferable. This warranty does not cover any color change or fading of prints or reimbursement of materials or services required for reprinting. This warranty does not cover damage to the Epson product caused by parts or supplies not manufactured, distributed or certified by Epson. This warranty does not cover ribbons, ink cartridges or third party parts, components, or peripheral devices added to the Epson product after its shipment from Epson, e.g., dealer or user-added boards or components. Epson is not responsible for warranty service should the Epson label or logo or the rating label or serial number be removed or should the product fail to be properly maintained or fail to function properly as a result of misuse, abuse, improper installation, neglect, improper shipping, damage caused by disasters such as fire, flood, and lightning, improper electrical current, software problems, interaction with non-Epson products, or service other than by an Epson Authorized Servicer. If a claimed defect cannot be identified or reproduced, you will be held responsible for the costs incurred.

THE WARRANTY AND REMEDY PROVIDED ABOVE ARE EXCLUSIVE AND IN LIEU OF ALL OTHER EXPRESS OR IMPLIED WARRANTIES INCLUDING, BUT NOT LIMITED TO, THE IMPLIED WARRANTIES OF MERCHANTABILITY, NON-INFRINGEMENT OR FITNESS FOR A PARTICULAR PURPOSE. SOME LAWS DO NOT ALLOW THE EXCLUSION OF IMPLIED

WARRANTIES. IF THESE LAWS APPLY, THEN ALL EXPRESS AND IMPLIED WARRANTIES ARE LIMITED TO THE WARRANTY PERIOD IDENTIFIED ABOVE. UNLESS STATED HEREIN, ANY STATEMENT OR REPRESENTATIONS MADE BY ANY OTHER PERSON OR FIRM ARE VOID. EXCEPT AS PROVIDED IN THIS WRITTEN WARRANTY, NEITHER EPSON AMERICA, INC. NOR ITS AFFILIATES SHALL BE LIABLE FOR ANY LOSS, INCONVENIENCE, OR DAMAGE, INCLUDING DIRECT, SPECIAL, INCIDENTAL OR CONSEQUENTIAL DAMAGES, RESULTING FROM THE USE OR INABILITY TO USE THE EPSON PRODUCT, WHETHER RESULTING FROM BREACH OF WARRANTY OR ANY OTHER LEGAL THEORY.

In Canada, warranties include both warranties and conditions.

Some jurisdictions do not allow limitations on how long an implied warranty lasts, and some jurisdictions do not allow the exclusion or limitation of incidental or consequential damages, so the above limitations and exclusions may not apply to you. This warranty gives you specific legal rights and you may have other rights which vary from jurisdiction to jurisdiction.

To find the Epson Authorized Reseller nearest you, visit our website at: <http://www.epson.com>.

To find the Epson Customer Care Center nearest you, visit <http://support.epson.com>.

You can also write to: Epson America, Inc., P.O. Box 93012, Long Beach, CA 90809-3012

How Many Photos Will I Get From a PictureMate Print Pack?

Epson has packaged the PictureMate Photo Cartridge with a quantity of 4 × 6 PictureMate Photo Paper, so that purchasing supplies for PictureMate is convenient and affordable. The number of sheets of photo paper in your PictureMate Print Pack is stated on the Print Pack's box. The photo ink cartridge in the Print Pack contains enough ink to allow borderless, color printing of about the stated number of sheets.

Our estimate of the number of photos you can print with a PictureMate Print Pack is based on test printing with a range of 20 different color photos. Actual yields will vary based on images printed, print settings, paper type, frequency of use and temperature. For example, printing many copies of the same photo, or printing many black and white or sepia photos, may result in fewer photos per PictureMate Photo Cartridge. Also, the PictureMate Photo Cartridge once installed should be replaced with a new one within 6 months. For print quality, a variable amount of ink remains in the cartridge after the "Replace Print Pack" indicator comes on.

You may be able to print more photos with a PictureMate Photo Cartridge than the number of sheets of photo paper in your PictureMate Print Pack. In this case the cartridge monitor indicates the cartridge can still be used. You can continue printing with paper from another PictureMate Print Pack or Epson Premium Glossy Photo Paper in the 4 × 6 borderless size which is available from many resellers or Epsonstore.com. There are other photo papers available but most are not formulated to be fully compatible with the

PictureMate Photo Cartridge. Using other papers may result in poor color reproduction, print quality problems or more fading.

Both a PictureMate Photo Cartridge and some PictureMate Photo Paper were included in the box with your PictureMate printer. The included cartridge contains enough ink to allow borderless, color printing of about the number of included paper sheets. The other comments above also apply to the cartridge and paper included in the printer box.

PictureMate Print Pack Satisfaction Guarantee

If you are dissatisfied because you receive fewer prints than the number of sheets of paper stated on your PictureMate Print Pack, you can return the remaining sheets of paper with the dated sales receipt and UPC code from the PictureMate Print Pack packaging within one year of purchase and Epson will give you a pro-rated refund for the number of sheets returned, plus a maximum of \$1.10 for postage. The amount of the refund depends on the number of sheets stated on your Print Pack and the Print Pack's suggested retail price. For example, if you purchased a 150-sheet Print Pack of glossy photo paper with a suggested retail price of \$39.99, Epson will refund 27 cents per sheet returned (\$39.99 divided by 150 sheets equals 27cents per sheet.). This Satisfaction Guarantee is a prorated refund that covers only end-user claims in the U.S. and Canada. It does not cover use of any non-Epson ink or paper, commercial use of the printer, or paper consumed by proofs or printing errors.

This Satisfaction Guarantee also applies to the PictureMate Photo Cartridge and PictureMate Photo Paper which were included in the box with your PictureMate printer, if you are dissatisfied because you receive fewer prints with the cartridge than the number of sheets included. The per-sheet refund in that case is 27 cents.

Refund Procedure

Please follow this refund procedure:

- 1** Print out the PictureMate Print Pack Satisfaction Guarantee Form, found on the web page below, or request this form to be mailed to you by calling (562) 276-1347 for U.S.A. and Puerto Rico or (905) 709-8676 for Canadian residents.

www.mypicturemate.com/satisfactionguarantee

- 2** Send the following items to:

PictureMate Print Pack Satisfaction Guarantee
P.O. Box 400067
EL Paso, TX 88540-0067

- a) Fully completed PictureMate Print Pack Satisfaction Guarantee Form
- b) Original UPC code of PictureMate Print Pack
- c) Copy of PictureMate Print Pack receipt
- d) Remaining PictureMate Print Pack paper from the original PictureMate Print Pack.

If you are making a claim based on the number of prints you were able to make with the initial cartridge and paper which were included in the box with your PictureMate printer, please submit:

- a) Fully completed PictureMate Print Pack Satisfaction Guarantee Form
- b) Copy of Original UPC code of PictureMate printer
- c) Copy of PictureMate printer receipt
- d) Remaining paper which was included in the PictureMate printer box

Customer claim status inquiries: (800) 305-7305.

Declaration of Conformity

According to 47CFR, Part 2 and 15 for Class B Personal Computers and Peripherals; and/or CPU Boards and Power Supplies used with Class B Personal Computers:

We: Epson America, Inc.

Located at: MS: 3-13
3840 Kilroy Airport Way
Long Beach, CA 90806-2469
Telephone: (562) 290-5254

Declare under sole responsibility that the product identified herein, complies with 47CFR Part 2 and 15 of the FCC rules as a Class B digital device. Each product marketed is identical to the representative unit tested and found to be compliant with the standards. Records maintained continue to reflect the equipment being produced can be expected to be within the variation accepted, due to quantity production and testing on a statistical basis as required by 47CFR §2.909. Operation is

subject to the following two conditions: (1) this device may not cause harmful interference, and (2) this device must accept any interference received, including interference that may cause undesired operation.

Trade Name: Epson

Type of Product: Ink Jet Printer

Model: B381A

FCC Compliance Statement

For United States Users

This equipment has been tested and found to comply with the limits for a Class B digital device, pursuant to Part 15 of the FCC Rules. These limits are designed to provide reasonable protection against harmful interference in a residential installation. This equipment generates, uses, and can radiate radio frequency energy and, if not installed and used in accordance with the instructions, may cause harmful interference to radio or television reception. However, there is no guarantee that interference will not occur in a particular installation. If this equipment does cause interference to radio and television reception, which can be determined by turning the equipment off and on, the user is encouraged to try to correct the interference by one or more of the following measures:

- Reorient or relocate the receiving antenna.
- Increase the separation between the equipment and receiver.

- Connect the equipment into an outlet on a circuit different from that to which the receiver is connected.
- Consult the dealer or an experienced radio/TV technician for help.

WARNING: The connection of a non-shielded equipment interface cable to this equipment will invalidate the FCC Certification of this device and may cause interference levels which exceed the limits established by the FCC for this equipment. It is the responsibility of the user to obtain and use a shielded equipment interface cable with this device. If this equipment has more than one interface connector, do not leave cables connected to unused interfaces. Changes or modifications not expressly approved by the manufacturer could void the user's authority to operate the equipment.

For Canadian Users

This Class B digital apparatus complies with Canadian ICES-003.

Cet appareil numérique de la classe B est conforme à la norme NMB-003 du Canada.

Copyright Notice

All rights reserved. No part of this publication may be reproduced, stored in a retrieval system, or transmitted in any form or by any means, electronic, mechanical, photocopying, recording, or otherwise, without the prior written permission of Seiko Epson Corporation. The information contained herein is designed only for use with this Epson product. Epson is not responsible for any use of this information as applied to other printers.

Neither Seiko Epson Corporation nor its affiliates shall be liable to the purchaser of this product or third parties for damages, losses, costs, or expenses incurred by purchaser or third parties as a result of: accident, misuse, or abuse of this product or unauthorized modifications, repairs, or alterations to this product, or (excluding the U.S.) failure to strictly comply with Seiko Epson Corporation's operating and maintenance instructions.

Seiko Epson Corporation shall not be liable for any damages or problems arising from the use of any options or any consumable products other than those designated as Original Epson Products or Epson Approved Products by Seiko Epson Corporation.

A Note Concerning the Responsible Use of Copyrighted Materials

Epson encourages each user to be responsible and respectful of the copyright laws when using any Epson product. While some countries' laws permit limited copying or reuse of copyrighted material in certain circumstances, those circumstances may not be as broad as some people assume. Contact your legal advisor for any questions regarding copyright law.

Trademarks

Epson and PictureMate are registered trademarks, and Exceed Your Vision, USB DIRECT-PRINT, and the USB DIRECT-PRINT logo are trademarks of Seiko Epson Corporation.

PhotoEnhance is a trademark and Epson Connection is a service mark of Epson America, Inc.

SD is a trademark.

SDHC is a trademark.

Memory Stick, Memory Stick Duo, Memory Stick PRO, and Memory Stick PRO Duo are trademarks of Sony Corporation.

xD-Picture Card is a trademark of Fuji Photo Film Co., Ltd.

DPOF is a trademark of CANON INC., Eastman Kodak Company, Fuji Photo Film Co., Ltd., and Matsushita Electric Industrial Co., Ltd.

The Bluetooth trademarks are owned by Bluetooth SIG, Inc., U.S.A. and licensed to Seiko Epson Corporation.



General Notice: Other product names used herein are for identification purposes only and may be trademarks of their respective owners. Epson disclaims any and all rights in those marks.

© 2007 Epson America, Inc. 1/07

CPD-21348R2

Index

A

Accessories, 4, 31, 33, 49

Adapter

Bluetooth, 3, 31 to 32

memory card, 7

power, 37, 50 to 51

Aligning print head, 41 to 42

All photos, printing, 9

ArcSoft PhotoImpression, 20, 49

Auto correction setting, Windows, 25

Auto shutoff, 8

B

Banding, fixing, 46

Basic printing

Macintosh, 27 to 29

Windows, 21 to 26

Black and white printing, 13, 25, 28

Blank pages, 47

Blank screen, 44

Bluetooth

connecting adapter, 3, 31

disconnecting adapter, 32

printing using, 31 to 32

Blurry prints, 46

Border

layout, see Layout

problems, 47

Borderless expansion, 25, 28, 38

Borderless layout, see Layout

Button

Cancel, 9

Layout, 9 to 10, 12 to 14

Menu, 9 to 10, 12 to 14

On, 6, 15, 18, 37, 44, 50

Open, 5, 6

Print, 9 to 10, 12 to 14, 39

Select All, 3, 9

C

Cable

- power, 37, 50 to 52
- USB, 15, 17 to 18, 30, 37

Camera

- printing from, 30 to 31
- selected photos (DPOF), 3, 10

Cancelling printing

- Macintosh, 29
- PictureMate Pal button, 9
- Windows, 23, 26

Card, memory, *see* Memory card

Care of PictureMate Pal, 40 to 42

Cartridge door, 34 to 36

Cartridge, *see* Photo cartridge

CD, installing software from, 15 to 20

Cell phone, printing from, 31 to 32

Charging photo cartridge, 36, 44

Choosing photos, 9 to 10

Cleaning

- PictureMate Pal, 42
- print head, 40 to 41

Color

- effects, 13 to 14
- enhancing, 14
- problems, 46

Compatible

- memory cards, 7, 43
- photo files, 3

Computer

- Bluetooth printing, 31 to 32
- connecting to PictureMate Pal, 15 to 18
- installing software on, 15 to 20
- printing from, 20 to 29
- saving photo files to, 20
- software installation problems, 45

Contrast

- photo viewer screen, 39
- photos, increasing, 14

Copies, number of

- Macintosh, 29
- PictureMate Pal buttons, 9, 10
- problems, 48
- Windows, 25

Customizing PictureMate Pal, 38 to 39

Cut-off photos, fixing, 25, 28, 38

D

- Date stamp, 13 to 14
- Default settings, resetting, 39
- Digital Camera Correction setting, Windows, 25
- Digital photography, 2
- Displaying photos, 11
- DOC (Declaration of Conformity), 56
- Door, cartridge, 34 to 36
- DPOF (Digital Print Order Format), 3, 10, 48

E

- Effects, color, 13 to 14
- Enhance Fine Details setting, 25, 28
- Enhancing photos, 14
- Epson
 - accessories, 4, 31, 33, 49
 - help, 48 to 49
- Error messages, 43 to 44
- Exif Print, 3, 14
- Expansion, borderless, 25, 28, 38
- External device port, 30 to 32

F

- Faint images, 46
- FCC compliance, 57
- Features, 3
- File formats, 3

G

- Gaps in image, 46
- Grainy prints, 46

H

- Help, 48 to 49

I

- Image
 - formats, 3
 - quality problems, 46
- Incorrect
 - colors, 46
 - margins, 47
- Ink, *see* Photo cartridge
- Internet support, 48 to 49

J

Jammed paper, 47

JPEG, 3

L

Landscape orientation, 27

Layout

- button, 9 to 10, 12 to 14

- lights, 9 to 10, 12 to 14

- Macintosh, 27

- problems, 47

- proof sheet, 12

- Windows, 25

Lever, cartridge, 34 to 36

License agreement, 16, 19

Lights

- Layout, 9 to 10, 12 to 14

- memory card, 6 to 7, 50

- On, 37, 44, 50

Lines in photos, fixing, 46

Loading paper, 5 to 6, 9, 47

Lock, cartridge, 34 to 36

M

Macintosh

- basic printing, 27 to 29

- Bluetooth printing, 32

- cancelling printing, 29

- installing software for, 18 to 20

- Printer Setup Utility, 19 to 20

Maintenance, 40 to 42

Manuals, 4, 17, 20

Margins

- eliminating, 38

- incorrect, 47

- see also* Layout

Memory card

- adapters, 7

- compatibility, 7, 43

- inserting, 6 to 7

- light, 6 to 7, 50

- problems, 45

- removing, 7, 15

- safety instructions, 50

Menu button, 9 to 10, 12 to 14

Mini-wallet size, 9 to 10, 12 to 14

Missing colors, 46

N

- Network installation, 45
- Noise, PictureMate Pal, 44
- Nozzles
 - checking, 41
 - cleaning, 40 to 41

O

- On button, 6, 15, 18, 37, 44, 50
- On light, 37, 44, 50
- Open button, 5, 6
- Orientation setting
 - Macintosh, 27
- Output tray, 5, 37

P

- Page Setup window, 27
- Paper
 - buying, 4, 33, 49
 - feeding problems, 47
 - jam, 47
 - loading, 5 to 6, 9, 47

Paper (*continued*)

- orientation, 27
 - output tray, 5, 37
 - size, 6, 27
 - storing, 11
 - support, 5 to 6, 37
- PDA, printing from, 31 to 32
- Photo
- choosing, 9 to 10
 - displaying, 11
 - enhancing, 14
 - formats, 3
 - paper, *see* Paper
 - printing, 9 to 10, 12 to 14, 21 to 29
 - quality problems, 46
 - saving to computer, 15, 20
 - storing, 11

Photo cartridge

- buying, 4, 33, 49
- charging, 36, 44
- door, 34 to 36
- information, 55 to 56
- lock, 34 to 36
- release lever, 34 to 36
- replacing, 33 to 36
- safety instructions, 52
- status, 36

Photo viewer screen

- adjusting contrast, 39
- blank, 44
- messages, 43 to 44
- problems, 44
- safety instructions, 53
- using, 9 to 14, 38 to 39, 40 to 42

PhotoImpression, ArcSoft, 20, 49

PictBridge camera, 3, 30 to 31

Picture and Fax Viewer, Windows, 21 to 26

Portrait orientation, 27

Power

- adapter, 37, 50 to 51
- cable, 37, 50 to 52
- problems, 44
- saving, 8
- turning off, 37
- turning on, 6, 15, 18

Preferences, setting, 38 to 39

Previewing printing, 9 to 10, 25, 39

Print

- button, 9 to 10, 12 to 14, 39
- preview, 9 to 10, 25, 39
- quality problems, 46
- speed, increasing, 45

Print head

- aligning, 41 to 42
- cleaning, 40 to 41

PRINT Image Matching (P.I.M.), 3, 14

Print Pack

- buying, 4, 33, 49
- information, 55 to 56
- replacing, 33 to 36
- safety instructions, 52
- status, 36

Printer Setup Utility, Macintosh, 19 to 20

Printing

- all photos, 9
- Bluetooth, 3, 31 to 32
- from camera, 30 to 31
- from PictureMate Pal, 9 to 10, 12 to 14
- Macintosh, 27 to 29
- preview, 9 to 10, 25, 39
- Windows, 21 to 26
- wireless, 3, 31 to 32

Problems

- blank pages, 47
- border or layout, 47
- color, 46
- copies, 48
- error messages, 43 to 44
- memory card, 45
- noise, 44
- paper feeding, 47
- paper jam, 47
- photo viewer screen, 44
- power, 44

Problems (*continued*)

- print quality, 46
 - printing, 44 to 45
 - slow printing, 45
 - software installation, 45
 - wrong photo, 48
- Proof sheet layout, 12

Q

- Quality problems, 46

R

- Release lever, 34 to 36
- Replacing photo cartridge, 33 to 36
- Requirements, 3, 45
- Resetting default settings, 39
- Resolution, 3

S

- Safety instructions, 50 to 53
- Saving power, 8

Screen

- adjusting contrast, 39
- blank, 44
- messages, 43 to 44
- problems, 44
- safety instructions, 53
- using, 9 to 14, 38 to 39, 40 to 42

Select All button, 3, 9

Sepia printing, 13, 25, 28

Service, 48 to 49

Sharpness, 14

Shut-off, automatic, 8

Size, paper, 6, 27

Smeared prints, 46

Software, installing, 15 to 20, 45

Speed, increasing print, 45

Stamp, date, 13 to 14

Start Here sheet, 4

Stopping printing

- Macintosh, 29

- PictureMate Pal buttons, 9

- Windows, 23, 26

Storing paper and photos, 11

Supplies, 4, 31, 33, 49

Support, 48 to 49

T

TIFF, 3

Transporting PictureMate Pal, 37

Troubleshooting, 43 to 49

Turning printer on or off, 6, 15, 37

U

USB cable, 15, 17 to 18, 30, 37

USB DIRECT-PRINT camera, 3, 30 to 31

User's Guide, 4, 17, 20

W

Wallet size, 9 to 10, 12 to 14

Warranty, 53 to 54

Windows

- basic printing, 21 to 26

- Bluetooth printing, 32

- cancelling printing, 26

- installing software for, 15 to 18

Wireless printing, 3, 31 to 32

Getting to Know PictureMate Pal

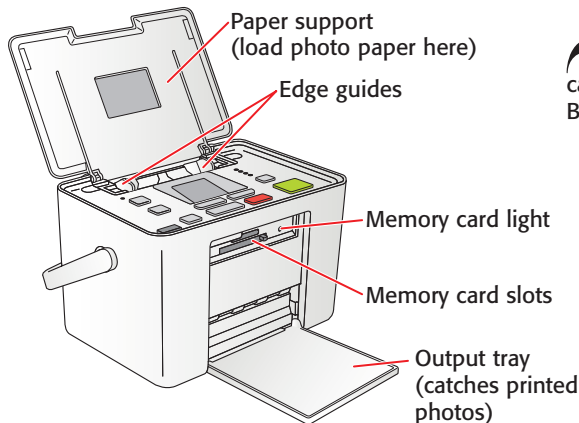
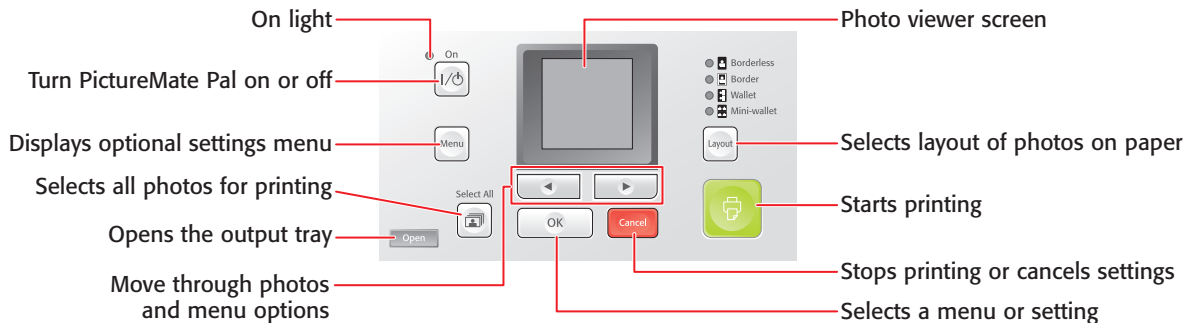

(USB) port for camera or optional Bluetooth™ adapter

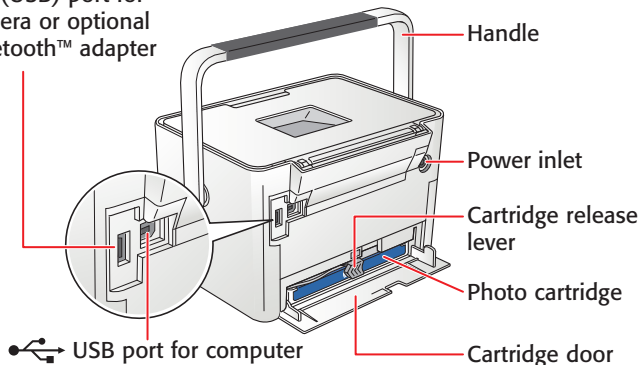

Need a New Print Pack?

The PictureMate 200 Series Print Pack has everything you need to print in one box: photo paper and a photo cartridge.

You can buy a PictureMate 200 Series Print Pack wherever PictureMate Pal is sold or from retailers that sell printer supplies.

The following Print Packs are available:



Print Pack contents	Part number	Supported PictureMate models
Glossy photo paper (150 sheets) and photo cartridge	T5846	PictureMate Pal and all other PictureMate 200 Series models
Matte photo paper (100 sheets) and photo cartridge	T5845-M	

You can also buy a Print Pack and other PictureMate Pal accessories from an Epson authorized reseller. To find the nearest reseller, call 800-GO-EPSON (800-463-7766). Or you can purchase online at www.epsonstore.com (U.S. sales) or www.epson.ca (Canadian sales).

For more PictureMate Pal information, special offers, and related accessories, visit www.MyPictureMate.com.

Snap



Print



Enjoy



410919100

CPD-21348R2
Printed in XXXXXX XX.XX-XX XXX