

## World Headquarters/ North America:

Hypercom Corporation  
2851 W. Kathleen Road, Phoenix, Arizona 85053, USA • Tel: +1.602.504.5000 • Fax: +1.602.866.5380

### HYC Latin America:

Hypercom Industria e Comercio LTDA  
Centro Empresarial Atibaia  
Rodovia Dom Pedro 1, KM 07, 5 Av.  
Tegula, 888-Ponte Alta  
Atibaia 12940-000, Brazil

Tel: +55.11.4417.7000  
Fax: +55.11.4417.7060

### HYC EMEA:

Hypercom EMEA  
Unit 2, Woking Eight  
Forsyth Road  
Woking, GU21 5SB,  
United Kingdom

Tel: +44.1483.718600  
Fax: +44.1483.718601

### HYC Asia:

Hypercom Asia  
21/F Metro Centre II  
21 Lam Hing Street  
Kowloon Bay, Kowloon  
Hong Kong

Tel: +85.2.2561.6800  
Fax: +85.2.2561.5890

### HYC Australia:

Hypercom Australia  
Unit 1,  
11 Orion Road  
Lane Cove, NSW 2066  
Australia

Tel: +612.9420.6444  
Fax: +612.9420.6466

©2004 Hypercom Corporation, all rights reserved. Hypercom and the Hypercom logo are registered trademarks of Hypercom Corporation. Optimum is a trademarks of Hypercom Corporation. All other products or services mentioned in this document are trademarks, service marks, registered trademarks or registered service marks of their respective owners.

Celebrating 26 years of technology excellence, innovation and leadership, Hypercom Corporation is a leading global provider of electronic payment solutions that add value at the point-of-transaction for consumers, merchants and acquirers, and yield increased profitability for its customers. Widely recognized as the global payment technology innovator, Hypercom delivers comprehensive card payment terminal, network and server solutions that help merchants and financial institutions generate revenues and increase profits.

Headquartered in Phoenix, Arizona, Hypercom's card payment terminal, network and server solutions are leading the transformation of electronic payments in more than 100 countries.

## COMPLIANCE:

- FCC Part 15 (ICES-003)
- UL/cUL Listed (UL 60950-1)
- RFID: FCC ID: NVA00001  
IC: 1204B-00001
- CE (Select Models)
- IEC 60950-1
- CISPR 22
- C-tick (Select Models)

Note: This equipment has been tested and found to comply with the limits for a Class A digital device, pursuant to Part 15 of the FCC Rules. These limits are designed to provide reasonable protection against harmful interference when the equipment is operated in a commercial environment. This equipment generates, uses and can radiate radio frequency energy and, if not installed and used in accordance with the instruction manual, may cause harmful interference to radio communications. Operation of this equipment in a residential area is likely to cause harmful interference in which case the user will be required to correct the interference at his own expense.

940432-002, Rev. A

07/04



www.hypercom.com

# Terminal Installation Guide



www.hypercom.com



# Optimum L4100 Installation Guide

## Equipment Check List →

### WARNING:

- Do not disassemble the AC adapter. Only qualified technicians should service the adapter.
- The AC adapter was designed for indoor use only; do not expose to rain or snow.
- Do not immerse in fluid.
- Changes or modifications not expressly approved can void the user's authority to operate the equipment.



Optimum L4100



AC Adapter



Power Cord

## Power Connection

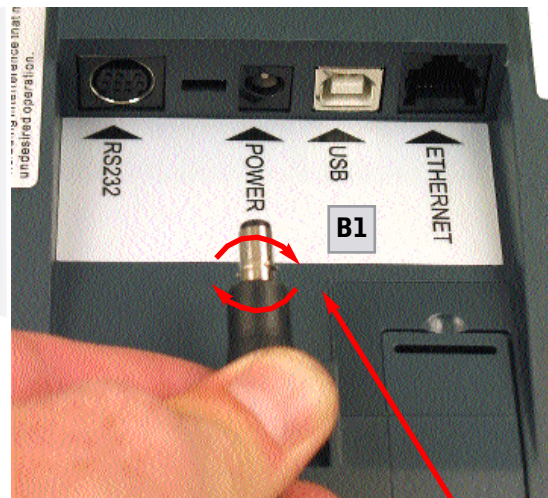
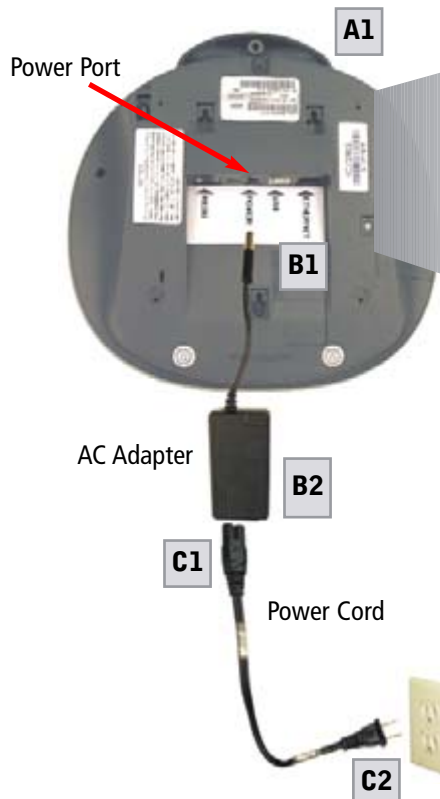

Insert and twist clockwise to lock

## Optional Equipment

If you are unable to purchase additional equipment through your bank or processor, contact TASQ Technology at **1.800.827.8297**.



RS232 Cable  
(P/N 810341-002)



Base Plate  
(P/N 600376-001)



Screen Protector  
(P/N 700351-002)