

ES-D3A

Wireless Door / Window Contact

[www.etiger.com](http://www.etiger.com)

## EN Box Content

- 1 x Door / Window Contact
- 1 x User Manual

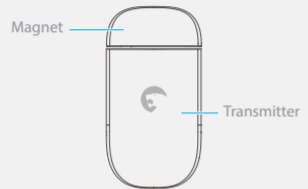

Images, illustrations and text are non-contractual. ETIGER and the ETIGER logo are registered trademarks and the property of ETIGER.  
Copyright © 2014 ETIGER. All rights reserved.

## Installation

- Open the case and remove the battery activation strip.
- Mount the sensor on the door and the magnet on the door frame.
- Make sure the magnet is placed above of the transmitter.
- Mount the magnet max. 1cm away from the transmitter and secure the transmitter and magnet with double-sided tape or screws.
- Avoid mounting the sensor in areas with a large amount of metal or electrical wiring, such as a furnace or utility room.

### Register the detector in the alarm system

Switch to Connection Mode on the control panel. Separate the magnet of the detector from its transmitter. The control panel beeps once: the detector is registered. If you hear two beeps, the detector has already been connected.

To check if the registration is complete, arm the system and separate the magnet from the transmitter again by opening the door or window on which it is installed. If the siren rings out, the registration is successful.

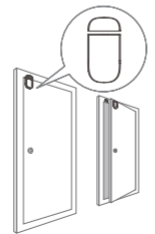

## PCB Layout

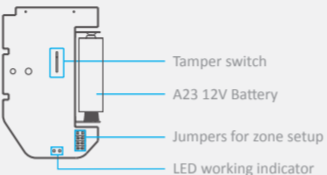

**Infrared sensor:** Detects the infrared rays released by human body motion. Do not touch the surface. Keep the surface clean.

**Tamper switch:** When the alarm system is armed, the tamper switch will trigger the alarm if the case is opened.

**Jumpers for Zone setup:** The jumpers enable you to assign the detector to a specific zone. Refer to the user manual of your alarm system for more information on zone set up.

## Specifications

**Power Supply:**  
DC 12V (A23 12V battery x1)

**Static current:**  
≤30 uA

**Alarm current:**  
≤40 mA

**Transmission distance**  
≤ 80 m (in open area)

**Radio-frequency:**  
315MHz (±75KHz)

**Housing material:**  
ABS plastic

**Operating conditions:**  
Temperature: -10°C ~ +55°C  
Relative Humidity: ≤80% (non-condensing)

**Transmitter dimensions:**  
60 x 43 x 18 mm

**Magnet dimensions:**  
19 x 43 x 18 mm

## LED indications

### Blinks once

The door or window is open and the transmitter sends a signal to the control panel.

### Blinks quickly

Low power indication: the batteries must be replaced.

## Standards



This product bears the selective sorting symbol for waste electrical and electronic equipment (WEEE). This means that this product must be handled pursuant to European Directive 2002/96/EC in order to be recycled or dismantled to minimize its impact on the environment. For further information, please contact your local or regional authorities. Electronic products not included in the selective sorting process are potentially dangerous for the environment and human health due to the presence of hazardous substances.



In compliance with European laws.



This product was designed and manufactured in compliance with Directive 2002/95/EC of the European Parliament and of the Council on the restriction of use of certain hazardous substances in electrical and electronic equipment (RoHS Directive - RoHS) and is deemed to comply with the maximum concentration values set by the European Technical Adaptation Committee (TAC).

Manufactured in China.



This user manual is available in other languages at  
[www.etiger.com/eu/support](http://www.etiger.com/eu/support)



ETIGER EUROPE  
Rue de la Loi, 25, 7100 La Louvière, Belgique  
[service@etiger.com](mailto:service@etiger.com)

## FCC Information and Copyright

This equipment has been tested and found to comply with the limits for a Class B digital device, pursuant to part 15 of the FCC Rules.

These limits are designed to provide reasonable protection against harmful interference in a residential installation. This equipment generates,

uses and can radiate radio frequency energy and, if not installed and used in accordance with the instructions, may cause harmful interference

to radio communications. However, there is no guarantee that interference will not occur in a particular installation. If this equipment does

cause harmful interference to radio or television reception, which can be determined by turning the equipment off and on, the user is

encouraged to try to correct the interference by one or more of the following measures:

- Reorient or relocate the receiving antenna.
- Increase the separation between the equipment and receiver.
- Connect the equipment into an outlet on a circuit different from that to which the receiver is connected.
- Consult the dealer or an experienced radio/TV technician for help.

### 15.19 Labelling requirements.

This device complies with part 15 of the FCC Rules. Operation is subject to the following two conditions:

- (1) This device may not cause harmful interference, and
- (2) this device must accept any interference received, including interference that may cause undesired operation.

changes or modifications not expressly approved by the party responsible for compliance could void the user's authority to operate the equipment.