

SuperTooth Gold

Bluetooth Handsfree Kit
For Bluetooth Mobile Phones



Product Description

SUPERTOOTH GOLD is a Bluetooth handsfree kit that supports headset or handsfree profile phones. Its special features include Full DSP Noise Cancellation/Echo Cancellation, thus, it provides an advanced audio quality. This kit also includes Text-To-Speech system. A voice will indicate you caller names and activated functions. It is designed for easy handsfree operation and superior performance.

Don't forget: Drive safely and within the law.

Check if the national or local legislation into force in your country does limit the use of mobile phones while driving. It is up to the user of this product to respect the said legislation in the area where he lives.

Product Overview

SUPERTOOTH GOLD (On Position)

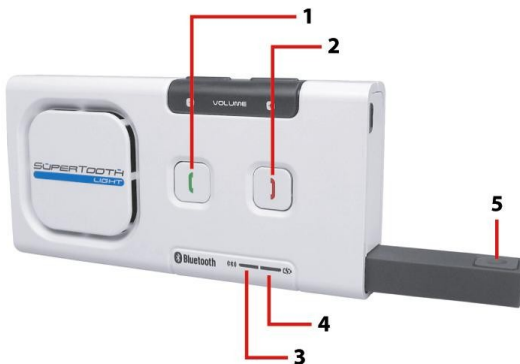

SUPERTOOTH GOLD (Off Position)



- 1 **Accept Button**
- 2 **End/Reject Button**
- 3 **Bluetooth Indicator**
- 4 **Charge Indicator**
- 5 **Microphone Shaft**
*Press-and-release to Switch On
*Push-in to Switch Off
- 6 **Speaker**
- 7 **Volume Down**
- 8 **Volume Up**
- 9 **Charger Port**
- 10 **Magnets**

SUPERTOOTH GOLD (Back View)

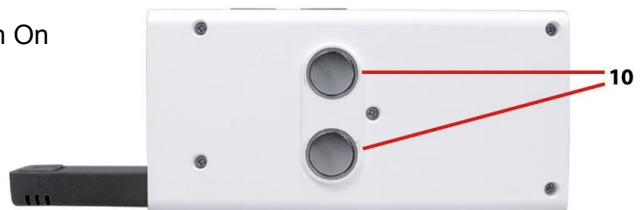

Charging

1. Connect the charger's plug into the **Charger Port (9)** of the SUPERTOOTH GOLD. Connect the charger to an external power source.

Charge Indicator (4) Status:

Steady orange: Charging

Steady green: Full Charge

2. When fully charged, disconnect the charger.

Power On/Off

Power On: Press-and-release the **Microphone Shaft (5)**.

A voice says, "Handsfree device ready".

Power Off: Push the **Microphone Shaft (5)** in.

A voice says, "Powering Down".

Pairing to your Bluetooth Mobile Phone

Pair the SUPERTOOTH GOLD to your Bluetooth mobile phone to create the link or audio connection between the two. This has to be done only at the first connection to a new phone.

1. From OFF, press and hold the **Accept Button (1)**.



2. While holding the **Accept Button (1)**, switch the kit on (Press-and-release the **Microphone Shaft (5)**).

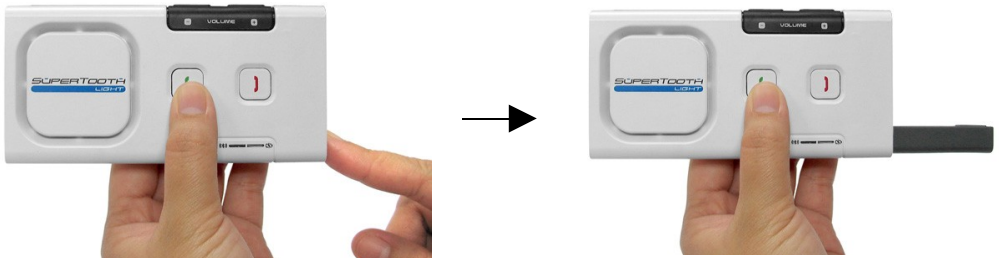

3. A voice says, "Please pair Bluetooth phone now. Enter pin code 0000". and the **Bluetooth Indicator (3)** turns blinking red/blue. The kit is now in pairing mode.

4. While the kit is in pairing mode, access the Bluetooth menu of your phone. Turn on the Bluetooth function then execute a Bluetooth search, or discover. (See your phone's manual.)
5. When the phone displays the list of Bluetooth devices, select **ST LIGHT**.
6. When the phone asks for the password/pin code, enter 0000 and press **Ok**. The voice says, "Pairing successful to Bluetooth phone."

Important Note: The kit is paired now. Most phones automatically connect to the kit after pairing. With some phones you need to connect manually after pairing.

Go back to **Bluetooth > Paired devices > highlight ST LIGHT > press Options > then press Connect.**

The kit is now ready to use.

Installation

Fix the metal clip of SUPERTOOTH GOLD on the sun visor.



Attach the magnetic back of SUPERTOOTH GOLD to the fixed metal clip. The SUPERTOOTH GOLD must be placed in such way that its microphone is directed to the mouth of the user.

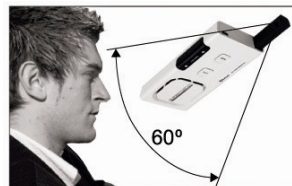

Basic Operations

IMPORTANT:

The kit needs to be 'paired' to your Bluetooth mobile phone first, before you can use the following functions. See **Pairing to your Bluetooth Mobile Phone** on page 3.

Make a Call (Normal Dial):

Dial the number on your phone. Audio will automatically be on the kit.

Answer a Call:

During the ring tone, press **Accept Button (1)** for 1 second to answer the call.
A voice will say, "Call from..."

End a Call:

Press **End/Reject Button (2)** for 1 second to end the call.
The voice will say, "End of call".

Voice Dial:

Important: Be sure the voice dialing function of your phone is activated. Record at least one **voice tag**. (Kindly refer to the procedure in your phone's manual.)
Important: *Voice dialing entries must be stored in the phone's memory, not on the SIM card!*

1. Press the **Accept Button (1)** for 1 second.
2. A voice dial beep will be heard on the kit to prompt the user to say the voice tag of the contact to call.
3. Say the voice tag exactly as how you recorded it.
4. The voice will be played back to you, and then the phone will dial the number automatically.

Note: **Voice dial deactivation:** If you press the **Accept Button (1)** for 1 second, it activates voice dial. But if you want to deactivate it (just after you activated), press the same button again for 1 second. It will be deactivated immediately.

Redial (For Handsfree Profile Phones only):

Press **Accept Button (1)** for 3 seconds. The last dialed number will be redialed.

Reject a Call (For Handsfree Profile Phones only):

During the ring tone, press **End/Reject Button (2)**. The incoming call will be rejected.

Volume Setting:

Increase or decrease the volume by pressing the **Volume Up (8)** or **Volume Down (7)** button. Pressing repeatedly will increase or decrease the volume by 1 level.

Note: For fast increment/decrement, press and hold **Volume Up** or **Down** until desired level is reached.

Audio Transfer (For Handsfree Profile Phones only):

During an ongoing call, you can transfer the audio.

Kit to Phone: Press the **Accept Button (1)** for 3 seconds. The audio will be transferred to the phone.

Phone to Kit: Press the **Accept Button (1)** for 1 second. The audio will be transferred to kit.

Buttons Mapping

Buttons Kit Status	Accept Button / (Short press/ 1 second)	Accept Button / (Long press / 2 seconds)	End / Reject Button (Short press)	Volume Up / Volume Down (Short Press)	Volume Up / Volume Down (Long Press)
Connected / On and Standby	Initiates Voice dial	Redials last dialed number		Increases/ Decreases volume by 1 level	Volume fast increment/ decrement
On and Standby but Disconnected	Creates reconnection/ initiates voice dial				
Incoming call (ring being generated)	Answers the call		Rejects the call		
Active call on ST LIGHT		Transfers audio to phone	Ends the call		
Active call on Phone	Transfers audio to kit				
Outgoing call being set-up			Ends the call		

SUPERTOOTH GOLD Specifications

<i>Bluetooth Compliance:</i>	<i>Bluetooth version 2.0 specifications</i>
<i>Supported Bluetooth Profiles:</i>	<i>Supports headset and handsfree profiles with automatic detection</i>
<i>Operating Range:</i>	<i>Up to 10 meters</i>
<i>Frequency:</i>	<i>2.4 GHz</i>
<i>Talk Time:</i>	<i>Up to 15 hours</i>
<i>Stand-by time:</i>	<i>Up to 800 hours</i>
<i>Charging Time:</i>	<i>3 hours</i>
<i>Battery Type:</i>	<i>Rechargeable Lithium Ion</i>
<i>Special Features:</i>	<ul style="list-style-type: none">▪ <i>Full Duplex</i>▪ <i>Full DSP Noise Cancellation / Echo Cancellation</i>▪ <i>Digital Volume Control</i>▪ <i>Voice Recognition Dialing (If phone supports)</i>▪ <i>Last Call Redial</i>▪ <i>Reject Incoming Call</i>▪ <i>Can also be charged directly from a PC via USB Cable (not included)</i>▪ <i>Compact Size</i>
<i>Installation:</i>	<i>Quick fixation on sun visor via magnetic clip</i>
<i>Dimensions (mm):</i>	<i>18.2 x 60.2 x 122</i>
<i>Weight:</i>	<i>115 g</i>

English

Correct Disposal of This Product

(Waste Electrical & Electronic Equipment)

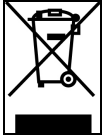

(Applicable in the European Union and other European countries with separate collection systems)

This marking shown on the product or its literature, indicates that it should not be disposed with other household wastes at the end of its working life. To prevent possible harm to the environment or human health from uncontrolled waste disposal, please separate this from other types of wastes and recycle it responsibly to promote the sustainable reuse of material resources.

Household users should contact either the retailer where they purchased this product, or their local government office, for details of where and how they can take this item for environmentally safe recycling.

Business users should contact their supplier and check the terms and conditions of the purchase contract. This product should not be mixed with other commercial wastes for disposal.

CE 0678

English

This equipment is in compliance with the essential requirements and other relevant provisions of Directive 1999/5/EC.

CE info:

<http://www.supertooth.fr/download>

Euro Communication Equipements sas

D117 Route de Foix

F 11500 NEBIAS

Federal Communications Commission (FCC) Statement

15.21

You are cautioned that changes or modifications not expressly approved by the part responsible for compliance could void the user's authority to operate the equipment.

15.105(b)

This equipment has been tested and found to comply with the limits for a Class B digital device, pursuant to part 15 of the FCC rules. These limits are designed to provide reasonable protection against harmful interference in a residential installation. This equipment generates, uses and can radiate radio frequency energy and, if not installed and used in accordance with the instructions, may cause harmful interference to radio communications. However, there is no guarantee that interference will not occur in a particular installation. If this equipment does cause harmful interference to radio or television reception, which can be determined by turning the equipment off and on, the user is encouraged to try to correct the interference by one or more of the following measures:

- Reorient or relocate the receiving antenna.
- Increase the separation between the equipment and receiver.
 - Connect the equipment into an outlet on a circuit different from that to which the receiver is connected.
- Consult the dealer or an experienced radio/TV technician for help.

Operation is subject to the following two conditions:

- 1) this device may not cause interference and
- 2) this device must accept any interference, including interference that may cause undesired operation of the device.

FCC RF Radiation Exposure Statement:

This equipment complies with FCC radiation exposure limits set forth for an uncontrolled environment. End users must follow the specific operating instructions for satisfying RF exposure compliance. This transmitter must not be co-located or operating in conjunction with any other antenna or transmitter.