

# Installation Instructions

## General Introduction

The SR804 Wireless Keyfob is used to Arm, Partial Arm and Disarm the system. The Keyfob also incorporates a Panic switch that will immediately initiate a Full Alarm condition when the system is Armed or Disarmed. Its great compatibility with our U-Net family security products makes it suitable for smart home cloud based platforms such as Homesys

## Product Overview

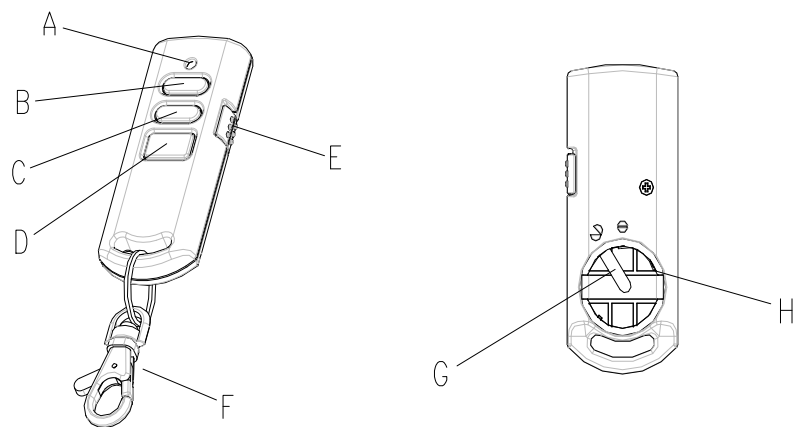

A	LED indicator	B	Arm	C	Partial Arm
D	Disarm	E	Panic Switch	F	Key Chain Ring
G	Negative Polarity	H	Positive Polarity		

## Binding with Homesys

1. Remove the battery cover behind the keyfob.
2. Prepare the CR2032 coin cell battery by removing any plastic wrapping on the battery. Do not insert the batteries yet into the unit.
3. Log into the Homesys account from a web browser.

4. Select "System", then "Add a New Device".

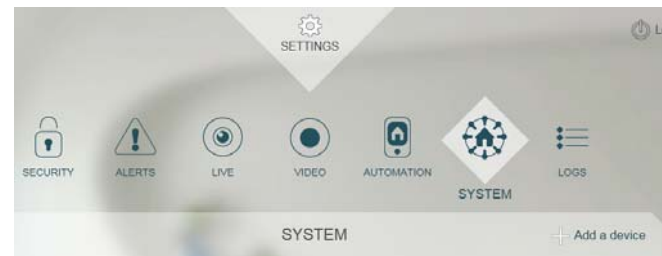

5. Select "Keyfob".



6. The following screen will appear. This means the gateway is entering binding mode.



7. Insert the battery ensuring that the +v terminal faces upwards away from the PCB and replace the battery cover.

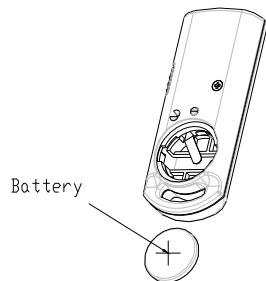

8. The screen below will appear in 10 seconds if the process is successful.

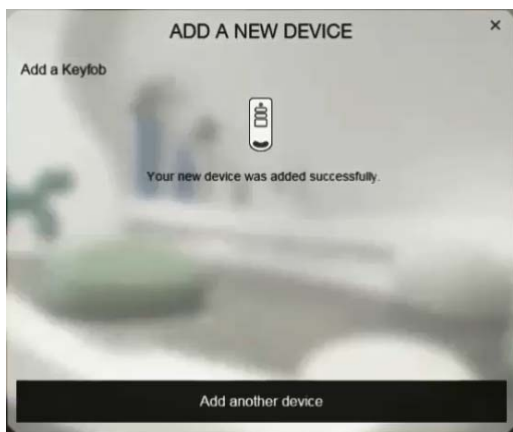

9. Time-out will occur if the binding process was unsuccessful. Please refer to the "Manual binding" section.

### Manual Binding

1. With the battery inserted, repeat steps 3 to 6 of the Binding with Homesys section.
2. Press and hold the Disarm button for more than 3 seconds until the LED flashes moderately (on for 2 second; off for 2 second). This implies keyfob has now entered the binding mode and is waiting to receive binding signals from the gateway.

3. Within 5 secs, the LED indicator then stop flashing and turn off, indicating the learning procedure is completed. The screen below will appear indicating the process is successful.



4. If after 30 seconds LED flashes rapidly for 3 times, it means the keyfob fails the binding process

## Operation & Testing

### Operating the Keyfob

There are 5 operating modes provided by the keyfob.

1. ARM : Press and release the ARM button.
2. DISARM : Press and release
3. PARTIAL ARM 1: Press and release the Partial Arm button once
4. PANIC: Slide the Panic Switch and hold for at least 3 secs before releasing.

**Note:** The LED on the keyfob will turn green after button press is released. This implies the keyfob receives a confirmation signal from the Gateway. Instead if the LED turns red, this means the keyfob did not receive the reply from gateway

### Testing the Keyfob

1. Press the Arm button to see if there is an entry in the LOGS page of your Homesys account.
2. Press the Partial Arm button to see if there is an entry in the LOGS page of your Homesys account.
3. Press the Disarm button to see if there is an entry in the LOGS page of your Homesys account.
4. Slide the Panic Switch and hold for at least 3 secs before releasing. See if there is an entry in the LOGS page of your Homesys account.

**Note:** Press the Disarm button to deactivate a triggered alarm and siren sound.

## Maintenance

Low Battery: When the battery becomes low, the LED will turn orange after each press to indicate low battery condition to the user. Replace the battery when this occurs.

## Troubleshooting

The troubleshooting table lists some possible causes and solutions. Please contact your original retailer or nearest service center if the below solutions cannot solve your problem.

Symptom	Cause of Failure	Recommendation
LED cannot be displayed	<ol style="list-style-type: none"> <li>1. Run out of battery power.</li> <li>2. Check if reverse battery polarity.</li> </ol>	<ol style="list-style-type: none"> <li>1. Replace a new battery.</li> <li>2. Refit the battery with correct polarity.</li> </ol>
LED turns red after pressing the button	<ol style="list-style-type: none"> <li>1. Keyfob is out of range of the gateway.</li> </ol>	<ol style="list-style-type: none"> <li>1. Move closer to the gateway</li> <li>2. Hold the keyfob higher and press again.</li> </ol>
LED blinks green slowly for 30secs after power on.	<ol style="list-style-type: none"> <li>1. Keyfob has not bind with Gateway</li> </ol>	<ol style="list-style-type: none"> <li>1. Remove the battery and perform binding with Homesys procedure.</li> </ol>

### LED Table

The table below summarizes the LED indication of the keyfob.

Function	LED Indication
RF transmission	Green LED illuminating for 1 second
Failed RF transmission	Red LED illuminating for 1 second
Low battery	Orange LED illuminating for 1 second
Binding in process	LED flashing with an interval of 2 seconds
Binding successful	Green LED illuminating for 0.5 seconds
Binding timeout	Green LED flash 3 times.

## Reset to Factory Settings

1. Remove the battery from the keyfob.
2. Using two fingers, press and hold both the Arm and Disarm simultaneously while inserting the battery.
3. Keep pressing both buttons for more than 5 secs until the detector's LED blinks red, this implies the device is reset back to factory mode.

**Note:** After power on, the Keyfob will automatically enter "Auto-binding" mode to bind with a gateway. The auto-binding process lasts for 30 seconds indicated by the LED blinking slowly.

## Specifications

Battery	CR2032 3V/230mAh
Operating Frequency	868MHz (EU)/ 923MHz (America)
Operating Temperature	-10°C to 40°C

\*\* Specifications are subject to change without notice.



### WARNING:

Do not dispose of electrical appliances as unsorted municipal waste, use separate collection facilities instead. Please contact your local government for information regarding the collection systems available.

If electrical appliances are disposed of in landfills or dumps, hazardous substances can leak into the groundwater and get into the food chain, damaging your health and well-being.

When replacing old appliances with new once, the retailer is legally obligated to take back your old appliance for disposal at least for free of charge.

### Federal Communication Commission Interference Statement

This equipment has been tested and found to comply with the limits for a Class B digital device, pursuant to Part 15 of the FCC Rules. These limits are designed to provide reasonable protection against harmful interference in a residential installation. This equipment generates, uses and can radiate radio frequency energy and, if not installed and used in accordance with the instructions, may cause harmful interference to radio communications. However, there is no guarantee that interference will not occur in a particular installation. If this equipment does cause harmful interference to radio or television reception, which can be determined by turning the equipment off and on, the user is encouraged to try to correct the interference by one of the following measures:

- Reorient or relocate the receiving antenna.
- Increase the separation between the equipment and receiver.
- Connect the equipment into an outlet on a circuit different from that to which the receiver is connected.
- Consult the dealer or an experienced radio/TV technician for help.

This device complies with Part 15 of the FCC Rules. Operation is subject to the following two conditions: (1) This device may not cause harmful interference, and (2) this device must accept any interference received, including interference that may cause undesired operation.

FCC Caution: Any changes or modifications not expressly approved by the party responsible for compliance could void the user's authority to operate this equipment.

This transmitter must not be co-located or operating in conjunction with any other antenna or transmitter.



EVERSPRING

[www.everspring.com](http://www.everspring.com)

3F., No. 50, Sec 1, Zhonghua Rd., Tucheng Dist.,  
New Taipei City 23666, R.O.C

A501112387R01