

Installing the ExtremeWirelessIndoor 802.11 a/ ac+b/g/n AP3915e Access Point

Overview of the AP3915e

The AP3915e is an 802.11AC Wave 2 Access Point featuring dual 2x2:2 radios. The all-metal design supports high operating temperatures, external antennas, and flexible mounting options for wall mount, ceiling mount, beam, and T-bar. The AP can be powered by 802.3af/at or by using a 12VDC wall brick power source.

Note: The AP3915e requires a minimum base firmware of 10.41.

The AP3915e model has the following features:

- Radios: 2 radios (2.4GHz and 5GHz); 1 IoT/BLE Radio (2.4 GHz)
- Console Port: RJ45
- One RJ45, 10/100/1000 Ethernet Port (LAN1) with PoE
- LEDs: 4 (see Figure 2)
- One Reset button
- Power: PoE 802.3at; 12VDC power in connector (see Table 1)
- Antennas:
 - Three **external** antennas (two dual band antennas and one IoT/BLE antenna)
 - RSPMA mount style antenna connectors
- External USB 2.0 port with features to support a locking module
- Safety Hangar provision
- Temperature:
 - -20 to +55°C ambient temperature anywhere
 - -20 to +60°C ambient temperature near sea level
- Enclosure: Metal

Figure 1 shows the top and side views of the AP3915e.

Figure 1 Top and Side Views of AP3915e

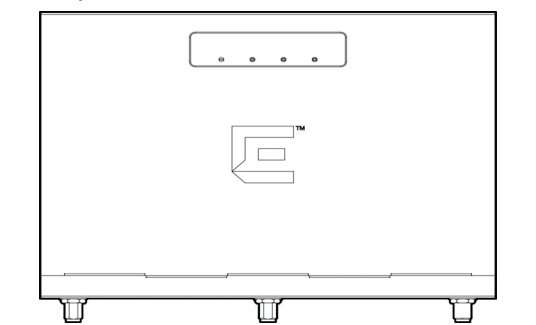

- 1 2.4G/5G Radio Antenna Connector
- 2 GE1/PoE
- 3 Console RJ45 connector
- 4 Reset button
- 5 Optional 12V DC power supply
- 6 IoT/BLE Radio Antenna Connector
- 7 Kensington Lock Slot
- 8 2.4G/5G Radio Antenna Connector

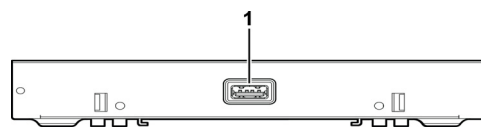

- 1 USB Port

Table 1 shows ways to power the AP3915e.

Table 1 Powering the AP3915e

Power Source	Description
Power over Ethernet (PoE)	Power is provided through the RJ45 Ethernet port (GE1 port) of AP3915e. This is the usual method of powering the AP on ceiling and high wall installations.
External 12V DC power supply (optional)	The AP3915e can also be powered by an external DC power supply plugged into an AC source. Plug the supply's input jack into the DC-In port (callout 5 in Figure 1).

Figure 2 shows the LEDs on the front of the AP3915e.

Figure 2 LEDs on AP Front Face

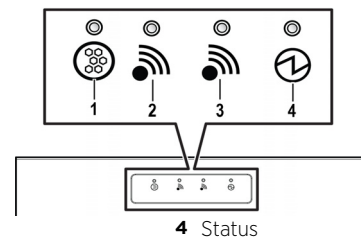

- 1 IoT Radio
- 2 Radio 1, 5GHz
- 3 Radio 2, 2.4GHz

Both the Radio LEDs will be Green when they are ON and the LEDs will not have any lights when they are OFF. Blue LED indicates the IoT status.

For detailed installation information about the AP3915e, see the *Extreme Networks Wireless AP3915e Installation Guide*.

Verifying the AP3915e Box Contents

Verify the contents of the box and ensure that the following items are available:

Table 2 Contents of the AP3915e Box

Quantity	Item
1	AP3915e Quick Reference Guide
1	Cloud Quick Start Card
The following hardware is included:	
2	Phillips Pan-head wood screws
2	Screw-in anchors

Mounting and Connecting the AP

Electrical Hazard: Only qualified personnel should perform installation procedures.

Use these instructions as guidelines for mounting and connecting the AP3915e easily and safely.

The AP3915e does not come with any bracket for mounting on a solid ceiling or junction/gang box. The optional bracket (WS-MBI-WALL04) is sold separately.

You must also purchase the optional adapter if you want to mount the AP on a beam.

For more information about installing the optional bracket and the adapter, see the *Extreme Networks Wireless AP3915e Installation Guide*.

For installation videos of the AP, see www.extremenetworks.com/support/

Note: The slot and lock cuts in the rear of the AP (Figure 3) are used for mounting the Wall/Junction Box/Gang Box bracket. The brackets can be mounted in two directions and so, the antennas on the AP can point up or down.

Mounting the AP on a Wood Wall/Solid Flat Ceiling

To install the AP on a dry wall or flat surface:

Option 1: Using the Philips Pan-head wood screws

- 1 Drill two holes 104mm (4.100") apart from each other on the wall where you want to mount the AP.
- 2 Insert the screws into the holes and use the screw-in anchors if needed.

Note: Leave 1/8" gap between the screw head and the wall.

- 3 Insert the Ethernet cable's RJ45 connector into the LAN1/GE1 port.
- 4 Align the AP against the screw heads and slide it down. Ensure that the AP is secured in place and tightened. If the AP is loose, unmount the AP and decrease the distance between the screw head and the wall. Remount the AP.

Figure 3 Attaching AP to a Wall

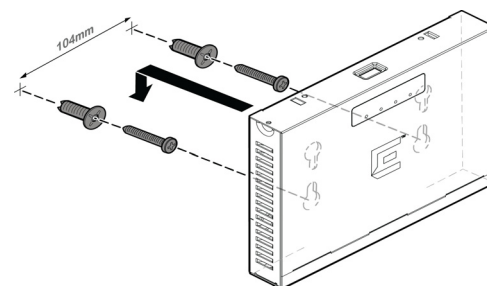

Option 2: Using an optional Wall and Box bracket

Note: Mounting the AP to a flat ceiling/wall requires the WS-MBI-WALL04 (Ordering Part #30516) bracket, which must be purchased separately.

- 1 Install the WS-MBI-WALL04 bracket onto a wall/ceiling with two screws and anchors and ensure that the locking tab is on the top side.
- 2 Use the optional wall and box bracket as a template and mark the holes to be used to mount as "A" or "B" and mark the hole centers on the attachment surface.
- 3 Drill the holes and attach the bracket using the screws and anchors provided in the kit.

Figure 4 Attaching the AP to a wall using the WALL04 bracket

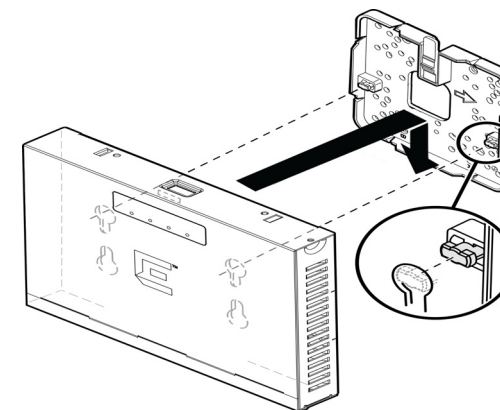

Note: If the holes that you need to use are not near the corners of the bracket, break off the corner to decrease bracket's visibility once the AP is installed.

- 4 Connect the LAN/Ethernet cable to the back of the AP.
- 5 Slide the AP onto the keyhole posts in the bracket, push down, and lock it into place.

Mounting the AP to a Bracket on a Junction or Gang Box

To mount the AP to a Bracket on a Junction or Gang box:

- 1 Use the Wall and Box Bracket (WS-MBI-WALL04 (Ordering Part #30516) that needs to be purchased separately).
- 2 Remove the screws from the junction/gang box.
- 3 Line up the bracket holes on the junction/gang box and ensure that they align. If the holes do not align, drill new holes.

Note: When you line up the holes, the locking tab on the bracket must be pointing up and the junction/gang box must be fully covered by the bracket. The bracket must be square to the rest of the room walls and the two holes that are being used must be on the opposite sides of large center hole on the bracket.

- 4 Using the holes aligned together or the new ones drilled, attach the bracket to the junction/gang box using the screws removed from the box earlier.
- 5 Attach the AP to the bracket as shown in Figure 4.

Mounting the AP to a Suspended or Drop Ceiling

To attach the AP on a Suspended or Drop ceiling, use the Multi T-bar bracket.

- 1 Slide the T-bar ceiling mount bracket base into the back of the access point. The locking tab fits into the grooves in the outside of the AP.
- 2 Gently raise the slider locking tab and open the movable sliding part of the bracket to give the stationary slider more space.
- 3 Hook the stationary end of the T-bar bracket onto the T-bar.
- 4 Tilt the AP slightly in such a way that the T-bar bracket will hold both sides of the T-bar.
- 5 Squeeze the bracket parts together until you hear the bracket's movable part locking tab click into place.
- 6 Hold the AP and rock it back and forth to ensure that it is securely mounted.
- 7 Attach the Ethernet cable's RJ45 connector to the LAN1/GE1 port and place the ceiling tile back in place.

Mounting the AP to a Beam

To attach an AP to a beam, attach an adaptor to the Multi T-bar bracket.

- 1 Attach the adaptor to the multi T-bar bracket by spreading the sliding part of the multi T-bar bracket.
- 2 Insert the adaptor in such a way that the T-bar holding clips Squeeze the sliding part of the multi T-bar bracket together to secure the adaptor in place.
- 3 Place the adaptor on a beam in such a way that there is enough space between the screw and clamp to be tightened.
- 4 Use the screw and clamp on the top of the adaptor to secure the AP in place on the beam.

- 5 Insert the Ethernet plug onto the AP.
- 6 Slide the AP onto the multi T-bar bracket.

For detailed procedure on Installing the AP, see the *Extreme Networks Wireless AP3915e Installation Guide*.

Connecting a Power Supply to the AP3915e

If you need to power the AP3915e with an external 12V DC power supply, you can plug the power cord into the power connector (callout 5 in Figure 1) on the back of the AP. There is no wall mount bracket for the 12V DC power supply. When the device is powered on, the power LED on the front face of the AP is lit. Refer to the *Extreme Networks Wireless AP3915e Installation Guide* for information about optional power supplies.

LAN/Console Connections

The AP3915e has one GE1 (Ethernet) port and a Console port. Refer to Figure 1 for the location of these ports. During administration and maintenance through the GE1 or Console, the AP must still have a power connection through either an Ethernet PoE cable or a DC power supply.

Professional Installation Instruction

Installation personal

This product is designed for specific application and needs to be installed by a qualified personal who has RF and related rule knowledge. The general user shall not attempt to install or change the setting.

Installation location

The product shall be installed at a location where the radiating antenna can be kept 36 cm from nearby person in normal operation condition to meet regulatory RF exposure requirement.

External antenna

Use only the antennas which have been approved by the applicant. The non-approved antenna(s) may produce unwanted spurious or excessive RF transmitting power which may lead to the violation of FCC/IC limit and is prohibited.

Installation procedure

Please refer to user's manual for the detail.

Warning: Please carefully select the installation position and make sure that the final output power does not exceed the limit set force in relevant rules. The violation of the rule could lead to serious federal penalty.

Instructions d'installation professionnelle

Installation

Ce produit est destine a un usage specifique et doit etre installe par un personnel qualifie maitrisant les radiofrequences et les regles s'y rapportant. L'installation et les réglages ne doivent pas etre modifiés par l'utilisateur final.

Emplacement d'installation

En usage normal, afin de respecter les exigences reglementaires concernant l'exposition aux radiofrequences, ce produit doit etre installe de facon a respecter une distance de 36 cm entre l'antenne emettrice et les personnes.

Antenn externe

Utiliser uniuquement les antennes approuvees par le fabricant. L'utilisation d'autres antennes peut conduire a un niveau de rayonnement essentiel ou non essentiel depassant les niveaux limites definis par FCC/IC, ce qui est interdit.

Procedure d'installation

Consulter le manuel d'utilisation.

Warning: Avertissement: Choisir avec soin la position d'installation et s'assurer que la puissance de sortie ne depasse pas les limites en vigueur. La violation de cette regle peut conduire a de serieuses penalites federales.

Operational Description of Antenna Configuration and RF Output Power Setting

Per KDB 353028 D01 Antennas Part 15 Transmitters v01 requirement, Applications must contain an exhibit listing each antenna, the antenna gain, antenna type, and antenna

manufacturer/vendor and output power that can be used for the device, that the info listed below are correct and represent the product in consideration under this filing.

No.	Function	Type	Manufacturer/ Vendor	Model	Gain (dBi)		Connector	Limit of MAX. Output Power(mW)				
					2.4GHz Band	5GHz Band		24GHz	5GHz UNII-1	5GHz UNII-3	BT-LE	Zigbee
1	WLAN	Dipole	Wha Yu	ML-2452-APA2-01	3.17	4.85	RP-SMA Male	347.575	355.022	382.663	---	---
2	WLAN	Dipole	Wha Yu	ML-2452-APA2-02	3	5	RP-SMA Male	347.575	355.022	382.663	---	---
3	WLAN	Dipole	Laird	ML-2452-HPA5-036	3	5	RP-SMA Male	347.575	355.022	382.663	---	---
4	WLAN	Dipole	Laird	ML-2452-HPAG4A6-01	4	7.3	N Male	337.824	374.496	371.702	---	---
5	WLAN	Dipole	Vertev	ML-2452-HPA6M4-S36	6.0	6.0	RP-SMA	337.824	374.496	371.702	---	---
6	WLAN	Panel	Laird	ML-2452-PNL9M3-036	11.0	10.7	RP-SMA Male	305.978	320.793	335.324	---	---
7	WLAN	Panel	Laird	ML-2452-PNL6M3-N36	6	6	N Male	330.856	245.252	333.341	---	---
8	WLAN	Panel	Laird	ML-2452-PNA5-01R	5.5	6	N Male	330.856	245.252	333.341	---	---
9	WLAN & BT LE & Zigbee	Panel	Laird	ML-2452-PNA7-01R	7.8	10.7	N Male	330.856	245.252	333.341	1.259	1.622
10	WLAN	Patch	Laird	ML-2452-PTA2M2-036	4	5	RP-SMA Male	360.481	374.632	382.259	---	---
11	WLAN	Patch	Laird	ML-2452-PTA4M4-036	5	6.6	RP-SMA Male	360.481	374.632	382.259	---	---
12	BT LE & Zigbee	Omni	Laird	ML-2499-HPA8-01	8	-	Fixed N-Male Std polarity	---	---	---	1.259	1.622

Regulatory and Compliance Information Safety Guidelines

This section contains notices that are intended to protect your personal safety and prevent damage to the equipment.

Qualified Personnel:

Electrical Hazard: Only qualified personnel should perform installation procedures. Within the context of the safety notes in this documentation, qualified persons are defined as persons who are authorized to commission, ground and label devices, systems, and circuits in accordance with established safety practices and standards. A qualified person understands the requirements and risks involved with installing outdoor electrical equipment in accordance with national codes.



Federal Communications Commission (FCC) Notice
This equipment has been tested and found to comply with the limits for a Class B digital device, pursuant to Part 15 of the FCC Rules. These limits are designed to provide reasonable protection against harmful interference in a residential installation. This equipment generates, uses and can radiate radio frequency energy and, if not installed and used in accordance with the instructions, may cause harmful interference to radio communications. However, there is no guarantee that interference will not occur in a particular installation. If this equipment does cause harmful interference to radio or television reception, which can be determined by turning the equipment off and on, the user is encouraged to try to correct the interference by one of the following measures:

- Reorient or relocate the receiving antenna.
- Increase the separation between the equipment and receiver.
- Connect the equipment into an outlet on a circuit different from that to which the receiver is connected.
- Consult the dealer or an experienced radio/TV technician for help.

Caution: Any changes or modifications not expressly approved by the party responsible for compliance could void the user’s authority to operate this equipment.

This device complies with Part 15 of the FCC Rules. Operation is subject to the following two conditions: (1) This device may not cause harmful interference, and (2) this device must accept any interference received, including interference that may cause undesired operation.

This transmitter must not be co-located or operating in conjunction with any other antenna or transmitter.
Operations in the 5.15-5.25GHz band are restricted to indoor usage only.



Warning: FCC Radiation Exposure Statement: This equipment complies with FCC radiation exposure limits set forth for an uncontrolled environment. This equipment should be installed and operated with minimum distance 31cm between the radiator & your body.

Industry Canada Notice

This device complies with ISED’s licence-exempt RSSs. Operation is subject to the following two conditions: (1) This device may not cause harmful interference, and (2) this device must accept any interference received, including interference that may cause undesired operation.

Le présent appareil est conforme aux CNR d’ ISED applicables aux appareils radio exempts de licence. L’exploitation est autorisée aux deux conditions suivantes : (1) le dispositif ne doit pas produire de brouillage préjudiciable, et (2) ce dispositif doit accepter tout brouillage reçu, y compris un brouillage susceptible de provoquer un fonctionnement indésirable.

Caution :

- The device for operation in the band 5150-5250 MHz is only for indoor use to reduce the potential for harmful interference to co-channel mobile satellite systems;
- The maximum antenna gain permitted for devices in the band 5725-5850 MHz shall be such that the equipment still complies with the e.i.r.p. limits specified for point-to-point and non-point-to-point operation as appropriate; and
- Users should also be advised that high-power radars are allocated as primary users (i.e. priority users) of the bands 5650-5850 MHz and that these radars could cause interference and/or damage to LE-LAN devices.

Avertissement:

- les dispositifs fonctionnant dans la bande 5150-5250 MHz sont réservés uniquement pour une utilisation à l’intérieur afin de réduire les risques de brouillage préjudiciable aux systèmes de satellites mobiles utilisant les mêmes canaux;

- le gain maximal d’antenne permis (pour les dispositifs utilisant la bande de 5725 à 5 850 MHz) doit être conforme à la limite de la p.i.r.e. spécifiée pour l’exploitation point à point et l’exploitation non point à point, selon le cas;
- De plus, les utilisateurs devraient aussi être avisés que les utilisateurs de radars de haute puissance sont désignés utilisateurs principaux (c.-à-d., qu’ils ont la priorité) pour les bandes 5650-5850 MHz et que ces radars pourraient causer du brouillage et/ ou des dommages aux dispositifs LAN-EL.

Warning: IC Radiation Exposure Statement: This equipment complies with ISED radiation exposure limits set forth for an uncontrolled environment. This equipment should be installed and operated with minimum distance 36cm between the radiator & your body.



Warning: Déclaration d’exposition aux radiations: Cet équipement est conforme aux limites d’exposition aux rayonnements ISED établies pour un environnement non contrôlé. Cet équipement doit être installé et utilisé avec un minimum de 36 cm de distance entre la source de rayonnement et votre corps.



單元 Unit	限用物質及其化學符號 Restricted substances and its chemical symbols					
	鉛Lead (Pb)	汞Mercury (Hg)	鎘Cadmium (Cd)	六價鉻 Hexavalent chromium (Cr ⁶⁺)	多溴聯苯 Polybrominated biphenyls (PBB)	多溴二苯醚 Polybrominated diphenyl ethers (PBDE)
金屬零件 (Metal Parts)	○	○	○	○	○	○
電路模組 (Circuit Modules)	—	○	○	○	○	○
電纜及電纜組件 (Cables & Cable Assemblies)	○	○	○	○	○	○
塑料和聚合物零件 (Plastic and Polymeric parts)	○	○	○	○	○	○
備考1. “超出0.1 wt %” 及 “超出0.01 wt %” 係指限用物質之百分比含量超出百分比含量基準值。 Note 1 : “Exceeding 0.1 wt %” and “exceeding 0.01 wt %” indicate that the percentage content of the restricted substance exceeds the reference percentage value of presence condition.						
備考2. “○” 係指該項限用物質之百分比含量未超出百分比含量基準值。 Note 2 : “○” indicates that the percentage content of the restricted substance does not exceed the percentage of reference value of presence.						
備考3. “—” 係指該項限用物質為排除項目。 Note 3 : The “—” indicates that the restricted substance corresponds to the exemption.						

European Waste Electrical and Electronic Equipment (WEEE) Notice



In accordance with Directive 2012/19/EU of the European Parliament on waste electrical and electronic equipment (WEEE):

- The symbol above indicates that separate collection of electrical and electronic equipment is required.
- When this product has reached the end of its serviceable life, it cannot be disposed of as unsorted municipal waste. It must be collected and treated separately.
- It has been determined by the European Parliament that there are potential negative effects on the environment and human health as a result of the presence of hazardous substances in electrical and electronic equipment.
- It is the users’ responsibility to utilize the available collection system to ensure WEEE is properly treated.

For information about the available collection system, please contact Extreme Customer Support at +353 61 705500 (Ireland).

Hazardous Substances

This product complies with the requirements of Directive 2011/65/EU of the European Parliament and of the Council of 8 June 2011 on the restriction of the use of certain hazardous substances in electrical and electronic equipment.

Detachable Antenna Usage

This radio transmitter (IC: 4141B-AP3915E / Model: AP3915e) has been approved by ISED to operate with the antenna type listed below with maximum permissible gain indicated. Antenna types not included in this list, having a gain greater than the maximum gain indicated for that type, are strictly prohibited for use with this device.

Le présent émetteur radio (IC: 4141B-AP3915E / Model: AP3915e) a été approuvé par ISED pour fonctionner avec les types d’antenne énumérés ci-dessous et ayant un gain admissible maximal. Les types d’antenne non inclus dans cette liste, et dont le gain est supérieur au gain maximal indiqué, sont strictement interdits pour l’exploitation de l’émetteur.

Approved Antenna(s) list:

No.	Function	Antenna Type	Model	Gain (dBi)		Connector
				2.4GHz Band	5GHz Band	
1	WLAN	Dipole	ML-2452-APA2-01	3.17	4.85	RP-SMA Male
2	WLAN	Dipole	ML-2452-APA2-02	3	5	RP-SMA Male
3	WLAN	Dipole	ML-2452-HPA5-036	3	5	RP-SMA Male
4	WLAN	Dipole	ML-2452-HPAG4A6-01	4	7.3	N Male
5	WLAN	Dipole	ML-2452-HPA6M4-S36	6.0	6.0	RP-SMA
6	WLAN	Panel	ML-2452-PNL9M3-036	11.0	10.7	RP-SMA Male
7	WLAN	Panel	ML-2452-PNL6M3-N36	6	6	N Male
8	WLAN	Panel	ML-2452-PNA5-01R	5.5	6	N Male
9	WLAN & BT LE & Zigbee	Panel	ML-2452-PNA7-01R	7.8	10.7	N Male
10	WLAN	Patch	ML-2452-PTA2M2-036	4	5	RP-SMA Male
11	WLAN	Patch	ML-2452-PTA4M4-036	5	6.6	RP-SMA Male
12	BT LE & Zigbee	Omni	ML-2499-HPA8-01	8	-	Fixed N-Male Std polarity

Declaration of Conformity in Languages of the European Community

English

Hereby, Extreme Networks, declares that this Radio LAN device is in compliance with the essential requirements and other relevant provisions of Directive 1999/5/EC.

Finnish

Valmistaja Extreme Networks vakuuttaa täten että Radio LAN device tyypininen laite on direktiivin 1999/5/EY oleellisten vaatimusten ja sitä koskevien direktiivin muiden ehtojen mukainen.

Dutch

Hierbij verklaart Extreme Networks dat het toestel Radio LAN device in overeenstemming is met de essentiële eisen en de andere relevante bepalingen van richtlijn 1999/5/EG.

French

Par la présente Extreme Networks déclare que l’appareil Radio LAN device est conforme aux exigences essentielles et aux autres dispositions pertinentes de la directive 1999/5/CE.

Par la présente, Extreme Networks déclare que ce Radio LAN device est conforme aux exigences essentielles et aux autres dispositions de la directive 1999/5/CE qui lui sont applicables.

Swedish

Härmed intygar Extreme Networks att denna Radio LAN device står i överensstämmelse med de väsentliga egenskapskrav och övriga relevanta bestämmelser som framgår av direktiv 1999/5/EG.

Danish

Undertegnede Extreme Networks erklærer herved, at følgende udstyr Radio LAN device overholder de væsentlige krav og øvrige relevante krav i direktiv 1999/5/EF.

German

Hiermit erklärt Extreme Networks die Übereinstimmung des "WLAN Wireless Controller bzw. Access Points" mit den grundlegenden Anforderungen und den anderen relevanten Festlegungen der Richtlinie 1999/5/EG.

Greek

ΜΕ ΤΗΝ ΠΑΡΟΥΣΑ Extreme Networks **ΔΗΛΩΝΕΙ ΟΤΙ** Radio LAN device **ΣΥΜΜΟΡΦΩΝΕΤΑΙ ΠΡΟΣ ΤΙΣ ΟΥΣΙΩΔΕΙΣ ΑΠΑΙΤΗΣΕΙΣ ΚΑΙ ΤΙΣ ΛΟΙΠΕΣ ΣΧΕΤΙΚΕΣ ΔΙΑΤΑΞΕΙΣ ΤΗΣ ΟΔΗΓΙΑΣ 1999/5/ΕΚ.**

Icelandic

Extreme Networks lýsir her með yfir að thessi bunadur, Radio LAN device, uppfyllir allar grunnkröfur, sem gerðar eru í R&TTE tilskipun ESB nr 1999/5/EC.

Italian

Con la presente Extreme Networks dichiara che questo Radio LAN device è conforme ai requisiti essenziali ed alle altre disposizioni pertinenti stabilite dalla direttiva 1999/5/CE.

Spanish

Por medio de la presente Extreme Networks declara que el Radio LAN device cumple con los requisitos esenciales y cualesquiera otras disposiciones aplicables o exigibles de la Directiva 1999/5/CE.

Portuguese

Extreme Networks declara que este Radio LAN device está conforme com os requisitos essenciais e outras disposições da Directiva 1999/5/CE.

Malti

Hawnhekk, Extreme Networks, jiddikjara li dan Radio LAN device jikkonforma mal-htigijiet essenzjali u ma provvedimenti ohrajn rilevanti li hemm fid-Dirrettiva 1999/5/EC.

Extreme Wireless™ Access Points

Quick Reference

P/N 31031 WS-AP3915e-FCC

P/N 31032 WS-AP3915e-ROW

Bij deze verklaart Extreme Networks dat deze Radio LAN device voldoet aan de essentiële eisen en aan de overige relevante bepalingen van Richtlijn 1999/5/EG.

Par la présente Extreme Networks déclare que l’appareil Radio LAN device est conforme aux exigences essentielles et aux autres dispositions pertinentes de la directive 1999/5/CE.

Par la présente, Extreme Networks déclare que ce Radio LAN device est conforme aux exigences essentielles et aux autres dispositions de la directive 1999/5/CE qui lui sont applicables.

Härmed intygar Extreme Networks att denna Radio LAN device står i överensstämmelse med de väsentliga egenskapskrav och övriga relevanta bestämmelser som framgår av direktiv 1999/5/EG.

Undertegnede Extreme Networks erklærer herved, at følgende udstyr Radio LAN device overholder de væsentlige krav og øvrige relevante krav i direktiv 1999/5/EF.

Hiermit erklärt Extreme Networks die Übereinstimmung des "WLAN Wireless Controller bzw. Access Points" mit den grundlegenden Anforderungen und den anderen relevanten Festlegungen der Richtlinie 1999/5/EG.

ΜΕ ΤΗΝ ΠΑΡΟΥΣΑ Extreme Networks **ΔΗΛΩΝΕΙ ΟΤΙ** Radio LAN device **ΣΥΜΜΟΡΦΩΝΕΤΑΙ ΠΡΟΣ ΤΙΣ ΟΥΣΙΩΔΕΙΣ ΑΠΑΙΤΗΣΕΙΣ ΚΑΙ ΤΙΣ ΛΟΙΠΕΣ ΣΧΕΤΙΚΕΣ ΔΙΑΤΑΞΕΙΣ ΤΗΣ ΟΔΗΓΙΑΣ 1999/5/ΕΚ.**

Extreme Networks lýsir her með yfir að thessi bunadur, Radio LAN device, uppfyllir allar grunnkröfur, sem gerðar eru í R&TTE tilskipun ESB nr 1999/5/EC.

Con la presente Extreme Networks dichiara che questo Radio LAN device è conforme ai requisiti essenziali ed alle altre disposizioni pertinenti stabilite dalla direttiva 1999/5/CE.

Por medio de la presente Extreme Networks declara que el Radio LAN device cumple con los requisitos esenciales y cualesquiera otras disposiciones aplicables o exigibles de la Directiva 1999/5/CE.

Extreme Networks declara que este Radio LAN device está conforme com os requisitos essenciais e outras disposições da Directiva 1999/5/CE.

Hawnhekk, Extreme Networks, jiddikjara li dan Radio LAN device jikkonforma mal-htigijiet essenzjali u ma provvedimenti ohrajn rilevanti li hemm fid-Dirrettiva 1999/5/EC.

Notice

Copyright © 2017 Extreme Networks, Inc. All Rights Reserved.

Legal Notices

Extreme Networks, Inc., on behalf of or through its wholly-owned subsidiary, Enterasys Networks, Inc., reserves the right to make changes in specifications and other information contained in this document and its website without prior notice. The reader should in all cases consult representatives of Extreme Networks to determine whether any such changes have been made.

The hardware, firmware, software or any specifications described or referred to in this document are subject to change without notice.

Trademarks

Extreme Networks and the Extreme Networks logo are trademarks or registered trademarks of Extreme Networks, Inc. in the United States and/or other countries.

All other names (including any product names) mentioned in this document are the property of their respective owners and may be trademarks or registered trademarks of their respective companies/owners.

For additional information on Extreme Networks trademarks, please see: www.extremenetworks.com/company/legal/trademarks/

Documentation & Support

For product support, including documentation, visit: www.extremenetworks.com/support/



P/N 9035134-02

Extreme[®]

Connect Beyond the Network