

Can't connect? Need help?



**DO NOT RETURN THIS  
PRODUCT TO THE STORE**

**1-800-790-1440**  
**Mon-Fri 9:00-5:00 EST (USA)**  
or **info@atomiusa.com**

Wi-Fi

 **atomi™**

# Smart AC Adaptor

## User Manual

AT1310



Scan the QR code  
for a quick video setup

[www.atomiusa.com/product/smart-ac-adaptor](http://www.atomiusa.com/product/smart-ac-adaptor)

Date Code: 01/19

## Thank you for purchasing the atomi Smart AC Adaptor.

The atomi Smart AC Adaptor controls your AC's power, temperature, mode and fan speed from your phone anytime, anywhere in the world! Set weekly schedules, turn your air conditioner on and off automatically, and much more.

### Inside the box you'll find:



Smart AC Wall Plate



User Manual

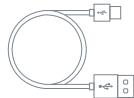

10ft Micro-USB Cable

## Compatibility

The atomi Smart AC Adaptor can be installed to control all window or free-standing air conditioners with a remote control.

## Before you begin

1. Know your Wi-Fi network and password
2. Make sure your mobile device is running iOS® 8 or higher or Android™ 4.1x or higher
3. Make sure you're connected to a 2.4GHz Wi-Fi network (atomi Smart can't connect to 5GHz networks)

## Step 1: Plug in

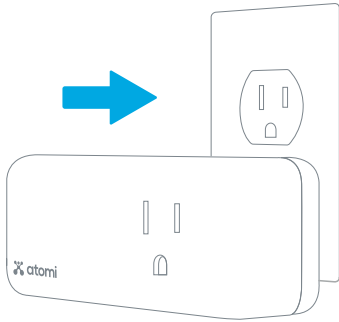

Plug your atomi Smart AC Wall Plate into any standard grounded outlet.

## Step 2: Connect

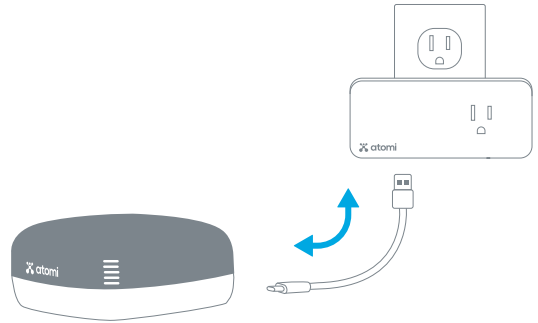

Connect the Micro-USB Cable to Smart AC Adaptor and Smart AC Wall Plate.

## Step 3: Download App

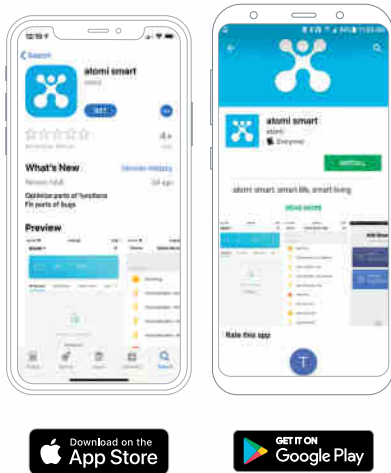

Download the atomi smart app from the App Store or Google Play.

## Step 4: Register

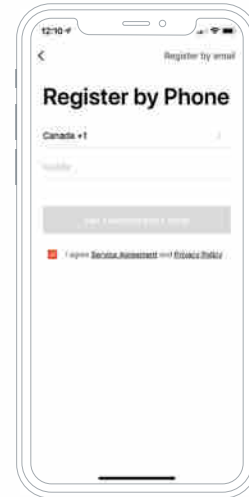

Enter your mobile phone number or email address.

## Step 5: Add Device



Enter the verification code and create a password.

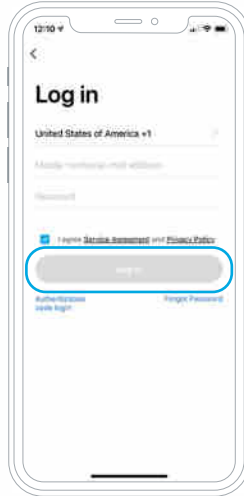

Log in to the app.

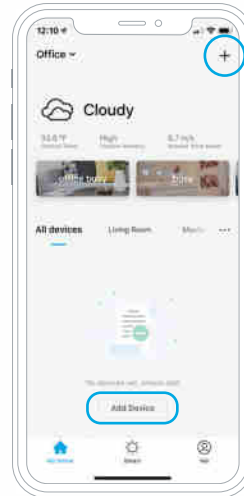

Select "Add Device" or click (+) at the top right corner of the devices screen.

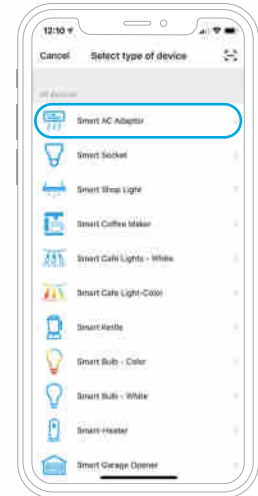

Choose "Smart AC Adaptor" from the device list.

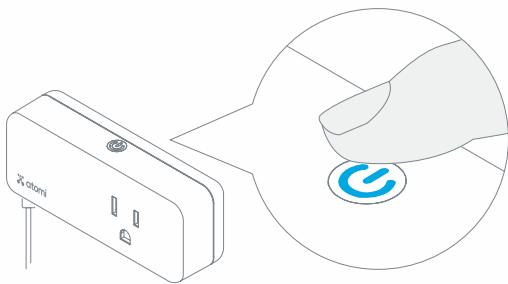

Hold the power button for 10 seconds until the indicator light is flashing rapidly, then press "Continue".

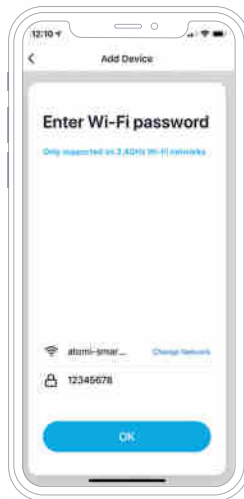

Enter your Wi-Fi network and password.

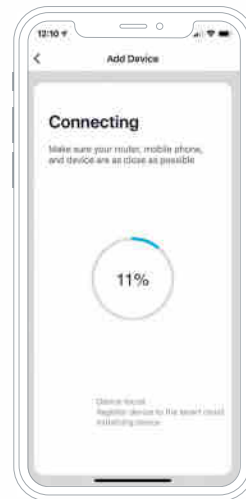

The atomi smart app will connect your device.

## Step 6: Plug in your AC

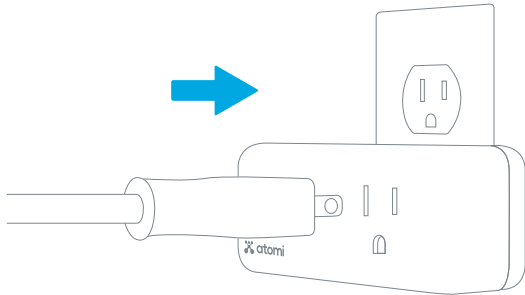

Plug in your AC cable into the  
Smart AC Wall Plate

## Step 7: AC Remote Control Setup



**No LCD  
Screen**  
Page 14-18



**with LCD  
Screen**  
Page 19-21

Based on the style of your AC's remote  
control, choose the correct option above  
and read the corresponding pages.

Point your AC Remote at the Smart AC Adaptor.  
Make sure the remote and your AC are within  
one meter from Smart AC Adaptor.

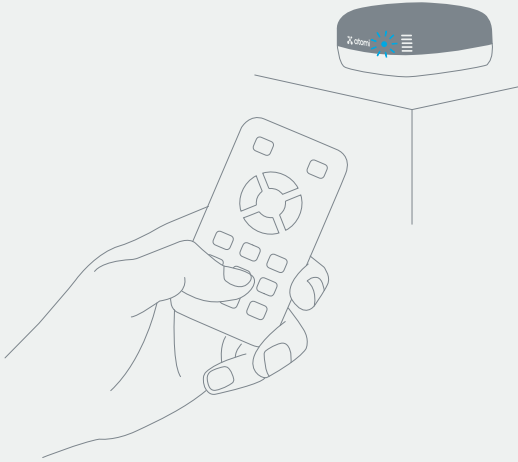

**Tip:** Smart AC Adaptor will blink blue  
when remote pairing is successful.



## No LCD Screen Remote Control

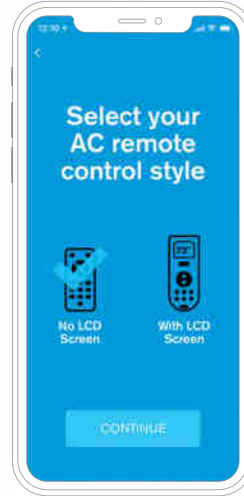

Select "No LCD  
Screen" and  
click "Continue".

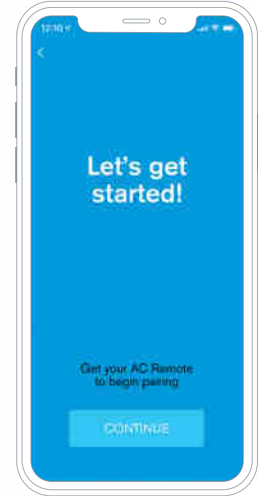

Click "Continue"  
to begin AC  
remote pairing.



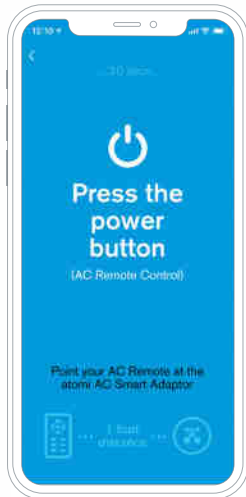

Press the power button on AC remote.

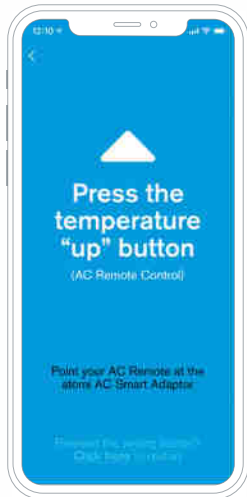

Press the temperature "up" button on AC remote.

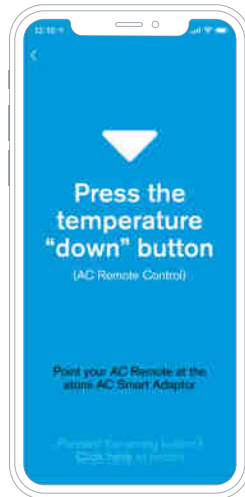

Press the temperature "down" button on AC remote.

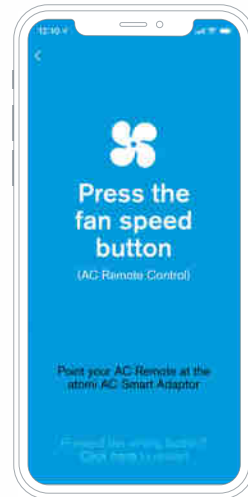

Press the fan speed button on AC remote.

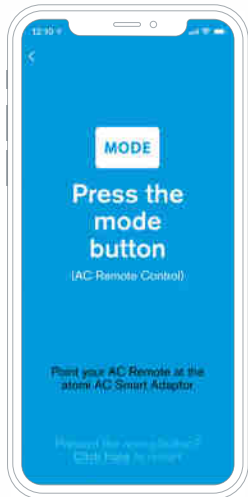

Press the mode speed button on AC remote.

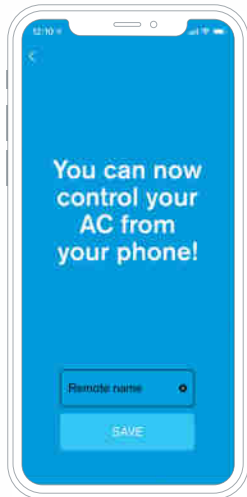

Setup is complete! Enter remote name and select save.

**Room Temperature**  
Displays current room temperature.  
\*Does not display AC temperature.

**Mode**  
Selects the operating mode such as cool, dry or fan.

**Fan Speed**  
Adjust the fan speed between low, medium or high.

**Down**  
Lowers temperature.

**Up**  
Increases temperature.

**Power**  
Turns the AC on and off.

**Usage**  
Monitors electric current usage of your AC.

**Schedule**  
Sets up weekly schedules to fit your lifestyle.

**Countdown**  
Automatically powers AC on and off based on a timer.

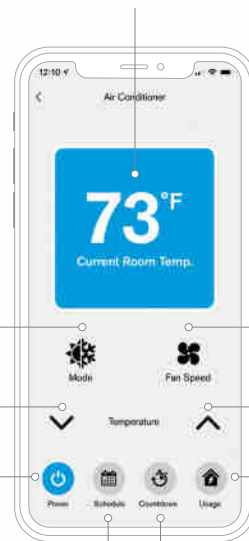



## With LCD Screen Remote Control

This mode allows for unlimited presets. Create your favorite temperature settings.

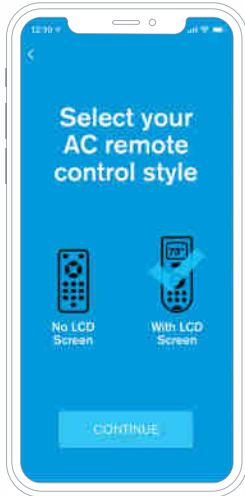

Select "with LCD Screen" and click "Continue".



Point your AC Remote at the AC Smart Adaptor and Click "Next".

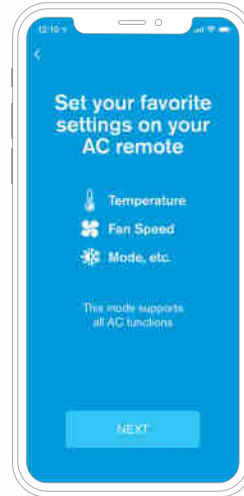

Set your favorite AC settings on your AC remote and Click "Next".

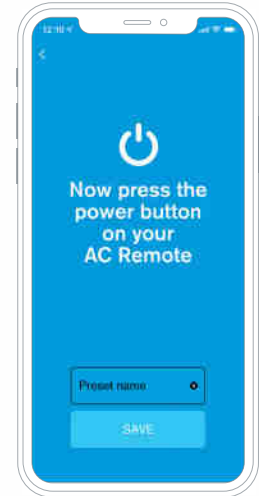

Press the power button on your AC Remote. Enter preset name and select save.



## Reset Smart AC Adaptor

To reset Smart AC Adaptor, unplug then plug Smart AC Adaptor back in. Press and hold the power button for 10 seconds.

- Reset one time (press and hold) to reach Easy Mode (Fast blinking blue)
- Reset two times (press and hold) to reach AP Mode (Slow blinking blue)

## System Requirements

- Mobile device running iOS® 8 or higher or Android™ 4.1x or higher
- Existing Wi-Fi Network

## Specifications:

Input: 125V~60Hz 10A 1250W (Resistive)  
 USB Input: 100-125V~50/60Hz 0.3A  
 USB Output: 5V=1A

## Troubleshooting

### **Cannot connect to your Wi-Fi network.**

Make sure you entered the correct Wi-Fi password during the Wi-Fi setup. Check whether there are problems with your internet connection. If the Wi-Fi signal is too weak, reset your Wi-Fi router and try again.

### **Setup is not working properly.**

1. Close all apps that are running in the background then re-open the atomi smart app.
2. Uninstall and reinstall the atomi smart app then repeat the setup process. For setup instructions, please refer to page 8.
3. Reset or restore your Smart AC Adaptor to factory default settings. Please go to page 22 for reset instructions.

**IMPORTANT:** Resetting your Smart AC Adaptor to its default factory settings will delete all the data that was saved in it. You will need to set up your Smart AC Adaptor again. Please refer to page 8 for setup instructions.

### **Setup complete but app is not responding.**

Make sure to keep the Smart AC Adaptor in the line of sight of your air conditioner.

### **Temperature control is not changing.**

If temperature is not changing on the atomi smart app it's because you are in the wrong MODE. Push the MODE button until you are in the cooling mode.

### **Wi-Fi pairing is not working.**

Make sure the Micro-USB Cable and Smart AC Adaptor are plugged in before Wi-Fi setup.

### **AC remote is not pairing with app.**

For initial setup, make sure the Smart AC Adaptor is within 1 meter of your air conditioner.

### **AC temperature is not showing on app.**

The AC temperature shown on app monitors your room temperature and not your AC temperature.

### **The AC remote control app is slow.**

The AC remote control app may function slower depending on Wi-Fi strength.

**Important Information:**

Before installing, read and follow all precautions, including the following:

**CAUTION:** Suitable for indoor use only.

**DO NOT IMMERSE IN WATER.**

**DO NOT EXCEED RATED CAPACITY.**

**Made in China**

For questions or concerns,  
email us at [info@atomiusa.com](mailto:info@atomiusa.com)  
Manufactured and marketed by Atomi, Inc.  
10 West 33rd St. Suite 520, New York, NY 10001  
atomi™ is a trademark of Atomi, Inc.  
Designed by atomi in New York.

One-year limited warranty from date of purchase against defects in materials and workmanship. Google is a trademark of Google LLC. Amazon, Alexa and all related logos are trademarks of Amazon.com, Inc. or its affiliates.

# FCC Warning Statement

This equipment has been tested and found to comply with the limits for a Class B digital device, pursuant to part 15 of the FCC Rules. These limits are designed to provide reasonable protection against harmful interference in a residential installation. This equipment generates, uses and can radiate radio frequency energy and, if not installed and used in accordance with the instructions, may cause harmful interference to radio communications. However, there is no guarantee that interference will not occur in a particular installation. If this equipment does cause harmful interference to radio or television reception, which can be determined by turning the equipment off and on, the user is encouraged to try to correct the interference by one or more of the following measures:

- Reorient or relocate the receiving antenna.
- Increase the separation between the equipment and receiver.
- Connect the equipment into an outlet on a circuit different from that to which the receiver is connected.
- Consult the dealer or an experienced radio/TV technician for help.

Caution: Any changes or modifications to this device not explicitly approved by manufacturer could void your authority to operate this equipment.

This device complies with part 15 of the FCC Rules. Operation is subject to the following two conditions: (1) This device may not cause harmful interference, and (2) this device must accept any interference received, including interference that may cause undesired operation.

To comply with FCC RF exposure compliance requirements, this grant is applicable to only mobile configurations. The antennas used for this transmitter must be installed to provide a separation distance of at least 20 cm from all persons and must not be co-located or operating in conjunction with any other antenna or transmitter.