

609.6mm

76.2mm

101.6mm



FLIhub + FLIcube

All-in-one fast charging solution



User manual

Welcome

Thank you for purchasing the FLIhub + FLIcube all-in-one fast charging solution which allows you to charge your battery powered devices at the same time. The FLIhub provides 10 watts of Qi wireless power and 50 watts of conductive power. Simply place the FLIcube on the FLIhub conductive surface to fast charge up to 2 devices at once via dual 12 watt USB-A ports.

Package contents

- (1) FLIhub charge pad
- (1) FLIcube charging module
- Power cord
- User manual

Features

- FLIhub + FLIcube can charge up to 3 of your mobile devices at the same time including smartphones, tablets, smart watches and other mobile devices.
- FLIhub features a 50 watt conductive charging surface that delivers high power wirelessly to the FLIcube charging module and other FLI Charge modules.
- FLIhub also features a 10 watt Qi wireless charge pad to fast charge the latest Apple, Samsung and Android phones plus other Qi-enabled devices.
- The FLIcube charging module delivers a combined 24 watts of fast charging power via dual 12 watt USB-A ports.

2

How to Use

- Use the supplied power plug to connect the FLIhub to the wall outlet.

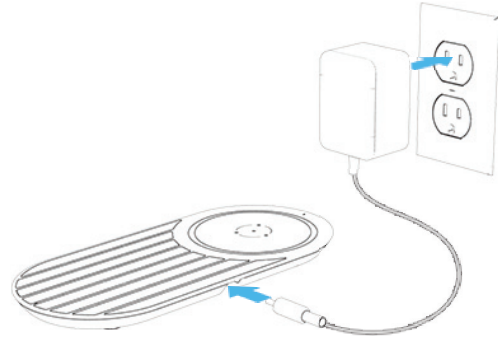

3

How to Use

- Place your Qi-enabled wireless device on the Qi pad.

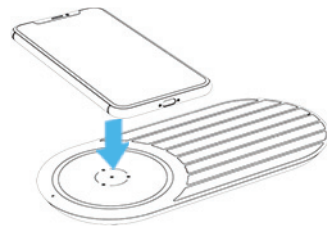

- Charging begins on contact.



4

How to Use

- Place the FLIcube charging module onto any powered FLI Charge conductive surface ensuring that at least 2 of the pogo pins located on the bottom make contact.

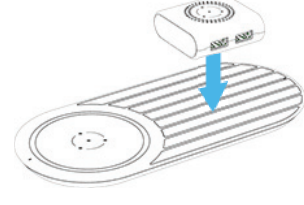

- Plug in a USB-A charging cable and connect to fast charge your mobile devices

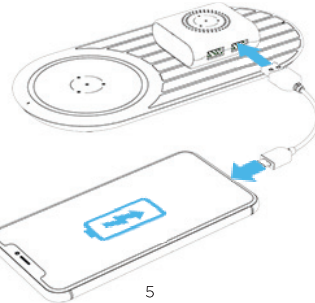

5

Maintenance and Usage

- The AC wall outlet should be located near the FLIhub charging pad and be easily accessible.
- The FLIcube can charge up to two mobile devices (smartphones, wireless earbuds, tablets, cameras, etc.). However, certain devices or combination of devices may require more power than is available. When this happens, the indicator light on the FLIhub will blink. Remove the high powered device to resume normal charging.
- Ensure that dirt or other contaminants are not on the FLIhub charging pad or underneath the FLIcube. Charging will not occur if proper contact between the FLIhub and FLIcube is not made.
- Ensure that the Qi-enabled device is resting flat on the Qi portion of the FLIhub. Charging will not occur if the device is in a tipped position and not centered on the pad.
- If you are using a case with your Qi-enabled smartphone, ensure that it is not too thick and is Qi compatible. Otherwise, your phone may not charge.

6

Troubleshooting Guide

The following table lists potential problems and their suggested solutions:

Problem	Cause	Solution
Indicator light does not turn on when a device is placed on the FLIhub charging pad.	The device is not Qi-enabled.	Place only Qi-enabled devices on the Qi charging pad.
	Device is not resting properly on the FLIhub charging pad surface.	Ensure the device is laying flat and making good contact with the charging surface. Clean pad surface if necessary.
	DC power plug not firmly plugged into charging pad or AC adapter not plugged into wall socket.	Ensure the AC adapter is plugged into a working outlet and DC power plug is firmly inserted into charging pad.
	Metallic objects such as keys or coins may be on the charging pad.	Remove metal objects and charging will resume normally.
Device does not indicate charging when placed on the FLIhub charging pad.	Smartphone case is too thick and/or non Qi-compatible.	Replace with thinner and/or Qi-compatible smartphone case.
	Device is not resting properly on the FLIhub charging pad surface.	Ensure the device is laying flat and making good contact with the charging surface. Clean pad surface if necessary.
Indicator light continuously blinks on and off (devices do not charge).	Smartphone case is too thick and/or non Qi-compatible.	Replace with thinner and/or Qi-compatible smartphone case.
	Overload condition; Try removing devices.	Remove devices one at a time until blinking stops.

7



www.FLICharge.com

FLI Charge Limited Warranty <p>What the Warranty covers Pursuant to this limited warranty (the "Warranty"), FLI Charge, LLC ("FLI Charge") warrants to the original purchaser of a FLI Charge product that such product shall be free of defects in design, assembly, material, or workmanship. What the period of coverage is FLI Charge warrants each of its products for one (1) year from the original date of purchase. What the Warranty does not cover This Warranty does not cover damage caused by misuse or abuse, accident, the attachment of any unauthorized accessory, alteration to the product, improper installation, unauthorized repairs or modifications, improper use of electrical/power supply, loss of power, dropped product, malfunction or damage of an operating part from failure to provide manufacturer's recommended maintenance, transportation damage, theft, neglect, vandalism, environmental condition, loss of use during the period that the product is at a repair facility or otherwise awaiting parts or repair, or any other conditions whatsoever that are beyond the control of FLI Charge. This Warranty is effective only if the product is purchased and operated in the country in which the product is purchased. A product that requires modifications or adoption to enable it to operate in any other country than the country for which it was designed, manufactured, approved and/or authorized, or repair of products damaged by these modifications is not covered under this Warranty. FLI Charge reserves the right to discontinue any of its products</p>	FLI Charge Limited Warranty <p>without notice, and disclaims any limited warranty to repair or replace any such discontinued products. In the event that FLI Charge is unable to replace the product (for example, because such product has been discontinued), FLI Charge will offer a similar replacement product if possible. This Warranty does not apply to products purchased from a source other than FLI Charge or a FLI Charge Authorized Reseller. How to Replace Defective Products If found to be defective, in FLI Charge's sole discretion, FLI Charge devices will be replaced without charge when returned to FLI Charge. Please send FLI Charge devices to: FLI Charge, LLC, 191 E Deerpath Road, Suite 100, Lake Forest, IL 60045, United States. You can contact customer support by e-mailing support@flicharge.com. FLI Charge reserves the right to review the damaged FLI Charge product. All costs of shipping the FLI Charge product to FLI Charge for inspection shall be borne solely by the purchaser. If FLI Charge determines, in its sole discretion, that it is impractical to ship the damaged equipment to FLI Charge, FLI Charge may designate, in its sole discretion, an equipment repair facility to inspect and estimate the cost to repair such equipment. The cost, if any, of shipping the equipment to and from such repair facility and of such estimate shall be borne solely by the purchaser. Damaged products must remain available for inspection until the claim is finalized. Whenever claims are settled, FLI Charge reserves the right to be subrogated under any insurance policies the purchaser may have.</p>	FLI Charge Limited Warranty <p>Disclaimer IN THOSE JURISDICTIONS WHERE IT CAN LAWFULLY DO SO, AND TO THE MAXIMUM EXTENT PERMITTED BY APPLICABLE LAW, THE WARRANTY PROVIDED HEREIN SHALL BE THE SOLE AND EXCLUSIVE WARRANTY. FLI CHARGE HEREBY DISCLAIMS AND EXCLUDES ALL OTHER WARRANTIES, EXPRESS, STATUTORY, OR IMPLIED, INCLUDING BUT NOT LIMITED TO IMPLIED WARRANTIES OF MERCHANTABILITY, ACCEPTABILITY, SATISFACTORY QUALITY, NON-INFRINGEMENT, TITLE, FITNESS FOR A PARTICULAR PURPOSE, LOSS OF OR DAMAGE TO DATA, LACK OF VIRUSES OR FREE FROM VIRUS OR MALWARE ATTACK, SECURITY, PERFORMANCE, LACK OF NEGLIGENCE, WORKMANLIKE EFFORT, QUIET ENJOYMENT, THAT THE FUNCTIONS CONTAINED IN THE PRODUCT WILL MEET YOUR REQUIREMENTS, OR THAT DEFECTS IN THE PRODUCT WILL BE CORRECTED, OR THAT YOUR USE OF THE PRODUCT WILL GENERATE ACCURATE, RELIABLE, TIMELY RESULTS, INFORMATION, OR DATA, NO ORAL OR WRITTEN INFORMATION OR ADVICE GIVEN BY FLI CHARGE, A DEALER, AGENT, OR AFFILIATE SHALL CREATE A WARRANTY, TO THE EXTENT WARRANTIES CANNOT BE DISCLAIMED OR EXCLUDED, THEY ARE LIMITED TO THE DURATION OF THE RELEVANT EXPRESS WARRANTY PERIOD. IN NO EVENT SHALL THIS WARRANTY REQUIRE MORE THAN THE REPLACEMENT OF ANY PRODUCT WHICH IS FOUND TO BE DEFECTIVE WITHIN THE EFFECTIVE PERIOD OF THE WARRANTY, NO REFUNDS WILL BE GIVEN. FLI CHARGE</p>	FLI Charge Limited Warranty <p>RESERVES THE RIGHT TO MAKE PRODUCT SUBSTITUTIONS IN LIEU OF REPLACEMENT, EXCEPT AS PROVIDED IN THIS WARRANTY AND TO THE MAXIMUM EXTENT PERMITTED BY APPLICABLE LAW, IN NO EVENT SHALL FLI CHARGE, ITS AFFILIATES, DEALERS, AGENTS OR SUPPLIERS OR THEIR RESPECTIVE OFFICERS, DIRECTORS, EMPLOYEES, LICENSORS AND ASSIGNS BE LIABLE FOR ANY DIRECT, INDIRECT, EXEMPLARY, PUNITIVE, SPECIAL, INCIDENTAL OR CONSEQUENTIAL DAMAGES WHATSOEVER (INCLUDING BUT NOT LIMITED TO DAMAGES FOR LOSS OF PROFITS OR REVENUE, FOR BUSINESS INTERRUPTION, FOR PERSONAL INJURY, FOR LOSS OF PRIVACY, FOR LOSS OF ABILITY TO USE ANY THIRD PARTY PRODUCTS OR SERVICES, FOR FAILURE TO MEET ANY DUTY INCLUDING OF GOOD FAITH OR OF REASONABLE CARE, FOR NEGLIGENCE, AND FOR ANY OTHER PECUNIARY OR OTHER LOSS WHATSOEVER), REGARDLESS OF THE THEORY OF LIABILITY (CONTRACT, TORT OR OTHERWISE) ARISING OUT OF OR IN ANY WAY RELATED TO THE USE OF OR INABILITY TO USE THE PRODUCT, EVEN IF FLI CHARGE OR SUCH OTHER ENTITIES HAVE BEEN ADVISED OF THE POSSIBILITY OF SUCH DAMAGES. IN NO EVENT SHALL THE TOTAL AGGREGATE LIABILITY OF FLI CHARGE, ITS AFFILIATES, ASSOCIATES, DEALERS, AGENTS OR SUPPLIERS TO YOU FOR ALL DAMAGES EXCEED THE PRICE YOU PAID FOR THE PRODUCT. THIS LIMITATION IS CUMULATIVE AND WILL NOT BE INCREASED BY THE EXISTENCE OF MORE THAN ONE INCIDENT OR CLAIM. THE FOREGOING LIMITATIONS WILL</p>	FLI Charge Limited Warranty <p>APPLY EVEN IF ANY WARRANTY OR REMEDY PROVIDED FAILS OF ITS ESSENTIAL PURPOSE. THE WARRANTIES AND REMEDIES SET OUT HEREIN ARE EXCLUSIVE, AND, TO THE EXTENT PERMITTED BY LAW, IN LIEU OF ALL OTHERS ORAL OR WRITTEN, EXPRESS OR IMPLIED. SOME JURISDICTIONS DO NOT ALLOW THE EXCLUSION OR LIMITATION OF IMPLIED WARRANTIES OR OF LIABILITY FOR INCIDENTAL OR CONSEQUENTIAL DAMAGES, SO THE FOREGOING LIMITATIONS MAY NOT APPLY TO YOU, IF ANY TERM IS HELD TO BE ILLEGAL OR UNENFORCEABLE, THE LEGALITY OR ENFORCEABILITY OF THE REMAINING TERMS SHALL NOT BE AFFECTED OR IMPAIRED. How state law relates to the Warranty Some states do not allow limitations on how long an implied warranty lasts, so the above limitations may not apply to you. This warranty gives you specific legal rights, and you may also have other rights, which may vary from state to state. Some states do not allow the exclusion or limitation of incidental, consequential, or other damages, so the above limitations may not apply to you. WARNING & SAFETY INFORMATION WARNING: Failure to follow these safety instructions could result in fire, electric shock, or other injury or damage. When using electrical devices certain precautions should be followed, including: Reduce the risk of electric shock:<ul style="list-style-type: none">• Unplug the device from the electrical outlet prior to cleaning.</p>	FLI Charge Limited Warranty <ul style="list-style-type: none">• Do not reach for an appliance that has fallen into water. Unplug it immediately.• Do not place or store appliance where it can fall or be pulled into water.• Do not place in or drop into water or other liquid.• To reduce the risk of burns, fire, electric shock or injury:• Do not use with extension cord.• Close supervision is necessary when FLI Charge products are used by or near children or disabled persons.• Use FLI Charge products only for their intended use as described in this manual.• Do not use with accessories of devices not having the FLI Charge logo.• Never operate FLI Charge products if they have damaged cords, plugs, cables or housing.• If FLI Charge products are not working properly, have been dropped or damaged, return it to FLI Charge for examination and repair.• Keep FLI Charge product cords away from heated surfaces.• Do not operate FLI Charge products where aerosol (spray) products are being used or where oxygen is being administered.• FLI Charge products are designed for indoor use only. Do not use outdoors.• Only set on dry surfaces. Do not place on surface wet from water or cleaning solvents.• All servicing of this product must be performed by only authorized FLI Charge Service Personnel.	FCC Warning <p>This device complies with part 15 of the FCC Rules. Operation is subject to the following two conditions: (1) this device may not cause harmful interference, and (2) this device must accept any interference received, including interference that may cause undesired operation. Any changes or modifications not expressly approved by the party responsible for compliance could void the user's authority to operate the equipment. NOTE: This equipment has been tested and found to comply with the limits for a Class B digital device, pursuant to Part 15 of the FCC Rules. These limits are designed to provide reasonable protection against harmful interference in a residential installation. This equipment generates, uses and can radiate radio frequency energy and, if not installed and used in accordance with the instructions, may cause harmful interference to radio communications. However, there is no guarantee that interference will not occur in a particular installation. If this equipment does cause harmful interference to radio or television reception, which can be determined by turning the equipment off and on, the user is encouraged to try to correct the interference by one or more of the following measures:<ul style="list-style-type: none">• Reorient or relocate the receiving antenna.• Increase the separation between the equipment and receiver.• Connect the equipment into an outlet on a circuit different from that to which the receiver is connected.• Consult the dealer or an experienced radio/TV technician for help.</p>	FCC Warning <p>To maintain compliance with FCC's RF Exposure guidelines, This equipment should be installed and operated with minimum distance between 20cm the radiator your body: Use only the supplied antenna.</p> IC Caution <p>This device contains licence-exempt transmitter(s)/receiver(s) that comply with Innovation, Science and Economic Development Canada's licence-exempt RSS(s). Operation is subject to the following two conditions: (1) This device may not cause interference. (2) This device must accept any interference, including interference that may cause undesired operation of the device. Ce dispositif contient les émetteurs/récepteurs autorisés-exempts qui sont conformes au permis RSS exempt du Canada d'innovation, de la Science et de développement économique. L'opération est sujette aux deux conditions suivantes: (1) Ce dispositif peut ne pas causer l'interférence. (2) Ce dispositif doit accepter n'importe quelle interférence, y compris l'interférence qui peut causer le fonctionnement peu désiré du dispositif. This device complies with ISED RF radiation exposure limits set forth for an uncontrolled environment. This transmitter must not be co-located or operating in conjunction with any other antenna or transmitter. This device must be installed and operated with a minimum distance of 20 cm between the radiator and user body. ce dispositif doit être installé et exploité à une distance minimale de 20 cm entre le radiateur et les corps.</p>
8	9	10	11	12	13	14	15